

HERTFORDSHIRE COUNTY COUNCIL
ROAD TRAFFIC REGULATION ACT 1984

Date of Order: 24 March 2006
Order No. : 6950

*Clare
More yellow lines
for the PA's to
enforce
Brian*

**THE HERTFORDSHIRE (HARCOURT ROAD, BUSHEY)
(RESTRICTION OF WAITING) ORDER 2004**

The Hertfordshire County Council in exercise of their powers under Sections 1, 2 and 3 of the Road Traffic Regulation Act 1984 (which said Act of 1984 is hereinafter referred to as "the Act of 1984"), and of all other enabling powers and after consultation with the Chief Officer of Police in accordance with Part III of Schedule 9 of the Act of 1984, hereby make the following Order:-

1. This Order may be cited as "The Hertfordshire (Harcourt Road, Bushey) (Restriction of Waiting) Order 2004" and shall come into operation on Monday 3 April 2006.
2. Save as provided in Articles 3, 4 and 5 of this Order no person shall cause or permit any vehicle to wait at any time in those lengths of Harcourt Road, Bushey, specified in the Schedule to this Order.
3. (1) Nothing in Article 2 of this Order applies to the lengths of road restricted by that Article (which said lengths of road are referred to in this Article as "the restricted area") in relation to –
 - (a) A vehicle being used for Fire and Rescue, Ambulance or Police purposes.
 - (b) Anything done with the permission of or at the direction of –
 - (i) a police officer in uniform;
 - (ii) in respect of any of the lengths of road in the restricted area which are in a special parking area designated under Part II of the Road Traffic Act 1991 or Schedule 3 to that Act, a parking attendant appointed under Section 63A of the Act of 1984;
 - (c) a vehicle which is prevented from proceeding by circumstances beyond the drivers control or which has stopped in order to avoid injury or damage to persons or property or when required to do so by law;
 - (d) a vehicle which is stationary in order that it may be used for one or more of the purposes specified in sub-Article (2) of this Article and which cannot reasonably be used for such a purpose without stopping in the restricted area;
 - (e) a marked vehicle which, whilst used by a universal service provider in the course of the provision of a universal postal service, is stationary only for so long as may be reasonably necessary for postal packets to be delivered or collected;

In this Article -

The expressions "universal service provider", "provision of a universal postal Service" and "postal packet" shall bear the same meanings as in the Postal Services Act 2000.

- (2) The "purposes" referred to in sub-Article (1)(d) of this Article are –
 - (a) any operation involving building, demolition or excavation;
 - (b) the removal of any obstruction to traffic;

- (c) the maintenance, improvement or reconstruction of a road;
- (d) constructing, improving, maintaining, or cleaning of any street furniture; or
- (e) the laying, erection, alteration, repair or cleaning of any sewer or of any main pipe or apparatus for the supply of gas, water or electricity, or of any telecommunications apparatus kept or installed for the purposes of a telecommunications code system or of any other telecommunications apparatus lawfully kept installed in any position.

4. Nothing in Article 2 of this Order applies to the lengths of road restricted by that Article (which said lengths of road are referred to in this Article as "the restricted area") so as to render it unlawful to cause or permit any vehicle to wait only for so long as may be reasonably necessary –

(a) to enable goods to be loaded on or unloaded from the vehicle from or to premises adjacent to the restricted area; or

(b) to enable a passenger to board or alight and to load and unload any luggage.

5. (1) Nothing in Article 2 of this Order shall render it unlawful to cause or permit a disabled person's vehicle which displays in the relevant position a disabled person's badge and a parking disc, to wait in the length of road specified in the Schedule to this Order for a period not exceeding 3 hours (not being a period separated by an interval of less than 1 hour from a previous period of waiting by the same vehicle in the same length of road).

(2) In this Article -

"disabled person's vehicle" has the same meaning as in Section 142(1) of the Act of 1984;

"disabled person's badge" has the same meaning as in Section 142(1) of the Act of 1984;

"parking disc" has the same meaning as given in Regulation 8(5) of The Local Authorities' Traffic Orders (Exemptions for Disabled Persons) (England) Regulations 2000; and

"relevant position" means

i) A vehicle displays a disabled person's badge in the relevant position if:-

a) in the case of a vehicle fitted with a dashboard or facia panel, the badge is exhibited thereon so that Part 1 of the badge is legible from outside the vehicle; or

b) in the case of a vehicle not fitted with a dashboard or facia panel, the badge is exhibited in a conspicuous position on the vehicle so that Part 1 of the badge is legible from outside the vehicle;

ii) A vehicle displays a parking disc in the relevant position if:-

a) in the case of a vehicle fitted with a dashboard or facia panel, the disc is exhibited thereon so that the quarter hour period during which the period of waiting began is legible from outside the vehicle; or

b) in the case of a vehicle not so fitted, the disc is exhibited in a conspicuous position on the vehicle so that the quarter hour period during which the period of waiting began is legible from outside the vehicle.

6. The Interpretation Act 1978 shall apply for the interpretation of this Order as it applies for the interpretation of an Act of Parliament.
7. The restrictions imposed by this Order shall be in addition to and not in derogation from any restriction or requirement imposed by any other regulations made or having effect as if made under the act of 1984 or by or under any other enactment.

SCHEDULE

lengths of Harcourt Road Bushey – no waiting at any time

Harcourt Road (a) from its junction with the north eastern kerbline of Meadow Road (north west side) north eastwards for approximately 29.5 metres to a point 5 metres south west of a point in line with the south western boundary of 53 Harcourt Road.

(b) from a point 15.5 metres north west of a point in line with the south western boundary of 53 Harcourt Road north eastwards for approximately 28 metres to a point 8 metres south west of a point in line with the north eastern boundary of 55 Harcourt Road.

Harcourt Road (a) from a point 9 metres north west of a point in line with the (south east side) boundary between 52 and 54 Harcourt Road north eastwards for 32.5 metres.

(b) from a point 3.5 metres south west of a point in line with the boundary between 56 and 58 Harcourt Road south westwards for 29 metres.

(both sides) from a point 6.5 metres south of a point in line with the boundary between 57 and 59 Harcourt Road northwards for 29.5 metres.

IN WITNESS whereof the Common Seal of the Hertfordshire County Council was here unto affixed this 24th day of March 2006 .

The Common Seal of)
 Hertfordshire County Council)
 was hereunto affixed)
 in the presence of:-)

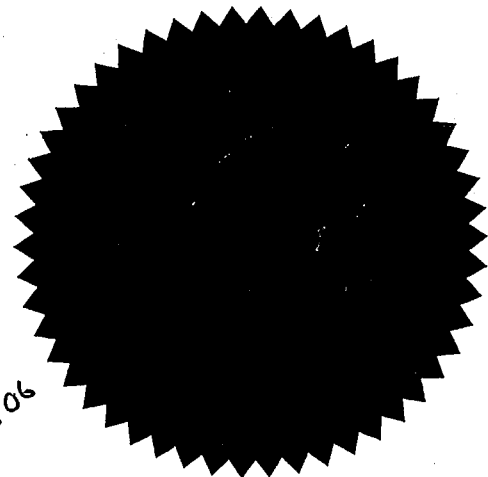

County Secretary



For reference purposes only.
 No further copies may be made.
 This map is based upon Ordnance Survey material with the permission of Ordnance Survey on behalf of the Controller of Her Majesty's Stationary Office.
 (c) Crown copyright.
 Unauthorised reproduction infringes Crown copyright and may lead to prosecution or civil proceedings.
 Herfordshire County Council, LA 076678, 2002

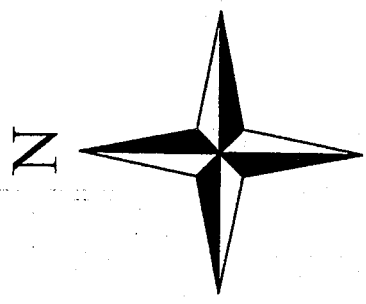

1:1500

Harcourt Road Bushey

 Proposed 20 mph Speed Limit

Rights of Way

Any Rights of Way information on this plan is based on information from the Definitive Map of Public Rights of Way in Herfordshire ("the Definitive Map").
 Accuracy of this plan cannot be guaranteed. In case of doubt, the Definitive Map should be consulted.

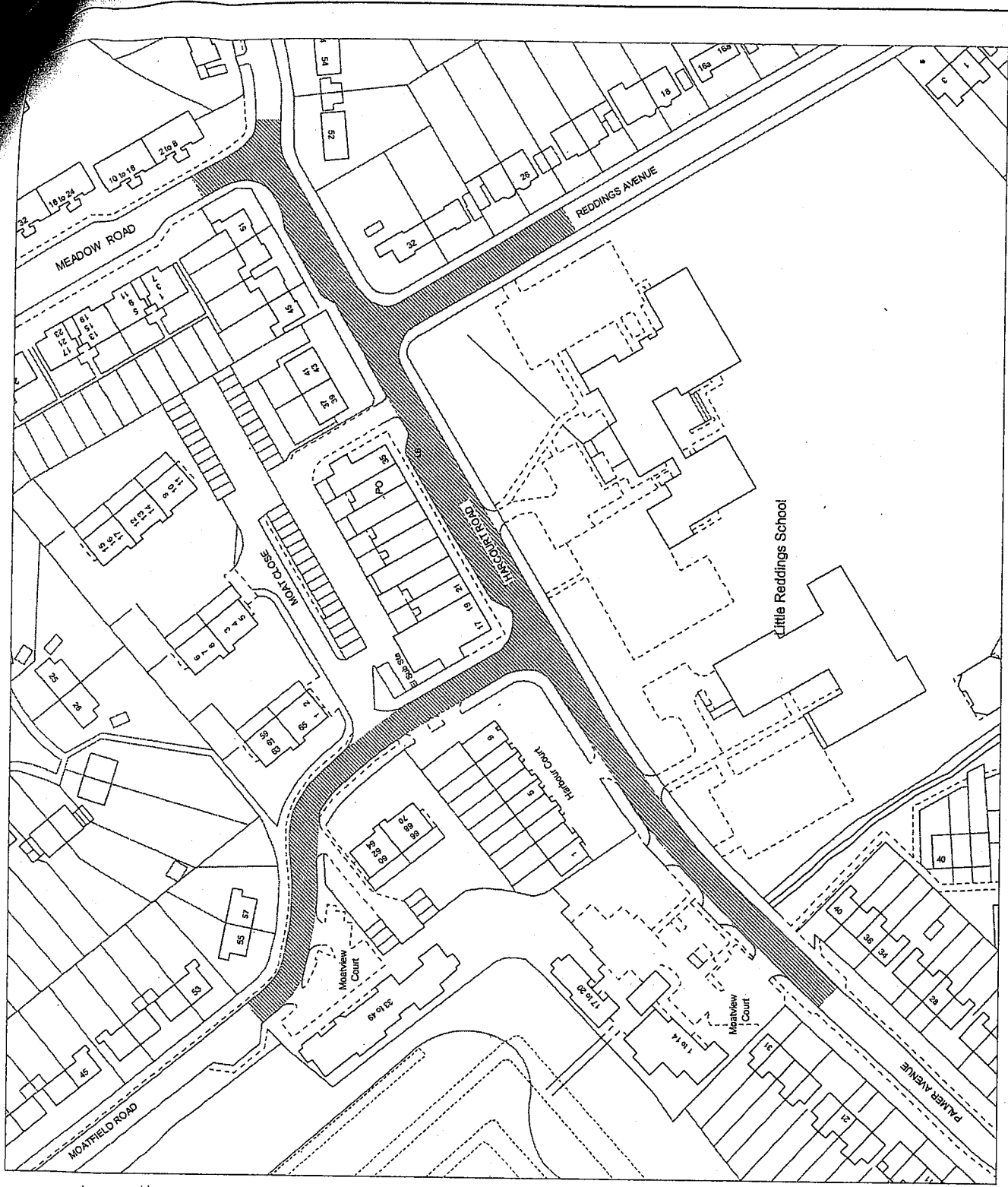

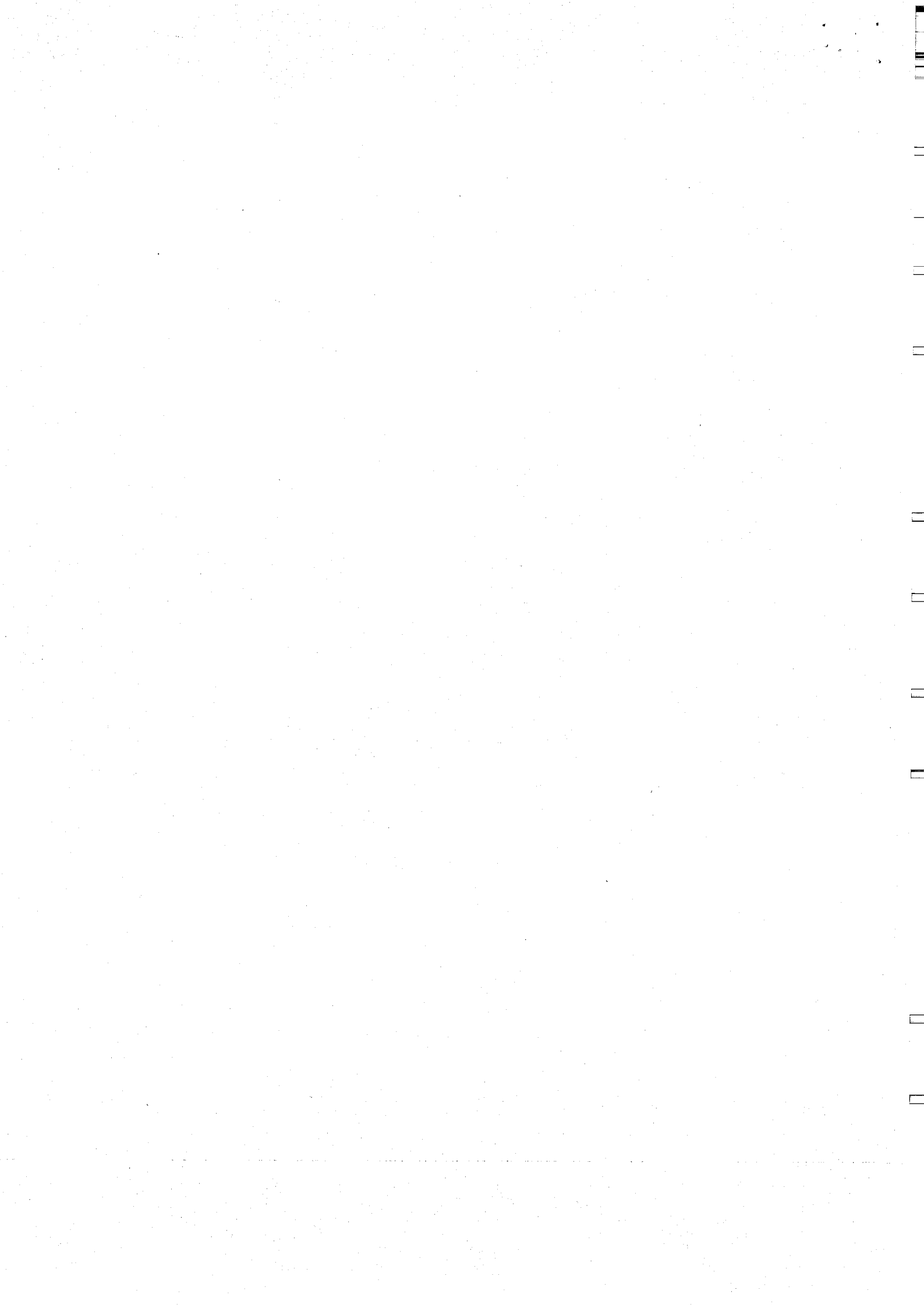

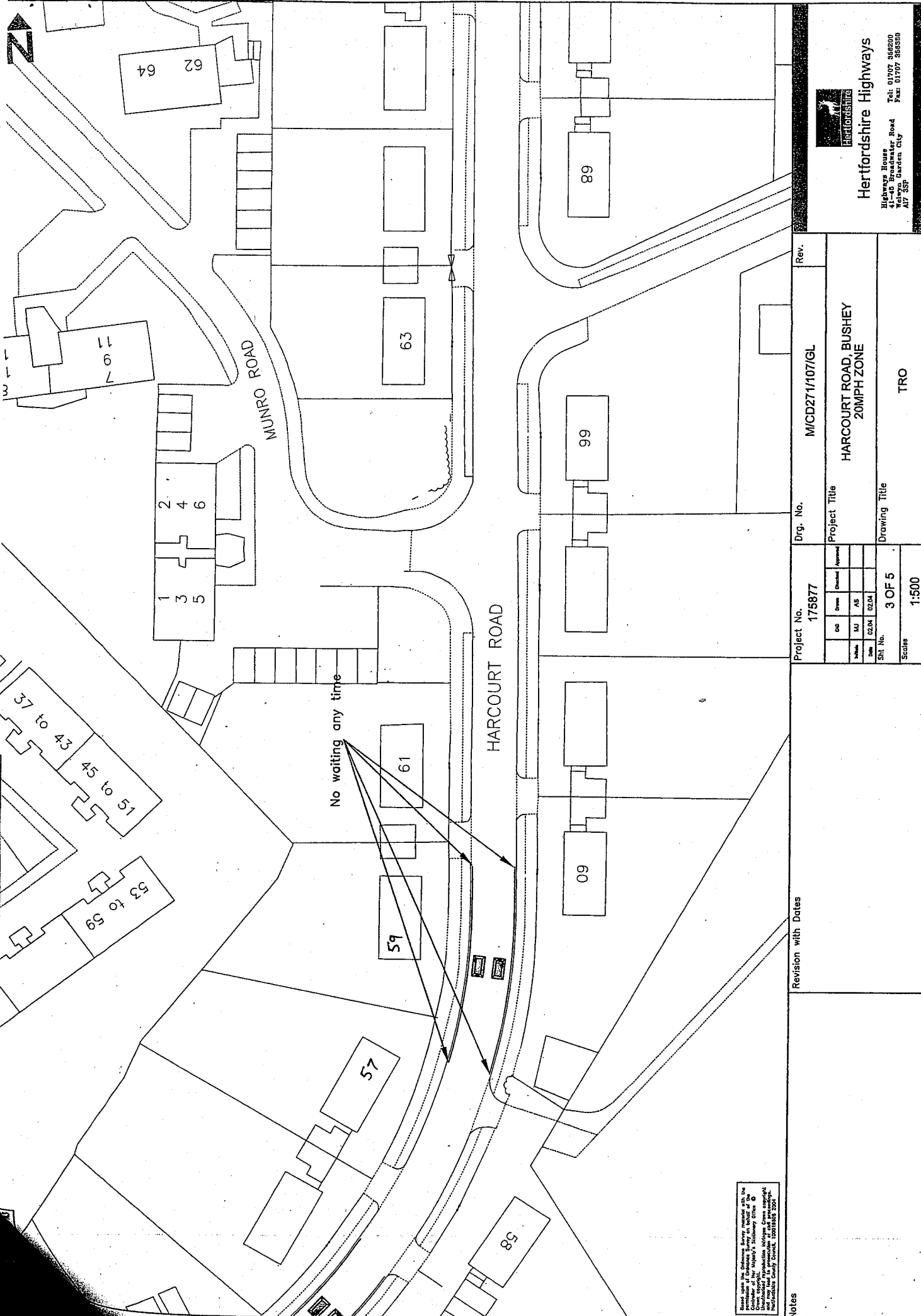

This drawing is the copyright of Hertfordshire County Council and must not be reproduced without written permission.
 Hertfordshire County Council, 100011605 2004

Hertfordshire Highways
 Highways House
 100011605
 Watlington Road
 Watlington, Oxford, OX12 9JF
 Tel: 01753 86200
 Fax: 01753 86300
 A17 35P

Project No.	175877	Drwg. No.	M/CD271/107/GL	Rev.													
<table border="1"> <tr> <td>DD</td> <td>DD</td> <td>Checked</td> <td>Approved</td> </tr> <tr> <td>MM</td> <td>AS</td> <td></td> <td></td> </tr> <tr> <td>Date</td> <td>02.04</td> <td>02.04</td> <td></td> </tr> </table>		DD	DD	Checked	Approved	MM	AS			Date	02.04	02.04		Project Title		HARCOURT ROAD, BUSHEY 20MPH ZONE	
DD	DD	Checked	Approved														
MM	AS																
Date	02.04	02.04															
Sht No.		3 OF 5		Drawing Title													
		1:500		TRO													

Notes

Revision with Dates

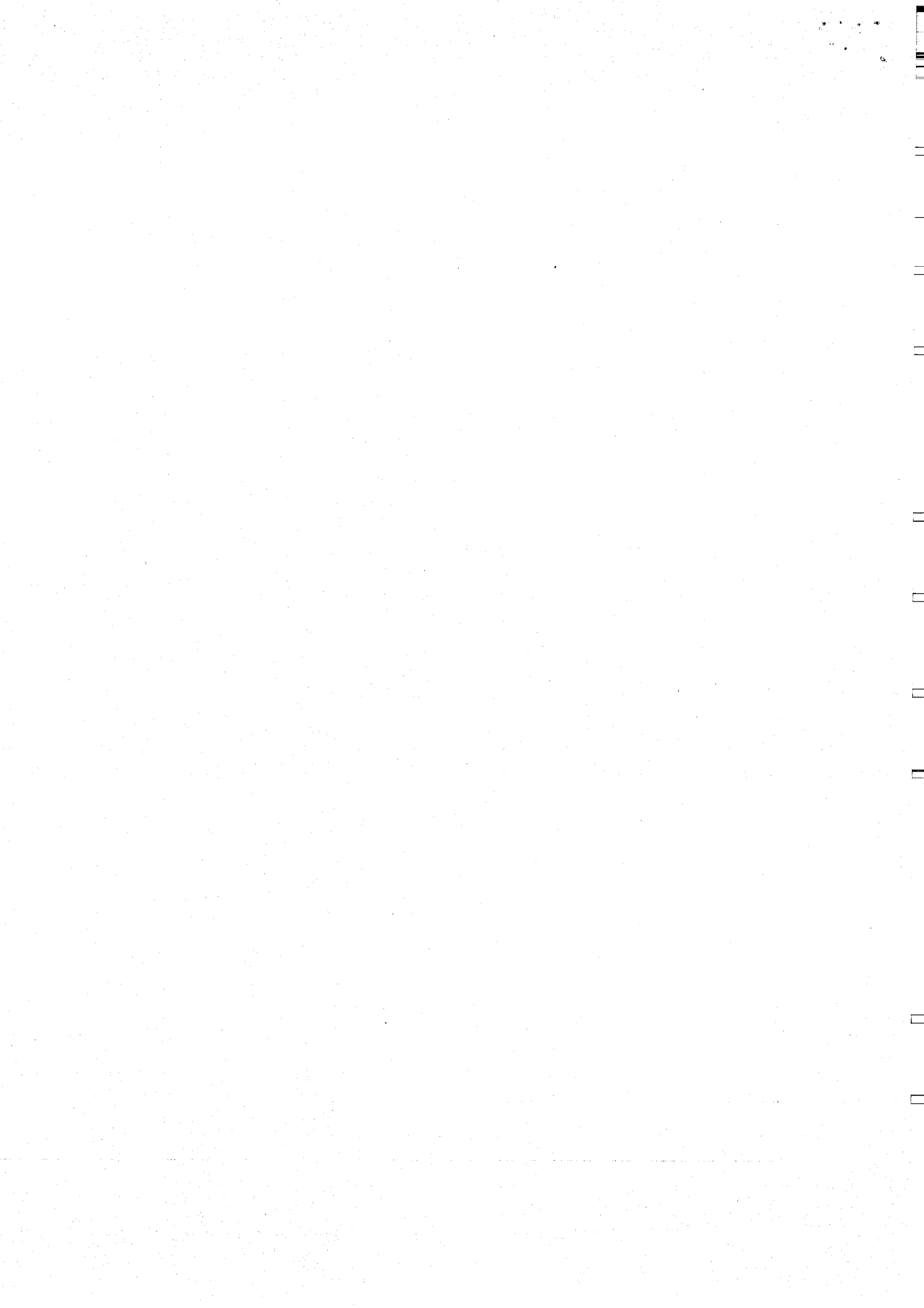

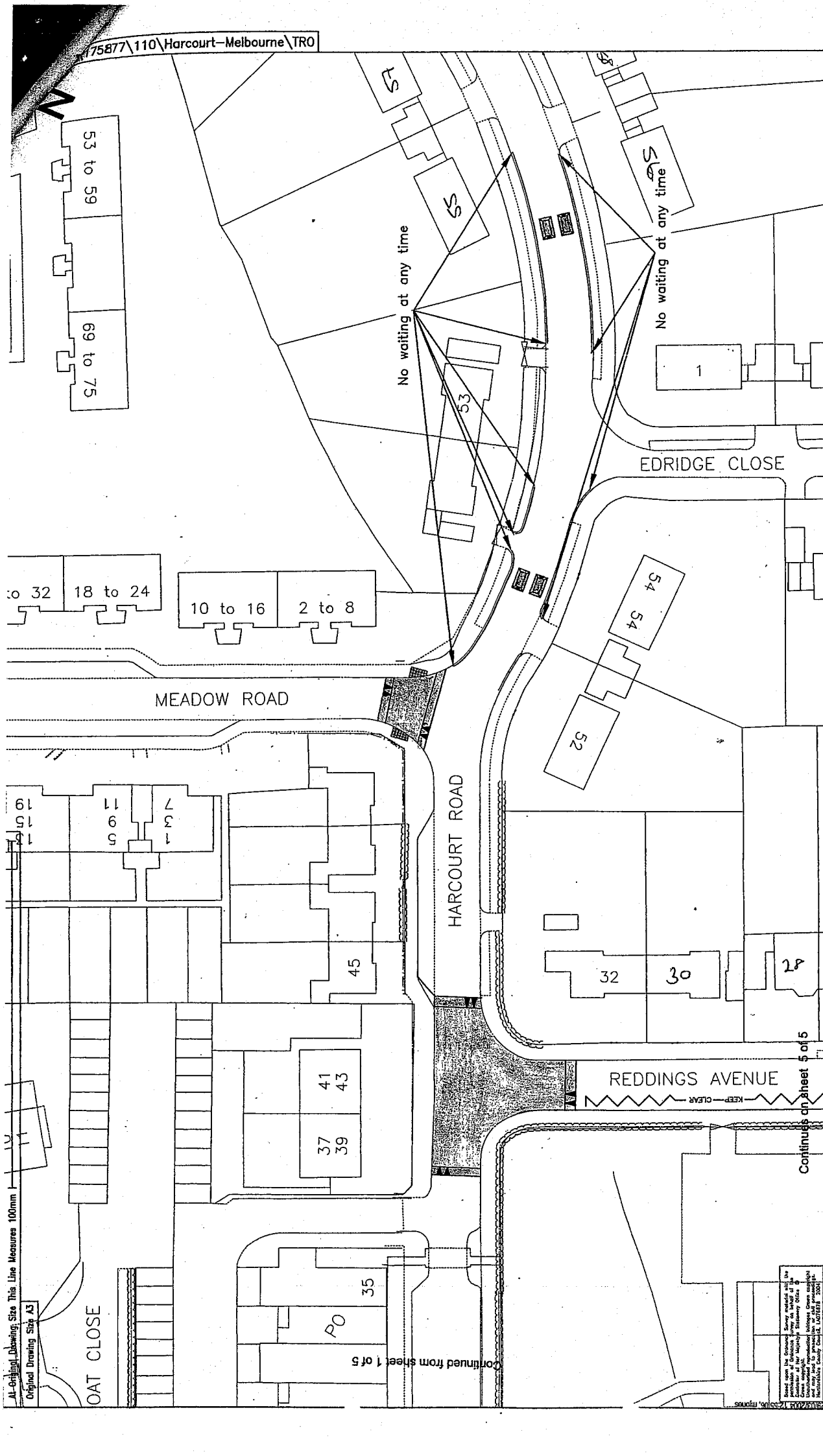

Hertfordshire Highways
 Highway House
 41-46 Broadwater Road
 Garden City
 MK7 5EP
 Tel: 01707 545500
 Fax: 01707 545580

Project No.	175877	Drng. No.	M/CD271/107/GL	Rev.	
Project Title		HARCOURT ROAD, BUSHEY 20MPH ZONE			
Drawing Title		TRO			
Scale	1:500				
Sheet No.	2 OF 5				
Issue	02.04	Rev.	02.04	Author	
Check		Drawn		Checked	
Drawn		AS		Approved	

Revision with Dates	

Notes
 Based upon the Ordnance Survey, which will be the responsibility of the Highway Authority. The Contractor shall be responsible for any errors or omissions in the information provided. The Highway Authority shall not be liable for any errors or omissions in the information provided. The Highway Authority shall not be liable for any errors or omissions in the information provided. The Highway Authority shall not be liable for any errors or omissions in the information provided.

At Original Drawing Size This Line Measures 100mm
 Original Drawing Size A3

Continued from sheet 1 of 5

Continues on sheet 5 of 5

