

HERTSMERE BOROUGH COUNCIL

ROAD TRAFFIC REGULATION ACT 1984

Date of Order: 19th August 2020
Order No. 329

THE HERTSMERE BOROUGH COUNCIL (VARIOUS ROADS, BUSHEY) (RESTRICTION OF WAITING) ORDER 2020

Hertsmere Borough Council (hereinafter referred to as "the Council") pursuant to arrangements made with Hertfordshire County Council ("the County Council") under Section 19 of the Local Government Act 2000 and the Local Government (Arrangements for Discharge of Functions) (England) Regulations 2000, in exercise of the powers on the said County Council by Sections 1, 2 and 3 of the Road Traffic Regulation Act 1984 (hereinafter referred to as "the Act of 1984") and Part IV of Schedule 9 of the Act of 1984 and of all other enabling powers and after consultation with the Chief Officer of Police in accordance with Part III of Schedule 9 to the Act of 1984, hereby make the following Order:

1. This Order may be cited as "The Hertsmere Borough Council (Various Roads, Bushey) (Restriction of Waiting) Order 2020" and shall come into operation on 7th September 2020.
2. Save as provided in Articles 3, 4 and 5 of this Order no person shall cause or permit any vehicle to wait at any time in those lengths of Roads as specified in the Schedule to this Order.
3. (1) Nothing in Article 2 of this Order applies to the lengths of road restricted by that Article (which said lengths of road are referred to in this Article as "the restricted area") in relation to:
 - (a) A vehicle being used for Fire and Rescue, Ambulance or Police purposes.
 - (b) Anything done with the permission of or at the direction of a Police Constable in uniform; or with the permission of a Civil Enforcement Officer appointed by Hertsmere Borough Council and as defined by the Traffic Management Act 2004.
 - (c) A vehicle which is prevented from proceeding by circumstances beyond the drivers control or which has stopped in order to avoid injury or damage to persons or property or when required to do so by law;
 - (d) A vehicle which is stationary in order that it may be used for one or more of the purposes specified in sub-Article (2) of this Article and which cannot reasonably be used for such a purpose without stopping in the restricted area;
 - (e) A marked vehicle which, whilst used by a universal service provider in the course of the provision of a universal postal service, is stationary only for so long as may reasonably be necessary for postal packets to be delivered or collected;

In this Article;

The expression "universal service provider", "provision of a universal postal service" and "postal packet" shall bear the same meanings as in Section 65 of the Postal Services Act 2011.

(2) The "purposes" referred to in sub-Article (1)(d) of this Article are:

- (a) Any operation involving building, demolition or excavation;
- (b) The removal of any obstruction to traffic;
- (c) The maintenance, improvement or reconstruction of a road;
- (d) Constructing, improving, maintaining or cleaning of any street furniture; or
- (e) The laying, erection, alteration, repair or cleaning of any sewer or of any main pipe or apparatus for the supply of gas, water or electricity, or of any telecommunications apparatus kept or installed for the purposes of a telecommunications code system or of any other telecommunications apparatus lawfully kept installed in any position.

4. Nothing in Article 2 of this Order applies to the lengths of road restricted by that Article (which said lengths of road are referred in this Article as "the restricted area") so as to render it unlawful to cause or permit any vehicle to wait only for so long as may reasonably be necessary -

(a) to enable goods to be loaded on or unloaded from the vehicle from or to premises adjacent to the restricted area; or

(b) to enable a passenger to board or alight and to load and unload any luggage.

5. (1) Nothing in Article 2 of this Order shall render it unlawful to cause or permit a disabled person's vehicle which displays in the relevant position a disabled person's badge, and a parking disc, to wait at any time in the lengths of road specified in the Schedule of this Order for a period not exceeding 3 hours (not being a period separated by an interval of less than 1 hour from a previous period of waiting by the same vehicle in the same length of road).

(2) In this Article –

"disabled person's vehicle" has the same meaning as in Section 142(1) of the Act of 1984;

"disabled person" means a disabled person of a description prescribed by Regulation 4 of the Disabled Persons (Badges for Motor Vehicles) (England) Regulations 2000;

"disabled persons badge", has the same meaning as given in Regulation 3(1) of The Local Authorities' Traffic Orders (Exemption for the Disabled Persons) (England) Regulations 2000;

"parking disc" has the same meaning as given in Regulation 8(5) of The Local Authorities' Traffic Orders (Exemptions for Disabled Persons) (England) Regulations 2000;

"Relevant position" has the same meaning as given in Regulation 4 of The Local Authorities' Traffic Orders (Exemptions for Disabled Persons) (England) Regulations 2000.

6. The Interpretation Act 1978 shall apply for the interpretation of this Order as it applies for the interpretation of an Act of Parliament:
7. Where a motor vehicle is parked in contravention of any of the Articles to this Order the driver of any such vehicle shall be issued with a penalty charge notice.

In this Article:-

"Penalty Charge Notice" has the same meaning as in The Civil Enforcement of Parking Contraventions (England) General Regulations 2007.

"Penalty Charge" shall have the meaning as a charge set by the Council in accordance with The Civil Enforcement of Parking Contraventions(Guidelines on Levels and Charges)(England) Order 2007 and the provisions of part 6 and Schedule 9 of the Traffic Management Act 2004

"driver" means the person driving or having control or charge of the vehicle at any given time and in particular in relation to the vehicle.

8. The restrictions imposed by this Order shall be in addition to and not in derogation from any restriction or requirement imposed by any regulations made or having effect as if made under the Act of 1984 or by any other enactment.
9. The provisions of the following Order are hereby revoked but only in so far as they are affected by the restrictions imposed by this Order;

The Borough of Hertsmere (Control of Parking) (Consolidation) Order 2012

SCHEDULE 1**NO WAITING AT ANYTIME**

Location	Side of Road	Description
Arden Close	Both	From its junction with Montacute Road northeastwards for a distance of 10 metres
Montacute Road	South	From a point in line with the southeastern kerb line of Montacute Road northwards for a distance of 16.5 metres
Caldecote Gardens	Both	From its junction with Elstree Road northwestwards for a distance of 10 metres
Elstree Road	Southeast	From a point in line with the common property boundary of numbers 67 and 69 Elstree Road northeastwards for a distance of 46 metres
Clay Lane	North	From its junction with Elstree Road southeastwards for distance of 10 metres
Elstree Road	South	From a point 25 metres from its junction with Sparrows Herne northeastwards for a distance of 91 metres
Elstree Road	North	From a point in line with the northern flank of No 2 Richfield Road eastwards for a distance of 114 metres
Howard Close	Both	From its junction with Clay Lane eastwards for a distance of 10 metres
Clay Lane	East	From a point in line with the northern flank wall of Pinelands southeastwards for a distance of 18 metres
Tower View	Both	From its junction with Montacute Road westwards for a distance of 10 metres
Montacute Road	West	From a point in line with the southern flank wall of No 1 Tower View northwards for a distance 20 metres
Montacute Road	West	From a point in line with the northern flank wall of No 4 Woodstock Road westwards for a distance of 14 metres
Woodstock Road	Both	From its junction with Montacute Road westwards for a distance of 8.2 metres
Woodstock Road	Southeast	From a point 4 metre in line with the eastern flank wall of number 6 Woodstock Road southwestwards for a distance of 20 metres
Woodstock Road	North	From its junction with Montacute Road eastwards for a distance of 11 metres

IN WITNESS where of the Common Seal of the Hertsmere Borough Council was hereunto affixed
This 19th ~~2020~~ day of August 2020.

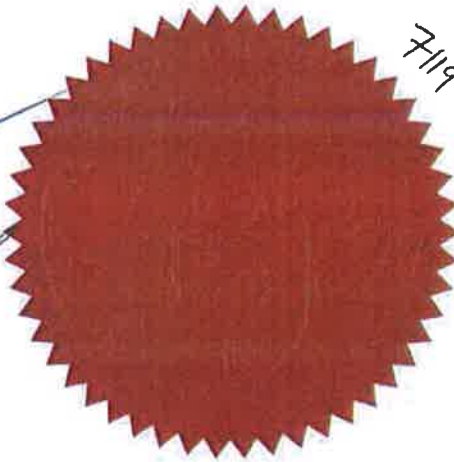
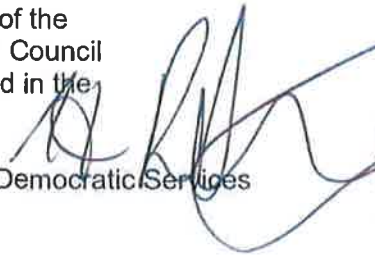

The Common Seal of the
Hertsmere Borough Council
was hereunto affixed in the
presence of :-

Head of Legal and Democratic Services

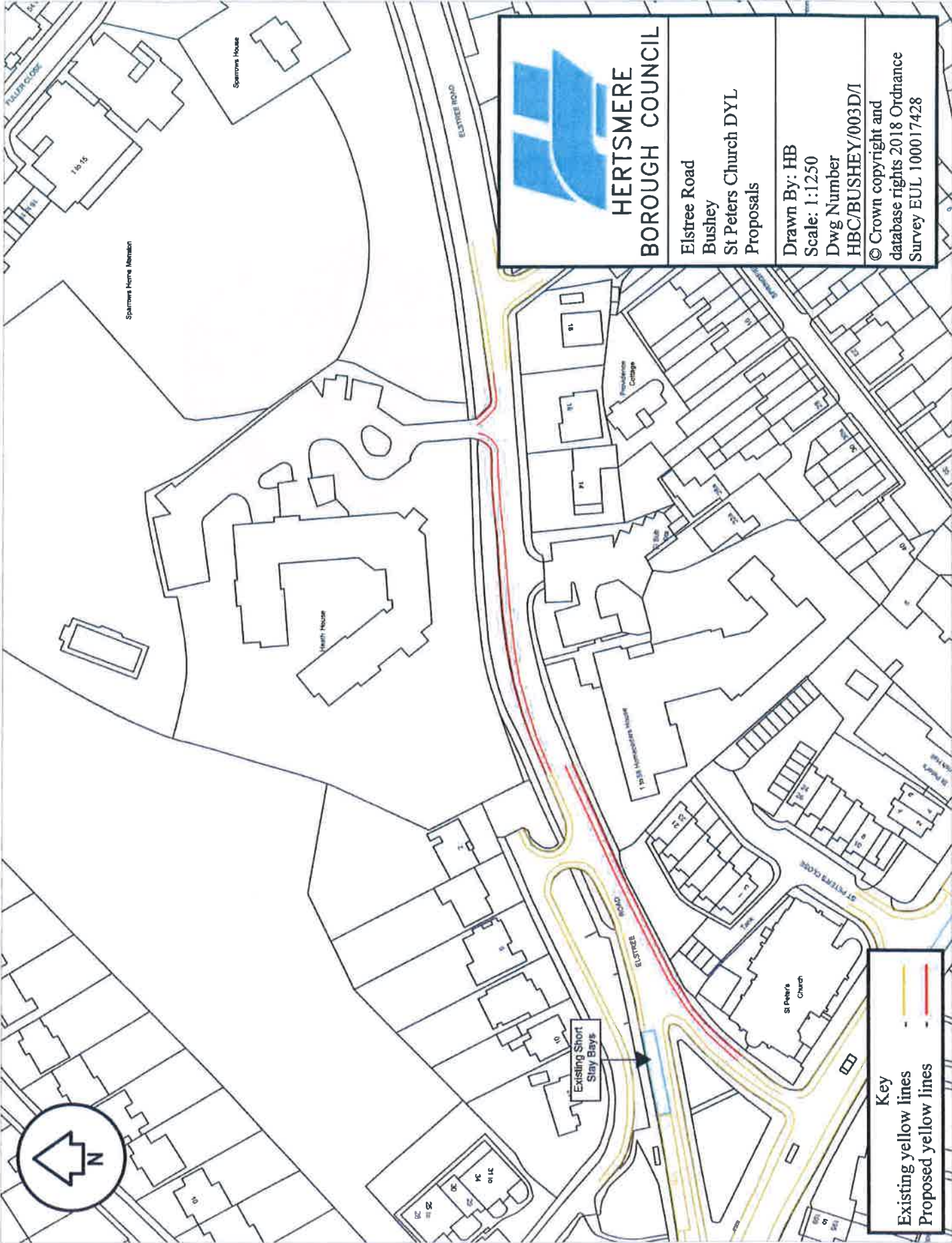



	HERTSMERE BOROUGH COUNCIL	
	Elstree Road Bushey St Peter's Church DYL Proposals	
Drawn By: HB Scale: 1:1250 Dwg Number HBC/BUSHEY/003D/1		© Crown copyright and database rights 2018 Ordnance Survey EUL 100017428

Key	
	Existing yellow lines
	Proposed yellow lines

Existing Short Stay Bays



Spartans Home Extension

Spartans House

Health House

Presidence Cottage

17338 Homeopathic Alliance

St Peter's Church

ST PETER'S CLOSE

ELSTREE ROAD

ELSTREE ROAD

TRULIER CLOSE

15-16

15-16

15-16

15-16

15-16

15-16

15-16

15-16

15-16

15-16

15-16

15-16

15-16

15-16

15-16

15-16

15-16

15-16

15-16

15-16

15-16

15-16

15-16

15-16

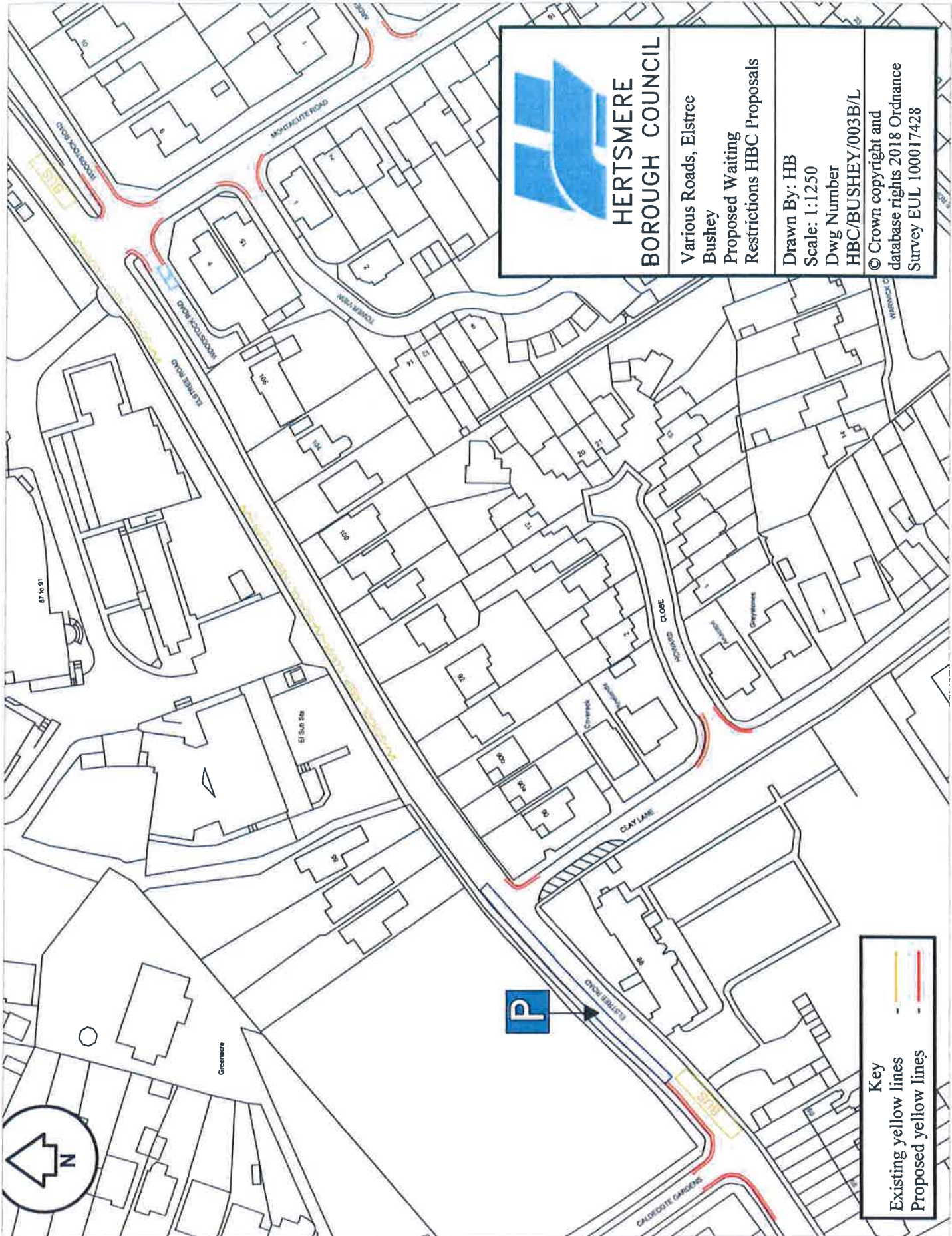

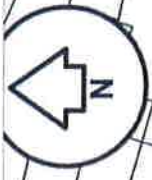

	HERTSMERE BOROUGH COUNCIL	
	Various Roads, Elstree Bushey Proposed Waiting Restrictions HBC Proposals	
Drawn By: HB Scale: 1:1250 Dwg Number HBC/BUSHEY/003B/L		© Crown copyright and database rights 2018 Ordnance Survey EUL 100017428

Key	
	Existing yellow lines
	Proposed yellow lines

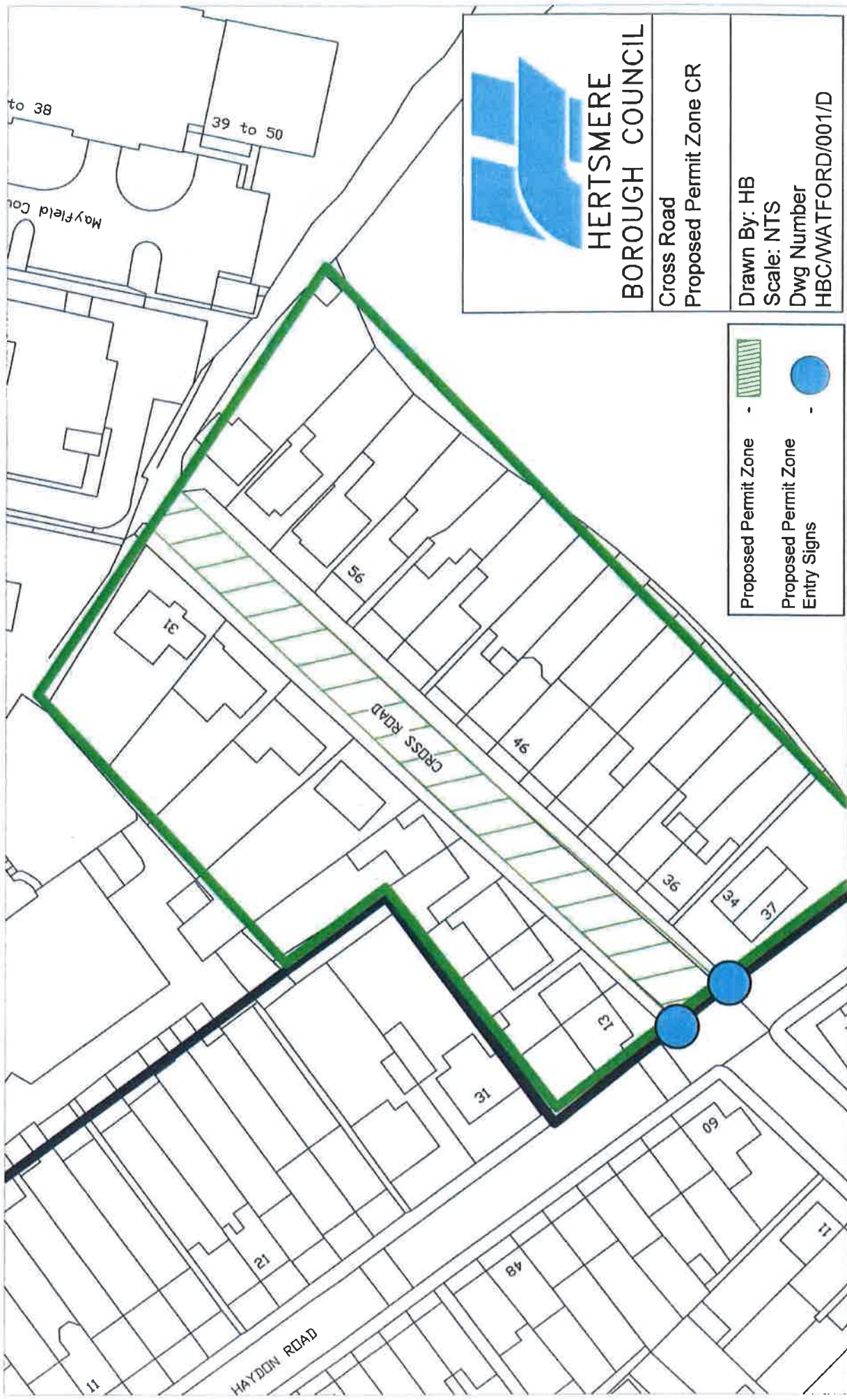



 HERTSMERE BOROUGH COUNCIL	Cross Road	Drawn By: HB
	Proposed Permit Zone CR	Scale: NTS
		Dwg Number
		HBC/WATFORD/001/D

Proposed Permit Zone	
Proposed Permit Zone Entry Signs	