

ROAD TRAFFIC REGULATION ACT 1984

THE COUNTY OF HEREFORD AND WORCESTER

(C1185 BREDWARDINE BRIDGE, BREDWARDINE)

(PROHIBITION OF WAITING) ORDER 1990

Hereford and Worcester County Council in exercise of their powers under Sections 1(1) and (2), 2(1) to (3) and 4(2) of the Road Traffic Regulation Act 1984 (which said Act is hereinafter referred to as "the Act of 1984") and of all other powers them enabling in that behalf, and after consultation with the Chief Officer of Police in accordance with Part III of Schedule 9 to the said Act of 1984, hereby make the following Order:-

1. Save as provided in Articles 2 and 3 of this Order no person shall, except upon the direction or with the permission of a police officer in uniform or of a traffic warden, cause or permit any vehicle to wait at any time on those lengths of road in the Parish of Bredwardine in the District of South Herefordshire in the County of Hereford and Worcester specified in the Schedule to this Order.
2. Nothing in Article 1 of this Order shall render it unlawful to cause or permit any vehicle to wait in the lengths of road referred to in the Article for so long as may be necessary to enable:-
 - (a) a person to board or alight from the vehicle;
 - (b) goods to be loaded onto and/or unloaded from the vehicle;
 - (c) the vehicle, if it cannot conveniently be used for such purpose in any other road, to be used in connection with any building operation or demolition, the removal of any obstruction to traffic, the maintenance, improvement or reconstruction of the lengths of road referred to, or the laying, erection, alteration or repair in or near the said lengths of road of any sewer or of any main, pipe or apparatus for the supply of gas, water or electricity, or of any telecommunications apparatus as defined in the Telecommunications Act 1984;
 - (d) the vehicle, if it cannot conveniently be used for such purpose in any other road, to be used in pursuance of statutory powers or duties;
 - (e) the vehicle to be used for the purpose of delivering or collecting postal packets as defined in Section 87 of the Post Office Act 1953;
 - (f) the vehicle to be used for the purpose of removing furniture and effects from one office or dwellinghouse to another, or to such premises from a depository or from such premises to a depository, provided notice is given twenty-four hours in advance to the police, their consent is obtained and such reasonable conditions as they may impose are complied with;

- (g) the vehicle to be used for fire brigade, police or ambulance purposes.
3. Nothing in Article 1 shall render it unlawful to cause or permit a disabled person's vehicle which displays in the relevant position a disabled person's badge, and a parking disc (on which the driver, or other person in charge of the vehicle, has marked the time at which the period of waiting began) to wait in the lengths of road referred to in that Article for a period not exceeding two hours (not being a period separated by an interval of less than one hour from a previous period of waiting by the same vehicle in the same lengths of road on the same day).
4. (1) In this Order:-
- "disabled person's badge" has the same meaning as in The Disabled Persons (Badges for Motor Vehicles) Regulations 1975;
- "disabled person's vehicle" has the same meaning as in The Local Authorities' Traffic Orders (Exemptions for Disabled Persons) (England and Wales) Regulations 1986;
- "parking disc" means a disc, issued by a local authority, complying with the requirements of the British Standard Specification for Parking Discs (BS No. 4631:1970), but coloured orange, and capable of showing the quarter hour period during which a period of waiting begins.
- (2) For the purpose of this Order a vehicle shall be regarded as displaying:-
- (a) a disabled person's badge in the relevant position, when -
- (i) in the case of a vehicle fitted with a front windscreen, the badge is exhibited thereon with the obverse side facing forwards on the near side of and immediately behind the windscreen; and
- (ii) in the case of a vehicle not fitted with a front windscreen, the badge is exhibited in a conspicuous position on the front or near side of the vehicle;
- (b) a parking disc in the relevant position, when the disc is exhibited thereon with the side which shows the time facing forwards or outwards and immediately behind the windscreen or side window nearest to the kerb.
5. The restrictions, prohibitions and requirements imposed by this Order are in addition to and not in derogation of any restriction, prohibition or requirement imposed by any other enactment and any exception or exemption to the provisions of this Order is without prejudice to the provisions of any other enactment.
6. This Order shall come into operation on the 12th day of November 1990 and may be cited as The County of Hereford and Worcester (C1185 Bredwardine Bridge, Bredwardine) (Prohibition of Waiting) Order 1990.

Dated this 1st day of November 1990.

The Common Seal of the Hereford and)
Worcester County Council was affixed)
hereto in the presence of:)

L.S.

(Signed) R. B. Barber

Deputy

County Secretary and Solicitor

RU:11:143

SCHEDULE

Lengths of road in the Parish of Bredwardine in the District of South Herefordshire in the County of Hereford and Worcester.

- | | | |
|--|-----|--|
| C1185 Bredwardine Bridge (both sides) | (a) | from a point 38 metres (125 feet) west of its junction with UC90000 for a distance of 40 metres (131 feet) in a westerly direction. |
| | (b) | from a point 153 metres (502 feet) west of its junction with UC90000 for a distance of 38 metres (125 feet) in a westerly direction. |

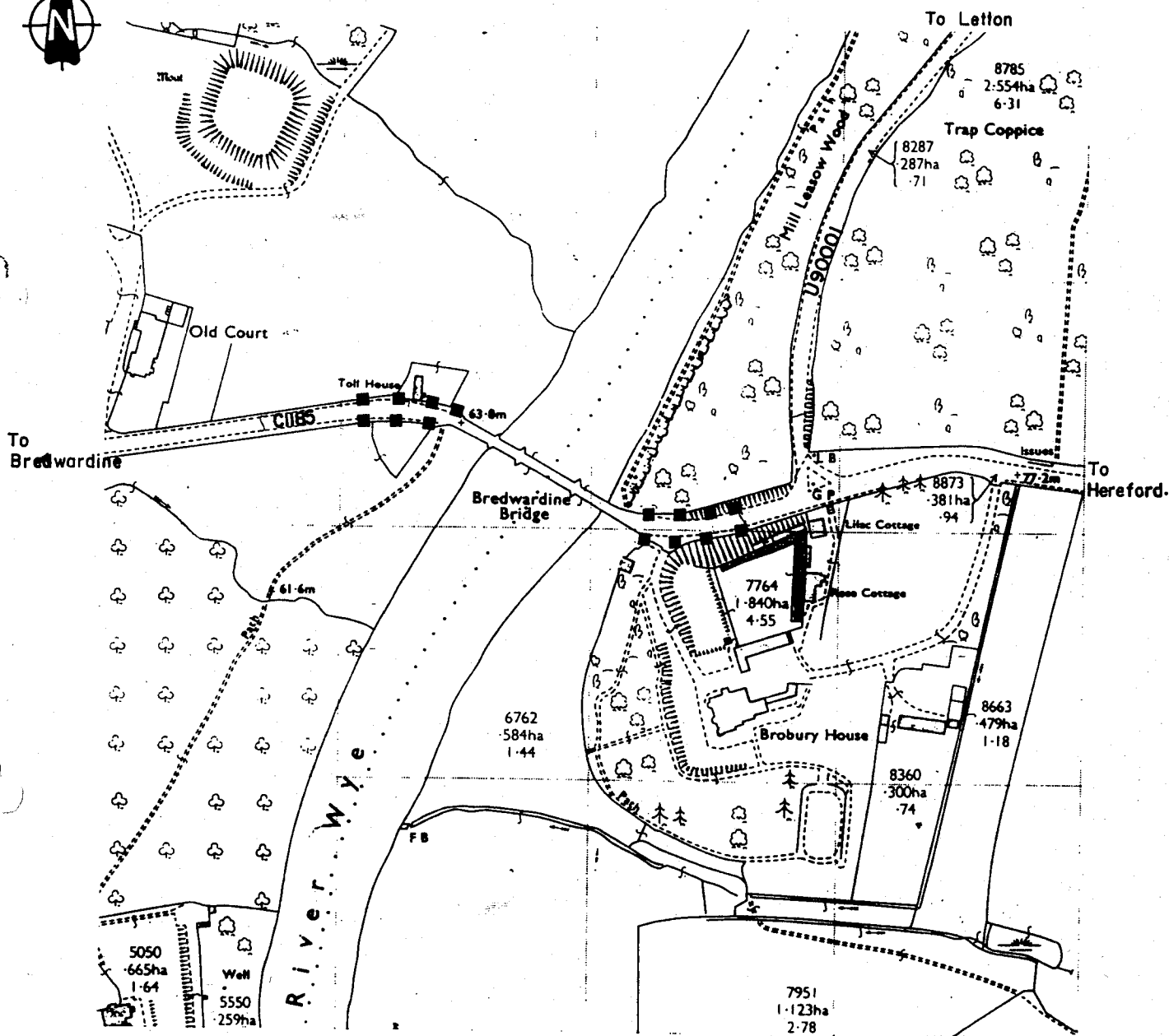

Requested Waiting Restriction ■ ■ ■



COUNTY COUNCIL OF
HEREFORD AND WORCESTER

C1185 Bredwardine Bridge.
Requested Waiting Restriction

SURVEYED DATE

DRAWN DATE

CHECKED DATE

SCALE

1:2500

DRG. No.

HD/T/C1185/416/1/A4

V.E. JONES M.Sc., Dip.T.P.,
F.I.C.E., F.I.H.T.
COUNTY SURVEYOR
& BRIDGEMASTER,
COUNTY HALL,
WORCESTER ROAD,
WORCESTER WR5 2NP.

PUBLIC NOTICE

BREDWA90/001

ROAD TRAFFIC REGULATION ACT 1984
THE COUNTY OF HEREFORD AND WORCESTER
(C1185 BREDWARDINE BRIDGE, BREDWARDINE)
(PROHIBITION OF WAITING) ORDER 1990

NOTICE is hereby given that on 1st November 1990 Hereford and Worcester County Council made an Order under Sections 1(1) and (2), 2(1) to (3) and 4(2) of the Road Traffic Regulation Act 1984, and of all other enabling powers the effect of which will be to prohibit waiting at any time on those lengths of road in the Parish of Bredwardine in the District of South Herefordshire in the County of Hereford and Worcester specified in the Schedule to this Notice.

The Order will come into operation on 12th November 1990.

A copy of the Order as made and a copy of the relevant map can be inspected at County Hall, Spetchley Road, Worcester, during normal office hours.

Any person who desires to question the validity of the Order or of any provision contained in the Order on the ground that it is not within the powers of the relevant Section of the Act or on the ground that any requirement of that Section or of Parts I, II or III of Schedule 9 to the Act of 1984 or of any regulations made under the said Part III of Schedule 9 have not been complied with in relation to the Order, may within 6 weeks of the date on which the Order were made (such date stated in this Notice) make application for the purpose to the High Court.

J.W. RENNEY

County Secretary and Solicitor

County Hall,
Spetchley Road,
Worcester.

8th November 1990

TN3:4:44

SCHEDULE

Lengths of road in the Parish of Bredwardine in the District of South Herefordshire in the County of Hereford and Worcester.

| | | |
|--|-----|--|
| C1185 Bredwardine Bridge (both sides) | (a) | from a point 38 metres (125 feet) west of its junction with UC90000 for a distance of 40 metres (131 feet) in a westerly direction. |
| | (b) | from a point 153 metres (502 feet) west of its junction with UC90000 for a distance of 38 metres (125 feet) in a westerly direction. |