

ROAD TRAFFIC REGULATION ACT 1984

ROAD TRAFFIC ACT 1991

TRAFFIC MANAGEMENT ACT 2004

HASTINGS BOROUGH COUNCIL (OFF-STREET  
PARKING PLACES) ORDER 2015

Reference: 2/HIGH/PP/00024

**HASTINGS BOROUGH COUNCIL** ("the Council") in the exercise of its powers, namely:

the Road Traffic Regulation Act 1984 ("the 1984 Act"), sections 32, 33, 35 and 39, as amended;

the Road Traffic Act 1991 ("the 1991 Act") as amended;

Part 6 of the Traffic Management Act 2004;

the Road Traffic (Permitted Parking Area and Special Parking Area) (County of East Sussex) (Borough of Hastings) Order 1999 (S.I. 1999 No. 1112);

and all other powers enabling the Council in that behalf;

with the consent of East Sussex County Council in accordance with section 39(3) of the 1984 Act;

after consultation with the Chief Officer of Police in accordance with Part III of Schedule 9 of the 1984 Act; and

in accordance with the Local Authorities' Traffic Orders (Procedure) (England and Wales) Regulations 1996 (S.I. 1996 No 2489);

**MAKES THIS CONSOLIDATION ORDER** in respect of all its parking places and amends the existing Order relating to such Parking Places as follows, namely:

## **PART 1: GENERAL**

1. (1) This Order may be cited as the Hastings Borough Council (Off-Street Parking Places) Order 2015.

(2) This Order shall come into operation on the 29<sup>th</sup> day of August 2015

- (3) The Hastings Borough Council (Off Street Parking Places) Consolidation Order 2008 and  
The Hastings Borough Council (Off-Street Parking Places) Consolidation Order 2008 (Amendment) Order 2009 No. 1  
are hereby revoked.

2. Interpretation

### **(1) In this order:**

"Reference to any statute or statutory provision includes a reference to that statute or statutory provision as from time to time amended, extended, re-enacted or consolidated or modified whether substantial or not and whether

before or after the date of this Order and all statutory instruments or orders made pursuant to it"

"Civil Enforcement Officer" has the same meaning as defined in Section 76 of the Traffic Management Act 2004"

"Coach" means a motor vehicle which is not a motor car and which is constructed or adapted to carry more than eight seated passengers (excluding the Driver)

"Council" means the Hastings Borough Council.

"Credit Card" means a card or similar thing issued by any person, use of which enables the holder to defer payment by him of the charge for parking a vehicle

"Debit Card" means a card or similar thing issued by any person, use of which by the holder causes the charge for parking a vehicle to be paid by the electronic transfer of funds from any current account of his at a bank or other institution providing banking services

"Disabled Person's Badge" has the same meaning as in regulation 3 of the Local Authorities' Traffic Orders (Exemptions for Disabled Persons) (England) Regulations 2000 (S.I. 2000 No. 683).

"Driver" in relation to a vehicle waiting in a Parking Place means the person driving the vehicle at the time it was left in the Parking Place.

"Electric Charing Point" means an electric charging point for the use by electric vehicles for charging of the vehicle

"Higher Level Contravention" has the same meaning as defined in the Civil Enforcement of Parking Contraventions (Guidelines on Levels of Charges) (England) Order 2007

"Higher Level Penalty Charge" has the same meaning as defined in the Civil Enforcement of Parking Contraventions (Guidelines on Levels of Charges) (England) Order 2007

"Invalid Carriage" has the same meaning as in section 136 of the 1984 Act.

"Lorry" means a motor vehicle which is not a motor car and which is constructed or adapted for use for the carriage or haulage of goods or burden of any description.

"Motorcar" has the same meaning as in section 136 of the 1984 Act.

"Motorcycle" has the same meaning as in section 136 of the 1984 Act.

"Operational hours" are hours of opening of a Parking Place which may be specified by site notice boards at the relevant Parking Place.

"Owner", in relation to a vehicle, has the same meaning as defined in Section 92 of the Traffic Management Act 2004

"Parking Charge" means the charge paid by the Driver of a vehicle, by which he is authorised under this Order to leave the vehicle in a Parking Place.

"Parking Place" means any of the parking places specified by name in column 1 of Schedule 1 to this Order.

"Parking Ticket" means a ticket issued by a Pay and Display Ticket Machine pursuant to this Order;

"Pay and Display" in relation to a parking place means a Parking Place where the Driver makes payment to a Ticket Machine whereby a ticket is issued which must be exhibited on the vehicle;

"Penalty Charge" means a Penalty Charge imposed under Part 6 of the Traffic Management Act 2004

"Penalty Charge Notice" means a notice issued or served by a Civil Enforcement Officer pursuant to the provisions of Part 6 of the Traffic Management Act 2004

"Registered Keeper" in relation to a vehicle waiting in a Parking Place means the person named in the Register kept by or on behalf of the Secretary of State under the Vehicle Excise and Registration Act 1994 and the Road Vehicles (Registration and Licensing) Regulations 2002 (SI 2002 No. 2742) as the keeper of the vehicle at the time it was left in the Parking Place.

"Relevant Position" in the case of a Parking Ticket or Season Ticket means:

- a) the Parking Ticket(s) shall be clearly and continuously displayed on the dashboard or front windscreen of the vehicle, or in the case of a motor cycle in a prominent position on the vehicle, so that the all the details shown on the front of the said ticket are clearly visible.
- (b) the Season Ticket shall be clearly and continuously displayed at all times in the front windscreen of the vehicle so that the all the details shown on the front of the said Season Ticket are clearly visible.

"Season Ticket" means a ticket issued for annual, quarterly, monthly and weekly periods allowing unlimited parking during those said periods at charges detailed in the Schedule to this Order which may be used at the Parking Place and all other unreserved parking places provided by the Council (except levels 7 –12 of the Priory Street Multi Storey Car Park and barrier-operated Parking Places and the Bourne Residents Car Park, the High Street Residents Car Park, Grand Parade Car Park, and the pay & display section of the Cornwallis Street Car Park).

"Ticket Machine" means an apparatus of a type and design approved by the Secretary of State for Transport, designed to indicate the time by a clock and to issue Parking Tickets to show that a payment has been made of an amount or for a period specified thereon and to specify the date and either the time of such payment or the time at which the vehicle must leave the Parking Place.

(2) The Interpretation Act 1978 shall apply for the interpretation of this Order as it applies for the interpretation of an Act of Parliament.

(3) Each of the Parking Places are shown for the purpose of identification only and edged with red on plans annexed to this Order. The plans are drawn to the scale as stated in each case. The reference of the relevant plan is given in Schedule 1, column 2.

## PART II: USE OF PARKING PLACES

1. The Parking Places specified in column 1 of Schedule 1 to this Order may be used subject to the following provisions of this Order as Parking Places for such vehicles or classes of vehicles as are specified in column 3 of that Schedule.
2. The Driver of a vehicle shall not permit the vehicle to wait in a Parking Place unless:-
  - (a) it is of the class specified in Schedule 1, and
  - (b) in a parking space clearly marked on the surface thereof.
3. The Driver of a vehicle shall not permit the vehicle to wait in a Parking Place for more than 24 hours, without the express consent of the Council.
4. No person may drive or cause or permit to be driven any vehicle in the Parking Place at a speed in excess of 10 miles per hour;
5. No person may enter a Parking Place for any purpose whatsoever other than a person authorised by the Council, the Driver of or a passenger in a vehicle parked or intended to be parked in the Parking Place, or a person authorised by such a Driver or passenger
6. Where signs are erected or surface markings are laid at or near to a Parking Place for the purpose of indicating the entrance to or exit from the Parking Place or indicating that a vehicle using the Parking Place shall proceed in a specified direction within the Parking Place, no person may drive or cause or permit to be driven any vehicle -
  - (i) so that it enters the Parking Place otherwise than by the entrance or leaves the Parking Place otherwise than by the exit so indicated; or
  - (ii) in a direction other than that specified.
7. No person may drive or permit to be driven any vehicle in a Parking Place for any purpose other than the purpose of leaving the vehicle in or for departing from the Parking Place in accordance with the provisions of this Order, except with the express consent of the Council.
8. the Driver of a vehicle in the Parking Place shall comply with any instructions given by a duly authorised person or by signs or markings as to the direction in which the vehicle shall be driven;
9. In relation to Falaise Road Car Park, Falaise Hall Car Park, Crystal Square Car Park, Summerfields Car Park and the pay & display section of the Cornwallis Street Car Park, the Driver of a vehicle shall not permit the vehicle to wait in the

Parking Place for more than 4 hours and shall not return to the Parking Place within the following 2 hour period without the express consent of the Council.

10. The Driver of a motor vehicle using a Parking Place shall stop the engine as soon as the vehicle is in position in the Parking Place, and shall not start the engine except when for the purpose of changing the position of the vehicle or departing from the Parking Place.
11. The Driver of a vehicle using a Parking Place may not sound a horn or similar instrument except when the engine is running.
12. While a vehicle is in a Parking Place, no person may carry out or permit the carrying out of any work of construction or repair to that vehicle except such repair as may be necessary to enable the vehicle to be moved from the Parking Place.
13. No person may wash, clean or service any vehicle or any part thereof while the vehicle is in a Parking Place.
14. No person may use a vehicle while it is in a Parking Place, in connection with the sale of any goods or services to persons at or near the Parking Place without the express consent of the Council.
15. No person may in any vehicle while the vehicle is in a Parking Place:
  - (a) wash any part of his person;
  - (b) sleep between the hours of 10.00 p.m. and 8.00 a.m.;
  - (c) light any fire, stove or cooker; or
  - (d) expose any washing to dry.
16. No person may use a Parking Place as a means of passage by vehicle from one road to another road.
17. No person may, at or near to a Parking Place, without the written consent of the Council (which may be given on such terms and conditions as the Council think fit):
  - (i) sell or offer for sale any goods or services;
  - (ii) make any collection of money or articles for charitable or other purposes;
  - (iii) advertise or publish by any means any event display entertainment sale business shop organisation collection or other thing;
18. The Driver of a vehicle shall not permit the vehicle to wait in a Parking Place unless:
  - (i) the vehicle is licensed in accordance with the provisions of section 1 of the Vehicle Excise and Registration Act 1994; and
  - (ii) unless there is in relation to the use of the vehicle by the Driver such a policy of insurance which complies with the requirements of Part VI of the Road Traffic Act 1988.

Any unlicensed vehicle found in a Parking Place can be subject to having the vehicle removed by the Council. Removal fees and storage charges will be levied on the registered keeper of the vehicle.

19. No person may:
- (a) shout or otherwise make a noise which causes or is likely to cause a nuisance or annoyance to users of the Parking Place or residents of premises in the neighbourhood;
  - (b) use threatening, abusive or insulting language, gesture or conduct which causes or is likely to cause a nuisance or annoyance to users of the Parking Place or residents of premises in the neighbourhood;
  - (c) leave or cause any shopping or supermarket trolley to be left unattended in any Parking Place other than in a designated trolley park, except with the express consent of the Council; or
  - (d) erect or cause to be erected any tent booth stand building or other structure in a Parking Place without the written consent of the Council
  - (e) play any game within a Parking Place;
  - (f) ride a pedal cycle within a Parking Place, except with the express consent of the Council;
20. No Driver of a vehicle shall permit the vehicle to park or wait in a parking space marked as being for the use of a reserved space Season Ticket holder unless he is a holder of a Season Ticket.
- 21.1 No Driver shall park in a parking space marked for the use of electric charging vehicles only and not being that class of vehicle nor shall a Driver leave a vehicle in the designated space without using the Electric Charging Point to charge the vehicle during restricted hours.
- 21.2 The maximum stay for parking spaces marked for the use of electric charging vehicles only, between the hours of 8 am and 6 pm, is 5 hours. Vehicles are required to be connected to the charge point and charging whilst in the parking bay.
22. Any person who wilfully or carelessly damages or interferes with the fabric or structure of the Parking Place or equipment therein shall be guilty of an offence under this Order, and in addition to the penalty provided by Section 35A of the 1984 Act shall be liable for the cost of repair of the damage;
23. No vehicle carrying inflammable or dangerous substances, including substances which might cause damage by fire or explosion or might endanger human life in any other way (with the exception of fuel in the fuel tank of the vehicle) shall be parked in the Parking Place;
24. Where a notice is displayed at the entrance to the Priory Street Multi Storey Car Park indicating that the Parking Place is fully occupied, no Driver may drive or attempt to drive his vehicle into the Parking Place, unless the Driver holds a valid annual Season Ticket for the exclusive use of a space in the Parking Place;
25. No person shall gain access to or egress from an upper level of Priory Street Multi Storey Car Park by any means other than by the stairways or lifts provided for that purpose;
26. Nothing in this Order shall prevent the Council by notice, sign or barrier displayed in the Parking Place:

- (a) from suspending the requirement that a Parking Charge be payable for the parking a vehicle in the Parking Place;
- (b) from specifying an alternative method of payment of the Parking Charge;
- (c) from suspending the Parking Place or any part thereof for any purpose for any period; or
- (d) from setting aside the Parking Place or any part or parts thereof on certain days or during certain parts of days for specified vehicles or class of vehicles.

Any such notice, sign or barrier shall be displayed prominently on or near to the Parking Place.

No person shall cause or permit a vehicle to be left in a Parking Place or any part thereof during such periods as the use of that Parking Place or the part thereof is suspended or set aside in accordance with paragraphs (c) and (d) of this Article.

### **PART III: PROVISION FOR DISABLED BADGE HOLDERS**

1. A vehicle, which displays a Disabled Person's Badge and special parking disc (clock) set at time of arrival, which is left in a bay which is designated for use as a disabled person's parking space, shall be exempt for the first three hours of any day from payment of any charge imposed by the provisions of this Order. This exemption does not apply in any other area of the Parking Place.
2. The Driver of a vehicle shall not permit it to wait in any of the bays marked as being available for use by 'disabled badge holders only' unless it is a vehicle which is clearly and continuously displaying a valid Disabled Person's Badge, positioned either on the dashboard or in the front windscreen of the vehicle, so that the serial number and expiry date of the badge can be clearly read from outside the vehicle. Additionally, a special parking disc (clock) must also be displayed next to the badge, set at time of arrival (3 hours free parking).

### **PART IV: PARKING CHARGES**

1. The charges for parking vehicles in a Parking Place shall continue to be and shall remain in full force and effect in all respects as set out in Schedule 2 or as amended by Notice or Order and as indicated on the tariff boards in each relevant Parking Place.
2. The Driver of a vehicle which is left in a Parking Place during Operational Hours shall pay a Parking Charge. The Parking Charge must be paid by the methods and manner specified within this Order.

#### *Season tickets*

3. The Council may issue a Season Ticket to an applicant for a vehicle. Season Tickets may be issued on criteria determined from time to time by the Council



4. If a paper Season Ticket is provided this must be clearly and continuously displayed in the Relevant Position during the entire period the vehicle is waiting in the Parking Place.
5. When payment is made by mobile telephone, the Parking Place will be identified by the Location Identification Number (LIN) displayed on the information signs and the parking period paid for will only be valid for that specific Parking Place and vehicle.

The LIN, Parking Charge paid and parking period will be available for the Civil Enforcement Officer's view on their hand-held device (which is programmed to interface with the telephone payment system) when the vehicle registration mark is entered.

6. A Season Ticket shall only be valid in respect of the vehicle for which it was issued and in such Parking Place as specified and shall be subject to any other conditions upon which it was issued.

#### *Pre-paid Parking*

7. The Parking Charge shall be paid:

- (a) where facilities allow, by the insertion of coins into a Ticket Machine; or
- (b) where facilities allow, by a Credit Card or Debit Card at a Ticket Machine; or
- (c) where facilities allow, by a mobile telephone payment

The Driver, of a vehicle to be parked in a Parking Place, shall on entering the car park pay the Parking Charge of the appropriate sum for the period for which he intends to park his vehicle, except where the Council decide on the occasion of any conference, carnival, public entertainment or other special occasion that a Parking Place may be closed and that no charge is payable.

8. When payment of a Parking Charge is made by using a Ticket Machine, a Parking Ticket(s) will be issued by the machine identifying the amount paid and the expiry time of the parking period. The Parking Ticket(s) is non-transferable between Parking Places or vehicles and must be displayed clearly and continuously in the Relevant Position
9. When payment is made by mobile telephone, the Parking Place will be identified by the Location Identification Number (LIN) displayed on the information signs and the parking period paid for will only be valid for that specific Parking Place and vehicle.
10. The LIN, Parking Charge paid and parking period will be available for the Civil Enforcement Officer's view on their hand-held device (which is programmed to interface with the telephone payment system) when the vehicle registration mark is entered.
11. If, when a vehicle is parked in a Parking Place, payment of the Parking Charge is not possible using the Drivers preferred method, it should be paid using any

alternative method available. Where there is a problem with a Ticket Machine the driver should check if there is another Ticket Machine in that Parking Place that could be used.

12. Only if all of the facilities for paying the Parking Charge at a Parking Place are unavailable or not working, will the Driver of that vehicle be exempt from paying the Parking Charge' for the remainder of that days charging period.
13. If a vehicle is left in a Parking Place in contravention of or without complying with any Article of this Order a Penalty Charge shall be payable and/or the vehicle may be removed from that location or Parking Place for any one of the following parking contraventions;
  - (i) parked in an electric vehicles' charging place during restricted hours without charging;
  - (ii) parked without payment of the Parking Charge;
  - (iii) parked for longer than permitted;
  - (iv) parked in a restricted area in a car park;
  - (v) parked after the expiry of paid for time;
  - (vi) parked without clearly displaying a valid pay & display ticket or car park permit;
  - (vii) parked without clearly displaying a valid permit where required;
  - (viii) not parked correctly within the marking of a bay or space;
  - (ix) parked in a designated disabled person's parking space, without displaying a valid disabled person's badge in the prescribed manner;
  - (x) parked in a parking place or area not designated for that class of vehicle;
  - (xi) parked causing an obstruction;
  - (xii) parked in a parking place for a purpose other than that designated
  - (xiii) using a vehicle in a parking place in connection with the sale or offering or exposing for sale of goods when prohibited
  - (xiv) vehicle parked exceeds maximum weight or height or length permitted
  - (xv) parked in a designated disabled person's parking space, without clearly displaying a special parking disc (clock) or not setting the clock at the time of arrival;
  - (x) parked in an area not designated for that class of vehicle;
  - (xi) parked in a designated space for electric charging vehicles only during restricted hours without charging

#### Penalty Charge Notice

#### 14. Service

In the case of a vehicle in respect of which a Penalty Charge may have been incurred, a Penalty Charge Notice may be served by a Civil Enforcement Officer

15. In the case of a vehicle in respect of which the Penalty Charge may have been incurred, it shall be the duty of the Civil Enforcement Officer to serve the Penalty Charge Notice:
  - (a) by attaching it to the vehicle in a conspicuous position; or

- (b) giving it to the person appearing to him to be in charge of the vehicle
16. A Penalty Charge Notice which has been served shall include the contents as laid down by the Schedule to Regulation 8 of The Civil Enforcement of Parking Contraventions (England) General Regulations 2007 together with those laid down by regulation 3 to The Civil Enforcement of Parking Contraventions (England) Representations and Appeals Regulations 2007
  17. The amount of the Penalty Charge for a Higher Level Contravention shall be £70.00 and for all other contraventions the Penalty Charge shall be £50.00.
  18. A Penalty Charge Notice fixed to a vehicle in accordance with any of the foregoing provisions of this Order, shall not be removed or interfered with except by or under the authority of either the Owner or person in charge of the vehicle or a civil enforcement office of the Council
  19. Manner of payment of Penalty Charge  
  
The Penalty Charge shall be paid to the Council at and by approved methods of payment in accordance with the instructions on the Penalty Charge Notice.  
  
Payment must reach the Council not later than the 28<sup>th</sup> day following the day on which the Penalty Charge Notice was issued  
  
The Penalty Charge will be discounted by 50% if payment is received by any of the methods aforesaid within 14 days of the date of service of the Penalty Charge
  20. The period for which a vehicle may be left in a Parking Place during the charging hours after the Penalty Charge has been incurred shall not exceed two hours
  21. "Higher Level Contraventions" are defined by the Civil Enforcement of Parking Contraventions (Guidelines on Levels of Charges) (England) Order 2007 as those falling within one or more of the descriptions of contravention listed in column (2) of Table 1 below, being descriptions based on Version 6.5 of the Standard PCN Codes used by local authorities engaged in parking enforcement and have the code number shown in column (1) of that table.

Table 1

(1) Code	(2) Description
70	Parked in a loading place during restricted hours without reasonable excuse
71	Parked in an electric vehicles' charging place during restricted hours without charging
74	Using a vehicle in a Parking Place in connection with the sale or offering or exposing for sale of goods when prohibited
81	Parked in a restricted area in a car park
85	Parked in a permit bay without clearly displaying a valid permit where required
87	Parked in a disabled person's parking space without clearly

	displaying a valid disabled person's badge
89	Vehicle parked exceeds maximum weight and/or height and/or length permitted in the area
91	Parked in a car park or area not designated for that class of vehicle
92	Parked causing an obstruction

22. Lower Level Contraventions are those listed below in Table 2

Table 2

(1) Code	(2) Description
73	Parked without payment of the Parking Charge
80	Parked for longer than permitted
82	Parked after the expiry of paid for time
83	Parked in a car park without clearly displaying a valid pay and display ticket or voucher or parking clock, if required
84	Parked with payment made to extend the stay beyond initial time
86	Not parked correctly within the markings of a bay or space
90	Re-parked in the same car park within two hours after leaving
93	Parked in a car park when closed
94	Parked in a pay & display car park without clearly displaying two valid pay and display tickets when required
95	Parked in a parking space for a purpose other than that designated
96	Parked with engine running where prohibited

23. Neither the payment of a parking fee nor the acceptance thereof shall guarantee that a parking space will be available at any particular time or at all.

24. Parking fees are in no circumstances refundable.

25. (1) If at any time while a vehicle is left in a Parking Place and either;

- a) has no Parking Ticket(s) exhibited on that vehicle in accordance with the provisions of Article 8; and / or
- b) the Civil Enforcement Officer's hand held device does not show that payment has been made in accordance with the provisions of Article 9 of this Order

it shall be presumed unless the contrary is proved that the charge has not been paid.

(2) If at any time while a vehicle is left in the Parking Place there is displayed on the vehicle one ticket issued by the Ticket Machine indicating that a charge has been paid for a particular period and the time indicated on the Ticket Machine clock shows that that period has expired it shall be presumed unless the contrary is proved that the charge specified for that period has been duly paid and that the period has expired.

- (3) If at any time while a vehicle is left in the Parking Place there are displayed on the vehicle two or more consecutive tickets issued by the Ticket Machine and indicating that a charge has been paid for a particular period and the time indicated on the Ticket Machine clock shows that that period has expired it shall be presumed unless the contrary is proved that the charge specified for that period has been duly paid and that the period has expired.
- (4) If at any time while a vehicle is left in the Parking Place there is displayed a ticket indicating the day and time, and the time indicated by the Ticket Machine clock is more than twenty-four hours later than the time indicated on the ticket those indications shall unless the contrary is proved:-
- (a) in any proceedings for a Penalty Charge under the 2004 Act, for non-compliance or contravention of this Order be evidence that the vehicle was left in the Parking Place for longer than twenty-four hours;
  - (b) in any proceedings for a Penalty Charge under the 2004 Act, of failing duly to pay the Penalty Charge, be evidence that the charge was incurred.

#### **PART IV**

##### **REMOVAL OF VEHICLES FROM A PARKING PLACE**

1. When a vehicle is left in a Parking Place in contravention of any of the foregoing provisions of this Order a person authorised in that behalf by the Council may move the vehicle or arrange for it to be removed from that Parking Place.
2. Any person moving or removing a vehicle pursuant to this Order may do so by towing or driving the vehicle and/or using such means as he may reasonably consider necessary to facilitate the removal of the vehicle.
3. A person who removes a vehicle from a Parking Place pursuant to this Order shall make such arrangements as may be reasonably necessary for the safe custody of the vehicle.
4. In the case of emergency, any person duly authorised by the Council, or a police constable in uniform may move or cause to be moved vehicles left in the Parking Place to any place he thinks fit.
5. If it appears to the Council that a vehicle which has been or could at any time be removed pursuant to this Order, has been abandoned, the Council may sell or otherwise dispose of the vehicle in accordance with section 100 of the Road Traffic Regulation Act 1984.

# SCHEDULE 1

## THE PARKING PLACES

1	2	3
PARKING PLACE	PLAN REFERENCE	THE VEHICLES OR CLASSES OF VEHICLES AUTHORISED TO USE THE PARKING PLACE
ROCK A NORE CAR PARK	2463	Motorcars, Invalid Carriages, motorcycles.
THE BOURNE (PAY-AND- DISPLAY) CAR PARK	2445	Motorcars, Invalid Carriages, motorcycles.
PELHAM PLACE CAR PARK	2460	Motorcars, Invalid Carriages, motorcycles.
CASTLE HILL -OTHERWISE KNOWN AS – CASTLE HILL ROAD - CAR PARK	2447	Motorcars, Invalid Carriages, motorcycles.
CARLISLE PARADE UNDERGROUND CAR PARK	2446	Motorcars, Invalid Carriages, motorcycles.
CRYSTAL SQUARE CAR PARK on area of land at the junction of Cross Street and South Street	2449	Motorcars, Invalid Carriages, motorcycles.
MARINA CAR PARK	2459	Motorcars, Invalid Carriages, motorcycles.
ST MARGARET'S ROAD CAR PARK	2464	Motorcars, Invalid Carriages, motorcycles.
THE PIER UNDERGROUND CAR PARK (except portion posted and/or chained off).	2461	Motorcars, Invalid Carriages, motorcycles.
PRIORY STREET – MULTI- STOREY CAR PARK	2462	Motorcars, Invalid Carriages, motorcycles.
CORNWALLIS STREET CAR PARK	2448	Motorcars, Invalid Carriages, motorcycles.
SUMMERFIELD CAR PARK	2465	Motorcars, Invalid Carriages, motorcycles.
FALAISE HALL CAR PARK	2453	Motorcars, Invalid Carriages, motorcycles.
FALAISE ROAD CAR PARK	2454	Motorcars, Invalid Carriages, motorcycles.

<b>RESIDENTS' CAR PARKS</b>		
GRAND PARADE RESIDENTS' CAR PARK	2456	Motorcars, Invalid Carriages, motorcycles.
HIGH STREET RESIDENTS' CAR PARK	2457	Motorcars, Invalid Carriages, motorcycles.
THE BOURNE RESIDENTS' CAR PARK (additional to, and separate from, the above car park called THE BOURNE (PAY-AND-DISPLAY) CAR PARK)	2466	Motorcars, Invalid Carriages, motorcycles.

## SCHEDULE 2

### THE EXISTING CHARGES

#### 1. Castle Hill Road and Pelham Place:

Up to:	(1 <sup>st</sup> Nov – 31 <sup>st</sup> Mar)	(1 <sup>st</sup> Apr – 31 <sup>st</sup> Oct)
1 hour	£1.30	£1.50
2 hours	£2.60	£3.00
3 hours	£3.50	£4.10
5 hours	£5.80	£6.30
10 hours	£6.90	£7.40
24 hours	£7.40	£8.40
Overnight	£1.00	£1.00

Motorcycles - Parking for 24 hours – paying the charge for one hour tariff

#### 2. Rock-A-Nore:

Up to:	(1 <sup>st</sup> Nov – 31 <sup>st</sup> Mar)	(1 <sup>st</sup> Apr – 31 <sup>st</sup> Oct)
1 hour	£1.10	£1.50
2 hours	£2.10	£3.00
3 hours	£3.20	£4.20
5 hours	£3.20	£6.30
10 hours	£3.20	£7.40
24 hours	£3.20	£8.40
Overnight	£1.00	£1.00

Motorcycles - Parking for 24 hours – paying the charge for one hour tariff

#### 3. Priory Street multi-storey and Carlisle Parade:

Up to:	(1 <sup>st</sup> Nov – 31 <sup>st</sup> Mar)	(1 <sup>st</sup> Apr – 31 <sup>st</sup> Oct)
1 hour	£1.20	£1.20
2 hours	£1.90	£1.90
3 hours	£2.50	£2.50
5 hours	£3.70	£3.70
10 hours	£5.80	£6.50
24 hours	£7.40	£7.40
Overnight	£1.00	£1.00
Sundays (Priory St)	£1.10	£1.10

Motorcycles - Parking for 24 hours – paying the charge for one hour tariff

4. Cornwallis Street:

Up to:	(1 <sup>st</sup> Nov – 31 <sup>st</sup> Mar)	(1 <sup>st</sup> Apr – 31 <sup>st</sup> Oct)
1 hour	£1.20	£1.20
2 hours	£1.90	£1.90
3 hours	£2.50	£2.50
4 hours	£3.60	£3.60
Overnight	£1.00	£1.00

Motorcycles - Parking for 24 hours – paying the charge for one hour tariff

5. Falaise Road, Falaise Hall, and Summerfields:

Up to:	(1 <sup>st</sup> Nov – 31 <sup>st</sup> Mar)	(1 <sup>st</sup> Apr – 31 <sup>st</sup> Oct)
1 hour	£0.20	£0.20
2 hours	£0.40	£0.40
3 hours	£0.50	£0.50
4 hours	£0.80	£0.80

Motorcycles - Parking for 24 hours – paying the charge for one hour tariff

6. The Bourne:

Up to:	(1 <sup>st</sup> Nov – 31 <sup>st</sup> Mar)	(1 <sup>st</sup> Apr – 31 <sup>st</sup> Oct)
1 hour	£1.30	£1.40
2 hours	£2.60	£2.80
3 hours	£3.50	£4.00
5 hours	£5.80	£5.80
10 hours	£6.90	£7.40
24 hours	£7.40	£8.40

Motorcycles - Parking for 24 hours – paying the charge for one hour tariff

7. Marina:

Up to:	(1 <sup>st</sup> Nov – 31 <sup>st</sup> Mar)	(1 <sup>st</sup> Apr – 31 <sup>st</sup> Oct)
1 hour	£1.00	£1.10
2 hours	£1.50	£1.60
3 hours	£2.10	£2.40
5 hours	£3.20	£3.20
10 hours	£4.80	£4.80
24 hours	£5.80	£5.80
Overnight	No Charge	No Charge

Motorcycles - Parking for 24 hours – paying the charge for one hour tariff



8. St Margret's Road

Up to: (1<sup>st</sup> Nov – 31<sup>st</sup> Mar) (1<sup>st</sup> Apr – 31<sup>st</sup> Oct)

1 hour	60p	60p
2 hours	80p	80p
3 hours	£1.10	£1.10
5 hours	£1.60	£1.60
10 hours	£2.10	£2.10
24 hours	£2.40	£2.40
Overnight	Not Available	Not Available

Motorcycles - Parking for 24 hours – paying the charge for one hour tariff

9. The Pier Underground

Up to: (1<sup>st</sup> Nov – 31<sup>st</sup> Mar) (1<sup>st</sup> Apr – 31<sup>st</sup> Oct)

1 hour	60p	60p
2 hours	80p	80p
3 hours	£1.10	£1.10
5 hours	£1.60	£1.60
10 hours	£2.10	£2.10
24 hours	£2.40	£2.40
Overnight	£1.00	£1.00

Motorcycles - Parking for 24 hours – paying the charge for one hour tariff

10. Crystal Square

Up to: (1<sup>st</sup> Nov – 31<sup>st</sup> Mar) (1<sup>st</sup> Apr – 31<sup>st</sup> Oct)

1 hour	60p	60p
2 hours	£1.10	£1.10
3 hours	£1.60	£1.60
4 hours	£2.10	£2.10

Motorcycles - Parking for 24 hours – paying the charge for one hour tariff

11. Season Tickets:

Annual	£675
Quarterly	£195
Monthly	£70
Weekly	£25
Motorcycles	25% car rate

Priory Street multi-storey – solely for parking in either the Reserved Spaces or the Restricted Zone

Annual (Reserved Space)	£870
Annual (Restricted Zone)	£440
Quarterly	£135
Monthly	£45
Motorcycles	25% of car rate

High Street, The Bourne, and Grand Parade Residents Only Car Parks:

Annual	£350
Quarterly	£110

Carlisle Parade Underground Car Park Motorcycle Bay	£52.00
Grand Parade Motorcycle Permit	50% of car permit rate

The COMMON SEAL of )  
HASTINGS BOROUGH COUNCIL )  
was affixed to this Order )  
the 25<sup>th</sup> day of August )  
Two Thousand and Fifteen )  
in the presence of:

*K. Carver*

AUTHORISED SIGNATORY







## The Bourne Car Park

Date: Feb 2015

Scale: 1:500

Drawing No. 2445

Use of this data is subject to terms and conditions. You are granted a non-exclusive, royalty free, revocable licence solely to view the Licensed Data for non-commercial purposes for the period during which Hastings Borough Council makes it available. You are not permitted to copy, sub-license, distribute, sell or otherwise make available the Licensed Data to third parties in any form. Third party rights to enforce the terms of this licence shall be reserved to Ordnance Survey.





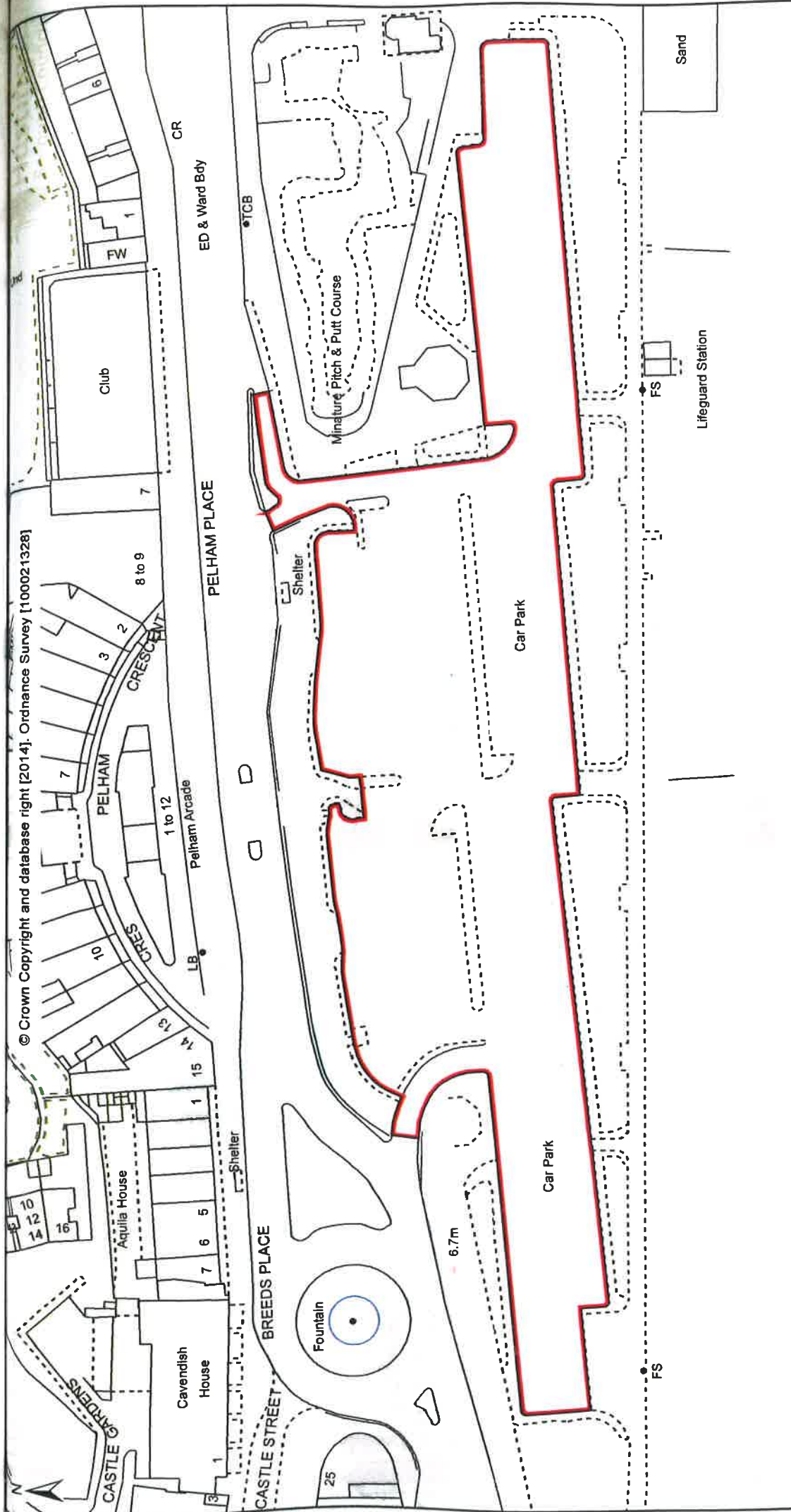

## Pelham Place Car Park

Date: May 2014

Scale: 1:1,000

Drawing No. 2460

Terms and Conditions of Use of Ordnance Survey Material i) You are granted a non-exclusive, royalty free, revocable licence solely to view the Licensed Data for non-commercial purposes for the period during which Hastings Borough Council makes it available; ii) You are not permitted to copy, sub-licence, distribute, sell or otherwise make available any Data to third parties in any form; and iii) Third party rights to enforce the terms of this licence shall be reserved to Ordnance Survey.

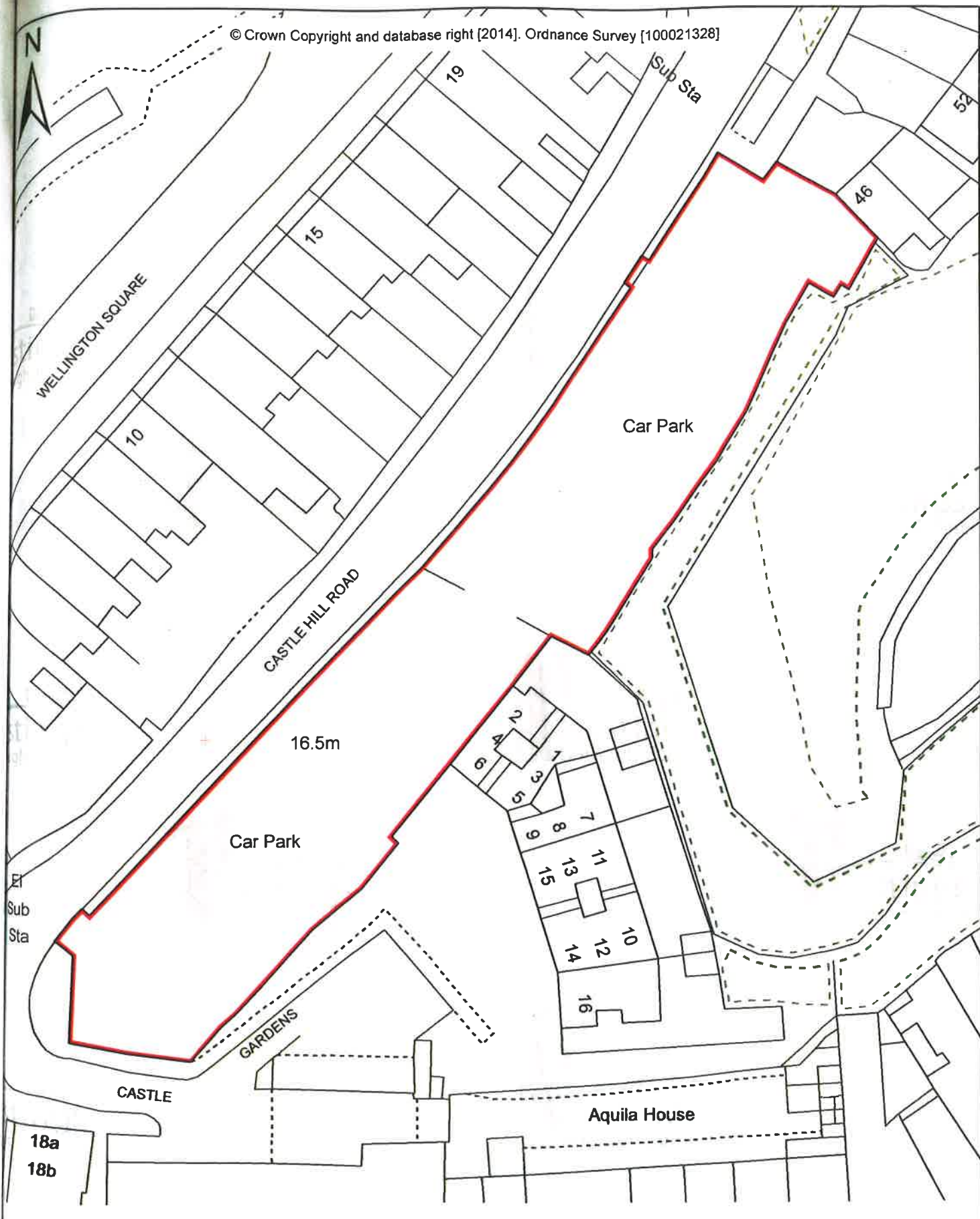

© Crown Copyright and database right [2014]. Ordnance Survey [100021328]

### Castle Hill Road Car Park

Date: April 2014  
 Scale: 1:500  
 Drawing No. 2447

Terms and Conditions of Use of Ordnance Survey Material i) You are granted a non-exclusive, royalty free, revocable licence solely to view the Licensed Data for non-commercial purposes for the period during which Hastings Borough Council makes it available; ii) You are not permitted to copy, sub-license, distribute, sell or otherwise make available any Data to third parties in any form; and iii) Third party rights to enforce the terms of this licence shall be reserved to Ordnance Survey.





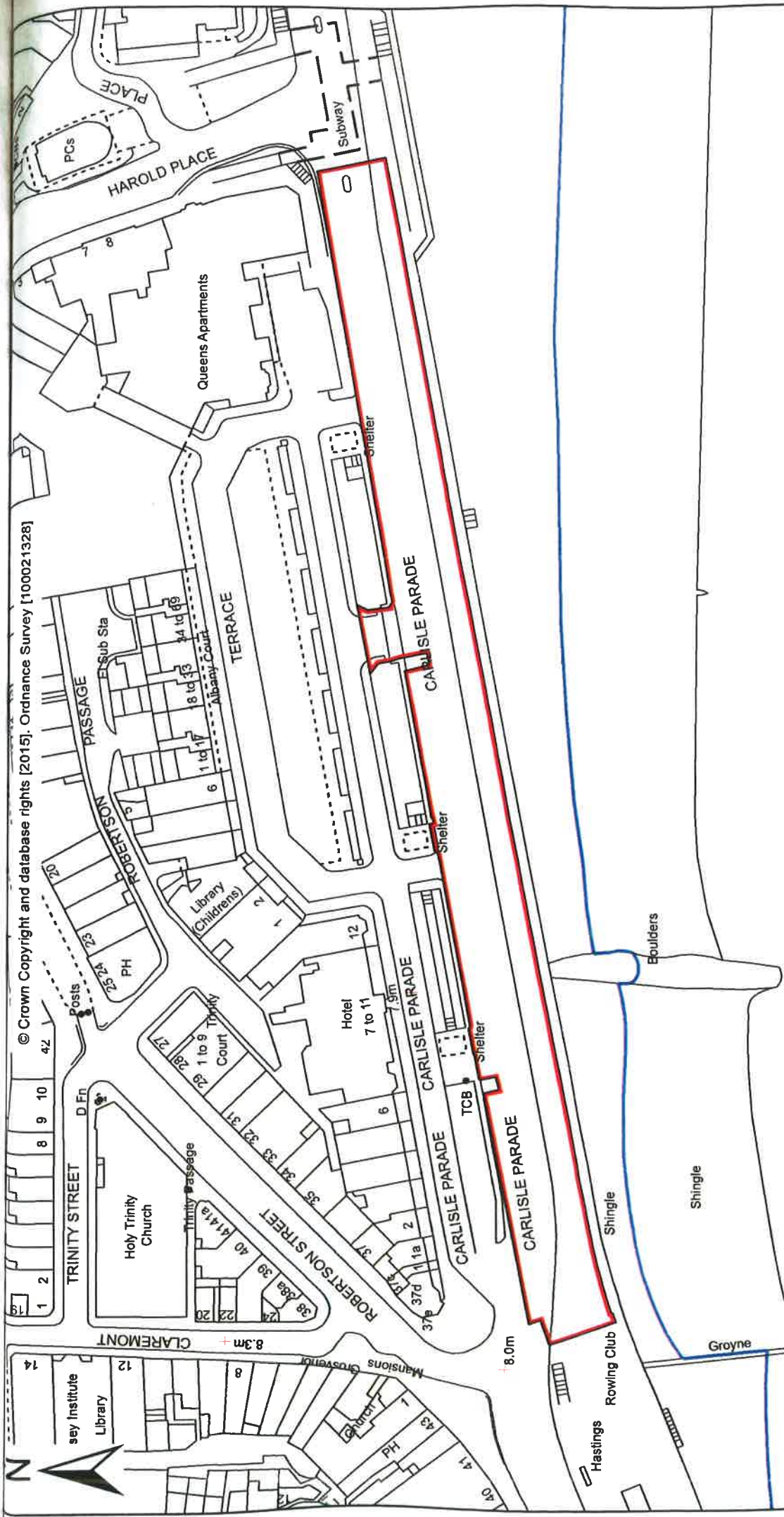

© Crown Copyright and database rights [2015]. Ordnance Survey [100021328]

# Carlisle Parade Underground Car Park

<p><b>Date:</b> Mar 2015</p>	<p>Use of this data is subject to terms and conditions. You are granted a non-exclusive, royalty free, revocable licence solely to view the Licensed Data for non-commercial purposes for the period during which Hastings Borough Council makes it available. You are not permitted to copy, sub-licence, distribute, sell or otherwise make available the Licensed Data to third parties in any form. Third party rights to enforce the terms of this licence shall be reserved to Ordnance Survey.</p>	
<p><b>Scale:</b> 1:1,250</p>		
<p><b>Drawing No.</b> 2446</p>		

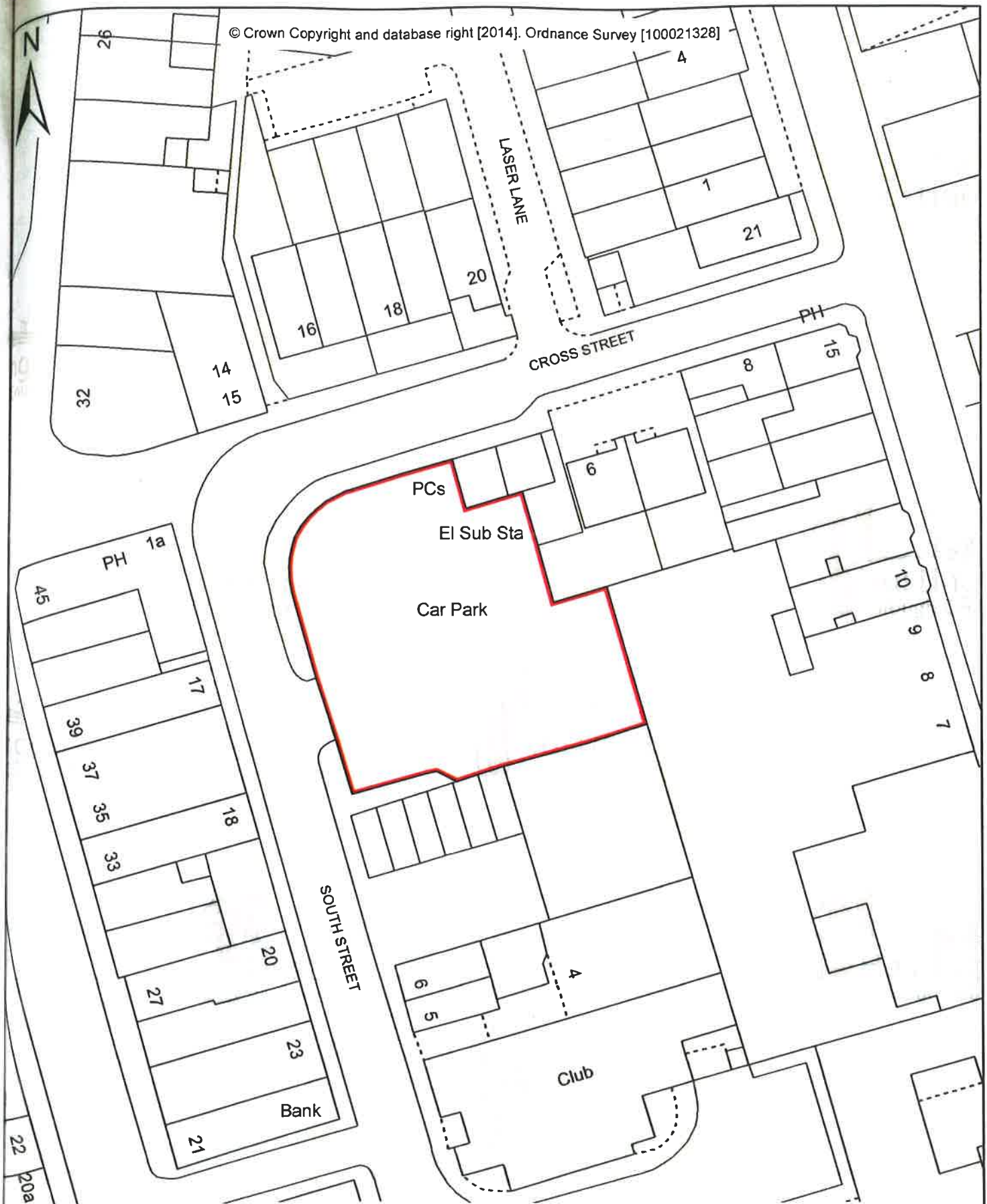

## Crystal Square Car Park

Date: April 2014

Scale: 1:500

Drawing No. 2449

Terms and Conditions of Use of Ordnance Survey Material i) You are granted a non-exclusive, royalty free, revocable licence solely to view the Licensed Data for non-commercial purposes for the period during which Hastings Borough Council makes it available; ii) You are not permitted to copy, sub-license, distribute, sell or otherwise make available any Data to third parties in any form; and iii) Third party rights to enforce the terms of this licence shall be reserved to Ordnance Survey.





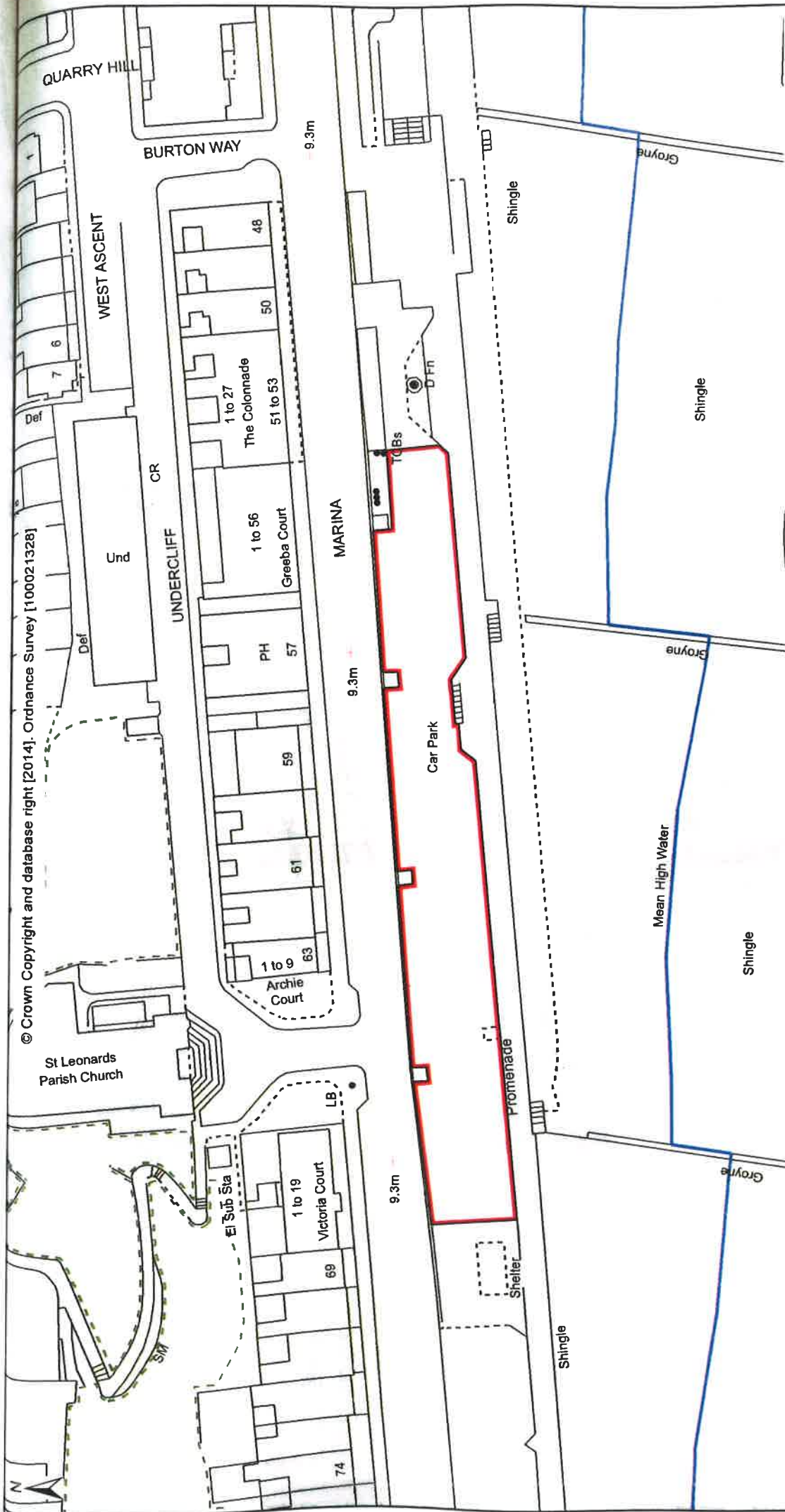

## Marina Car Park

Date: May 2014

Scale: 1:1,000

Drawing No. 2459

Terms and Conditions of Use of Ordnance Survey Material i) You are granted a non-exclusive, royalty free, revocable licence solely to view the Licensed Data for non-commercial purposes for the period during which Hastings Borough Council makes it available; ii) You are not permitted to copy, sub-license, distribute, sell or otherwise make available any Data to third parties in any form; and iii) Third party rights to enforce the terms of this licence shall be reserved to Ordnance Survey.

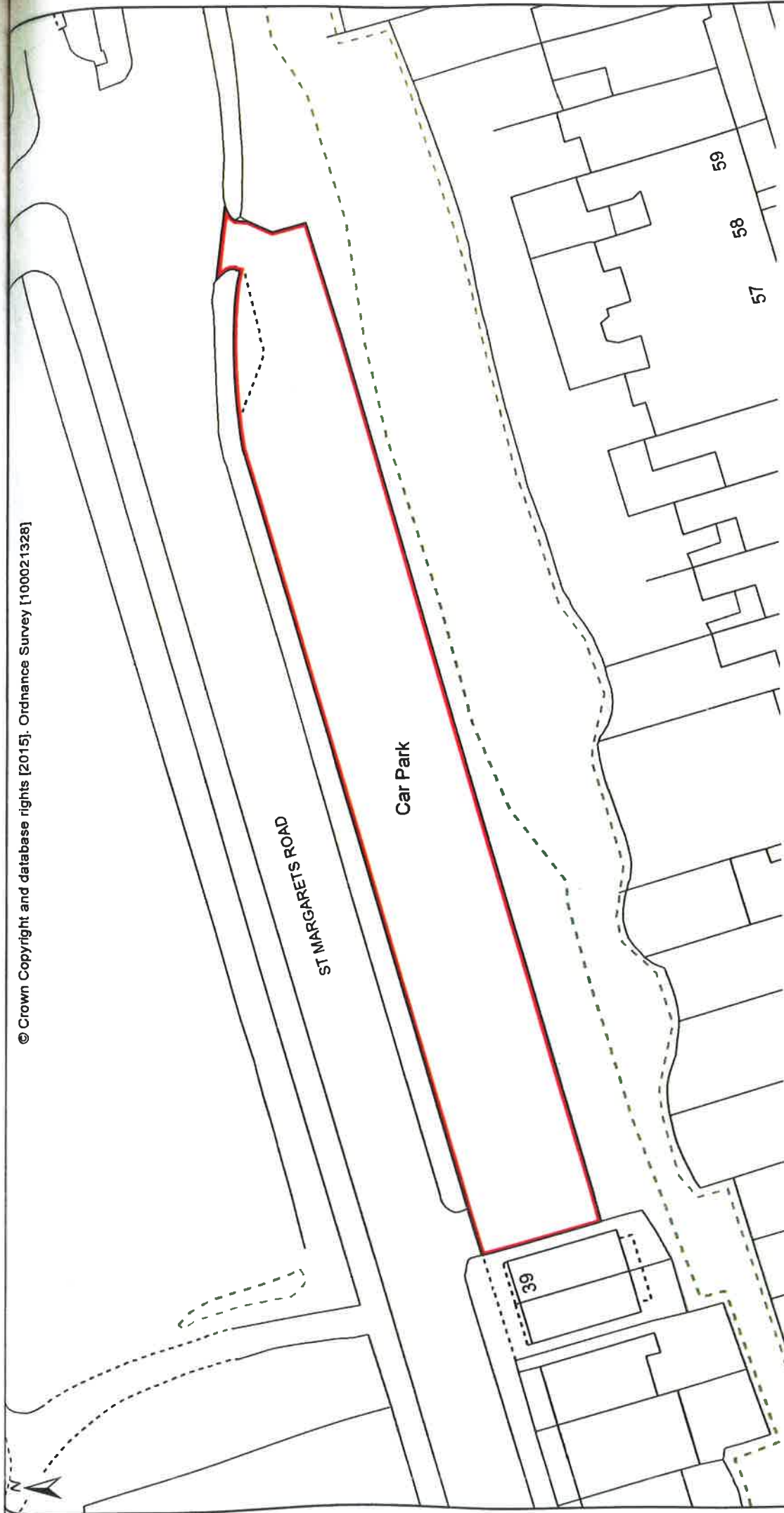

## St Margarets Road Car Park

Date: Feb 2015

Scale: 1:500

Drawing No. 2464

Use of this data is subject to terms and conditions. You are granted a non-exclusive, royalty free, revocable licence solely to view the Licensed Data for non-commercial purposes for the period during which Hastings Borough Council makes it available. You are not permitted to copy, sub-license, distribute, sell or otherwise make available the Licensed Data to third parties in any form. Third party rights to enforce the terms of this licence shall be reserved to Ordnance Survey.



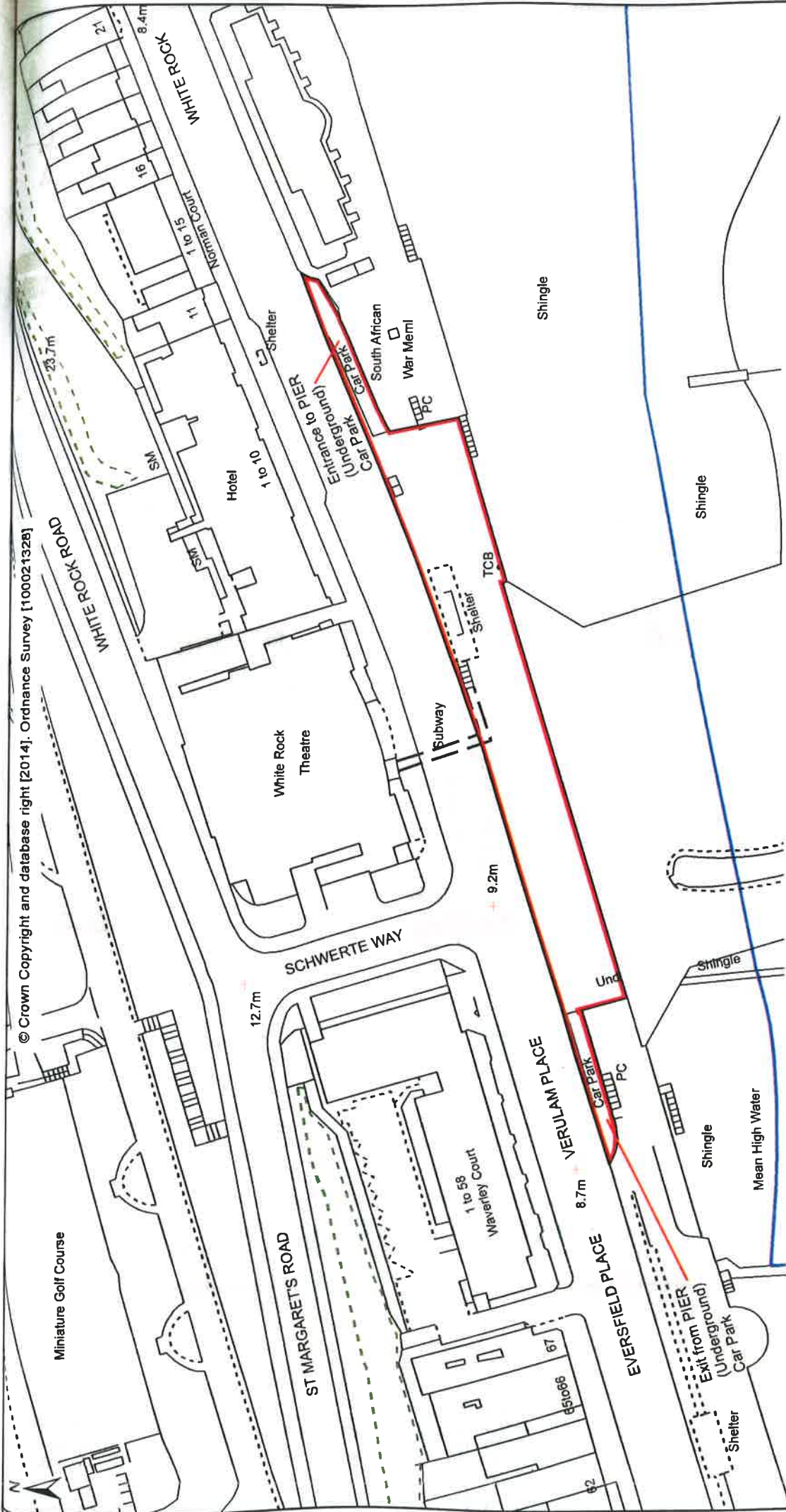

© Crown Copyright and database right [2014]. Ordnance Survey [100021328]

## Pier Underground Car Park

Date: May 2014  
Scale: 1:1,000  
Drawing No. 2461

Terms and Conditions of Use of Ordnance Survey Material i) You are granted a non-exclusive, royalty free, revocable licence solely to view the Licensed Data for non-commercial purposes for the period during which Hastings Borough Council makes it available; ii) You are not permitted to copy, sub-license, distribute, sell or otherwise make available any Data to third parties in any form; and iii) Third party rights to enforce the terms of this licence shall be reserved to Ordnance Survey.



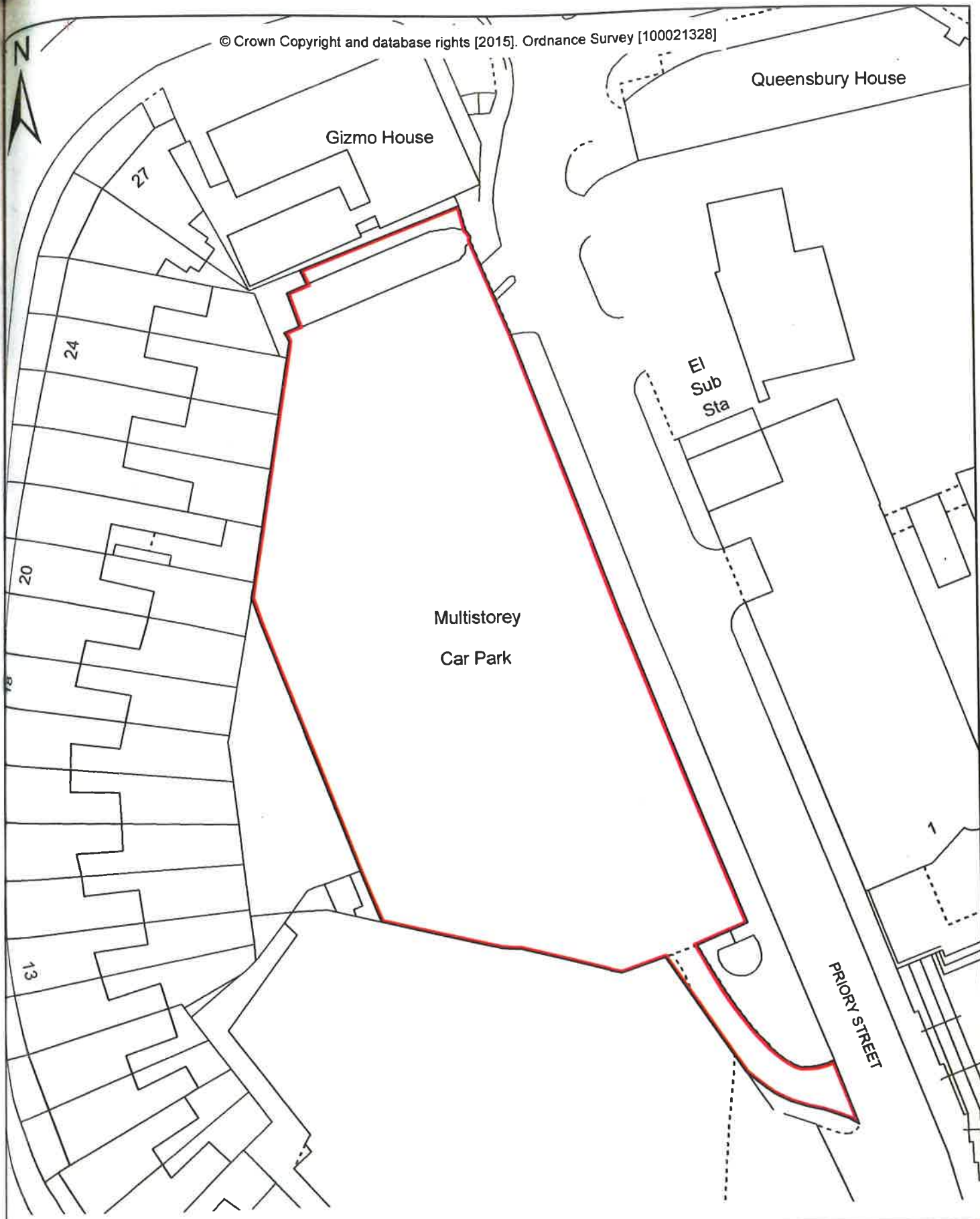

### Priory Street Multi-Storey Car Park

Date: Mar 2015  
Scale: 1:500  
Drawing No. 2462

Use of this data is subject to terms and conditions. You are granted a non-exclusive, royalty free, revocable licence solely to view the Licensed Data for non-commercial purposes for the period during which Hastings Borough Council makes it available. You are not permitted to copy, sub-license, distribute, sell or otherwise make available the Licensed Data to third parties in any form. Third party rights to enforce the terms of this licence shall be reserved to Ordnance Survey.





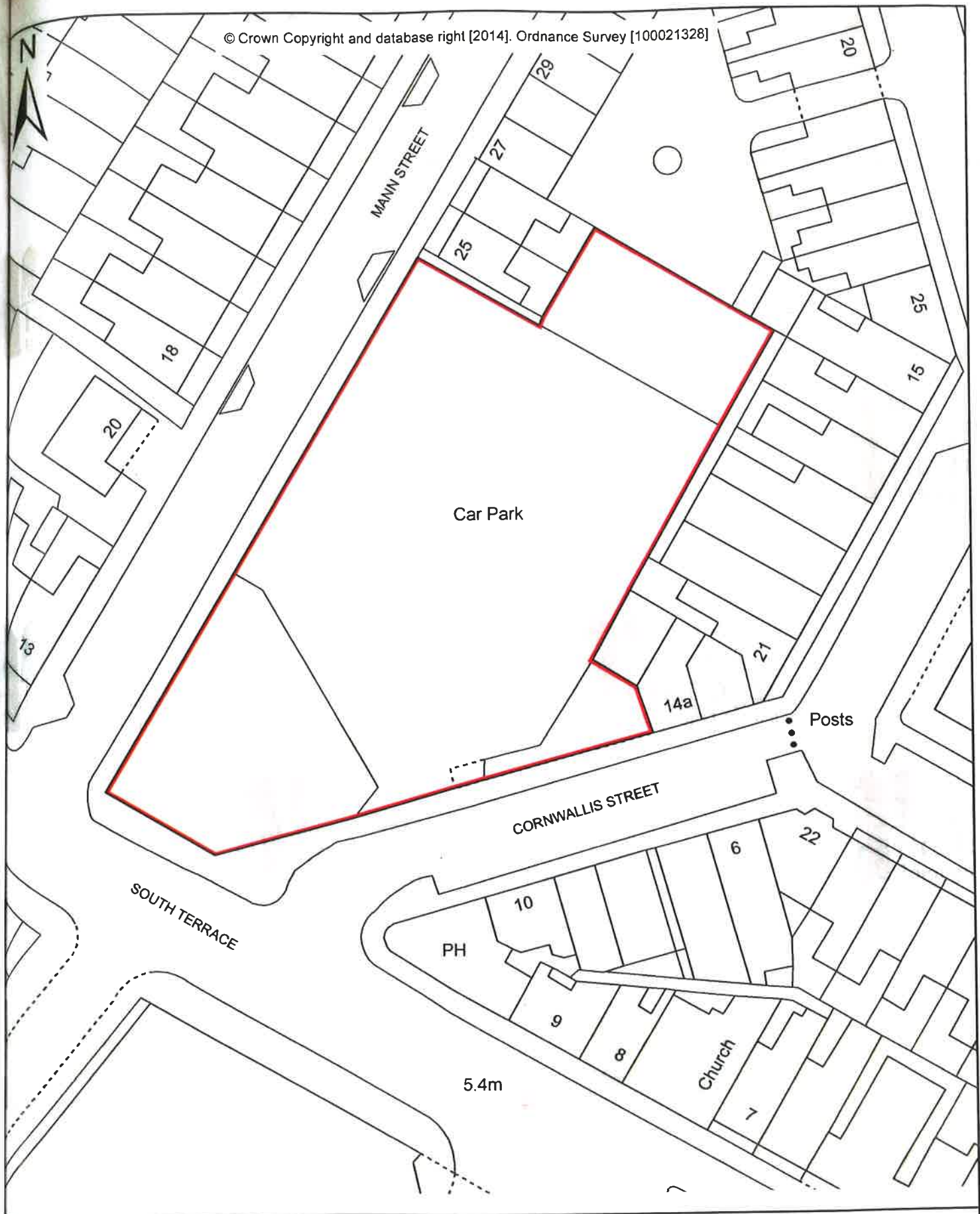

## Cornwallis Street Car Park

Date: April 2014

Scale: 1:500

Drawing No. 2448

Terms and Conditions of Use of Ordnance Survey Material i) You are granted a non-exclusive, royalty free, revocable licence solely to view the Licensed Data for non-commercial purposes for the period during which Hastings Borough Council makes it available; ii) You are not permitted to copy, sub-license, distribute, sell or otherwise make available any Data to third parties in any form; and iii) Third party rights to enforce the terms of this licence shall be reserved to Ordnance Survey.



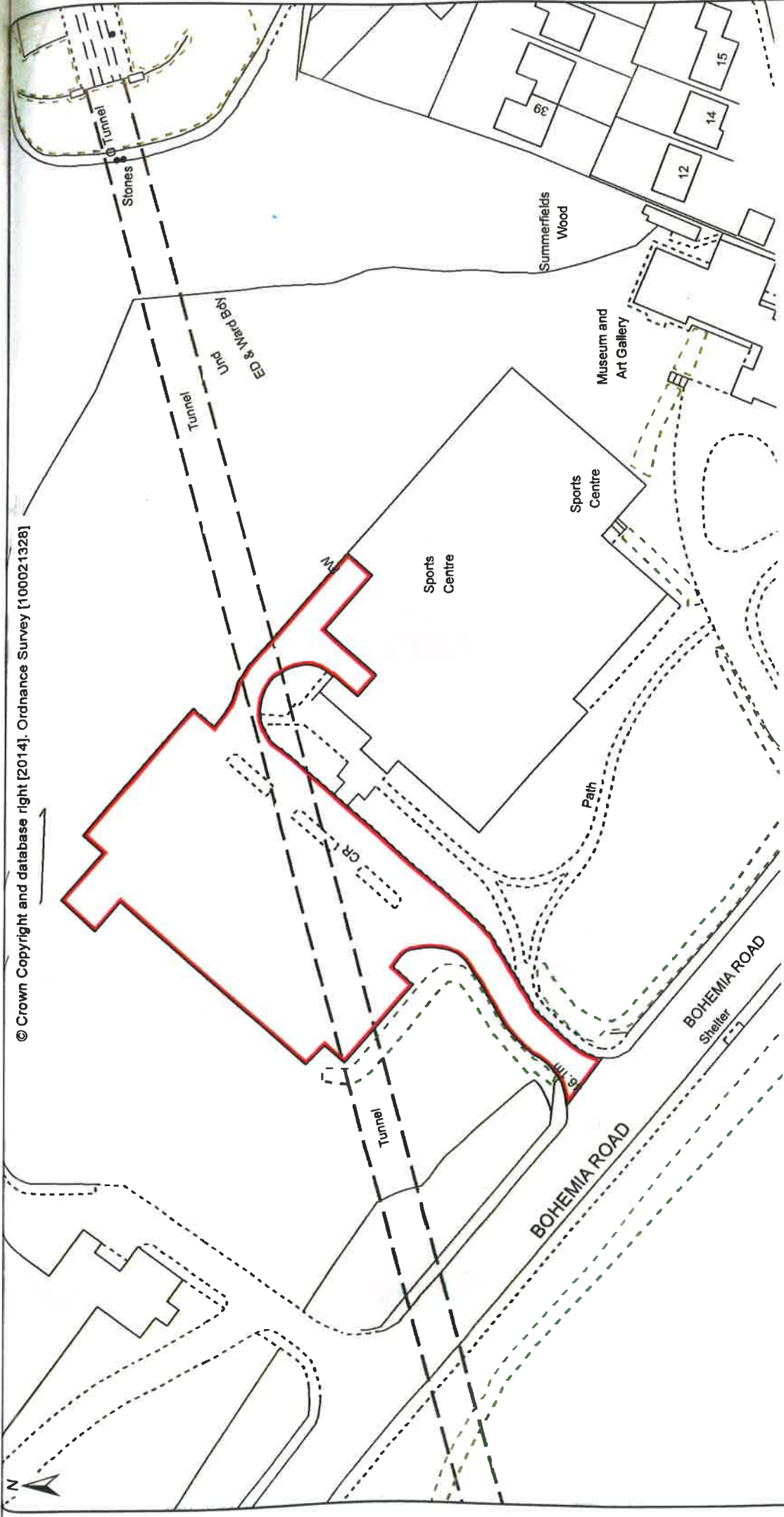

© Crown Copyright and database right [2014]. Ordnance Survey [100021328]

### Summerfield Car Park

Date: May 2014
Scale: 1:1,000
Drawing No. 2465

Terms and Conditions of Use of Ordnance Survey Material i) You are granted a non-exclusive, royalty free, revocable licence solely to view the Licensed Data for non-commercial purposes for the period during which Hastings Borough Council makes it available; ii) You are not permitted to copy, sub-license, distribute, sell or otherwise make available any Data to third parties in any form; and iii) Third party rights to enforce the terms of this licence shall be reserved to Ordnance Survey.





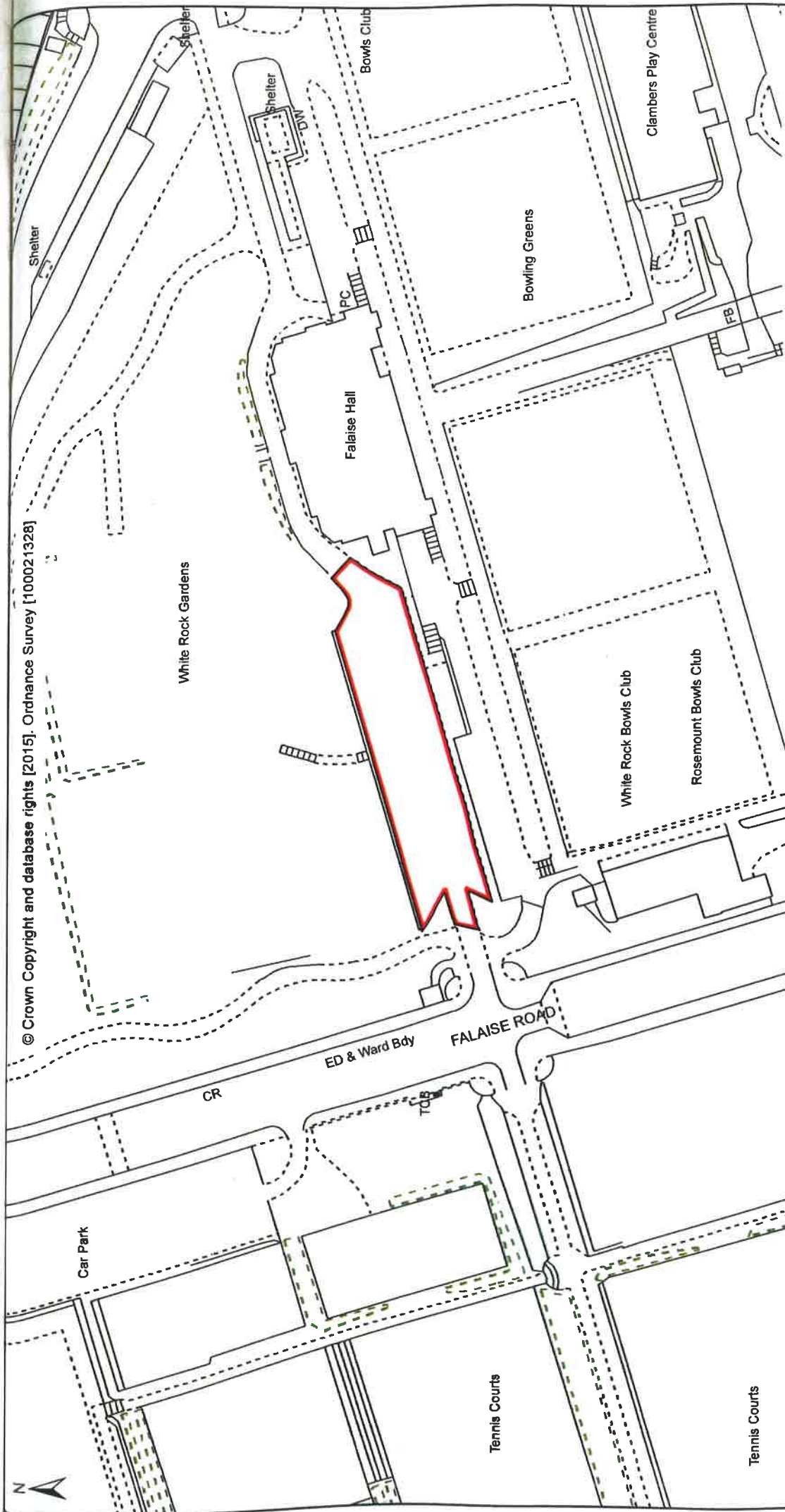

## Falaise Hall Car Park

Date: Feb 2015

Scale: 1:1,000

Drawing No. 2453

Use of this data is subject to terms and conditions. You are granted a non-exclusive, royalty free, revocable licence solely to view the Licensed Data for non-commercial purposes for the period during which Hastings Borough Council makes it available. You are not permitted to copy, sub-license, distribute, sell or otherwise make available the Licensed Data to third parties in any form. Third party rights to enforce the terms of this licence shall be reserved to Ordnance Survey.

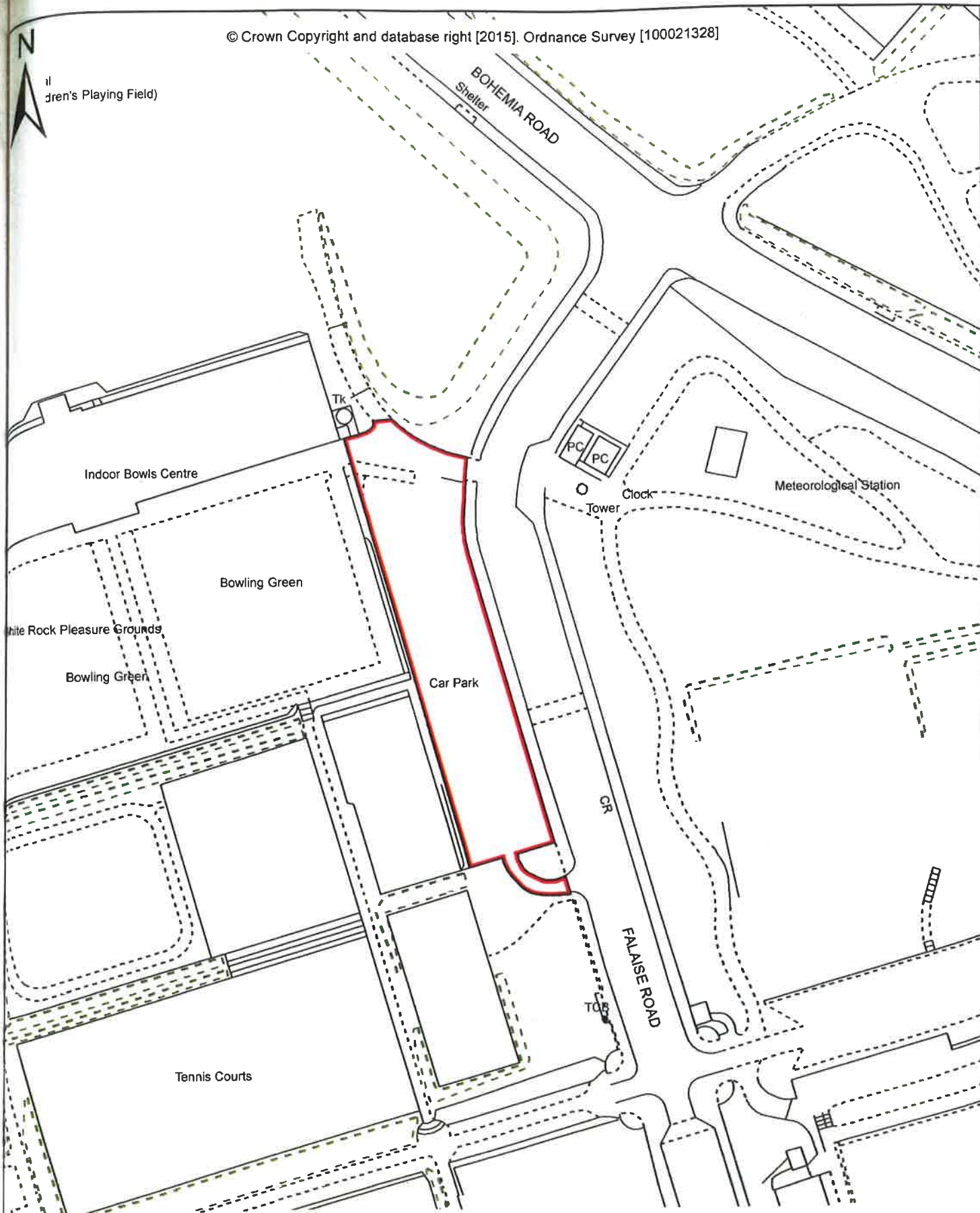

## Falaise Road Car Park

Date: Feb 2015

Scale: 1:1,000

Drawing No. 2454

Use of this data is subject to terms and conditions. You are granted a non-exclusive, royalty free, revocable licence solely to view the Licensed Data for non-commercial purposes for the period during which Hastings Borough Council makes it available. You are not permitted to copy, sub-license, distribute, sell or otherwise make available the Licensed Data to third parties in any form. Third party rights to enforce the terms of this licence shall be reserved to Ordnance Survey.





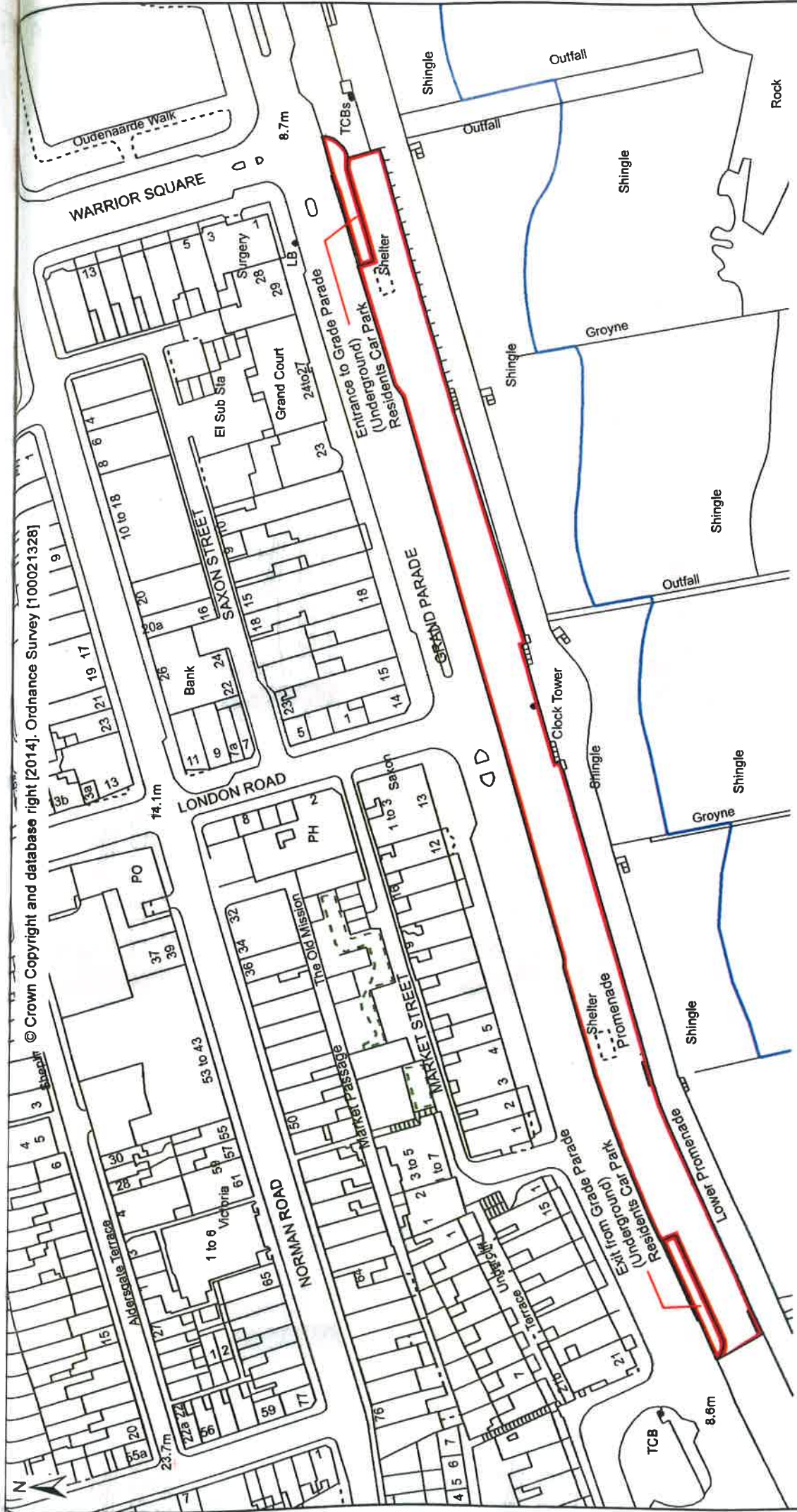

© Crown Copyright and database right [2014]. Ordnance Survey [100021328]

## Grand Parade Residents Car Park

**Date:** May 2014  
**Scale:** 1:1,250  
**Drawing No.** 2456

Terms and Conditions of Use of Ordnance Survey Material i) You are granted a non-exclusive, royalty free, revocable licence solely to view the Licensed Data for non-commercial purposes for the period during which Hastings Borough Council makes it available; ii) You are not permitted to copy, sub-license, distribute, sell or otherwise make available any Data to third parties in any form; and iii) Third party rights to enforce the terms of this licence shall be reserved to Ordnance Survey.



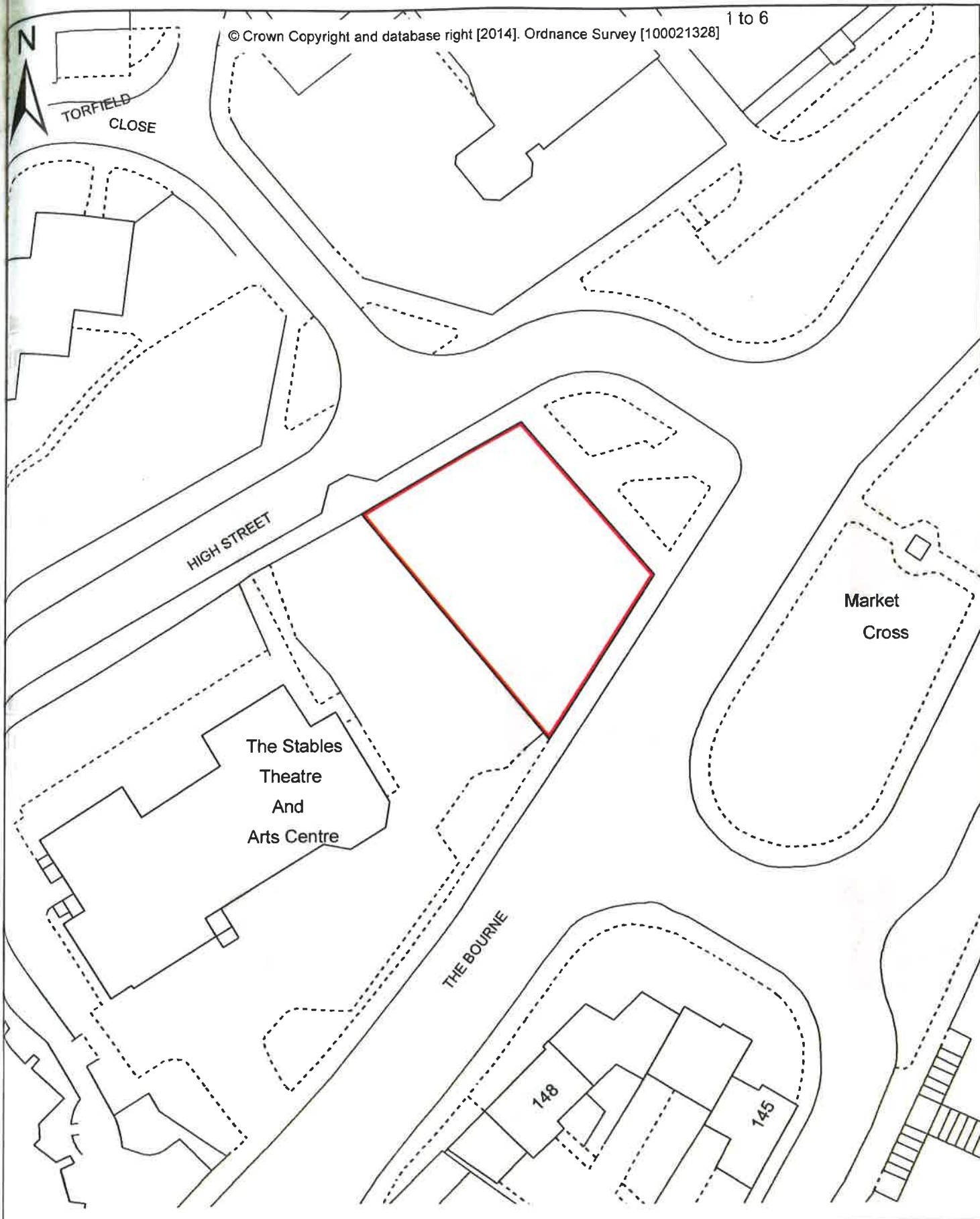

## High Street Residents Car Park

Date: May 2014

Scale: 1:500

Drawing No. 2457

Terms and Conditions of Use of Ordnance Survey Material i) You are granted a non-exclusive, royalty free, revocable licence solely to view the Licensed Data for non-commercial purposes for the period during which Hastings Borough Council makes it available; ii) You are not permitted to copy, sub-license, distribute, sell or otherwise make available any Data to third parties in any form; and iii) Third party rights to enforce the terms of this licence shall be reserved to Ordnance Survey.





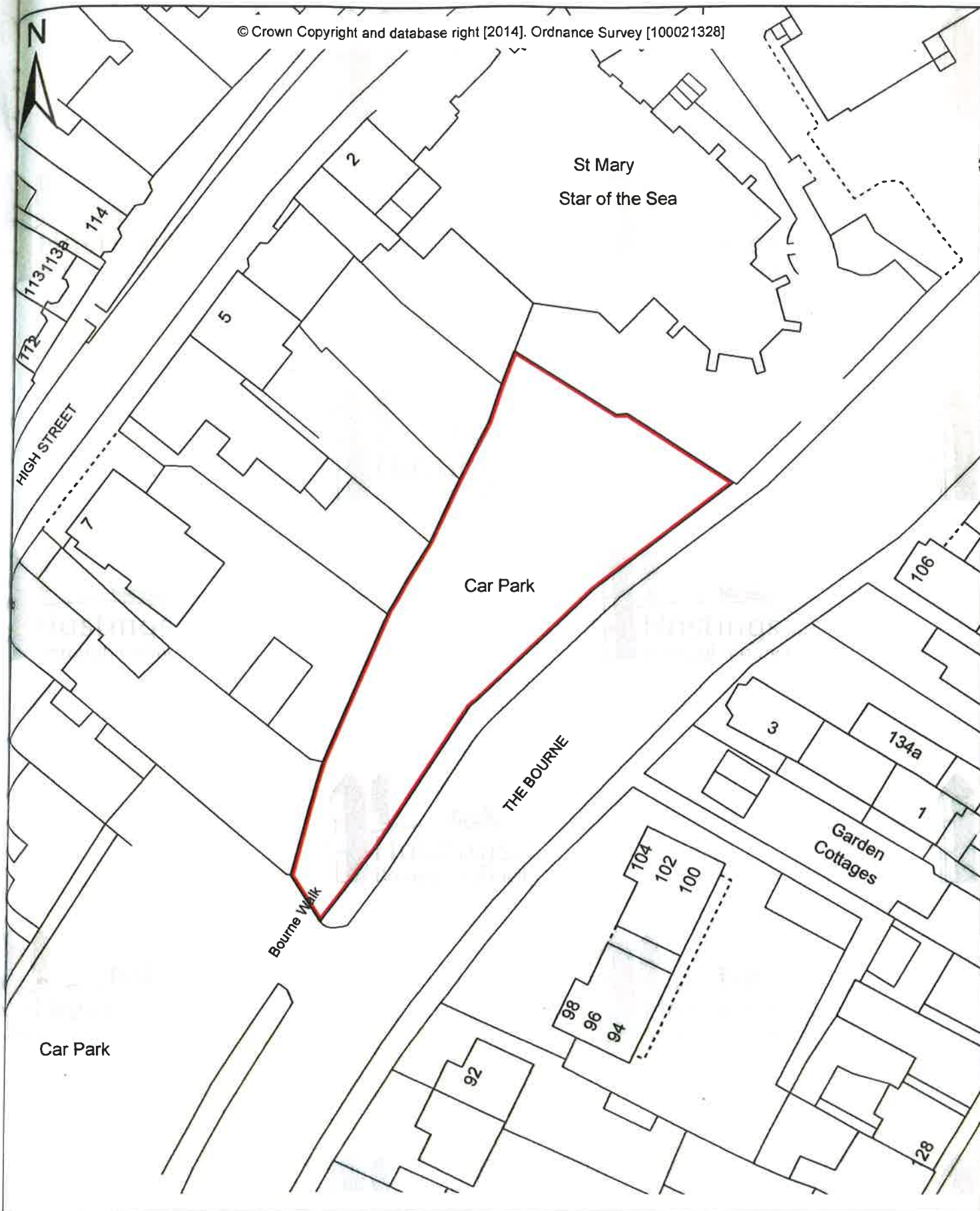

## The Bourne Residents Car Park

Date: May 2014

Scale: 1:500

Drawing No. 2466

Terms and Conditions of Use of Ordnance Survey Material i) You are granted a non-exclusive, royalty free, revocable licence solely to view the Licensed Data for non-commercial purposes for the period during which Hastings Borough Council makes it available; ii) You are not permitted to copy, sub-licence, distribute, sell or otherwise make available any Data to third parties in any form; and iii) Third party rights to enforce the terms of this licence shall be reserved to Ordnance Survey.

