

THE BOROUGH OF EASTLEIGH (BISHOPSTOKE, FAIR OAK AND HORTON
HEATH)(PROHIBITION AND RESTRICTION OF WAITING)(DISABLED PERSONS
PARKING PLACES)(AMENDMENT NO.9) ORDER 2015

The Council of the Borough of Eastleigh (hereinafter referred to as "the Council") pursuant to arrangements made under Section 19 of the Local Government Act 2000 with the Hampshire County Council in exercise of the powers of the said County Council under Sections 1, 2, 32 and 35 of the Road Traffic Regulation Act 1984 ("the Act") and Part IV of Schedule 9 to the Act and of all other enabling powers, and after consultation with the Chief Officer of Police in accordance with Part III of Schedule 9 to the Act hereby makes the following Order:-

Commencement and Citation

1. This Order shall come into operation on Monday 20 April 2015 and may be cited as the "Borough of Eastleigh (Bishopstoke, Fair Oak and Horton Heath) (Prohibition and Restriction of Waiting)(Disabled Persons Parking Places)(Amendment No.9) Order 2015"

Prohibition and Restriction of Waiting

2. In this Order the Principle Order means The Borough of Eastleigh (Bishopstoke, Fair Oak and Horton Heath)(Prohibition and Restriction of Waiting)(Disabled Persons Parking Places) Order 2004.
3. The Principle Order is hereby amended as follows:

(a) After Part V of the Order there shall be inserted a new Part, 'Part VI- Prohibition of Stopping on Entrance Markings' and shall read as follows:

31A. Save as provided in Article 31B of this Order, no person shall, except upon the direction or with the permission of a police constable in uniform or with the permission of a Civil Enforcement Officer, cause or permit any vehicle to stop or remain at rest on an Entrance Marking at any time on the roads specified in the twelfth schedule.

31B. Nothing in Article 31A of this order shall render it unlawful for a person to cause or permit a vehicle to stop or wait on an Entrance Marking if:

- (a) the vehicle is waiting owing to the driver being prevented from proceeding by circumstances beyond his or her control or to such waiting being necessary in order to avoid an accident;
- (b) the vehicle is a vehicle used for Fire Brigade or Ambulance purposes or a vehicle is in the service of the Police force in either case being used in pursuance of statutory powers or duties;
- (c) the vehicle is waiting only for so long as may be necessary to enable it to be used in connection with the removal of any obstruction to traffic;

(d) the vehicle, if it cannot conveniently be used for such purpose in any other road, to be used in connection with any of the following operations, namely –

i. the maintenance, improvement or reconstruction of the said sides of road or length of road;

ii. the laying, erection, alteration or repair in, or in land adjacent to the said sides of roads or length of roads of any sewer or of any main, pipe or apparatus for the supply of gas, water or electricity or of any telecommunication apparatus;

(b) In Article 20 after paragraph (d) there shall be inserted:

(e) Between the hours of 8am and 9am and 2:30pm and 4pm on any day other than a Saturday or Sunday in the roads, on the sides of roads, or in any lengths of roads specified in the Eleventh Schedule to this Order.

(c) After Article 21 there shall be inserted two new articles; Article 21A and 21B and shall read:

21A. Save as provided in Articles 23 and 24 of this Order no person shall except upon the direction or with the permission of a Police Constable in uniform or a Civil Enforcement Officer cause or permit any vehicle to wait between the hours of 8.00am and 8.00pm on a day other than a Sunday on the sides of roads or in the lengths of roads specified in the Ninth Schedule to this order-

(a) For a longer period than thirty minutes; or

(b) If a period of less than 1 hour has elapsed since the termination during the said hours of the last period of waiting (if any) of the vehicle on those sides of roads or in those lengths of roads.

(d) In the First Schedule (No Waiting at Any Time) after item 7 relating to Burnetts Lane there shall be inserted:

7A	Burnetts Lane	Both	From a point 80 metres west of its junction with Botley Road in a westerly direction for a distance of 45 metres.
----	---------------	------	---

(e) In the First Schedule (No Waiting at Any Time) after item 13A relating to Earls Close there shall be inserted:

13B	Elkins Square	West	From its junction with Fair Oak Road in a southerly direction for a distance of 5 metres.
13C	Elkins Square	East	From its junction with Fair Oak Road in

a southerly direction for a distance of 17 metres.

(f) In the First Schedule (No Waiting at Any Time) after item 13C relating to Elkins Square there shall be inserted:

13D	Elland Close	Both	From a point 70 metres south of its junction with Selhurst Way in a westerly then northerly and then westerly direction (turning head) for a distance of 17 metres.
13E	Elland Close	Both	From its junction with Selhurst Way in a southerly direction for a distance of 10 metres.

(g) In the First Schedule (No Waiting at Any Time) after item 17 relating to Fair Oak Road there shall be inserted:

17A	Fair Oak Road	South	From its junction with Elkins Square in an easterly and a westerly direction for a distance of 10 metres.
-----	---------------	-------	---

(h) In the First Schedule (No Waiting at Any Time) after item 18 relating to Fair Oak Road there shall be inserted:

18A	Fratton Way	East	From its junction with Selhurst Way in both a northerly and a southerly direction for a distance of 10 metres.
-----	-------------	------	--

(i) In the First Schedule (No Waiting at Any Time) after item 32D relating to Montague Road there shall be inserted:

32E	Noyce Drive	South	From its junction with Stubbington Way east for a distance of 10 metres.
-----	-------------	-------	--

(j) In the First Schedule (No Waiting at Any Time) after item 34 relating to Pavilion Close there shall be inserted:

34A	Reynolds Road	North	From its junction with Stubbington Way west for a distance of 10 metres.
34B	Reynolds Road	South	From its junction with Stubbington Way west for a distance of 15 metres.

(k) In the First Schedule (No Waiting at Any Time) after item 37 relating to Sandy Lane there shall be inserted:

37A	Sandy Lane	East	From its junction with Witt Road in a
-----	------------	------	---------------------------------------

southerly direction for a distance of 11 metres.

37B	Sandy Lane	East	From its junction with Witt Road in a northerly direction for a distance of 36 metres.
-----	------------	------	--

(l) In the First Schedule (No Waiting at Any Time) after item 38A relating to Sayers Road there shall be inserted:

38B	Saxon Court	Both	From its junction with Burnetts Lane in a northerly direction for a distance of 2.5 metres.
-----	-------------	------	---

(m) In the First Schedule (No Waiting at Any Time) after item 41 relating to Sedgwick Road there shall be inserted:

41A.	Selhurst Way	Both	From its junction with Fratton Way in an easterly direction for a distance of 10 metres.
------	--------------	------	--

41B.	Selhurst Way	South	From its junction with Elland Road in an easterly direction for a distance of 10 metres.
------	--------------	-------	--

41C.	Selhurst Way	South	From its junction with Elland Close in a westerly direction for a distance of 13 metres.
------	--------------	-------	--

(n) In the First Schedule (No Waiting at Any Time) after item 47K relating to Stubbington Way there shall be inserted:

47L	Stubbington Way	East	From its junction with Noyce Drive in a southerly direction for a distance of 15 metres.
-----	-----------------	------	--

47M	Stubbington Way	West	From its junction with Reynolds Road in a northerly direction for a distance of 14 metres.
-----	-----------------	------	--

47N	Stubbington Way	West	From its junction with Reynolds Road in a southerly direction for a distance of 10 metres.
-----	-----------------	------	--

(o) In the First Schedule (No Waiting at Any Time) after item 53 relating to Winchester Road/Botley Road (A3051) there shall be inserted:

54	Witt Road	Both	From its junction with Sandy Lane in a south easterly direction for a distance of
----	-----------	------	---

10 metres.

(p) After the Eighth Schedule there shall be inserted:

NINTH SCHEDULE

Thirty Minutes Limited Waiting Monday to Saturday 8.00am to 8.00pm
(No Return Within One Hour)

- | | | | |
|----|---------------|-------|---|
| 1. | Fair Oak Road | South | From a point 2 metres west of the eastern most property wall of no.168 Fair Oak Road in a westerly direction for a distance of 19 metres. |
|----|---------------|-------|---|

ELEVENTH SCHEDULE

No Waiting Monday to Friday 8.00am to 9.00am and 2:30pm to 4pm

- | | | | |
|----|--------------|-------|--|
| 1. | Selhurst Way | South | From a point opposite the western most property wall of no. 17 Selhurst Way in a westerly direction for a distance of 47 metres. |
| 2. | Selhurst Way | North | From a point 5 metres east of the common boundary of nos. 37/39 Selhurst Way in a westerly direction for a distance of 108 metres. |

TWELFTH SCHEDULE

No Stopping

- | | | | |
|----|--------------|------|---|
| 1. | Elland Close | Both | From a point 61 metres south of its junction with Selhurst Way in a southerly, then westerly and then a northerly direction (turning head) for a distance of 26 metres. |
|----|--------------|------|---|

Dated this 8 day of April 2015

THE COMMON SEAL of EASTLEIGH)
BOROUGH COUNCIL was hereunto)
affixed in the presence of:-)



Ant

Head of Legal & Democratic Services

DATED 8 April 2015

BOROUGH OF EASTLEIGH

THE BOROUGH OF EASTLEIGH
(BISHOPSTOKE, FAIR OAK AND
HORTON HEATH)(PROHIBITION AND
RESTRICTION OF
WAITING)(DISABLED PERSONS
PARKING PLACES)(AMENDMENT
NO9) ORDER 2015

A R Ward
Head of Legal & Democratic Services
Eastleigh Borough Council
Eastleigh House
Upper Market Street
Eastleigh
Hampshire
SO50 9YN

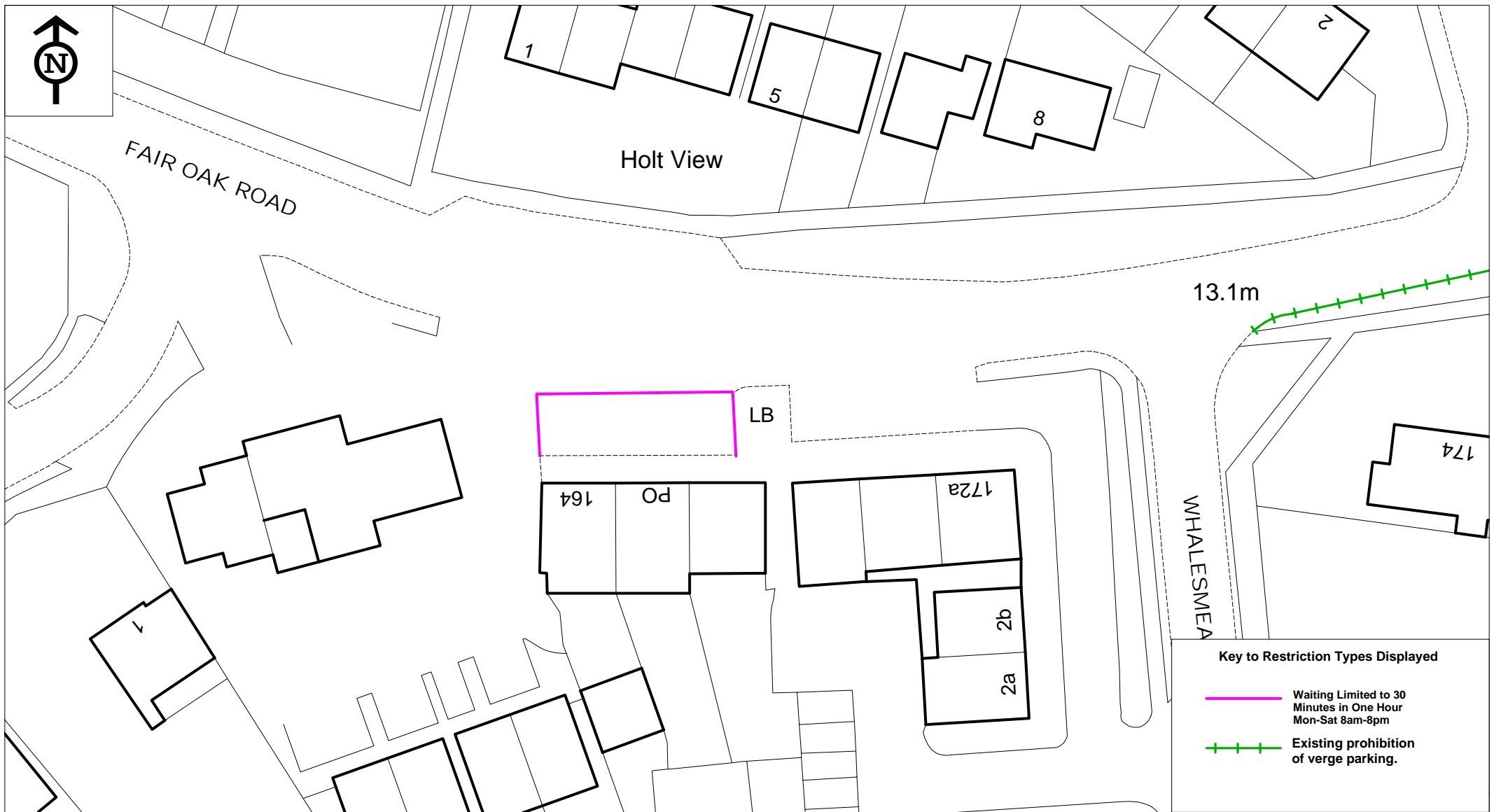

Fair Oak Road/Whalesmead Shops
(as recommended)

© Crown copyright. All rights reserved
Eastleigh Borough Council
Licence No. 100019622 2015

SCALE	1 : 500
DATE	23/02/2015
DRAWING No.	TM01/01466/1A
DRAWN BY	TL
CHECKED BY	SRW

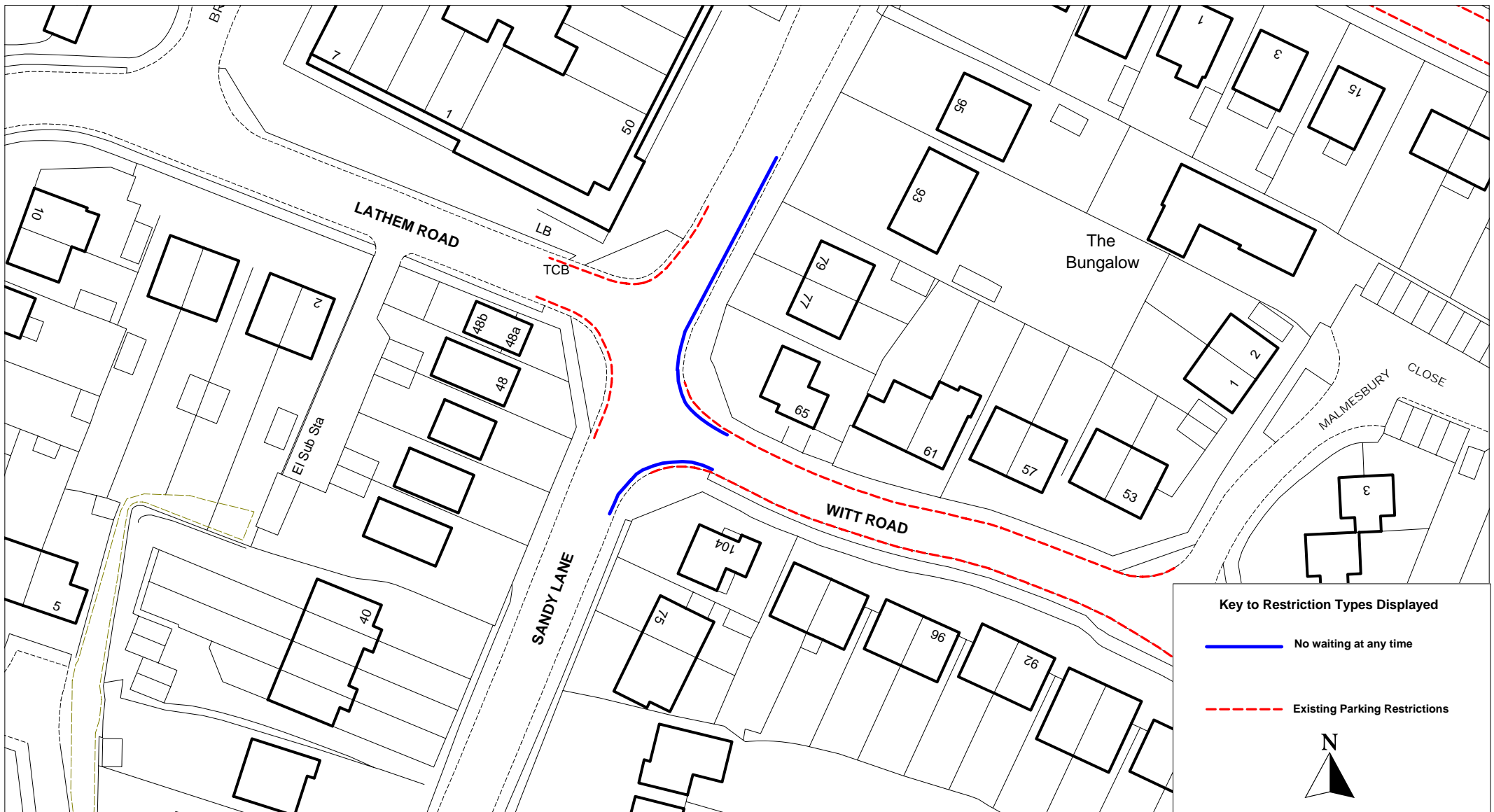

Sandy Lane/ Witt Road / Lathem Road

© Crown copyright. All rights reserved
 Eastleigh Borough Council
 Licence No. 100019622 2015

SCALE	1 : 750
DATE	19/01/2015
DRAWING No.	TM01/01466/2
DRAWN BY	
CHECKED BY	

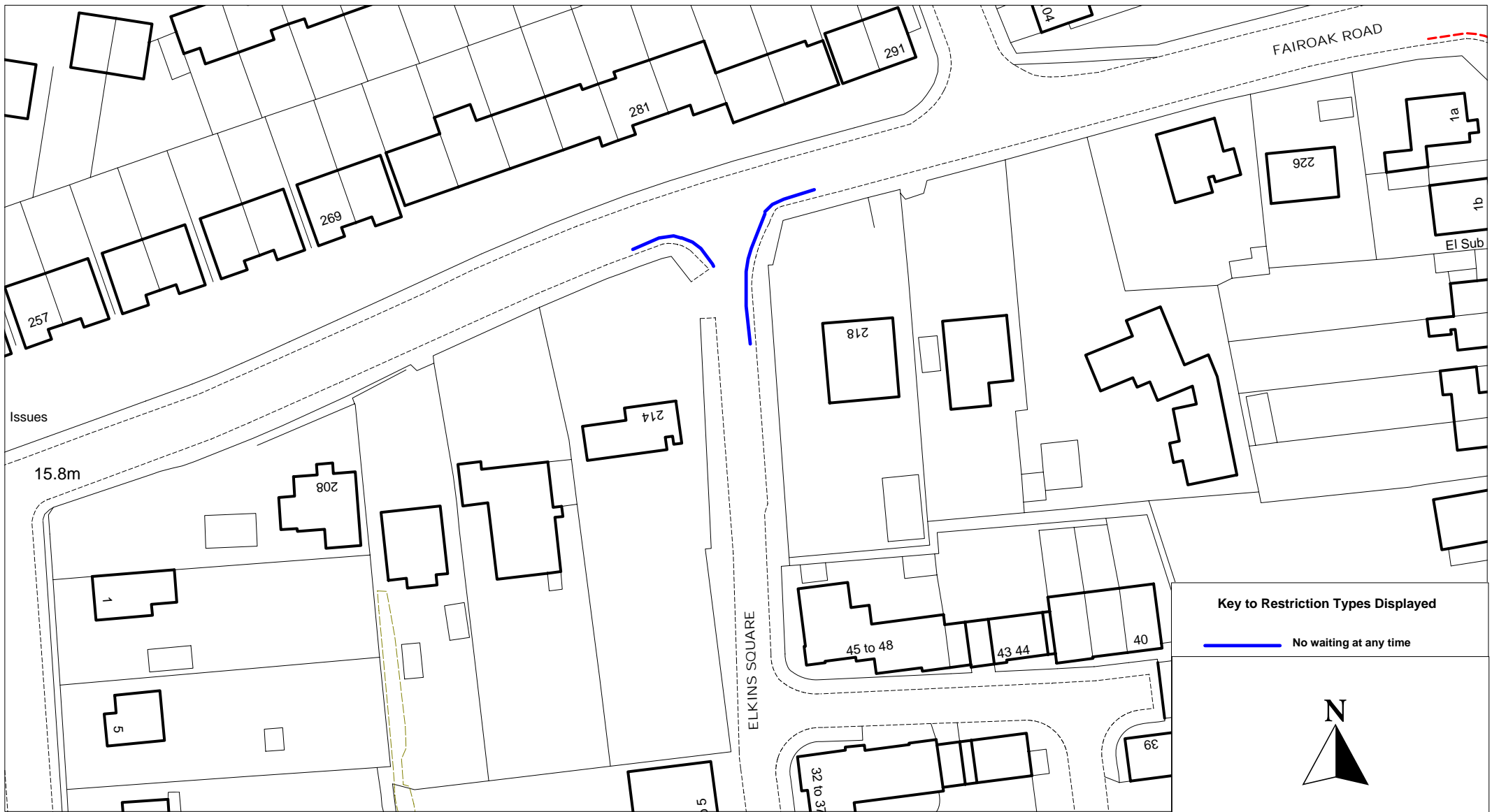

Fair Oak Road/Elkins Square

© Crown copyright. All rights reserved
 Eastleigh Borough Council
 Licence No. 100019622 2015

SCALE	1 : 750
DATE	15/01/2015
DRAWING No.	TM01/01466/3
DRAWN BY	
CHECKED BY	

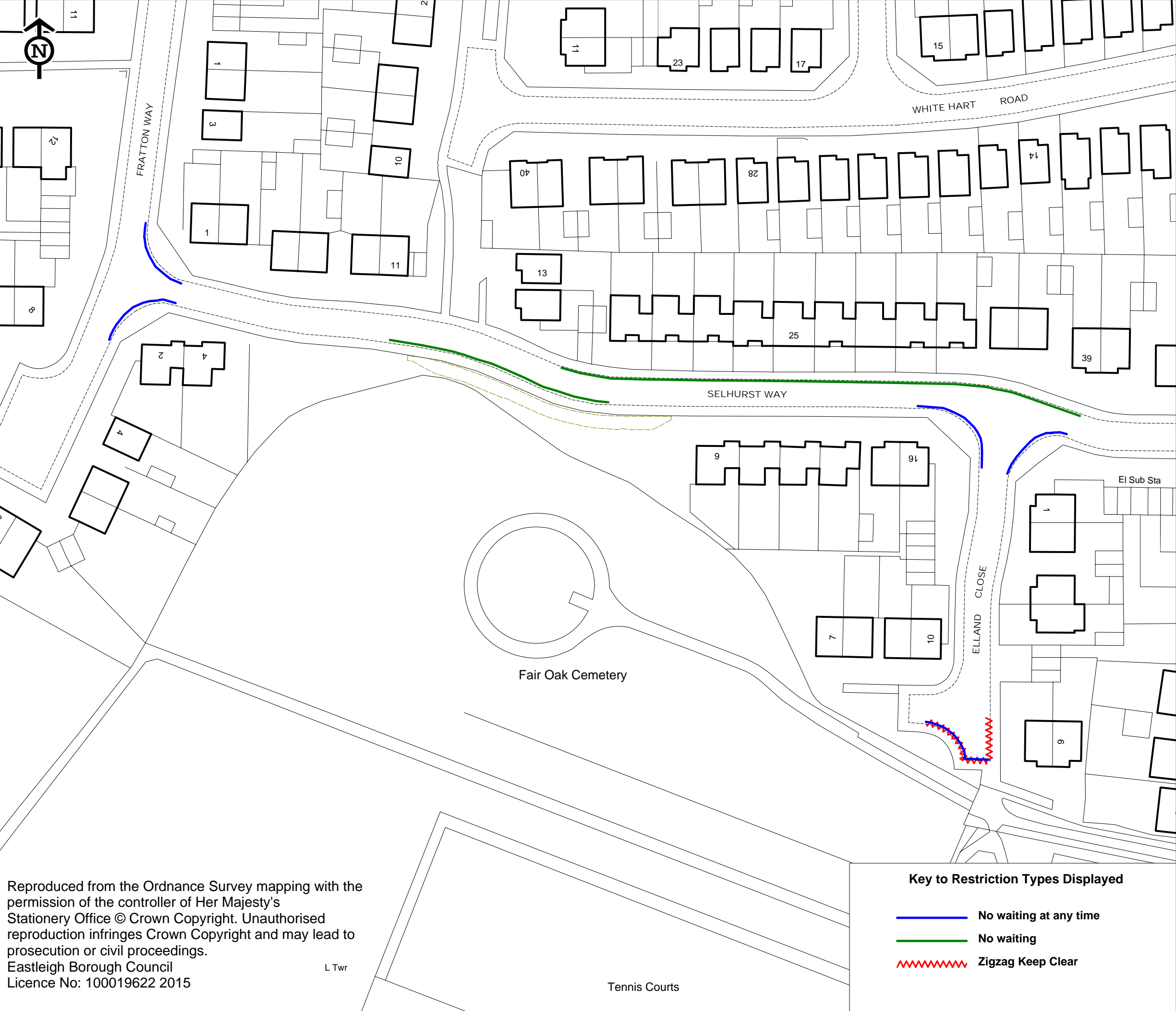

Her Majesty's Office (c) Crown Copyright.
Unauthorised reproduction infringes Crown
Copyright and may lead to prosecution
or civil proceedings.

EASTLEIGH
BOROUGH COUNCIL

DRAWING TITLE

Selhurst Way/Elland Cl/Fratton Way

SCALE	1 : 750
DATE	19/01/2015
DRAWING No.	TM01/01466/4
DRAWN BY	

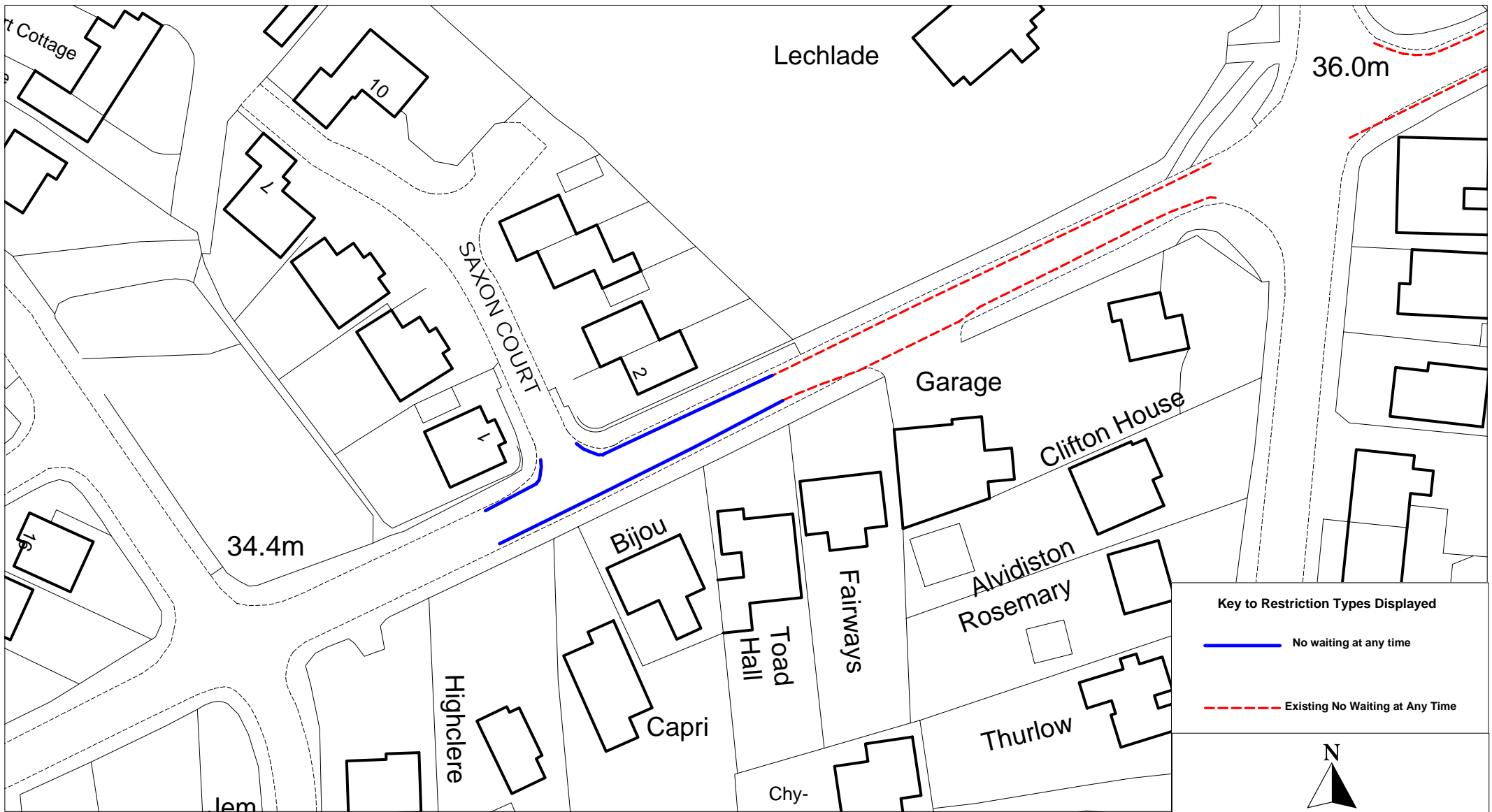

Burnetts Lane

© Crown copyright. All rights reserved
 Eastleigh Borough Council
 Licence No. 100019622 2015

SCALE

1 : 750

DATE

16/01/2015

DRAWING No.

TM01/01466/5

DRAWN BY

CHECKED BY

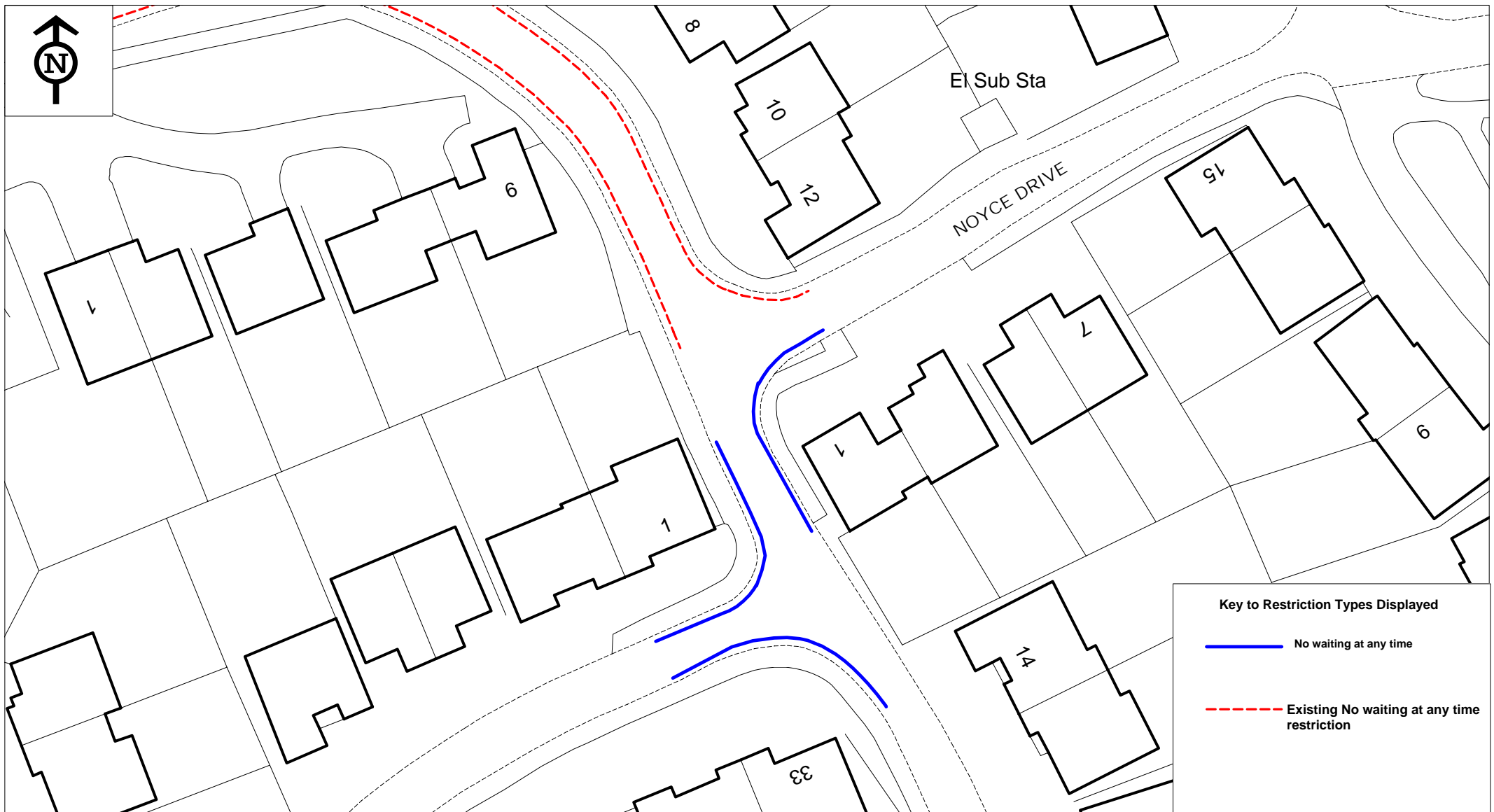

Key to Restriction Types Displayed

——— No waiting at any time

- - - - - Existing No waiting at any time restriction



Stubbington Way (as recommended)

© Crown copyright. All rights reserved
 Eastleigh Borough Council
 Licence No. 100019622 2015

SCALE	1 : 500
DATE	23/02/2015
DRAWING No.	TM01_01466_6_A
DRAWN BY	TL
CHECKED BY	SRW