

THE BOROUGH OF EASTLEIGH (BURSLEDON, HAMBLE-LE-RICE AND
HOUND) (AMENDMENT NO.5) ORDER 2014

The Council of the Borough of Eastleigh (hereinafter referred to as "the Council") pursuant to arrangements made under Section 19 of the Local Government Act 2000 with the Hampshire County Council in exercise of the powers of the said County Council under Sections 1, 2, 4, 32 and 35 of the Road Traffic Regulation Act 1984 ("the Act") and Part IV of Schedule 9 to the Act and of all other enabling powers, and after consultation with the Chief Officer of Police in accordance with Part III of Schedule 9 to the Act hereby makes the following Order:-

Commencement and Citation

1. This Order shall come into operation on 22 December 2014 and may be cited as the "Borough of Eastleigh (Bursledon, Hamble-le-Rice and Hound) (Amendment No.5) Order 2014".

Prohibition and Restriction of Waiting

2. In this Order the Principal Order means The Borough of Eastleigh (Bursledon, Hamble-le-Rice and Hound) Consolidation Order 2012.

3. The Principal Order is hereby amended as follows:

(a) After Article 40 (b) the following shall be inserted:

(c). between the hours of 8am and 5pm on any day other than a Saturday or a Sunday in the roads specified in the Twenty Third Schedule to this Order.

(b) Following the Twenty Second Schedule (No Stopping 8am-10am and 2pm-4pm Monday to Friday on Entrance Markings) there shall be inserted a new schedule (Schedule Twenty Three - No Stopping 8am - 5pm Monday to Friday on Entrance Markings).

(c) In Schedule Twenty Three (No Stopping 8am - 5pm Monday to Friday on Entrance Markings) there shall be inserted:

1. Moore Crescent North From a point 6 metres north of the south-western most corner of the turning head adjacent to the rear garden of no. 49 Moore Crescent in a northerly and then an easterly direction for a distance of 26 metres.

(d) In the Forth Schedule (No Waiting at Any time) after item number 5B (relating to Bridge Road) there shall be inserted:

- 5i. Bursledon West From its junction with Long Lane in a

Heights southerly direction for a distance in 57 metres.

5ii. Bursledon East Heights From its junction with Long Lane in a southerly direction for a distance of 55 metres.

(e) In the Fourth Schedule (No Waiting at Any Time) item numbers 5C and 5D (relating to Castle Road) shall be revoked and replaced with:

5C Castle Road Both From its junction with Priory Road in a south-easterly direction for a distance of 20 metres.

(f) In the Forth Schedule (No Waiting at Any time) before item number 12 (relating to Copse Lane) there shall be inserted:

11A. Coach Road South East From its junction with Norbury Gardens in a north easterly direction and a south westerly direction for a distance of 10 metres.

(g) In the Forth Schedule (No Waiting at Any time) after item number 15 (relating to Denzil Avenue) there shall be inserted:

15A Dodwell Lane West From its junction with Pewit Hill Close in a northerly and a southerly direction for a distance of 10 metres.

15B Elmslie Gardens Both From its junction with Manor Close in a southerly direction for a distance of 15 metres.

(h) In the Forth Schedule (No Waiting at Any time) after item number 24 (relating to Farm Close) there shall be inserted:

24i. Forge Close East From its junction with Portsmouth Road in a northerly and then an easterly direction for a distance of 20 metres.

24ii. Forge Close West From its junction with Portsmouth Road in a northerly direction for a distance of 15 metres.

(i) In the Forth Schedule (No Waiting at Any time) after item number 41 (relating to Harrier Mews Service Road) there shall be inserted:

41i Heath Gardens Both From its junction with Woolston Road in an easterly direction for a distance of 10 metres.

(j) In the Fourth Schedule (No Waiting at Any Time) item numbers 52A and B (relating to Kings Field) shall be revoked and replaced with:

52A. Kings Field East From its junction with Portsmouth Road in a north westerly direction for a distance of 30 metres.

52B. Kings Field West From its junction with Portsmouth Road in a north westerly direction for a distance of 20 metres.

(k) In the Forth Schedule (No Waiting at Any time) after item number 52B (relating to Kings Field) there shall be inserted:

52C Kings Field South From a point 1.5 metres south of the south eastern most building line of no. 24 Kings Field in a northerly and then a westerly direction for a distance of 33 metres.

(l) In the Forth Schedule (No Waiting at Any time) after item number 56 (relating to Lands End Road) there shall be inserted:

56A Long Lane South From its junction with Bursledon Heights in an easterly and a westerly direction for a distance of 15 metres.

56B Long Lane Both From its junction with School Road in a northerly direction for a distance of 20 metres.

(m) In the Fourth Schedule (No Waiting at Any Time) item number 59 (relating to Long Lane) shall be revoked and replaced with:

59. Long Lane East From a point 24 metres south of the point opposite the southern edge of the school lay-by northwards for a distance of 36 metres.

(n) In the Forth Schedule (No Waiting at Any time) before item number 62 (relating to Marina Drive) there shall be inserted:

61i. Manor Close South From its junction with Elmslie Close in an easterly direction for a distance of 10 metres.

(o) In the Forth Schedule (No Waiting at Any time) before item number 78A (relating to Portsmouth Road) there shall be inserted:

78i. Norbury Gardens Both From its junction with Coach Road in a south easterly direction for a distance of 10 metres.

78ii Peewit Hill Close Both From its junction with Dodwell Lane in a westerly direction for a distance of 70 metres.

(p) In the Forth Schedule (No Waiting at Any time) after item number 79F (relating to Peewit Hill) there shall be inserted:

79G. Portsmouth Road North East From its junction with Forge Close for a distance of 32 metres in a westerly direction and for a distance of 15 metres in an easterly direction.

79H. Portsmouth Road South From its junction with Redcroft Lane in an easterly direction for a distance of 23 metres and a westerly direction for a distance of 15 metres.

79I. Portsmouth Road South From its junction with Elmslie Gardens in a westerly direction for a distance of 15 metres.

(q) In the Forth Schedule (No Waiting at Any time) after item number 80 (relating to Pound Road) there shall be inserted:

80A Pound Road South West From its junction with Priors Hill Lane in a south easterly direction and a north westerly direction for a distance of 10 metres.

(r) In the Fourth Schedule (No Waiting at Any Time) item numbers 82A (relating to Priory Road) shall be revoked and replaced with:

82A Priory Road South East From a point 15 metres north-east of its junction with Castle Road south-westwards to a point 15 metres south west of that junction.

(s) In the Forth Schedule (No Waiting at Any time) after item number 94 (relating to Pylands Lane) there shall be inserted:

94i. Redcroft Lane Both From its junction with Portsmouth Road in a southerly direction for a distance of 20 metres.

(t) In the Forth Schedule (No Waiting at Any time) after item number 101 (relating to School Road) there shall be inserted:

101A	School Road	North	From its junction with Long Lane in an easterly direction for a distance of 15 metres and a westerly direction for a distance of 20 metres.
------	-------------	-------	---

(u) In the Forth Schedule (No Waiting at Any time) after item number 118A (relating to The Grove there shall be inserted:

118B	The Grove (east/west)	North	From a point 2 metres east of the common boundary of nos. 1 and 3 The Grove in an easterly direction for a distance of 32 metres.
118C	The Grove (east/west)	North East	From a point 95 metres east and then south of the common boundary of nos. 1 and 3 The Grove in a northerly and then a westerly direction for a distance of 30 metres.
118D	The Grove (east/west)	South	From its junction with the eastern most southbound spur in a westerly direction for a distance of 10 metres.
118E	The Grove (eastern most southbound spur)	West	From its junction with The Grove (east/west) in a southerly direction for a distance of 15 metres.
118F	The Grove (east/west)	South	From its junction with The Grove (western most southbound spur) in an easterly and a westerly direction for a distance of 10 metres.
118G	The Grove (western most southbound spur)	Both	From its junction with The Grove (east/west) in a southerly direction for a distance of 10 metres.

(v) In the Fourth Schedule (No Waiting at Any Time) item numbers 138A, and 138D (relating to Woolston Road) shall be revoked and replaced with:

138A.	Woolston Road	North East	From its junction with Ingleside eastwards and southwards to its junction with Heath Gardens.
138D.	Woolston	South	From the common boundary of nos. 109

Road West and 111 Woolston Road north-westwards for a distance of 110 metres.

(w) In the Forth Schedule (No Waiting at Any time) after item number 138E (relating to Woolston Road) there shall be inserted:

138F. Woolston East From its junction with Heath Gardens in a southerly direction for a distance of 10 metres.
Road

(x) In the Seventeenth Schedule (Areas on the Highway Designated as Disabled Persons Parking Places) item number 3 (relating to Castle Road) shall be revoked and replaced with:

3 Castle South West From a point 52 metres north east of its junction with Queens View in a north easterly direction for a distance of 13.2 metres.
Road

(y) In the Seventeenth Schedule (Areas on the Highway Designated as Disabled Persons Parking Places) after item number 7 (relating to Grantham Avenue) there shall be inserted:

7A Jarvis North West From a point 49.5 metres north of its junction with Church Lane in a north westerly direction for a distance of 6.6 metres. Received
Fields

Dated this 10th day of December 2014

THE COMMON SEAL of EASTLEIGH)
BOROUGH COUNCIL was hereunto)
affixed in the presence of:-)



Head of Legal & Democratic Services

DATED _____ 2014

BOROUGH OF EASTLEIGH

THE BOROUGH OF EASTLEIGH
(BURSLEDON, HAMBLE-LE-RICE AND
HOUND) (AMENDMENT NO.5) ORDER
2014

A R Ward
Head of Legal & Democratic Services
Eastleigh Borough Council
Eastleigh House
Upper Market Street
Eastleigh
Hampshire
SO50 9YN

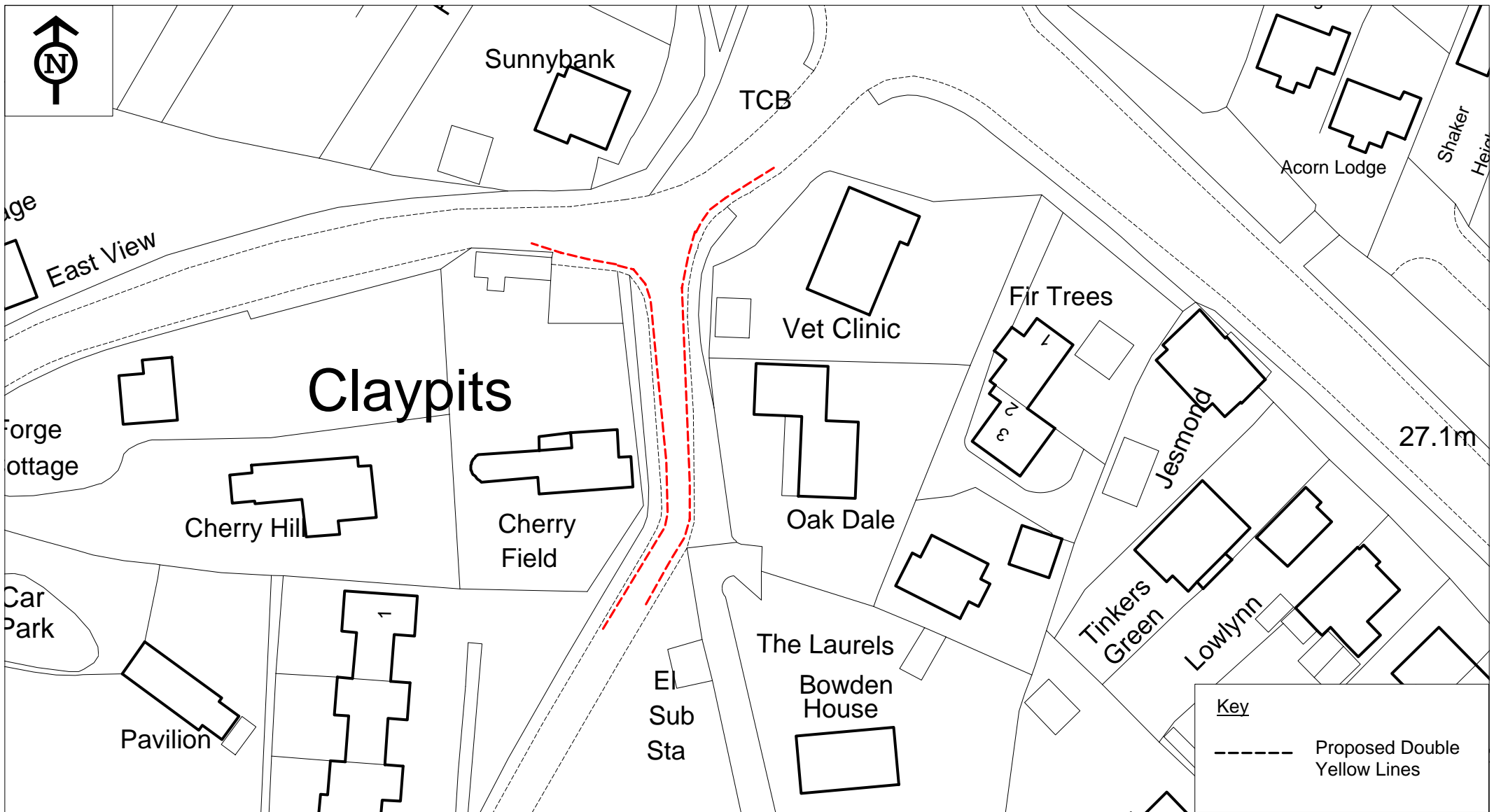

TM01/01371/1 Bursledon Heights

© Crown copyright. All rights reserved
 Eastleigh Borough Council
 Licence No. 100019622 (2013)

SCALE	1 : 750
DATE	04/07/2014
DRAWING No.	
DRAWN BY	
CHECKED BY	

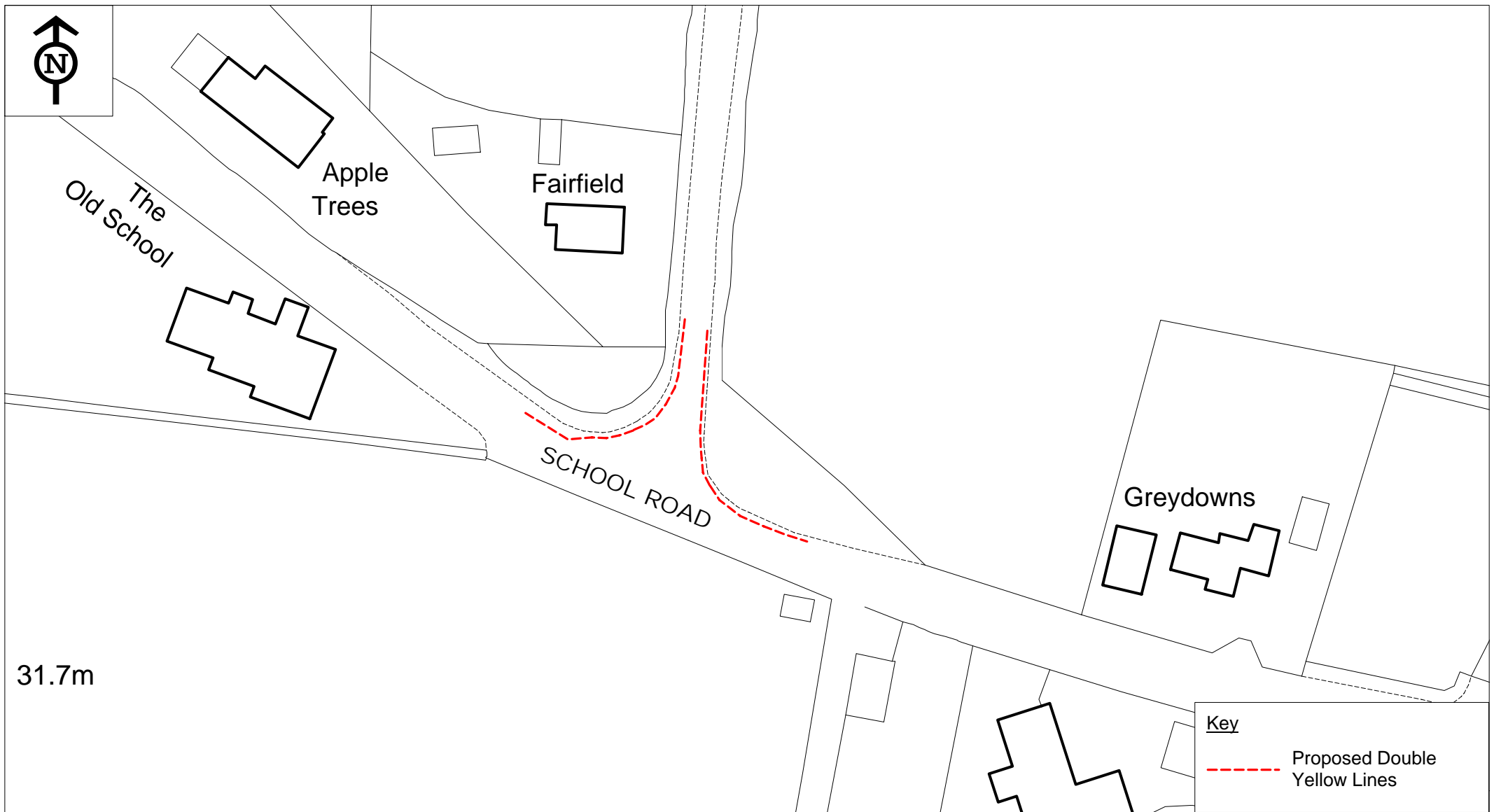

Key	
	Proposed Double Yellow Lines



TM01/01371/10 School Road

© Crown copyright. All rights reserved
 Eastleigh Borough Council
 Licence No. 100019622 (2013)

SCALE	1 : 750
DATE	04/07/2014
DRAWING No.	
DRAWN BY	
CHECKED BY	



Key	Proposed Double Yellow Lines
-----	------------------------------



TM01/01371/11 The Grove

© Crown copyright. All rights reserved
 Eastleigh Borough Council
 Licence No. 100019622 (2013)

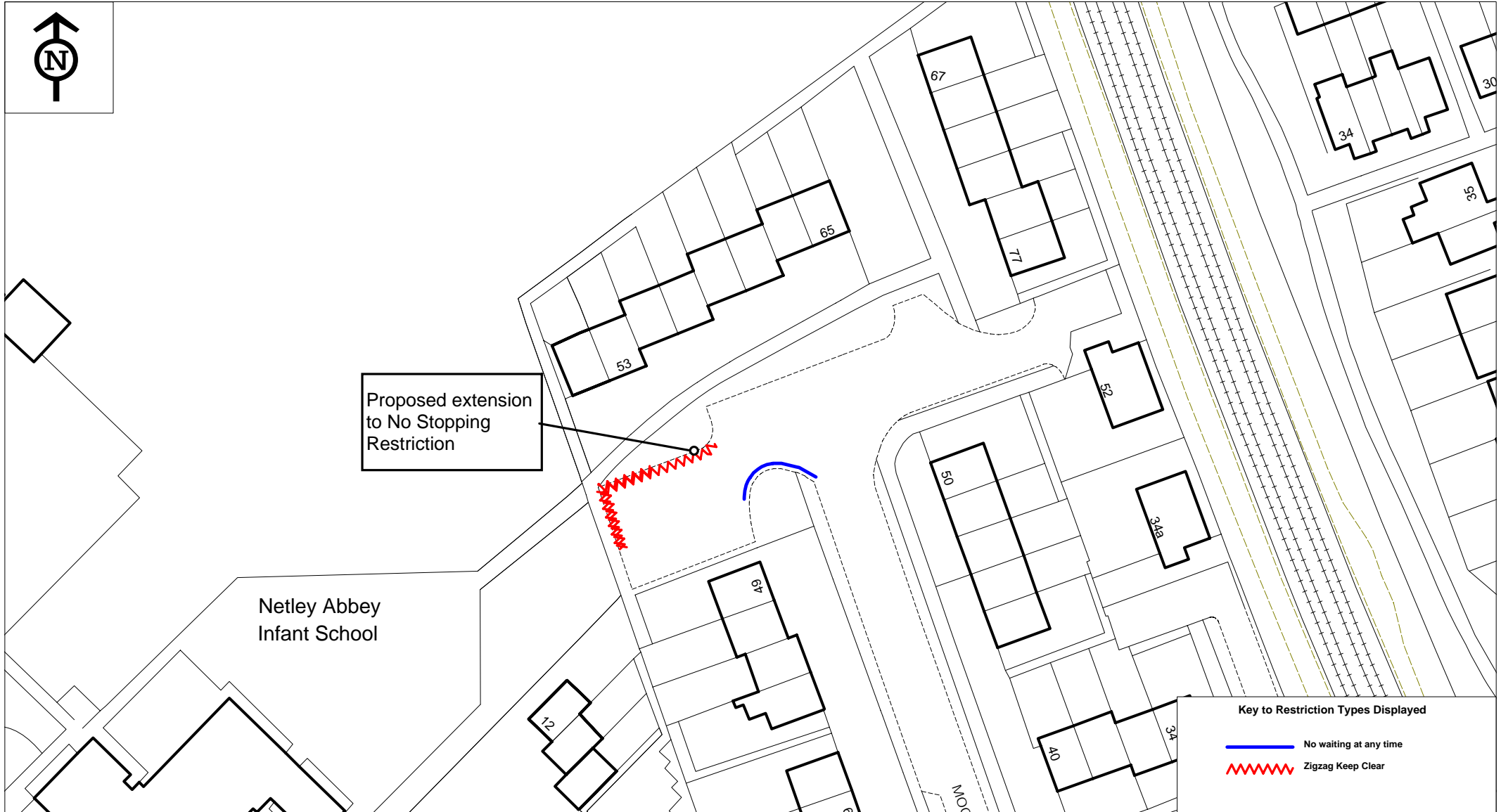

SCALE	1 : 750
DATE	04/07/2014
DRAWING No.	
DRAWN BY	
CHECKED BY	



Proposed extension
to No Stopping
Restriction

Netley Abbey
Infant School

Key to Restriction Types Displayed

-  No waiting at any time
-  Zigzag Keep Clear



TM01/01371/12 Moore Crescent

© Crown copyright. All rights reserved
Eastleigh Borough Council
Licence No. 100019622 (2013)

SCALE	1 : 750
DATE	07/07/2014
DRAWING No.	
DRAWN BY	
CHECKED BY	

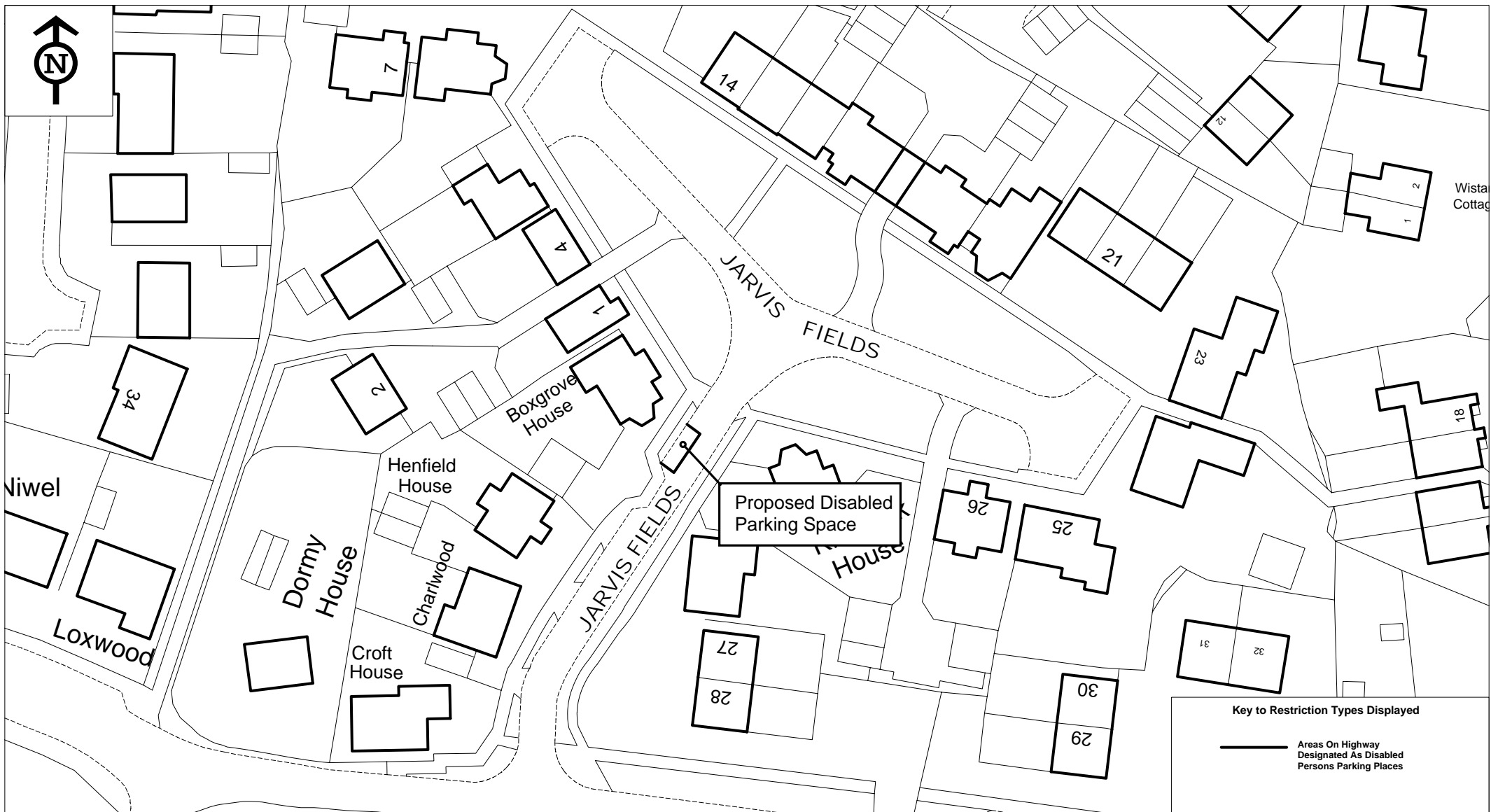

TM01/01371/14 Jarvis Fields

© Crown copyright. All rights reserved
 Eastleigh Borough Council
 Licence No. 100019622 (2013)

SCALE	1 : 750
DATE	07/07/2014
DRAWING No.	
DRAWN BY	
CHECKED BY	

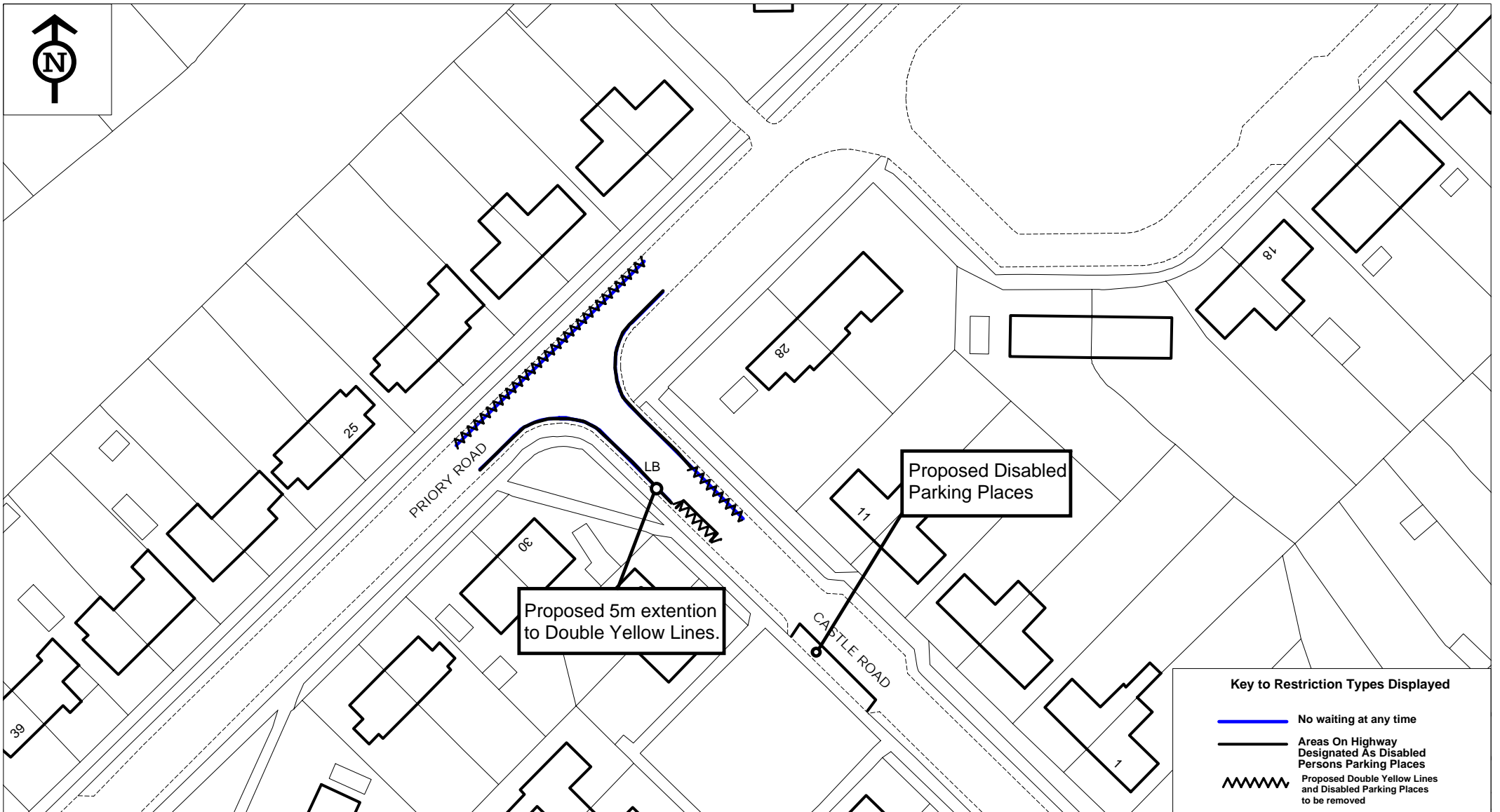

TM01/01371/2 Priory Rd and Castle Road

© Crown copyright. All rights reserved
 Eastleigh Borough Council
 Licence No. 100019622 (2013)

SCALE	1 : 750
DATE	04/07/2014
DRAWING No.	
DRAWN BY	
CHECKED BY	

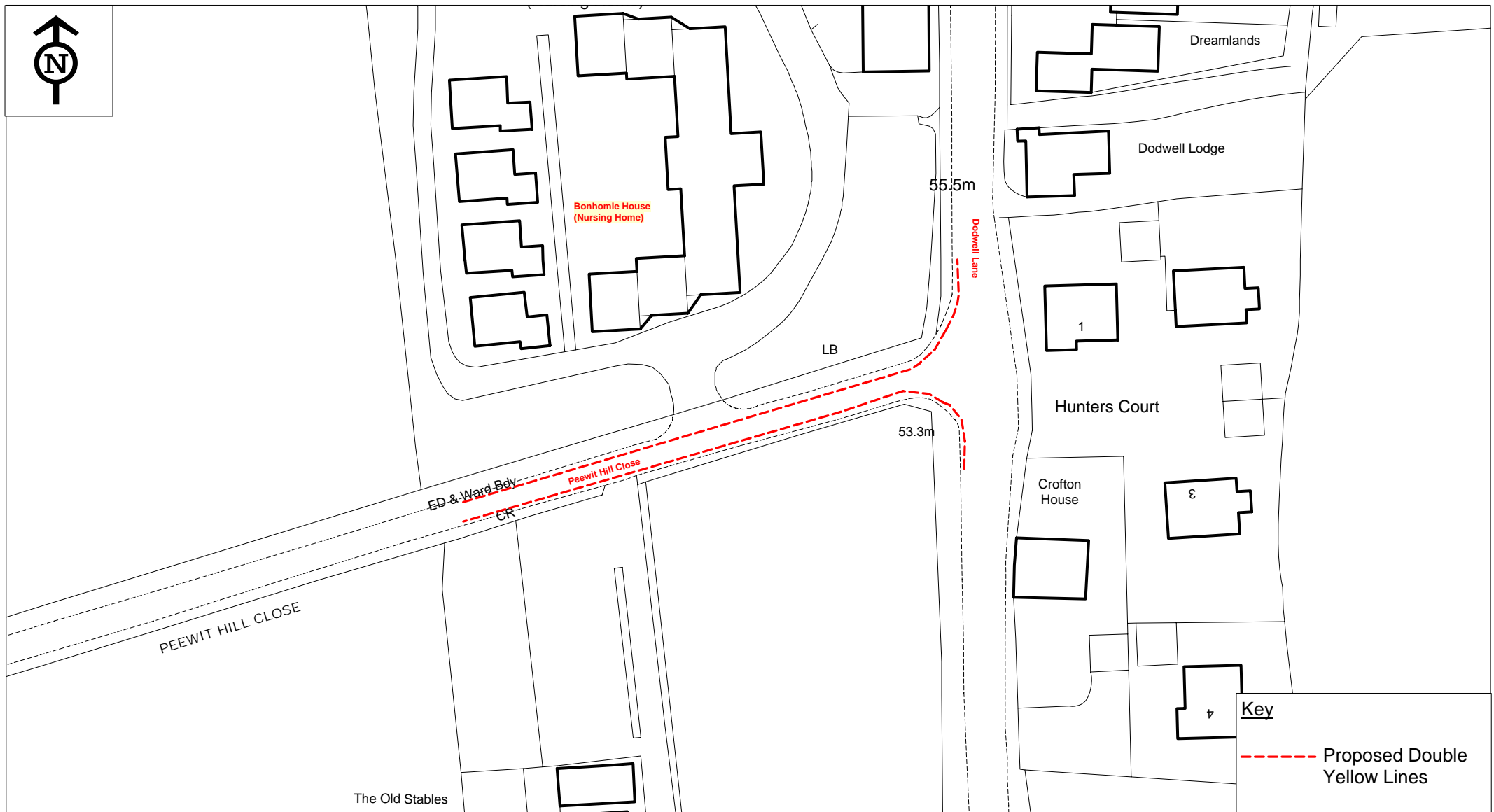

TM01/01371/3 Peewit Hill Close

© Crown copyright. All rights reserved
 Eastleigh Borough Council
 Licence No. 100019622 (2013)

SCALE	1 : 750
DATE	04/07/2014
DRAWING No.	
DRAWN BY	
CHECKED BY	

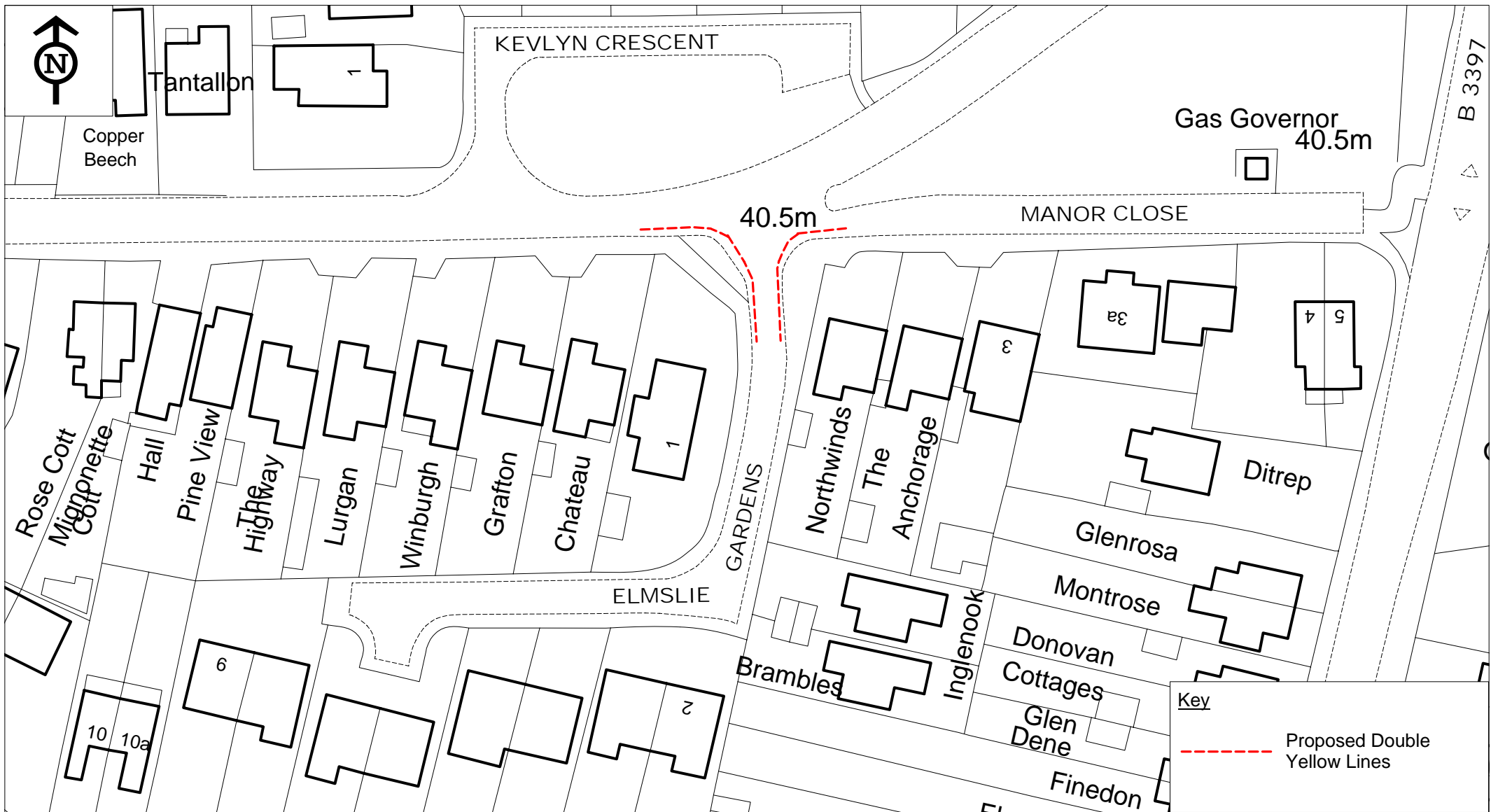

TM01/01371/5 Elmslie Gardens

© Crown copyright. All rights reserved
 Eastleigh Borough Council
 Licence No. 100019622 (2013)

SCALE	1 : 750
DATE	04/07/2014
DRAWING No.	
DRAWN BY	
CHECKED BY	

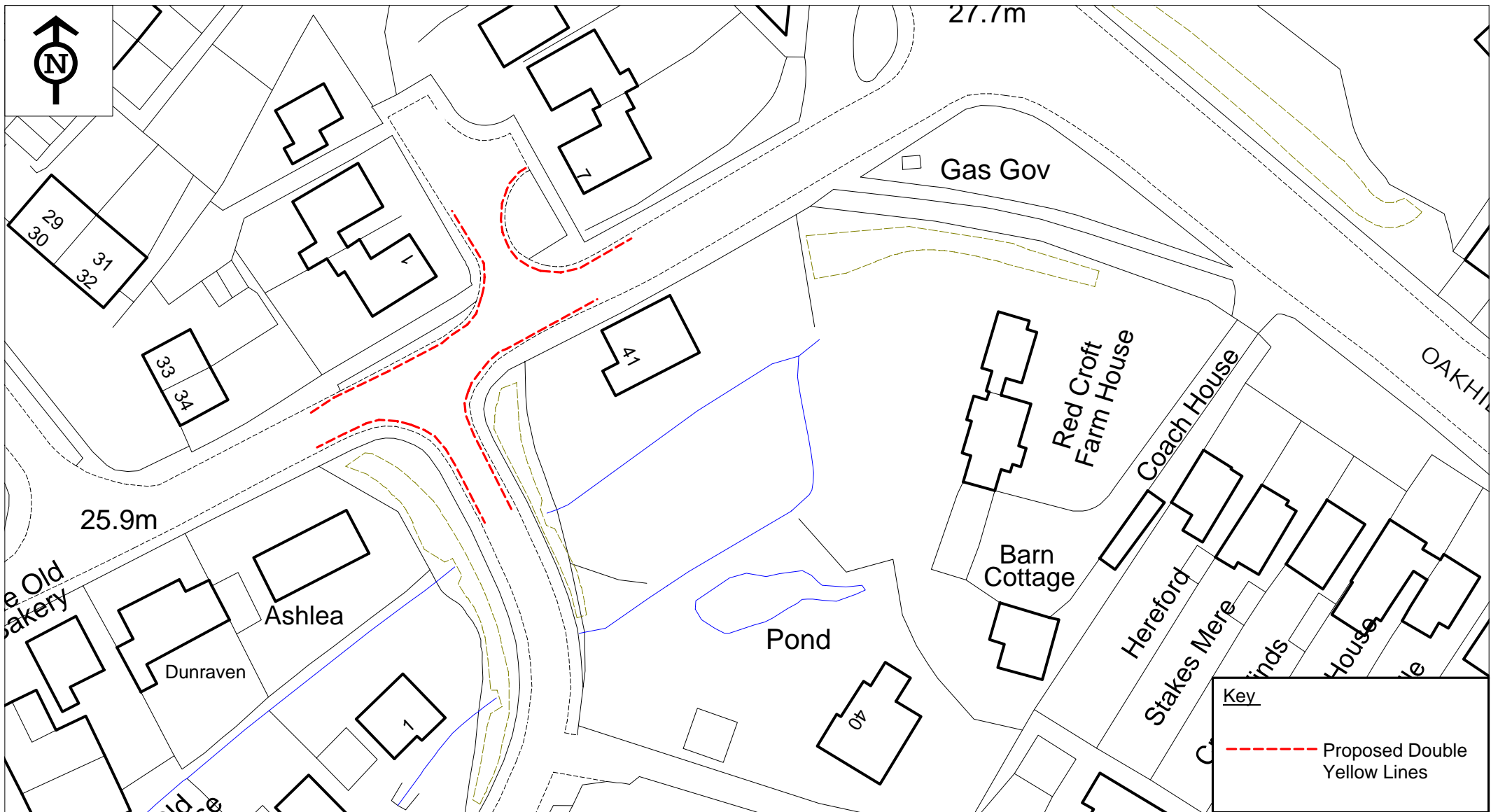

TM01/01371/6 Forge Close and Redcroft Lane

© Crown copyright. All rights reserved
 Eastleigh Borough Council
 Licence No. 100019622 (2013)

SCALE	1 : 750
DATE	04/07/2014
DRAWING No.	
DRAWN BY	
CHECKED BY	

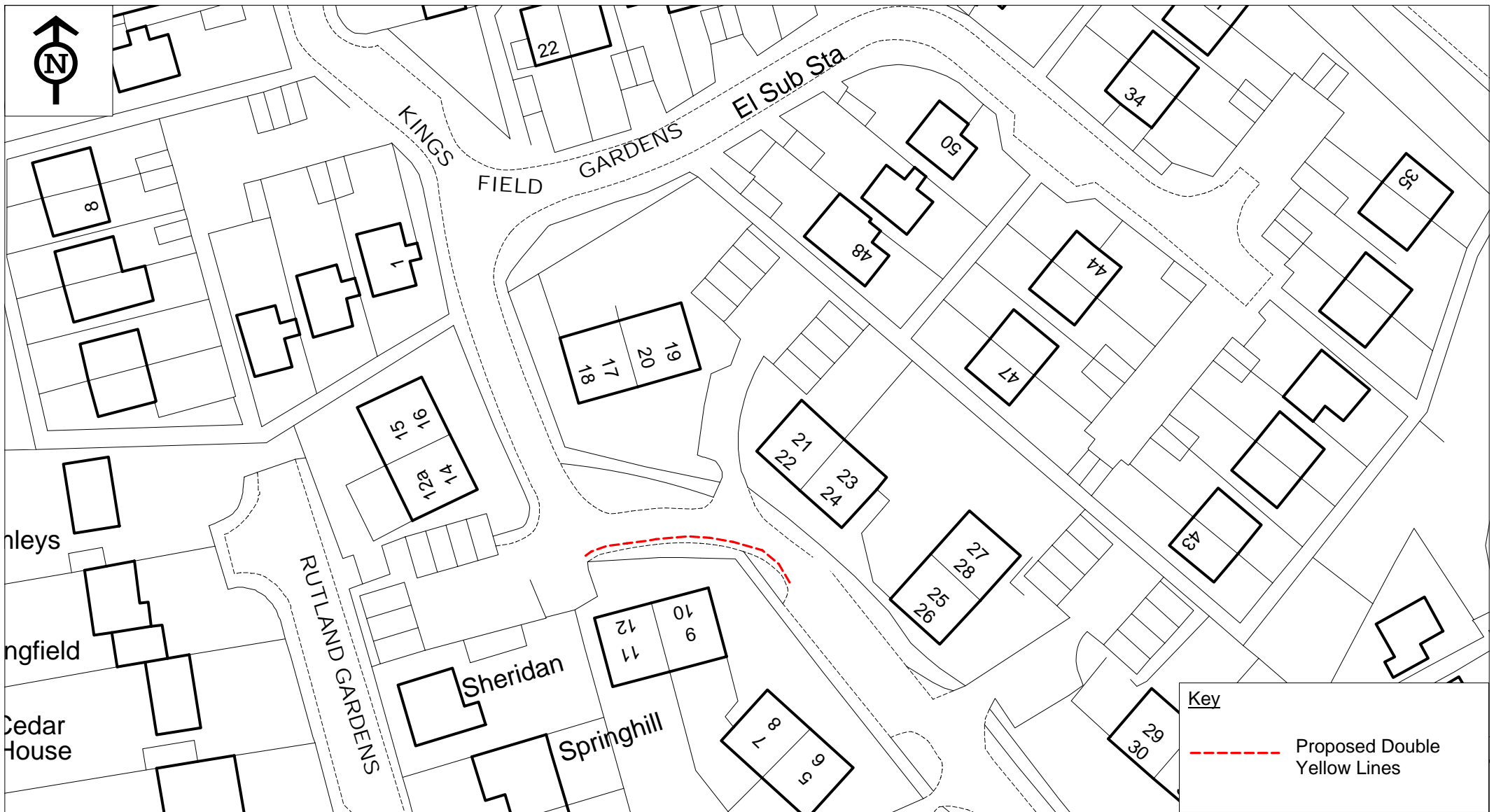

TM01/01371/7 Kings Field

© Crown copyright. All rights reserved
 Eastleigh Borough Council
 Licence No. 100019622 (2013)

SCALE	1 : 750
DATE	04/07/2014
DRAWING No.	
DRAWN BY	
CHECKED BY	



TM01/01371/7 Woolston Rd (Roll Call)

© Crown copyright. All rights reserved
 Eastleigh Borough Council
 Licence No. 100019622 (2013)

Key	
-----	Proposed Double Yellow Lines
SCALE	1 : 750
DATE	04/07/2014
DRAWING No.	
DRAWN BY	
CHECKED BY	

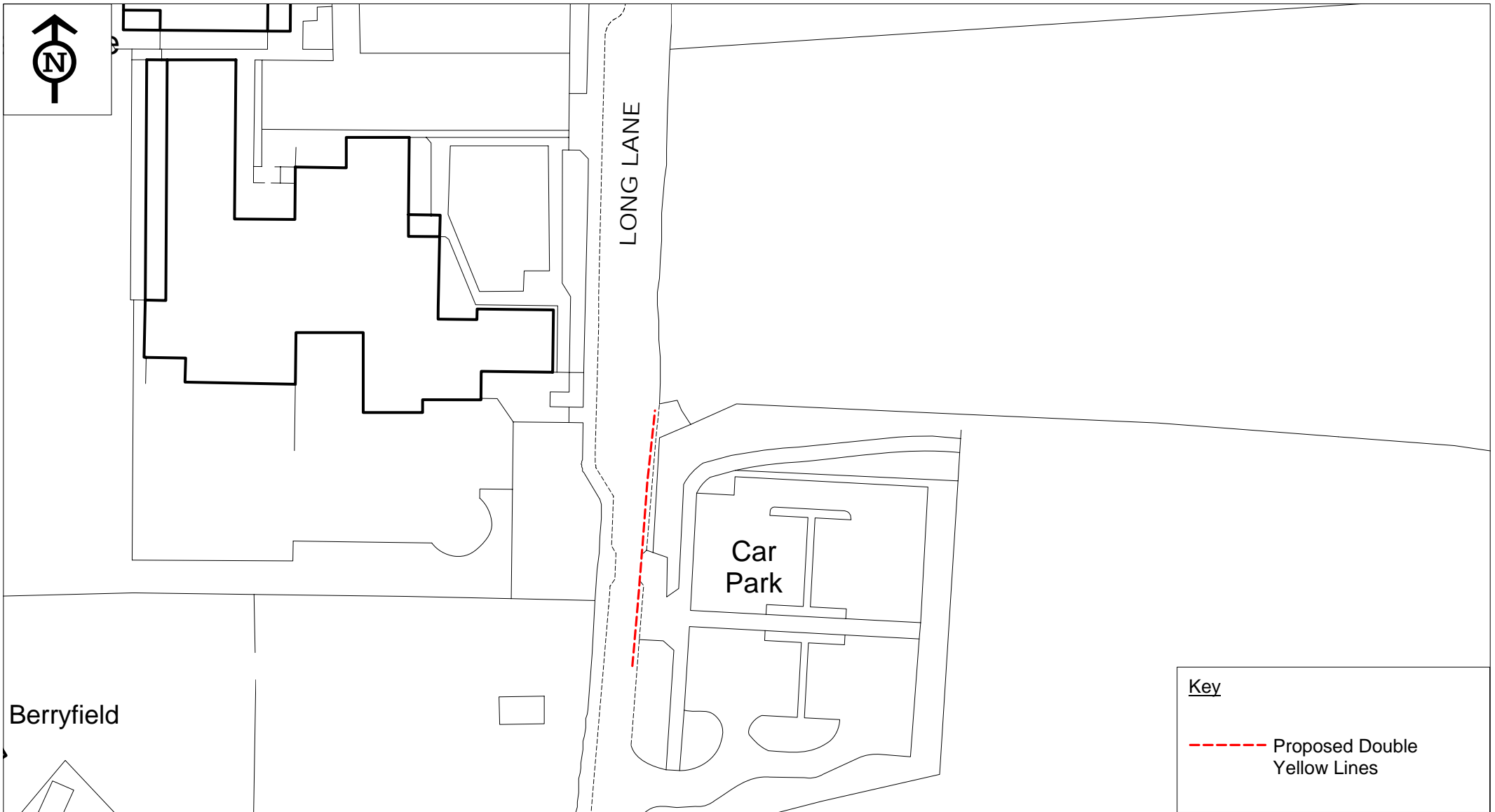

Berryfield

Car
Park

LONG LANE

Key

----- Proposed Double Yellow Lines



TM01/01371/8 Long Lane

© Crown copyright. All rights reserved
 Eastleigh Borough Council
 Licence No. 100019622 (2013)

SCALE	1 : 750
DATE	04/07/2014
DRAWING No.	
DRAWN BY	
CHECKED BY	



Key	
	Proposed Double Yellow Lines



TM01/01371/9 Pound Road

© Crown copyright. All rights reserved
 Eastleigh Borough Council
 Licence No. 100019622 (2013)

SCALE	1 : 750
DATE	04/07/2014
DRAWING No.	
DRAWN BY	
CHECKED BY	