

THE BOROUGH OF EASTLEIGH (CHANDLERS FORD AND  
HILTINGBURY) (PROHIBITION AND RESTRICTION OF WAITING)  
(DISABLED PERSONS PARKING PLACES)  
(AMENDMENT NO.13) ORDER 2013

The Council of the Borough of Eastleigh (hereinafter referred to as "the Council") pursuant to arrangements made under Section 19 of the Local Government Act 2000 with the Hampshire County Council in exercise of the powers of the said County Council under Sections 1, 2 and 4 of the Road Traffic Regulation Act 1984 ("the Act") and Part IV of Schedule 9 to the Act, and of all other enabling powers, and after consultation with the Chief Officer of Police in accordance with Part III of Schedule 9 to the Act hereby makes the following Order:-

Commencement and Citation

1. This Order shall come into operation on 16 December 2013 and may be cited as the "Borough of Eastleigh (Chandlers Ford and Hiltingbury) (Prohibition and Restriction of Waiting) (Disabled Persons Parking Places) (Amendment No.13) Order 2013".

Prohibition and Restriction of Waiting

2. In this Order the Principal Order means The Borough of Eastleigh (Chandlers Ford and Hiltingbury) (Prohibition and Restriction of Waiting) (Disabled Persons Parking Places) Order 2004
3. The Principal Order is hereby amended as follows:

- (a) In the Sixth Schedule (Areas on the Highway Designated as Disabled Persons Parking Places) after item A (relating to Avon Green) the following shall be inserted:

Avon Green	South-west	From a point 1 metre north-west of the south-eastern property boundary of No.20 Avon Green north-westwards for a distance of 6.6 metres.	Within the bay marked by white lines	Disabled Persons Vehicles	All Day	All Hours
------------	------------	--	--------------------------------------	---------------------------	---------	-----------

- (b) In the Sixth Schedule (Areas on the Highway Designated as Disabled Persons Parking Places) item number 1 (relating to Beresford Road) shall be revoked and replaced with:

Chalvington Road	North-east	From a point 1 metre north-west of the south-eastern property boundary of No.17 Chalvington Road north-westwards for a distance of 6.6 metres.	Within the bay marked by white lines	Disabled Persons Vehicles	All Day	All Hours
------------------	------------	--	--------------------------------------	---------------------------	---------	-----------

(c) In the Sixth Schedule (Areas on the Highway Designated as Disabled Persons Parking Places) after item number 1A (relating to Cumberland Avenue) the following shall be inserted:

1B	Kerry Close	South-west	The easternmost of the parking bays on the south-western side of the turning head at the northern end of Kerry Close.	Within the bay marked by white lines	Disabled Persons Vehicles	All Day	All Hours
----	-------------	------------	---	--------------------------------------	---------------------------	---------	-----------

(d) In the Sixth Schedule (Areas on the Highway Designated as Disabled Persons Parking Places) item number 3 (relating to Meon Crescent) shall be revoked;

(e) In the Sixth Schedule (Areas on the Highway Designated as Disabled Persons Parking Places) after item number 4 (relating to Milford Gardens) the following shall be inserted:

4A	Pantheon Road	West	From the northern property boundary of No.3 Pantheon Road southwards for a distance of 6.6 metres.	Within the bay marked by white lines	Disabled Persons Vehicles	All Day	All Hours
----	---------------	------	--	--------------------------------------	---------------------------	---------	-----------

4B	Porteous Crescent	South-west	From the south-eastern property boundary of No.10 Porteous Crescent north-westwards for a distance of 6.6 metres.	Within the bay marked by white lines	Disabled Persons Vehicles	All Day	All Hours
----	-------------------	------------	---	--------------------------------------	---------------------------	---------	-----------

4C	Purkess Close	South-east	From the north-eastern property boundary of No.27 Purkess Close south-westwards for a distance of 6.6 metres.	Within the bay marked by white lines	Disabled Persons Vehicles	All Day	All Hours
----	---------------	------------	---	--------------------------------------	---------------------------	---------	-----------

(f) In the Sixth Schedule (Areas on the Highway Designated as Disabled Persons Parking Places) after item number 5 (relating to Ribble Close) the following shall be inserted:

6.	Warren Avenue	East	From a point 20 metres south of its junction with Saxon Walk southwards for a distance of 6.6 metres.	Within the bay marked by white lines	Disabled Persons Vehicles	All Day	All Hours
----	---------------	------	---	--------------------------------------	---------------------------	---------	-----------



Dated this 4<sup>th</sup> day of December 2013

THE COMMON SEAL of EASTLEIGH  
BOROUGH COUNCIL was hereunto  
affixed in the presence of:-

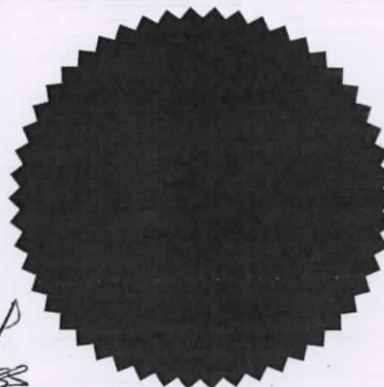

  
ASST

Head of Legal & Democratic Services

THE BOROUGH OF EASTLEIGH  
COUNCIL  
COUNCIL CHAMBERS  
100, SOUTHAMPTON ROAD  
EASTLEIGH, HANTS  
SO50 5YH

A R Ward  
Head of Legal & Democratic Services  
Eastleigh Borough Council  
Civic Offices  
Loph Road  
Eastleigh  
Hampshire  
SO50 5YH

DATED 4<sup>th</sup> December 2013

BOROUGH OF EASTLEIGH

THE BOROUGH OF EASTLEIGH  
(CHANDLERS FORD AND  
HILTINBURY) (PROHIBITION AND  
RESTRICTION OF WAITING)  
(DISABLED PERSONS PARKING  
PLACES) (AMENDMENT NO.13)  
ORDER 2013

A R Ward  
Head of Legal & Democratic Services  
Eastleigh Borough Council  
Civic Offices  
Leigh Road  
Eastleigh  
Hampshire  
SO50 9YN

U:\Legal & Democratic Services\Democratic  
Services\COMADMIN\TRAFFORDS\DECRIM\NONCPZ\PARISHES\CFHAMEND  
NO.X- CFH DPPB REVIEW 2012\CFH DPPB REVIEW 2012 ORDER.DOC

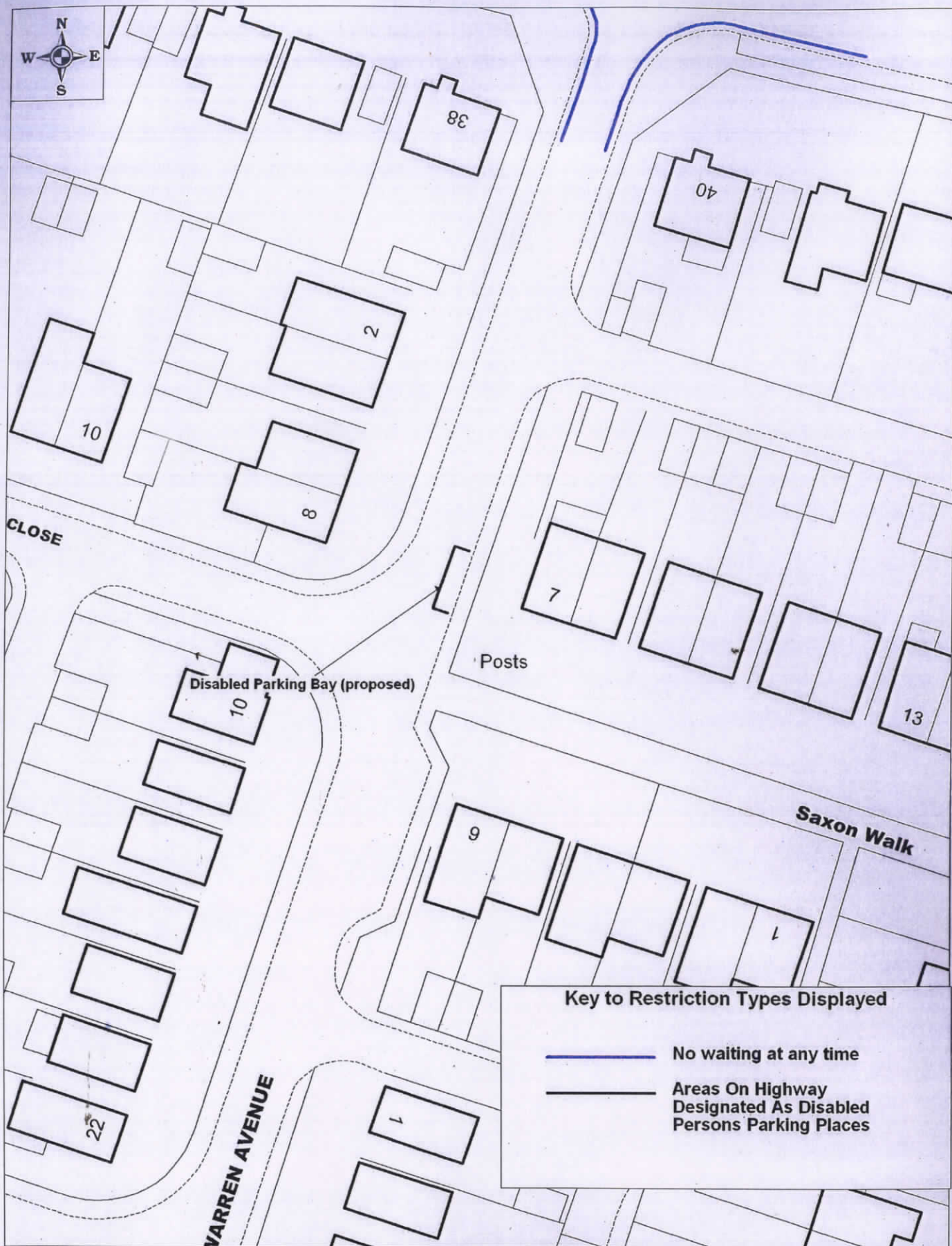



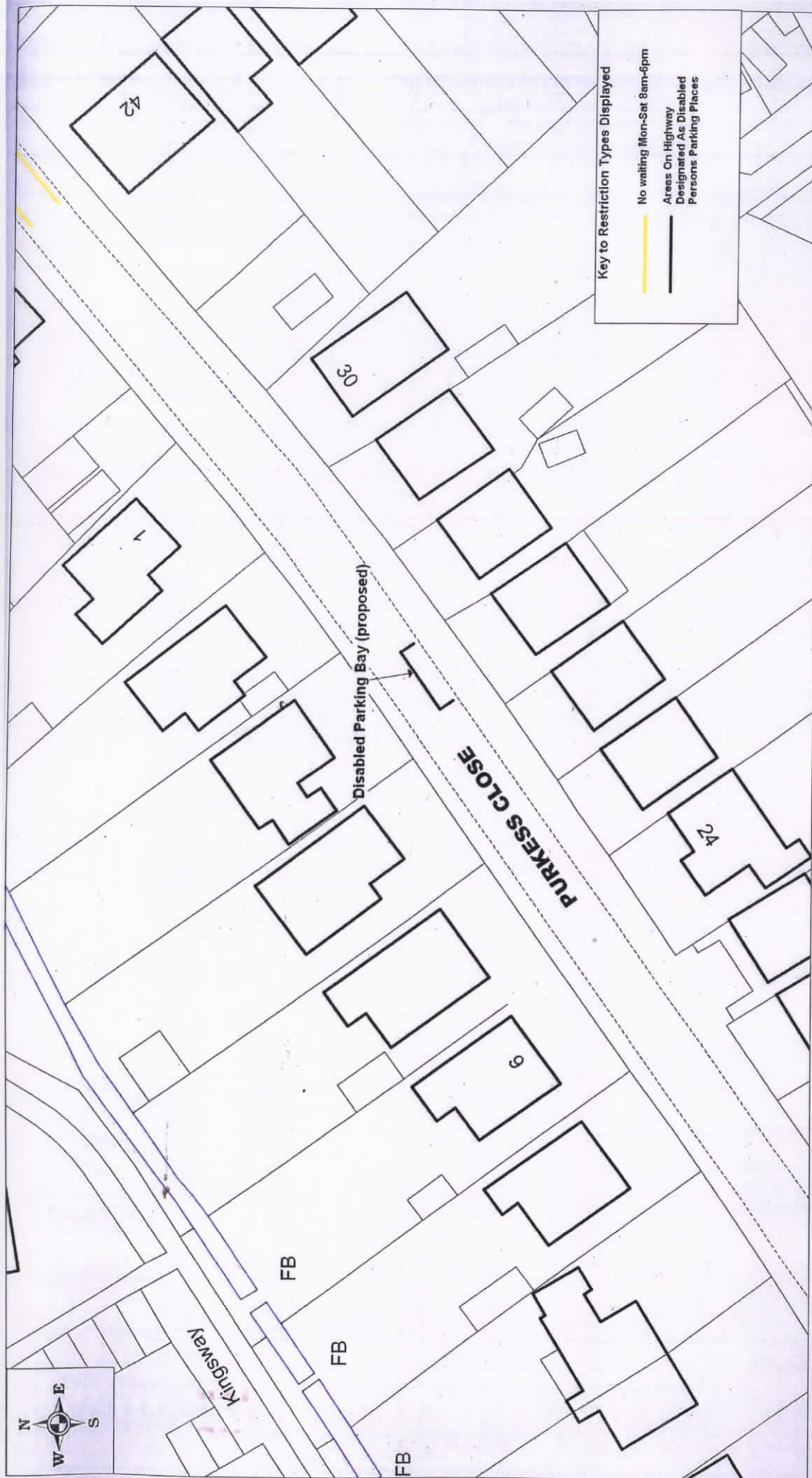

<b>Purkess Close: Disabled Parking Bay</b>  © Crown copyright. All rights reserved Eastleigh Borough Council Licence No. 100019622 (2013)		SCALE	1 : 500
		DATE	28/08/2013
		DRAWING No.	TM01/1138/6
		DRAWN BY	PJH
		CHECKED BY	SRW

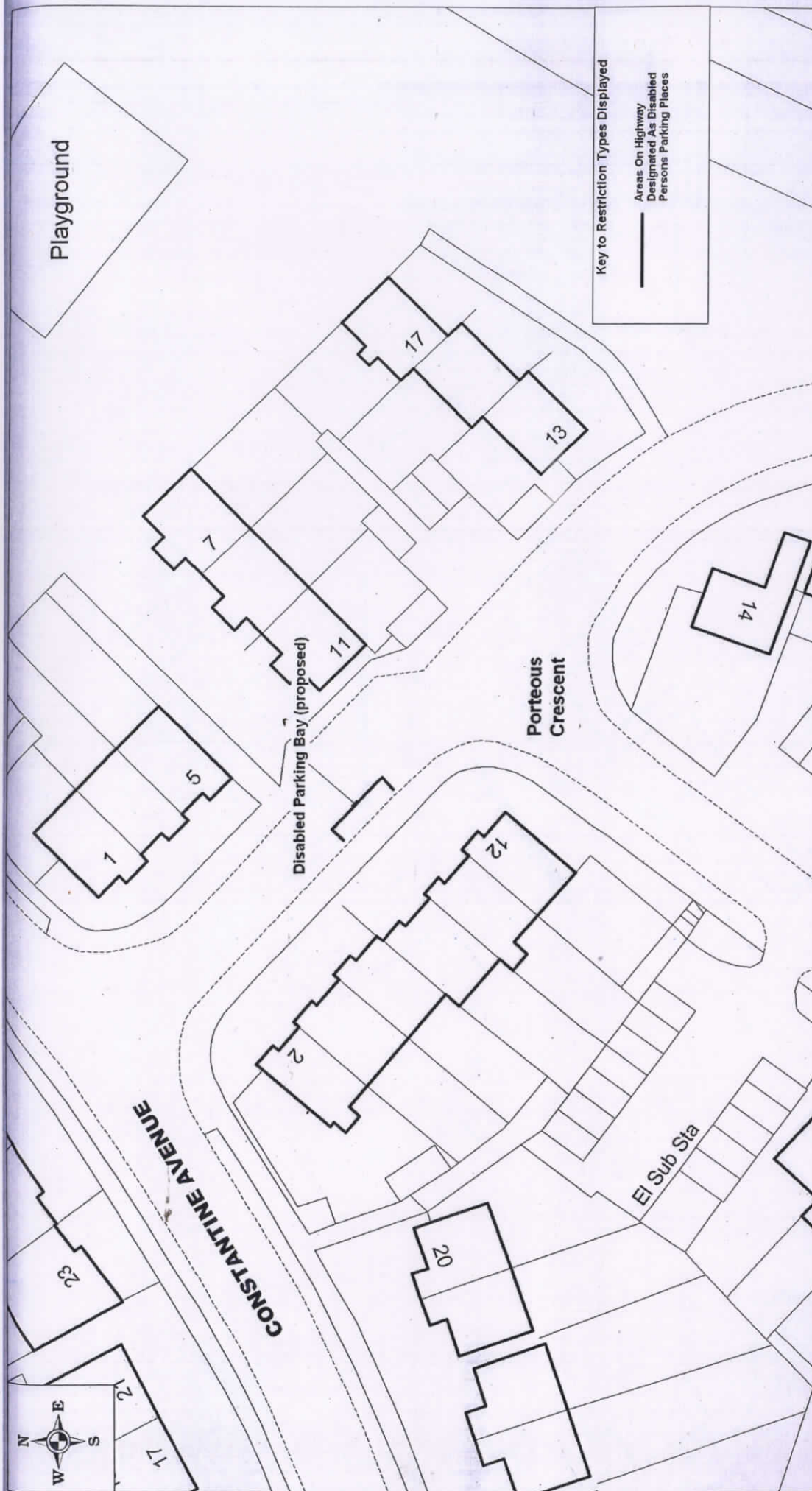

<p>Porteous Crescent: Disabled Parking Bay</p> <p>© Crown copyright, All rights reserved Eastleigh Borough Council Licence No. 100019622 (2013)</p>		SCALE	1 : 500
		DATE	28/08/2013
		DRAWING No.	TM01/1138/5
		DRAWN BY	PJH
		CHECKED BY	SRW

**EASTLEIGH**  
BOROUGH COUNCIL



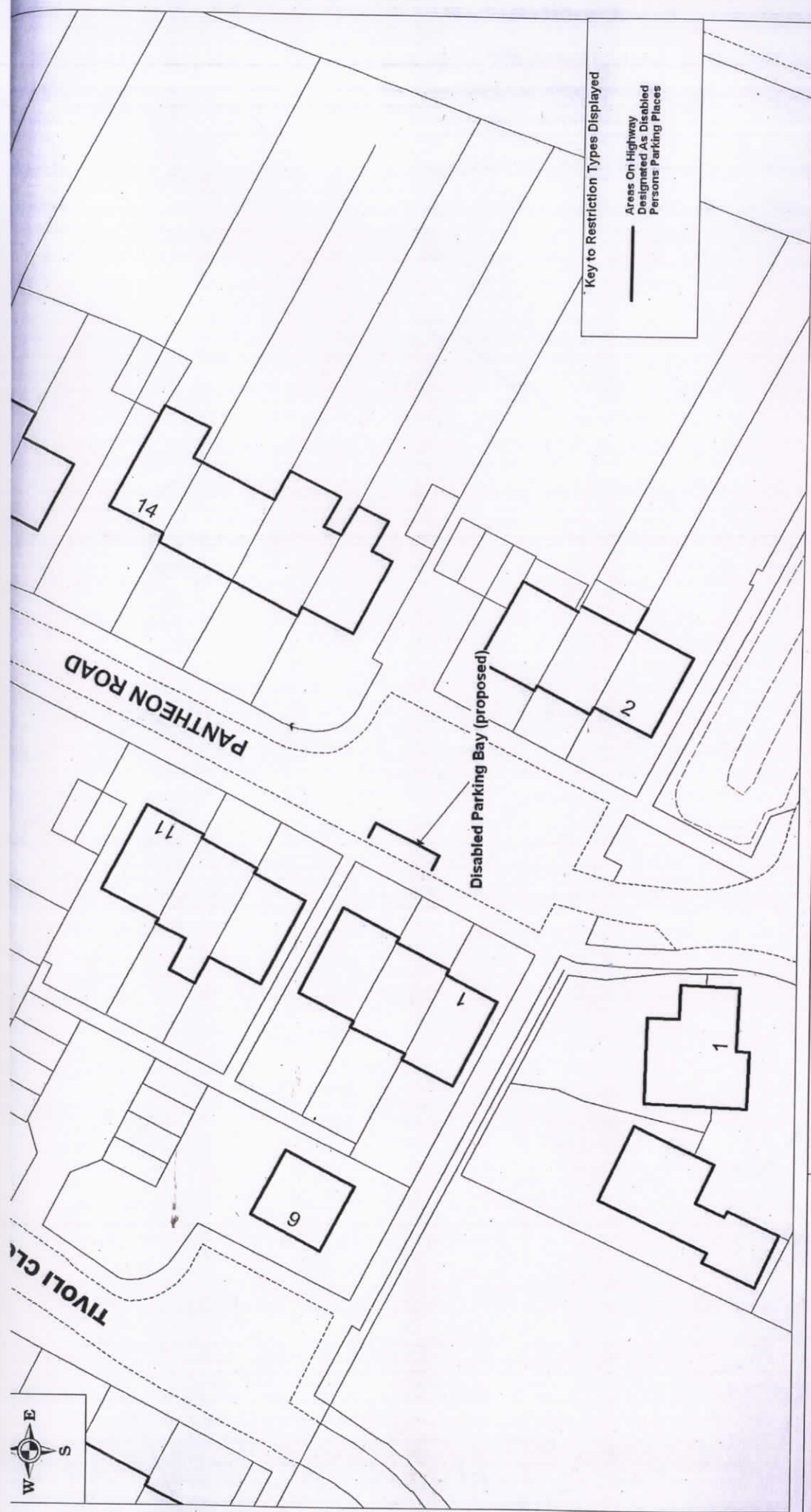

Key to Restriction Types Displayed

— Areas On Highway Designated As Disabled Persons Parking Places

SCALE	1 : 500
DATE	28/08/2013
DRAWING No.	TM01/1138/4
DRAWN BY	PJH
CHECKED BY	SRW

Pantheon Road: Disabled Parking Bay



© Crown copyright. All rights reserved  
Eastleigh Borough Council  
Licence No. 100019622 (2013)



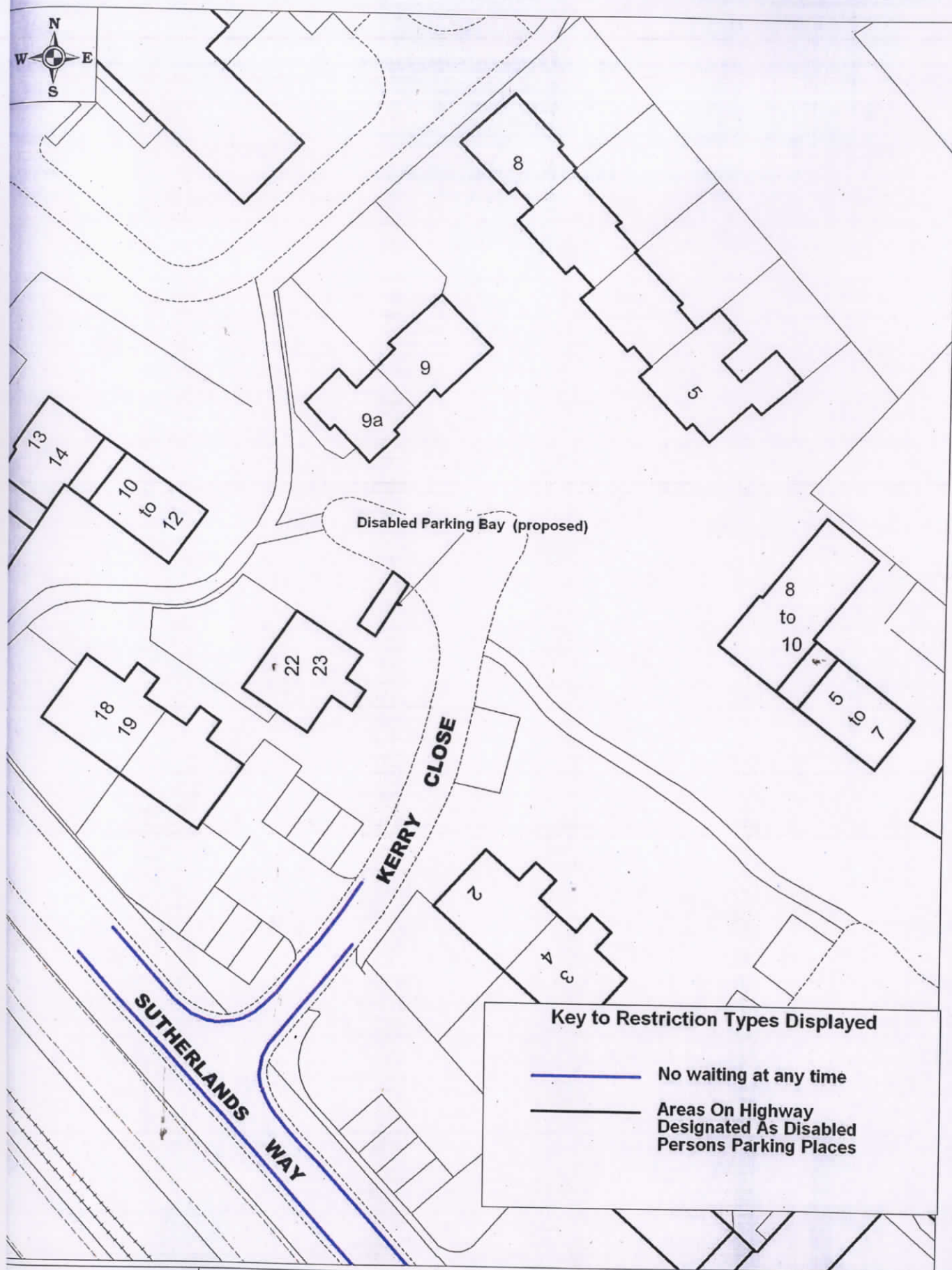



#### Key to Restriction Types Displayed

-  No waiting at any time
-  Areas On Highway Designated As Disabled Persons Parking Places

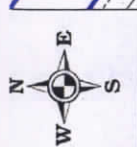

**Key to Restriction Types Displayed**

- No waiting at any time
- Areas On Highway Designated As Disabled Persons Parking Places



Chalvington Road: Disabled Parking Bay

© Crown copyright. All rights reserved  
Eastleigh Borough Council  
Licence No. 100019622 (2013)

SCALE	1 : 500
DATE	28/08/2013
DRAWING No.	TM01/1138/2
DRAWN BY	PJH
CHECKED BY	SRW





SCALE	1 : 500
DATE	28/08/2013
DRAWING No.	TM01/1138/1
DRAWN BY	PJH
CHECKED BY	SRW

### Avon Green: Disabled Parking Bay

© Crown copyright. All rights reserved  
 Eastleigh Borough Council  
 Licence No. 100019622 (2013)

**EASTLEIGH**  
 BOROUGH COUNCIL