

THE BOROUGH OF EASTLEIGH (HIGH STREET AND MARKET STREET,
EASTLEIGH) (ON-STREET PAY AND DISPLAY PARKING BAYS)
EXPERIMENTAL ORDER 2013

The Council of the Borough of Eastleigh (hereinafter referred to as "the Council") pursuant to arrangements made under Section 19 of the Local Government Act 2000 with the Hampshire County Council in exercise of the powers of the said County Council under Sections 9 and 10 of the Road Traffic Regulation Act 1984 ("the Act") and of all other enabling powers after consultation with the Chief Officer of Police in accordance with Part III of Schedule 9 to the Act hereby makes the following Order:-

PART 1- GENERAL

Commencement and Citation

1. This Order shall come into operation on 2 December 2013 and may be cited as "The Borough of Eastleigh (High Street and Market Street, Eastleigh) (On-Street Pay and Display Parking Bays) Experimental Order 2013".

Interpretation

2. In this Order the Principal Order means The Borough of Eastleigh (Eastleigh Town Centre) Consolidation Order 2013.
3. The Head of Legal and Democratic Services at the Council may modify or suspend the operation of this order or any provision contained in it in accordance with section 10 of the Act.

4. The Principal Order is hereby amended as follows:

- (a) In Article 2(1) in the definitions of 'charged parking place'; 'chargeable hours'; 'parking charge' and 'parking period' after the words 'Schedules 2, 2.1' the following shall be inserted '2.2';

- (b) In Article 4(1) after the words 'Schedules 2, 2.1' the following shall be inserted '2.2';

- (c) In Article 4(2) after the words 'Schedules 2, 2.1' the following shall be inserted '2.2';

- (d) After Article 6 the following shall be inserted:

6A. (1) Each of the parts of road specified in Schedule 2.3 is to be used subject to the following provisions of this Order and are hereby designated as parking places on such days and during such hours as are specified in that Schedule in relation to that part of the road in the said Schedule.

(2) Nothing in paragraph (1) of this Article shall restrict the power of the Council to close any parking place.

6B. Save as provided in Articles 14 and 35 of this Order no person shall, except on direction or with the permission of a Police Constable in uniform or a civil enforcement officer cause or permit any vehicle to wait between the hours of 3.00pm and 6.00pm in a parking places described in Schedule 2.3 unless it is a vehicle of appropriate class for that parking place and unless the vehicle displays in the relevant position at all times whilst so parked a parking ticket issued by the ticket machine relating to the parking place in which the vehicle has been left.

6C. Save as provided in Articles 14 and 35 of this Order no person shall except upon the direction or with the permission of a Police Constable in uniform or a civil enforcement officer cause or permit any vehicle to wait between the hours of 8.00am and 3.00pm on any day other than a Saturday or Sunday or between the hours of 8.00am and 6.00pm on a Saturday on the sides of roads or in the lengths of roads specified Schedule 2.2 to this Order-

- (a) for a longer period than 1 hour; or
- (b) if a period of less than 2 hours have elapsed since the termination during the said hours of the last period of waiting (if any) of the vehicle on those sides of roads or in those lengths of roads.

6D. Save as provided in Articles 14 and 35 of this Order no person shall except upon the direction or with the permission of a Police Constable in uniform or a civil enforcement officer cause or permit any vehicle to wait between the hours of 3.00pm and 6.00pm on any day other than a Saturday or Sunday on the sides of roads or in the lengths of roads specified Schedule 2.3 to this Order-

- (a) for a longer period than 1 hour; or
- (b) if a period of less than 2 hours have elapsed since the termination during the said hours of the last period of waiting (if any) of the vehicle on those sides of roads or in those lengths of roads.

(e) In Articles 14 and 35 after the words 'Articles 5,' the following shall be inserted '6B, 6C, 6D';

(f) In the Schedule 2 (Pay & Display Parking [One Hour Maximum Stay No Return Within Two Hours] Monday – Saturday 8.00am – 6.00pm) items numbered 5, 6, 7, 9, 10 and 11 (relating to High Street and Market Street) shall be revoked;

(g) After Schedule 2.1 (Pay & Display Parking [Ten hour maximum stay no return within five hours] [Monday to Friday 8.00am – 6.00pm]) there shall be inserted:

SCHEDULE 2.2

Pay & Display Parking (One Hour Maximum Stay No Return Within Two Hours)
Monday to Friday 8.00am – 3.00pm and Saturday 8.00am – 6.00pm

	Road	Side	Description	Parking Charge
1.	High Street	East	From a point 160 metres north of the junction with Wells Place northwards for a distance of 12 metres.	60p for 30 minutes £1.30 for 60 minutes
2.	High Street	West	From a point 64 metres south of the junction with Leigh Road to a point 90 metres north of the junction with Wells Place.	60p for 30 minutes £1.30 for 60 minutes
3.	High Street	West	From a point 14 metres north of the junction with Wells Place northwards for a distance of 50 metres.	60p for 30 minutes £1.30 for 60 minutes
4.	Market Street	West	From a point 32 metres south of its junction with Leigh Road southwards for a distance of 28 metres.	60p for 30 minutes £1.30 for 60 minutes
5.	Market Street	West	From a point 72 metres south of its junction with Leigh Road southwards for a distance of 42 metres.	60p for 30 minutes £1.30 for 60 minutes
6.	Market Street	East	From a point 15 metres north of the junction with Wells Place northwards for a distance of 47 metres.	60p for 30 minutes £1.30 for 60 minutes

SCHEDULE 2.3

Pay & Display Parking (One Hour Maximum Stay No Return Within Two Hours)
Monday to Friday 3.00pm – 6.00pm

	Road	Side	Description	Parking Charge
1.	High Street	East	From a point 160 metres north of the junction with Wells Place northwards for a distance of 12 metres.	Free for up to one hour
2.	High Street	West	From a point 64 metres south of the junction with Leigh Road to a point 90 metres north of the junction with Wells Place.	Free for up to one hour
3.	High Street	West	From a point 14 metres north of the junction with Wells Place northwards for a distance of 50 metres.	Free for up to one hour

- | | | | | |
|----|---------------|------|---|-------------------------|
| 4. | Market Street | West | From a point 32 metres south of its junction with Leigh Road southwards for a distance of 28 metres. | Free for up to one hour |
| 5. | Market Street | West | From a point 72 metres south of its junction with Leigh Road southwards for a distance of 42 metres. | Free for up to one hour |
| 6. | Market Street | East | From a point 15 metres north of the junction with Wells Place northwards for a distance of 47 metres. | Free for up to one hour |

DATED the 22nd day of November 2013

THE COMMON SEAL of EASTLEIGH)

BOROUGH COUNCIL was hereunto)

affixed in the presence of:-

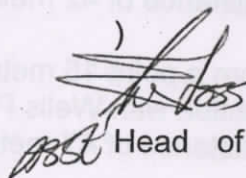

Head of Legal & Democratic Services

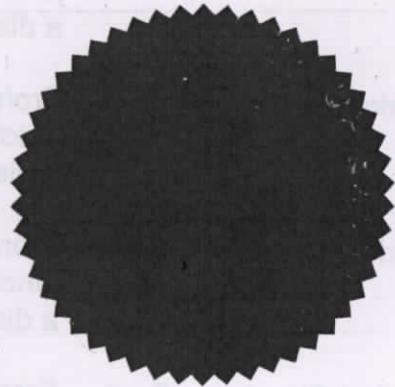

DATED: 20 November 2013

THE BOROUGH OF EASTLEIGH (HIGH
STREET AND MARKET STREET,
EASTLEIGH) (ON-STREET PAY AND
DISPLAY PARKING BAYS)
EXPERIMENTAL ORDER 2013

A R Ward
Head of Legal and Democratic Services
Civic Offices
Leigh Road
EASTLEIGH
SO50 9YN

U:\Legal & Democratic Services\Democratic
Services\COMADMIN\TRAFORDS\DECRIM\EXPERIMENTAL
S\HIGH STREET & MARKET STREET P&D\HIGH STREET &
MARKET STREET P&D ORDER.doc

Key to Restriction Types Displayed



Pav & Display parking Mon - Fri 1hr Free
from 3pm, 1 hour maximum stay, no return
within 2 hours

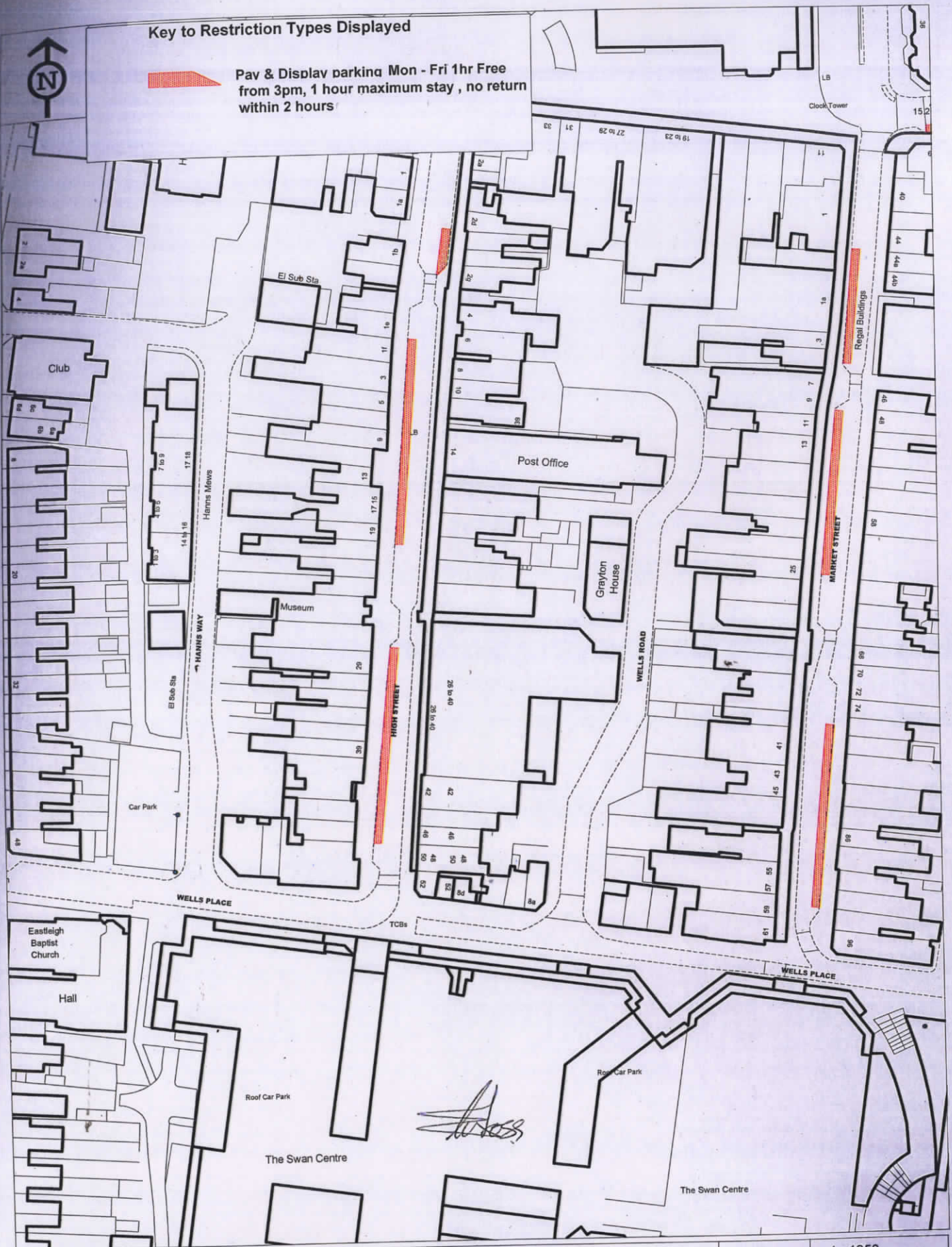

EASTLEIGH
BOROUGH COUNCIL

High Street & Market Street - pay and display
© Crown copyright. All rights reserved
Eastleigh Borough Council
Licence No. 100019622 (2013)

SCALE	1 : 1250
DATE	05/11/2013
DRAWING No.	
DRAWN BY	JF
CHECKED BY	