

THE BOROUGH OF EASTLEIGH (BURSLEDON, HAMBLE-LE-RICE AND  
HOUND) (AMENDMENT NO.2) ORDER 2013

The Council of the Borough of Eastleigh (hereinafter referred to as "the Council") pursuant to arrangements made under Section 19 of the Local Government Act 2000 with the Hampshire County Council in exercise of the powers of the said County Council under Sections 1, 2 and 4 of the Road Traffic Regulation Act 1984 ("the Act") and Part IV of Schedule 9 to the Act and of all other enabling powers, and after consultation with the Chief Officer of Police in accordance with Part III of Schedule 9 to the Act hereby makes the following Order:-

Commencement and Citation

1. This Order shall come into operation on 25 March 2013 and may be cited as the "Borough of Eastleigh (Bursledon, Hamble-le-Rice and Hound) (Amendment No.2) Order 2013".

Prohibition and Restriction of Waiting

2. In this Order the Principal Order means The Borough of Eastleigh (Bursledon, Hamble-le-Rice and Hound) Consolidation Order 2012.

3. The Principal Order is hereby amended as follows:

- (a) After Article 23 the following shall be inserted:

23A. Save as provided in Articles 31 and 33 of this Order no person shall except upon the direction or with the permission of a Police Constable in uniform or a civil enforcement officer cause or permit any vehicle to wait between the hours of 8.00am and 6.00pm on any day other than a Sunday on the sides of roads or in the lengths of roads specified in the Twenty Second Schedule to this Order-

- (a) for a longer period than 2 and a half hours; or
- (b) if a period of less than 3 hours has elapsed since the termination during the said hours of the last period of waiting (if any) of the vehicle on those sides of roads or in those lengths of roads.

- (b) In Articles 31 and 33 after the words "Nothing in Articles 21, 22, 23" the following shall be inserted "23A";

- (c) In the Fourth Schedule (No Waiting at Any Time) after item number 5 (relating to Bridge Road) there shall be inserted:

- |     |             |               |   |
|-----|-------------|---------------|---|
| 5A. | Bridge Road | South<br>East | From its junction with Yachtsman Close in a north westerly direction for a distance of 10 metres. |
| 5B. | Bridge Road | South<br>East | From its junction with Yachtsman Close in a south easterly direction for a distance of 2 metres.  |

(d) In the Fourth Schedule (No Waiting at Any Time) after item number 52 (relating to Kings Avenue) there shall be inserted:

52A.	Kings Field	Both Sides	From its junction with Portsmouth Road in a north westerly direction for a distance of 10 metres.
------	-------------	---------------	---

(e) In the Fourth Schedule (No Waiting at Any Time) after item number 71 (relating to New Road) there shall be inserted:

71A.	New Road	North East	From its junction with Sea View Estate in a north westerly direction for a distance of 10 metres.
------	----------	---------------	---

71B.	New Road	North East	From its junction with Sea View Estate in a south easterly direction for a distance of 10 metres.
------	----------	---------------	---

(f) In the Fourth Schedule (No Waiting at Any Time) after item number 78 (relating to New Road) there shall be inserted:

78A.	Peewit Hill	Both Sides	From its junction with West End Road in a north easterly direction for a distance of 20 metres.
------	-------------	---------------	---

(g) In the Fourth Schedule (No Waiting at Any Time) after item number 79 (relating to Portsmouth Road) there shall be inserted:

79A.	Portsmouth Road	North West	From its junction with Kings Field in a north easterly direction for a distance of 15 metres.
------	-----------------	---------------	---

79B.	Portsmouth Road	North West	From its junction with Kings Field in a south westerly direction for a distance of 15 metres.
------	-----------------	---------------	---

79C.	Portsmouth Road	South West	From the western side of the unnamed access road into Veolia in a general northern and then north westerly direction for a distance of 39 metres.
------	-----------------	---------------	---

79D.	Portsmouth Road	South West	From the eastern side of the unnamed access road into Veolia in a general northern and then south easterly direction for a distance of 42 metres.
------	-----------------	---------------	---

(h) In the Fourth Schedule (No Waiting at Any Time) after item number 102 (relating to School Road) there shall be inserted:

102A.	Sea View Estate	Both Sides	From its junction with New Road in a north easterly direction for a distance of 10 metres.
-------	-----------------	---------------	--

(i) In the Fourth Schedule (No Waiting at Any Time) after item number 118 (relating to Sydney Avenue) there shall be inserted:

118A.	The Grove	Both Sides	From its junction with Woolston Road in a north easterly direction for a distance of 10 metres.
-------	-----------	---------------	---



- (j) In the Fourth Schedule (No Waiting at Any Time) items numbered 130, 131 and 133 (relating to Victoria Road) shall be revoked and replaced with:

130.	Victoria Road	South West	From its junction with Beach Lane in a north westerly direction to the entrance to the car park of Abbey Hall.
131.	Victoria Road	South West	From its junction with Beech Lane in a south easterly direction for a distance of 10 metres.
133.	Victoria Road	North East	From its junction with Grange Road in a south easterly direction for a distance of 20 metres.

- (k) In the Fourth Schedule (No Waiting at Any Time) after item number 136 (relating to Victoria Road) there shall be inserted:

136A.	West End Road	East	From its junction with Peewit Hill in a northerly direction for a distance 10 metres.
136B.	West End Road	East	From its junction with Peewit Hill in a southerly direction for a distance 54 metres.

- (l) In the Fourth Schedule (No Waiting at Any Time) after item number 138 (relating to Woolston Road) there shall be inserted:

138A.	Woolston Road	North East	From its junction with The Grove in a north westerly direction for a distance of 10 metres.
138B.	Woolston Road	North East	From its junction with The Grove in a south easterly direction for a distance of 10 metres.
138C.	Woolston Road	South West	Between points 5 metres north west and 8 metres south east (13 metres in total) from a point in line with and opposite the north western kerb line of The Grove.

- (m) In the Fourth Schedule (No Waiting at Any Time) after item number 139 (relating to Wykeham Road) there shall be inserted:

140.	Yachtsman Close	Northwest	From its junction with Bridge Road (A27) in a south westerly direction for a distance 12 metres.
141.	Yachtsman Close	Southeast	From its junction with Bridge Road (A27) In a South westerly direction following the curb line for a distance of 18 metres.

- (n) After the Twenty First Schedule there shall be inserted:

## TWENTY SECOND SCHEDULE

Waiting Limited to 2 Hours 30 Minutes Return Prohibited Within 3 Hours  
Monday to Saturday 8.00am to 6.00pm

	Road	Side	Description
1.	Coronation Parade	South West	Between points 3 metres and 14 metres north west of its junction with Coach Road.
2.	Coronation Parade	South West	Between points 6 metres and 38 metres south east of its junction with Kings Avenue.
3.	Coronation Parade	North East	Between point 4 metres north west of its junction with Coach Road and 10 metres south east of junction with Kings Avenue.

Dated this 15<sup>TH</sup> day of MARCH 2013

THE COMMON SEAL of EASTLEIGH )  
BOROUGH COUNCIL was hereunto )  
affixed in the presence of:- )



  
ABG

Head of Legal & Democratic Services



DATED 15 MARCH 2013

BOROUGH OF EASTLEIGH

THE BOROUGH OF EASTLEIGH  
(BURSLEDON, HAMBLE-LE-RICE  
AND HOUND) (AMENDMENT NO.2)  
ORDER 2013

A R Ward  
Head of Legal & Democratic Services  
Eastleigh Borough Council  
Civic Offices  
Leigh Road  
Eastleigh  
Hampshire  
SO50 9YN

U:\Legal & Democratic Services\Democratic  
Services\COMADMIN\TRAFFORDS\DECRIMNONCPZ\PARISHES\BHHAMEND  
NO.X VICTORIA ROAD\Final - Implemented\Victoria Road Order.doc

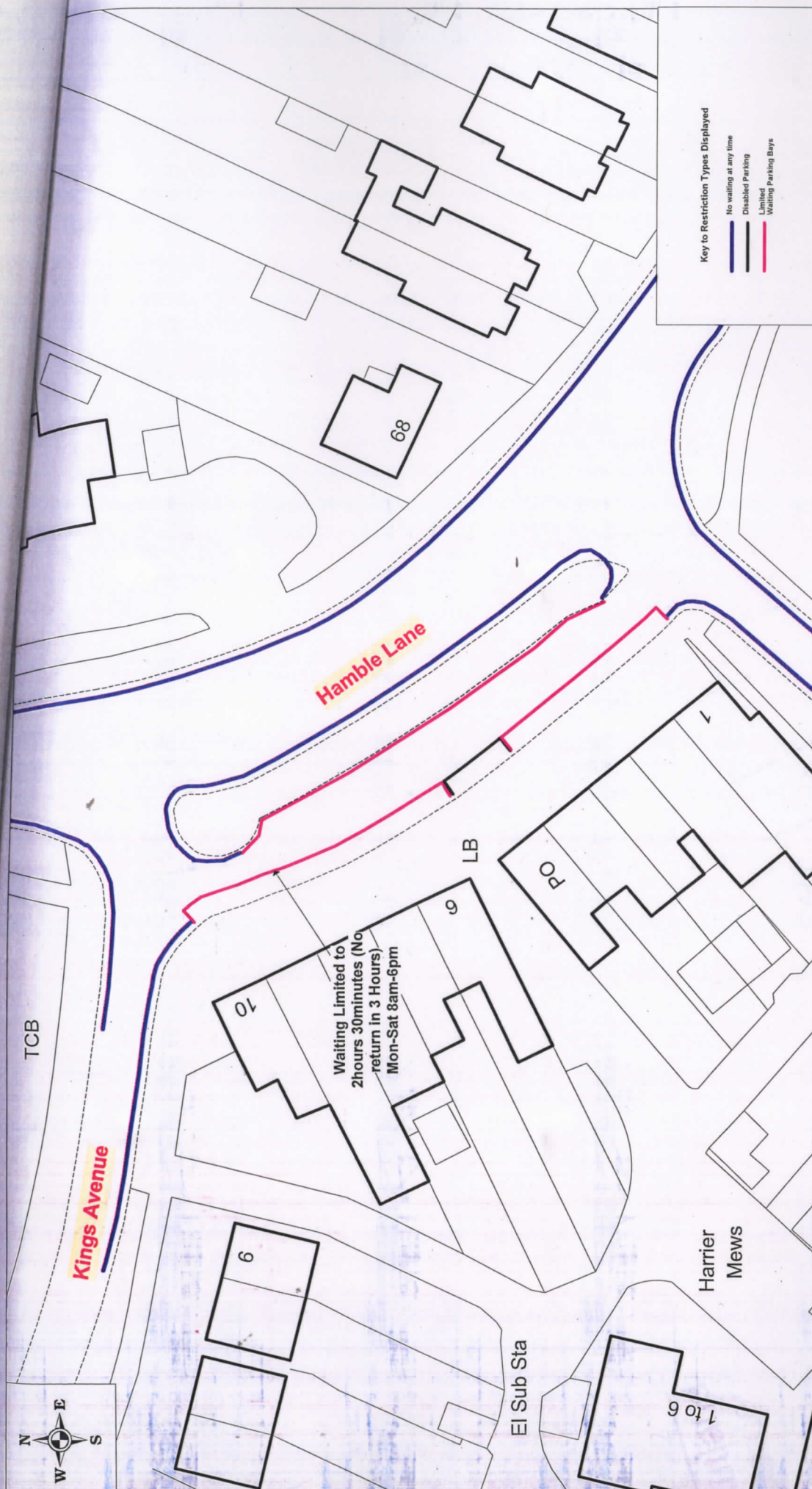

<b>EASTLEIGH</b> BOROUGH COUNCIL		SCALE	1 : 500
		DATE	11/03/2013
		DRAWING No.	E/TM/01/M/34/36
		DRAWN BY	KH
		CHECKED BY	JF

Coronation Parade

© Crown copyright. All rights reserved  
Eastleigh Borough Council  
Licence No. 100019622 (2006)



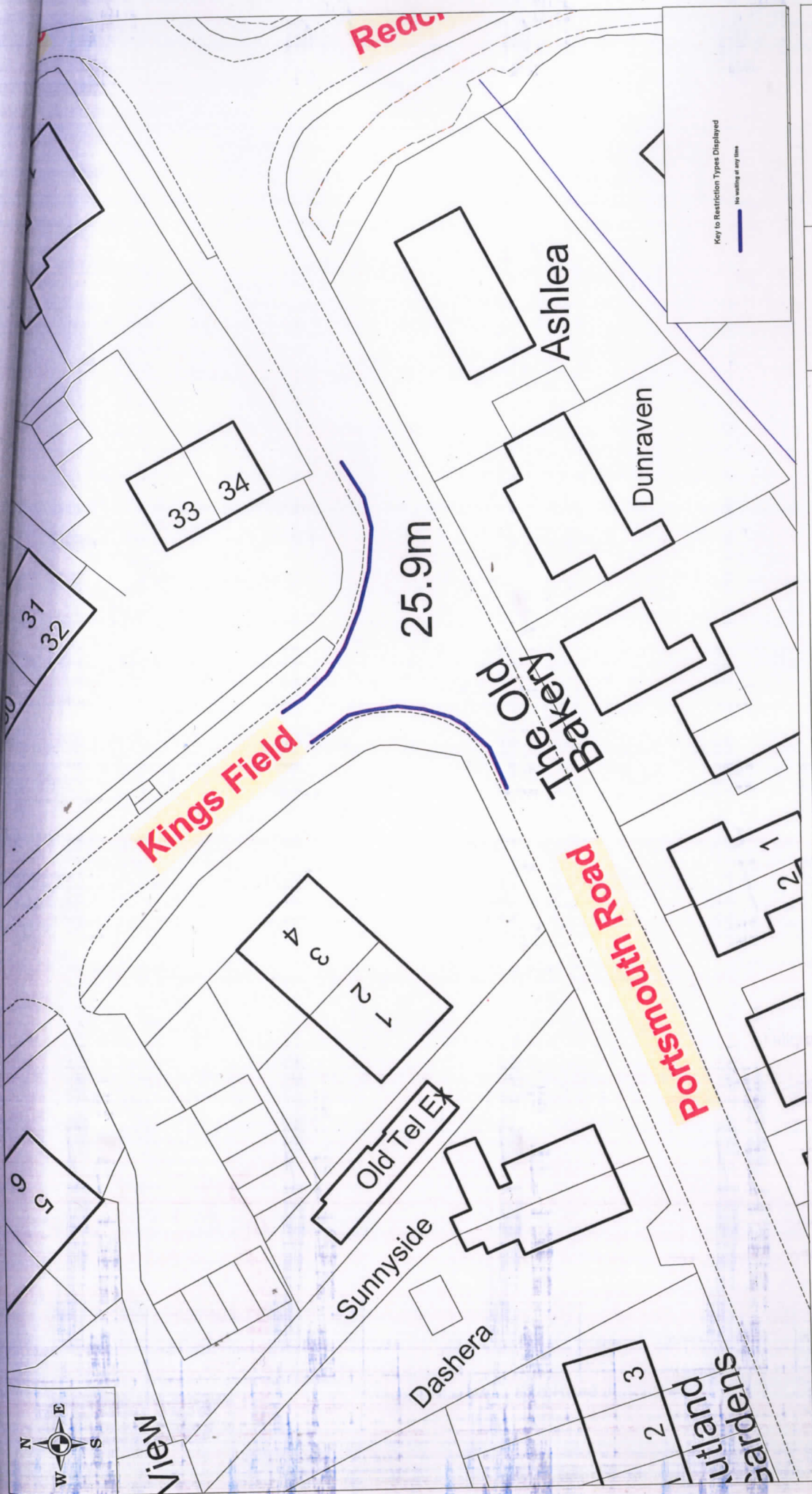

SCALE	1 : 500
DATE	11/03/2013
DRAWING No.	E/TM/01/M/34/25
DRAWN BY	KH
CHECKED BY	JF

Kings Field



© Crown copyright. All rights reserved  
 Eastleigh Borough Council  
 Licence No. 100019622 (2006)



**West End Road**

**Peewit Hill**

68.3m

Hilltop

Chartwell  
Cottage

Stoneycroft

Hillcroft

Key to Restriction Types Displayed

 No waiting at any time

**EASTLEIGH**  
BOROUGH COUNCIL

Peewit Hill- West End Road Junction

© Crown copyright. All rights reserved  
Eastleigh Borough Council  
Licence No. 100019622 (2006)

SCALE	1 : 500
DATE	11/03/2013
DRAWING No.	E/TM/01/M/34/33
DRAWN BY	KH
CHECKED BY	JF



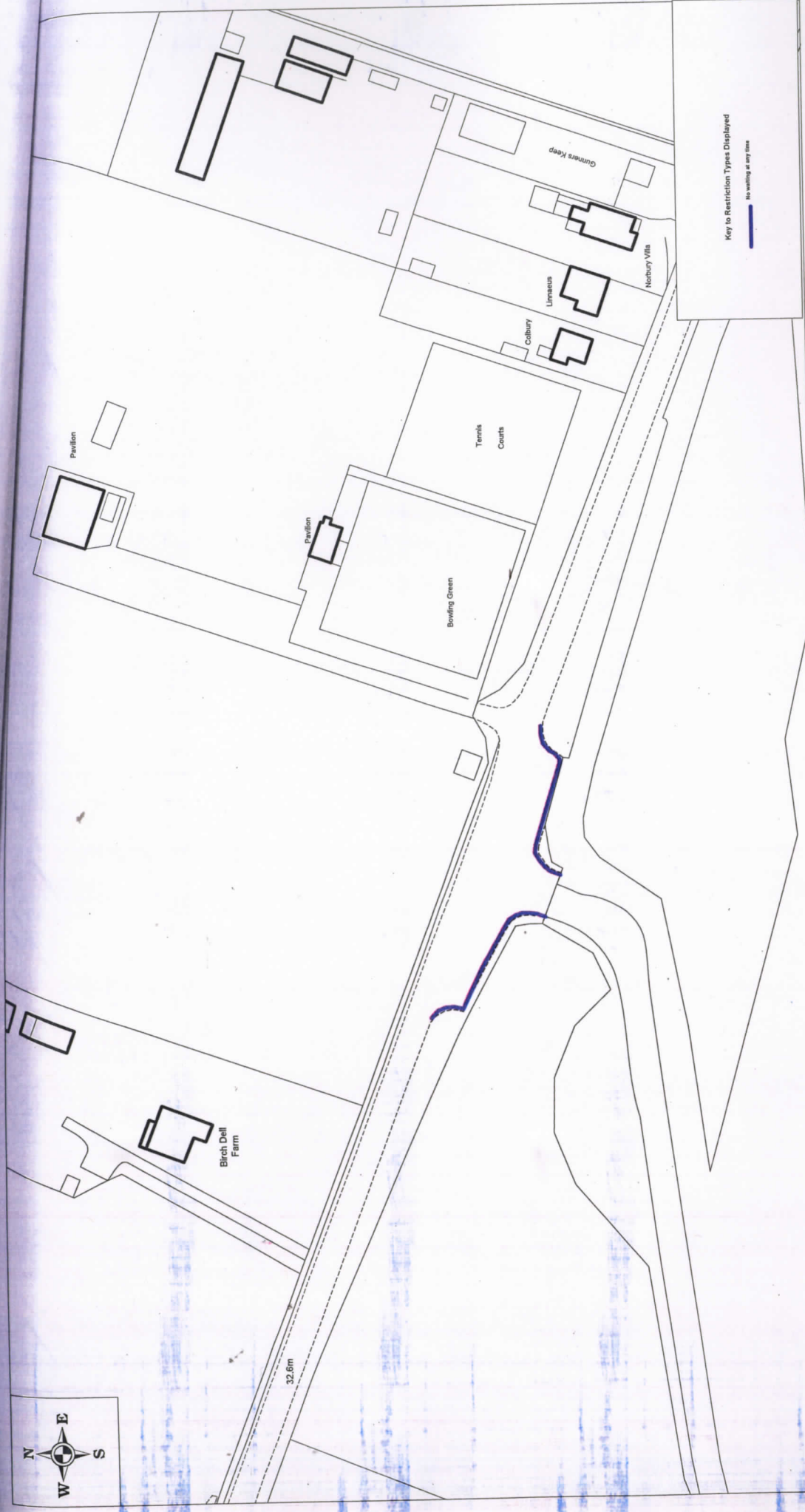

SCALE	1 : 1250
DATE	11/03/2013
DRAWING No.	E/TM/01/M/34/26
DRAWN BY	KH
CHECKED BY	JF

Portsmouth Road by Veolia Works



© Crown copyright. All rights reserved  
 Eastleigh Borough Council  
 Licence No. 100019622 (2006)

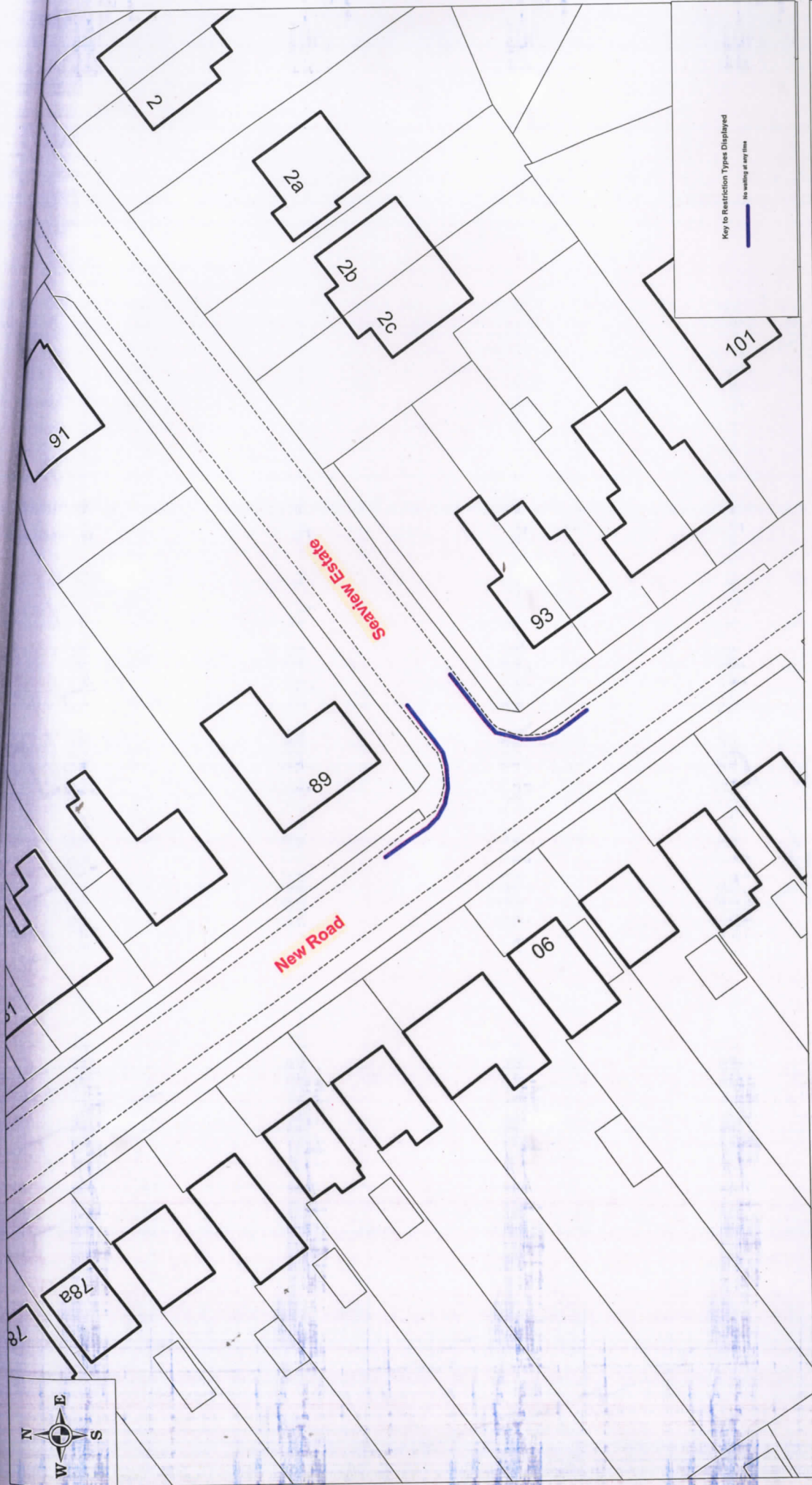

SCALE	1 : 500
DATE	11/03/2013
DRAWING No.	E/TM/01/M/34/28
DRAWN BY	KH
CHECKED BY	JF

Seaview Estate



© Crown copyright. All rights reserved  
 Eastleigh Borough Council  
 Licence No. 100019622 (2006)



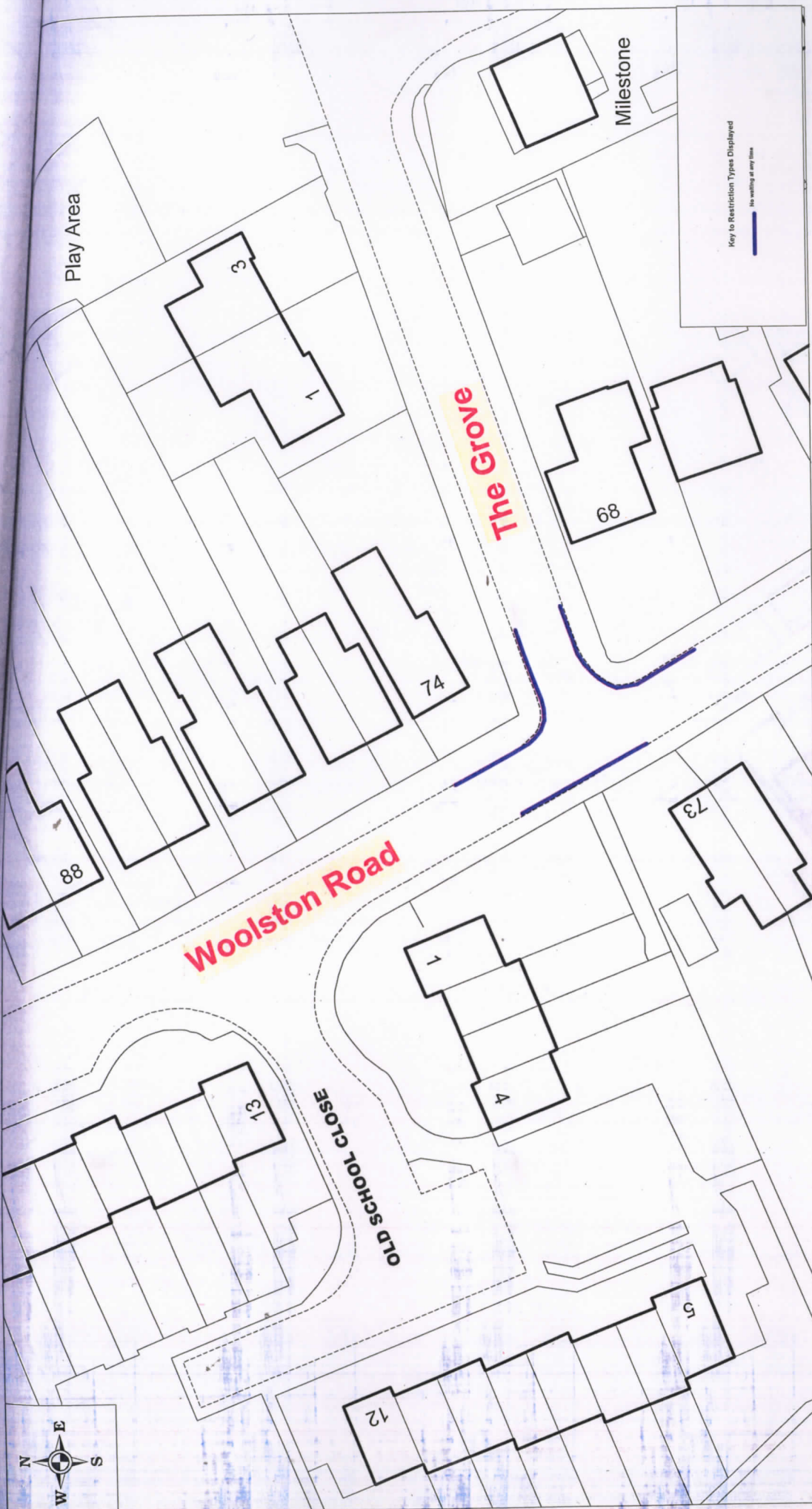

SCALE	1 : 500
DATE	11/03/2013
DRAWING No.	E/TM/01/M/34/29
DRAWN BY	KH
CHECKED BY	JF

Woolston Road/ The Grove

© Crown copyright. All rights reserved  
 Eastleigh Borough Council  
 Licence No. 100019622 (2006)





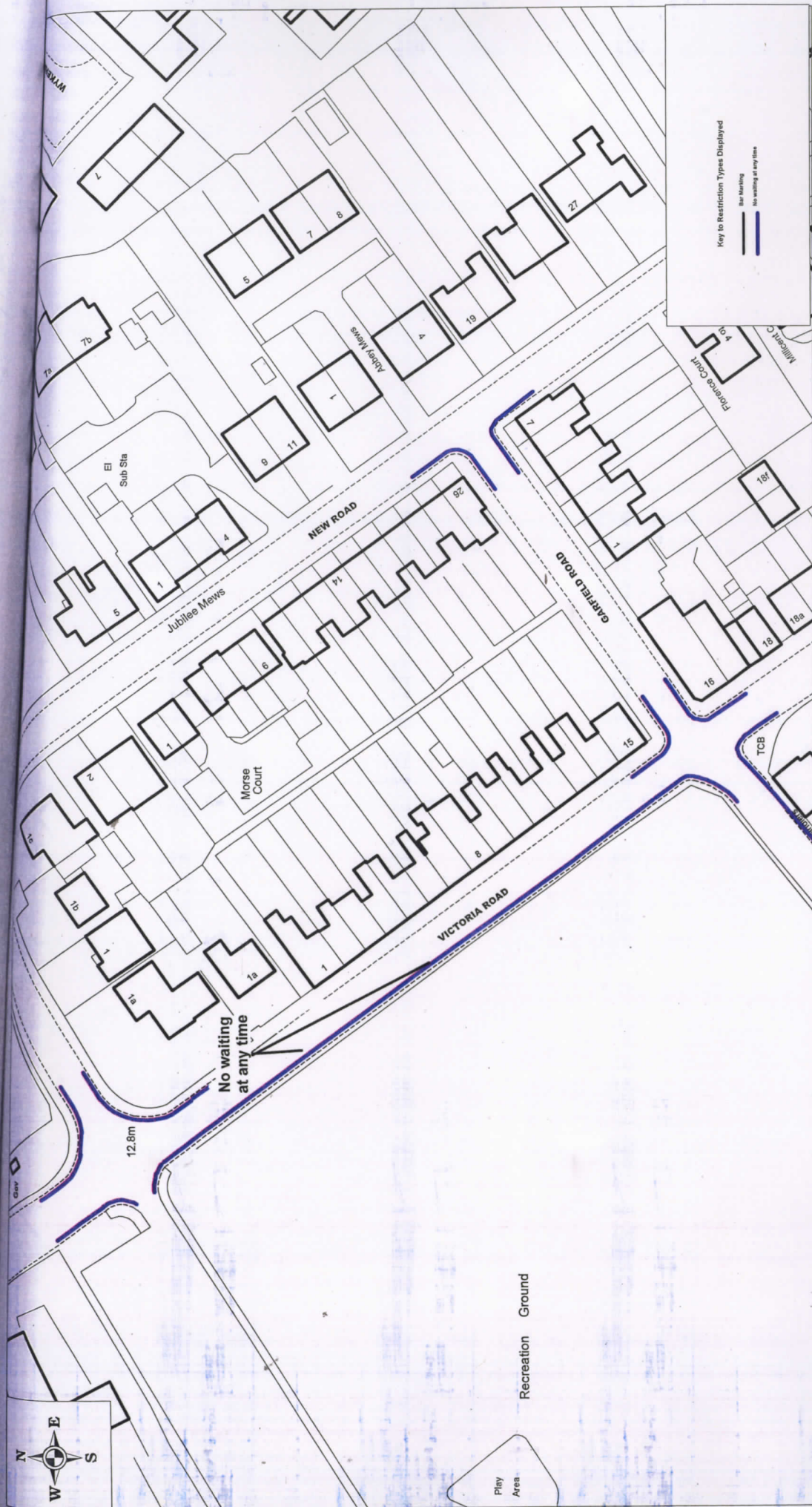

SCALE	1 : 1000
DATE	11/03/2013
DRAWING No.	E/TM/01/M/34/27
DRAWN BY	KH
CHECKED BY	JF

Victoria Road

© Crown copyright. All rights reserved  
Eastleigh Borough Council  
Licence No. 100019622 (2006)

**EASTLEIGH**  
BOROUGH COUNCIL



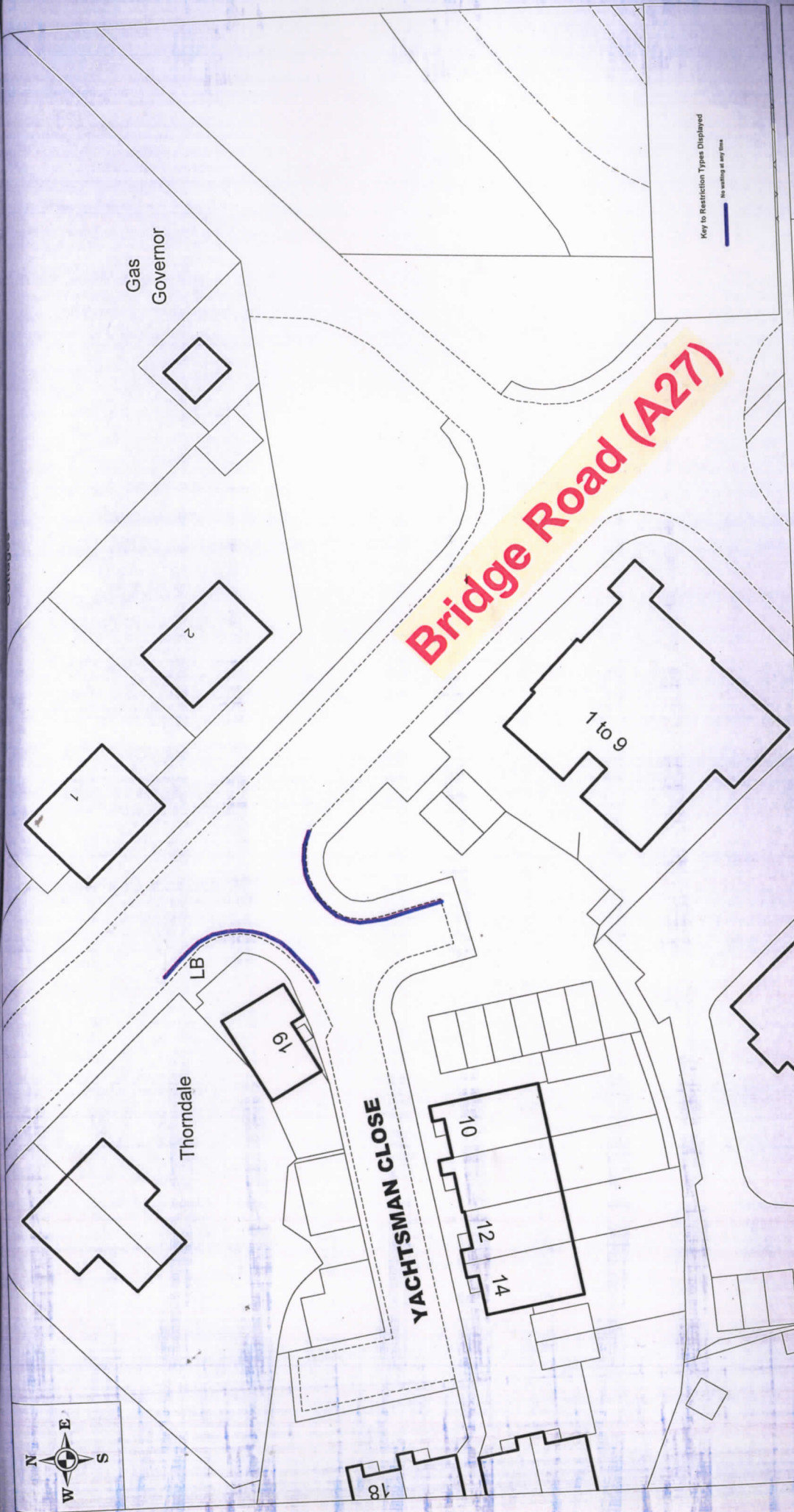

Key to Restriction Types Displayed  
No waiting at any time

SCALE	1 : 500
DATE	11/03/2013
DRAWING No.	E/TM/01/M/34/24
DRAWN BY	KH
CHECKED BY	JF

Yachtsman Close



© Crown copyright. All rights reserved  
Eastleigh Borough Council  
Licence No. 100019622 (2006)