

THE BOROUGH OF EASTLEIGH (CHANDLERS FORD AND
HILTINGBURY) (PROHIBITION AND RESTRICTION OF WAITING)
(DISABLED PERSONS PARKING PLACES)
(AMENDMENT NO.10) ORDER 2011

The Council of the Borough of Eastleigh (hereinafter referred to as "the Council") pursuant to arrangements made under Section 19 of the Local Government Act 2000 with the Hampshire County Council in exercise of the powers of the said County Council under Sections 1, 2 and 4 of the Road Traffic Regulation Act 1984 ("the Act") and Part IV of Schedule 9 to the Act, and of all other enabling powers, and after consultation with the Chief Officer of Police in accordance with Part III of Schedule 9 to the Act hereby makes the following Order:-

Commencement and Citation

1. This Order shall come into operation on 14 March 2011 and may be cited as the "Borough of Eastleigh (Chandlers Ford and Hiltingbury) (Prohibition and Restriction of Waiting) (Disabled Persons Parking Places) (Amendment No.10) Order 2011".

Prohibition and Restriction of Waiting

2. In this Order the Principal Order means The Borough of Eastleigh (Chandlers Ford and Hiltingbury) (Prohibition and Restriction of Waiting) (Disabled Persons Parking Places) Order 2004
3. The Principal Order is hereby amended as follows:

(a) After Article 23 there shall be inserted:

"23A. No person shall except upon the direction or with the permission of a Police Constable in uniform or a Civil Enforcement Officer cause or permit any vehicle to wait or cause goods to be loaded or unloaded at any time in the roads, on the sides of roads or in any of the lengths of roads specified in the Tenth Schedule to this Order."

(b) In the First Schedule (No Waiting at Any Time) item number 1 relating to Avenger Close shall be revoked;

(c) In the First Schedule (No Waiting at Any Time) after item number 18 relating to Constantine Avenue shall be revoked and replaced with:

- | | | | |
|------|--------------------|-----------|---|
| 18. | Constantine Avenue | Northwest | From its junction with Oakmount Road north-eastwards for a distance of 25 metres. |
| 18i. | Constantine Avenue | Southeast | From its junction with Oakmount Road north-eastwards for a distance of 26 metres. |

- | | | | |
|--------|-------------|-----------|---|
| 18ii. | Craven Road | Northwest | From the north-eastern boundary of No. 1 Craven Road south-westwards for a distance of 33 metres. |
| 18iii. | Craven Road | Southeast | From a point 14 metres northeast of its junction Hillcrest Avenue to a point 11 metres south-west of that junction. |

(d) In the First Schedule (No Waiting at Any Time) item number 20 relating to Electron Way shall be revoked and replaced with:

- | | | | |
|-----|--------------|------|---|
| 20. | Electron Way | Both | From its junction with School Lane for its entire length. |
|-----|--------------|------|---|

(e) In the First Schedule (No Waiting at Any Time) after item number 21J relating to Highfield Road there shall be inserted:

- | | | | |
|--------|---------------------------------|------|--|
| 21Ji. | Hiltingbury Schools Access Road | West | From its junction with Hiltingbury Road southwards for a distance of 160 metres. |
| 21Jii. | Hiltingbury Schools Access Road | East | From its junction with Hiltingbury Road southwards for a distance of 188 metres. |

(f) In the First Schedule (No Waiting at Any Time) after item number 21L relating to Hillcrest Avenue there shall be inserted:

- | | | | |
|------|------------------|-----------|--|
| 21M. | Hillcrest Avenue | Northeast | From its junction with Craven Road south-eastwards for a distance of 13 metres. |
| 21N. | Hillcrest Avenue | Southwest | From its junction with Craven Road south-eastwards for a distance of 15 metres. |
| 21O. | Hillcrest Avenue | Southwest | From a point 5 metres southeast of the north-western boundary of No.34 Hillcrest Avenue north-westwards for a distance of 65 metres. |

(g) In the First Schedule (No Waiting at Any Time) item number 22 relating to Hiltingbury Road shall be revoked and replaced with:

- | | | | |
|-----|------------------|-----------|---|
| 22. | Hiltingbury Road | Northeast | From a point 110 metres west of its junction with Ashdown Road eastwards to a point 100 metres east of that junction. |
|-----|------------------|-----------|---|

(h) In the First Schedule (No Waiting at Any Time) after item number 22A relating to Hiltingbury Road there shall be inserted:

- | | | | |
|------|------------------|-----------|---|
| 22B. | Hiltingbury Road | Northeast | From the north-western boundary of No. 174 Hiltingbury Road south-eastwards for a distance of 58 metres. |
| 22C. | Hiltingbury Road | Southwest | From the south-eastern boundary of No's. 135 to 141 Hiltingbury Road south-eastwards for a distance of 64 |

metres.

- | | | | |
|------|------------------|-----------|--|
| 22D. | Hiltingbury Road | Southwest | From the north-western boundary of No. 119 Hiltingbury Road south-eastwards for a distance of 33 metres. |
| 22E. | Hiltingbury Road | Southwest | From a point 21 metres east of the school pedestrian entrance centre-line south-eastwards to a point 6 metres southeast of the north-western boundary of No. 101 Hiltingbury Road. |
| 22F. | Hiltingbury Road | Southwest | From a point 12 metres northwest of its junction with Pine Road to a point 12 metres southeast of that junction. |

(i) In the First Schedule (No Waiting at Any Time) after item number 32A relating to Kingsway there shall be inserted:

- | | | | |
|---------|----------|-----------|--|
| 32Ai. | Kingsway | Northwest | From a point 16 metres southwest of its junction with Merdon Avenue north-eastwards to a point 30 metres northeast of that junction. |
| 32Aii. | Kingsway | Southeast | From a point 16 metres southwest of its junction with Merdon Avenue north-eastwards to a point 26 metres northeast of that junction. |
| 32Aiii. | Kingsway | Northwest | From its junction with Hiltingbury Road north-eastwards for a distance of 33 metres. |
| 32Aiv. | Kingsway | Southeast | From its junction with Hiltingbury Road north-eastwards for a distance of 32 metres. |

(j) In the First Schedule (No Waiting at Any Time) after item number 37B relating to Merdon Avenue Road there shall be inserted:

- | | | | |
|------|---------------|-----------|---|
| 37C. | Merdon Avenue | Northeast | From a point 33 metres northwest of its junction with Kingsway to a point 18 metres southeast of that junction. |
| 37D. | Merdon Avenue | Southwest | From a point 31.5 metres northwest of its junction with Kingsway to a point 20 metres southeast of that junction. |

(k) In the First Schedule (No Waiting at Any Time) item number 38 relating to Millbrook Close shall be revoked;

(l) In the First Schedule (No Waiting at Any Time) after item number 43D relating to Oakwood Road there shall be inserted:

- | | | | |
|------|-----------------|-----------|--|
| 43E. | Octavia Gardens | Southeast | From a point opposite the southern boundary wall of No.2 Octavia Gardens north-eastwards for a distance of |
|------|-----------------|-----------|--|

7 metres.

(m) In the First Schedule (No Waiting at Any Time) item number 47A relating to Pine Road shall be revoked and replaced with:

47A Pine Road Southwest From a point 15 metres east of its junction with Cuckoo Bushes Lane north-westwards to a point 60 metres west of the same junction.

(n) In the First Schedule (No Waiting at Any Time) after item number 47C relating to Pine Road there shall be inserted:

47Ci. Pine Road Both From its junction with Hiltingbury Road southwards for a distance of 15 metres.

(o) In the First Schedule (No Waiting at Any Time) item number 63F relating to Station Lane shall be revoked and replaced with:

63F. Station Lane West From a point 18.5 metres south of the private access to Fordington Villas southwards for a distance of 10.5 metres.

(p) In the Second Schedule (No Waiting 8.00am – 6.00pm Monday to Saturday) item number 1D relating to Nichol Road shall be revoked and replaced with:

1D. Nichol Road Northwest From its junction with Hiltingbury Road north-eastwards for a distance of 70 metres.

1E. Nichol Road Southeast From its junction with Hiltingbury Road to its junction with Gordon Road.

(q) In the Third Schedule (No Waiting 8.00am – 6.00pm Monday to Friday) before item number 1 relating to Keble Road there shall be inserted:

A. Beechcroft Close Northwest From its junction with Hillcrest Avenue south-westwards for a distance of 15 metres.

B. Beechcroft Close Southeast From its junction with Hillcrest Avenue south-westwards for a distance of 11 metres.

C. Beechcroft Way Both From its junction with Hillcrest Avenue north-eastwards for a distance of 10 metres.

D. Hillcrest Avenue Southwest From a point 14 metres northwest of its junction with Beechcroft Close south-eastwards to a point 27 metres south-east of that junction.

E. Hillcrest Avenue Northeast From a point 13.5 metres northwest of its junction with Beechcroft Way south-eastwards to a point 28.5 metres southeast of that junction.

(r) In the Third Schedule (No Waiting 8.00am – 6.00pm Monday to Friday) after item number 4 relating to Keble Road there shall be inserted:

- 4i. Kingsway Northwest From its junction with Hiltingbury Road south-westwards for a distance of 54 metres.
- 4ii. Kingsway Southeast From its junction with Hiltingbury Road south-westwards for a distance of 46 metres.

(s) In the Third Schedule (No Waiting 8.00am – 6.00pm Monday to Friday) items numbered 4B and 4C relating to Merdon Avenue shall be revoked and replaced with:

- 4B. Merdon Avenue Northeast From a point 18 metres southeast of its junction with Kingsway south-eastwards for a distance of 147 metres.
- 4C. Merdon Avenue Southwest From a point 20 metres southeast of its junction with Kingsway south-eastwards for a distance of 99 metres.

(t) In the Third Schedule (No Waiting 8.00am – 6.00pm Monday to Friday) after item number 7 relating to Oakmount Road there shall be inserted:

- 8. Oakmount Road Southwest From a point 25 metres southeast of the junction with the Fryern Infant & Junior School vehicle entrance south-eastwards for a distance of 22 metres.

(u) In the Sixth Schedule (Areas on the Highway Designated as Disabled Persons Parking Places) after item number 1 relating to Beresford Road the following shall be inserted:

- 2. Hillcrest Avenue Southwest From a point 5metres northwest opposite the junction of Highfield Road north-westwards for a distance of 5.5 metres. Within the bay marked by white lines Disabled Persons Vehicles All Day All Hours

(v) In the Eighth Schedule (Waiting Limited to Three Hours Return Prohibited Within Four Hours Monday to Friday 9.00am – 6.00pm) item number 3 relating to Station Lane shall be revoked and replaced with:

- 3. Station Lane West From a point 7 metres south of the private access to Fordington Villas southwards for a distance of 11.5 metres

(w) After the Ninth Schedule there shall be inserted:

TENTH SCHEDULE
No Loading/Unloading At Any Time

1. Hiltingbury Schools West From its junction with Hiltingbury Road southwards
Access Road for a distance of 160 metres.
2. Hiltingbury Schools East From its junction with Hiltingbury Road southwards
Access Road for a distance of 188 metres.

Dated this day of 2011

THE COMMON SEAL of EASTLEIGH)
BOROUGH COUNCIL was hereunto)
affixed in the presence of:-)

Head of Legal & Democratic Services

DATED _____ 2011

BOROUGH OF EASTLEIGH
THE BOROUGH OF EASTLEIGH
(CHANDLERS FORD AND
HILTINBURY) (PROHIBITION AND
RESTRICTION OF WAITING)
(DISABLED PERSONS PARKING
PLACES) (AMENDMENT NO.10)
ORDER 2011

A R Ward
Head of Legal & Democratic Services
Eastleigh Borough Council
Civic Offices
Leigh Road
Eastleigh
Hampshire
SO50 9YN

U:\Legal & Democratic Services\Democratic Services\COMADMIN\TRAFORDS\DECRIM\NONCPZ\PARISHES\CFH\AMEND NO.X- hILTINGBURY ROAD\HILTINGBURY ROAD ORDER.DOC

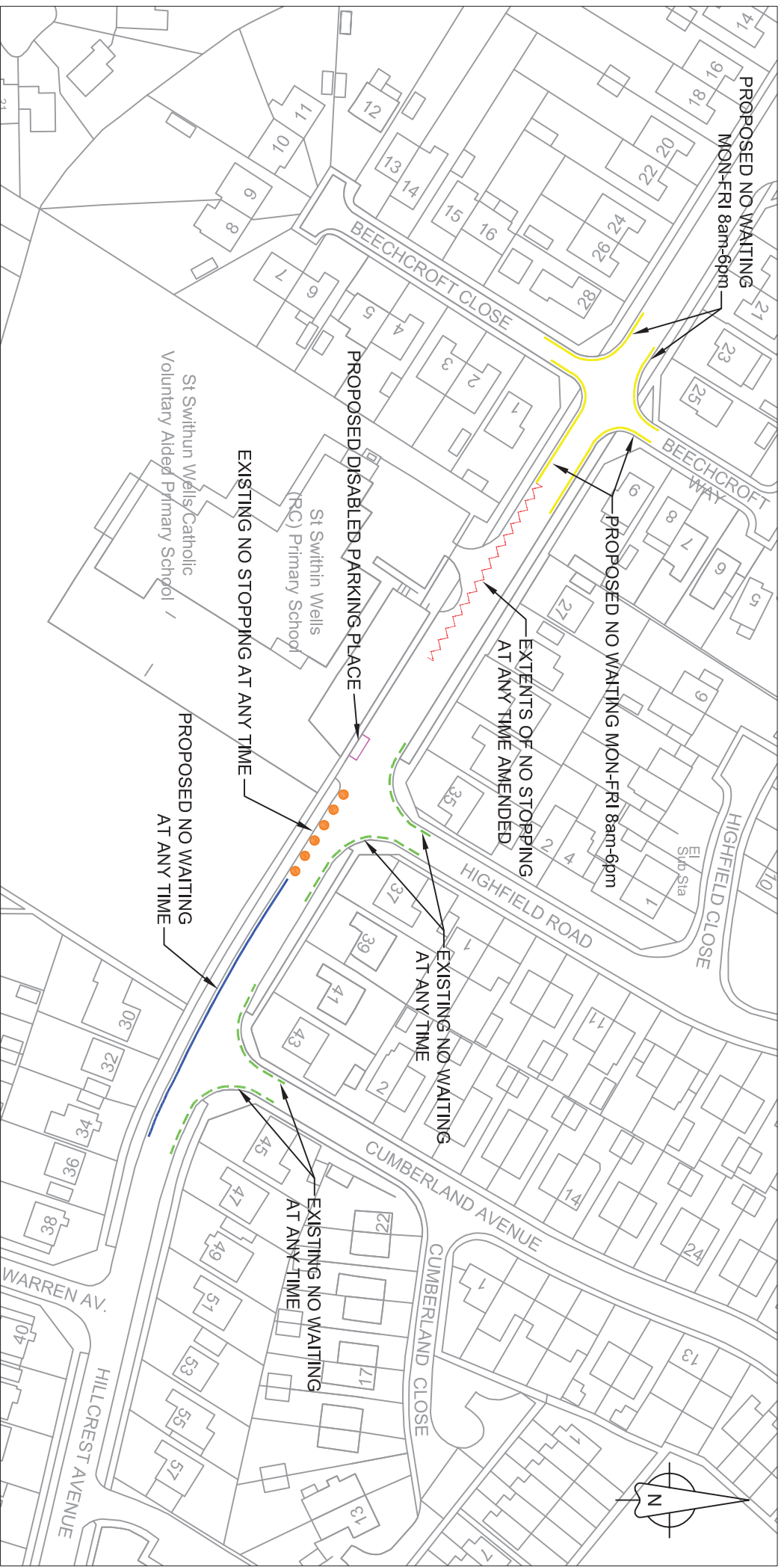

Reproduced from the Ordnance Survey mapping with the permission of Her Majesty's Stationery Office (C) Crown copyright. Unauthorised reproduction infringes Crown copyright and may lead to prosecution or civil proceedings. Licence No. 100019622 (2010)



Ed Vokes
BSc (Hons) MCLT/MCHT
Head of Transportation and Engineering
Civic Offices
Leigh Road, Eastleigh
Hampshire, SO50 9YN
Telephone: (023) 8068 8000
Fax: (023) 8062 0908
Email: engineers@eastleigh.gov.uk

**Transportation
and
Engineering**

Scheme:
**HILLCREST AVENUE / BEECHCROFT CLOSE /
BEECHCROFT WAY, CHANDLERS FORD**

Title:
PROPOSED WAITING RESTRICTIONS

Scale @ A4: 1:1250 Date: SEP 10 Drawn by: GJB Checked by: NP
Drawing No: E/TM/01/N-16/001B Project No: E/TM/01/N-16 Rev: B

LEGEND:

- PROPOSED NO WAITING AT ANY TIME
- PROPOSED NO WAITING MON - FRI 8am - 6pm
- EXISTING NO WAITING AT ANY TIME
- NO STOPPING AT ANY TIME (EXTENTS AMENDED)
- PROPOSED DISABLED PARKING PLACE
- EXISTING NO STOPPING AT ANY TIME

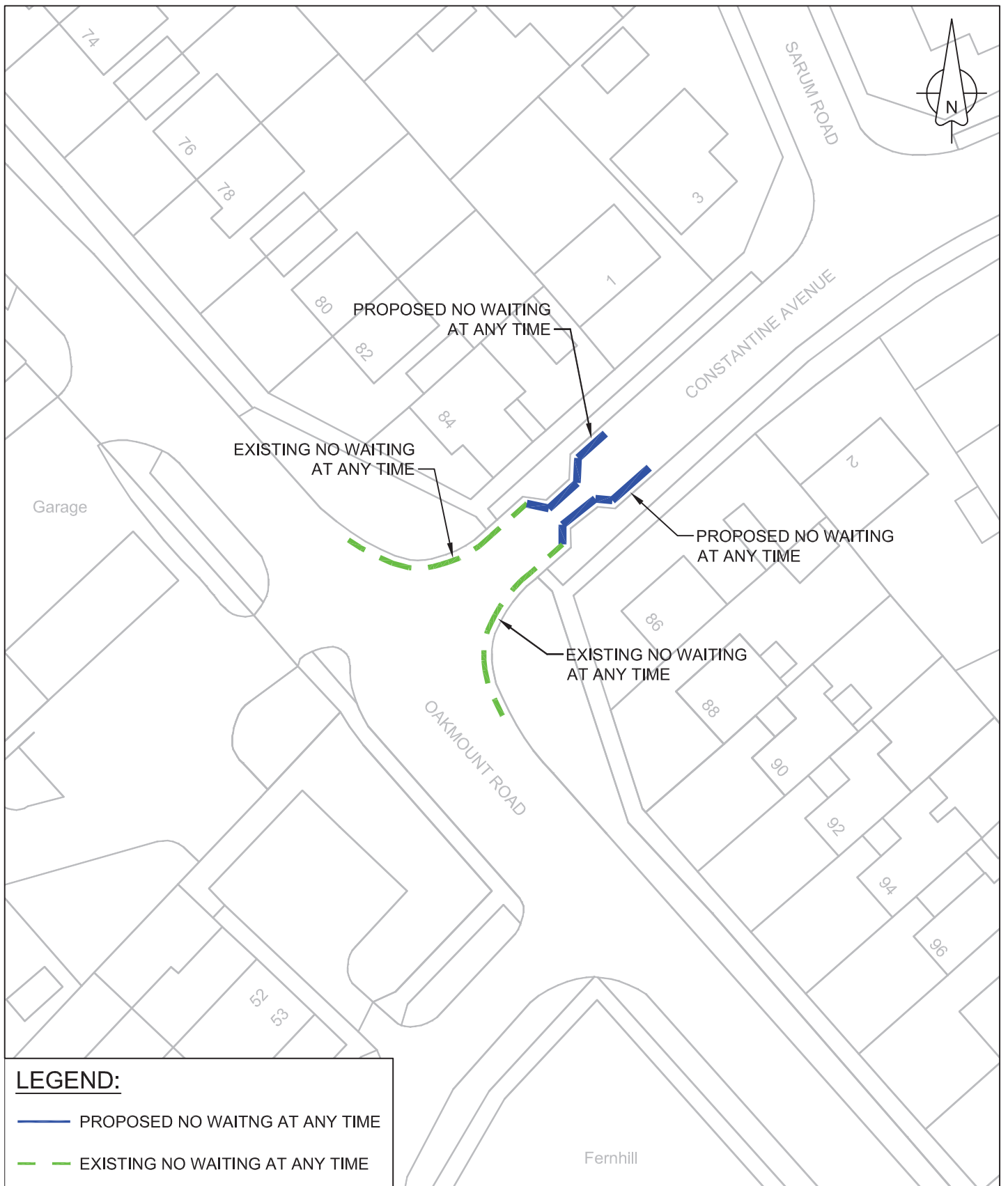

LEGEND:

- PROPOSED NO WAITING AT ANY TIME
- - EXISTING NO WAITING AT ANY TIME



Ed Vokes
 BSc (Hons) MCILT MCILT
 Head of Transportation and Engineering
 Civic Offices
 Leigh Road, Eastleigh
 Hampshire, SO50 9YN
 Telephone: (023) 8068 8000
 Fax: (023) 8062 0908
 Email: engineers@eastleigh.gov.uk

**Transportation
 and
 Engineering**

Reproduced from the Ordnance Survey mapping with the permission of Her Majesty's Stationery Office (C) Crown copyright. Unauthorised reproduction infringes Crown copyright and may lead to prosecution or civil proceedings. Licence No. 100019622 (2010)

Scheme:
CONSTANTINE AVENUE, CHANDLER'S FORD

Title:
PROPOSED WAITING RESTRICTIONS

Scale @ A4: 1:500	Date: SEP 10	Drawn by: GJB	Checked by: NP
----------------------	-----------------	------------------	-------------------

Drawing No.:	Project No.:	Rev:
E/TM/01/N-16/002	E/TM/01/N-16	

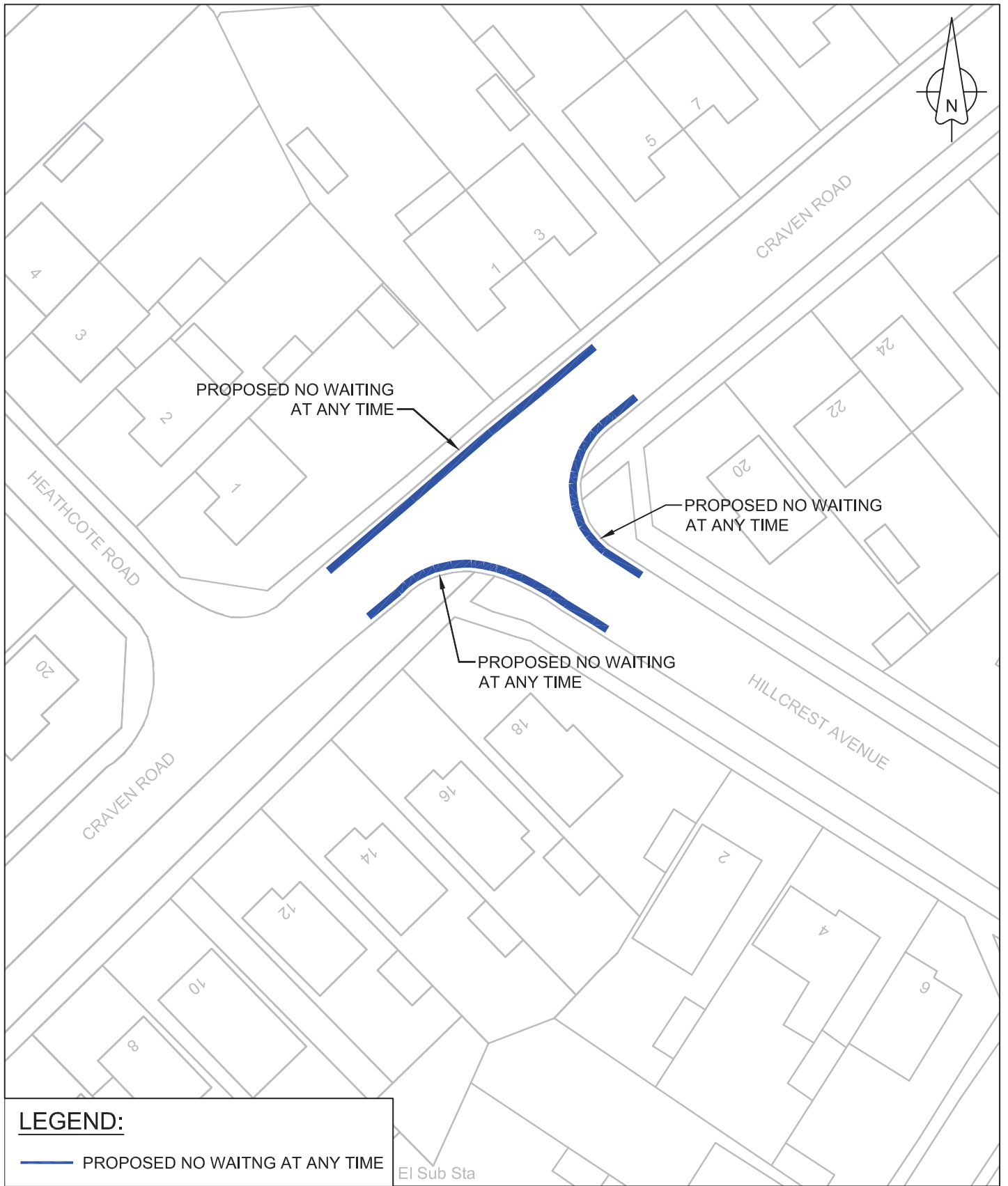

Ed Vokes
 BSc (Hons) MCILT MCiHT
 Head of Transportation and Engineering
 Civic Offices
 Leigh Road, Eastleigh
 Hampshire, SO50 9YN
 Telephone: (023) 8068 8000
 Fax: (023) 8062 0908
 Email: engineers@eastleigh.gov.uk

**Transportation
 and
 Engineering**

Reproduced from the Ordnance Survey mapping with the permission of Her Majesty's Stationery Office (C) Crown copyright. Unauthorised reproduction infringes Crown copyright and may lead to prosecution or civil proceedings. Licence No. 100019622 (2010)

Scheme:
**CRAVEN ROAD / HILLCREST AVENUE,
 CHANDLER'S FORD**

Title:
PROPOSED WAITING RESTRICTIONS

Scale @ A4: 1:500 Date: SEP 10 Drawn by: GJB Checked by: NP

Drawing No.: E/TM/01/N-16/003 Project No.: E/TM/01/N-16 Rev:

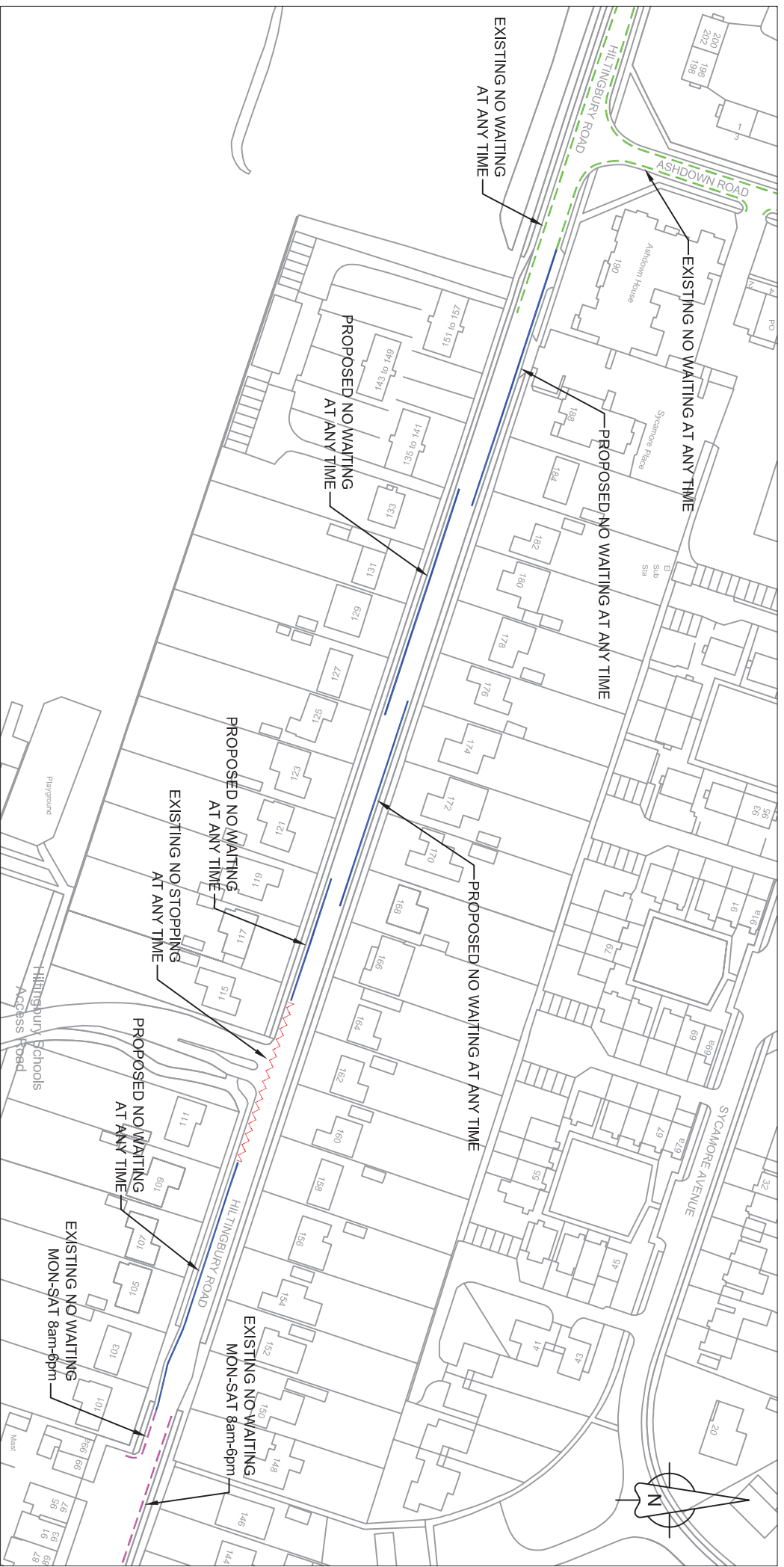

Reproduced from the Ordnance Survey mapping with the permission of Her Majesty's Stationery Office (C) Crown copyright. Unauthorised reproduction infringes Crown copyright and may lead to prosecution or civil proceedings. Licence No. 100019622 (2010)



Ed Vokes
BSc (Hons) MCLT MCIHT
Head of Transportation and Engineering
Civic Offices
Leigh Road, Eastleigh
Hampshire, SO50 9YN
Telephone: (023) 8068 8000
Fax: (023) 8062 0908
Email: engineers@eastleigh.gov.uk

Transportation
and
Engineering

Scheme:
HILTINGBURY ROAD, CHANDLER'S FORD
Title:
PROPOSED WAITING RESTRICTIONS

Scale @ A4: 1:1500 Date: SEP 10 Drawn by: GJB Checked by: NP
Drawing No: E/TM/01/N-16/004 Project No: E/TM/01/N-16 Rev:

LEGEND:

- PROPOSED NO WAITING AT ANY TIME
- - - EXISTING NO WAITING AT ANY TIME
- ~ ~ ~ EXISTING NO STOPPING AT ANY TIME
- - - EXISTING NO WAITING MON-SAT 8am-6pm

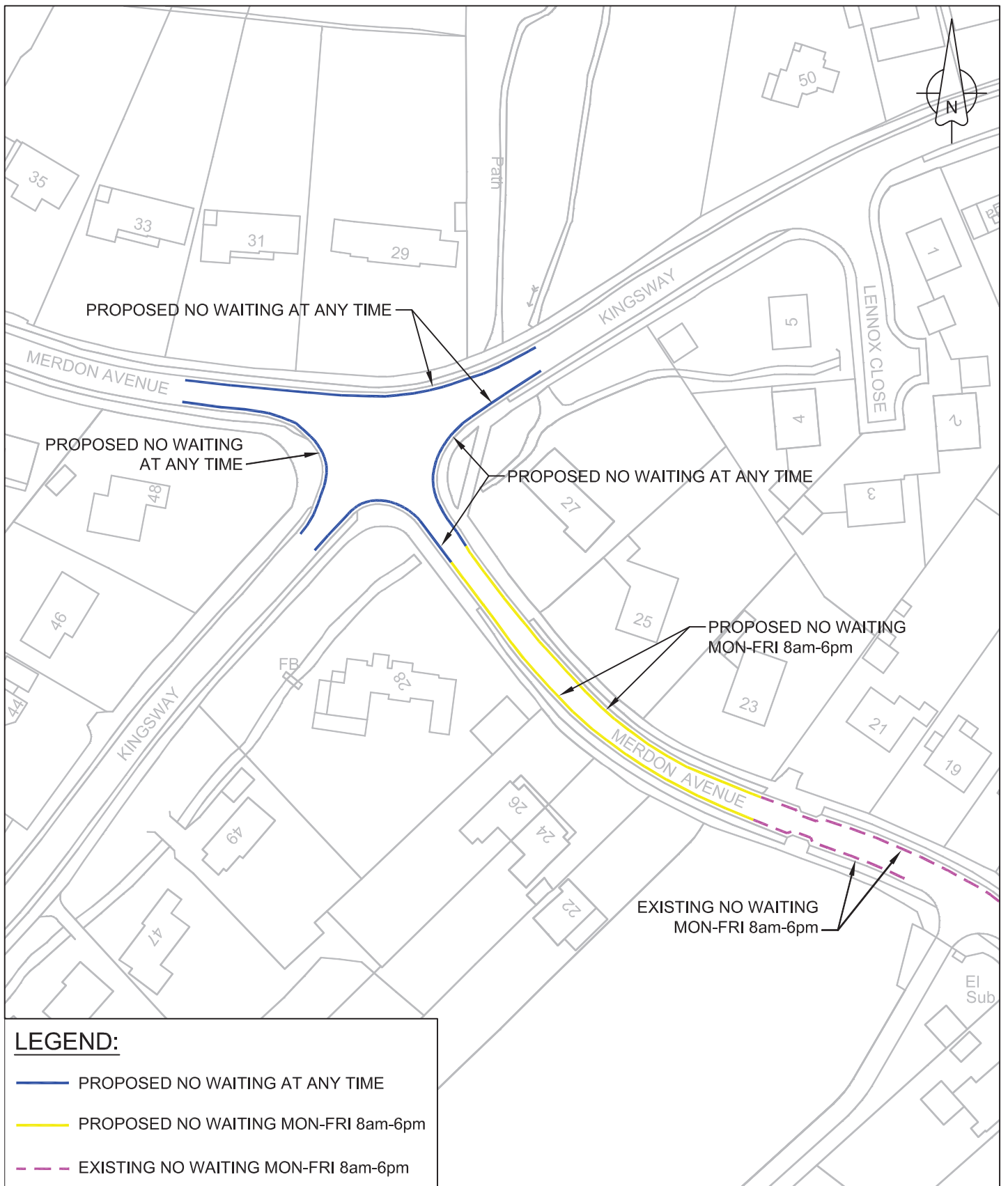

LEGEND:

- PROPOSED NO WAITING AT ANY TIME
- PROPOSED NO WAITING MON-FRI 8am-6pm
- EXISTING NO WAITING MON-FRI 8am-6pm



Ed Vokes
 BSc (Hons) MCILT MCiHT
 Head of Transportation and Engineering
 Civic Offices
 Leigh Road, Eastleigh
 Hampshire, SO50 9YN
 Telephone: (023) 8068 8000
 Fax: (023) 8062 0908
 Email: engineers@eastleigh.gov.uk

**Transportation
 and
 Engineering**

Reproduced from the Ordnance Survey mapping with the permission of Her Majesty's Stationery Office (C) Crown copyright. Unauthorised reproduction infringes Crown copyright and may lead to prosecution or civil proceedings. Licence No. 100019622 (2010)

Scheme:
**MERDON AVENUE / KINGSWAY,
 CHANDLER'S FORD**

Title:
PROPOSED WAITING RESTRICTIONS

Scale @ A4: 1:1000 Date: SEP 10 Drawn by: GJB Checked by: NP

Drawing No.: E/TM/01/N-16/005 Project No.: E/TM/01/N-16 Rev:

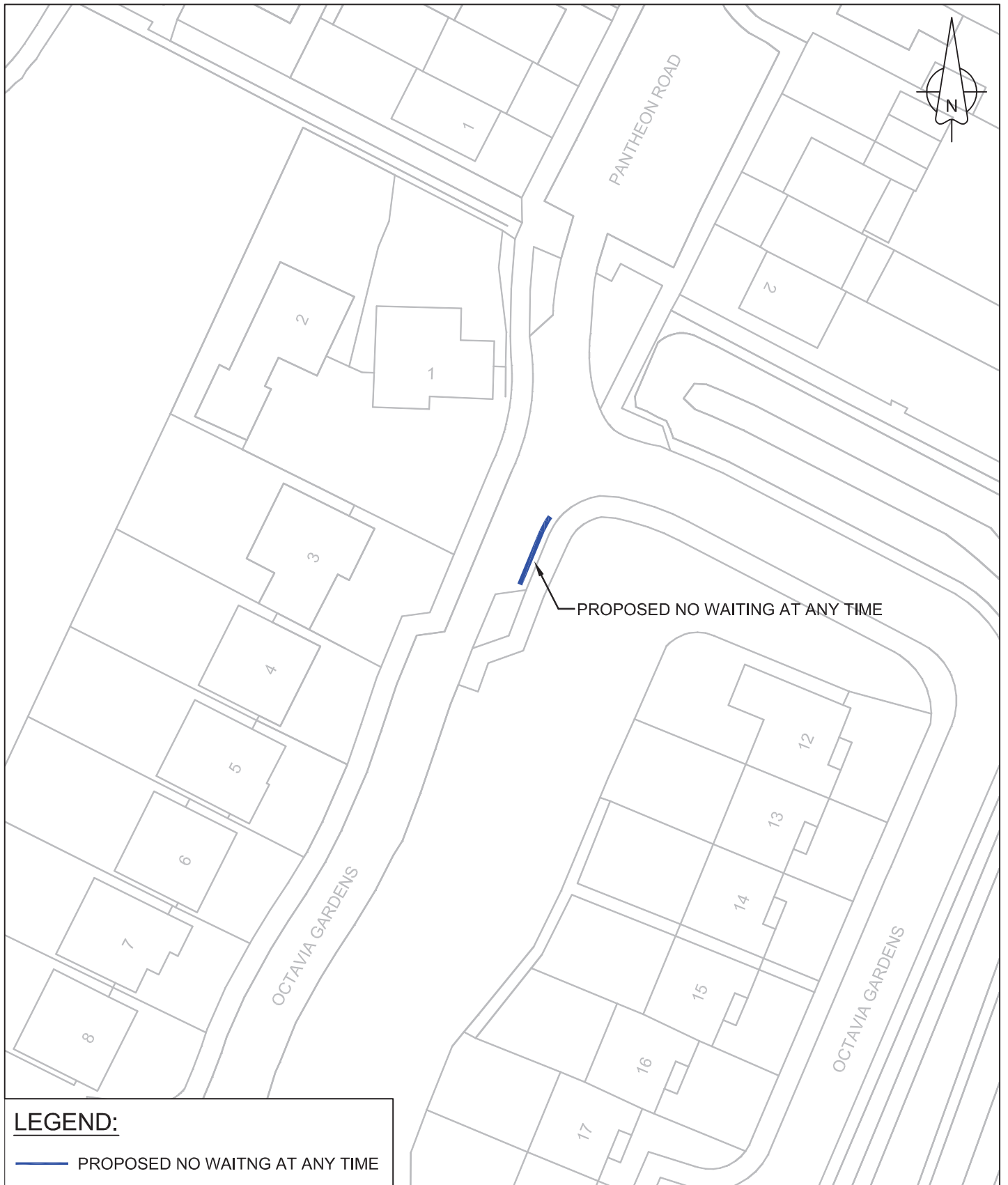

Ed Vokes
 BSc (Hons) MCILT MCiHT
 Head of Transportation and Engineering
 Civic Offices
 Leigh Road, Eastleigh
 Hampshire, SO50 9YN
 Telephone: (023) 8068 8000
 Fax: (023) 8062 0908
 Email: engineers@eastleigh.gov.uk

**Transportation
 and
 Engineering**

Reproduced from the Ordnance Survey mapping with the permission of Her Majesty's Stationery Office (C) Crown copyright. Unauthorised reproduction infringes Crown copyright and may lead to prosecution or civil proceedings. Licence No. 100019622 (2010)

Scheme:
OCTAVIA GARDENS, CHANDLER'S FORD

Title:
PROPOSED WAITING RESTRICTIONS

Scale @ A4: 1:500 Date: SEP 10 Drawn by: GJB Checked by: NP

Drawing No.: E/TM/01/N-16/006 Project No.: E/TM/01/N-16 Rev:

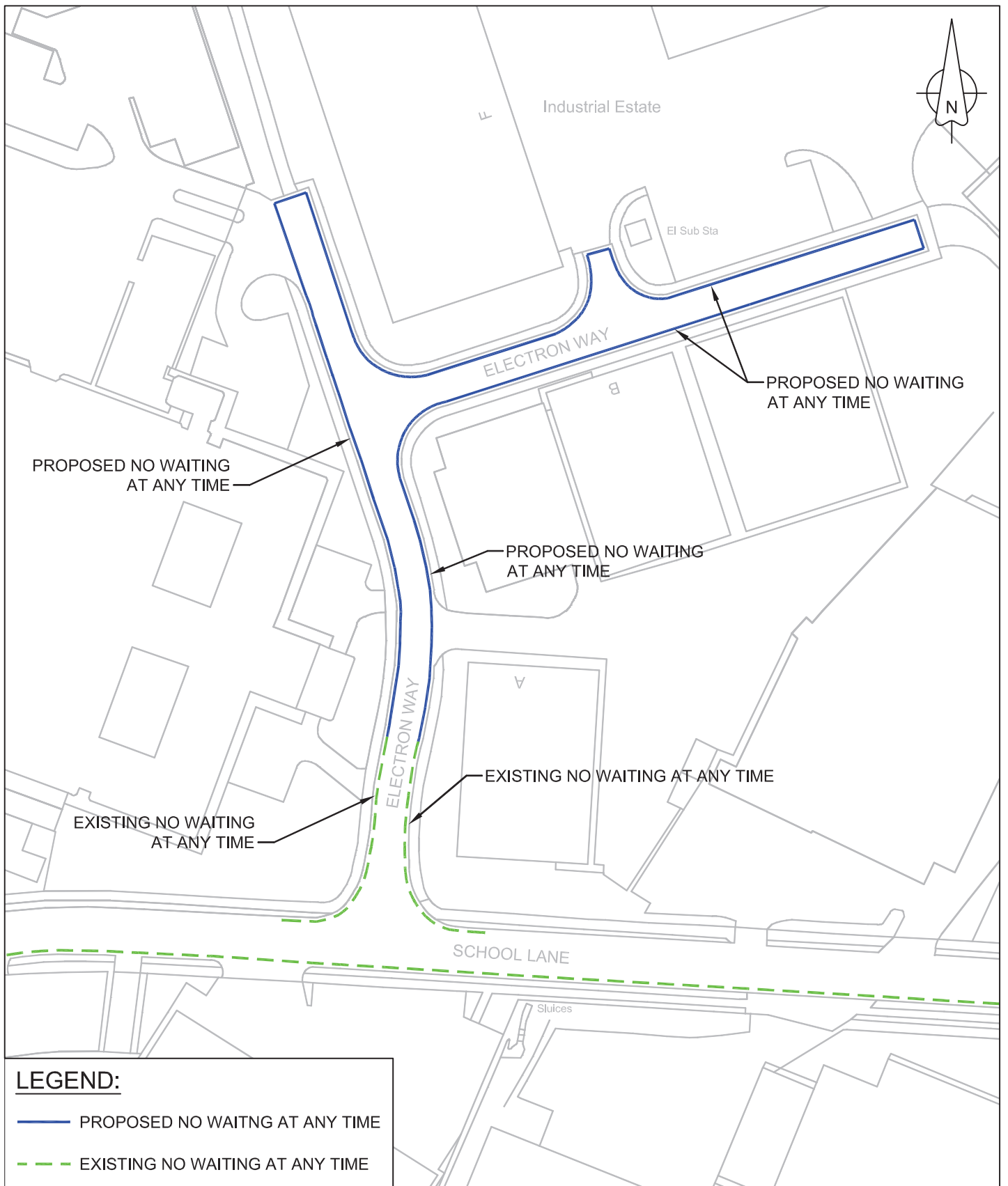

LEGEND:

- PROPOSED NO WAITING AT ANY TIME
- - - EXISTING NO WAITING AT ANY TIME



Ed Vokes
 BSc (Hons) MCILT MCiHT
 Head of Transportation and Engineering
 Civic Offices
 Leigh Road, Eastleigh
 Hampshire, SO50 9YN
 Telephone: (023) 8068 8000
 Fax: (023) 8062 0908
 Email: engineers@eastleigh.gov.uk

**Transportation
 and
 Engineering**

Reproduced from the Ordnance Survey mapping with the permission of Her Majesty's Stationery Office (C) Crown copyright. Unauthorised reproduction infringes Crown copyright and may lead to prosecution or civil proceedings. Licence No. 100019622 (2010)

Scheme:
ELECTRON WAY, CHANDLER'S FORD

Title:
PROPOSED WAITING RESTRICTIONS

Scale @ A4: 1:1000 Date: SEP 10 Drawn by: GJB Checked by: NP

Drawing No.: E/TM/01/N-16/007A	Project No.: E/TM/01/N-16	Rev: A
-----------------------------------	------------------------------	-----------

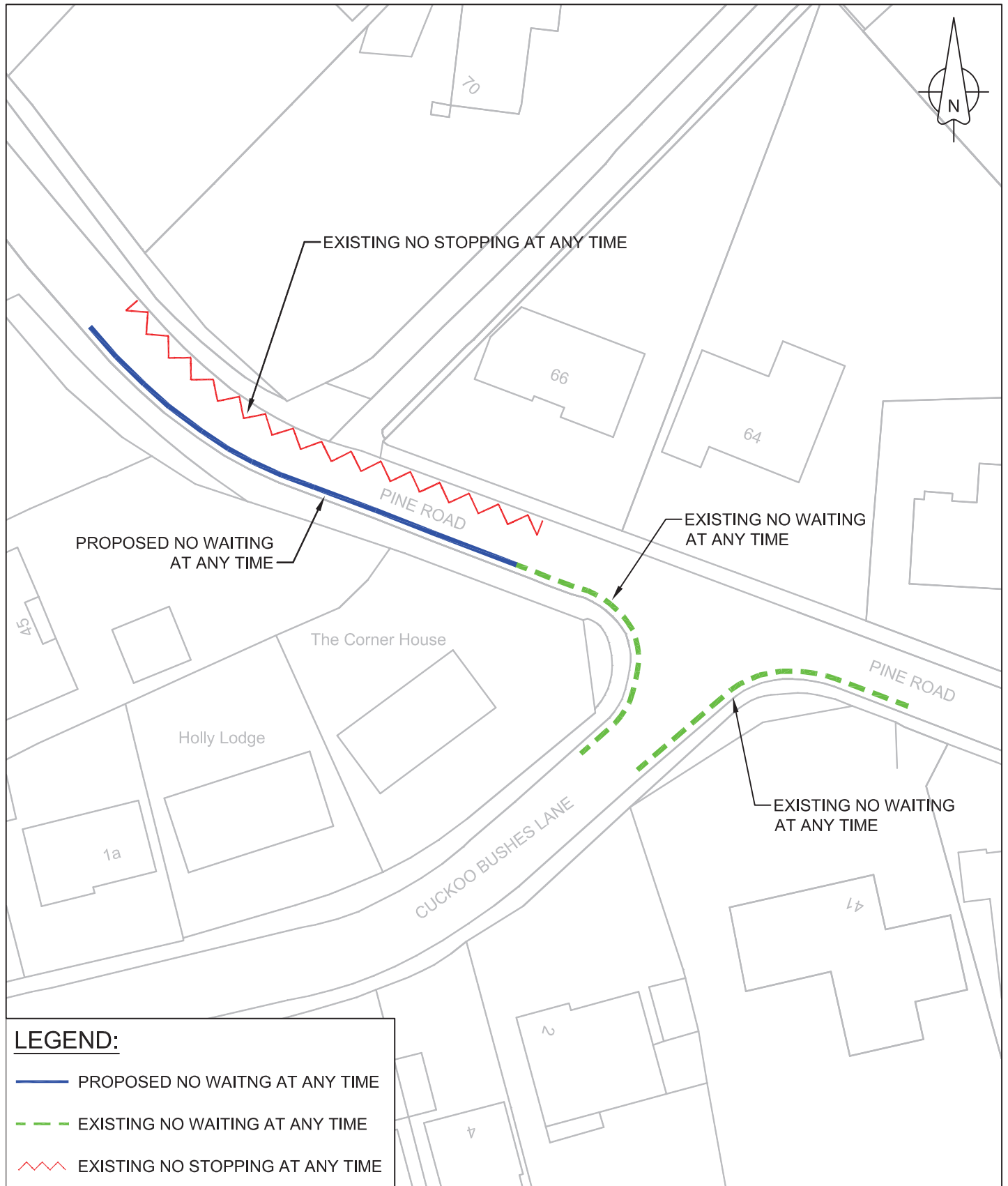

LEGEND:

- PROPOSED NO WAITING AT ANY TIME
- - - EXISTING NO WAITING AT ANY TIME
- ⚡ EXISTING NO STOPPING AT ANY TIME



Ed Vokes
 BSc (Hons) MCILT MCiHT
 Head of Transportation and Engineering
 Civic Offices
 Leigh Road, Eastleigh
 Hampshire, SO50 9YN
 Telephone: (023) 8068 8000
 Fax: (023) 8062 0908
 Email: engineers@eastleigh.gov.uk

**Transportation
 and
 Engineering**

Reproduced from the Ordnance Survey mapping with the permission of Her Majesty's Stationery Office (C) Crown copyright. Unauthorised reproduction infringes Crown copyright and may lead to prosecution or civil proceedings. Licence No. 100019622 (2010)

Scheme:
PINE ROAD, CHANDLER'S FORD

Title:
PROPOSED WAITING RESTRICTIONS

Scale @ A4: 1:500 Date: SEP 10 Drawn by: GJB Checked by: NP

Drawing No.: E/TM/01/N-16/008 Project No.: E/TM/01/N-16 Rev:

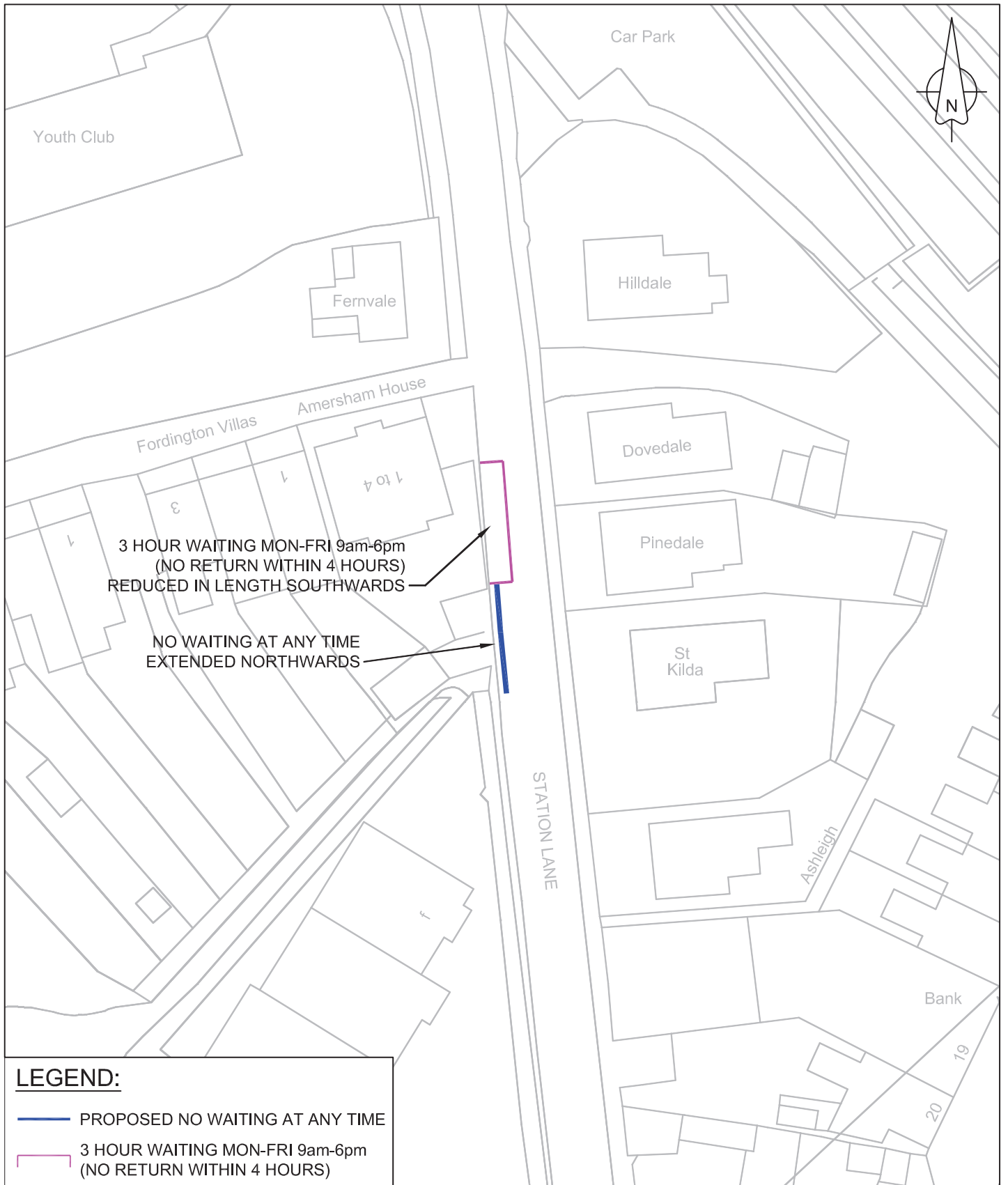

LEGEND:

- PROPOSED NO WAITING AT ANY TIME
- 3 HOUR WAITING MON-FRI 9am-6pm (NO RETURN WITHIN 4 HOURS)



Ed Vokes
 BSc (Hons) MCILT MCIHT
 Head of Transportation and Engineering
 Civic Offices
 Leigh Road, Eastleigh
 Hampshire, SO50 9YN
 Telephone: (023) 8068 8000
 Fax: (023) 8062 0908
 Email: engineers@eastleigh.gov.uk

**Transportation
 and
 Engineering**

Reproduced from the Ordnance Survey mapping with the permission of Her Majesty's Stationery Office (C) Crown copyright. Unauthorised reproduction infringes Crown copyright and may lead to prosecution or civil proceedings. Licence No. 100019622 (2010)

Scheme:

STATION LANE, CHANDLER'S FORD

Title:

PROPOSED WAITING RESTRICTIONS

Scale @ A4:

1:500

Date:

SEP 10

Drawn by:

GJB

Checked by:

NP

Drawing No.:

E/TM/01/N-16/009

Project No.:

E/TM/01/N-16

Rev:

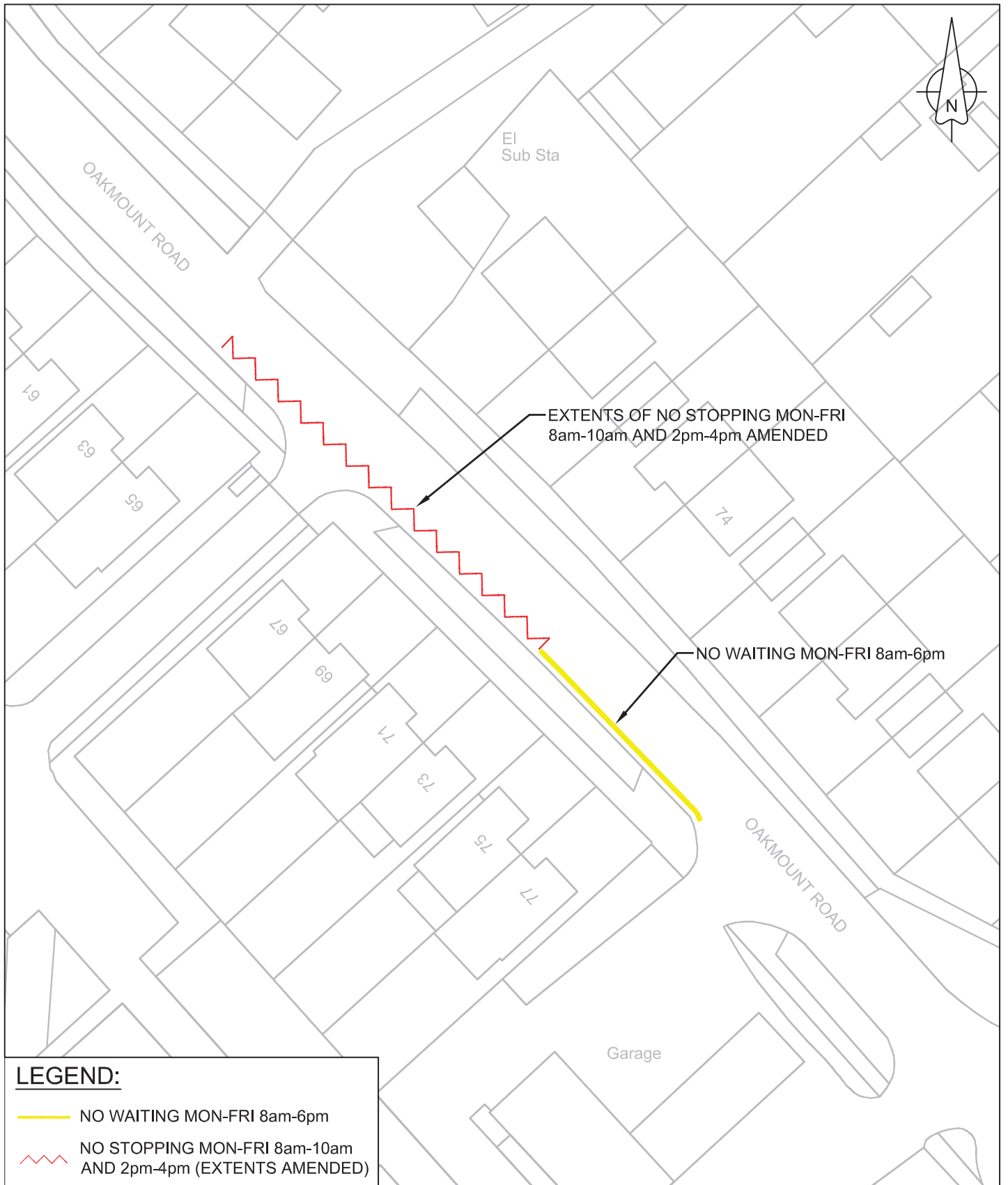

LEGEND:

- NO WAITING MON-FRI 8am-6pm
- ⚡ NO STOPPING MON-FRI 8am-10am AND 2pm-4pm (EXTENTS AMENDED)



Ed Vokes
 BSc (Hons) MCILT MCiHT
 Head of Transportation and Engineering
 Civic Offices
 Leigh Road, Eastleigh
 Hampshire, SO50 9YN
 Telephone: (023) 8068 8000
 Fax: (023) 8062 0908
 Email: engineers@eastleigh.gov.uk

**Transportation
 and
 Engineering**

Reproduced from the Ordnance Survey mapping with the permission of Her Majesty's Stationery Office (C) Crown copyright. Unauthorised reproduction infringes Crown copyright and may lead to prosecution or civil proceedings. Licence No. 100019622 (2010)

Scheme:
OAKMOUNT ROAD, CHANDLER'S FORD

Title:
PROPOSED WAITING RESTRICTIONS

Scale @ A4: 1:500 Date: SEP 10 Drawn by: GJB Checked by: NP

Drawing No.: E/TM/01/N-16/010	Project No.: E/TM/01/N-16	Rev:
----------------------------------	------------------------------	------

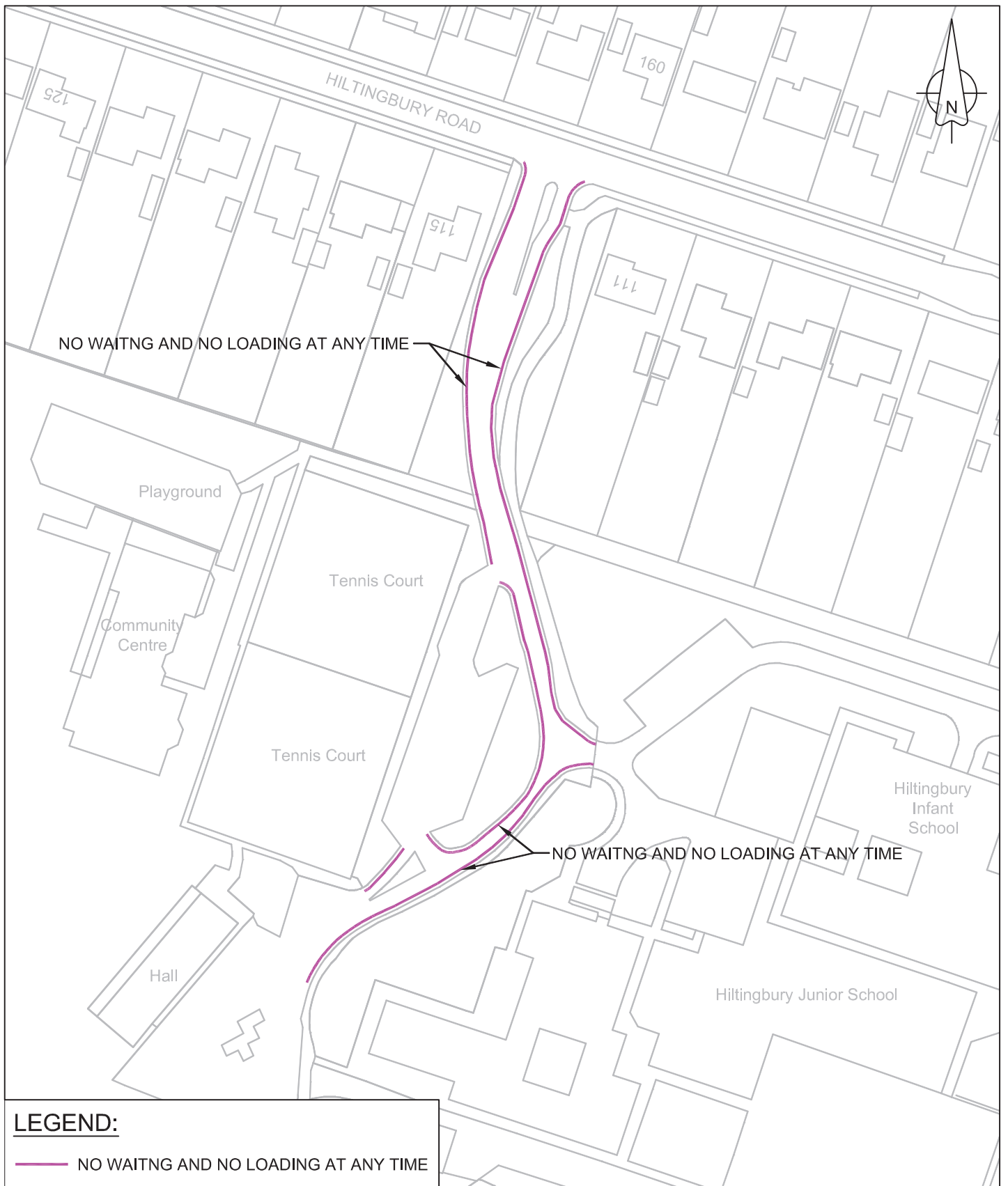

Ed Vokes
 BSc (Hons) MCILT MCIT
 Head of Transportation and Engineering
 Civic Offices
 Leigh Road, Eastleigh
 Hampshire, SO50 9YN
 Telephone: (023) 8068 8000
 Fax: (023) 8062 0908
 Email: engineers@eastleigh.gov.uk

**Transportation
 and
 Engineering**

Reproduced from the Ordnance Survey mapping with the permission of Her Majesty's Stationery Office (C) Crown copyright. Unauthorised reproduction infringes Crown copyright and may lead to prosecution or civil proceedings. Licence No. 100019622 (2010)

Scheme:
**HILTINGBURY SCHOOLS ACCESS ROAD,
 CHANDLER'S FORD**

Title:
PROPOSED WAITING RESTRICTIONS

Scale @ A4: 1:1000	Date: SEP 10	Drawn by: GJB	Checked by: NP
-----------------------	-----------------	------------------	-------------------

Drawing No.: E/TM/01/N-16/011	Project No.: E/TM/01/N-16	Rev:
----------------------------------	------------------------------	------

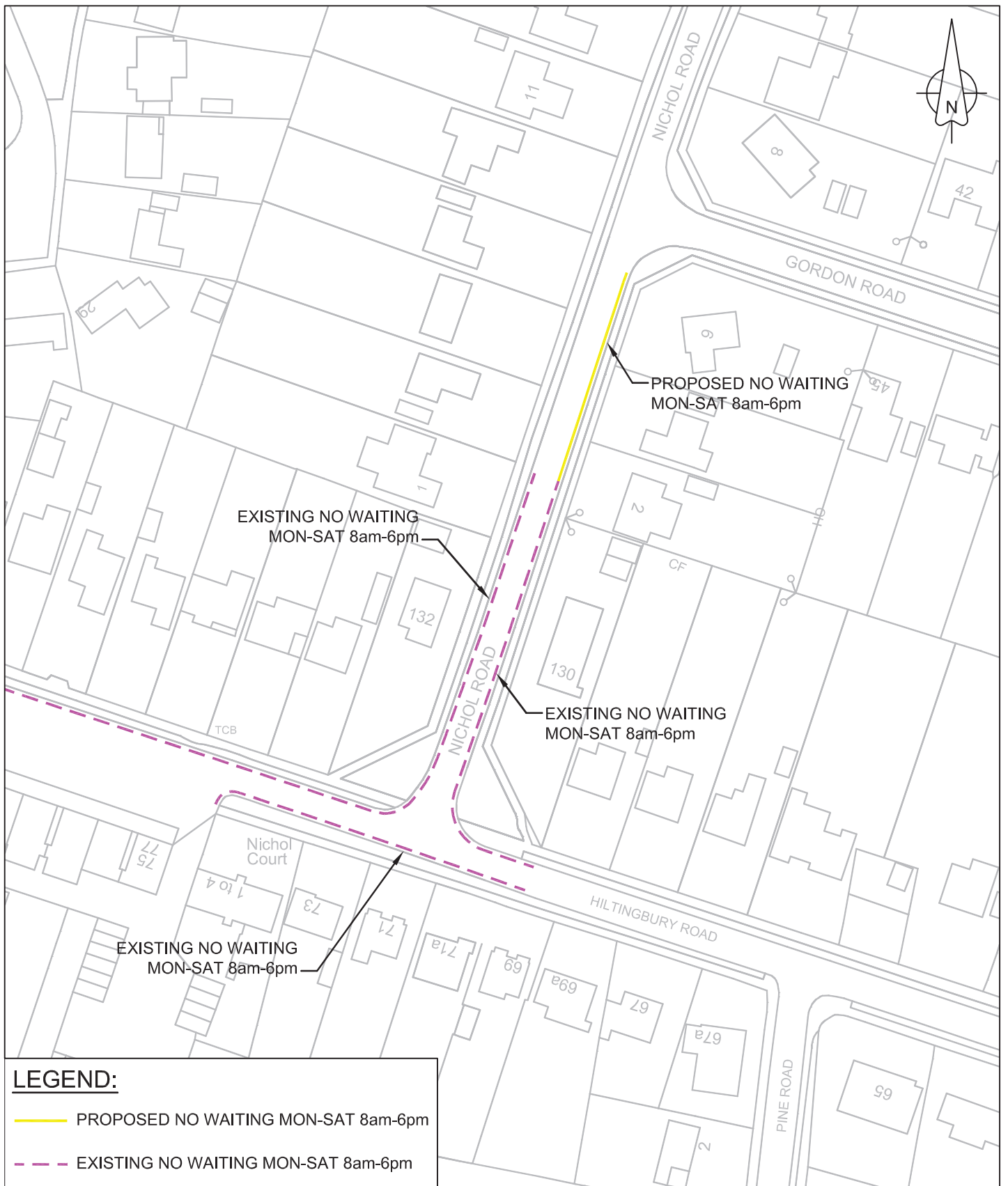

LEGEND:

- PROPOSED NO WAITING MON-SAT 8am-6pm
- - - EXISTING NO WAITING MON-SAT 8am-6pm



Ed Vokes
 BSc (Hons) MCILT MCILT
 Head of Transportation and Engineering
 Civic Offices
 Leigh Road, Eastleigh
 Hampshire, SO50 9YN
 Telephone: (023) 8068 8000
 Fax: (023) 8062 0908
 Email: engineers@eastleigh.gov.uk

**Transportation
 and
 Engineering**

Reproduced from the Ordnance Survey mapping with the permission of Her Majesty's Stationery Office (C) Crown copyright. Unauthorised reproduction infringes Crown copyright and may lead to prosecution or civil proceedings. Licence No. 100019622 (2010)

Scheme:
NICHOL ROAD, CHANDLER'S FORD

Title:
PROPOSED WAITING RESTRICTIONS

Scale @ A4: 1:1000 Date: SEP 10 Drawn by: GJB Checked by: NP

Drawing No.: E/TM/01/N-16/012 Project No.: E/TM/01/N-16 Rev:

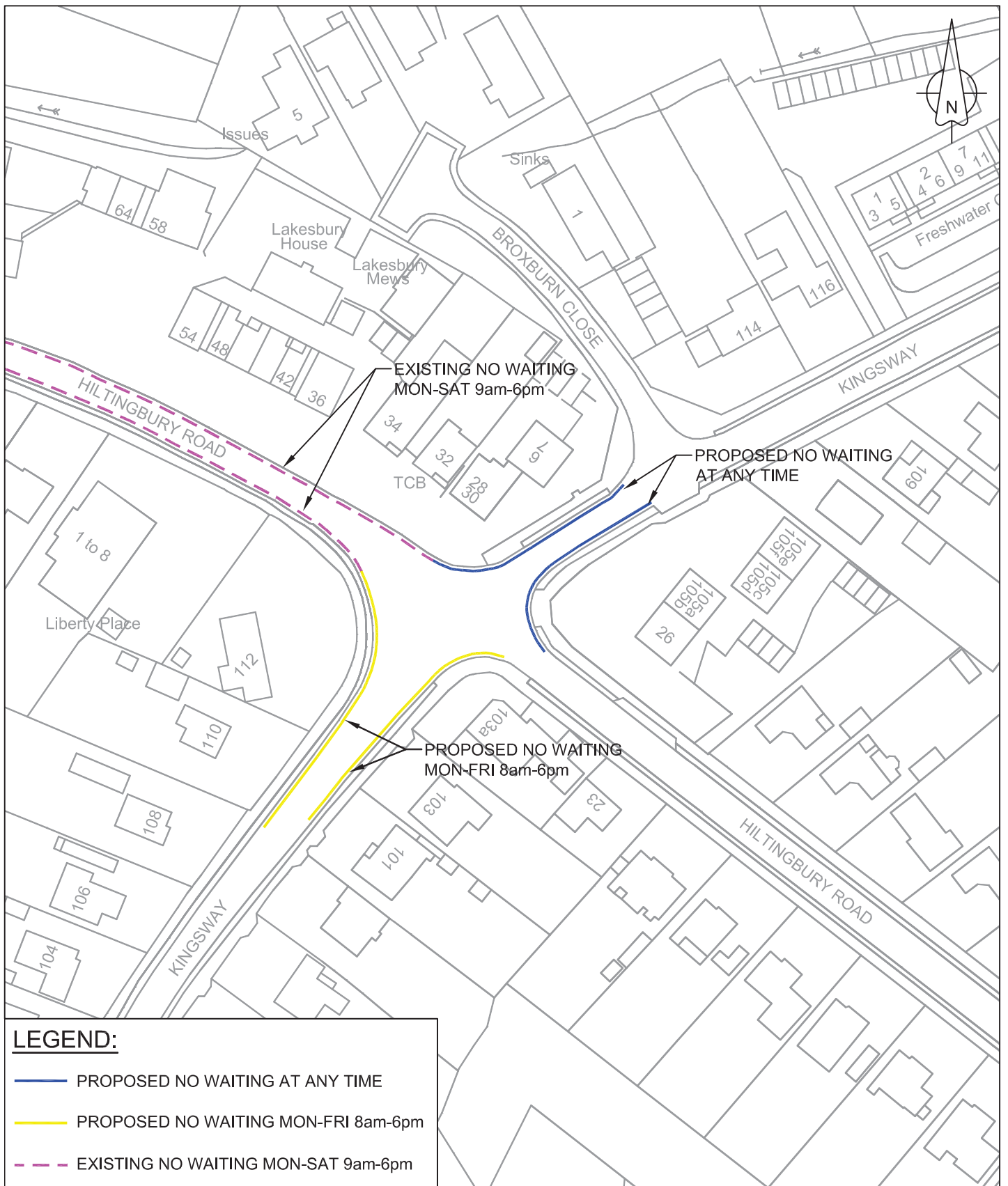

LEGEND:

- PROPOSED NO WAITING AT ANY TIME
- PROPOSED NO WAITING MON-FRI 8am-6pm
- EXISTING NO WAITING MON-SAT 9am-6pm



Ed Vokes
 BSc (Hons) MCILT MCiHT
 Head of Transportation and Engineering
 Civic Offices
 Leigh Road, Eastleigh
 Hampshire, SO50 9YN
 Telephone: (023) 8068 8000
 Fax: (023) 8062 0908
 Email: engineers@eastleigh.gov.uk

**Transportation
 and
 Engineering**

Reproduced from the Ordnance Survey mapping with the permission of Her Majesty's Stationery Office (C) Crown copyright. Unauthorised reproduction infringes Crown copyright and may lead to prosecution or civil proceedings. Licence No. 100019622 (2010)

Scheme:
KINGSWAY, CHANDLER'S FORD

Title:
PROPOSED WAITING RESTRICTIONS

Scale @ A4: 1:1000 Date: SEP 10 Drawn by: GJB Checked by: NP

Drawing No.: E/TM/01/N-16/013A Project No.: E/TM/01/N-16 Rev: A

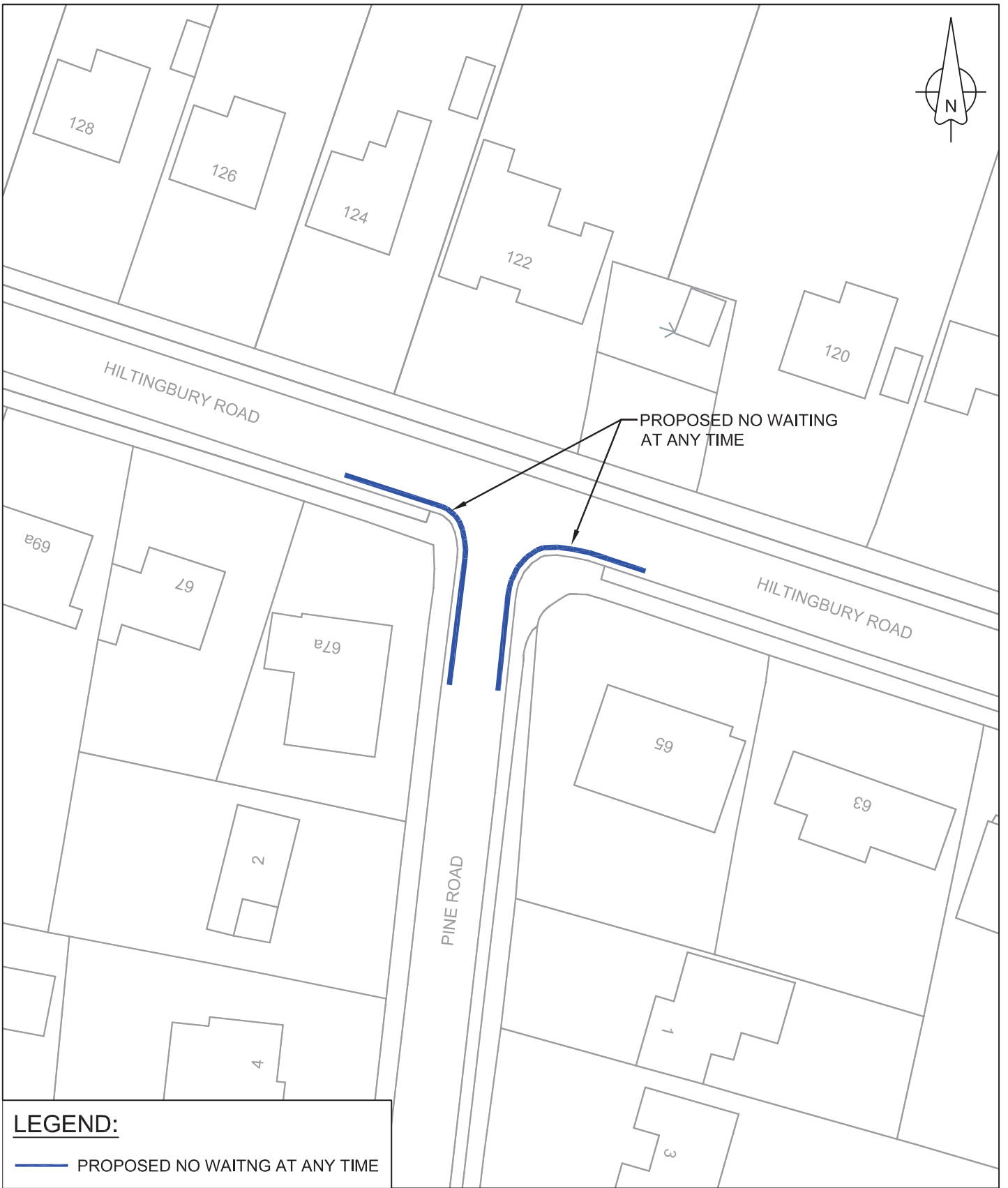

LEGEND:

— PROPOSED NO WAITING AT ANY TIME



Ed Vokes
 BSc (Hons) MCILT MCIT
 Head of Transportation and Engineering
 Civic Offices
 Leigh Road, Eastleigh
 Hampshire, SO50 9YN
 Telephone: (023) 8068 8000
 Fax: (023) 8062 0908
 Email: engineers@eastleigh.gov.uk

**Transportation
 and
 Engineering**

Reproduced from the Ordnance Survey mapping with the permission of Her Majesty's Stationery Office (C) Crown copyright. Unauthorised reproduction infringes Crown copyright and may lead to prosecution or civil proceedings. Licence No. 100019622 (2010)

Scheme: **HILTINGBURY ROAD / PINE ROAD,
 CHANDLER'S FORD**

Title: **PROPOSED WAITING RESTRICTIONS**

Scale @ A4: 1:500 Date: SEP 10 Drawn by: GJB Checked by: NP

Drawing No.: E/TM/01/N-16/014 Project No.: E/TM/01/N-16 Rev: