

THE BOROUGH OF EASTLEIGH (CHANDLERS FORD AND
HILTINGBURY) (PROHIBITION AND RESTRICTION OF WAITING)
(DISABLED PERSONS PARKING PLACES)
(AMENDMENT NO.8) ORDER 2009

The Council of the Borough of Eastleigh (hereinafter referred to as "the Council") pursuant to arrangements made under Section 19 of the Local Government Act 2000 with the Hampshire County Council in exercise of the powers of the said County Council under Sections 1, 2 and 4 of the Road Traffic Regulation Act 1984 ("the Act") and Part IV of Schedule 9 to the Act, and of all other enabling powers, and after consultation with the Chief Officer of Police in accordance with Part III of Schedule 9 to the Act hereby makes the following Order:-

Commencement and Citation

1. This Order shall come into operation on 11 May 2009 and may be cited as the "Borough of Eastleigh (Chandlers Ford and Hiltingbury) (Prohibition and Restriction of Waiting) (Disabled Persons Parking Places) (Amendment No.8) Order 2009".

Prohibition and Restriction of Waiting

2. In this Order the Principal Order means The Borough Of Eastleigh (Chandlers Ford and Hiltingbury) (Prohibition And Restriction Of Waiting) (Disabled Persons Parking Places) Order 2004
3. The Principal Order is hereby amended as follows:

(a) In Article 2 there shall be inserted:

"restricted zone" is all the lengths of road specified in the Ninth Schedule to this Order;

(b) In Article 3(1) the words "and are included in the First Schedule hereto" shall be deleted;

(c) In Article 20(a) there shall be inserted the words "and the Ninth Schedule Part A" after the words "First Schedule";

(d) In the First Schedule (No Waiting at Any Time) items 2, 3 and 4 relating to Bournemouth Road shall be revoked and replaced with:

- | | | |
|----|-----------------------|---|
| 2. | Bournemouth West Road | From its junction with Hursley Road in a southerly direction to the northern end of the lay-by outside 2-20 Bournemouth Road. |
| 3. | Bournemouth West Road | From the southern end of the lay-by outside 2-20 Bournemouth Road to the northern boundary of 39 Bournemouth Road. |

- | | | | |
|-----|------------------|------|--|
| 4. | Bournemouth Road | West | From the southern boundary of 48 Bournemouth Road in a southerly direction to the northern boundary of 86 Bournemouth Road. |
| 4B. | Bournemouth Road | West | From a point 18 metres south of the junction with Keble Close in a southerly direction to the northern boundary of 140 Bournemouth Road. |
| 4C. | Bournemouth Road | East | From its junction with Hursley Road in a southerly direction to its junction with the service road adjacent to 7 Bournemouth Road. |
| 4D. | Bournemouth Road | East | From the southern end of the lay-by outside 13 - 17 Bournemouth Road in a southerly direction to the northern end of the lay-by outside 49 Bournemouth Road. |
| 4E. | Bournemouth Road | East | From the southern end of the lay-by outside 49 Bournemouth Road in a southerly direction to a point 15m north of its junction with Leigh Road. |

(e) In the First Schedule (No Waiting at Any Time) after item number 24C relating to Hursley Road there shall be inserted:

- | | | | |
|------|----------------|------|--|
| 24D. | Hut Farm Place | Both | From its junction with Bournemouth Road in a easterly direction for a distance of 7metres. |
|------|----------------|------|--|

(f) After the Eighth Schedule there shall be inserted:

NINTH SCHEDULE
Restricted Zone

PART A: No Waiting at Any Time

- | | | | |
|----|----------------|------|---|
| 1. | Hut Farm Place | Both | For its entire length (excluding the lay-by on the north eastern side). |
|----|----------------|------|---|

PART B: Areas on the Highway designated as Parking Places

- | | | | |
|----|----------------|---------------|--------------------------------------|
| 1. | Hut Farm Place | North Eastern | In the lay-by for its entire length. |
|----|----------------|---------------|--------------------------------------|

Dated this day of 2009

THE COMMON SEAL of EASTLEIGH)
BOROUGH COUNCIL was hereunto)
affixed in the presence of:-)

Head of Legal & Democratic Services

DATED _____ 2009

BOROUGH OF EASTLEIGH

THE BOROUGH OF EASTLEIGH
(CHANDLERS FORD AND
HILTINBURY) (PROHIBITION AND
RESTRICTION OF WAITING)
(DISABLED PERSONS PARKING
PLACES) (AMENDMENT NO.8)
ORDER 2009

A R Ward
Head of Legal & Democratic Services
Eastleigh Borough Council
Civic Offices
Leigh Road
Eastleigh
Hampshire
SO50 9YN

\\EBC01-100\Users\Legal & Democratic Services\Democratic
Services\COMADMIN\TRAFORDS\DECRIM\NONCPZ\PARISHES\CFH\AMEND
NO8- HUT FARM PLACE\HUT FARM PLACE ORDER.DOC

Key to Restriction Types Displayed

- No waiting at any time
- - - Existing Restrictions

approx 3 car lengths of restriction to be removed



Bournemouth Road/Hut Farm Place Proposed Restrictions

SCALE	1 : 4000
DATE	26/11/2008
DRAWING No.	E/TM/01/N/14/001
DRAWN BY	JF
CHECKED BY	SRW

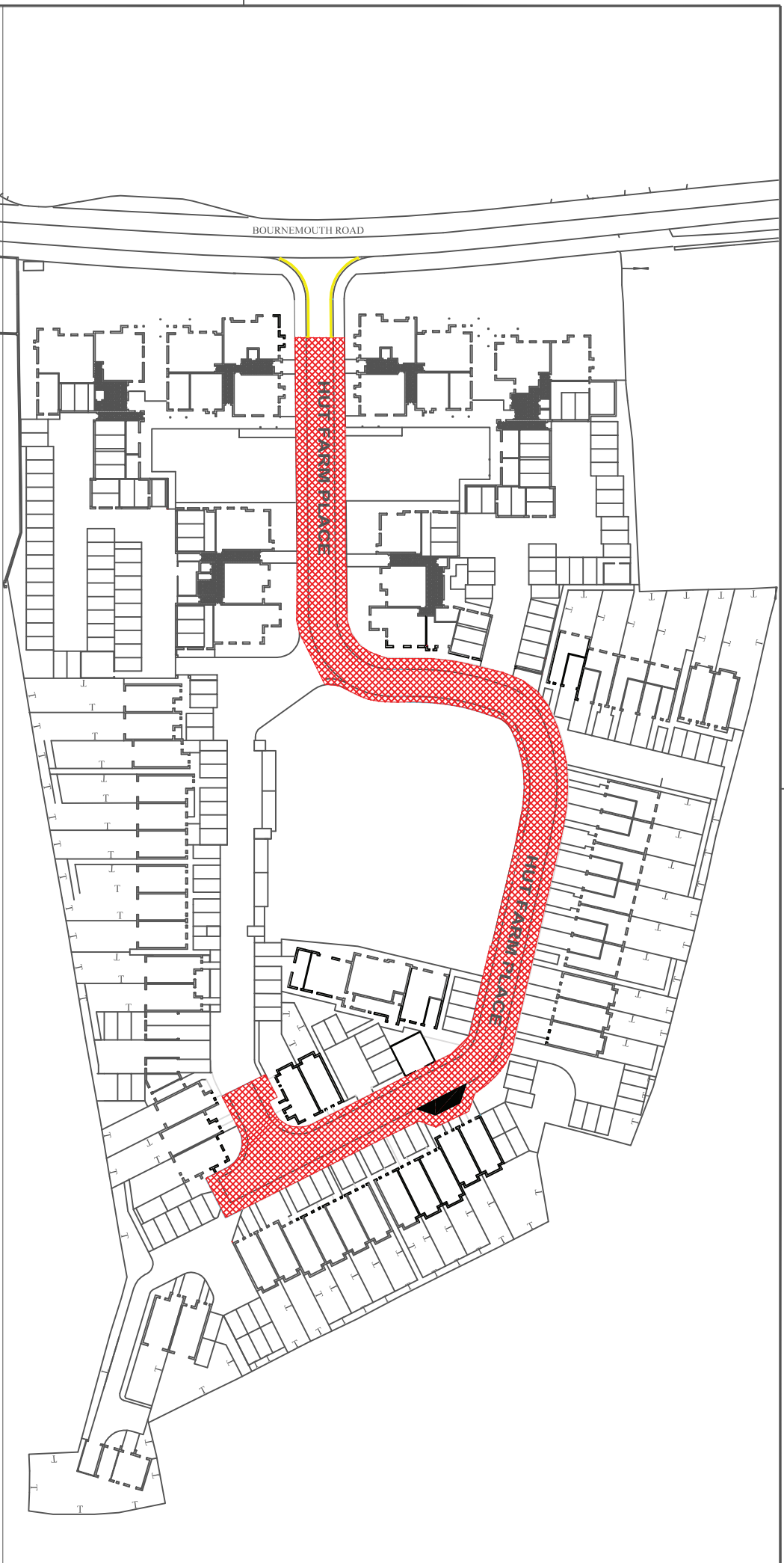

This plan contains extracts from the Ordnance Survey map with the permission of The Controller of Her Majesty's Stationery Office. Unauthorised reproduction infringes Crown copyright and may lead to prosecution or civil proceedings. Licence LA077860







Duncan Melvey B.Sc., C.Eng., M.I.C.E.
Head of Transportation & Engineering
Civic Offices
Leigh Road, Eastleigh
Hampshire, SO50 9YN
Telephone: (023) 8068 8000
Fax: (023) 8062 0908
Email: engineers@eastleigh.gov.uk

**Transportation
and
Engineering**

Scheme
Hendy Forde's Site - Parking Restrictions
Title
Hur Farm Place, Proposed Restricted Parking Zone

Scale @A4 1:1000	Date 12-02-2008	Drawn by JR
Drawing No 001	Project No E/TM/01/N/14	Checked by SRW

- KEY**
-  Restricted Zone
 -  No Waiting at Any Time except in marked parking spaces
 -  Parking space: 2hours limited waiting, Monday - Friday 8am - 6pm
 -  No Waiting at Any Time