

BOROUGH OF EASTLEIGH

THE BOROUGH OF EASTLEIGH (FACTORY ROAD AREA) (PROHIBITION AND RESTRICTION OF WAITING) (DISABLED PERSONS PARKING PLACES) (SECOND ZONE) (CONTROLLED ZONE) (AMENDMENT NO. 3) ORDER 2006

The Council of the Borough of Eastleigh (hereinafter referred to as "the Council") pursuant to arrangements made under Section 101 of the Local Government Act 1972 with the Hampshire County Council in exercise of the powers of the said County Council under Sections 1, 2 and 4 of the Road Traffic Regulation Act 1984 ("the Act") and Part IV of Schedule 9 to the Act, and of all other enabling powers, and after consultation with the Chief Officer of Police in accordance with Part III of Schedule 9 to the Act hereby makes the following Order:-

Commencement and Citation

1. This Order shall come into operation on 6 March 2006 and may be cited as the "Borough of Eastleigh (Factory Road Area) (Prohibition and Restriction of Waiting) (Disabled Persons Parking Places) (Second Zone) (Controlled Zone) (Amendment No. 3) Order 2006".

Revocation and amendments

2. The Borough of Eastleigh (Factory Road Area) (Residents Parking Places and Prohibition and Restriction of Waiting) (Disabled Persons Parking Places) (Second Zone) (Controlled Zone) Order 2004 is hereby amended as follows:

THIRD SCHEDULE - No Waiting at any time

- (i) Item 20 shall be deleted and replaced with the following

Road	Side	Description
20. Cranbury Road	Both	From a point 10 metres south of the junction of Leigh Road southwards for a distance of 5 metres.

- (ii) Item 27 shall be deleted and replaced with the following:

Road	Side	Description
27. Desborough Road	Both	From a point 10 metres south of the junction of Leigh Road southwards for a distance of 5 metres.

Dated this 27 day of february 2006

THE COMMON SEAL of EASTLEIGH)
BOROUGH COUNCIL was hereunto)
affixed in the presence of:-)

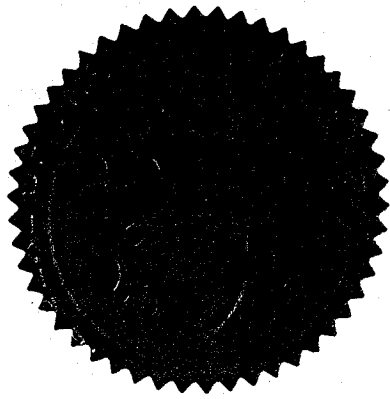

Wendi Peterson

Head of Legal & Democratic Services

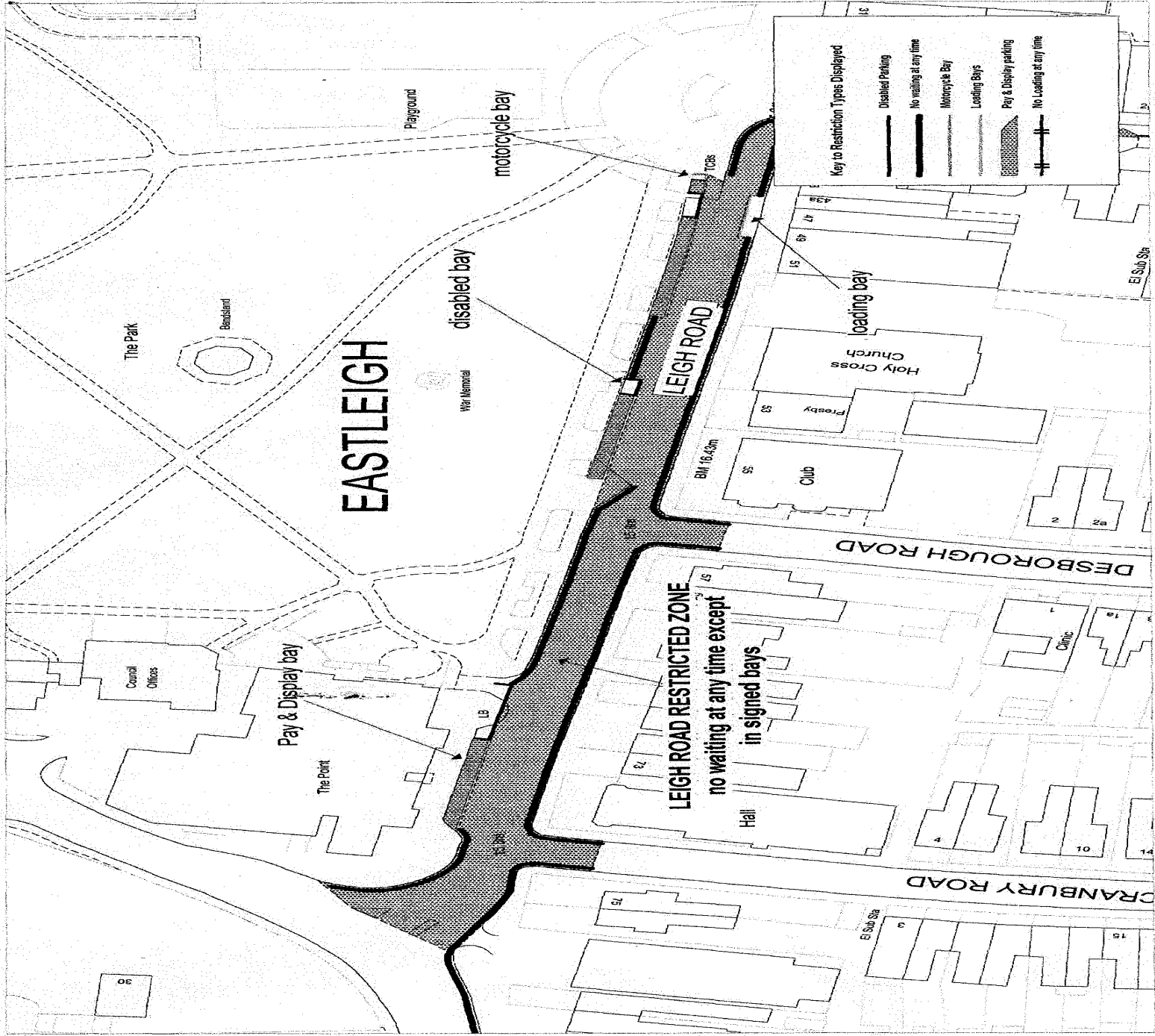

PROPOSED RESTRICTED ZONE: LEIGH ROAD

SCALE	1 : 1000
DATE	04/05/2005
DRAWING No.	ETM101P/22001
DRAWN BY	PG
CHECKED BY	SRW

(c) Crown copyright. All rights reserved.
Eastleigh Borough Council License No. 1001/0522 (2004)

DATED 22nd february 2006

THE BOROUGH OF EASTLEIGH
(FACTORY ROAD AREA)
(PROHIBITION AND RESTRICTION
OF WAITING) (DISABLED
PERSONS PARKING PLACES)
(SECOND ZONE) (CONTROLLED
ZONE) (AMENDMENT NO. 3)
ORDER 2006

A R Ward
Head of Legal & Democratic Services
Eastleigh Borough Council
Civic Offices
Leigh Road
Eastleigh
Hampshire
SO50 9YN

F:\COMADMIN\WORD\TRAFORDS\IDECRIM\6ZONES\FACTORY
AMENDMENTS\AMENDNO.X RESTRICTED ZONE\Factory Road Amend
No.3 Order.doc