

**The County Council of Durham (West Rainton, Pitlington, Sherburn and Ludworth)
(Parking and Waiting Restrictions) Order 2013 (Amendment No.1) Order 2021**

The County Council of Durham ("the Council") in exercise of their powers under Sections 1, 2, 4, 32 and 35 and Part IV of Schedule 9 to the Road Traffic Regulation Act 1984, as amended ("the Act") and Part 6 of the Traffic Management Act 2004, as amended and of all other enabling powers and after consultation with the Chief Officer of Police in accordance with Part III of Schedule 9 to the Act, hereby make the following Order:-

General

1. This Order may be cited as The County Council of Durham (West Rainton, Pitlington, Sherburn and Ludworth) (Parking and Waiting Restrictions) Order 2013 (Amendment No. 1) Order 2021 and shall come into operation on the 17th day of December 2021.

Amendments

2. The under-noted amendments have been made to the following Orders:

The County Council of Durham (West Rainton, Pitlington, Sherburn and Ludworth) (Parking and Waiting Restrictions) Order 2013.

Purpose of Amendments

The following brief synopsis of amendments should be viewed in conjunction with the plans identified within the Schedules to the above Order, however the plan(s) should prevail in the event of any discrepancy:

To introduce No Waiting At Any Time restrictions on:

- (a) The northern side of Front Street, both sides of the junction with Hallgarth Street from a point adjacent to Number 21 Front Street for 45 metres. – plan EH138 refers
- (b) The southern side of Front street, both sides of the junction with Hope Street from a point adjacent to Number 9 Peart Close for 31m on the eastern side and from a point adjacent to Number 80 Front Street for 56m on the western side. – plan EH138 refers.
- (c) Both sides of the junction of Hall Gardens with Front street for 18 metres - plan EH138 refers.
- (d) Both sides of the junction of Gray Avenue and Park Road for 34 metres – plans EH139 and EH140 refer.
- (e) The west side of the access of Pitlington Primary School for 10 metres – plan EJ144 refers.

To introduce to No Waiting and No Loading/Unloading At Any Time restrictions on:

- (a) Front Street, south side from a point adjacent to Number 80 Front Street in an easterly direction for 30 metres across the entrance to the Co-op Food Store – plan EH138 refers.

Schedules

Plans EH139 and EJ144 have been amended to reflect the changes to those restrictions noted in Article 2 above. Where these plans are referenced in the Schedules to the Order described in Article 2 above, new plans EH138 and EH140 bearing the seal date as at the date of this Amendment Order have been inserted.

Saving

3. In so far as any provision of this Order conflicts with any provision which is contained in an Order made or having effect as if made under the Act or by or under any other enactment then the provisions of this Order shall prevail.
4. The prohibitions and restrictions imposed by this Order shall be in addition to and not in derogation from any restriction or requirement imposed by any regulations made or having effect as if made under the Act or by or under any other enactment.

**MADE THIS 3rd DAY OF DECEMBER 2021 BY
THE AFFIXING OF THE COMMON SEAL OF THE COUNTY COUNCIL
OF DURHAM BY ORDER:**

.....
**AUTHORISED SIGNATORY
(A PERMANENT OFFICER OF THE COUNTY COUNCIL)**



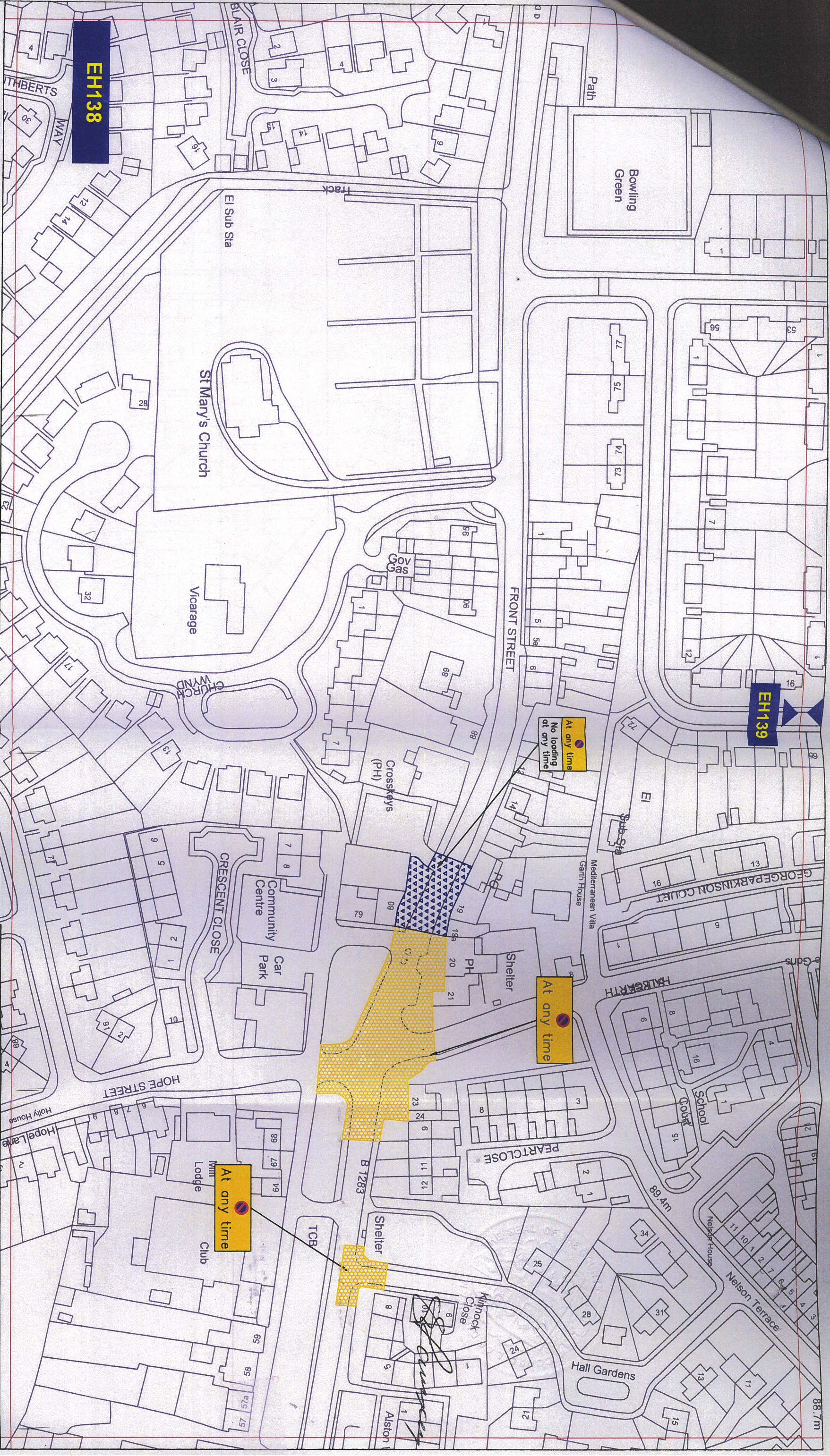

Key to Types of Restriction

No Waiting At Any Time

No Waiting and No Loading/Unloading At Any Time

XXXXX Individual Reference Number



Corporate Director
Regeneration & Economic
Development

Strategic Traffic Management
County Hall, Durham DH1 5UQ

THE COUNTY COUNCIL OF DURHAM
SHERBURN
PARKING AND WAITING RESTRICTIONS
FINAL

Scale: 1:1250 @ A3

Date: July 2021

Drawn by: T. Burton

Date Sealed:

Signature: T. Burton

Map Schedule: EH138

PATH:

Reproduced from Ordnance Survey material with the permission of Ordnance Survey on behalf of the Controller of Her Majesty's Stationery Office @ Crown copyright. Unauthorised reproduction infringes Crown copyright and may lead to prosecution or civil proceedings. Durham County Council. LA 100049055. 2021.

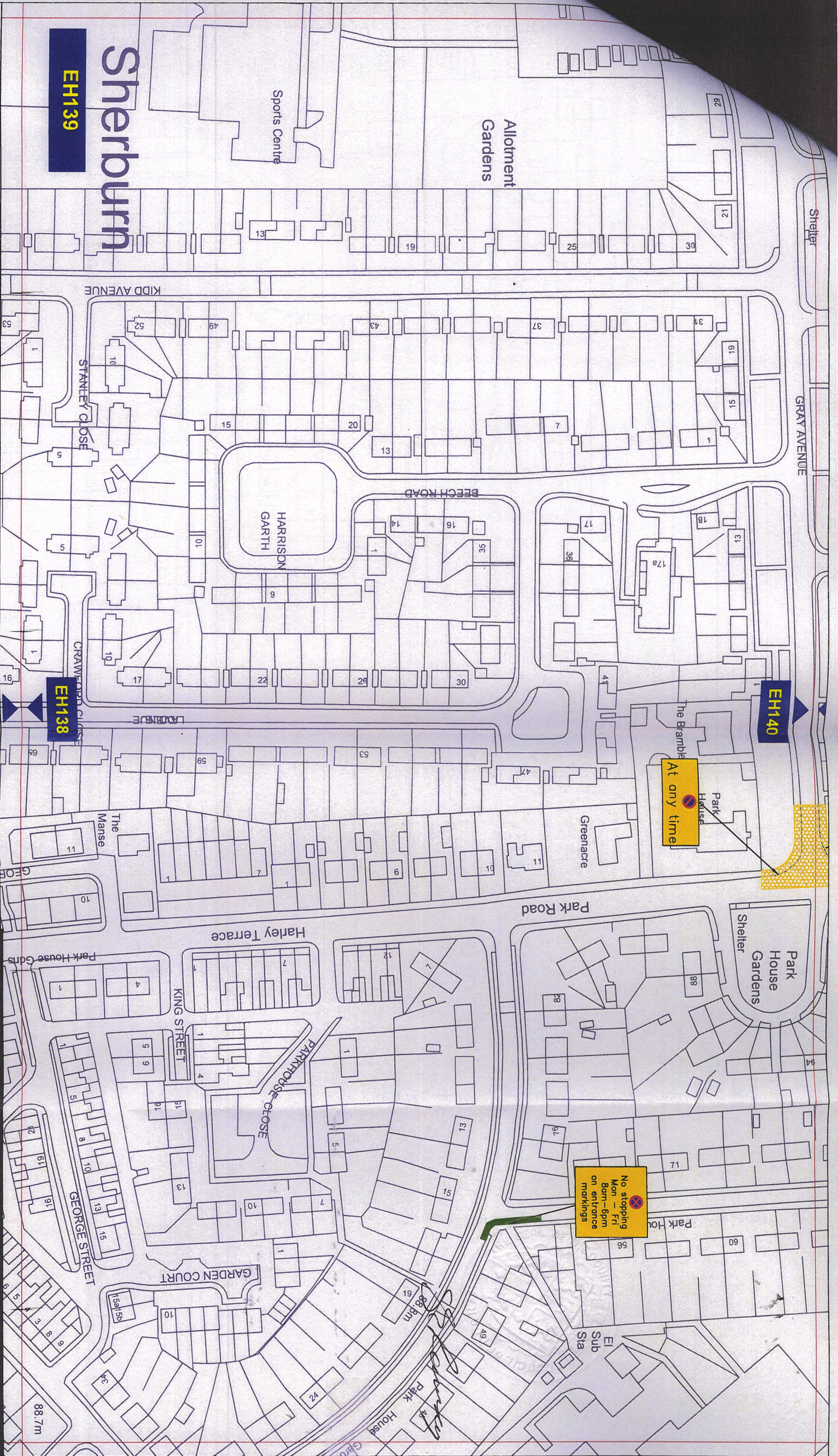

Sherburn

EH139

Key to Types of Restriction



No Waiting At Any Time



No Stopping



Individual Reference Number



Corporate Director
Regeneration Economy and
Growth

Strategic Traffic Management

County Hall, Durham DH1 5UQ

THE COUNTY COUNCIL OF DURHAM
WEST RAINTON, PITTINGTON, SHERBURN, LUDWORTH &
SHOTTON COLLIERY
PARKING AND WAITING RESTRICTIONS
FINAL

Scale: 1:1250 @ A3

Date: July 2021

Drawn by: T. Burton

Signature: *T. Burton*

Date Sealed:

Map Schedule: EH139

PATH:

Reproduced from Ordnance Survey material with the permission of Ordnance Survey on behalf of the Controller of Her Majesty's Stationery Office © Crown copyright. Unauthorised reproduction infringes Crown copyright and may lead to prosecution or civil proceedings. Durham County Council. LA 100049055. 2021.

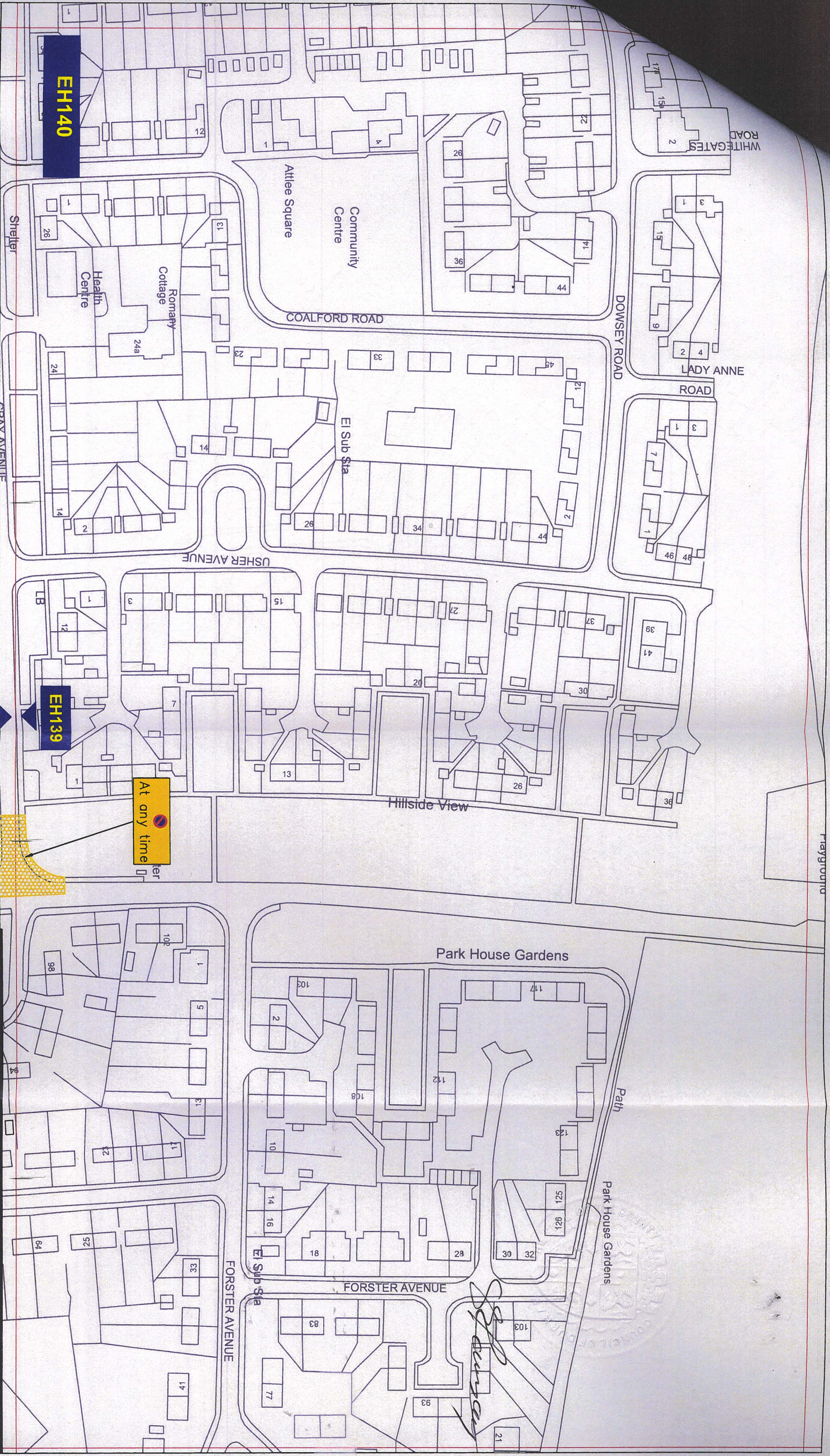

Key to Types of Restriction

 No Waiting At Any Time

 Individual Reference Number



Corporate Director
Regeneration Economy and
Growth
Strategic Traffic Management
County Hall, Durham DH1 5UQ

THE COUNTY COUNCIL OF DURHAM
WEST RAINTON, PITTINGTON, SHERBURN, LUDWORTH &
SHOTTON COLLIERY
PARKING AND WAITING RESTRICTIONS
FINAL

Scale: 1:1250 @ A3

Date: July 2021

Drawn by: T. Burton Signature: *T. Burton*

Date Sealed: Map Schedule: **EH140**

PATH:

Reproduced from Ordnance Survey material with the permission of Ordnance Survey on behalf of the Controller of Her Majesty's Stationary Office @ Crown copyright. Unauthorised reproduction infringes Crown copyright and may lead to prosecution or civil proceedings. Durham County Council. LA 100049055. 2021.

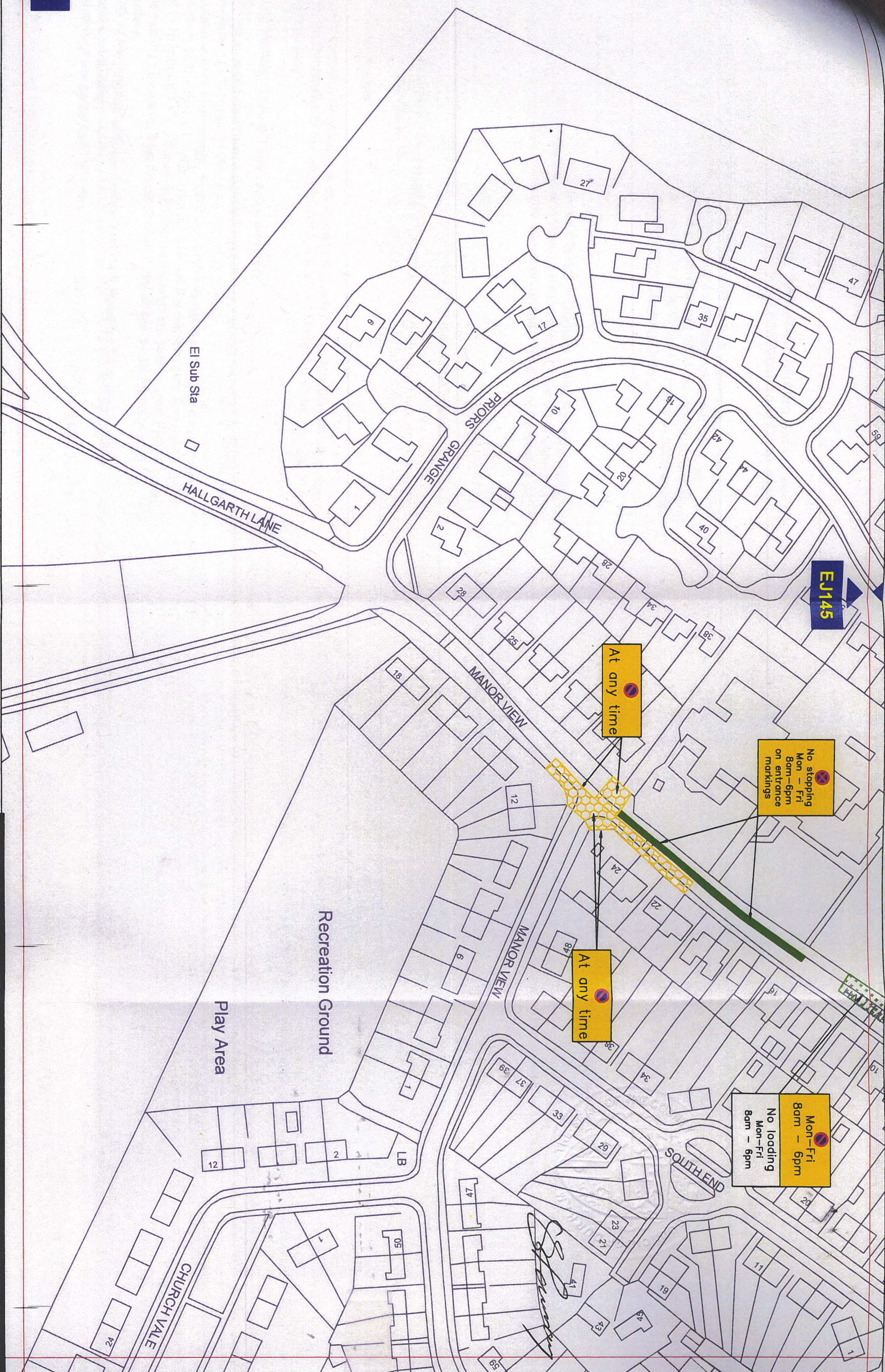

EJ145

No stopping
Mon - Fri
8am - 6pm
on entrance
markings

Mon-Fri
8am - 6pm
No loading
Mon-Fri
8am - 6pm

At any time

At any time

EJ144

Key to Types of Restriction

- No Waiting At Any Time
- No Stopping
- Restricted Waiting and Loading/Unloading

XXXXX Individual Reference Number



Corporate Director
Regeneration Economy and Growth
Strategic Traffic Management
County Hall, Durham DH1 5UQ

THE COUNTY COUNCIL OF DURHAM
WEST RAINTON, PITTINGTON, SHERBURN, LUDWORTH &
SHOTTON COLLIERY
PARKING AND WAITING RESTRICTIONS
FINAL



Scale:	1:1250 @ A3
Date:	July 2021
Drawn by:	T. Burton
Signature:	<i>T. Burton</i>
Date Sealed:	
Map Schedule:	EJ144