

**THE COUNTY COUNCIL OF DURHAM
(FERRYHILL)
(PROHIBITION AND RESTRICTION OF WAITING, LOADING, STOPPING
& PARKING PLACES)
ORDER 2011 (AMENDMENT No. 1) ORDER 2024**

The County Council of Durham ("the Council") in exercise of their powers under Sections 1, 2, 4, 32 and 35 and Part IV of Schedule 9 to the Road Traffic Regulation Act 1984, as amended ("the Act") and Part 6 of the Traffic Management Act 2004, as amended and of all other enabling powers and after consultation with the Chief Officer of Police in accordance with Part III of Schedule 9 to the Act, hereby make the following Order:-

PART I

1. General

This Order may be cited as The County Council of Durham (Ferryhill) (Prohibition and Restriction of Waiting, Loading, Stopping & Parking Places) Order 2011 (Amendment No. 1) Order 2024 and shall come into operation on the 17th day January of 2025.

PART II

2. Articles

New article numbered 9 has been inserted and will read as follows and all existing articles numbered accordingly

Prohibition of Waiting and Loading/Unloading Mon-Fri 7:30am – 4pm

9. Save as provided in Article 13 of this Order no person shall, except upon the direction or with the permission of an enforcement officer, cause or permit any vehicle to:
- a. wait, or
 - b. wait for the purpose of enabling goods to be loaded onto or unloaded from the vehicle, at such times, on any of the lengths of roads or sides of lengths of roads identified within the individual plans detailed in Schedule 11 to this Order.

3. Amendments

The under-noted amendments have been made to the following Order:

The County Council of Durham (Ferryhill) (Prohibition and Restriction of Waiting, Loading, Stopping & Parking Places) Order 2011

Purpose of Amendments

The following brief synopsis of amendments should be viewed in conjunction with the plans identified within the Schedules to the above Order, however the plan(s) should prevail in the event of any discrepancy:

To introduce 'No Waiting At Any Time' restrictions on:

- a. Eastern side of Kitchener Terrace from the junction with the C26 Broom Road for 49 metres in a southerly direction. – Plan EC101 Refers
- b. Northeast side of the junction from Mainsforth Road leading into Dennison Terrace in a northerly direction for 15 metres. – Plan EE100 Refers
- c. Southern side of the junction from C26 leading into Cleves Court in a northerly direction for 28 metres. – Plan ED104 Refers
- d. Northern side of the junction from C26 leading into Cleves Court in a southerly direction for 15 metres. – Plan ED104 Refers
- e. Southeast side of the junction from Broom Road leading into Bede Terrace in a northwest direction for 24 metres. – Plan EC102 Refers
- f. Northwest side of the junction from Broom Road leading into Bede Terrace in a southerly direction for 10 metres. – Plan EC102 Refers
- g. Southeast side of the junction from Broom Road leading into Milford Terrace in a northerly direction for 16 metres. – Plan EC102 Refers
- h. Northwest side of the junction from Broom Road leading into Milford Terrace in a southerly direction for 12 metres. – Plan EC102 Refers

To introduce to no waiting and no loading/unloading Mon-Fri 7:30am – 4pm on:

- a. Northwest side of Merrington Road from a point 5m northeast from existing pedestrian refuge for 35m southwest. – Plan DY101 Refers
- b. Northwest side of Merrington Road from existing 'School Keep Clear' for 81m southwest. – Plan DY100 Refers
- c. Northwest side of Merrington Road from the southwest entrance of Ferryhill Comprehensive school for 52m southwest. – Plan DY100 Refers
- d. Southwest side of Merrington Road from a point 5m northeast from existing pedestrian refuge for 243m southwest. – Plan DY100 & DY101 Refers

To amend the operational hours of existing restriction 'No Stopping Mon-Fri 8am-6pm' to No Stopping Mon-Fri 7:30am-4pm' on:

Northwest side of Merrington Road from a point adjacent to 42 Joseph Patterson Crescent in a southwest direction for 58 metres. **Plan DY100 & DY101 Refers**

4.SCHEDULES

The following amendments have been made to the Schedules:

New Schedule number 11 has been inserted to read as follows:-

Schedule 11
Prohibition of Waiting and Loading/Unloading Mon-Fri 7:30am – 4pm
Plan reference number(s): DY100, DY101

New plans DY100, DY101, ED104, EE100 have been inserted into the Schedules of the order to reflect the changes to the restrictions noted in Article 3 above. Where these plans are referenced in the Schedules to the Order described in Article 3 above, new plans bearing the seal date as at the date of this Amendment Order have been inserted.

PART III

5. Saving

In so far as any provision of this Order conflicts with any provision which is contained in an Order made or having effect as if made under the Act or by or under any other enactment then the provisions of this Order shall prevail.

The prohibitions and restrictions imposed by this Order shall be in addition to and not in derogation from any restriction or requirement imposed by any regulations made or having effect as if made under the Act or by or under any other enactment.

**MADE THIS 3rd DAY OF JANUARY 2025 BY
THE AFFIXING OF THE COMMON SEAL OF THE COUNTY COUNCIL
OF DURHAM BY ORDER:**



**AUTHORISED SIGNATORY
(A PERMANENT OFFICER OF THE COUNTY COUNCIL)**



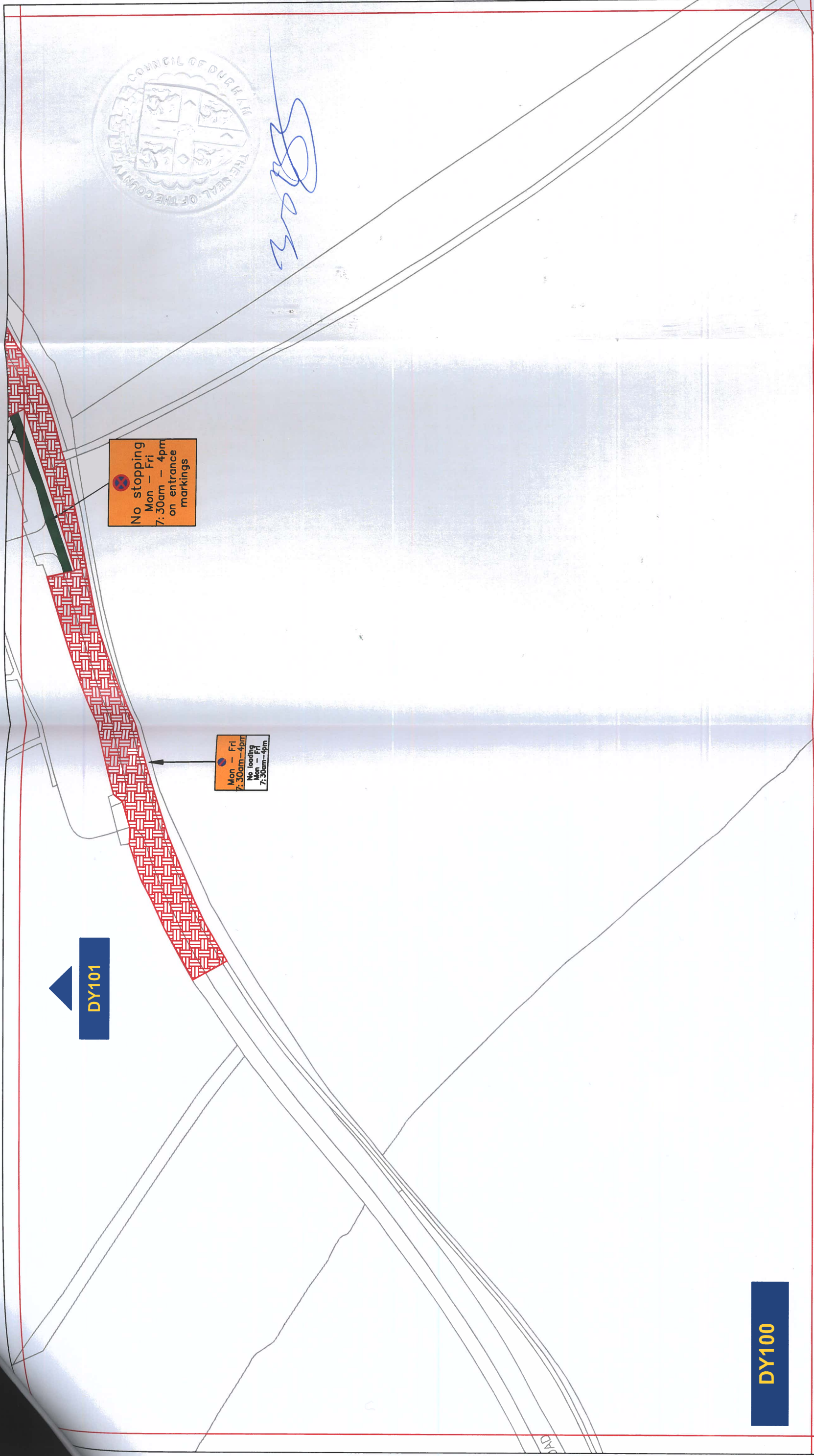

DY100

DY101

No stopping
Mon - Fri
7:30am - 4pm
on entrance
markings

Mon - Fri
7:30am - 4pm
No loading
Mon - Fri
7:30am - 4pm

Key to Types of Restriction

 Proposed Restricted Waiting

 Proposed No Stopping

PATH: L:\TRAFFIC\PROJ\06 REGULATION DESIGN & IMPLEMENTATION\Settlement\FerryhillTraffic Regulation Orders (Parking Restrictions)2022 - September\Legal Documentation\Drawings

Reproduced from Ordnance Survey material with the permission of Ordnance Survey on behalf of the Controller of His Majesty's Stationary Office © Crown copyright. Unauthorised reproduction infringes Crown copyright and may lead to prosecution or civil proceedings. Durham County Council, LA 100049055, 2023.



Durham
County Council

Corporate Director
Regeneration Economy and
Growth

Strategic Traffic Management
County Hall, Durham DH1 5UQ

THE COUNTY COUNCIL OF DURHAM
(FERRYHILL)
(PARKING AND WAITING RESTRICTIONS)
FINAL

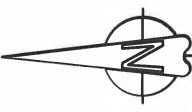

Scale: 1:1250 @ A3
Date: 25/01/2023
Drawn by: J. Wraith
Date Sealed:
Signature: *J. Wraith*
Map Schedule: **DY100**

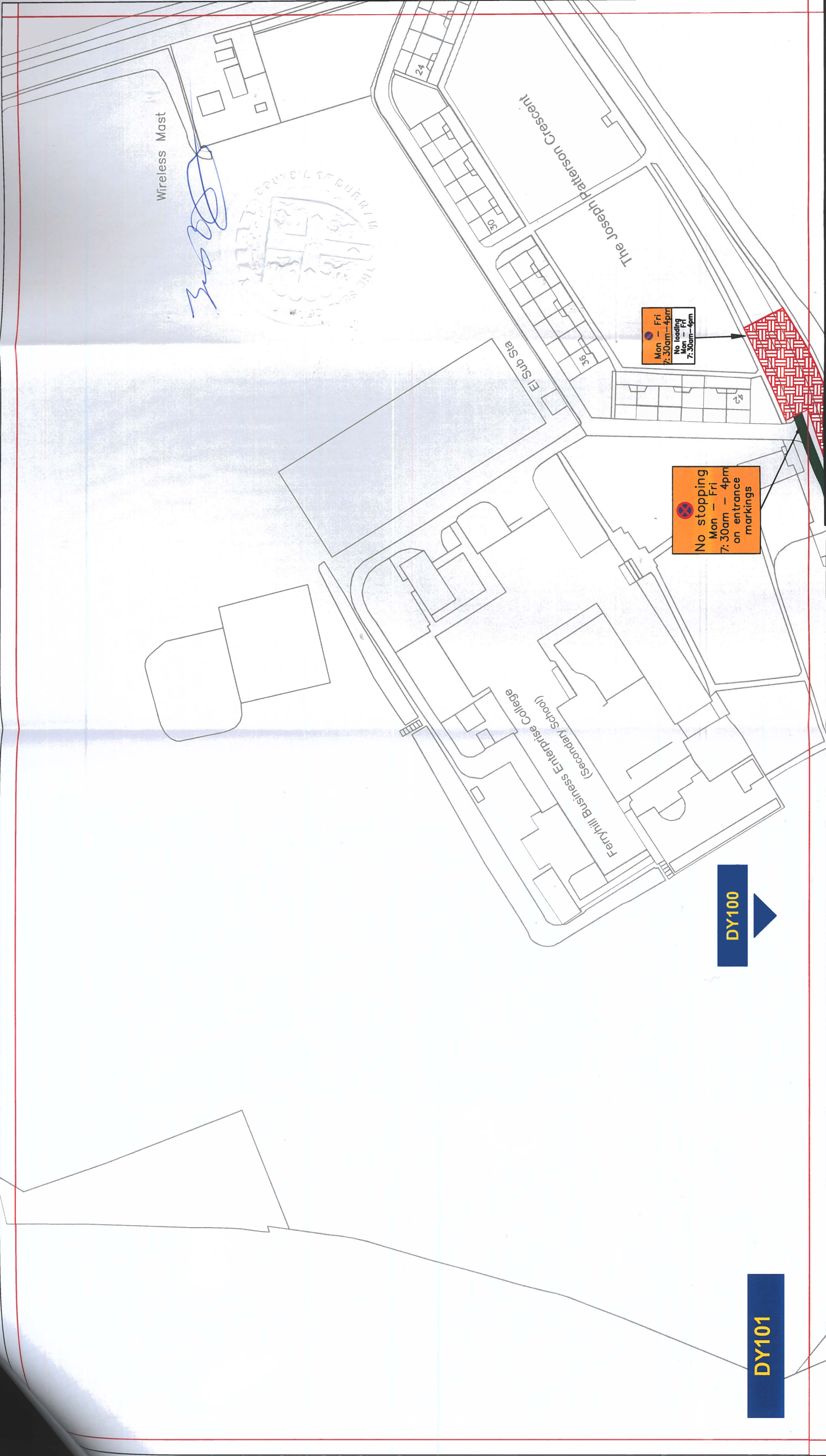

Key to Types of Restriction

 Proposed Restricted Waiting

 Proposed No Stopping

PATH: L:\TRAFFPROJ\06 REGULATION DESIGN & IMPLEMENTATION\Settlement\Ferryhill\Traffic Regulation Orders (Parking Restrictions)\2022 - September\Legal Documentation\Drawings

Reproduced from Ordnance Survey material with the permission of Ordnance Survey on behalf of the Controller of His Majesty's Stationary Office © Crown copyright. Unauthorised reproduction infringes Crown copyright and may lead to prosecution or civil proceedings. Durham County Council. LA 100049055, 2023.



Corporate Director
Regeneration Economy and
Growth

Strategic Traffic Management
County Hall, Durham DH1 5UQ

THE COUNTY COUNCIL OF DURHAM
(FERRYHILL)
(PARKING AND WAITING RESTRICTIONS)
FINAL

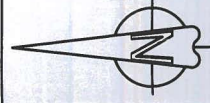

Scale: 1:1250 @ A3

Date: 25/01/2023

Drawn by: J.Wraith

Signature: *J.Wraith*

Date Sealed:

Map Schedule: **DY101**

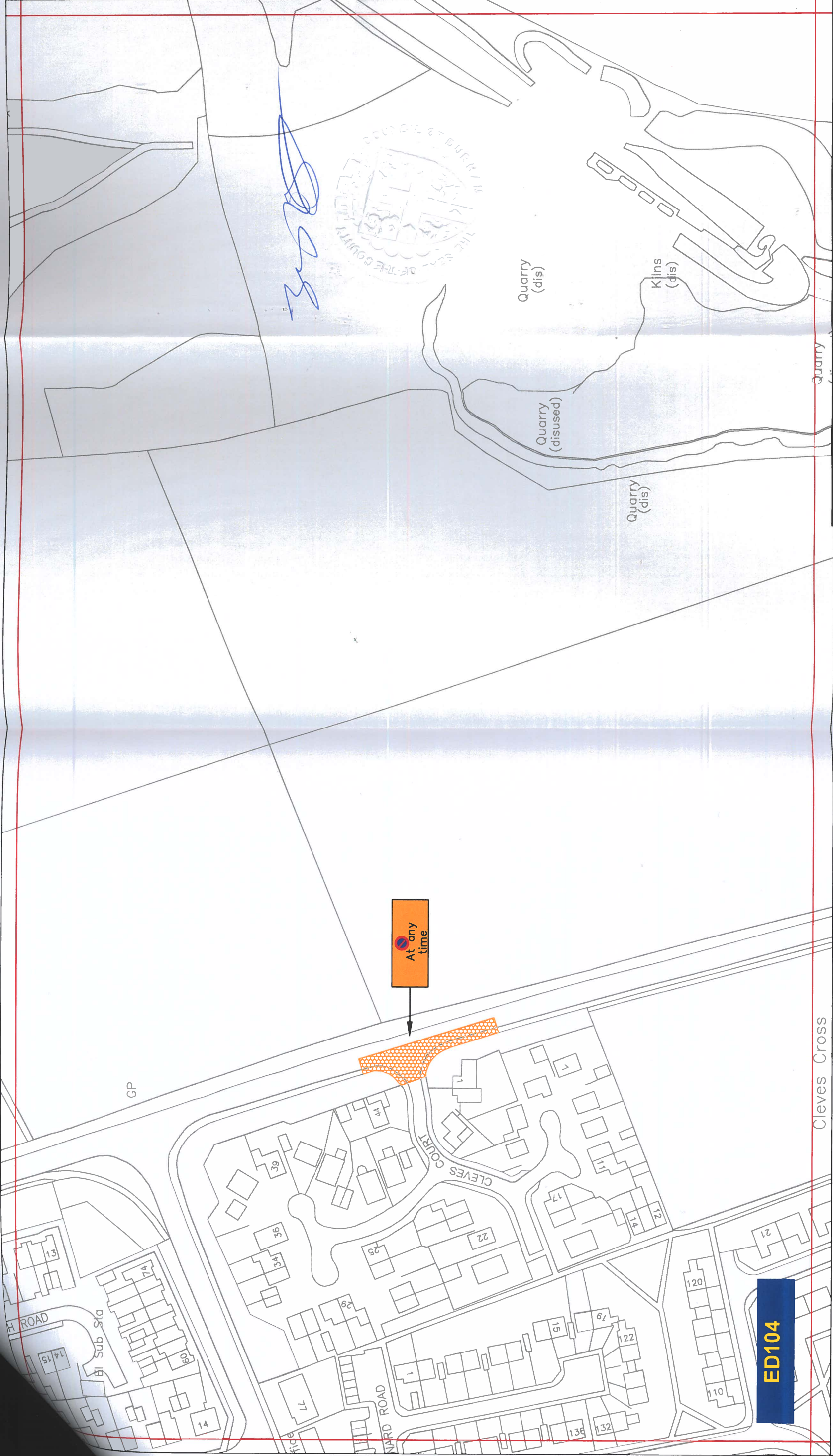

Key to Types of Restriction

 No Waiting At Any Time

ED104

At any time



Durham
County Council

Corporate Director
Regeneration Economy and Growth

Strategic Traffic Management
County Hall, Durham DH1 5UQ

THE COUNTY COUNCIL OF DURHAM
(FERRYHILL)
(PARKING AND WAITING RESTRICTIONS)
FINAL

Scale: 1:1250 @ A3
Date: 25/01/2023
Drawn by: J. Wraith
Date Sealed:

Signature: *J. Wraith*
Map Schedule: **ED104**

Reproduced from Ordnance Survey material with the permission of Ordnance Survey on behalf of the Controller of His Majesty's Stationary Office © Crown copyright. Unauthorised reproduction infringes Crown copyright and may lead to prosecution or civil proceedings. Durham County Council. LA 100049055. 2023.

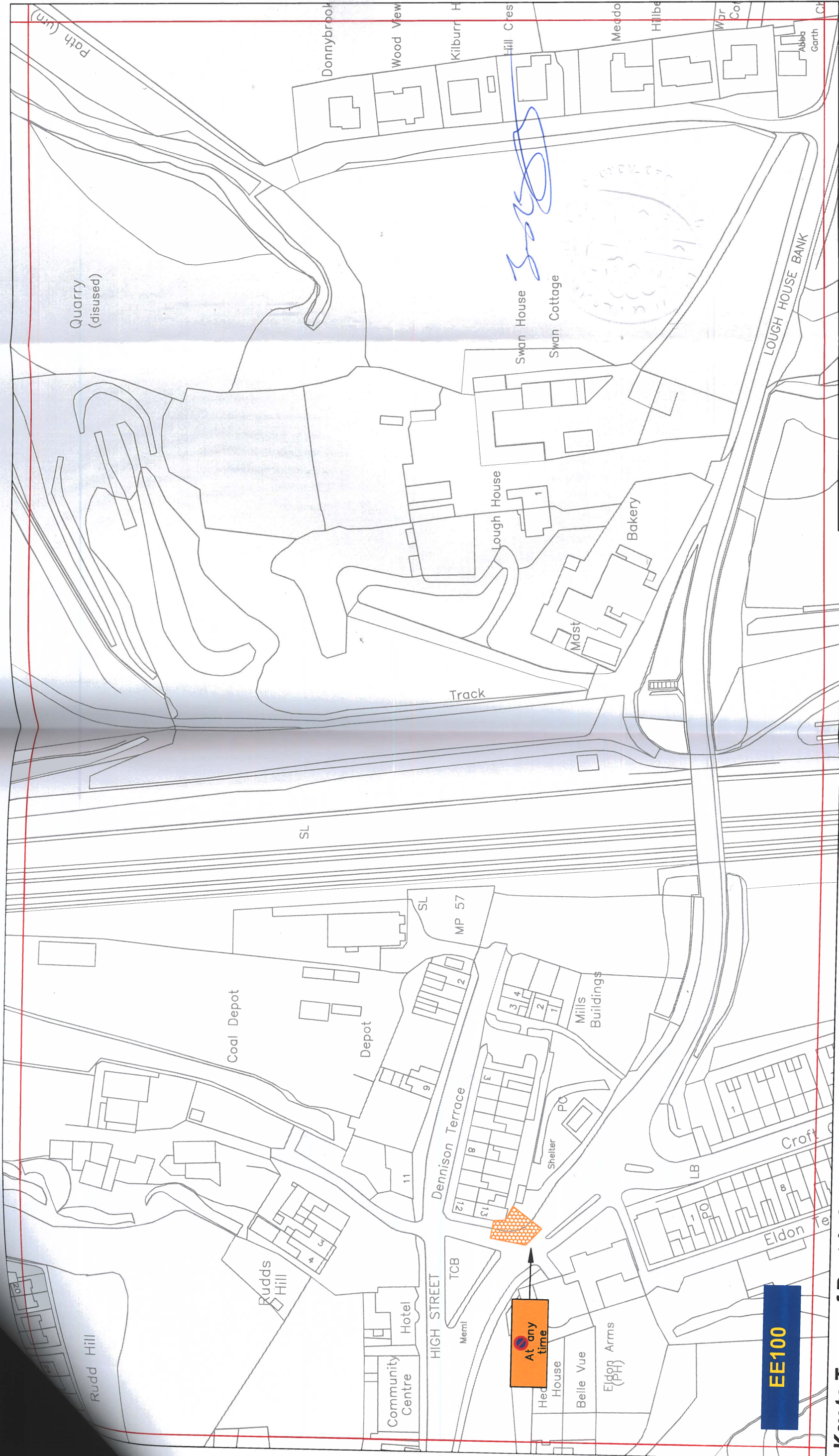

Key to Types of Restriction

 No Waiting At Any Time

PATH: L:\TRAFFIC\REGULATION\DESIGN & IMPLEMENTATION\Settlement\Ferryhill\Traffic Regulation Orders (Parking Restrictions)\2022 - September\Legal Documentation\Drawings

Reproduced from Ordnance Survey material with the permission of Ordnance Survey on behalf of the Controller of His Majesty's Stationary Office © Crown copyright. Unauthorised reproduction infringes Crown copyright and may lead to prosecution or civil proceedings. Durham County Council. LA 100049055. 2023.



Corporate Director
Regeneration Economy and Growth

Strategic Traffic Management
County Hall, Durham DH1 5UQ

THE COUNTY COUNCIL OF DURHAM
(FERRYHILL)
(PARKING AND WAITING RESTRICTIONS)
FINAL

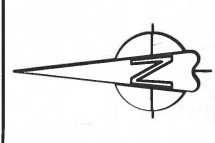

Scale:	1:1250 @ A3		
Date:	25/01/2023		
Drawn by:	J. Wraith	Signature:	<i>J. Wraith</i>
Date Sealed:		Map Schedule:	EE100