

**THE COUNTY COUNCIL OF DURHAM
(GREENLAND INFANT AND JUNIOR SCHOOLS, SOUTH MOOR)
(TRAFFIC MANAGEMENT)
ORDER 2008**

The County Council of Durham ("the Council") in exercise of their powers under Sections 1, 2 and 4 of the Road Traffic Regulation Act 1984, as amended, ("the Act") and of all other enabling powers and after consultation with the Chief Officer of Police in accordance with Part III of Schedule 9 to the Act hereby make the following Order:-

Part I

General

1. This Order may be cited as The County Council of Durham (Greenland Infant and Junior Schools, South Moor) (Traffic Management) Order 2008 and shall come into operation on 6 December 2008.

Interpretation

2. In this Order the following expressions have the meanings hereby respectively assigned to them:-

"enforcement officer" means a uniformed police officer, police community support officer or any subsequent designation of these officers.

Part II

Prohibition of Stopping on School Entrance Markings

3. Save as provided in Article 5 of this Order no person shall, except upon the direction or with the permission of an enforcement officer, cause or permit any vehicle to wait or stop Monday to Friday between the hours of 8.00 a.m. and 6.00 p.m. on the lengths of road or sides of lengths of road detailed in the Schedule 1 of this Order.

Prohibition of Waiting Monday to Saturday between the hours of 8.00am and 6.00pm

4. Save as provided in Article 5 of this Order no person shall, except upon the direction or with the permission of an enforcement officer, cause or permit any vehicle to wait Monday to Saturday between the hours of 8.00am and 6.00pm in or on any of the lengths of roads or sides of lengths of roads specified in Schedule 2 to this Order.

Part III

Exceptions

5. (1) Nothing in Articles 3 and 4 of this Order shall apply to a vehicle being used for police, fire brigade or ambulance purposes.
- (2) Nothing in Article 3 of this Order shall apply to anything done in accordance with any restrictions or requirements indicated by traffic signs placed on the roads by or on behalf of Durham Constabulary.
- (3) Nothing in Article 4 of this Order shall render it unlawful to cause or permit any vehicle to wait in the lengths of roads or sides of lengths of roads referred to therein for so long as may be necessary to enable:-
- (a) the vehicle, if it cannot conveniently be used for such purpose in any other road, to be used in connection with any of the following operations namely –
 - (i) building or demolition;
 - (ii) the removal of any obstruction to traffic;
 - (iii) the maintenance, improvement or reconstruction of the said roads;
 - (iv) the laying, erection, alteration or maintenance in or in land adjacent to the said lengths of roads of any sewer, main, pipe or apparatus for the supply of gas, water or electricity or any telecommunications apparatus as defined in the Telecommunications Act 1984;
 - (b) the vehicle if it cannot conveniently be used for such purpose in any other road to be used in the service of a local authority or water authority in pursuance of statutory duties;

Part IV

Saving

6. In so far as any provision of this Order conflicts with any provision which is contained in an Order made or having effect as if made under the Act or by or under any other enactment then the provisions of THIS Order shall prevail.

7. The restrictions imposed by this Order shall be in addition to and not in derogation from any restriction or requirement imposed by any regulations made or having effect as if made under the Act or by or under any other enactment.

Schedule 1

Prohibition of Stopping on School Entrance markings Monday to Friday 8.00 a.m. to 6.00 p.m.

<u>Location</u>	<u>Description</u>
School Terrace	West side from a point 7.8m north of its junction line with Rydal Avenue in a northerly direction for a distance of 43.56m.
Rydal Avenue	North side from a point 5.3m east of the centre line of its junction with Rydal Avenue (side) in an easterly direction for a distance of 43.56m.
Keswick Road (side) & Rydal Avenue (side)	East sides from a point 16.3m south of its junction with Keswick Road (side) and School Lane in a southerly direction for a distance of 31.56m

Schedule 2

Prohibition of Waiting Monday to Saturday between the hours of 8.00am and 6.00pm

<u>Location</u>	<u>Description</u>
Rydal Avenue	North side from the centre line of its junction with School Terrace in a westerly direction for a distance of 9.8m
Rydal Avenue	North side from the centre line of its junction with Rydal Avenue (side) in an easterly direction for a distance of 5.3m
School Terrace	West side from its junction with Rydal Avenue in a northerly direction for a distance of 7.8m

Rydal Avenue (side)

East side from its junction with Rydal Avenue in a northerly direction for a distance of 24.0m

Given under the Common Seal of the Council this 5th day of December 2008 .

B. Smith

Authorised Sealing Officer

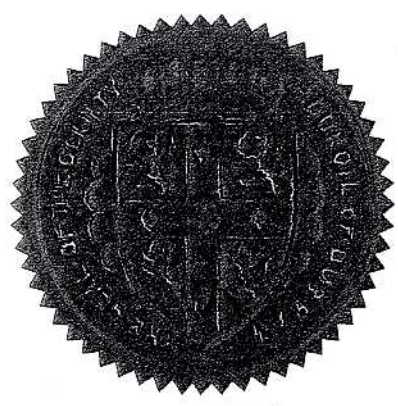

45668

I CERTIFY THIS IS A TRUE COPY OF THE ORIGINAL

THE COUNTY COUNCIL OF DURHAM
(GREENLAND INFANT & JUNIOR SCHOOLS, SOUTH MOOR)
(TRAFFIC MANAGEMENT)
ORDER 2008



①
No stopping
Mon - Fri
8 am - 6pm
on entrance
markings

No stopping at school
entrance signs. (during
periods indicated)

②
Mon - Sat
8 am - 6pm

No waiting during
period
indicated

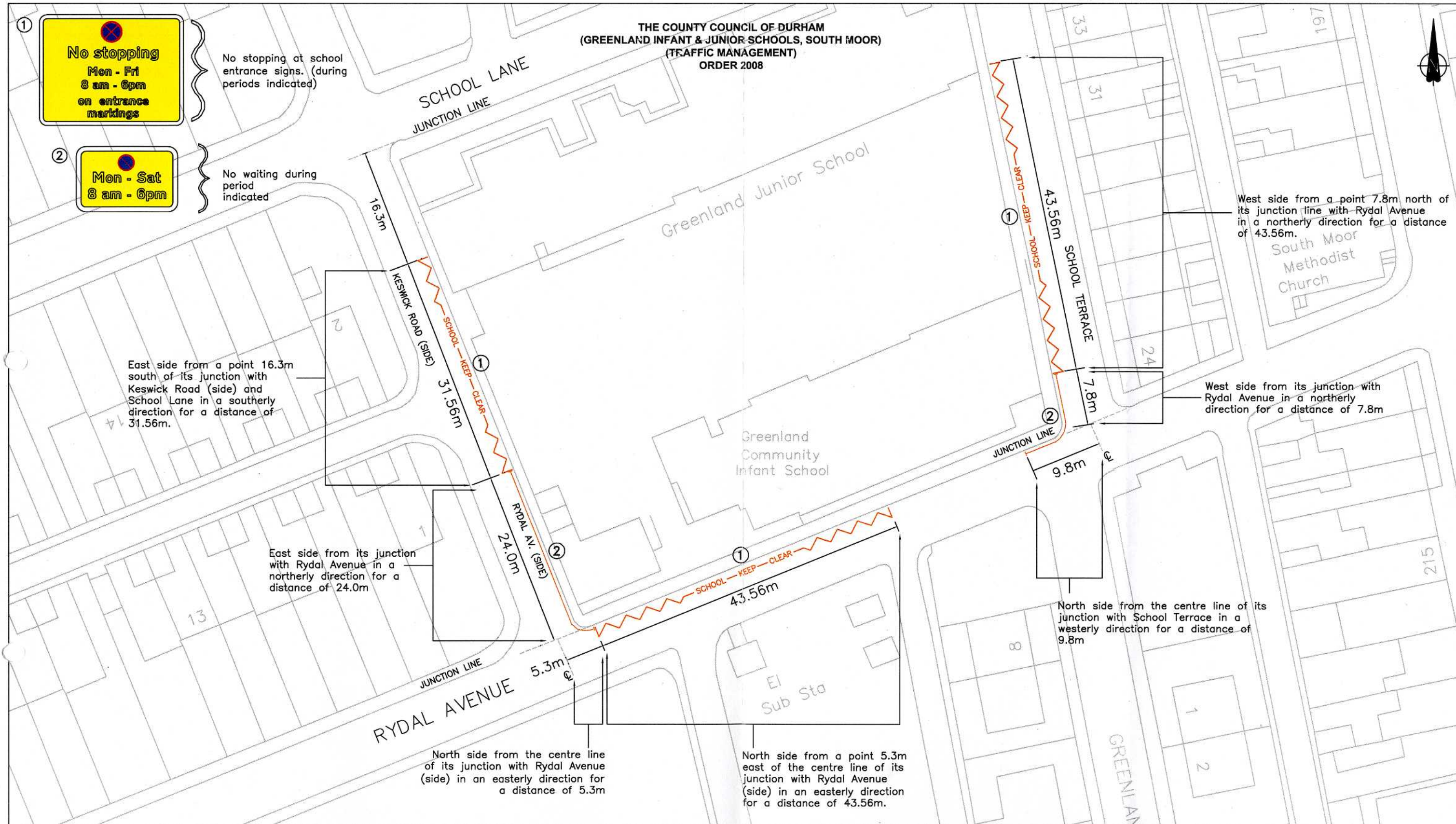

East side from a point 16.3m
south of its junction with
Keswick Road (side) and
School Lane in a southerly
direction for a distance of
31.56m.

East side from its junction
with Rydal Avenue in a
northerly direction for a
distance of 24.0m

North side from the centre line
of its junction with Rydal Avenue
(side) in an easterly direction for
a distance of 5.3m

North side from a point 5.3m
east of the centre line of its
junction with Rydal Avenue
(side) in an easterly direction
for a distance of 43.56m.

West side from a point 7.8m north of
its junction line with Rydal Avenue
in a northerly direction for a distance
of 43.56m.

West side from its junction with
Rydal Avenue in a northerly
direction for a distance of 7.8m

North side from the centre line of its
junction with School Terrace in a
westerly direction for a distance of
9.8m

This map is reproduced from Ordnance Survey material with the permission of Ordnance Survey on behalf of the Controller of Her Majesty's Stationery Office © Crown copyright. Unauthorised reproduction infringes Crown copyright and may lead to prosecution or civil proceedings. Durham County Council 076589 2001.

Rev/ Amdt	Drawn By		Approved By			Description Of Amendments
	Name	Date	Name	Date	Sign	
0/-	P STOREY	SEP 08	I HENRY	SEP 08	<i>I Henry</i>	

Making a difference where you live

HIGHWAY MANAGEMENT SERVICES

CORPORATE DIRECTOR OF ENVIRONMENT
COUNTY HALL, DURHAM. DH1 5UQ

Project GREENLAND INFANT & JUNIOR SCHOOLS, SOUTH MOOR	
Drawing TRO DRAWING - SCHOOL KEEP CLEARS - NO WAITING 8am - 6pm MON - SAT	
Scales 1:500	Project/Drawing No. TRO 01