

THE COUNTY COUNCIL OF DURHAM
(BYRON PLACE, SEAHAM)
(TRAFFIC MANAGEMENT) ORDER 2007

The County Council of Durham ("the Council") in exercise of their powers under Sections 1, 2, 4, 32, 35 and Part IV of Schedule 9 to the Road Traffic Regulation Act 1984, as amended, ("the Act") and of all other enabling powers and after consultation with the Chief Officer of Police in accordance with Part III of Schedule 9 to the Act, hereby make the following Order:-

General

1. This Order may be cited as The County Council of Durham (Byron Place, Seaham) (Traffic Management) Order 2007 and shall come into operation on 1 November 2007.

Interpretation

2. In this Order the following expressions have the meanings hereby respectively assigned to them:-

"buses" has the same meaning as in Regulation 22 of the Traffic Signs Regulations 2002;

"goods vehicle" means a motor vehicle constructed or adapted for use for the carriage of goods, or a trailer so constructed or adapted;

"pedal cycle" means a pedal cycle or pedal tricycle, not being in either case a motor vehicle;

"disabled person's badge" has the same meaning as in the Disabled Person's (Badges for Motor Vehicles) (England) Regulations 2000;

"parking disc" means a device, issued by a local authority and has not ceased to be in force, 125 millimetres square coloured blue, if issued on or after 1 April 2000, or orange if issued before that date and capable of showing the quarter hour period during which a period of waiting began;

"Universal service provider" has the same meaning as in the Postal Services Act 2000.

- (2) For the purposes of this Order a vehicle shall be regarded as displaying –
 - (a) A disabled person's badge in the relevant position if –
 - (i) the badge is exhibited on the dashboard or fascia of the vehicle; or

- (ii) where the vehicle is not fitted with a dashboard or fascia, the badge is exhibited in a conspicuous position on the vehicle;

So that the front of the badge is clearly legible from the outside of the vehicle.

- (b) A parking disc in the relevant position if –

- (i) the disc is exhibited on the dashboard or fascia of the vehicle;

or

- (ii) where the vehicle does not have a dashboard or fascia, the disc is exhibited in a conspicuous position on the vehicle, so that when marked to show the quarter hour period during which a period of waiting began, that period is clearly legible from outside of the vehicle.

Part I Amendments

- 3. The County of Durham (South Terrace, South Crescent etc., Seaham) 1/24 (Prohibition of Waiting) Order 1981 and The County Council of Durham (Various Streets, Seaham) (Traffic Management) Order 1998 are 2/103 hereby amended by the revocation of the items listed in Schedule 1 to this Order.

Part II One Way Restriction

- 4. Save as provided in Article 13 of this Order no person shall, except upon the direction or with the permission of a Police Officer in uniform or of a Police Community Support Officer, cause or permit any vehicle to proceed in the length of road specified in Column 1 of Schedule 2 to this Order in a direction other than that specified in relation to that road, in Column 2 of the said Schedule 2.

Part III Left Turn only Restriction

- 5. Save as provided in Article 13 of this Order every person shall, except upon the direction or with the permission of a Police Officer in uniform or of a Police Community Support Officer, cause or permit any vehicle proceeding in the road specified in Column 1 of Schedule 3 to this Order, on reaching the junction of that road with the road specified in Column 2 of Schedule 3 to make a left turn.

Part IV
No Entry Restriction

6. Save as provided in Article 13 of this Order no person shall, except upon the direction or with the permission of a Police Officer in uniform or of a Police Community Support Officer, cause or permit any vehicle/motor vehicle proceeding in the length of road specified in Column 1 of Schedule 4 to this Order to enter the road specified in relation to that road in Column 2 of the said Schedule 4.

Part V
No vehicles 10.00 a.m. to 6.00 p.m.

7. Save as provided in Article 14 of this Order no person shall, except upon the direction or with the permission of a Police Officer in uniform or of a Police Community Support Officer, cause or permit any vehicle to proceed in the length of road specified in Schedule 5 to this Order between the hours of 10.00 a.m. and 6.00 p.m.

Part VI
Prohibition of Waiting at Any Time

8. Save as provided in Articles 15 and 16 of this Order no person shall, except upon the direction or with the permission of a Police Officer in uniform or of a Police Community Support Officer, cause or permit any vehicle to wait at any time in or on the lengths of roads or sides of lengths of roads specified in Schedule 6 to this Order.

Part VII
Prohibition of Loading/Unloading at Any Time

9. No person shall, except upon the direction or with the permission of a Police Officer in uniform or of a Police Community Support Officer, cause or permit any vehicle to wait in the lengths of roads or sides of lengths of roads specified in Schedule 6 to this Order for the purpose of enabling goods to be loaded onto or unloaded from the vehicle, unless the vehicle is in actual use for the purpose of delivering or collecting postal packets in the service of a universal service provider.

Part VIII
Loading Bays

10. (1) The areas of highway described in Schedule 7 to this Order are hereby authorised to be used as loading bays.
- (2) Each loading bay may be used, subject to the provisions of this Order, for the waiting of vehicles for the purpose of loading or unloading goods only during the hours specified in Schedule 7 to this Order.
- (3) Save as provided in Articles 17 and 18 of this Order no person shall cause or permit any vehicle, other than a vehicle loading or unloading goods, to wait in a loading bay.

- (4) The limits of each loading bay shall be indicated, by the Council, on the carriageway by the appropriate traffic signs.
 - (5) Every vehicle using a loading bay shall stand so that every part of the vehicle is wholly within the loading bay.
11. (1) Nothing in Article 10(1) of this Order shall restrict the power of the Council to suspend the use of a loading bay or any part thereof.
- (2) A Police Officer in uniform or a Police Community Support Officer may suspend for not longer than twenty-four hours the use of a loading bay or any part thereof whenever he considers such suspension is reasonably necessary for the purpose of facilitating the movement of traffic or promoting its safety.
- (3) Any person suspending the use of a loading bay or any part thereof in accordance with this Article shall thereupon place or cause to be placed in or adjacent to any part of that loading bay, the use of which is suspended, a traffic sign indicating that the waiting of vehicles for the purpose of loading or unloading is prohibited.
- (4) No person shall cause or permit a vehicle to wait in a loading bay or any part thereof during such period as there is placed in or adjacent to that loading bay or part thereof, a traffic sign indicating that the waiting of vehicles for the purpose of loading or unloading is prohibited provided that nothing in this paragraph shall apply to any vehicle waiting in the loading bay with the permission of the person suspending the loading bay or part thereof in pursuance of paragraphs (1) or (2) of this Article.
12. No persons shall use a loading bay in connection with the sale of any article to persons in or near the loading bay or in connection with the selling or offering for hire of their skill or services.

Part IX Saving

13. Nothing in Articles 4, 5 and 6 of this Order shall apply to:-
- (a) any police, fire brigade or ambulance vehicles on emergency call;
14. Nothing in Article 7 of this Order shall apply to:-
- (a) any police, fire brigade or ambulance vehicles on emergency call;
 - (b) buses;

- (c) goods vehicles entering for the purposes of loading goods;
 - (d) pedal cycles
15. (1) Nothing in Article 8 of this Order shall render it unlawful to cause or permit any vehicle to wait in the lengths of roads or sides of lengths of roads referred to therein for so long as may be necessary to enable:-
- (a) the picking up or setting down of passengers;
 - (b) the vehicle, if it cannot conveniently be used for such purpose in any other road, to be used in connection with any of the following operations namely –
 - (i) building or demolition;
 - (ii) the removal of any obstruction to traffic;
 - (iii) the maintenance, improvement or reconstruction of the said roads;
 - (iv) the laying, erection, alteration or maintenance in or in land adjacent to the said lengths of roads of any sewer, main, pipe or apparatus for the supply of gas, water or electricity or any telecommunications apparatus as defined in the Telecommunications Act 1984;
 - (d) the vehicle if it cannot conveniently be used for such purpose in any other road to be used in the service of a local authority or water authority in pursuance of statutory duties;
 - (e) the vehicle to be used for the purpose of delivering or collecting postal packets in the service of a universal service provider.
- (2) Nothing in Article 8 of this Order shall apply to any vehicle being used for police, fire brigade or ambulance purposes.
16. Nothing in Article 8 of this Order shall render it unlawful to cause or permit a vehicle which displays in the relevant position a disabled person's badge and parking disc (on which the driver or other person in charge of the vehicle, has marked the quarter hour period during which the period of waiting began) to wait in any of the lengths of road or the sides of road referred to in that Article for a period not exceeding three hours (not being a period separated by an interval of less than one hour from a previous period of waiting by the same vehicle in the same length of road on the same day). EXCEPT in the same lengths of roads as may be specified in Schedule 6 to this Order.

17. Nothing in Article 10 of this Order shall apply so as to prevent any person from causing or permitting a vehicle to wait in a loading bay for so long as may be necessary to enable:-

- (a) for the purpose of facilitating the movement of traffic or promoting its safety;
- (b) the vehicle if it cannot conveniently be used for such purpose in any other road, to be used in conjunction with any of the following operations:-
 - (i) building, industrial or demolition operations;
 - (ii) the removal of any obstruction to traffic;
 - (iii) the maintenance, improvement or reconstruction of the road;
 - (iv) the laying, erection, alterations or maintenance in or in land adjacent to the loading bay of any sewer, main, pipe or apparatus for the supply of gas, water or electricity or any telecommunications apparatus as defined in the Telecommunications Act 1984;
- (c) for the convenience of occupiers of premises adjacent to the loading area on any occasion of the removal of furniture from one office or dwellinghouse to another or the removal of furniture from such premises to a depository or to such premises from a depository; and
- (d) the vehicle if it cannot conveniently be used for such purpose in any other road to be used in the service of a local authority or water authority in pursuance of its statutory duties;
- (e) the vehicle to be used for the purpose of delivering or collecting postal packets in the service of a universal service provider;
- (f) the vehicle to be used for police, fire brigade or ambulance purposes;
- (g) for so long as may be necessary to enable a person to board or alight from the vehicle;
- (h) on any occasion on which it is likely by reason of some special attraction that any street will be thronged or obstructed.

18. (1) When a vehicle is left in a loading bay in contravention of any of the provisions contained in Articles 10, 11 or 12 of this Order, a person authorised by the Council may remove the vehicle or arrange for it to be removed from the loading bay.

- (2) A police officer in uniform or a Police Community Support Officer may in any case of an emergency move or cause to be moved vehicles left in a loading bay to any place he thinks fit.
- (3) (a) Any person removing a vehicle by virtue of paragraphs (1) or (2) of this Article may do so by towing or driving the vehicle or in such other manner as he may think necessary to enable him to remove it.
- (b) When a person removes or makes arrangements for the removal of a vehicle from a loading bay he shall make such arrangements as may be reasonably necessary for the safe custody of the vehicle;
19. Insofar as any provision of this Order conflicts with any provision which is contained in an Order made or having effect as if made under the Act or by or under any other enactment then the provisions of THIS Order shall prevail.
20. The prohibitions and restrictions imposed by this Order shall be in addition to and not in derogation from any restriction or requirement imposed by any regulations made or having effect as if made under the Act or by or under any other enactment.

SCHEDULE 1 PART REVOCATIONS

1. The County of Durham (South Terrace, South Crescent etc, Seaham) (Prohibition of Waiting) Order 1981

1/24

Part hereby revoked:
Schedule – Item No 1

2. The County Council of Durham (Various Streets, Seaham) (Traffic Management) Order 1998

14

Parts hereby revoked:
Schedule 3 – Items concerning South Crescent (West Side) and South Crescent (East Side)
Schedule 4

2/103

**SCHEDULE 2
ONE WAY**

Item No.	Location	Column 1	Column 2
1	Unc. South Terrace/South Crescent	From a point 5m north of the centre line of its junction with Unc. Shaw Street in a northerly direction to its junction with the A182 (locally known as The Promenade)	Northbound

**SCHEDULE 3
LEFT TURN ONLY**

Item No.	Column 1	Column 2
1	Unc. South Crescent	A182 (locally known as The Promenade)

**SCHEDULE 4
NO ENTRY**

Item No.	Column 1	Column 2
1	A182 (locally known as The Promenade)	Unc. South Crescent

**SCHEDULE 5
NO VEHICLES 10 AM – 6 PM EXCEPT FOR BUSES, CYCLES AND
LOADING BY GOODS VEHICLES**

Item No.	Location	Description	Direction	Restricted Period
1	Unc. South Terrace/South Crescent	From a point 5m north of the centre line of its junction with Unc. Shaw Street to its junction with the A182 (locally known as The Promenade)	Northbound	10am - 6pm

SCHEDULE 6
NO WAITING NO LOADING/UNLOADING

REV BY
3/166.

Item No.	Location	Description	Side of Road	Restricted Period
1	Unc. South Terrace	From a point 13 metres south of the centre line of its junction with Unc. Shaw Street to a point 6m north of the same centre line.	East	At any time ✓
2	Unc. South Terrace/ South Crescent	From a point 35 metres north of the centre line of its junction with Unc. Shaw Street for a distance of 80 metres in a generally northerly direction. <i>should be 70</i>	East	At any time
3	Unc. South Crescent	From the highway boundary of the A182 (locally known as The Promenade) for a distance of 5m in a generally south westerly direction.	West	At any time ✕
4	Unc. South Terrace	From a point 41 metres north of the centre line of its junction with Unc. Shaw Street for a distance of 15 metres in a northerly then north easterly direction.	West	At any time ✕
5	Unc. South Crescent	From a point 34m south of the highway boundary of the A182 (locally known as The Promenade) for a distance of 13m in a generally southerly direction.	West	At any time ✕
6	A182 (locally known as The Promenade)	From a point 12m south of the centre line of its junction with Unc. South Crescent to a point 24m north of the same centre line.	West	At any time ✕

Item No.	Location	Description	Side of Road	Restricted Period
7	Unc. Shaw Street	From a point 6.4m west of the highway boundary of Unc. South Terrace in an easterly direction to a point 4m east of the same boundary.	North	At any time ✓

**SCHEDULE 7
LOADING ONLY (LOADING BAYS)**

REV BY 3/166.

Item No.	Location	Description	Side of Road	Restricted Period
1	Unc. South Terrace	From a point 6 metres north of the centre line of its junction with Unc. Shaw Street (in the purpose built lay-by) for a distance of 29 metres in a northerly direction.	East	24Hr x
2	Unc. South Crescent	From the highway boundary of the A182 for a distance of 39m in a southerly direction (in the purpose built lay-by).	East	24Hr x
3	Unc. South Terrace/ South Crescent	From a point 56 metres north of the centre line of its junction with Unc. Shaw Street in the purpose built lay-by for a distance of 21 metres in a north easterly direction.	West	24Hr



**Given under the Common Seal of the County Council of Durham this
25th day of October 2007.**

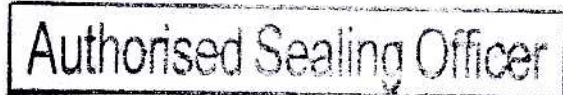



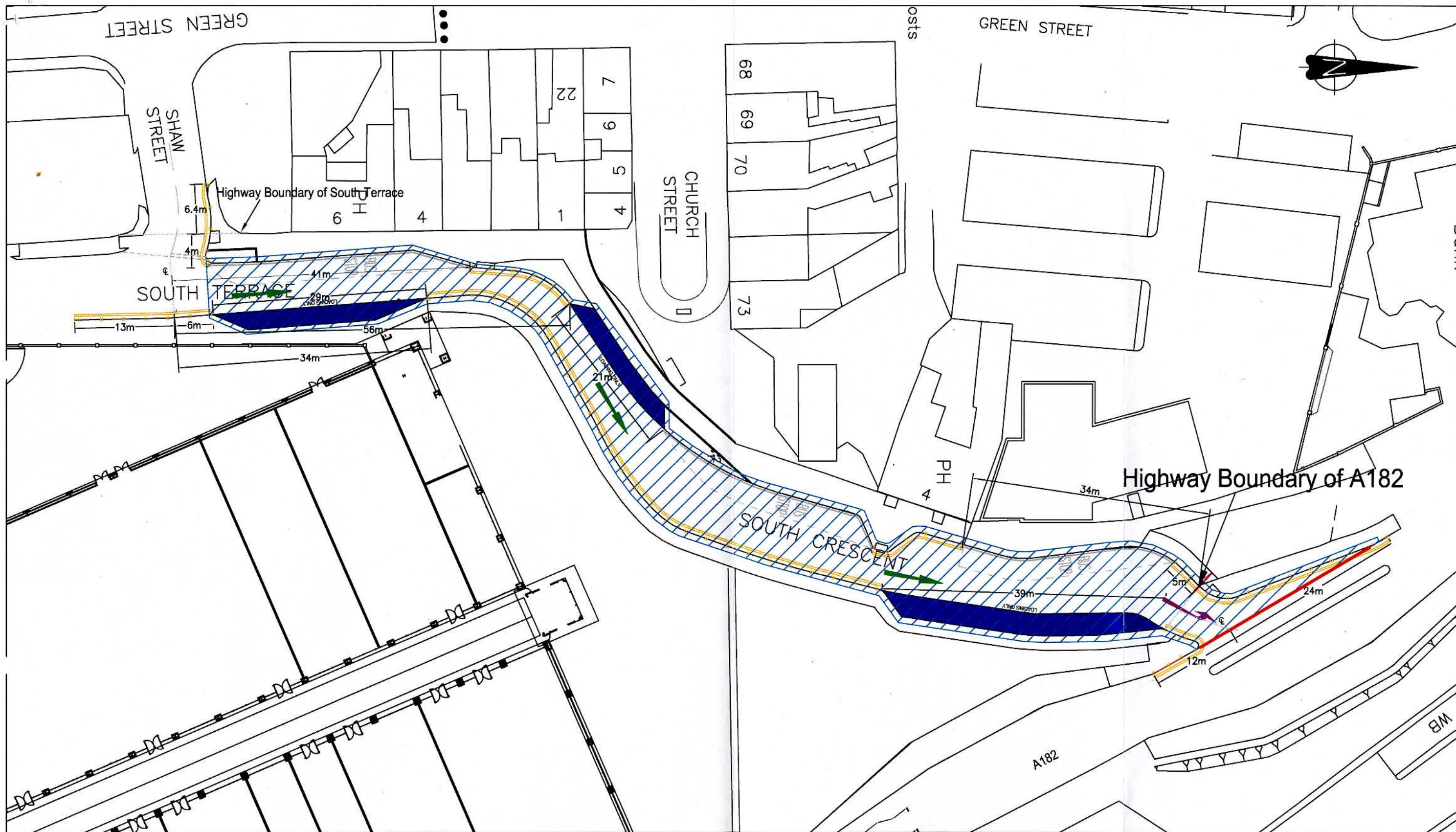

L. M. Walker

ORDERS/MISC/GP3





Key

-  No Waiting & No Loading at Any Time
-  Loading Only
-  No Vehicles Except for Buses & Loading/Unloading 10am - 6pm
-  One Way
-  Left Turn Only
-  No Entry

Rev/ Amdt	Approved By			Description Of Amendments
	Name	Date	Sign	
0/-	R.Hamilton	22/05/07	<i>R.Hamilton</i>	
0/A	S.Alder	Jul 07	<i>S.Alder</i>	



Making a difference where you live

HIGHWAY DESIGN

JOHN RICHARDSON
CORPORATE DIRECTOR, ENVIRONMENT
COUNTY HALL
DURHAM DH1 5UQ

Project		Byron Place, Seaham Bus Link	
Drawing		TRO Drawing	
Scales		N.T.S	Project/Drawing No. TM/40038/07/08
			Rev. 0/A