

**THE COUNTY COUNCIL OF DURHAM
(DURHAM CITY (SOUTH WEST))
(PARKING AND WAITING RESTRICTIONS) (CONSOLIDATION ORDER NO.1) 2021
(AMENDMENT NO. 1) ORDER 2024**

The County Council of Durham ("the Council") in exercise of their powers under Sections 1, 2, 4, 32 & 35 and Part IV of Schedule 9 to the Road Traffic Regulation Act 1984, as amended ("the Act") and Part 6 of the Traffic Management Act 2004, as amended and of all other enabling powers and after consultation with the Chief Officer of Police in accordance with Part III of Schedule 9 to the Act, hereby make the following Order:-

1.General

This Order may be cited as The County Council of Durham (Durham City (South West)) (Parking & Waiting Restrictions) (Consolidation Order No.1) 2021 (Amendment No. 1) Order 2024 and shall come into operation on the 31st day of March 2025.

2.Definitions

The following definition has been inserted:-

"Police Vehicle" means a vehicle being used for police purposes or operating under the instruction of a Chief Officer of Police for Durham Constabulary.

3.Amendments

The under-noted amendments have been made to the following Order:

The County Council of Durham (Durham City (South West) (Parking & Waiting Restrictions) Order 2013.

Purpose of Amendments

The following brief synopsis of amendments should be viewed in conjunction with the plans identified within the Schedules to the above Order, however the plan(s) should prevail in the event of any discrepancy:

To remove existing 'Limited Waiting Bays' (Monday-Friday, 7am-6pm, 20 mins, no return within 1 hour) on:

The northern side of Relly Path – plan DV137 refers.

To introduce 'Restricted Waiting & Loading' Restrictions (Monday-Friday, 8-10am, 3-5pm) on:

The northern side of Relly Path, starting from a point adjacent to No. 2 Relly Path, for a distance of 26 metres in a westerly direction - plan DV137 refers.

To remove existing 'Restricted Waiting' (Monday-Friday, 8am-5pm) restrictions on:

The eastern side of St Monica Grove, extending from existing restrictions leading from its junction with Redhills Lane, for a distance of 2 metres in a southerly direction - plan DW139 refers.

To extend existing 'No Waiting at Any Time' restrictions on:

Either side of St Monica Grove, extending from existing restrictions either side of the junction from Redhills Lane, for a distance of 2 metres in a southerly direction - plan DW139 refers.

To replace existing 'No Waiting at Any Time' restrictions with 'No Waiting & No Loading/Unloading at any time' restrictions on:

- a. the northern side of the junction from North Road into Rushford Court for a distance of 21 metres in a northerly direction – plans DX139 and DX140 refer.
- b. the northern side of North Road, starting from the western boundary of Numbers 58 to 62 North Road, for a distance of 55 metres in an easterly direction - plan DX139 refers.

To replace existing 'No Waiting at Any Time' restrictions with 'Permit Holders or Pay & Display bays' Restrictions on:

- a. the northern side of Sutton Street, starting from a point adjacent to Number 27 Sutton Street, for a distance of 12 metres in a south-westerly direction – plan DX139 refers.
- b. the southern side of Sutton Street, starting from a point adjacent to Number 27 Sutton Street, for a distance of 13 metres in a south-westerly direction – plan DX139 refers.

To replace existing 'Loading Only' (8am-6pm) restrictions with 'Police Vehicle Only' restrictions on:

on the southern side of North Road, starting from a point adjacent to Durham Bus Station, for a distance of 9 metres in an easterly direction - plan DX139 refers.

To introduce 'No waiting at Any time' Restrictions on:

- a. the northern side of the junction from Neville's Cross Bank into Neville's Cross Villas, starting from a point on Neville's Cross Bank 10 metres north of the junction, for a distance of 19 metres in a southern/south-easterly direction - plan DV136 refers.
- b. the western side of Neville's Cross Villas, starting from a point on Neville's Cross Bank 6 metres south of its junction with Neville's Cross Villas, for a distance of 92 metres in a southern direction – plan DV136 refers.
- c. the eastern side of Neville's Cross Villas, starting from a point 11 metres north of the boundary between Numbers 7 and 8 Neville's Cross Villas, for a distance of 7 metres in a north-easterly direction – plan DV136.
- d. the eastern side of the junction from the A690 into the A690 South, starting from a point 32 metres south of the junction, for a distance of 27 metres in a north/north-easterly direction – plans DV134 and DV135 refers.
- e. the western side of the junction from the A690 into the A690 South, starting from a point 35 metres south of the junction, for a distance of 53 metres in a northern direction plans DV134 and DV135 refer.
- f. the southern side of Hastings Avenue, starting from the western boundary of Number 18 Park House Road, for a distance of 50 metres in a westerly direction – plans DW133, DW134 and DV134 refer.
- g. the northern side of Hastings Avenue, starting from the western boundary of Number 1 Park House Road, for a distance of 23 metres in a westerly direction – plan DW134 refers.
- h. the eastern side of the junction from Clay Lane into Sheraton House, for a distance of 16 metres in an easterly direction from the junction – plan DW135 refers.
- i. both sides of the junction from Faraday Court into Neville House, for a distance of 7 metres either side - plan DW136 refers.

4.Schedules

New Plans DV134, DV135 and DW133 have been inserted. Plans DV136, DV137, DW134, DW135, DW136, DW139 and DX139 have been amended to reflect the changes to those

restrictions noted in Article 3 above. Where the plans are referenced in the Schedules to the Order described in Article 3 above, new plans bearing the seal date as at the date of this Amendment Order have been inserted.

5.Saving

Insofar as any provision of this Order conflicts with any provision which is contained in an Order made or having effect as if made under the Act or by or under any other enactment then the provisions of this Order shall prevail.

The prohibitions and restrictions imposed by this Order shall be in addition to and not in derogation from any restriction or requirement imposed by any regulations made or having effect as if made under the Act or by or under any other enactment.

**MADE THIS 14th DAY OF MARCH 2025 BY
THE AFFIXING OF THE COMMON SEAL OF THE COUNTY COUNCIL
OF DURHAM BY ORDER:**



**AUTHORISED SIGNATORY
(A PERMANENT OFFICER OF THE COUNTY COUNCIL)**

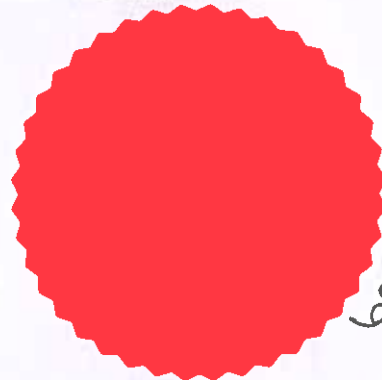

600367

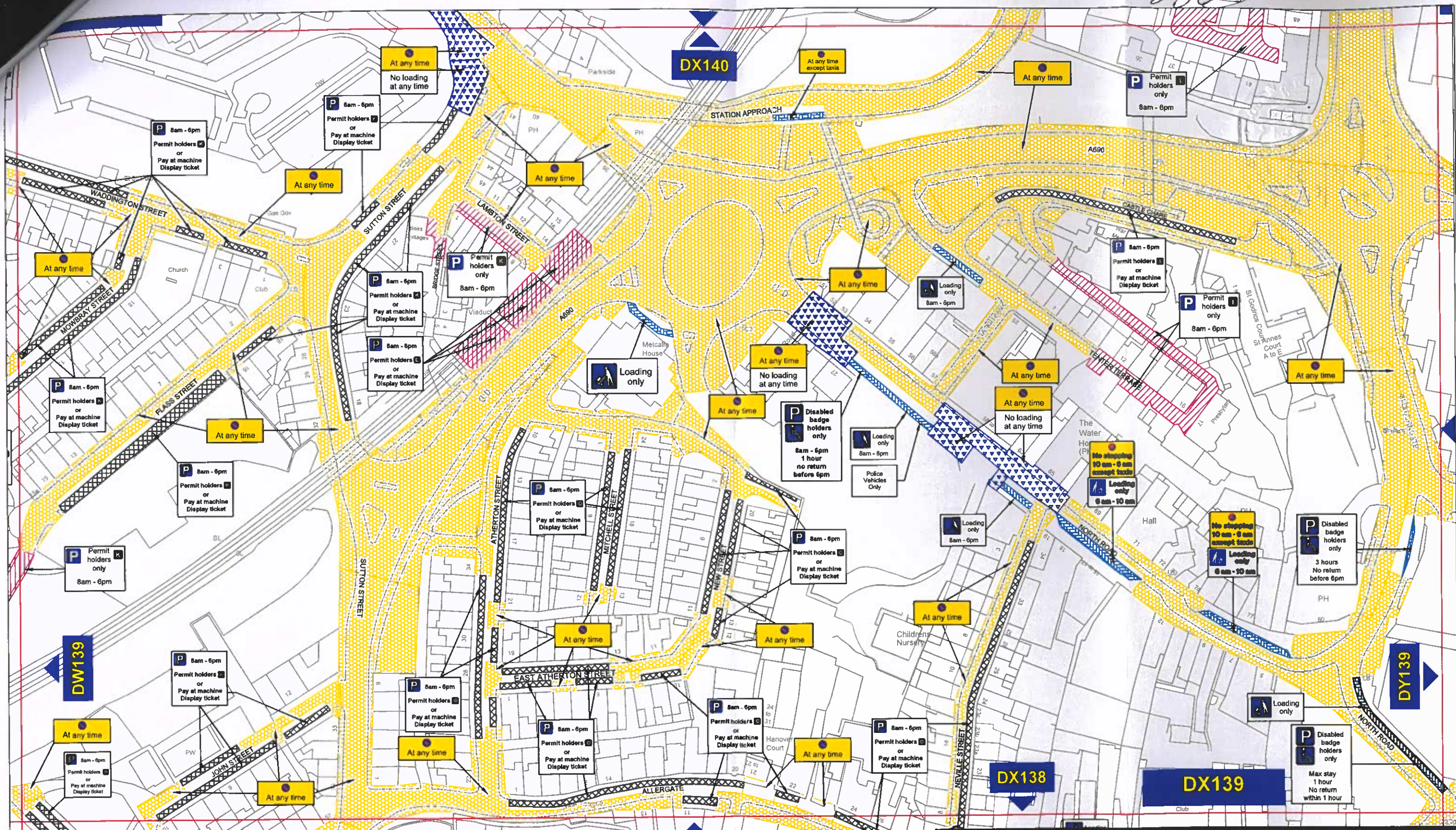

Key to Types of Restriction

	No Waiting At Any Time		Permit Holders Only
	No Waiting and No Loading/Unloading At Any Time		
	Restricted Bay		
	Pay and Display and Permit Holders		

Individual Reference Number

PATH: L:\TRAFFPROJ\06 REGULATION DESIGN & IMPLEMENTATION\Settlement\Durham City South West\Traffic Regulation Orders (Parking Restrictions)\Dec 2022

Reproduced from Ordnance Survey material with the permission of Ordnance Survey on behalf of the Controller of His Majesty's Stationary Office © Crown copyright. Unauthorised reproduction infringes Crown copyright and may lead to prosecution or civil proceedings. Durham County Council. LA 100049055. 2023.



Corporate Director
Regeneration & Economic Development

Strategic Traffic Management

Corten House,
Ayckley Heads Business Park
Durham, DH1 5TS

THE COUNTY COUNCIL OF DURHAM DURHAM CITY, SOUTH WEST (PARKING & WAITING RESTRICTIONS) TRAFFIC REGULATION AMENDMENT ORDER 2024



Scale:	1:1250 @ A3		
Date:	September 2024		
Drawn by:	E.Brown	Signature:	<i>shown</i>
Date Sealed:		Map Schedule:	DX139

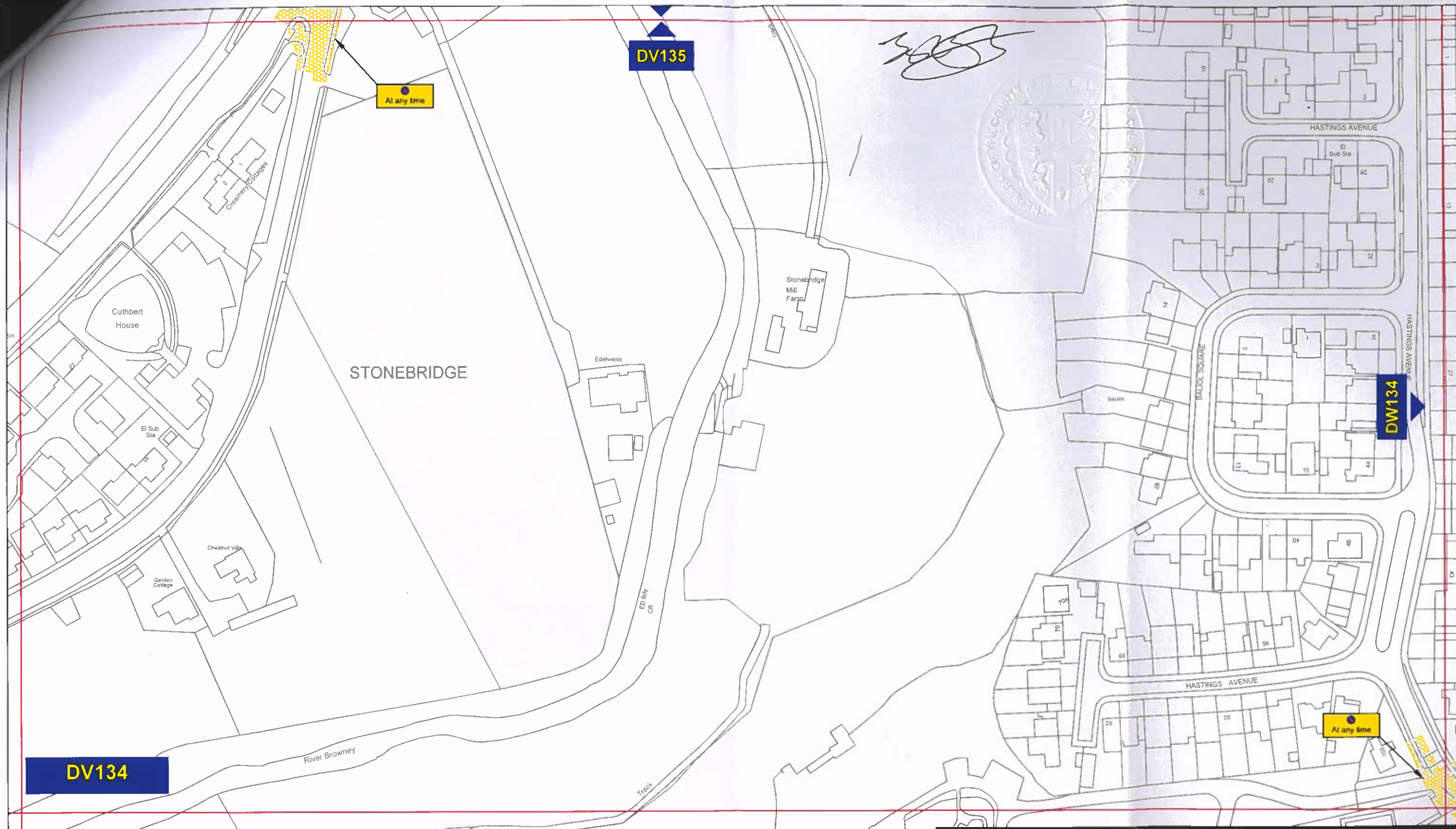

Key to Types of Restriction



No Waiting At Any Time



Individual Reference Number

PATH: L:\TRAFFPROJ\06 REGULATION DESIGN & IMPLEMENTATION\Settlement\Durham City South West\Traffic Regulation Orders (Parking Restrictions)\Dec 2022

Reproduced from Ordnance Survey material with the permission of Ordnance Survey on behalf of the Controller of His Majesty's Stationery Office © Crown copyright. Unauthorised reproduction infringes Crown copyright and may lead to prosecution or civil proceedings. Durham County Council. LA 100049055. 2023.



Corporate Director
Regeneration & Economic
Development

Strategic Traffic Management

Corten House,
Ayckley Heads Business Park
Durham, DH1 5TS

THE COUNTY COUNCIL OF DURHAM
DURHAM CITY, SOUTH WEST
(PARKING & WAITING RESTRICTIONS)
TRAFFIC REGULATION AMENDMENT ORDER 2024



Scale:	1:1250 @ A3		
Date:	September 2024		
Drawn by:	E.Brown	Signature:	<i>shown</i>
Date Sealed:		Map Schedule:	DV134



Key to Types of Restriction

 No Waiting At Any Time

 Individual Reference Number



**Corporate Director
Regeneration & Economic
Development**

Strategic Traffic Management

Corten House,
Ayckley Heads Business Park
Durham, DH1 5TS

**THE COUNTY COUNCIL OF DURHAM
DURHAM CITY, SOUTH WEST
(PARKING & WAITING RESTRICTIONS)
TRAFFIC REGULATION AMENDMENT ORDER 2024**



Scale:	1:1250 @ A3		
Date:	September 2024		
Drawn by:	E.Brown	Signature:	<i>ebrown</i>
Date Sealed:		Map Schedule:	DV135

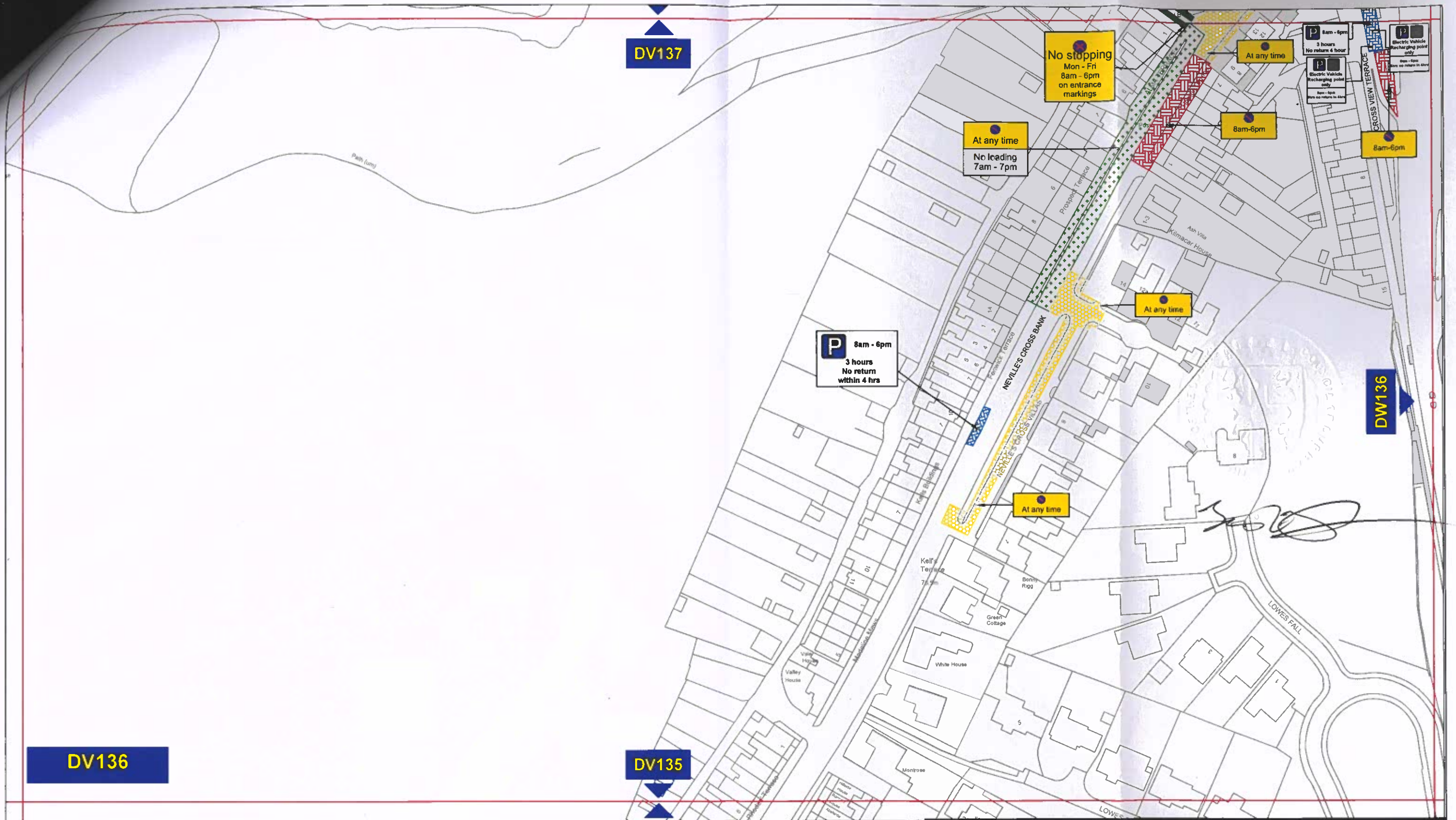

Key to Types of Restriction

	No Waiting At Any Time		No Stopping
	Restricted Waiting		
	Restricted Waiting and Loading/Unloading		
	Restricted Bay		



PATH: L:\TRAFFPROJ\06 REGULATION DESIGN & IMPLEMENTATION\Settlement\Durham City South West\Traffic Regulation Orders (Parking Restrictions)\Dec 2022

Reproduced from Ordnance Survey material with the permission of Ordnance Survey on behalf of the Controller of His Majesty's Stationery Office © Crown copyright. Unauthorised reproduction infringes Crown copyright and may lead to prosecution or civil proceedings. Durham County Council. LA 100049055. 2023.



Corporate Director
Regeneration & Economic
Development

Strategic Traffic Management

Corten House,
Ayckley Heads Business Park
Durham, DH1 5TS

THE COUNTY COUNCIL OF DURHAM
DURHAM CITY, SOUTH WEST
(PARKING & WAITING RESTRICTIONS)
TRAFFIC REGULATION AMENDMENT ORDER 2024



Scale:	1:1250 @ A3		
Date:	September 2024		
Drawn by:	E.Brown	Signature:	<i>shown</i>
Date Sealed:		Map Schedule:	DV136

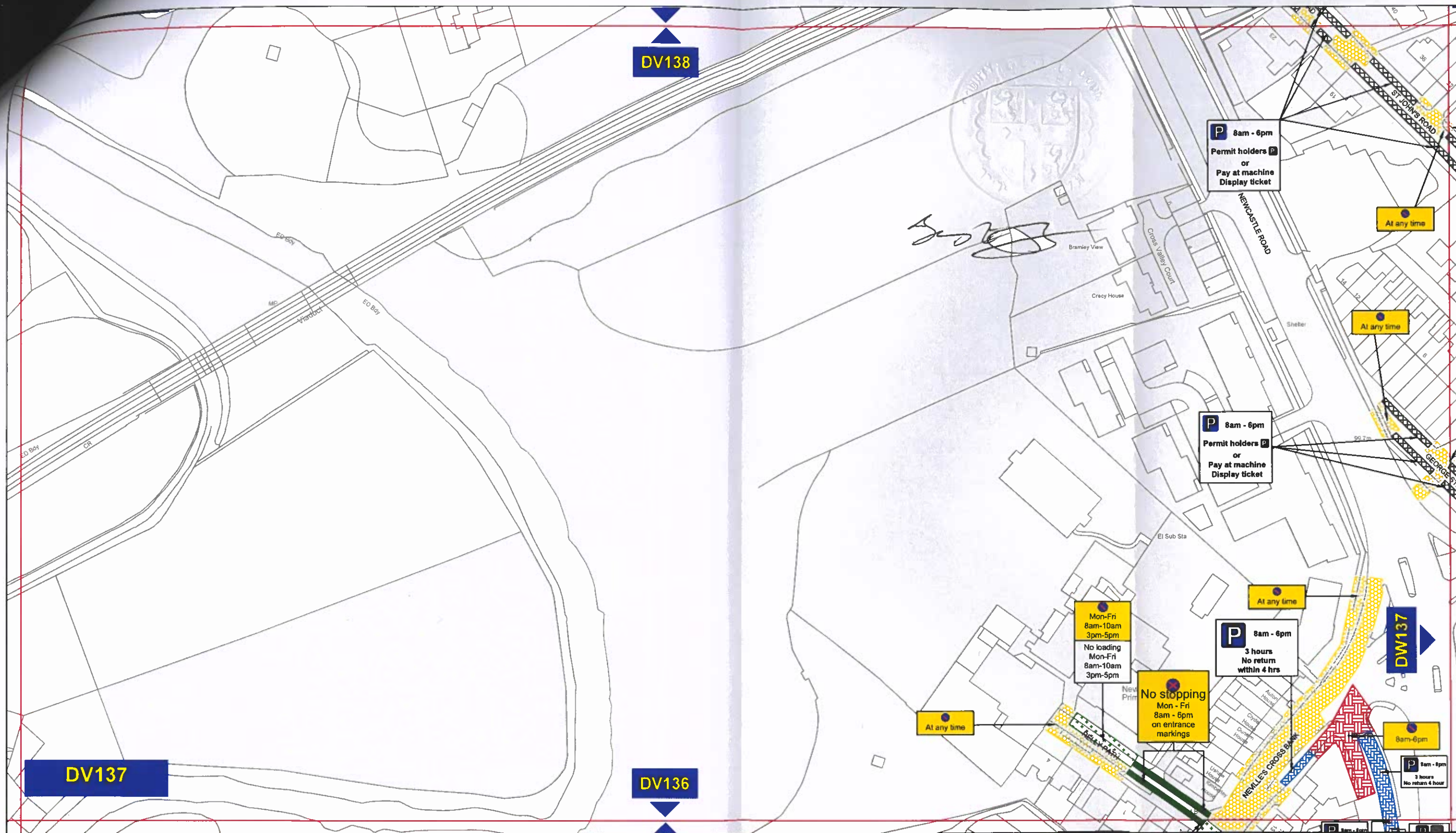

Key to Types of Restriction

	No Waiting At Any Time		Pay and Display and Permit Holders
	Restricted Waiting		No Stopping
	Restricted Waiting and Loading/Unloading		
	Restricted Bay		

Individual Reference Number

PATH: L:\TRAFFPROJ\06 REGULATION DESIGN & IMPLEMENTATION\Settlement\Durham City South West\Traffic Regulation Orders (Parking Restrictions)\Dec 2022

Reproduced from Ordnance Survey material with the permission of Ordnance Survey on behalf of the Controller of His Majesty's Stationery Office © Crown copyright. Unauthorised reproduction infringes Crown copyright and may lead to prosecution or civil proceedings. Durham County Council. LA 100049055. 2023.



**Corporate Director
Regeneration & Economic
Development**

Strategic Traffic Management

Corten House,
Ayckley Heads Business Park
Durham, DH1 5TS

THE COUNTY COUNCIL OF DURHAM DURHAM CITY, SOUTH WEST (PARKING & WAITING RESTRICTIONS) TRAFFIC REGULATION AMENDMENT ORDER 2024



Scale:	1:1250 @ A3		
Date:	September 2024		
Drawn by:	E.Brown	Signature:	<i>E. Brown</i>
Date Sealed:		Map Schedule:	DV137

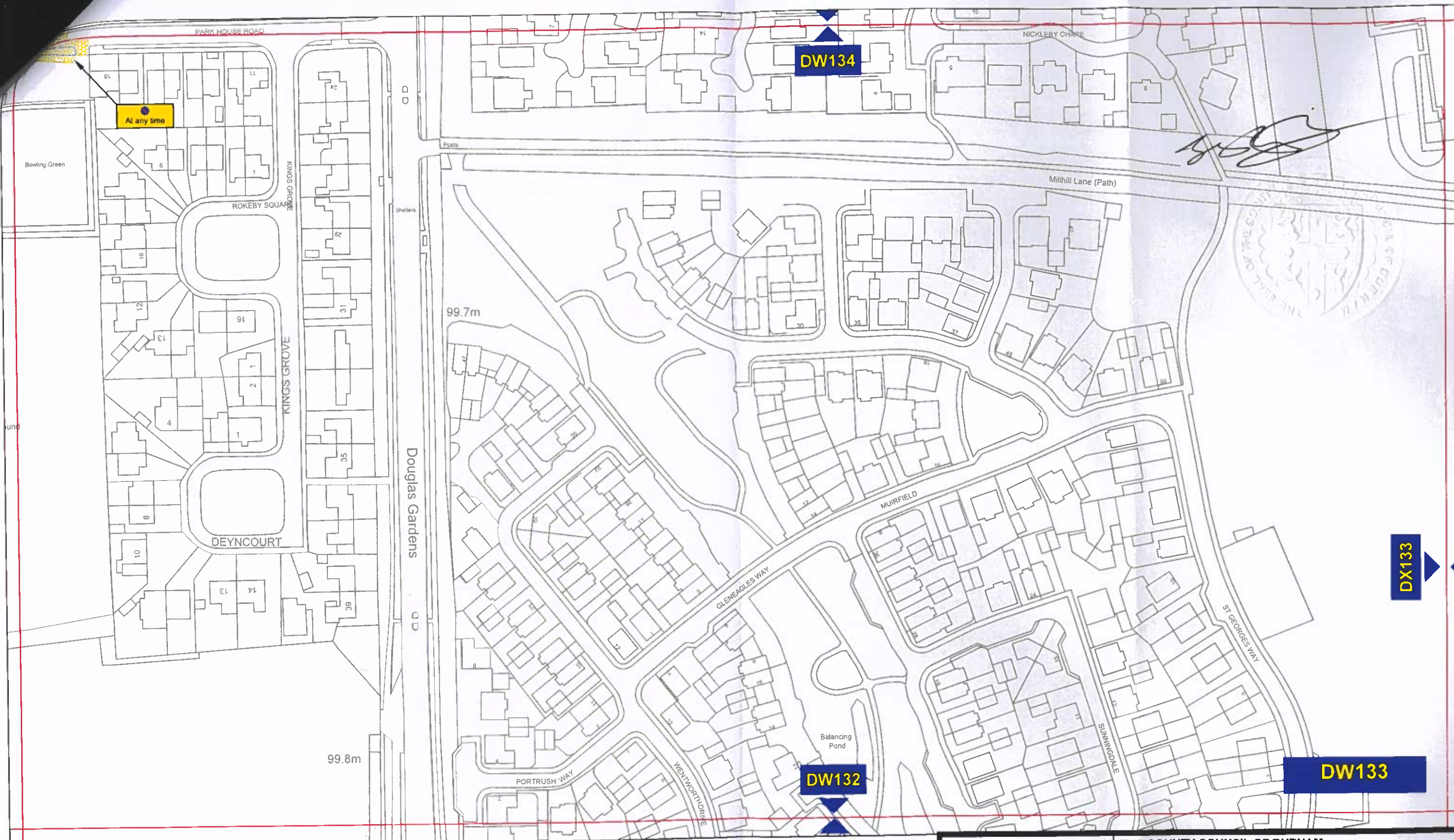

Key to Types of Restriction

 No Waiting At Any Time

 Individual Reference Number

PATH: L:\TRAFFPROJ\06 REGULATION DESIGN & IMPLEMENTATION\Settlement\Durham City South West\Traffic Regulation Orders (Parking Restrictions)\Dec 2022

Reproduced from Ordnance Survey material with the permission of Ordnance Survey on behalf of the Controller of His Majesty's Stationery Office © Crown copyright. Unauthorised reproduction infringes Crown copyright and may lead to prosecution or civil proceedings. Durham County Council. LA 100049055. 2023.



Corporate Director
Regeneration & Economic
Development

Strategic Traffic Management

Corten House,
Ayckley Heads Business Park
Durham, DH1 5TS

THE COUNTY COUNCIL OF DURHAM
DURHAM CITY, SOUTH WEST
(PARKING & WAITING RESTRICTIONS)
TRAFFIC REGULATION AMENDMENT ORDER 2024



Scale:	1:1250 @ A3		
Date:	September 2024		
Drawn by:	E.Brown	Signature:	<i>ebrown</i>
Date Sealed:		Map Schedule:	DW133

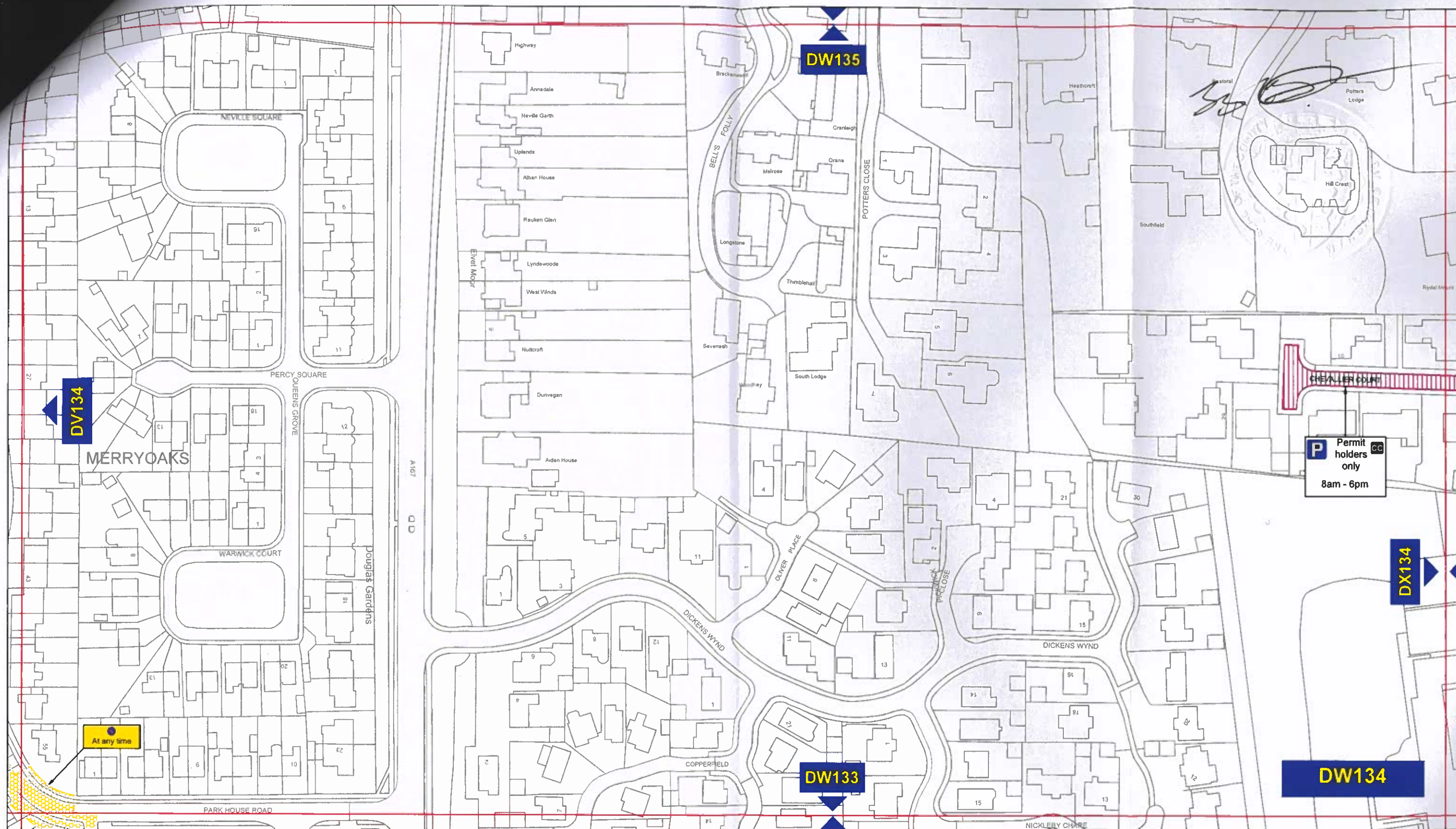

Key to Types of Restriction

-  No Waiting At Any Time
-  Permit Holders Only

 Individual Reference Number

PATH: L:\TRAFFPROJ\06 REGULATION DESIGN & IMPLEMENTATION\Settlement\Durham City South West\Traffic Regulation Orders (Parking Restrictions)\Dec 2022

Reproduced from Ordnance Survey material with the permission of Ordnance Survey on behalf of the Controller of His Majesty's Stationary Office © Crown copyright. Unauthorised reproduction infringes Crown copyright and may lead to prosecution or civil proceedings. Durham County Council. LA 100049055. 2023.

Durham
 County Council
 Corporate Director
 Regeneration & Economic
 Development
 Strategic Traffic Management
 Corten House,
 Aykley Heads Business Park
 Durham, DH1 5TS

THE COUNTY COUNCIL OF DURHAM
DURHAM CITY, SOUTH WEST
(PARKING & WAITING RESTRICTIONS)
TRAFFIC REGULATION AMENDMENT ORDER 2024

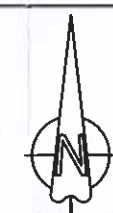

Scale:	1:1250 @ A3		
Date:	September 2024		
Drawn by:	E.Brown	Signature:	<i>ebrown</i>
Date Sealed:		Map Schedule:	DW134

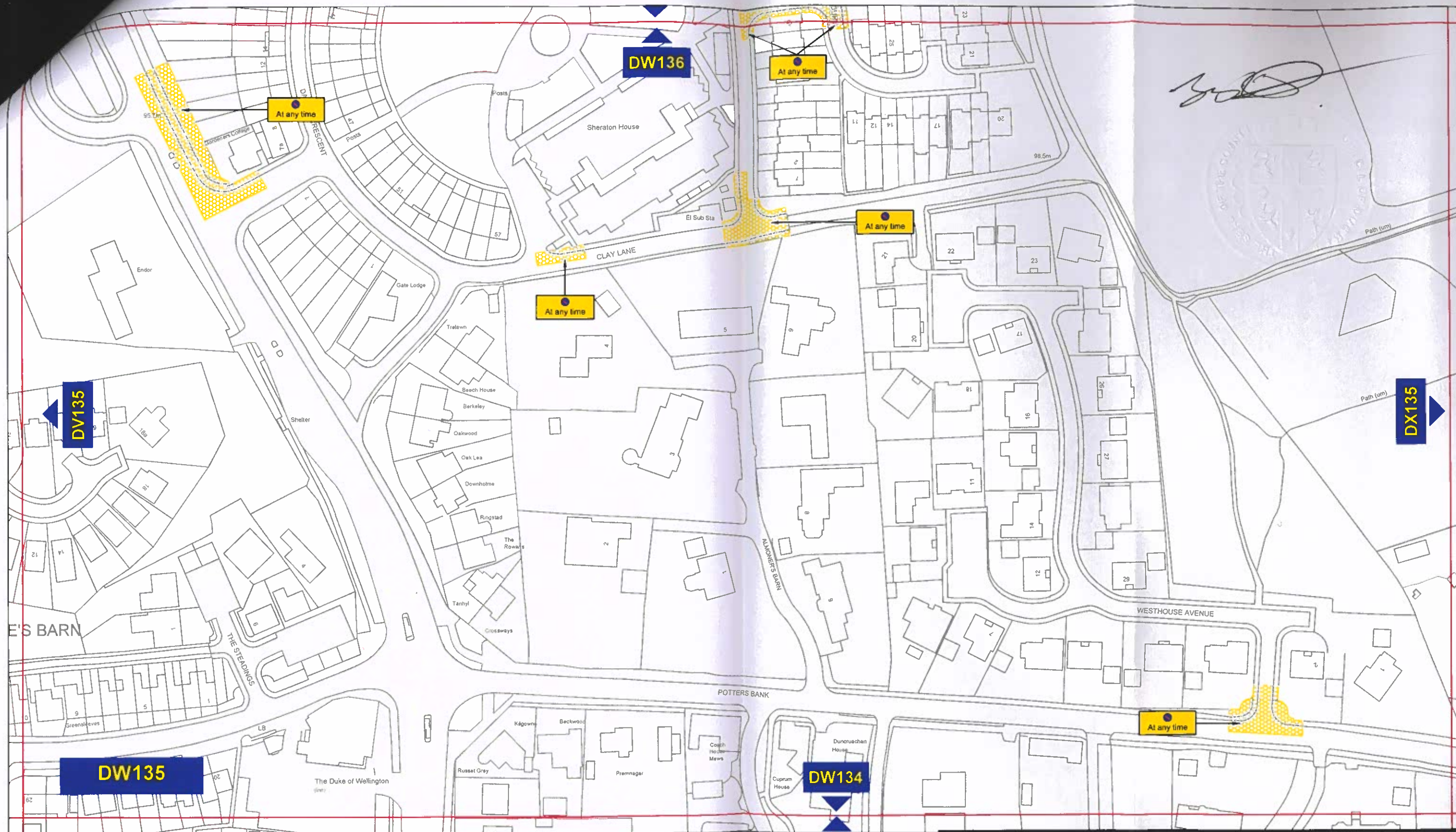

Key to Types of Restriction

 No Waiting At Any Time

 Individual Reference Number



**Corporate Director
Regeneration & Economic
Development**

Strategic Traffic Management

Corten House,
Aykley Heads Business Park
Durham, DH1 5TS

**THE COUNTY COUNCIL OF DURHAM
DURHAM CITY, SOUTH WEST
(PARKING & WAITING RESTRICTIONS)
TRAFFIC REGULATION AMENDMENT ORDER 2024**



Scale:	1:1250 @ A3		
Date:	September 2024		
Drawn by:	E.Brown	Signature:	<i>ebrown</i>
Date Sealed:		Map Schedule:	DW135

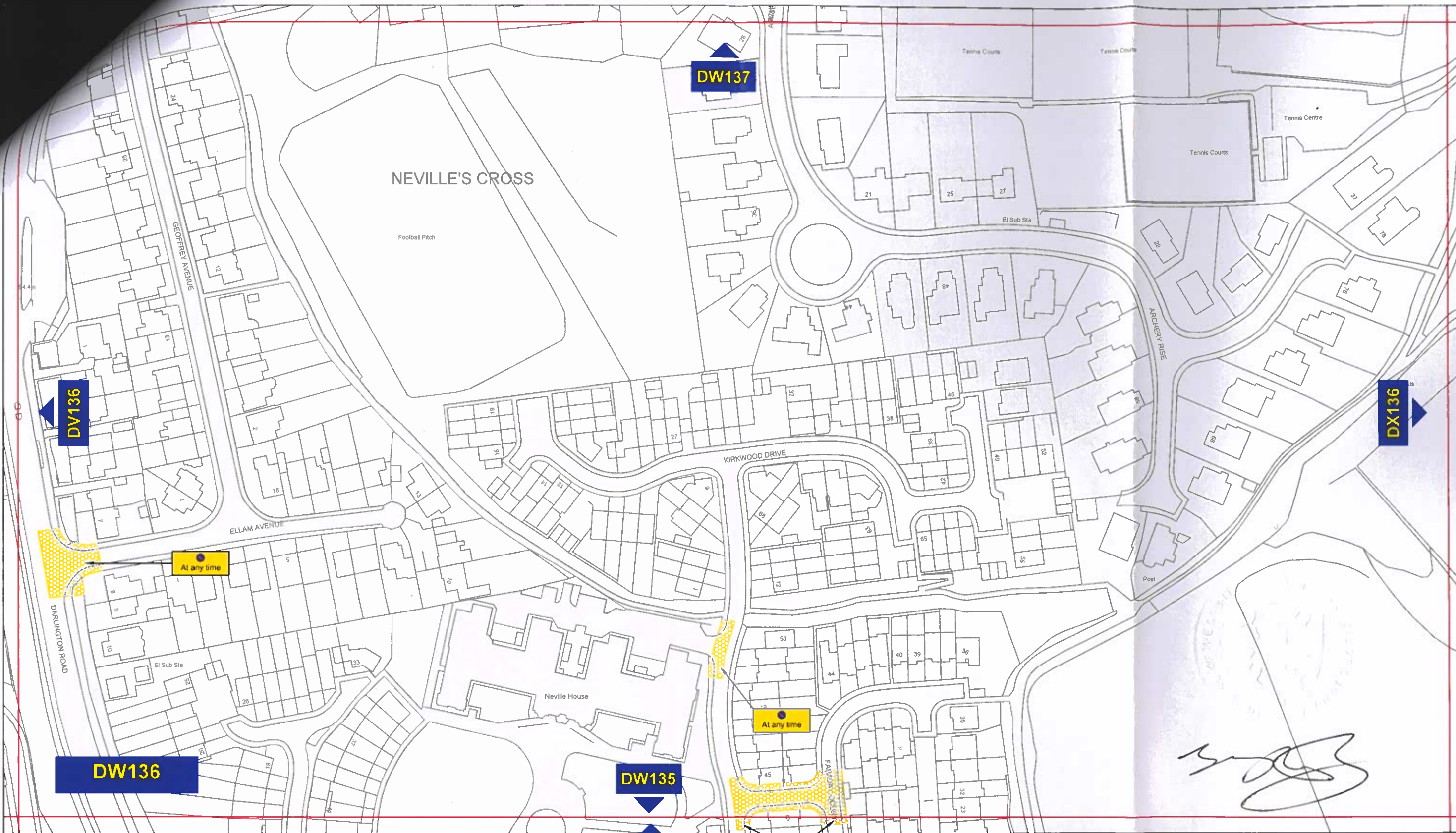

Key to Types of Restriction

 No Waiting At Any Time

 Individual Reference Number

PATH: L:\TRAFFPROJ\06 REGULATION DESIGN & IMPLEMENTATION\Settlement\Durham City South West\Traffic Regulation Orders (Parking Restrictions)\Dec 2022

Reproduced from Ordnance Survey material with the permission of Ordnance Survey on behalf of the Controller of His Majesty's Stationary Office © Crown copyright. Unauthorised reproduction infringes Crown copyright and may lead to prosecution or civil proceedings. Durham County Council. LA 100049055. 2023.



Corporate Director
Regeneration & Economic
Development

Strategic Traffic Management

Corten House,
Aykley Heads Business Park
Durham, DH1 5TS

THE COUNTY COUNCIL OF DURHAM
DURHAM CITY, SOUTH WEST
(PARKING & WAITING RESTRICTIONS)
TRAFFIC REGULATION AMENDMENT ORDER 2024



Scale:	1:1250 @ A3		
Date:	September 2024		
Drawn by:	E.Brown	Signature:	<i>ebrown</i>
Date Sealed:		Map Schedule:	DW136

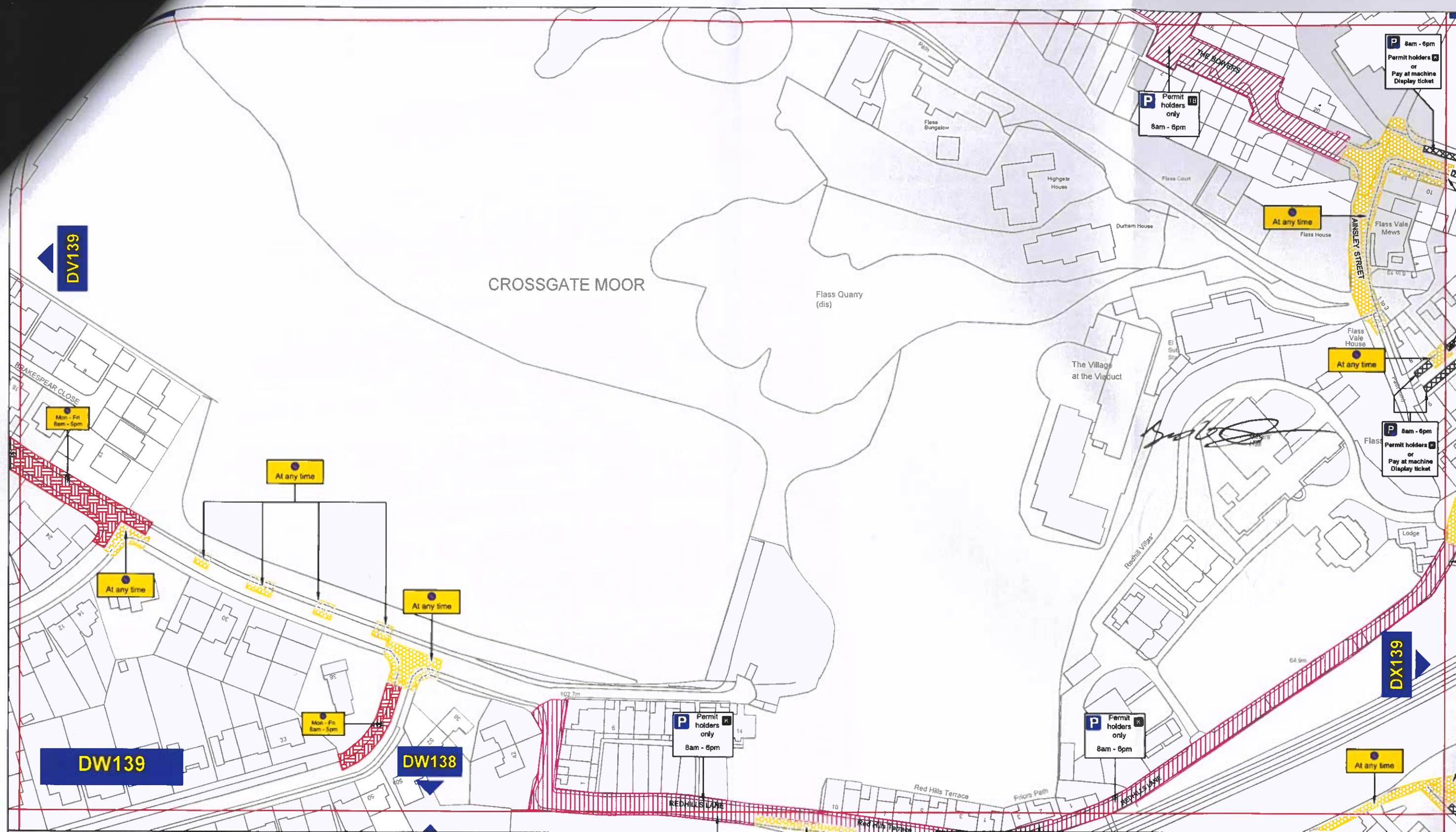

Key to Types of Restriction

-  No Waiting At Any Time
-  Restricted Waiting
-  Pay and Display and Permit Holders
-  Permit Holders Only



Individual Reference Number



**Corporate Director
Regeneration & Economic
Development**

Strategic Traffic Management

Corten House,
Aykley Heads Business Park
Durham, DH1 5TS

**THE COUNTY COUNCIL OF DURHAM
DURHAM CITY, SOUTH WEST
(PARKING & WAITING RESTRICTIONS)
TRAFFIC REGULATION AMENDMENT ORDER 2024**

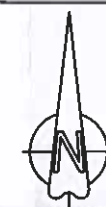

Scale:	1:1250 @ A3		
Date:	September 2024		
Drawn by:	E.Brown	Signature:	<i>shown</i>
Date Sealed:		Map Schedule:	DW139

PATH: L:\TRAFFPROJ\06 REGULATION DESIGN & IMPLEMENTATION\Settlement\Durham City South West\Traffic Regulation Orders (Parking Restrictions)\Dec 2022

Reproduced from Ordnance Survey material with the permission of Ordnance Survey on behalf of the Controller of His Majesty's Stationery Office © Crown copyright. Unauthorised reproduction infringes Crown copyright and may lead to prosecution or civil proceedings. Durham County Council. LA 100049055. 2023.