

**THE COUNTY COUNCIL OF DURHAM
(BISHOP AUCKLAND)
(PARKING AND WAITING RESTRICTIONS) (CONSOLIDATION NO. 1) ORDER 2014
(AMENDMENT NO. 2) ORDER 2017**

The County Council of Durham ("the Council") in exercise of their powers under Sections 1, 2, 4, 32 and 35 and Part IV of Schedule 9 to the Road Traffic Regulation Act 1984, as amended ("the Act"); Part 6 of the Traffic Management Act 2004, as amended, and of all other enabling powers and after consultation with the Chief Officer of Police in accordance with Part III of Schedule 9 to the Act, hereby make the following Order:-

Part I

1. General

This Order may be cited as The County Council of Durham (Bishop Auckland) (Parking and Waiting Restrictions) (Consolidation No. 1) Order 2014 (Amendment No. 2) Order 2017 and shall come into operation on the 17th day of July 2017.

Part II

2. Amendments

The following amendments apply to:

- The County Council of Durham (Bishop Auckland) (Parking and Waiting Restrictions) (Consolidation No. 1) Order 2014 4/261.
- The County Council of Durham (Bishop Auckland) (Parking and Waiting Restrictions) (Consolidation No. 1) Order 2014 (Amendment No. 1) Order 2015 – plans DJ86, DL89, DL90, DL91 DL93 have been revoked and replaced with plans bearing the same reference dated as at the date of this Amendment Order. 4/268.

3. Purpose of Amendments

The following brief synopsis of amendments should be viewed in conjunction with the plans identified within the Schedules to the above Order however the plans should prevail in the event of any discrepancy:

- a) **Union Street** – replace the existing loading bay with Parking Mon-Sat 8am-6pm Max Stay 1 hour No return within 2 hours and introduce a 4m length of No Waiting At Any Time from a point at the end of the new Parking bay eastwards to the end of the Road. (Plan DL90 refers)
- b) **Adelaide Street** – replace the existing Parking Mon-Sat 8am-6pm Max Stay 1 hour No return within 2 hours and extend the existing No Waiting At Any Time for the full length of the Road. (Plan DL91 refers)
- c) **Murphy Crescent** – Reconfigure the alignment of the existing No Stopping Mon-Fri 8am-6pm on entrance markings to follow the curve of the highway outside St Wilfrid's RC Primary School. (Plan DJ86 refers)
- d) **Fore Bondgate to Newgate Street** – introduce No Waiting At Any Time on Fore Bondgate from No. 35 easterly onto Newgate Street then southerly to No 40 Newgate Street. (Plan DL93 refers)

- e) **Market Place** – introduce No Waiting At Any Time on the west side of Market Place between No's 1a and 41. (Plan DL93 refers)
- f) **A688 Bypass** – introduce No Waiting At Any Time from a point adjacent to Bishop Auckland Football Club Ground (Heritage Park) between (and including) the roundabout serving Abraham Enterprise Park and the roundabout serving St Helens Auckland Industrial Estate. (Plans DI81, DJ81 and DJ82 refer)
- g) **Ladysmith Street** – introduce a 30m length of No Waiting At Any Time at the junction with Etherley Lane (both sides of road). (Plan DK91 refers)
- h) **Clarence Street** - introduce a 30m length of No Waiting At Any Time at the junction with Etherley Lane (both sides of road). (Plan DK91 refers)
- i) **Escomb Road** – replace a 30m length of existing Permit Holder Only Parking on the south side with Parking Mon-Sat 8am-6pm Max stay 2 hours No return within 2 hours from a point where it joins the existing No Waiting/No Loading At Any Time. (Plan DL89 refers)

4. ARTICLES

A new Article 20 (9) has been inserted which reads:

- (9) Nothing in Article 7 of this Order shall apply to a vehicle being used on identified market days for the purpose of trading in Market Place where the vehicle clearly displays a valid Market Trader parking permit issued by the Council and distributed by the relevant Market Manager.

A new Article 14B (23) has been inserted which reads:

- (23) Save as provided in Article 20 of this Order no person shall, except upon the direction or with the permission of an enforcement officer, or civil enforcement officer, cause or permit any vehicle, other than a vehicle displaying a valid parking permit issued by the Council, to wait in a permit holder only parking place on such days and during such times as identified in the individual plans detailed in Schedule 9 to this Order.

5. SCHEDULES

The following plans contained in the Schedules to the Order detailed in Article 2 herein have been removed / replaced / new plans inserted as indicated below:

- Schedule 1:** (a) Existing plans DL89, DL90, DL91 & DL93 have been removed and replaced with new plans bearing the seal date as at the date of this Order;
- (b) New plans bearing the reference DI81, DJ81, DJ82 and DK91 have been inserted; and
- Schedule 2:** Existing plan DL89, DL90, DL91 & DL93 have been removed and replaced with new plans bearing the seal date as at the date of this Order;
- Schedule 3:** Existing plans DL90 and DL91 have been removed and replaced with new plans bearing the seal date as at the date of this Order;
- Schedule 4:** Existing plans DL90, DL91 and DL93 have been removed and replaced with new plans bearing the seal date as at the date of this Order;

Schedule 5: Existing plans DL90 and DL93 have has been removed and replaced with new plans bearing the seal date as at the date of this Order;

Schedule 6: (a) Existing plans DL90, DL91 and DL93 have been removed and replaced with new plans bearing the seal date as at the date of this Order.

(b) New plan reference DL89 has been inserted.

Schedule 7: New plans DL90 and DL93 have been removed and replaced with new plans bearing the seal date as at the date of this Order;

Schedule 8: Existing plan DL93 has been removed and replaced with a new plan bearing the seal date as at the date of this Order;

Schedule 9: Existing plans DL89 & DL93 have been removed and replaced with new plans bearing the seal date as at the date of this Order;

Schedule 10: Existing plans DJ86 & DL91 have been removed and replaced with new plans bearing the seal date as at the date of this Order;

Schedule 11: Existing plans DL90 and DL93 have been removed and replaced with new plans bearing the seal date as at the date of this Order;

GIVEN UNDER THE COMMON SEAL OF THE COUNTY COUNCIL OF DURHAM ON THE 6th DAY OF JULY 2017

.....
Authorised Sealing Officer



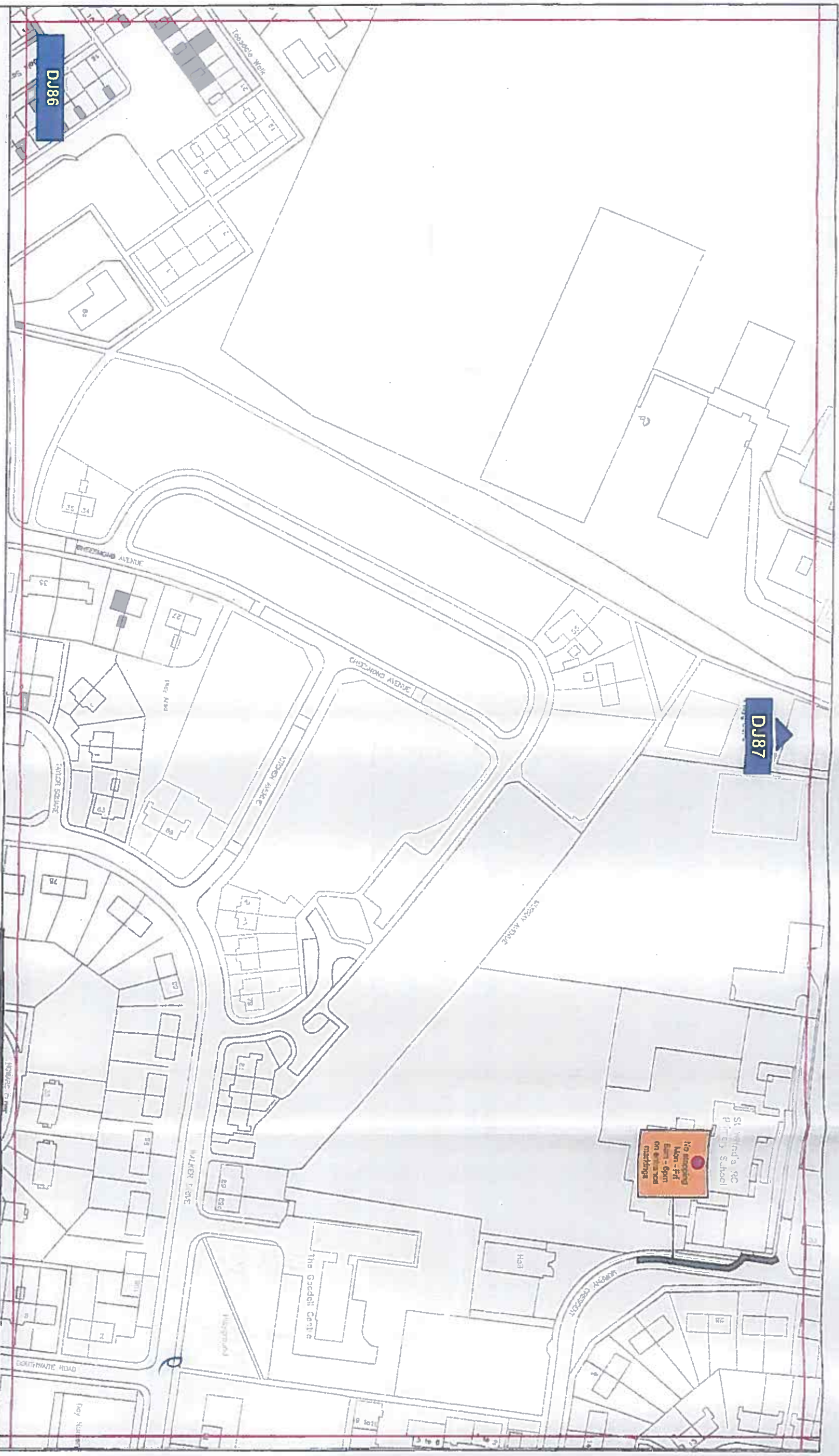

Key to Type of Restriction

No Stopping

XXXXX Individual Map Schedule Reference Number



Corporate Director
Regeneration & Economic
Development
Strategic Traffic Management
County Hall, Durham DH1 1SU

BISHOP AUCKLAND PARKING AND WAITING RESTRICTIONS

| | |
|---------------|-------------|
| Scale: | 1:1250 @ A3 |
| Date: | March 2017 |
| Drawn by: | J. Hegarth |
| Date Sealed: | 6/7/17. |
| Signature: | J. Hegarth |
| Map Schedule: | DJ86 |



Key to Types of Restriction



No Waiting At Any Time



XXXXX Individual Map Schedule Reference Number



Corporate Director
Regeneration & Economic
Development

Strategic Traffic Management
County Hall, Durham DH1 1SU

BISHOP AUCKLAND PARKING AND WAITING RESTRICTIONS

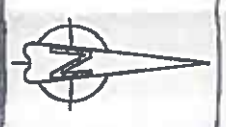

| | |
|---------------|-------------|
| Scale: | 1:1250 @ A3 |
| Date: | March 2017 |
| Drawn by: | J. Hogarth |
| Date Sealed: | 6/7/17 |
| Signature: | J. Hogarth |
| Map Schedule: | DK86 |

PATH: L:\MAPS\Map Based Schedules\OPE SOUTH
Weir Valley Bishop Auckland MBS

Reproduced from Ordnance Survey material with the permission of Ordnance Survey on behalf of the Controller of Her Majesty's Stationery Office & Crown copyright. Unauthorised reproduction infringes Crown copyright and may lead to prosecution or civil proceedings. Durham County Council, LA 100049055, 2017.



Key to Types of Restriction

-  No Waiting At Any Time
-  No Waiting and No Loading/Unloading At Any Time
-  Restricted Bay
-  Permit Holders Only

PATH: L:\MAPS\Map Based Schedules\CPE SOUTH
Wear Valley\Bishop Auckland HBS

Reproduced from Ordnance Survey material with the permission of Ordnance Survey on behalf of the Controller of Her Majesty's Stationary Office © Crown copyright. Unauthorised reproduction infringes Crown copyright and may lead to prosecution or civil proceedings. Durham County Council. LA 100049055. 2017

XXXXX Individual Map Schedule Reference Number



Corporate Director
Regeneration & Economic
Development

Strategic Traffic Management
County Hall, Durham DH1 5UG

BISHOP AUCKLAND PARKING AND WAITING RESTRICTIONS

| | |
|---------------|-------------|
| Scale: | 1:1250 @ A3 |
| Date: | March 2017 |
| Drawn by: | J Hoggath |
| Date Sealed: | 6/7/17 |
| Signature: | J Hoggath |
| Map Schedule: | DL89 |

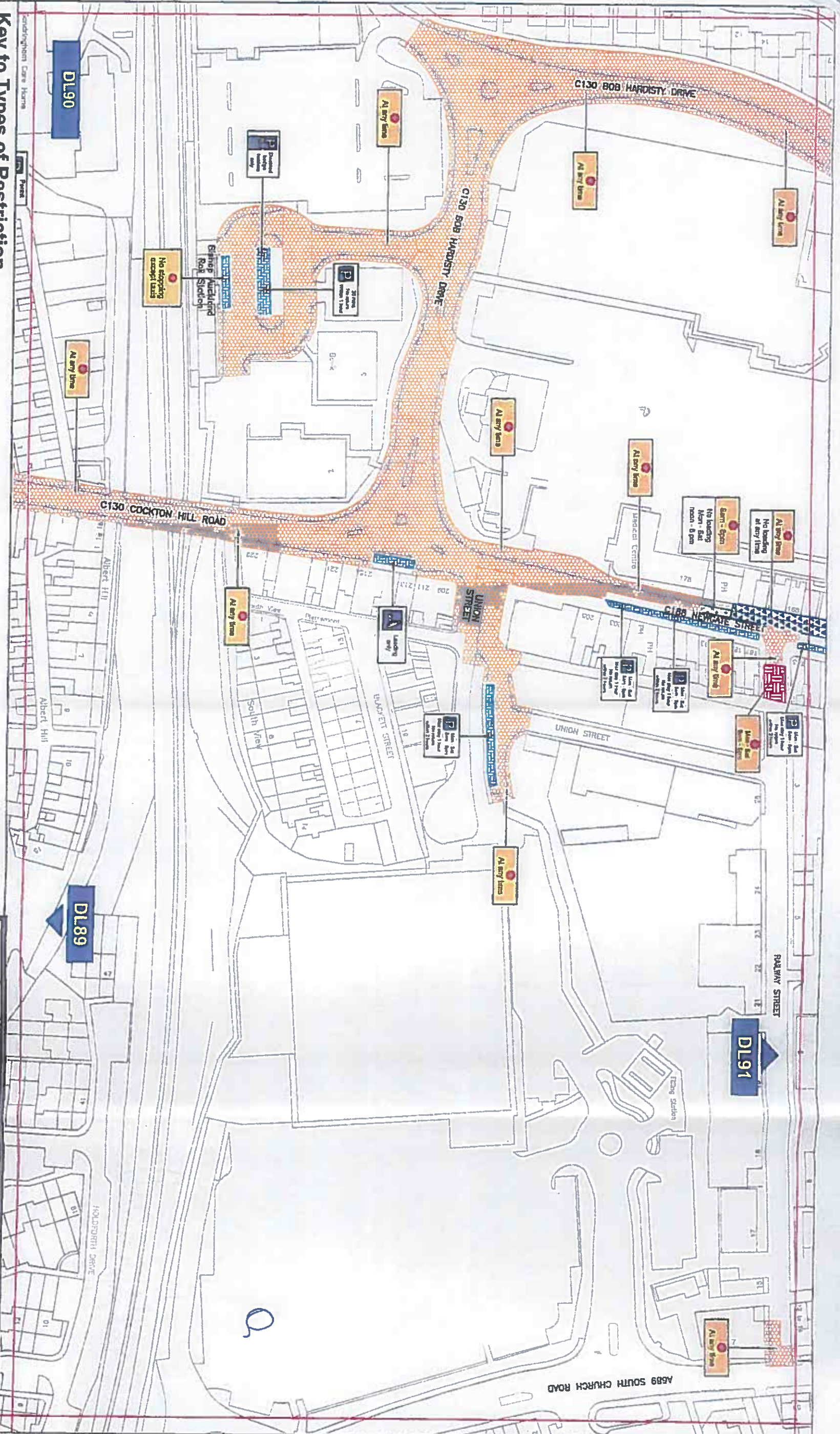

Key to Types of Restriction

- No Waiting At Any Time
- No Waiting and No Loading/Unloading At Any Time
- Restricted Bay
- Restricted Waiting
- Restricted Loading/Unloading

PA11: L:\MAPSWAP Based Schedules\CPE SOUTH
Wear Valley\Bishop Auckland MBS

Reproduced from Ordnance Survey material with the permission of Ordnance Survey on behalf of the Controller of Her Majesty's Stationary Office © Crown copyright. Unauthorised reproduction infringes Crown copyright and may lead to prosecution or civil proceedings. Durham County Council, LA 100049055, 2017

XXXXX Individual Map Schedule Reference Number



Corporate Director
Regeneration & Economic
Development

Strategic Traffic Management
County Hall, Durham DH1 1SU

BISHOP AUUCKLAND
PARKING AND WAITING RESTRICTIONS

| | |
|---------------|-------------|
| Scale: | 1:1250 @ A3 |
| Date: | March 2017 |
| Drawn by: | J. Hogarth |
| Date Sealed: | 6/7/17 |
| Signature: | J. Hogarth |
| Map Schedule: | DL90 |

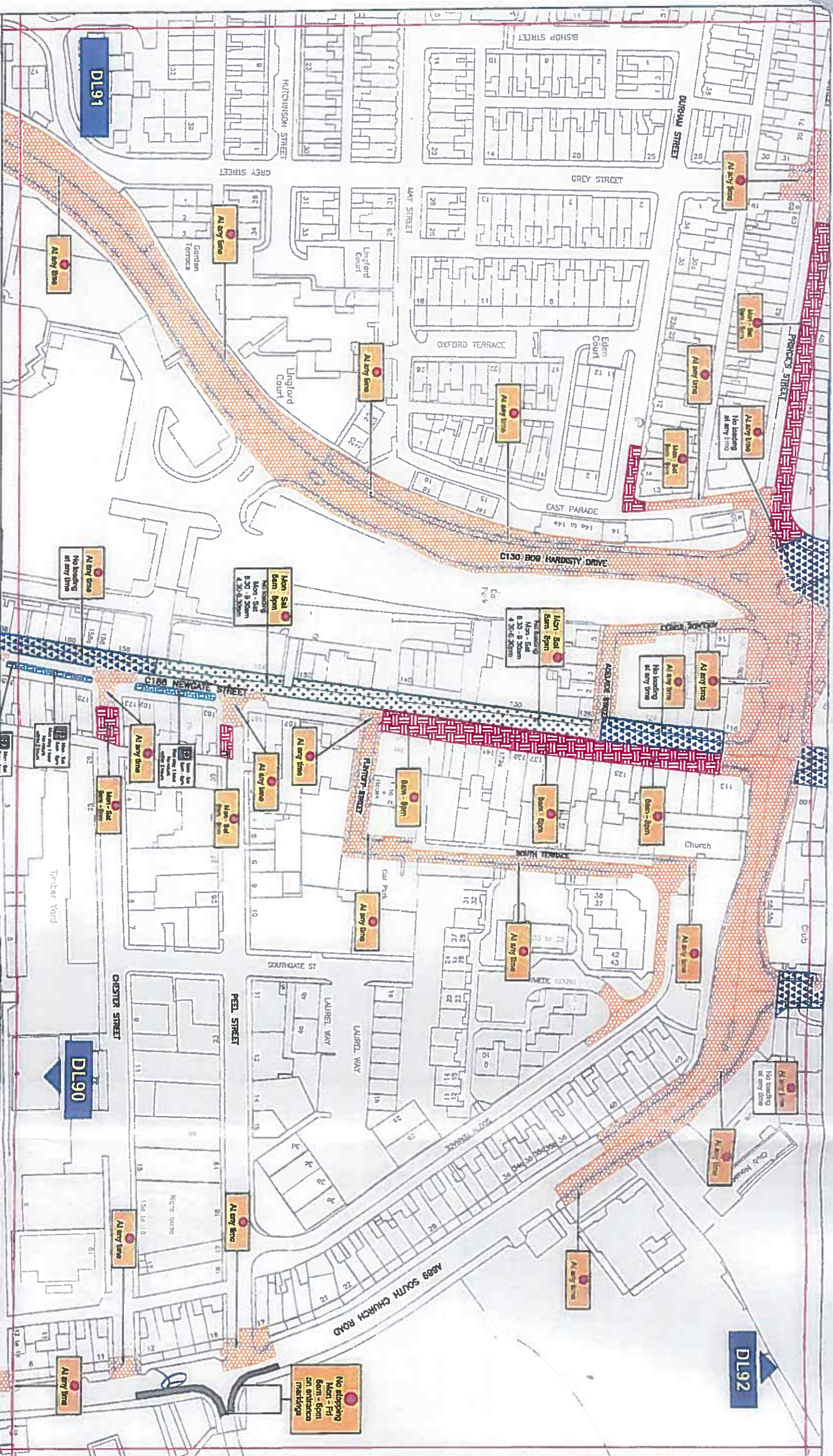

Key to Types of Restriction

- No Waiting At Any Time
- Restricted Waiting
- No Waiting and No Loading/Unloading At Any Time
- Restricted Bay
- Restricted Loading/Unloading
- No Stopping

XXXXX Individual Map Schedule Reference Number



Corporate Director
Regeneration & Economic
Development

Strategic Traffic Management
County Hall, Durham DH1 1SU

BISHOP AUCKLAND PARKING AND WAITING RESTRICTIONS

| | | | |
|--------------|-------------|---------------|------------|
| Scale: | 1:1250 @ A3 | | |
| Date: | March 2017 | | |
| Drawn by: | J. Hogarth | Signature: | J. Hogarth |
| Date Sealed: | 6/7/17 | Map Schedule: | DL91 |

PATH: L:\MAPS\Map Based Schedules\CPE SOUTH
Wear Valley\Bishop Auckland MBS

Reproduced from Ordnance Survey material with the permission of Ordnance Survey on behalf of the Controller of Her Majesty's Stationary Office © Crown copyright. Unauthorised reproduction infringes Crown copyright and may lead to prosecution or civil proceedings. Durham County Council. LA 100049055. 2017.

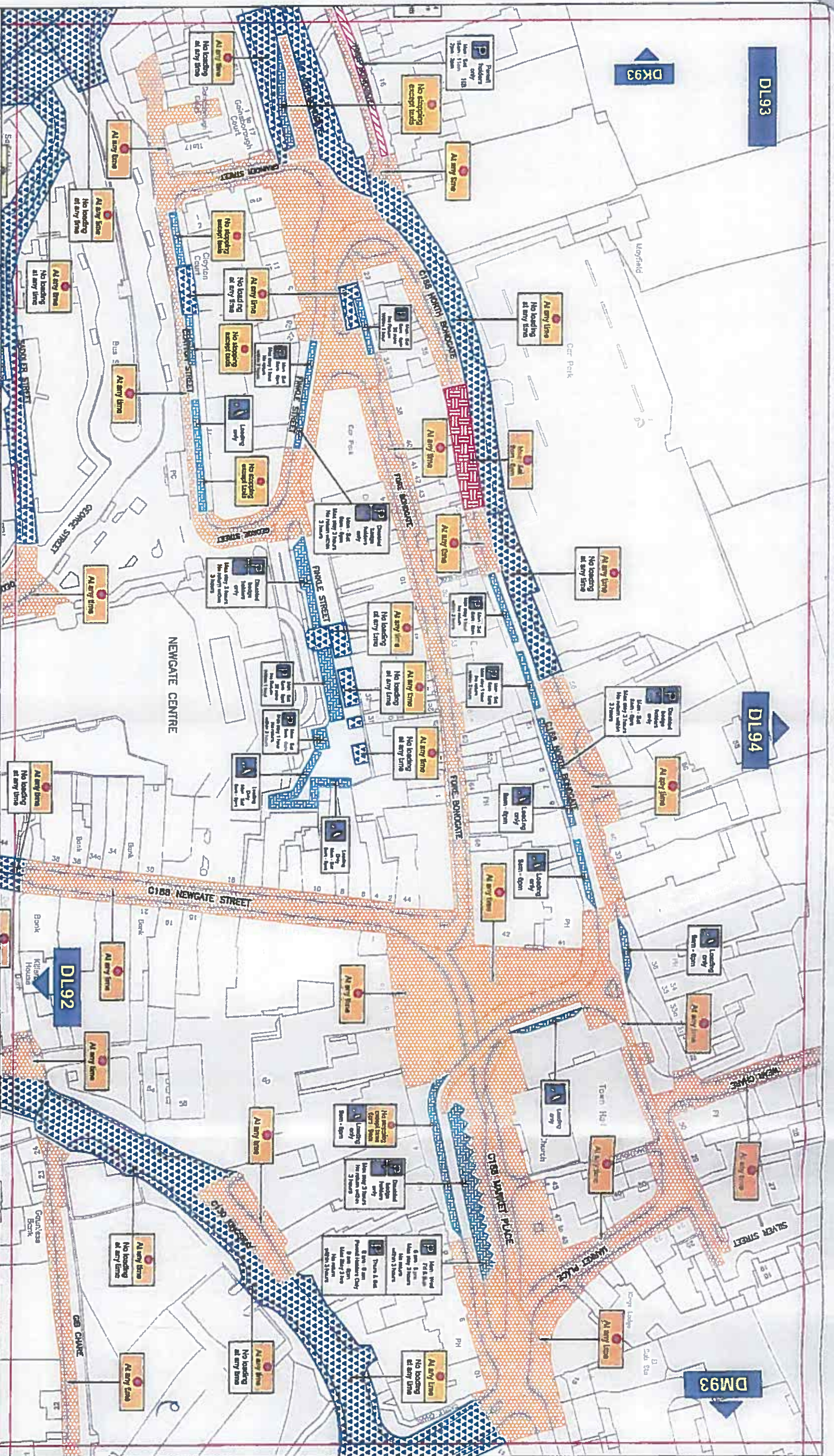

Key to Types of Restriction

- No Waiting At Any Time
- No Waiting and No Loading/Unloading At Any Time
- Restricted Waiting
- Restricted Bay
- Permit Holders Only

XXXXXX Individual Map Schedule Reference Number



Corporate Director
Regeneration & Economic
Development

Strategic Traffic Management
County Hall, Durham DH1 1SU

BISHOP AUCKLAND PARKING AND WAITING RESTRICTIONS

| | |
|---------------|-------------|
| Scale: | 1:1250 @ A3 |
| Date: | March 2017 |
| Drawn by: | J. Hogarth |
| Date Sealed: | 6/7/17 |
| Signature: | J. Hogarth |
| Map Schedule: | DL93 |

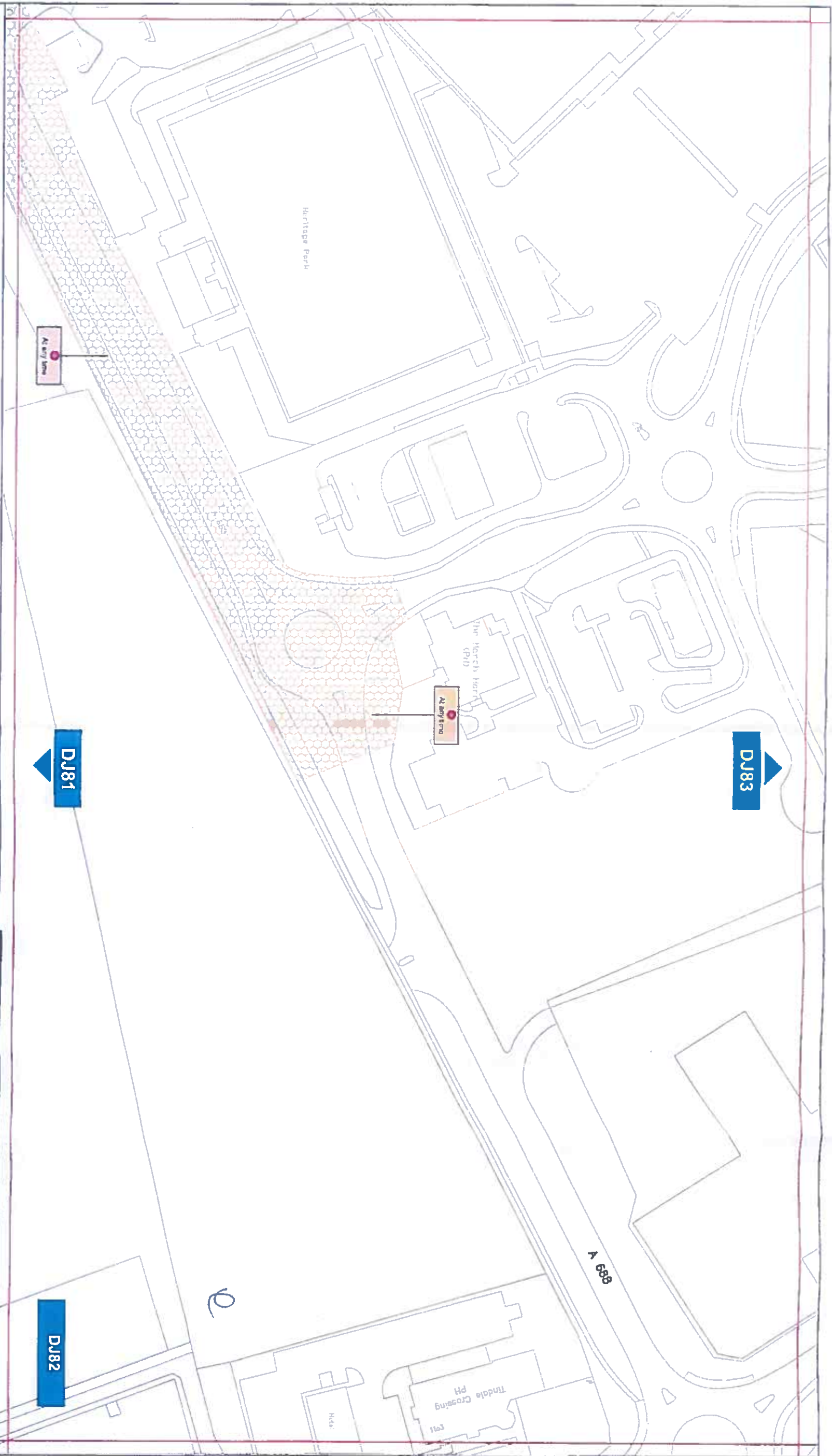

No Waiting At Any Time

Key to Type of Restriction

XXXXX

Individual Map Schedule Reference Number

PATH: L:\MAPS\Map Based Schedule\CPRE SOUTH Wear Valley\Bishop Auckland MBS

Reproduced from Ordnance Survey material with the permission of Ordnance Survey on behalf of the Controller of Her Majesty's Stationary Office © Crown copyright. Unauthorised reproduction infringes Crown copyright and may lead to prosecution or civil proceedings. Durham County Council. LA 100049855. 2017.



Corporate Director
Regeneration & Economic
Development

Strategic Traffic Management
County Hall, Durham DH1 5UD

BISHOP AUCKLAND PARKING AND WAITING RESTRICTIONS

Scale: 1:1250 @ A3

Date: March 2017

Drawn by: J. Hogarth

Signature: J. Hogarth

Date Sealed: 6/7/17

Map Schedule:

DJ82

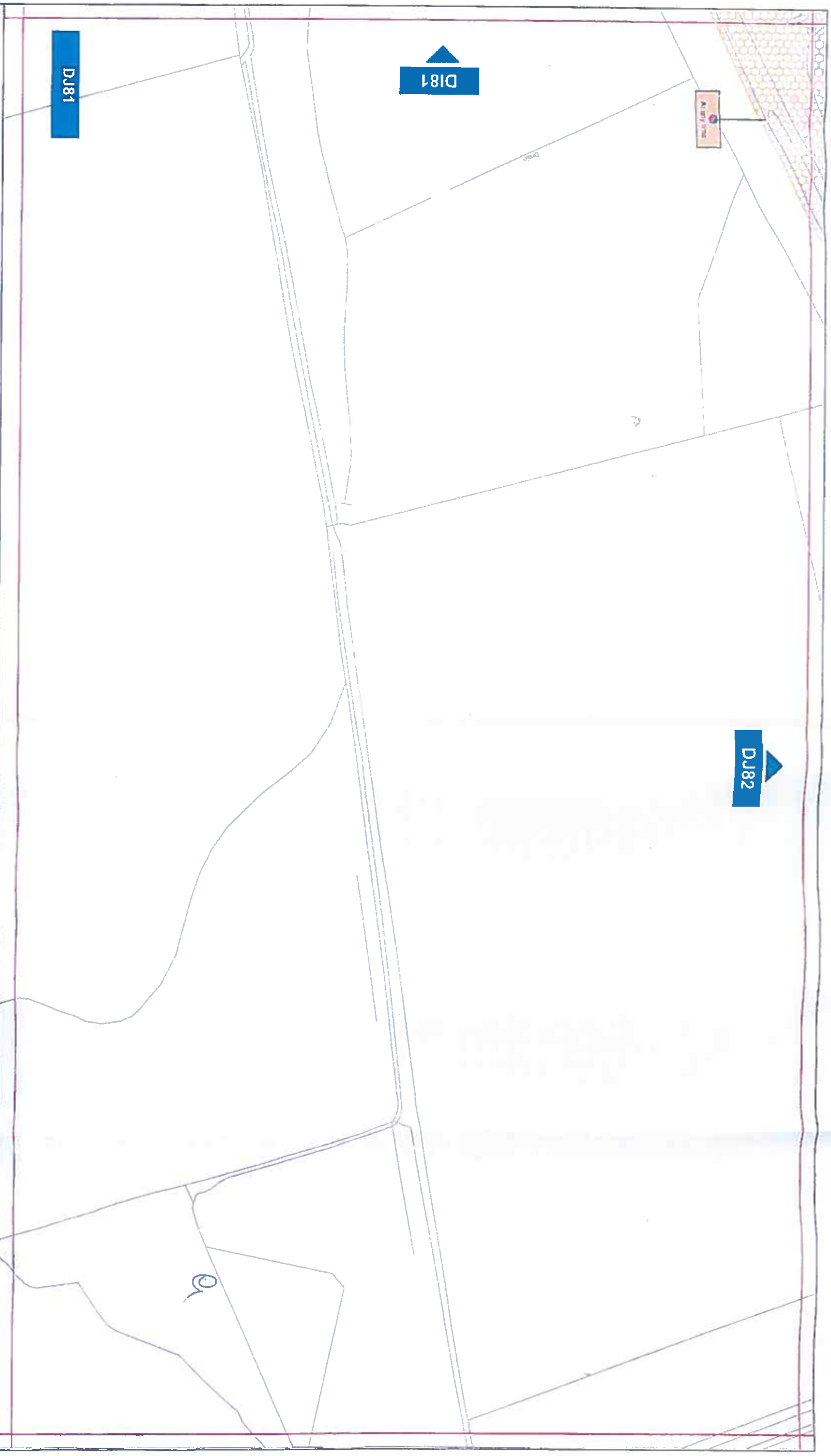

Key to Type of Restriction

No Waiting At Any Time

XXXXXX
Individual Map Schedule Reference Number

Reproduced from Ordnance Survey material with the permission of Ordnance Survey on behalf of the Controller of Her Majesty's Stationery Office © Crown copyright. Unauthorised reproduction infringes Crown copyright and may lead to prosecution or civil proceedings. Durham County Council. LA 100049055. 2017.



**Corporate Director,
Regeneration & Economic
Development**

**Strategic Traffic Management
County Hall, Durham DH1 1UA**

BISHOP AUCKLAND PARKING AND WAITING RESTRICTIONS

Scale: 1:1250 @ A3

| | |
|-------|------------|
| Date: | March 2017 |
|-------|------------|

| | | | |
|-----------|---------------|------------|---------------|
| Drawn by: | J. H. Hogarth | Signature: | J. H. Hogarth |
|-----------|---------------|------------|---------------|

| | | | |
|--------------|--------|---------------|------|
| Date Sealed: | 5/7/17 | Map Schedule: | DJ81 |
|--------------|--------|---------------|------|



