THE BOROUGH COUNCIL OF DUDLEY (2022HK TRO) (VARIOUS ROADS)
(PROHIBITION AND RESTRICTION OF WAITING AND LOADING, NO STOPPING
ON ENTRANCE MARKINGS, DISABLED PARKING PLACES AND PARKING
PLACES) (NUMBERS 3,4,5,6 AND 7 ORDER TYPE) (STOURBRIDGE, HALESOWEN,
CENTRAL DUDLEY, NORTH DUDLEY, AND BRIERLEY HILL AREAS)

ORDER 2022

THE BOROUGH COUNCIL OF DUDLEY (2022HK TRO) (VARIOUS ROADS)
(PROHIBITION AND RESTRICTION OF WAITING AND LOADING, NO STOPPING
ON ENTRANCE MARKINGS, DISABLED PARKING PLACES AND PARKING
PLACES) (NUMBERS 3,4,5,6 AND 7 ORDER TYPE) (STOURBRIDGE, HALESOWEN,
CENTRAL DUDLEY, NORTH DUDLEY, AND BRIERLEY HILL AREAS)
ORDER 2022

The Borough Council of Dudley (hereinafter referred to as “the Council”) in exercise of its powers under Sections 1, 2, 4, 5, 32, 35, 124 (1) (d) and part IV of Schedule 9 of the Road Traffic Regulation Act 1984 (“the Act of 1984”) and of all other powers them enabling in that behalf, and with the consent of every authority and person responsible for the maintenance of the roads affected by this Order and after consultation with the Chief Officer of Police in accordance with Part III of Schedule 9 to the Act of 1984, hereby makes the following Order.

SECTION 1 – PRELIMINARY

Citation and commencement

1. This Order shall come into operation on the 16th day of November 2022 and may be cited as The Borough Council of Dudley (2022HK TRO) (Various Roads) (Prohibition And Restriction of Waiting and Loading, No Stopping on Entrance Markings, Disabled Parking Places and Parking Places) (Numbers 3,4,5,6 And 7 Order Type) (Stourbridge, Halesowen, Central Dudley, North Dudley, and Brierley Hill Areas) Order 2022
2. The Borough Council of Dudley (2022HK TRO) (Various Roads) (Prohibition And Restriction of Waiting and Loading, No Stopping on Entrance Markings, Disabled Parking Places and Parking Places) (Numbers 3,4,5,6 And 7

Order Type) (Stourbridge, Halesowen, Central Dudley, North Dudley, and Brierley Hill Areas) Order 2022

3. Plans including the Key (the “Plans”) are incorporated into this Order.

Interpretation

4. In this Order, except where the context otherwise required, the following expressions have the meaning hereby respectively assigned to them:

“Council” means The Borough Council of Dudley and includes any parking services contractors or authorised agent appointed by or acting on behalf of the Council for the purposes of any function under the provisions of this Order;

“civil enforcement officer” means a person employed in accordance with section 63A of the Act of 1984 to carry out the functions therein within the district of The Borough Council of Dudley;

“clearway” means the main carriageway of any of the sides or lengths of roads specified in the Plans where stopping is prohibited during the restricted hours provided that the expression clearway shall not include any lay-by or parking place;

“disabled person’s badge” has the same meaning as in the Disabled Persons (Badges for Motor Vehicles) (England) Regulations 2000;

“dispensation” means permission given by or on behalf of the Council for the purposes of this Order permitting a specified vehicle to wait in specified circumstances on a parking place without time limit where the waiting of that vehicle in that parking place would otherwise be restricted in time.

“doctor” means qualified medical practitioner;

“driver” in relation to a vehicle waiting in a restricted area, means the person driving the vehicle at the time it was left in the restricted waiting area or parking place;

“goods” means goods of any kind whether animate or inanimate and includes postal packets of any kind or description;

"hackney carriage" is as defined by the Town Police Clauses Act 1847, means a vehicle standing or plying for hire;

“highway” means a way over which there exists a public right of passage, that is to say a right for all of Her Majesty’s subjects at all seasons of the year freely and at their will to pass and repass without let or hindrance, the extents of which is the entire width of the highway, which comprises either a footway or footways, or a verge and a carriageway or a combination thereof, in which the highway authority may vary the relative widths thereof,

“highway boundary” means the entire width of the highway, which comprises either a footway or footways, or a verge and a carriageway or a combination thereof;

“Key” means the key attached to the Plans to be read in conjunction with the Plans;

“lay-by” in relation to a main carriageway means any area of a highway at the side of the main carriageway but not part of it and marked in accordance with the Traffic Signs and General Directions 2002 intended for the waiting of vehicles, provided that no person shall cause or permit any vehicle to wait in any lay-by for the purpose of selling goods or services from that vehicle;

“light goods vehicle” means a motor vehicle which is constructed or adapted for use for the carriage of goods or burden of any description the overall height of which does not exceed 2.3 metres and the overall length of which does not exceed 5.25 metres and is not a drawing trailer;

“loading area” means any of the sides or lengths of roads specified on the Plans where activities other than loading are prohibited at the stated times;

“loading permit area” means any of the sides or lengths of roads specified on the Plans where activities other than continuous loading and unloading to and from vehicles are prohibited at the stated times. A permit for loading and unloading may be issued by the Council from time to time and must be displayed when issued;

“loading zone area” means any of the sides or lengths of roads specified on the Plans where activities other than loading are prohibited at the stated times;

“main carriageway” means that part of a public highway used primarily for through traffic provided that the expression main carriageway shall not include any lay-by;

“motor-cycle” has the same meaning as that defined by section 136(4) of the Road Traffic Regulation Act 1984;

“motor vehicle” has the same meaning as that defined by section 136 of the Road Traffic Regulation Act 1984

“no loading hours” means in relation to any no loading road the hours specified on the Plans during which loading and unloading is restricted;

“no loading road” means any of the sides or lengths of roads specified on the Plans where loading is prohibited provided that the expression “no loading road” shall not include any parking place;

“no stopping hours” means in relation to any no stopping road the hours of which are specified in the Plans during which stopping is restricted;

“no stopping road” means any of the sides or lengths of roads (including clearways) specified on the Plans where stopping is prohibited provided that the expression “no stopping road” shall not include any parking place;

“one-way street” means a highway in which the driving of vehicles otherwise than in a specified direction is prohibited;

“Order” means The Borough Council of Dudley (2022HK TRO) (Various Roads) (Prohibition And Restriction of Waiting and Loading, No Stopping on Entrance Markings, Disabled Parking Places and Parking Places) (Numbers 3,4,5,6 And 7 Order Type) (Stourbridge, Halesowen, Central Dudley, North Dudley, and Brierley Hill Areas) Order 2022

“owner” in relation to a vehicle, means the person by whom such vehicle is kept and used. In determining who was the owner at any time it shall be presumed that the owner was the person named in the vehicle registration document as the registered keeper of the vehicle or the person who has the use of such vehicle in the course of his / her employment and who is entitled to use such vehicle as though he / she were the registered keeper thereof;

“parking disc” has the same meaning as in the Local Authorities Orders (Exemptions for Disabled Persons) (England) Regulations 2000 and being a parking disc, which is capable of showing the quarter hour period during which a period of waiting has begun;

“parking place” means an area of a highway designated by this Order for the waiting of vehicles of specific classes and indicated on a carriageway by markings in accordance with the Traffic Signs Regulations and General Directions 2002;

“passenger vehicle” means a motor vehicle (other than a motor-cycle or invalid carriage) constructed or adapted solely for the carriage of not more than twelve passengers (exclusive of the driver);

“Penalty Charge” means a charge imposed by legislation in respect of parking contraventions that are subject to civil enforcement and which has the same meaning as in the Civil Enforcement of Parking Contraventions (England) General Regulations 2007;

“Penalty Charge Notice” has the same meaning as in the Civil Enforcement of Parking Contraventions (England) General Regulations 2007;

“permit” means any valid permit issued by the Council under the provisions of this order or any other orders made under the Act of 1984 and includes duplicate permits issued by the Council under the provisions of this Order;

“permit holder” means a person, business or organisation to whom a valid permit has been issued under the provisions of this order or any other orders made under the Act of 1984;

“permitted hours” means the periods specified on the Plans for each parking place during which waiting by vehicles of a specific class is permitted;

“Plans” means those plans as listed in the Schedule to this Order, including any Amendment Orders;

“prohibited hours” means in relation to any prohibited road the hours specified on the Plans during which waiting or loading is prohibited;

“prohibited road” means any of the sides or lengths of roads specified on the Plans where waiting is prohibited provided that the expression “prohibited road” shall not include any parking place;

“qualified medical practitioner” means a fully registered person within the medical Act 1983;

“relevant position” means:

(i) In respect of a disabled badge-

- (a) in the case of a vehicle fitted with a front windscreen, the badge is exhibited on the dashboard or fascia of the vehicle, or
 - (b) in the case of vehicle not fitted with a front windscreen, the badge is exhibited in a conspicuous position on the vehicle,
so that the front of the badge is clearly legible from outside the vehicle,
-

(ii) In respect of a pay and display ticket or season ticket-

- (a) in the case of a two-wheeled motor cycle having a sidecar attached thereto, in a conspicuous position on the vehicle in front of the driving seat; and in the case of all other vehicles:-
 - (b)
 - (i) where the vehicle is fitted with a front glass windscreen inside the windscreen or in a conspicuous position facing forwards; or
 - (ii) where the vehicle is not fitted with a front glass windscreen, in a conspicuous position on the vehicle, so that the amount paid and the date and time of expiry of the ticket on the front of the said ticket or tickets is clearly visible;
-

“restricted hours” means in relation to any restricted road the hours specified on the Plans during which waiting is restricted;

“restricted road” means any of the sides or lengths of roads specified on the Plans where waiting is restricted or specific activities are restricted during the restricted hours provided that the expression “restricted road” shall not include any parking place;

“taxi rank” means an area of carriageway designated for the waiting of hackney carriages and which is indicated by road markings complying with the Traffic Signs Regulations and General Directions 2002;

“telecommunication system” has the same meaning as in the Telecommunications Act 1984;

“waiver certificate” means a certificate issued by or on behalf of the Council for the purposes of this Order permitting a specified vehicle to wait in specified circumstances on a length or lengths of road where the waiting of that vehicle would otherwise be restricted or prohibited.

5. Any reference in this Order to a numbered Article shall, unless the context requires otherwise, be construed as a reference to the Article bearing that number in this Order and any reference to a Plan is a reference to a Plan incorporated into this Order.
 6. Any reference in this Order to any enactment shall be construed as a reference to that enactment as amended, applied, consolidated, re-enacted by, or as having effect by virtue of any subsequent enactment.
-
7. The Interpretation Act 1978 shall apply to the interpretation of this Order as it applies for the interpretation of an Act of Parliament and as if for the purposes of Section 21 of that Act this Order were an Act of Parliament and the Orders revoked were Acts of Parliament thereby repealed.

SECTION 2 – PROHIBITION AND RESTRICTION OF WAITING AND LOADING

Prohibition of Waiting

8. Save as provided in Articles 13 to 21 no person shall, except upon the direction or with the permission of a police officer in uniform, cause or permit any vehicle to wait at any time on any prohibited road as specified on the Plans.

Restriction of waiting

9. Save as provided in Articles 13 to 21 no person shall, except upon the direction or with the permission of a police officer in uniform, cause or permit any vehicle or a vehicle of a specific class to wait on any restricted road during the restricted hours as specified on the Plans.

Loading zone areas

10. Save as provided in Articles 13 to 15 and 20 no person shall, except upon the direction or with the permission of a police officer in uniform, cause or permit any vehicle to wait during the restricted hours in any loading area specified on the Plans unless it is of the specified class and except for the loading or unloading of goods in connection with nearby trade, commercial or business premises.
11. Where there is specified in the Plans a maximum period during the restricted hours for which loading or unloading is permitted, no person shall, except upon the direction or with the permission of a police officer in uniform, cause or permit any vehicle to wait in any loading zone area,
- (a) for longer than is necessary for goods to be loaded onto or unloaded from the vehicle
 - (b) for a period longer than specified on the Plans, or
 - (c) if a period less than that specified on the Plans as being the period in which the vehicle shall not return has elapsed since a previous period of waiting by the same vehicle on the same side of length of road.

Restriction on loading and unloading

12. Save as provided in Articles 13 to 14 and 20 no person shall, except upon the direction or with the permission of a police officer in uniform, cause or permit any vehicle or a vehicle of a specific class to wait for the purpose of enabling goods to be loaded to or unloaded from the vehicle on any no loading road during the no loading hours as specified on the Plans.

Restriction on stopping

13. Save as provided in Articles 13 to 14 and 20 no person shall, except upon the direction or with the permission of a police officer in uniform, cause or permit any vehicle to stop on any no stopping road or clearway during the no stopping hours as specified on the Plans.
-

Emergencies

14. Nothing in Articles 7 to 12 shall render it unlawful to cause or permit any vehicle to wait in any of the roads, lengths of road or on the sides of road or loading areas specified therein for so long as may be necessary to enable the vehicle to be used in an emergency for fire and rescue, ambulance, or police purposes:

General exemptions

15. Nothing in Articles 7 to 12 shall render it unlawful to cause or permit any vehicle to wait in any of the roads, lengths of road or on the sides of road or loading areas specified therein for so long as may be necessary to enable:
- (a) the vehicle, if it cannot conveniently be used for such purpose in any other road, to be used in connection with any of the following operations, namely:-
 - (i) building, shop fitting, industrial or demolition operations;
 - (ii) the removal of any obstruction to traffic;
 - (iii) the maintenance, improvement or reconstruction of the said lengths or sides of road; the laying, erection, alteration or repair in or on land adjacent to the said lengths or sides of road of any sewer or of any main, pipe or apparatus for the supply of gas, water or electricity or of any telecommunications system ; and
 - (iv) the removal of snow, ice or traffic debris, by Council maintenance vehicles,

- (b) the vehicle, not being a passenger vehicle, if it cannot conveniently be used for such purposes in any other road, to be used in the service of a local authority or its contractors in pursuance of that authority's statutory powers or duties;
 - (c) the vehicle of the Royal Mail or other universal service provider (as defined in section 4(3) and (4) of the Postal Services Act 2000) to be used for the purpose of delivering and/or collecting mail;
-
- (d) in any case where the person in control of the vehicle,
 - (i) is required by law to stop;
 - (ii) is obliged to stop so as to prevent an accident, or
 - (iii) is prevented from proceeding by circumstances outside his/her control;

Loading and unloading

-
16. Nothing in Articles 7 to 10 shall render it unlawful to cause or permit any vehicle to wait in any of the roads, lengths of road or on the sides of road or loading areas specified therein for so long as may be necessary to enable goods to be loaded to or unloaded from a vehicle (or goods or merchandise to be delivered or collected).

Board and alight from a vehicle

17. Nothing in Articles 7 to 8 shall render it unlawful to cause or permit any vehicle to wait in any of the roads, lengths of road or on the sides of road specified therein for so long as may be necessary to enable a person to board or alight from the vehicle.

Funerals, weddings and other civic duties

18. Nothing in Articles 7 to 8 shall render it unlawful to cause or permit any vehicle to wait, if it cannot safely and conveniently do so elsewhere, in any of the roads,

lengths of road or on the sides of road specified therein if it is an official vehicle being used in connection with any funerals or weddings or official civic duties;

Council Highway Maintenance Vehicles

19. Nothing in Articles 7 to 12 shall prevent Council-controlled highway maintenance vehicles from operating where necessary.

Parking places

20. Nothing in Articles 7 to 12 shall render it unlawful to cause or permit any vehicle to wait in a designated parking place.

Waiting by vehicle displaying a waiver certificate

21. Nothing in Articles 7 to 12 shall prevent any person from causing or permitting a vehicle to wait in any prohibited or restricted road if it is displaying in the relevant position a valid waiver certificate issued by the Council and the vehicle is waiting in accordance with the terms and conditions of the said permit or certificate.

Waiting by disabled persons' vehicle

22. Nothing in Articles 7 to 8 shall render it unlawful to cause or permit a vehicle which displays in the relevant position a disabled person's badge and the accompanying a parking disc, on which the driver or other person in charge of the vehicle has marked the time at which the period of waiting began, to wait in a prohibited road or a restricted road for a period not exceeding 3 hours (not being a period separated by an interval of less than that specified on the Plans from a previous period of waiting by the same vehicle in the same length of road or on the same side of road on the same day):

Provided that the vehicle immediately before or after the act of parking has been or is about to be driven or used by the person to whom the badge has been issued or, as the case may be, used for the carrying of disabled person(s) as passenger(s).

-
23. Nothing in Articles 7 and 8 and 12 shall prevent any person from causing or permitting a licensed hackney carriage to wait in any duly authorised taxi rank during the period of operation specified on the Plans.
24. No person shall cause or permit any vehicle other than a hackney carriage to wait on a taxi rank during the period of operation.
25. No person shall cause or permit a hackney carriage to wait on a taxi rank during the period of operation other than for the purpose of plying for hire.
-
26. No person shall cause or permit any vehicle to wait on a taxi rank outside the period of operation of the taxi rank as specified on the Plans.

SECTION 3 - GENERAL

Waiver certificate

27. The Council may issue a waiver certificate on receipt of application and may impose terms and conditions as appropriate.
28. A waiver certificate may be cancelled at any time at the sole discretion of the Council and shall thereupon immediately cease to be valid. Notification of such cancellation shall be in writing to the holder of the certificate at any address that

the Council believes to be that person's address or last known address and the certificate shall forthwith be surrendered to the Council.

Pedestrian crossings and bus stops

29. Nothing in the provisions of this Order shall be taken as authorising anything which would be a contravention of any regulations made or having effect as if made under Sections 23 and 25 of the Act of 1984.
30. Insofar as any provision of this Order conflicts with a provision which is contained in an order made or having effect as if it were made under the Act of 1984, and existing at the time when this Order comes into operation, and which imposes a restriction or prohibition on waiting by vehicles other than public service vehicles being used to operate a local service in a bus stop area or grants an exemption from such restriction or prohibition, the provisions of that order will prevail.

SECTION 4 - CONTRAVENTION OF ORDER

Contravention

If a Vehicle is left in a prohibited or restricted road or parking place without complying with the requirements of this Order, a contravention shall have occurred and a penalty charge shall be payable. A penalty charge notice conforming to the relevant statutory requirements may then be served and / or the vehicle may be removed from the location.

Indications as evidence

31. The particulars given in the penalty charge notice served in accordance with this Order shall be treated as evidence in any proceedings relating to failure to pay such penalty charge.

Restriction on removal of notices

32. Where a penalty charge notice has been attached to a vehicle in accordance with the provisions of this Order no person, not being the driver of the vehicle, a police officer in uniform, a civil enforcement officer or some other person duly authorised by the Council shall remove the notice from the vehicle unless authorised to do so by the driver of the vehicle.
-

Immobilisation

33. If a vehicle is left after a penalty charge has been incurred, a civil enforcement officer or a person acting under his/her direction may attach to the vehicle an immobilisation device and a notice in accordance with the requirements of section 69(1) of the Act of 1991 and that vehicle shall only be released from the device on payment of the penalty charge along with such release fee as may be required by the Council.
-

Removal of vehicle

34. Where a civil enforcement officer has removed or caused to be removed a vehicle in accordance with this Order
- (a) he / she shall provide for the safe custody of the vehicle;
 - (b) the Council shall be entitled to recover from the person responsible such charges in respect of the removal, storage and disposal of the vehicle as it might prescribe from time to time;
 - (c) the provisions of the Act of 1984 as amended shall apply to the disposal of such vehicles removed by or on behalf of the Council pursuant to this Article.
35. No vehicles shall be immobilised or removed in accordance with the provisions of this Order where that vehicle is displaying in a relevant position a valid disabled person's badge.

36. The restrictions imposed by this Order shall be in addition to and not in derogation from any restriction or requirements imposed by any regulations made or having effect as if made under the Act of 1984 or by or under any other enactment.

SECTION 5 - VALIDITY

37. If a court, the Department for Transport, the Traffic Penalties Tribunal, or the Traffic Enforcement Centre declares any part of this Order to be invalid or unenforceable, such declaration shall not invalidate the remainder of the Order.

SECTION 6 - REVOCATIONS

38. All the traffic regulation orders, or parts of traffic regulation orders specified in Schedule 2 to this Order are hereby revoked.

Schedule 1

Those lengths of road listed below as shown in plan:

TM 5236	Olive Lane, Halesowen
TM5237	Woodland Avenue, Dudley
TM5238	Southwick Road, Halesowen
TM5239	Blackberry Lane, Halesowen
TM5240	Hagley Road, Stourbridge
TM5241	Prospect Hill, Stourbridge
TM5242	Highbridge Road, Netherton
TM5243	Victoria Street, Stourbridge
TM5244	New England, Halesowen
TM5245	Rosemary Lane, Stourbridge
TM5246	Powlers Close, Stourbridge

TM5247 TM5248	Long Lane, Southwick Road, Halesowen
TM5271	Masters Lane, Holt Road, Halesowen
TM5249	Talbots Lane, Quarry Bank
TM5253	Long Lane, Halesowen
TM5254	Two Gates Lane, Halesowen

Schedule 2

Revocation of Parts of Existing Orders

Order Title	Lengths to be revoked as overlaid with the plans to this Order and Tile References
<p style="text-align: center;">THE BOROUGH COUNCIL OF DUDLEY (PROHIBITION AND RESTRICTION OF WAITING AND LOADING AND PARKING PLACES, DISABLED RESIDENTS PARKING PLACES AND NO STOPPING ON SCHOOL ENTRANCE MARKINGS) (CONSOLIDATION 2.0) ORDER 2021</p>	<p>Tile Ref: so9785 NW (Olive Lane, Halesowen) So9491 SW (Woodland Avenue, Dudley) So9885 NW (Southwick Road) So9682 NW (Blackberry Lane, Halesowen) So9083 NW (Hagley Road and Prospect Hill, Stourbridge) So9387 NE (Highbridge Road, Netherton) So9084 SW (Victoria Road, Stourbridge) So8883 SE (Rosemary Lane, Stourbridge) So9785 NE (Southwick Road and Long Lane, Halesowen) So9286 SW (Talbots Lane, Brierley Hill) So9484 SW (Two Gates Lane, Halesowen) So9886 SW (Masters Lane Holt Road, Halesowen) So9282 NW (Powlers Close, Pedmore)</p>

**THE COMMON SEAL of THE BOROUGH
COUNCIL OF DUDLEY was hereunto affixed
This 9th day of November 2022
In the presence of:- Jo White, clerk .**

Mandy Wilcox
Principal Lawyer



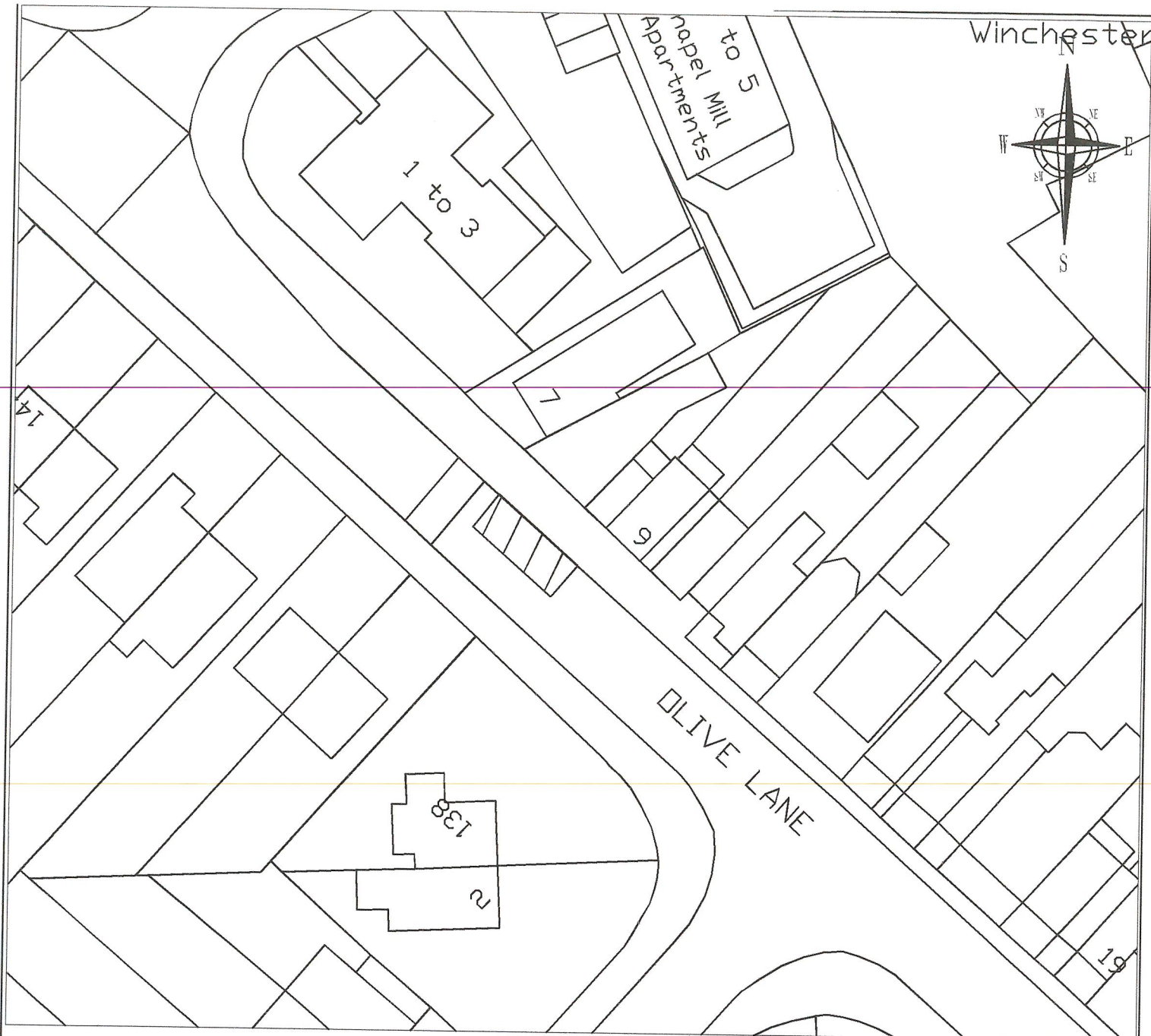

Revoke Permit Holders Disabled Bay

© Crown Copyright and database right 2022.
Ordnance Survey 100019566

Directorate of Public Realm

Traffic & Road Safety
4 Ednam Road
Dudley DY1 1HL
www.dudley.gov.uk



Project **Revocation of Permit Holders Disabled Bay, Olive Lane, Halesowen**
Title **Interim Programme 2022**

Drawing No.
TM 5236

Drawn By **JK**

Checked By **JB**

Revision No.

Date **May 2022**

Scale **NTS@ A4**

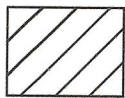

Revoke Limited Waiting, Mon - Fri
8.30am to 8.30pm, 1 hour no return 2 hours

Replace with Prohibition of Waiting

© Crown Copyright and database right 2022.
Ordnance Survey 100019566

Directorate of Public Realm

Traffic & Road Safety
4 Ednam Road
Dudley DY1 1HL
www.dudley.gov.uk



Project Title
**Proposed Prohibition of Waiting and revocation of Limited Waiting,
Woodland Avenue, Dudley
Interim Programme 2022**

Drawing No.
TM 5237

Drawn By
JK

Checked By
JB

Revision No.

Date
May 2022

Scale
NTS@ A4



Revoke Permit Holders Disabled Bay

© Crown Copyright and database right 2022.
Ordnance Survey 100019566

Directorate of Public Realm

Traffic & Road Safety
4 Ednam Road
Dudley DY1 1HL
www.dudley.gov.uk



Project **Revocation of Permit Holders Disabled Bay, Southwick Road, Halesowen**
Title **Interim Programme 2022**

Drawing No.
TM5238

Drawn By **JK**

Checked By **JB**

Revision No.

Date **May 2022**

Scale **NTS@ A4**

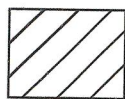
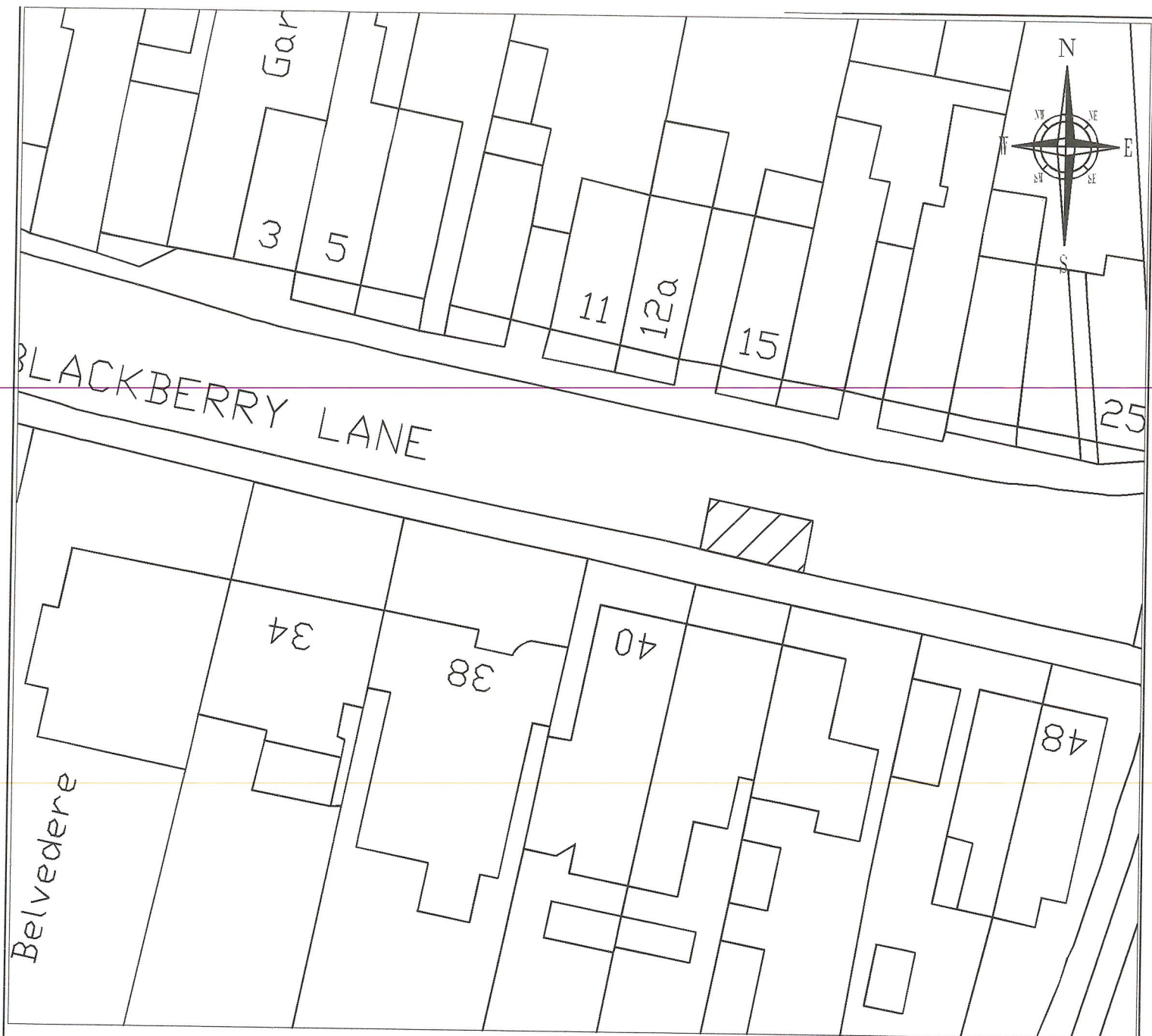

Revoke Permit Holders Disabled Bay

© Crown Copyright and database right 2022.
Ordnance Survey 100019566

Directorate of Public Realm

Traffic & Road Safety
4 Ednam Road
Dudley DY1 1HL
www.dudley.gov.uk



Project **Revocation of Permit Holders Disabled Bay, Blackberry Lane, Halesowen**
Title **Interim Programme 2022**

Drawing No.
TM5239

Drawn By **JK**

Checked By **JB**

Revision No.

Date **May 2022**

Scale **NTS@ A4**



Revoke No Stopping 11.30pm - 4.30am
Except Taxis

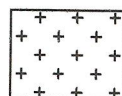

Revoke No Stopping 7pm - 7am
Except Taxis



Revoke No Stopping 7pm - 7am
Except Taxis

Revoke Limited Waiting 7am - 7pm
2 Hours, No Return 4 Hours

© Crown Copyright and database right 2022.
Ordnance Survey 100019566

Directorate of Public Realm

Traffic & Road Safety
4 Ednam Road
Dudley DY1 1HL
www.dudley.gov.uk



Project Title: Proposed Revocation of No Stopping Except Taxis and Limited Waiting, Hagley Road, Stourbridge Interim Programme 2022

Drawing No.
TM 5240

Drawn By
JK

Checked By
JB

Revision No.

Date
May 2022

Scale
NTS@ A4

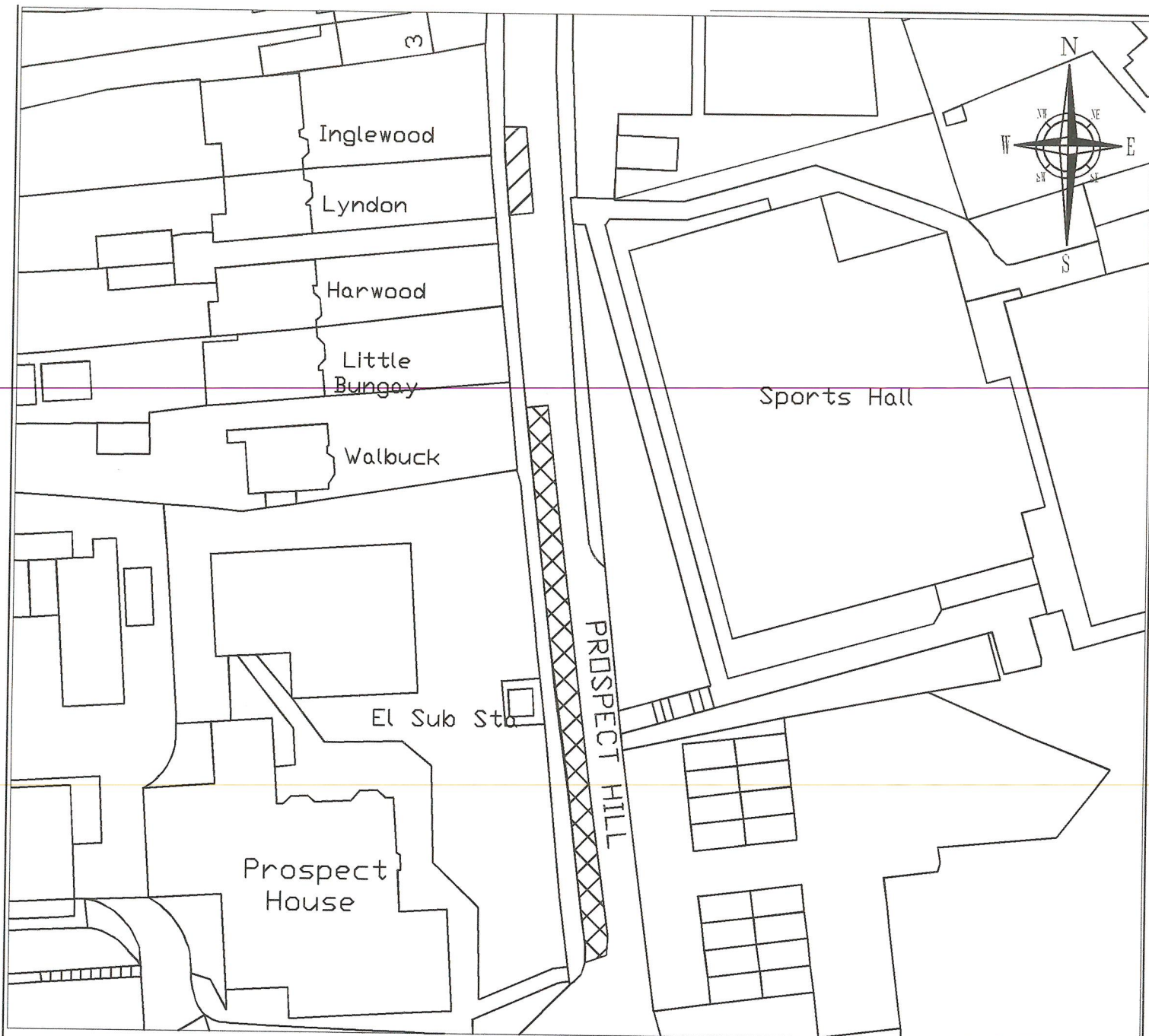

Revoke Limited Waiting 7am to 7pm, 2 hours,
No Return within 4 hours



Revoke Limited Waiting 7am to 7pm, 2 hours,
No Return within 2 hours
Replace with Limited Waiting 7am to 7pm, 2
hours, No Return within 4 hours

© Crown Copyright and database right 2022.
Ordnance Survey 100019566

Directorate of Public Realm

Traffic & Road Safety
4 Ednam Road
Dudley DY1 1HL
www.dudley.gov.uk



Project Title Proposed Limited Waiting and Revocation of Limited Waiting, Prospect Hill, Stourbridge
Interim Programme 2022

Drawing No.
TM5241

Drawn By JK

Checked By JB

Revision No.

Date May 2022

Scale NTS@ A4

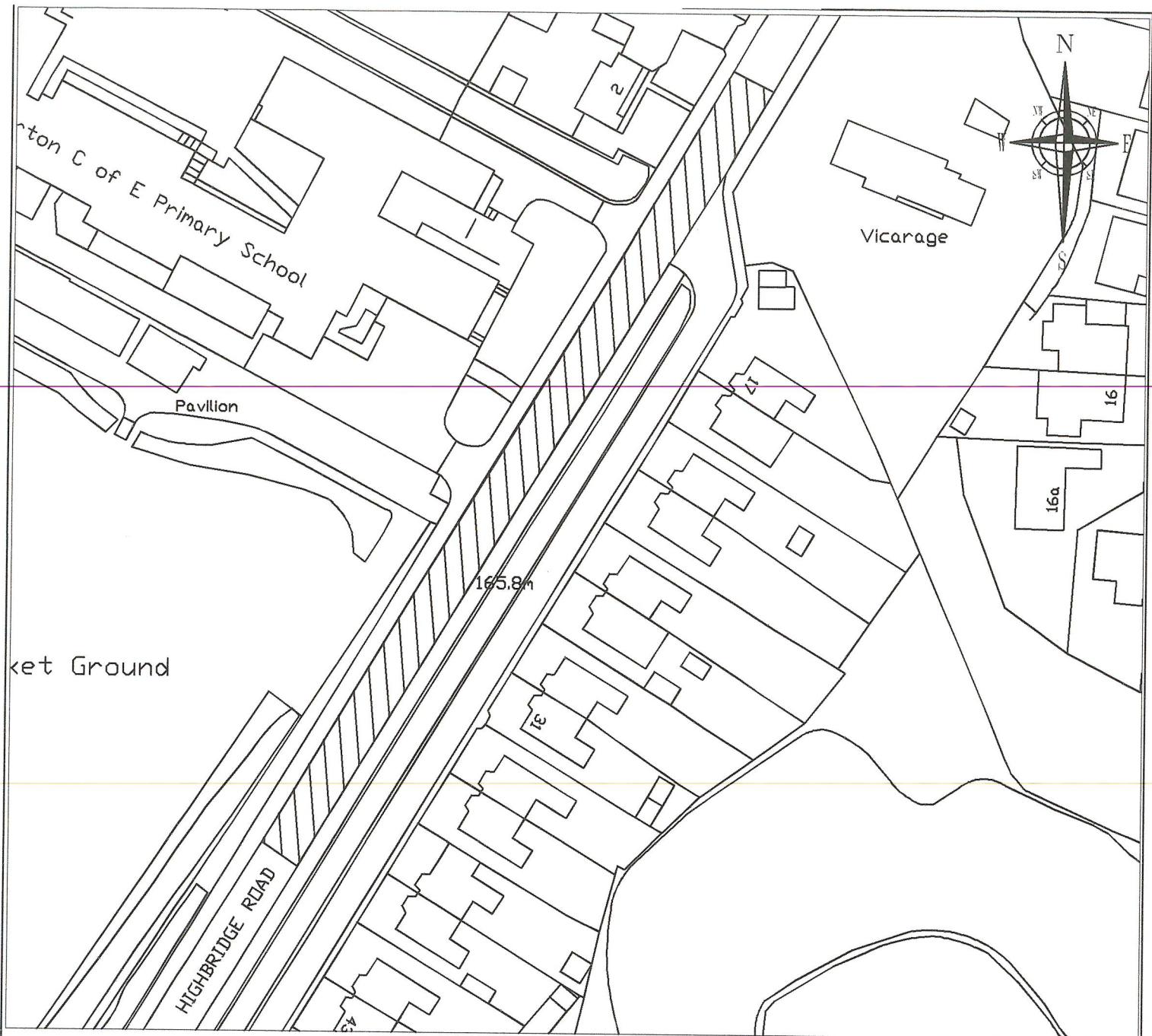

Revoke Restriction of Waiting Mon - Fri,
8am to 5pm

Replace with No Stopping Mon - Fri, 8am to
5pm on School Entrance Markings

© Crown Copyright and database right 2022.
Ordnance Survey 100019566

Directorate of Public Realm

Traffic & Road Safety
4 Ednam Road
Dudley DY1 1HL
www.dudley.gov.uk



Project Title
**Proposed No Stopping and revocation of Restriction of Waiting,
Highbridge Road, Netherton, Dudley
Interim Programme 2022**

Drawing No.
TM5242

Drawn By
JK

Checked By
JB

Revision No.

Date
May 2022

Scale
NTS@ A4

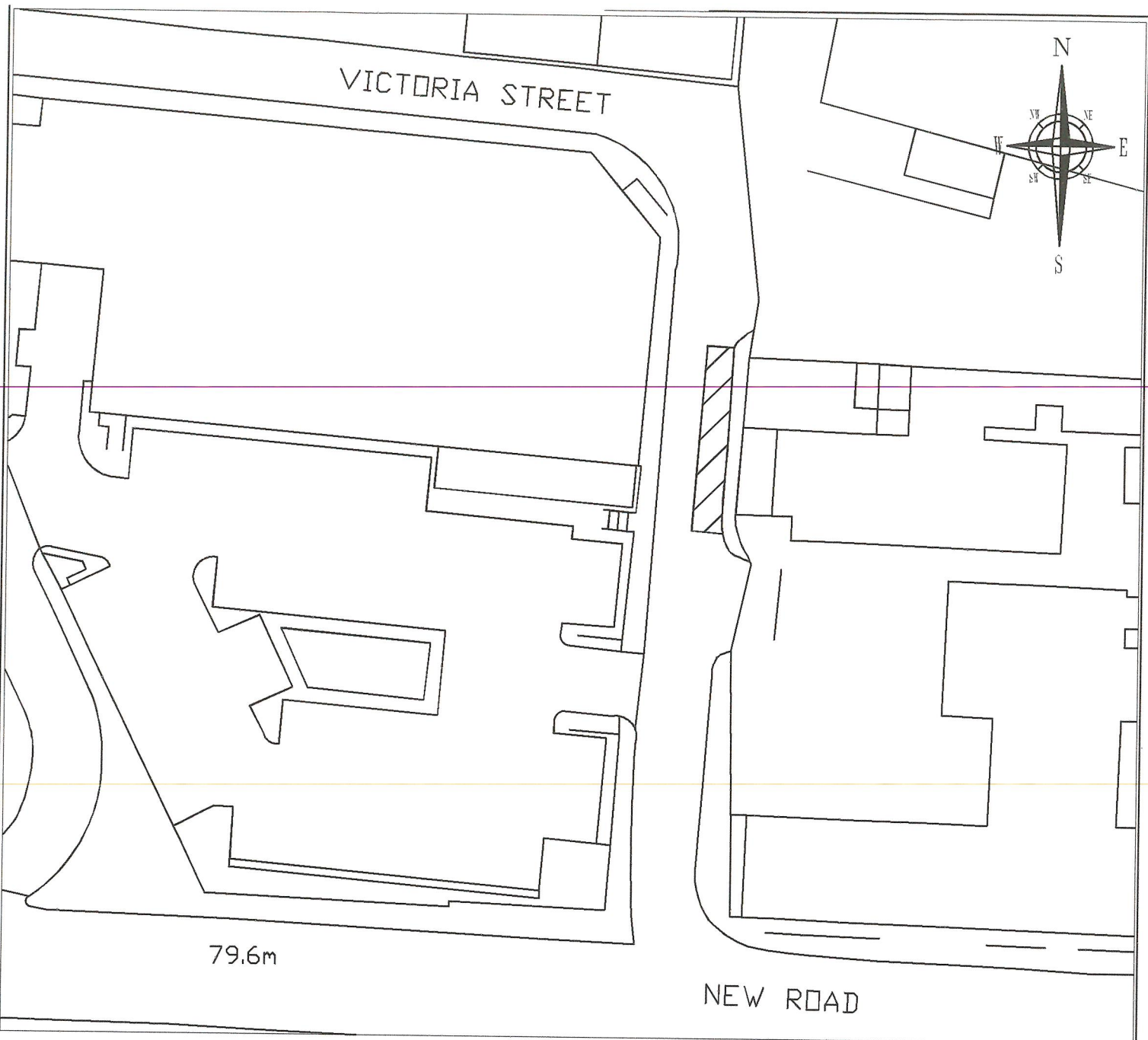

Revoke No Waiting except Police Vehicles

Replace with Limited Waiting Mon - Sat, 8am - 6pm,
1 Hour No Return 2 Hours

© Crown Copyright and database right 2022.
Ordnance Survey 100019566

Directorate of Public Realm

Traffic & Road Safety
4 Ednam Road
Dudley DY1 1HL
www.dudley.gov.uk



Project Title Proposed Limited Waiting & Revocation of No Waiting except Police Vehicles, Victoria Street, Stourbridge
Interim Programme 2022

Drawing No.
TM5243

Drawn By
JK

Checked By
JB

Revision No.

Date
May 2022

Scale
NTS@ A4

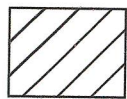
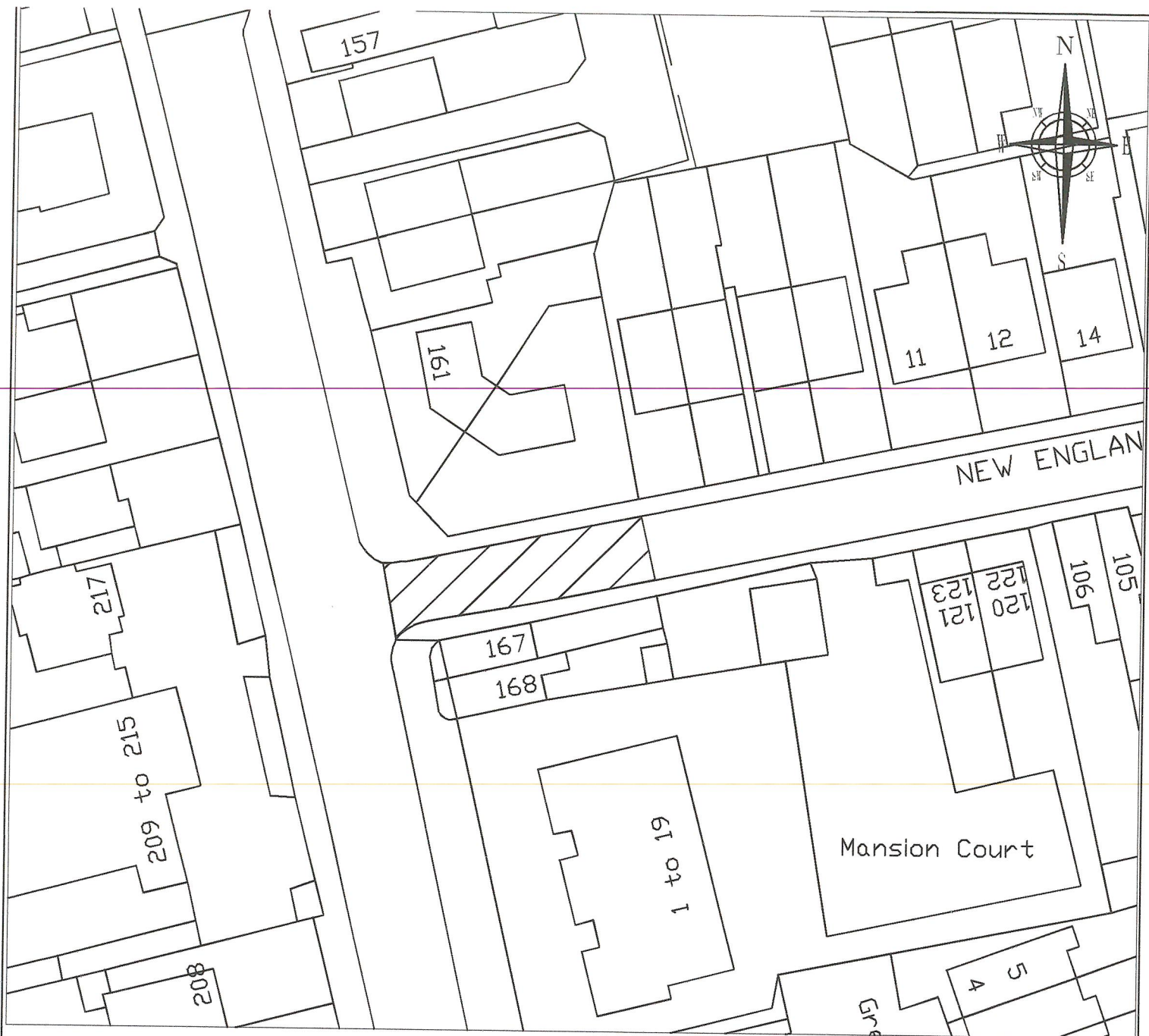

Prohibition of Waiting

© Crown Copyright and database right 2022.
Ordnance Survey 100019566

Directorate of Public Realm

Traffic & Road Safety
4 Ednam Road
Dudley DY1 1HL
www.dudley.gov.uk



Project **Proposed Prohibition of Waiting, New England, Halesowen**
Title **Interim Programme 2022**

Drawing No.
TM5244

Drawn By
JK

Checked By
JB

Revision No.

Date
May 2022

Scale
NTS@ A4

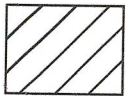

Revoke Permit Holders Disabled Bay

© Crown Copyright and database right 2022.
Ordnance Survey 100019566

Directorate of Public Realm

Traffic & Road Safety
4 Ednam Road
Dudley DY1 1HL
www.dudley.gov.uk



Project Title **Revocation of Permit Holders Disabled Bay, Rosemary Lane, Stourbridge
Interim Programme 2022**

Drawing No.
TM5245

Drawn By **JK**

Checked By **JB**

Revision No.

Date **May 2022**

Scale **NTS@ A4**

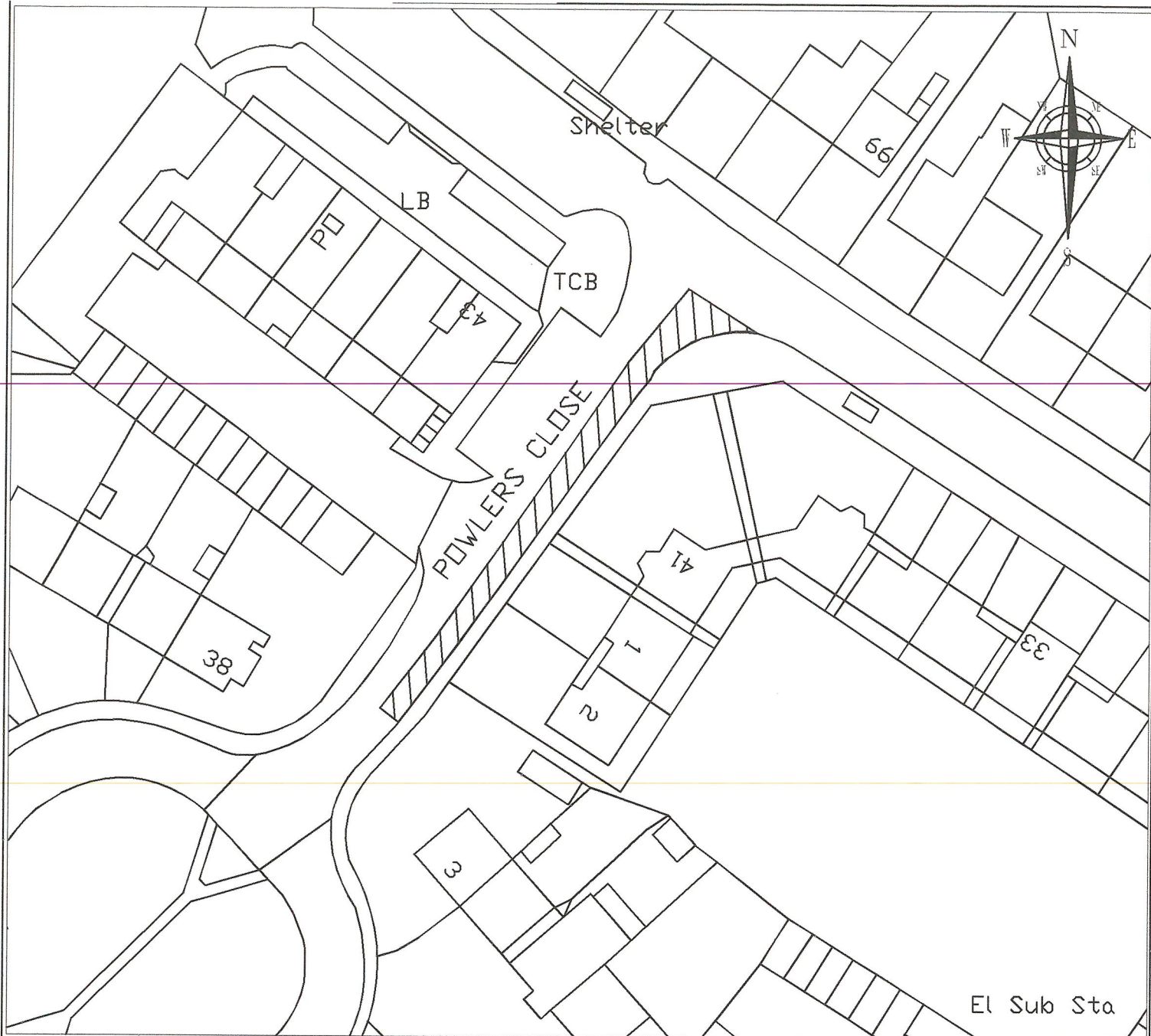

Revocation of Restriction of Waiting Mon - Fri,
8am to 4pm

Replace with Prohibition of Waiting

© Crown Copyright and database right 2022.
Ordnance Survey 100019566

Directorate of Public Realm

Traffic & Road Safety
4 Ednam Road
Dudley DY1 1HL
www.dudley.gov.uk



Project
Title

Proposed Prohibition of Waiting and Revocation of Restriction of
Waiting, Powlers Close, Stourbridge
Interim Programme 2022

Drawing No.

TM5246

Drawn By

JK

Checked By

JB

Revision No.

Date

May 2022

Scale

NTS@ A4



Revoke Prohibition of Waiting

© Crown Copyright and database right 2022.
Ordnance Survey 100019566

Directorate of Public Realm

Traffic & Road Safety
4 Ednam Road
Dudley DY1 1HL
www.dudley.gov.uk



Project Title	Proposed Revocation of Prohibition of Waiting, Southwick Road, Halesowen Interim Programme 2022			Drawing No. TM5247
Drawn By JK	Checked By JB	Revision No.	Date May 2022	Scale NTS@ A4



Revoke of Prohibition of Waiting

© Crown Copyright and database right 2022.
Ordnance Survey 100019566

Directorate of Public Realm

Traffic & Road Safety
4 Ednam Road
Dudley DY1 1HL
www.dudley.gov.uk



Project Title **Proposed Revocation of Prohibition of Waiting, Long Lane, Halesowen
Interim Programme 2022**

Drawing No.
TM5248

Drawn By
JK

Checked By
JB

Revision No.

Date
May 2022

Scale
NTS@ A4

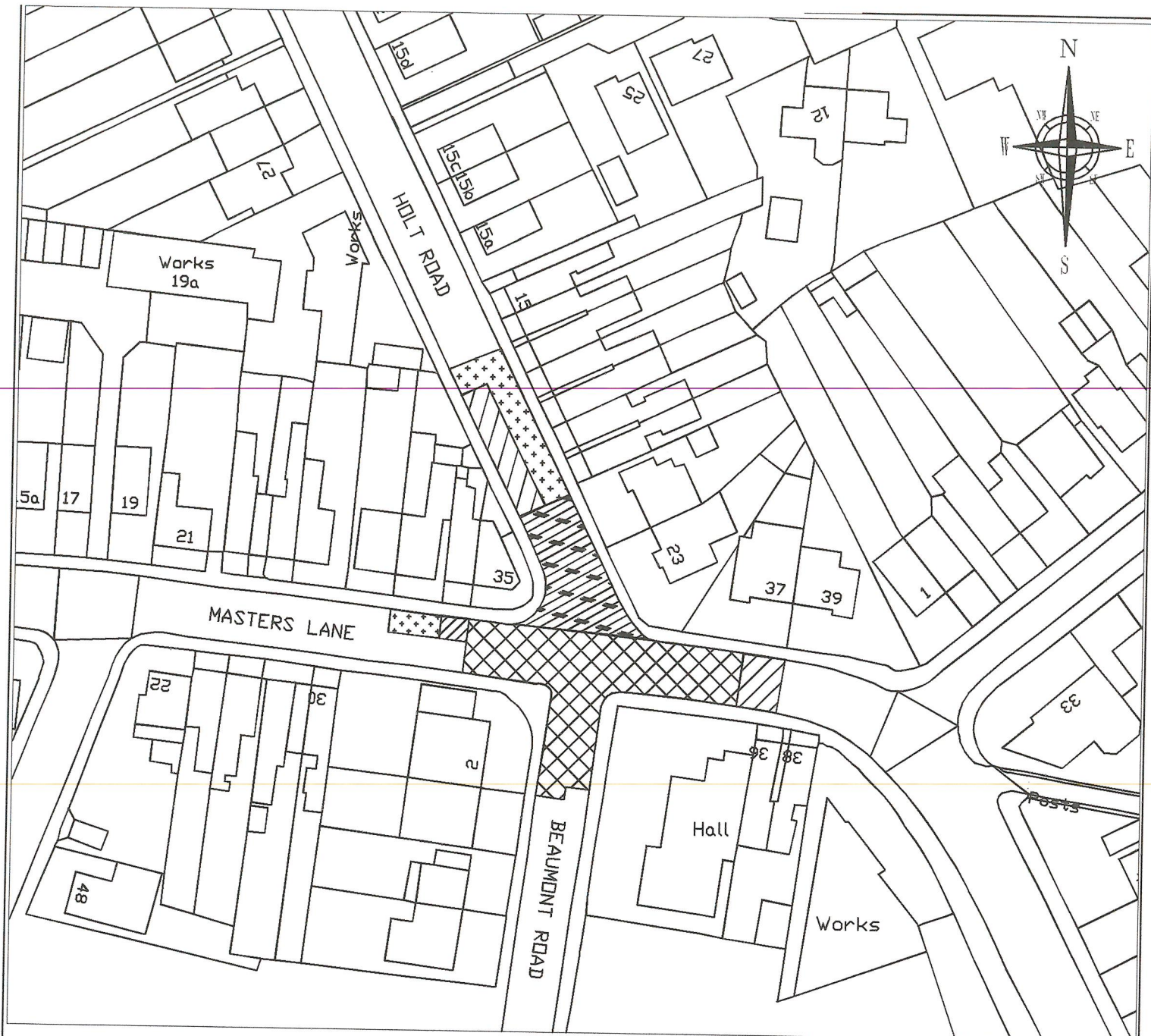

Existing Prohibition of Waiting

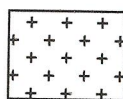

Revoke Restriction of Waiting Mon -
Fri 8.45am - 9.15am and 3pm -
3.30pm



Revoke Restriction of Waiting Mon -
Fri 8.45am - 9.15am and 3pm -
3.30pm
Replace with Prohibition of Waiting



Revoke Prohibition of Waiting
(Currently shown incorrectly on site
as a single yellow line)
Replace with Prohibition of Waiting

© Crown Copyright and database right 2022.
Ordnance Survey 100019566

Directorate of Public Realm

Traffic & Road Safety
4 Ednam Road
Dudley DY1 1HL
www.dudley.gov.uk



Project Title
**Proposed Prohibition of Waiting and Revocation of Restriction of
Waiting, Holt Road, Masters Lane, Halesowen
Interim Programme 2022**

Drawing No.
TM 5271

Drawn By
JK

Checked By
JB

Revision No.

Date
May 2022

Scale
NTS@ A4

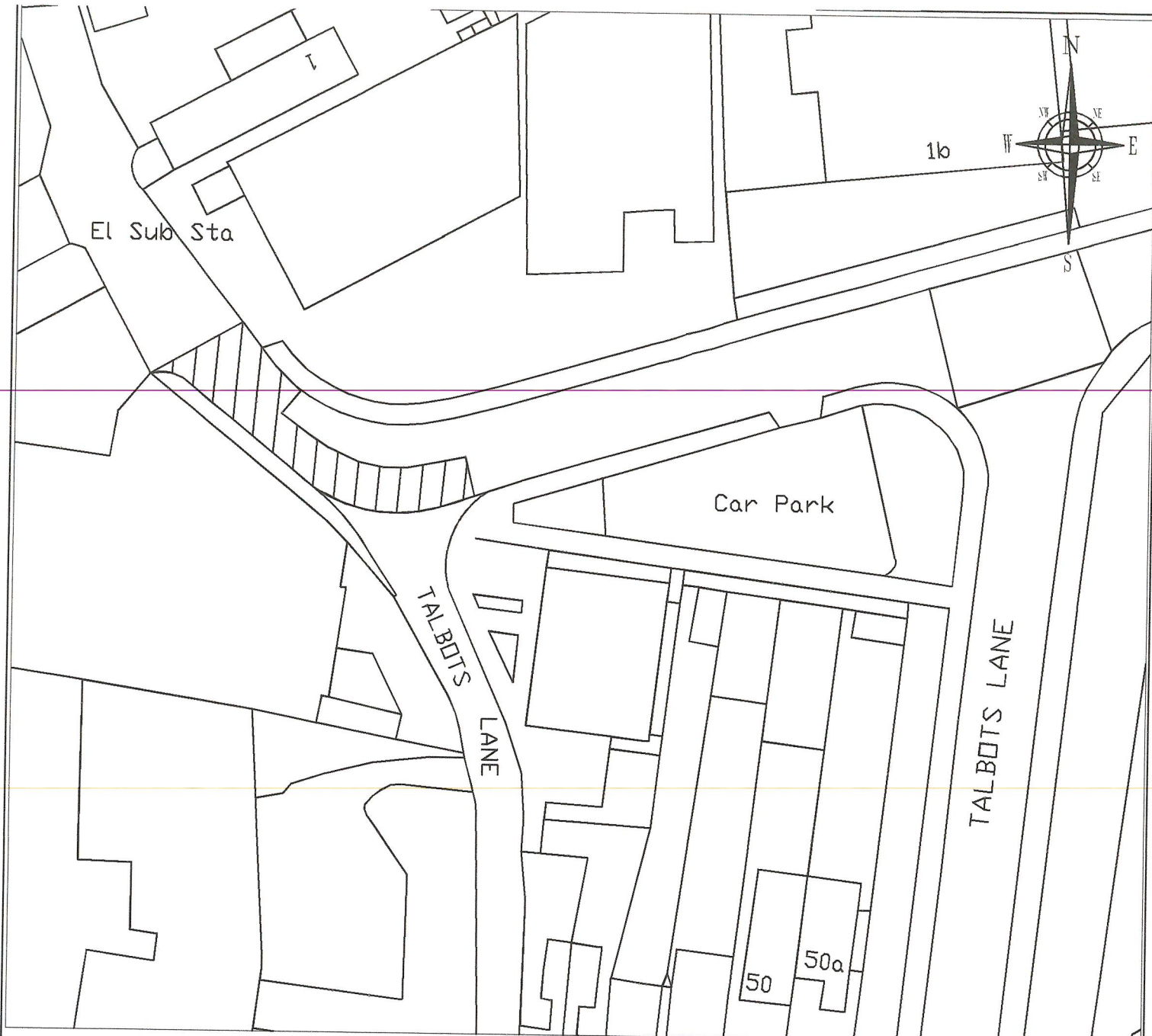

Revoke Restriction of Waiting Mon - Fri
8.30am - 4.30pm

© Crown Copyright and database right 2022.
Ordnance Survey 100019566

Directorate of Public Realm

Traffic & Road Safety
4 Ednam Road
Dudley DY1 1HL
www.dudley.gov.uk



Project Title
Revocation of Restriction of Waiting, Talbots Lane, Quarry Bank,
Brierley Hill
Interim Programme 2022

Drawing No.
TM5249

Drawn By
JK

Checked By
JB

Revision No.

Date
May 2022

Scale
NTS@ A4

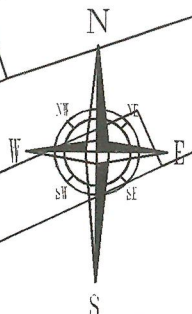
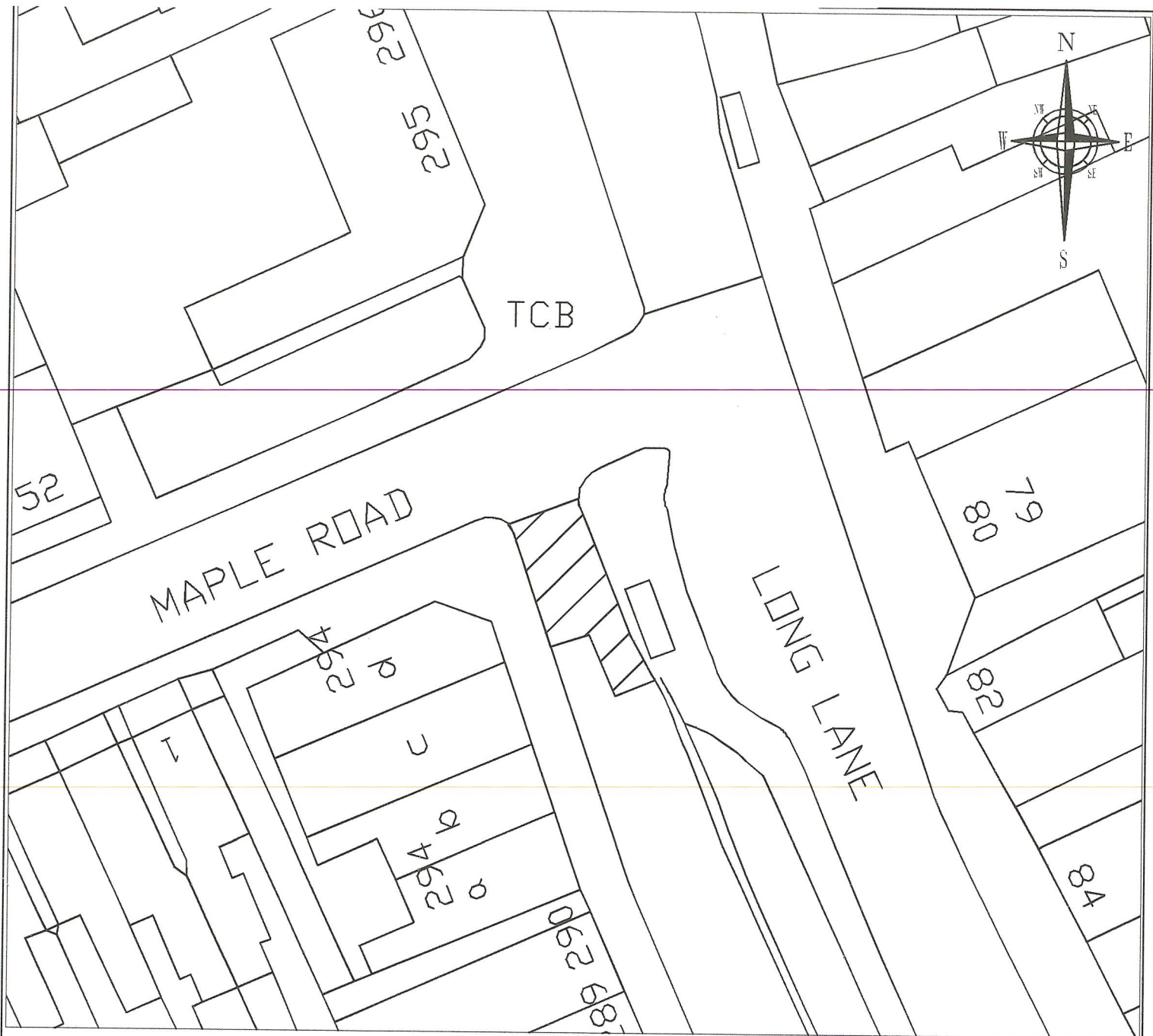

Prohibition of Waiting

Restriction of Loading 7am to 7pm

© Crown Copyright and database right 2022.
Ordnance Survey 100019566

Directorate of Public Realm

Traffic & Road Safety
4 Ednam Road
Dudley DY1 1HL
www.dudley.gov.uk



Project Title
Proposed Prohibition of Waiting and Restriction of Loading, Long Lane (Service Road), Halesowen Interim Programme 2022

Drawing No.
TM5253

Drawn By
JK

Checked By
JB

Revision No.

Date
May 2022

Scale
NTS@ A4

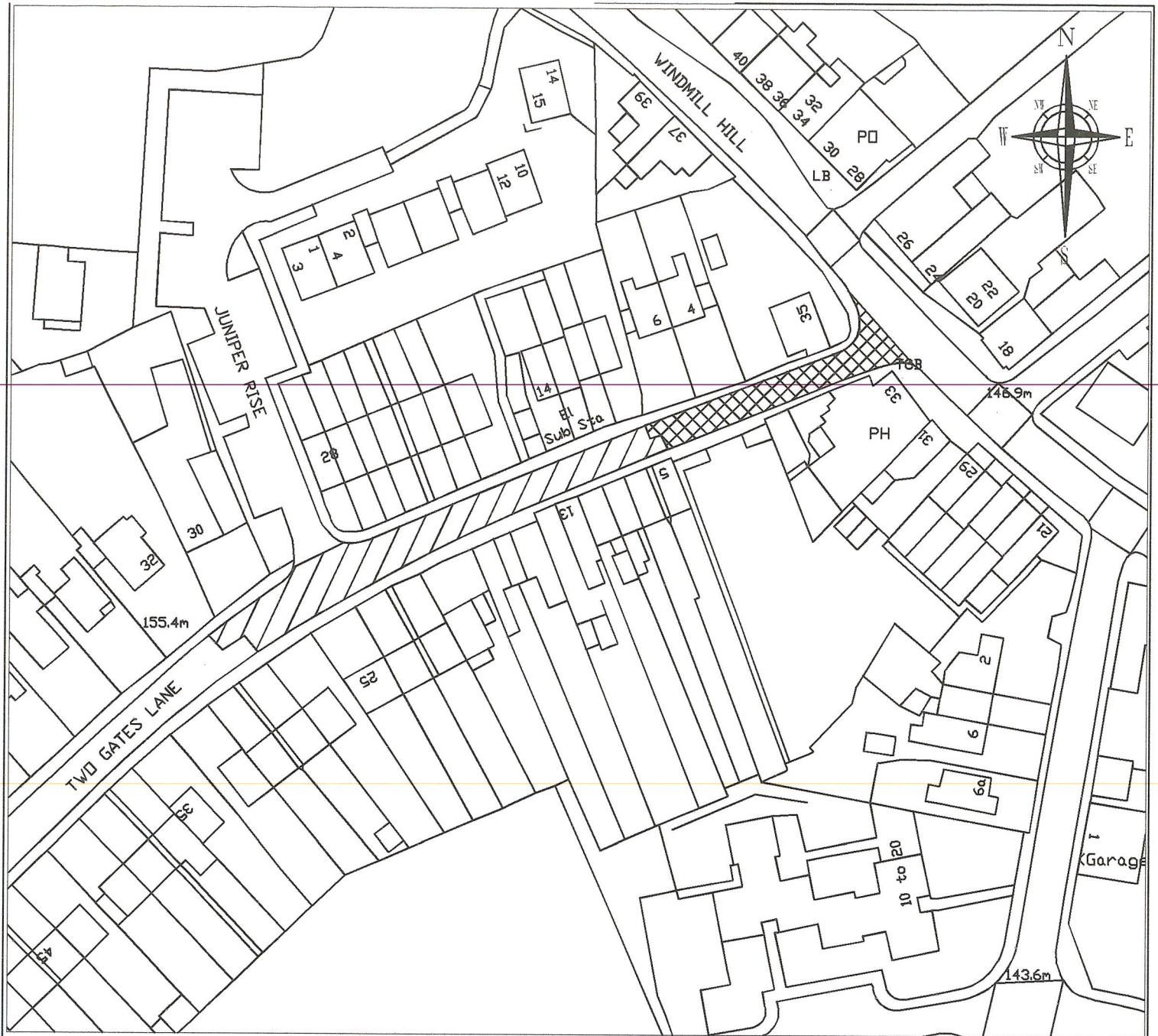

Revoke Restriction of Waiting 7am - 7pm



Revoke Restriction of Waiting 7am - 7pm
Replace with Prohibition of Waiting

© Crown Copyright and database right 2022.
Ordnance Survey 100019566

Directorate of Public Realm

Traffic & Road Safety
4 Ednam Road
Dudley DY1 1HL
www.dudley.gov.uk



Project Title Proposed Prohibition of Waiting and revocation of Restriction of Waiting, Two Gates Lane, Halesowen Interim Programme 2022

Drawing No.
TM5254

Drawn By
JK

Checked By
JB

Revision No.

Date
May 2022

Scale
NTS@ A4