

**DONCASTER BOROUGH COUNCIL
(VARIOUS ROADS DONCASTER)
(PARKING, STOPPING, WAITING AND LOADING)(CONSOLIDATION)
ORDER 2008
(AMENDMENT NO. 97) ORDER 2012**

Doncaster Borough Council ("the Council") in exercise of its powers under Section 1(1), 2(1) to (3), 4(2) and Part IV of Schedule 9 of the Road Traffic Regulation Act 1984 ("the Act") and of all other enabling powers and after consultation with the Chief Officer of Police in accordance with Part III of Schedule 9 to the Act hereby makes the following Order:-

1 The Doncaster Borough Council (Various Roads Doncaster) (Parking Stopping Waiting and Loading) (Consolidation) Order 2008 shall have the effect as though the following items were included in Schedule 1.03 of the Order No Waiting At Any Time:-

Melton Road Sprotbrough
South East side

from a point 10 metres south-west of its junction with Richmond Hill Road in a north-easterly direction to a point 10 metres north-east of its junction with Richmond Hill Road

Melton Road Side Road Sprotbrough
North East side

from its junction with Richmond Hill Road for a distance of 10 metres in a south-westerly direction

Richmond Hill Road Sprotbrough
East side

from its junction with Melton Road for a distance of 26 metres in a southerly direction

West side

from its junction with Melton Road in a southerly direction to its junction with Melton Road Side Road

2 This Order shall come into operation on the 23rd day of April 2012 and may be cited as the "Doncaster Borough Council (Various Roads Doncaster) (Parking Stopping Waiting and Loading) (Consolidation) Order 2008 (Amendment No. 97) Order 2012".

GIVEN under the Common Seal of the Doncaster Borough Council this 18th day of April 2012

THE COMMON SEAL of DONCASTER)

BOROUGH COUNCIL was hereunto affixed)

In the presence of:-)



Authorised by the Assistant Director Legal and Democratic Services
No. 6152 in Seal Register



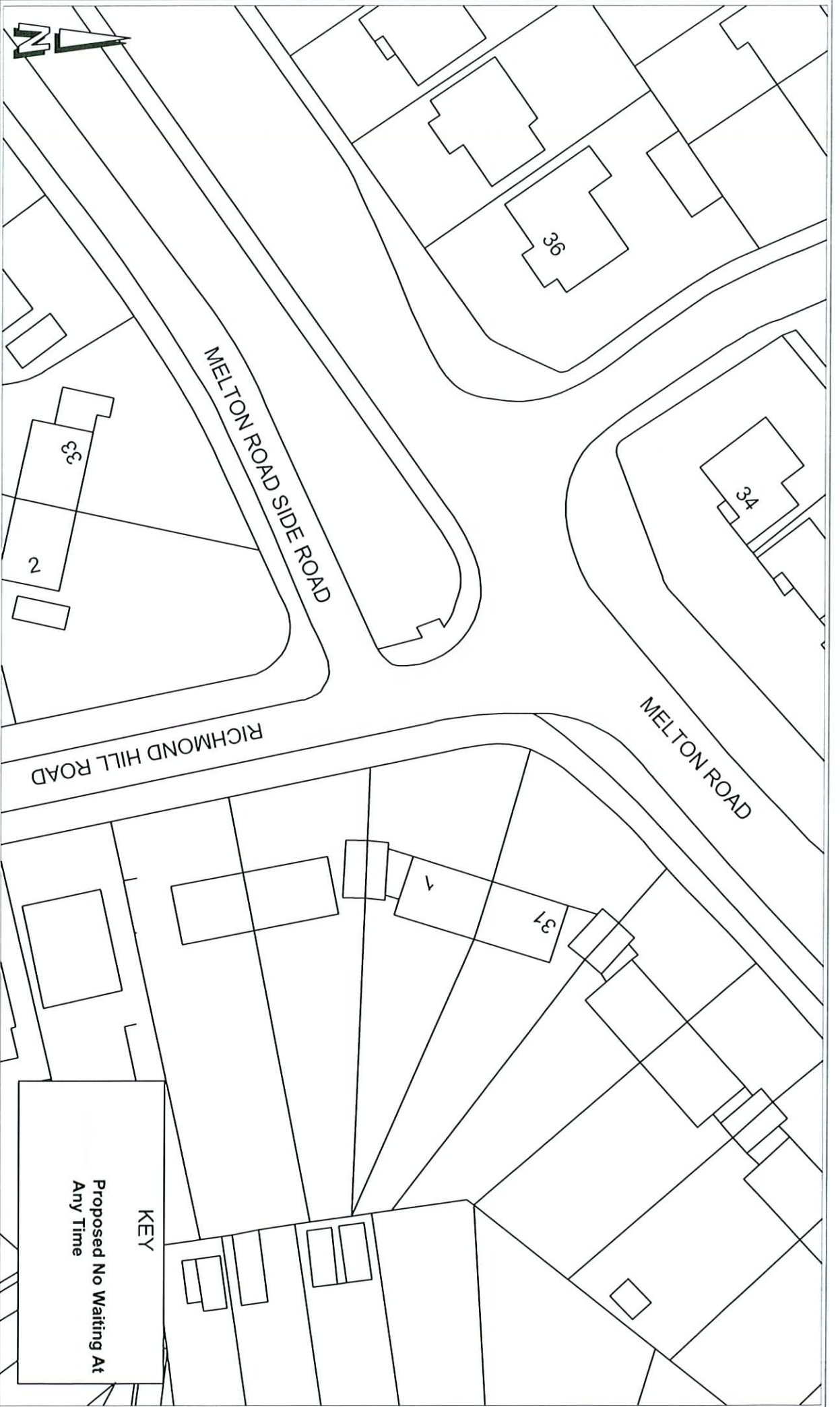

Doncaster MBC
 Scarborough House, Chequer Road
 DONCASTER DN1 2DB

TITLE:

**PROPOSED WAITING RESTRICTIONS
 MELTON ROAD, RICHMOND HILL ROAD,
 & MELTON ROAD SIDE ROAD**

DATE: **OCT 2011**

SCALE: **1:500**

DRAWING NO: **45001/1006**