

Devon County Council (Off-Street Parking Places) Amendment Order 2024

Devon County Council make the following order under sections 1, 2, 32, 35, 59, part IV of schedule 9 of the Road Traffic Regulation Act 1984 ("1984 Act"), the Traffic Management Act 2004 ("2004 Act") and all other enabling powers

PART A - INTERPRETATION

1 In this order except where the context otherwise requires the following expressions have these meanings assigned to them

appropriate remittance means

in relation to pay and display is the rate in column 8 of the table in part 1 of schedule 1

b) in relation to parking permits is the sum specified in column 4 of the table in schedule 3 for the period that relates to a permit which is valid in one or more of the designated parking places referred to in the schedules

authorised buses means buses liveried as "park & ride" for the transportation of passengers from a parking place to the city centre, County Hall or the hospital

buses has the same meaning as in regulation 22(2) of The Traffic Signs Regulations and General Directions 2002 and **bus** shall be construed accordingly

civil enforcement officer has the meaning given in section 76 of the 2004 Act

Council means Devon County Council

delivering and **collecting** in relation to any goods include checking the goods for the purpose of their delivery or collection

disabled person and **disabled person's badge** have the same meaning as in the Disabled Persons' (Badges for Motor Vehicles) (England) Regulations 2000

disabled persons vehicle means a vehicle lawfully displaying a disabled person's badge and which is a vehicle that immediately before or after any period of waiting allowed by virtue of a provision of a kind required by the Local Authorities' Traffic orders (Exemptions for Disabled Persons) (England) Regulations 2000 to be included in an order under the 1984 Act has been or is to be driven by a disabled person or has been or is to be used for carrying disabled person's as passengers

driver in relation to a vehicle waiting in a parking place means the person driving the vehicle at the time it was left in the parking place

enforcement authority means the authority specified in column 2 of the table in Part 1 of Schedule 1

goods includes postal packets of any description and the collection and delivery in relation to any goods including the checking of the goods for the purpose of delivery and collection

issuing authority means the enforcement authority, the Council or an agent acting on behalf of the Council

motorcycle means a mechanically propelled vehicle (not being an invalid carriage) with fewer than 4 wheels of which the weight un-laden does not exceed 410 kilograms

parking place means the area bounded by a blue line on the relevant plan in Schedule 1

parking permit refers to a permit issued by the issuing authority under part D

parking space means a space individually marked for the leaving of a vehicle within a parking place

park & cycle means the scheme operated by the Council enabling an authorised vehicle displaying a parking permit, in the relevant position, to park free of charge then allowing the driver to continue a journey by cycle

park & ride means the scheme operated by the Council in conjunction with authorised buses enabling permitted vehicles to park free of charge when the driver and any passengers of that vehicle use the authorised buses

park & share means the scheme operated by the Council enabling permitted vehicles to park free of charge and continue their journey by means of another vehicle

penalty charge has the same meaning as in regulation 2(1) of the Civil Enforcement of Parking Contraventions (England) General Regulations 2007

permit holder means a person who has been issued with a parking permit

rail user means a person using a rail service from a railway station serving a parking place

relevant position means

a) In the case of a disabled person's badge the position described in regulation 4 of the Local Authorities' Traffic orders (Exemptions for Disabled Persons) (England) Regulations 2000

b) In the case of a parking disc a vehicle displays the disc in the relevant position if

- i) in the case of a vehicle fitted with a dashboard or a fascia panel the disc is exhibited so that the quarter-hour period during which the period of waiting began is legible from outside the vehicle throughout the permitted period of parking; or
- ii) in the case of a vehicle not so fitted the disc is exhibited in a conspicuous position on the vehicle so that the quarter-hour period during which the period of waiting began is legible from outside the vehicle throughout the permitted period of parking
- c) In the case of pay and display the ticket referred to in part C, it shall be exhibited on the vehicle dashboard or fascia so that the time shown on the front of the ticket is clearly visible throughout the permitted period of parking
- d) In the case of any other badge or permit
 - i) in the case of a vehicle fitted with a front windscreen, the badge or permit is exhibited on the dashboard or fascia facing forwards on the near side of and immediately behind the windscreen or affixed to the windscreen so that the necessary details are clearly visible from outside of the vehicle throughout the permitted period of parking
 - ii) in the case of a vehicle not fitted with a front windscreen, the badge or permit is exhibited in a conspicuous position on the front or near side of the vehicle throughout the permitted period of parking

road means any length of highway or of any other road to which the public has access including any length of footway, verge or grass verge comprising the road or bridges over which a road passes

restricted road means a length of road marked in red on the plans in schedule 2

taxed means the vehicle has up-to-date vehicle tax as recorded by the DVLA

valid ticket means a ticket obtained under provisions of this order for parking in a parking space

- 2 a) Unless stated any reference to an article, part or schedule refers to the corresponding article, part or schedule in this order and except where the context otherwise requires any reference to a numbered or lettered paragraph or sub-paragraph is a reference to the paragraph or sub-paragraph bearing that number or letter in the article or schedule or (in the case of a sub-paragraph) paragraph in which the reference occurs
- b) The restrictions imposed by this order shall be in addition to and not in derogation of any restriction or requirement imposed by any regulations made under or having effect as if made under the 1984 Act or by or under any other enactment
- c) Any reference in this order to any enactment shall be construed as a reference to that enactment as amended by any subsequent enactment
- d) The Interpretation Act 1978 shall apply for the interpretation of this order as it applies for the interpretation of an Act of Parliament

PART B - PARKING PLACES

- 3 The limits of each parking space, where defined, shall be indicated by markings appropriate to the position in which a vehicle may park
- 4 Only vehicles authorised to do so by Part F are permitted to park without displaying a valid ticket or permit, where one is required. Otherwise, a penalty charge shall be payable
- 5 Provided always that the provisions of article 6 apply to any parking place or any part thereof, and in the event of any contravention of or non-compliance with a provision of article 6 the person responsible shall be liable to a penalty charge

suspension of parking places

- 6 The enforcement authority may subject to such conditions or exemptions as they consider necessary suspend the use of the parking place or any part thereof
 - a) if it is satisfied that the use of the parking place should be restricted or prohibited by reason that works are being or are proposed to be executed on or near the parking place or due to the likelihood of danger to the public or of serious damage to the parking place
 - b) for facilitating the movement of traffic or promoting its safety
 - c) any other reasons deemed appropriate by the council

- 7 The police may suspend for no longer than seven days the use of a parking place or any part thereof whenever they consider such suspension reasonably necessary

miscellaneous conditions

- 8 A driver of a vehicle shall not use a parking place
- so as to be a nuisance
 - when such parking place or part thereof if it has been suspended in accordance with the provisions of article 6
 - unless the vehicle has been taxed and the driver is insured to use the vehicle
 - for sleeping, camping or cooking
- 9 No person shall
- sell, offer or exhibit for sale or hire any vehicle while it is in a parking place
 - use a vehicle while it is in a parking place in connection with the sale of any article to persons in or near the parking place or in connection with the selling or offering for hire of their skills in handicraft or services in any capacity
- provided** always that this article shall not be deemed to prohibit persons employed in connection with a licensed public service or a licensed hackney carriage operation from plying for hire or accepting passengers for hire in accordance with any regulation or condition under which the service is required by law to operate
- 10 No person shall carry out upon any vehicle while it is in a parking place any work of construction, cleaning, maintenance or repair except such as may be expedient to enable the vehicle to be moved from the parking place

moving and removing vehicles

- 11 When a vehicle is left in the parking place in contravention of or non-compliance with any of the provisions of this order a person authorised by and on behalf of the enforcement authority may remove the vehicle or arrange for it to be removed from the parking place or if appropriate move the vehicle so that its position complies with the provisions of this order
- 12 In case of an emergency the police or a person authorised by the enforcement authority may alter the position of a vehicle in the parking place or remove the vehicle or arrange for it to be removed from the parking place to a place they think fit
- 13 Any person altering the position of a vehicle in or removing a vehicle from the parking place may take such measures in relation to the vehicle as they think necessary to enable them to remove it or alter its position
- 14 When the police or a person authorised by the enforcement authority removes or makes arrangements for the removal of a vehicle from the parking place
- they shall make arrangements as are reasonably necessary for the safe custody of the vehicle
 - the owner/driver of the vehicle shall be required to contact the police or the enforcement authority to determine how to recover the vehicle

PART C - DESIGNATION AND USE OF PARKING PLACES

manner of standing in parking places

- 15 The driver of a motor vehicle using a parking place shall stop the engine as soon as the vehicle is in position and shall not start the engine except when about to change position or to depart from the parking place
- 16 Where the limits of each parking space are defined, either by use of lines, surface materials or other physical means, a vehicle may only be parked wholly within a parking space defined. Where the limits are not defined, vehicles must not be parked in areas that are defined as no parking areas

pay & display

- 17 Save as provided in part F a vehicle is only permitted to wait in a parking place if
- it complies with the restrictions specified in schedule 1 and

- b) the appropriate remittance has been paid either by the purchase of a ticket, which is then displayed in the relevant position, or by payment using a mobile phone or other device
- 18** Where any vehicle exceeds the size limitations of a defined parking space, the appropriate remittance must be paid for all parking spaces the vehicle encroaches
- 19** Pay and display ticket machines will be at locations signed within the parking place. In the event of a ticket machine being inoperable and an alternative ticket machine is available nearby the driver must obtain a ticket and display the ticket in a relevant position. If no alternative ticket machine is available for use, and the driver is unable to make a payment by means of a mobile phone or device or to obtain a ticket where there is a period of parking available for which there is no charge, the driver must contact the enforcement authority as soon as practical. The vehicle must not be parked for any longer than the maximum period of parking permitted for that parking place and must not return to the parking place within 1 hour
- 20** The initial charge is payable on the leaving of a vehicle in a pay and display parking place and is the appropriate remittance specified in corresponding tariff to purchase a ticket from a pay and display ticket machine or a payment made by means of a mobile phone or device, if that service is available, to cover the anticipated length of stay subject to the maximum stay permitted at that parking place
- 21** Upon payment of the initial charge for the vehicle or where there is a period of parking available for which there is no charge any valid ticket(s) must be displayed in a relevant position
- 22** Where an initial charge has been made or where there is a period of parking available for which there is no charge on the leaving of a vehicle in a parking place referred to in article 21 by obtaining a ticket from the relevant pay and display ticket machine or a payment made by means of a mobile phone or device that vehicle is not
- a) to remain in the parking place beyond the expiry time of the displayed ticket or mobile phone/device paid period; or
 - b) to extend the initial period by use of another ticket for which there is no charge; or
 - c) to have additional time purchased for it if the total amount of time it remains in the parking place exceeds the maximum stay permitted for that parking place; or
 - d) permitted to return to that parking place until 1 hour has elapsed since the end of the last period of waiting in that parking place unless the parking place is subject to a maximum period of waiting in 24 hours in which case the vehicle may not return within 24 hours of the last period of waiting in that parking place

disabled badge holder only parking spaces

- 23** Save as provided in part F no person shall cause or permit a vehicle to park in a parking space marked for a disabled persons vehicle unless the vehicle displays a valid Disabled Person's Badge in the Relevant Position, otherwise a penalty charge is payable

motorcycle parking spaces

- 24** Save as provided in part F no person shall cause or permit a vehicle to park in a parking space marked for a motorcycle unless the vehicle is a motorcycle, otherwise a penalty charge is payable

parking spaces for buses

- 25** Save as provided in part F no person shall cause or permit a vehicle to park in a parking space marked for a bus unless the vehicle is a bus, otherwise a penalty charge is payable

miscellaneous parking spaces

- 26** Save as provided in part F, where a parking space is marked for a specific type of vehicle, no person shall cause or permit a vehicle to park in that parking space unless that vehicle is of the type specified, otherwise a penalty charge is payable

PART D - PROVISIONS RELATING TO PARKING PERMITS

- 27** Schedule 3 contains the list of the permit types and related charges

- 28 Permits have to be renewed annually unless there are specific provisions in place to the contrary and information regarding this will be provided on the application form or terms and conditions for the permit
- 29 The issuing authority may require a permit applicant to produce evidence in respect of the application as they reasonably require to verify any particulars or information given. This may include proof of residence which must be dated within the last three months and clearly state the name and address of the applicant
- 30 The issuing authority can terminate all rights granted by the permit if at any time there is any contravention of any of the provisions or terms and conditions and the permit holder will not be entitled to any refund in respect of the amount paid for the permit
- 31 A parking permit shall include the following particulars that must be visible when displayed in the relevant position
- a) the registration of the vehicle (or a variation agreed by the issuing authority)
 - b) the expiry date of the permit
 - c) the parking place in which it is valid for use
 - d) an authentication that it was issued by the issuing authority
- 32 All permit types remain the property of the issuing authority
- 33 All permits must be displayed in the relevant position within the vehicle throughout the permitted period of parking

vehicles for which permits can be used

- 34 Only those vehicles specified in column 4 of the table in Part 1 of Schedule 1 may use a permit issued under the provisions in this part of the order within the parking place, unless there are specific provisions in place to the contrary and information regarding this will be provided on the application form or terms and conditions for the permit

eligibility to apply for parking permits

- 35 A person as identified in column 3 of the table in Schedule 3, may apply to the issuing authority for the issue of a parking permit to authorise a vehicle to park in a parking place for which the permit applies. The application shall include the particulars and information required by the issuing authority and shall be accompanied by the appropriate remittance
- 36 On receipt of an application made under the provisions of this part of the order and of the appropriate remittance the issuing authority, upon being satisfied that the applicant is eligible, may issue to the applicant a parking permit or permits for the leaving of the vehicle or vehicles to which the parking permit relates by the owner of that vehicle or by any person using the vehicle with the consent of the owner other than a person who the vehicle has been let for hire or reward, in any parking place to which the parking permit relates

lost damaged destroyed or replacement permits

- 37 If a permit is lost, damaged, destroyed or requires renewing due to a change of vehicle the permit holder may apply to the issuing authority for the issue of a replacement and the issuing authority upon being satisfied as to the loss, damage or destruction shall upon payment of a fee determined in Schedule 3 issue a replacement permit and upon such issue the permit which it replaces shall become invalid
- 38 If a permit requires replacement due to a change of vehicle the permit holder may apply to the issuing authority for the issue of a replacement and the issuing authority, upon being satisfied as to the legitimacy of the change of vehicle, and on return of the original permit, shall issue a replacement permit without charge
- 39 If a permit becomes mutilated or defaced or the figures or particulars become illegible or the colour becomes altered by fading or otherwise, the permit holder shall surrender it to the issuing authority and may then apply for the issue of a replacement permit
- 40 If a permit is lost or destroyed and the permit holder has applied to the issuing authority for the issue of a replacement the original must be surrendered if it is subsequently found or retrieved

- 41 The provisions of this order apply to the replacement permit and application for the permit as if it were a permit or as the case may be an application for a permit transfer and surrender of permits
- 42 The issuing authority may at its discretion levy an administration charge for the issue of a replacement permit whether or not a charge was made for the permit it replaces
- 43 A parking permit shall not be transferred to any person or business but may be surrendered at any time to the issuing authority and shall be surrendered in the event of
- a) the permit holder ceasing to be eligible for a permit by virtue of no longer meeting the terms and conditions specified in schedule 3 of the relevant appendix; or
 - b) the permit holder ceasing to be the owner of the vehicle to which a permit has been issued; or
 - c) a replacement permit issued under the provisions of articles 37 to 39; or
 - d) the expiry of the period for which the permit was issued
- 44 A permit holder may surrender a permit to the issuing authority at any time and shall surrender a permit on the occurrence of any of the events set out in article 43
- 45 The issuing authority may by notice in writing served on the permit holder at the address shown by that person on the application for the permit or at any other address believed to be that person's residence withdraw a permit if it appears that any of the events set out in article 43 has occurred and the permit holder shall surrender the permit within forty-eight hours of the receipt of the said notice
- 46 It shall be an offence to alter the said parking permit in any manner and any person so doing may have the parking permit withdrawn

PART E – PROHIBITION OF WAITING

no waiting at any time

- 47 Save as provided in part F no person shall cause or permit a vehicle to wait in the lengths of road indicated on the plans in schedule 2, otherwise a penalty charge is payable

PART F - EXEMPTIONS

general exemptions from prohibitions & restrictions

- 48 Nothing in this order shall apply to anything done with the permission or at the direction of a police officer, civil enforcement officer or an officer authorised by the enforcement authority
- 49 No provision of this order shall apply to a vehicle being used for ambulance, coastguard, fire or police purposes in relation to an emergency or whilst in pursuit of duties or police purposes if the observance of that provision would be likely to hinder the use of that vehicle for the purpose for which it is being used on that occasion
- 50 Nothing in this order shall make it unlawful to cause or permit a vehicle to wait in a restricted road or parking place for so long as may be necessary to enable
- a) a person to board or alight the vehicle or to load/unload luggage to/from the vehicle
 - b) a hackney carriage whilst plying for hire upon a duly authorised taxi rank in accordance with the Local Government (Miscellaneous Provisions) Act 1976 or any modification or re-enactment of the same for the time being in force
 - c) the vehicle to be used for the purpose of delivering or collecting postal packets as defined in section 27(2) of the Postal Services Act 2011
 - d) the principal vehicle to wait at or near to any premises situated on or adjacent to a length of road or parking place for so long as waiting by that vehicle is reasonably necessary in connection with any wedding or funeral
 - e) the vehicle to be used in connection with the removal of furniture from one building to another
 - f) the vehicle to be used for the purpose authorised by and described on a permit issued by the enforcement authority or the Council provided such permit is clearly displayed in the relevant position

PART G - COMMENCEMENT & CITATION

51 This order comes into operation 2nd April 2024 and may be cited as “Devon County Council (Off-Street Parking Places) Amendment Order 2024”

PART H – REVOCATION

52 Devon County Council (Off-Street Parking Places) (Consolidation) Order 2023 is revoked

SCHEDULE 1
Parking Places

PART 1

Location of Parking Place	Enforcement authority	Type of Parking Place ¹	Class of vehicle ²	Days and Hours of operation	Days and Hours when charges will be made	Maximum period for which vehicles may wait	Scale of Charges	
<i>Column 1</i>	<i>Column 2</i>	<i>Column 3</i>	<i>Column 4</i>	<i>Column 5</i>	<i>Column 6</i>	<i>Column 7</i>	<i>Column 8</i>	
Barnstaple Civic Centre (Plan 1A)	Devon County Council	a	A, A1, B, B1, C1, D1, L, P	At all times	Saturdays, Sundays and Bank Holidays 8am to 6pm	Up to 24 hours during a Saturday, Sunday or Bank Holiday	Motorcycles When parked in a motorcycle parking space	FREE
		When not parked in a motorcycle parking space					As below	
		f			Monday to Friday excluding Bank Holidays 8am to 6pm	Up to 24 hours during Monday to Friday (excluding bank holidays)	All Other Vehicles Up to 1 hour Between 1 hour and 2 hours Between 2 hours and 3 hours Over 3 hours	£1.00 £2.00 £3.00 £4.00
							Free providing a valid Barnstaple Civic Centre permit is displayed in the relevant position	

¹ See Note 1 in Part 2

² See Note 2 in Part 2

Location of Parking Place	Enforcement authority	Type of Parking Place ¹	Class of vehicle ²	Days and Hours of operation	Days and Hours when charges will be made	Maximum period for which vehicles may wait	Scale of Charges		
<i>Column 1</i>	<i>Column 2</i>	<i>Column 3</i>	<i>Column 4</i>	<i>Column 5</i>	<i>Column 6</i>	<i>Column 7</i>	<i>Column 8</i>		
Cullompton St Andrews Road (Plan 1B)	Devon County Council	a, f	A, A1, B, B1, L, P	At all times	All days 8am-6pm	4 hours* and no vehicle may return within 1 hour *4½ hours for Disabled Persons Vehicles	<i>All Vehicles</i> Up to 1 hour Between 1 hour and 2 hours Between 2 hours and 4 hours	FREE £1.00 £2.00	
							<i>Disabled Persons Vehicle</i> Must obtain a ticket but will be allowed an additional 30 minutes beyond the ticket expiry time.		
							<i>Permit Holders</i> Free providing a valid Cullompton St Andrews Road Daytime permit is displayed in the relevant position		
Exeter County Hall (Plan 1C)	Devon County Council	a	A, A1, B, B1, D1, L, P	At all times	Monday to Friday excluding Bank Holidays 8am to 4pm	8 hours and no vehicle may return within 1 hour	<i>Motorcycles</i> When parked in a motorcycle parking space When not parked in a motorcycle parking space	FREE As below	
							<i>Disabled Persons Vehicle</i>		FREE
							<i>All Other Vehicles</i> Up to 30 minutes Between 30 minutes and 1 hour Between 1 hour and 2 hours Between 2 hours and 4 hours Between 4 hours and 8 hours		FREE £1.10 £2.20 £4.40 £7.00

Location of Parking Place	Enforcement authority	Type of Parking Place ¹	Class of vehicle ²	Days and Hours of operation	Days and Hours when charges will be made	Maximum period for which vehicles may wait	Scale of Charges	
<i>Column 1</i>	<i>Column 2</i>	<i>Column 3</i>	<i>Column 4</i>	<i>Column 5</i>	<i>Column 6</i>	<i>Column 7</i>	<i>Column 8</i>	
Exeter Digby Park & Rail (Plan 1D)	Devon County Council	e	A, A1, B, B1, D, D1, L, P	At all times	Not applicable	Unlimited	Free providing the driver is a rail user using a rail service from Digby & Sowton station	
Exeter Digby Park & Ride (Plan 1E)	Devon County Council	g	A, A1, B, B1, D, D1, L, P	At all times	Not applicable	Unlimited	Free providing the driver is an authorised member of staff at the Royal Devon & Exeter NHS Foundation Trust	
Exeter Honiton Road Park & Ride (Plan 1F)	Devon County Council	b, c	A, A1, B, B1, D, D1, L, P	At all times	Not applicable	Unlimited	Free providing the driver: a) is catching the park and ride bus, or b) the driver is cycling to area outside of the exclusion zone specified in the terms and conditions and the vehicle displays a park and cycle permit in the relevant position	
Exeter Sowton Park & Ride (Plan 1G)	Devon County Council	b, c	A, A1, B, B1, D, D1, L, P	At all times	Not applicable	Unlimited	Free providing the driver: a) is catching the park and ride bus, or b) the driver is cycling to area outside of the exclusion zone specified in the terms and conditions and the vehicle displays a park and cycle permit in the relevant position	
Exeter Sowton Pay & Display (Plan 1H)	Devon County Council	a	A, A1, B, B1, D, D1, L, P	At all times	Monday to Saturday excluding Bank Holidays 6am to 11pm	Unlimited	<i>Disabled Persons Vehicle</i>	FREE
							<i>All Other Vehicles</i> Up to 24 hours	£3.20
Newton Abbot, Brunel Road Car Park (Plan 1I)	Devon County Council	f	A, A1, B, B1, L, P	At all times	Not applicable	Unlimited	Free providing a valid Brunel Road permit is displayed in the relevant position	

Location of Parking Place	Enforcement authority	Type of Parking Place ¹	Class of vehicle ²	Days and Hours of operation	Days and Hours when charges will be made	Maximum period for which vehicles may wait	Scale of Charges	
<i>Column 1</i>	<i>Column 2</i>	<i>Column 3</i>	<i>Column 4</i>	<i>Column 5</i>	<i>Column 6</i>	<i>Column 7</i>	<i>Column 8</i>	
Salcombe, Bonfire Hill Car Park (Plan 1J)	Devon County Council	a, f	A, A1, B, B1, L, P	At all times	At all times	Up to 168 hours (7 days)	<i>Motorcycles</i>	FREE
							<i>All Other Vehicles</i> Up to 24 hours (1 day) Up to 48 hours (2 days) Up to 72 hours (3 days) Up to 96 hours (4 days) Up to 120 hours (5 days) Up to 168 hours (7 days)	£3.00 £6.00 £9.00 £12.00 £15.00 £21.00
Stover Country Park Car Park (Plan 1K)	Devon County Council	a, f	A, A1, B, B1, D, D1, L, P	At all times	All days Sunrise to Sunset	All day	<i>All Vehicles</i> Up to 2 hours Over 2 hours	£1.70 £3.50
							<i>Permit Holders</i> Free providing a valid Stover Country Park permit is displayed in the relevant position	

Location of Parking Place	Enforcement authority	Type of Parking Place ¹	Class of vehicle ²	Days and Hours of operation	Days and Hours when charges will be made	Maximum period for which vehicles may wait	Scale of Charges		
<i>Column 1</i>	<i>Column 2</i>	<i>Column 3</i>	<i>Column 4</i>	<i>Column 5</i>	<i>Column 6</i>	<i>Column 7</i>	<i>Column 8</i>		
Teignmouth Bitton House Car Park (Plan 1L)	Devon County Council	a, f	A, A1, B, B1, L, P	At all times	At all times	8am – 6pm Teignmouth Bitton House Daytime permit holders may park until 6pm.	<i>All Vehicles</i> Up to 30 minutes Between 30 minutes and 2 hours Between 2 hours and 4 hours Between 4 hours and 6 hours Between 6 hours and 8 hours		FREE £1.50 £2.50 £3.50 £4.50
							<i>Disabled Persons Vehicle</i> Must obtain a ticket but will be allowed an additional 30 minutes beyond the ticket expiry time, up to 6pm.		
							<i>Permit Holders</i> Free providing a valid Teignmouth Bitton House permit is displayed in the relevant position		
							6pm – 8am Up to 8am Overnight permit holders may park until 8am		<i>All Vehicles</i> Up to 8am £1.00
<i>Permit Holders</i> Free providing a valid Teignmouth Bitton House permit is displayed in the relevant position									
Tiverton Grand Western Canal County Park Car Park (Plan 1M)	Devon County Council	a, f	A, A1, B, B1, D, D1, L, P	At all times	All days Sunrise to Sunset	All day	<i>All Vehicles (except buses)</i> Up to 2 hours Over 2 hours		£1.70 £3.50
							<i>Buses (in marked bays)</i> All Day		£3.50
							<i>Permit Holders</i> Free providing a valid Tiverton Grand Western Canal permit is displayed in the relevant position		

PART 2

Note 1 - Type of Parking Place

This means the type of parking available at the parking place as specified by the letters in Column 3 of the table in Part 1

- a** means 'pay and display'. Each period of parking is paid for in advance in accordance with article 17 b)
- b** means 'park and ride'. Parking is free to those using the park & ride service at that location
- c** means 'park and cycle'. Parking is free to those using the park & cycle service at that location
- d** means 'park and share'. Parking is free to those using the park & share service at that location
- e** means 'park and rail'. Parking is free to rail users
- f** means 'permit parking'. Parking is free to permit holders displaying a valid permit in the relevant position
- g** means 'RD&E Staff parking'. Parking is free to authorised staff at the Royal Devon & Exeter NHS Foundation Trust

Note 2 – Class of Vehicle

This describes the class of vehicle as determined by the DVLA that are permitted to park in each parking place specified by the letters in Column 4 of the table in Part 1

- A and A1** means any motorcycle (with or without a side car)
- B** means any motor vehicle and light goods vehicle with up to 8 seats up to 3,500kg Maximum Authorised Mass (MAM)
- B1** means any motor vehicle weighing not more than 400 kg unladen (550 kg laden) (other than an invalid carriage)
- C1** means Goods Vehicle with MAM between 3,500 and 7,500 kg and pulling trailer, as long as the total weight of both vehicles is not more than 8,250 kg.
- D** means any bus with more than eight passenger seats, with a trailer up to 750 kg
- D1** means Passenger carrying vehicle with between 9 and 17 seats (driving for hire or reward)
- L** means electrically propelled vehicle (other than an invalid carriage)
- P** means Moped with an engine size of up to 50cc and a maximum speed of up to 50km/h

PART 3

Index of Plans

Plan 1A	Barnstaple Civic Centre Car Park
Plan 1B	Cullompton St Andrews Road Car Park
Plan 1C	Exeter County Hall Car Park
Plan 1D	Exeter Digby Park & Rail Car Park
Plan 1E	Exeter Digby Park & Ride Car Park
Plan 1F	Exeter Honiton Road Park & Ride Car Park
Plan 1G	Exeter Sowton Park & Ride Car Park
Plan 1H	Exeter Sowton Pay & Display Car Park
Plan 1I	Newton Abbot Brunel Road Car Park
Plan 1J	Salcombe Bonfire Hill Car Park
Plan 1K	Stover County Park Car Park
Plan 1L	Teignmouth Bitton House Car Park
Plan 1M	Tiverton Grand Western Canal Car Park

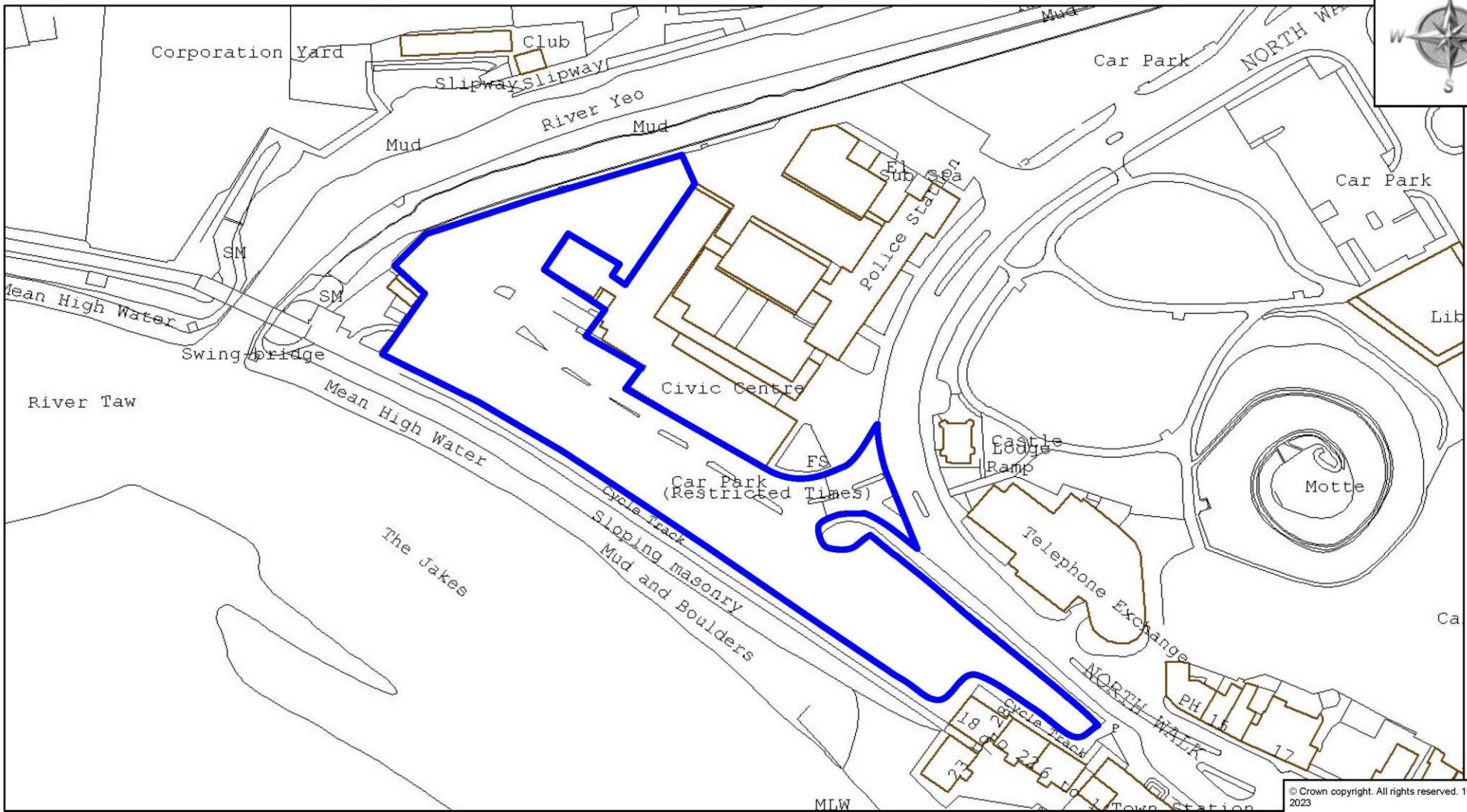

© Crown copyright. All rights reserved. 100019783. 2023

Do not scale from this drawing in either hard or electronic format. No responsibility is accepted where this drawing is used in circumstances other than that for which it was originally prepared and issued.



Meg Booth
Director for Climate Change,
Environment & Transport

TRAFFIC MANAGEMENT TEAM
DEVON COUNTY COUNCIL
COUNTY HALL
TOPSHAM ROAD
EXETER
EX2 4GD
Telephone: 0345 155 1004

SCHEME

OFF STREET PARKING PLACES

DRAWING

**BARNSTAPLE CIVIC CENTRE
CAR PARK**

drawn by | scale
JPB | 1:1500

date | O.S.Ref
05-Jun-2023 | 255419,133313

drawing number
PLAN 1A

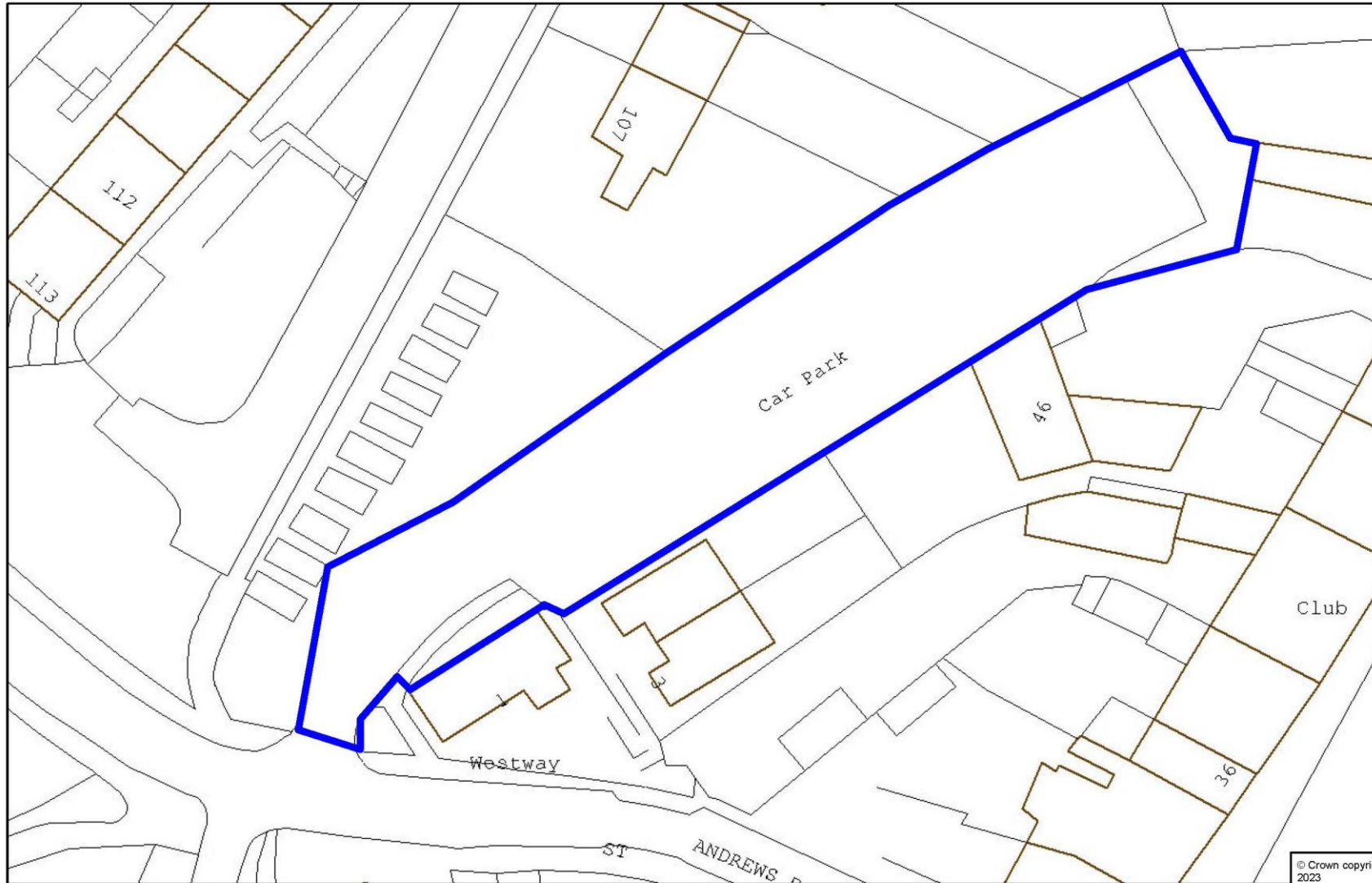

© Crown copyright. All rights reserved. 100019783. 2023

Do not scale from this drawing in either hard or electronic format. No responsibility is accepted where this drawing is used in circumstances other than that for which it was originally prepared and issued.

drawn by	scale
JPB	1:500

date	O.S.Ref
05-Jun-2023	302041,107519

drawing number
PLAN 1B



Meg Booth
Director for Climate Change,
Environment & Transport

TRAFFIC MANAGEMENT TEAM
DEVON COUNTY COUNCIL
COUNTY HALL
TOPSHAM ROAD
EXETER
EX2 4QD
Telephone 0345 155 1004

SCHEME

OFF STREET PARKING PLACES

DRAWING

CULLOMPTON ST ANDREWS ROAD
CAR PARK

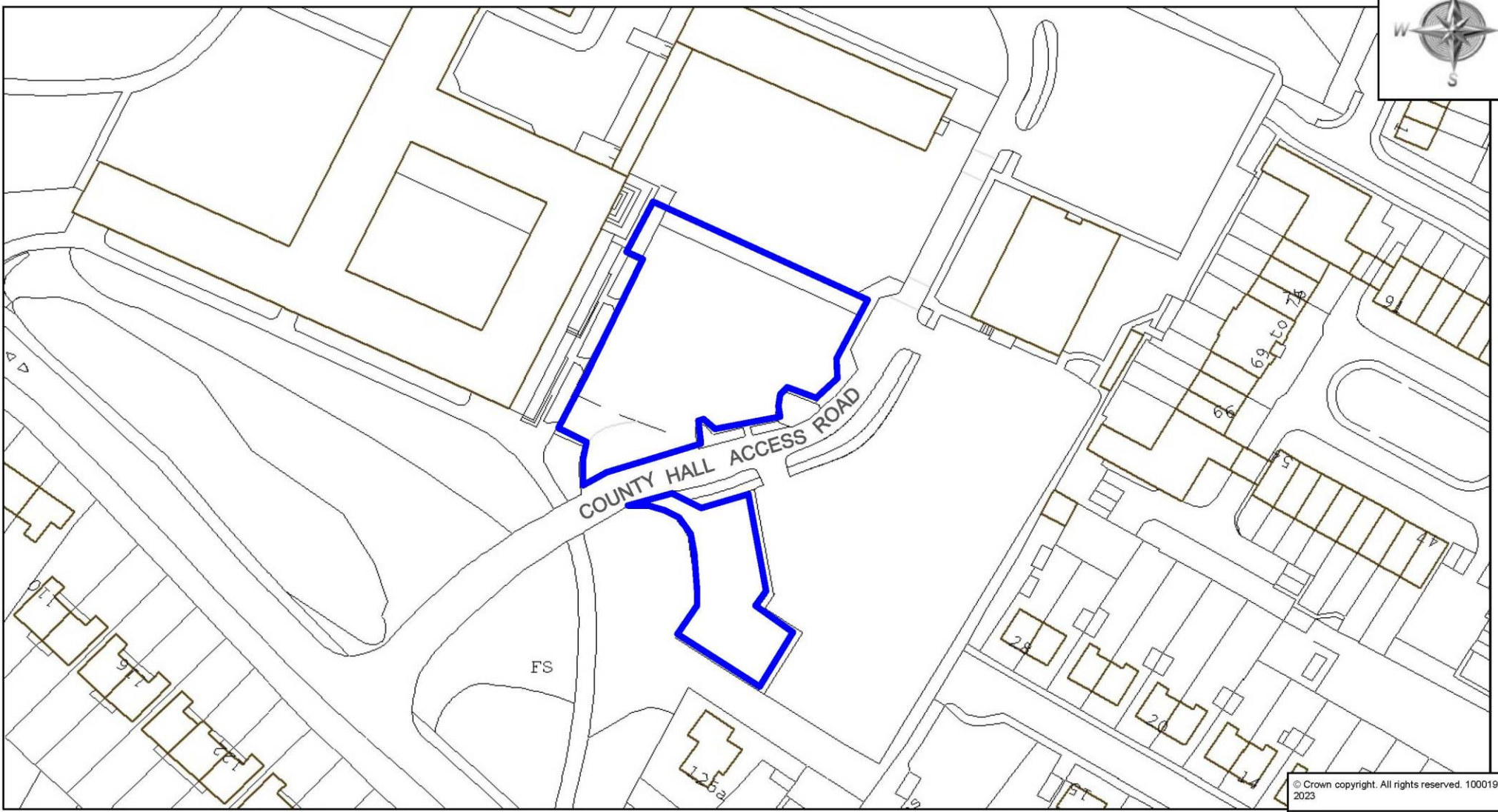

© Crown copyright. All rights reserved. 100019783. 2023

Do not scale from this drawing in either hard or electronic format. No responsibility is accepted where this drawing is used in circumstances other than that for which it was originally prepared and issued.



Meg Booth
Director for Climate Change,
Environment & Transport

TRAFFIC MANAGEMENT TEAM
DEVON COUNTY COUNCIL
COUNTY HALL
TOPSHAM ROAD
EXETER
EX2 4DD
Telephone 0345 155 1004

SCHEME

OFF STREET PARKING PLACES

DRAWING

EXETER COUNTY HALL
CAR PARK

drawn by	scale
JPB	1:1250
date	O.S.Ref
05-Jun-2023	293061,91596
drawing number	
PLAN 1C	



© Crown copyright. All rights reserved. 100019783. 2023

Do not scale from this drawing in either hard or electronic format. No responsibility is accepted where this drawing is used in circumstances other than that for which it was originally prepared and issued.



Meg Booth
Director for Climate Change,
Environment & Transport

TRAFFIC MANAGEMENT TEAM
DEVON COUNTY COUNCIL
COUNTY HALL
TOPSHAM ROAD
EXETER
EX2 4GD
Telephone 0345 155 1004

SCHEME

OFF STREET PARKING PLACES

DRAWING

EXETER DIGBY PARK & RAIL
CAR PARK

drawn by

JPB

scale

1:1250

date

05-Jun-2023

O.S.Ref

296026,91511

drawing number

PLAN 1D

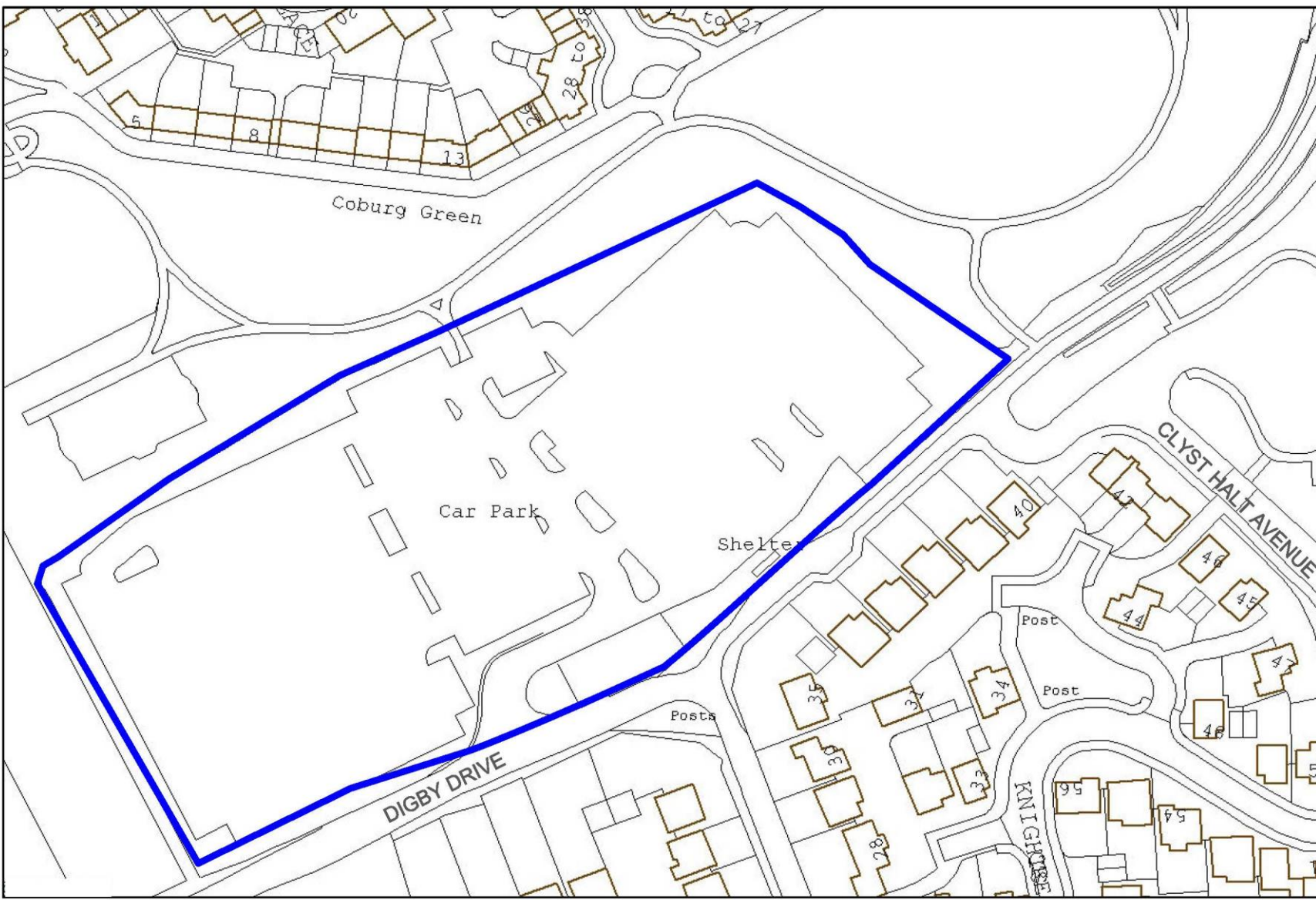

© Crown copyright. All rights reserved. 100019783. 2023

Do not scale from this drawing in either hard or electronic format. No responsibility is accepted where this drawing is used in circumstances other than that for which it was originally prepared and issued.



Meg Booth
Director for Climate Change,
Environment & Transport

TRAFFIC MANAGEMENT TEAM
DEVON COUNTY COUNCIL
COUNTY HALL
TOPSHAM ROAD
EXETER
EX2 4QD
Telephone 0345 155 1004

SCHEME

OFF STREET PARKING PLACES

DRAWING

EXETER DIGBY PARK & RIDE
CAR PARK

drawn by

JPB

scale

1:1250

date

05-Jun-2023

O.S.Ref

295898,91492

drawing number

PLAN 1E

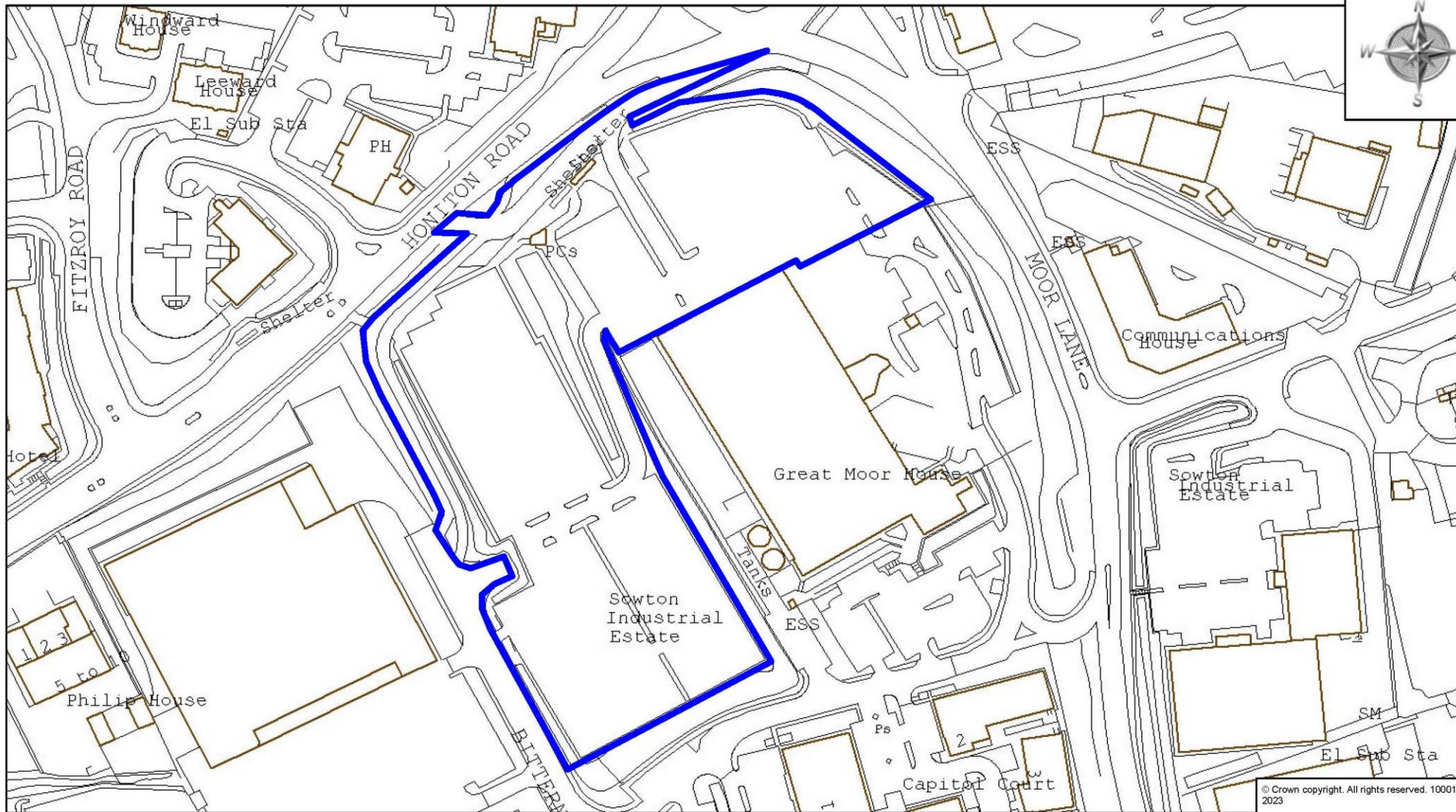

© Crown copyright. All rights reserved. 100019783. 2023

Do not scale from this drawing in either hard or electronic format. No responsibility is accepted where this drawing is used in circumstances other than that for which it was originally prepared and issued.



Meg Booth
Director for Climate Change,
Environment & Transport

TRAFFIC MANAGEMENT TEAM
DEVON COUNTY COUNCIL
COUNTY HALL
TOPSHAM ROAD
EXETER
EX2 4GD
Telephone 0345 155 1004

SCHEME

OFF STREET PARKING PLACES

DRAWING

EXETER HONITON ROAD PARK & RIDE CAR PARK

drawn by

JPB

scale

1:2000

date

05-Jun-2023

O.S.Ref

296278,92675

drawing number

PLAN 1F

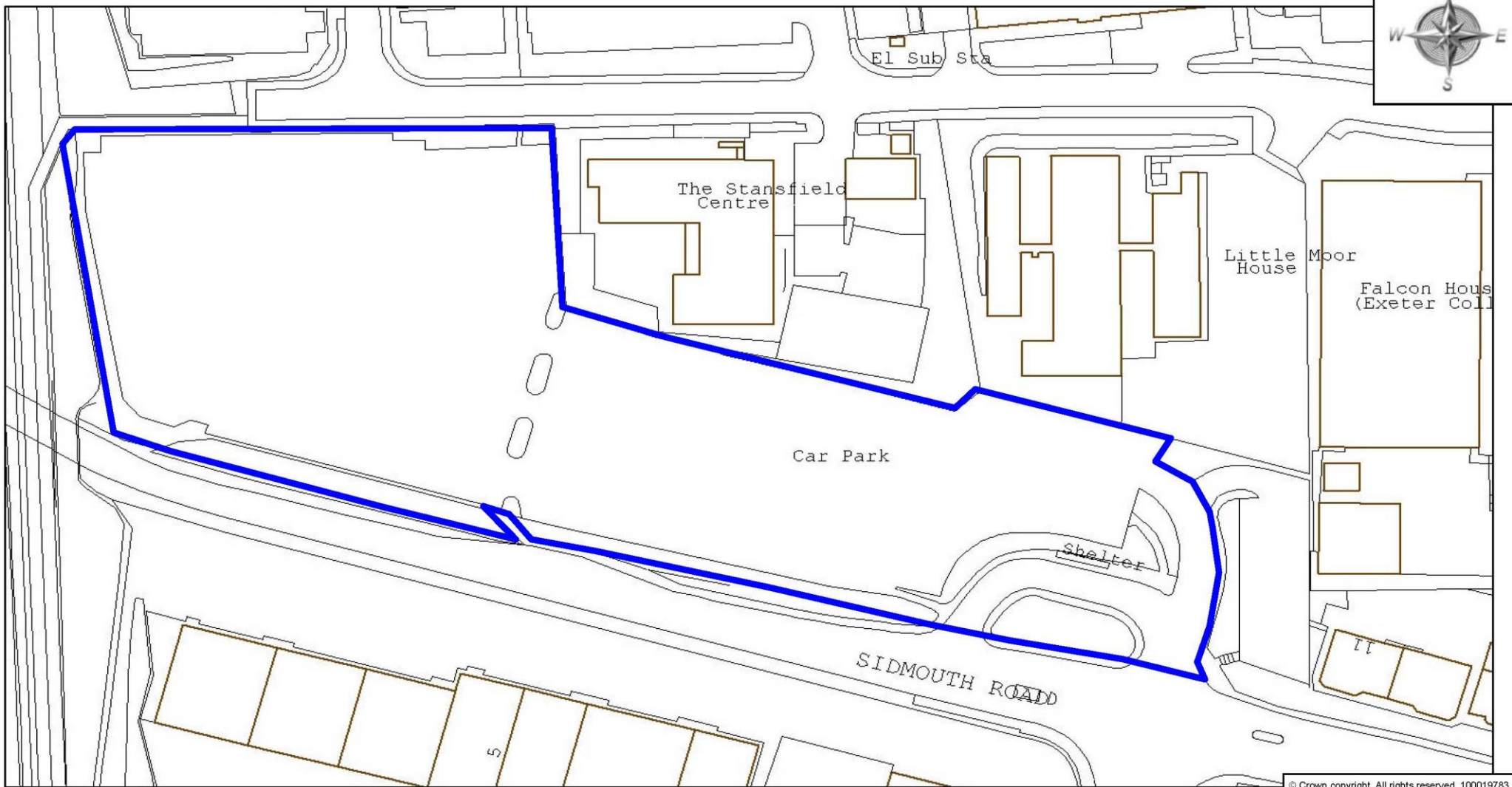

© Crown copyright. All rights reserved. 100019783. 2023

Do not scale from this drawing in either hard or electronic format. No responsibility is accepted where this drawing is used in circumstances other than that for which it was originally prepared and issued.



Meg Booth
Director for Climate Change,
Environment & Transport

TRAFFIC MANAGEMENT TEAM
DEVON COUNTY COUNCIL
COUNTY HALL
TOPSHAM ROAD
EXETER
EX2 4GD
Telephone 0345 155 1004

SCHEME

OFF STREET PARKING PLACES

drawn by

JPB

scale

1:1250

DRAWING

EXETER SOWTON PARK & RIDE
CAR PARK

date

05-Jun-2023

O.S.Ref

296272,91724

drawing number

PLAN 1G

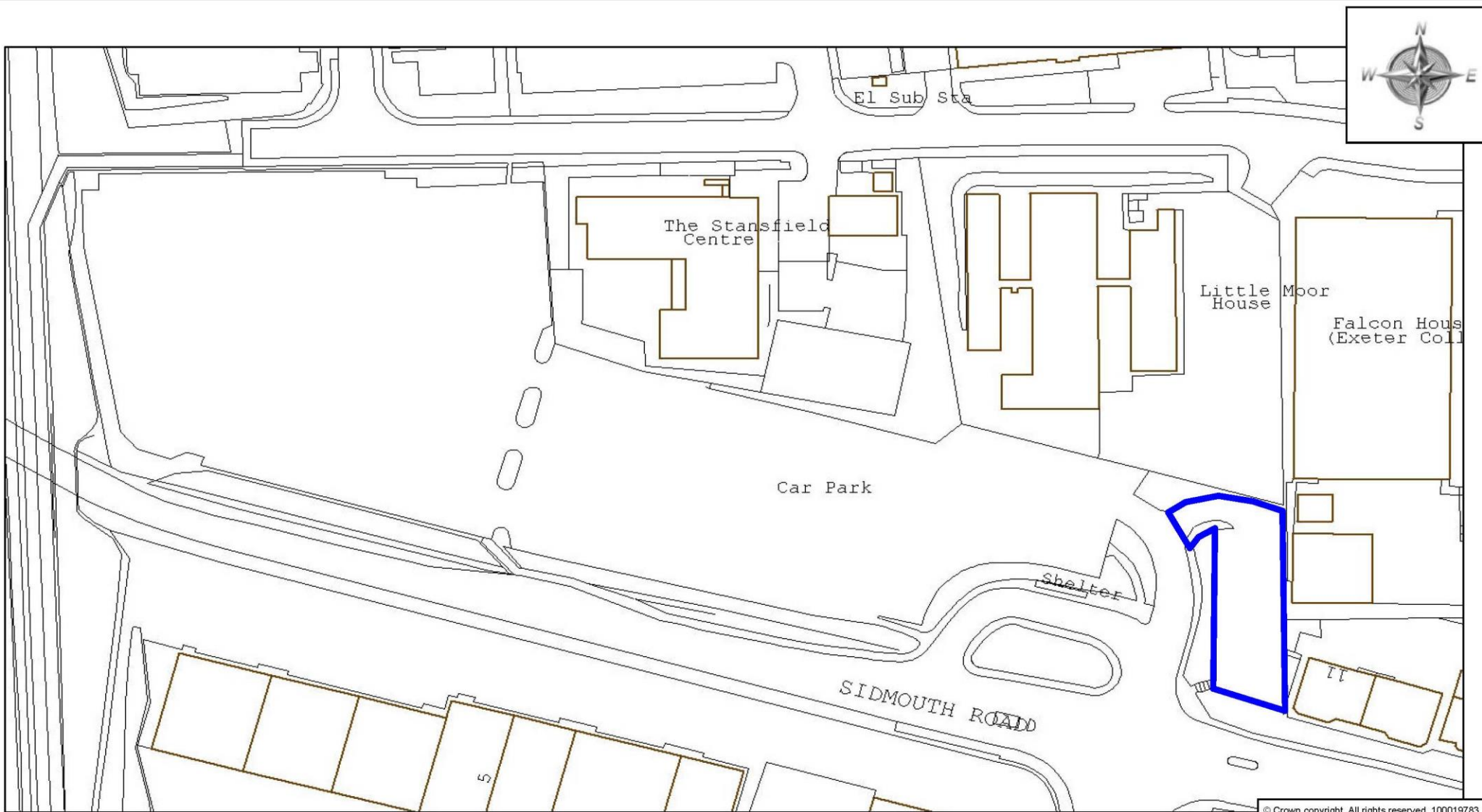

© Crown copyright. All rights reserved. 100019783. 2023

Do not scale from this drawing in either hard or electronic format. No responsibility is accepted where this drawing is used in circumstances other than that for which it was originally prepared and issued.



Meg Booth
 Director for Climate Change,
 Environment & Transport
 TRAFFIC MANAGEMENT TEAM
 DEVON COUNTY COUNCIL
 COUNTY HALL
 TOPSHAM ROAD
 EXETER
 EX2 4GD
 Telephone 0345 155 1004

SCHEME
 DRAWING

OFF STREET PARKING PLACES
 EXETER SOWTON PAY & DISPLAY
 CAR PARK

drawn by	scale
JPB	1:1250
date	O.S.Ref
05-Jun-2023	296324,91703
drawing number	
PLAN 1H	

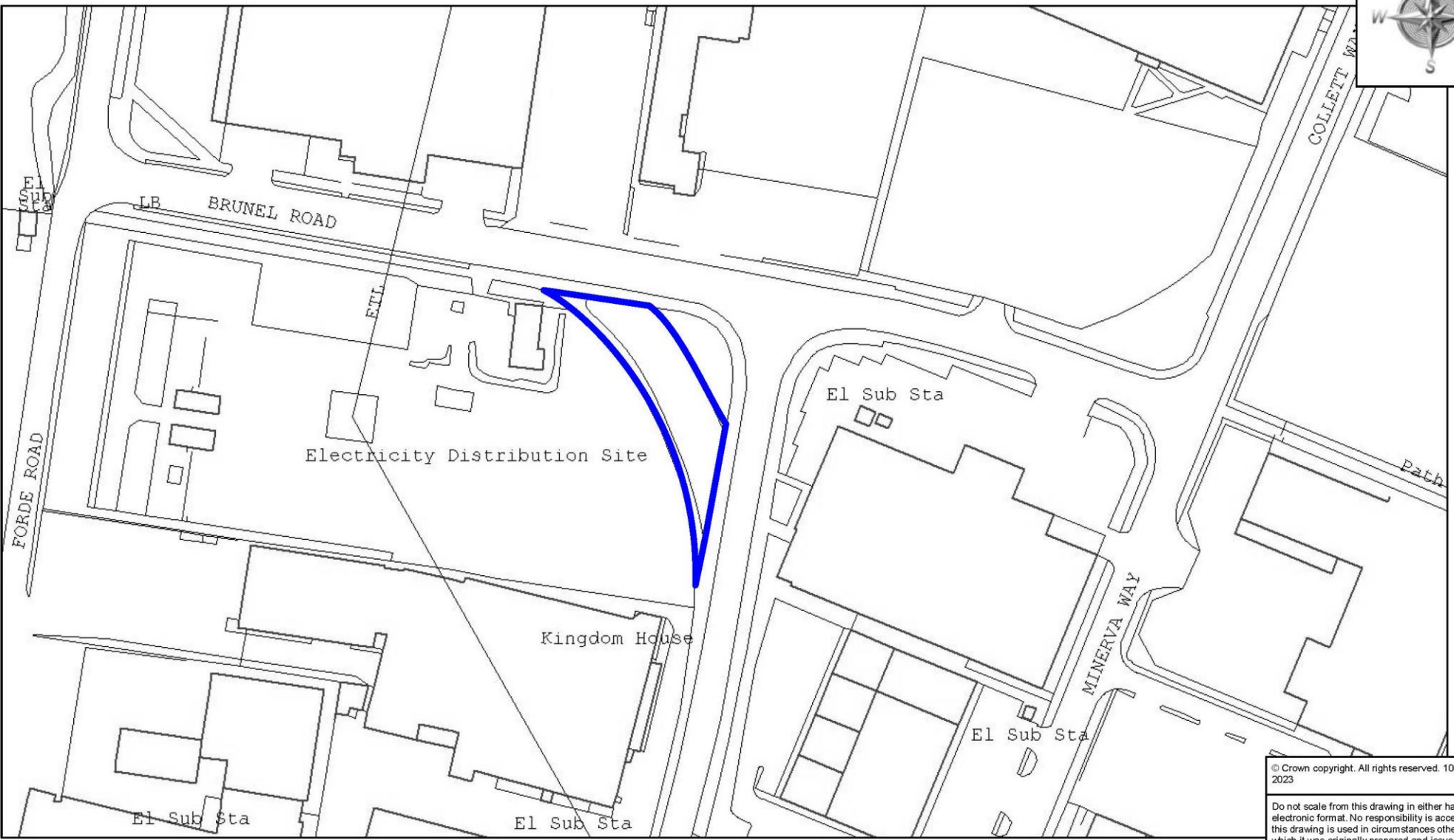

© Crown copyright. All rights reserved. 100019783. 2023

Do not scale from this drawing in either hard or electronic format. No responsibility is accepted where this drawing is used in circumstances other than that for which it was originally prepared and issued.



Meg Booth
Director for Climate Change,
Environment & Transport

TRAFFIC MANAGEMENT TEAM
DEVON COUNTY COUNCIL
COUNTY HALL
TOPSHAM ROAD
EXETER
EX2 4GD
Telephone 0345 155 1004

SCHEME

OFF STREET PARKING PLACES

DRAWING

NEWTON ABBOT BRUNEL ROAD
CAR PARK

drawn by

JPB

scale

1:1250

date

05-Jun-2023

O.S.Ref

287049,71344

drawing number

PLAN 11

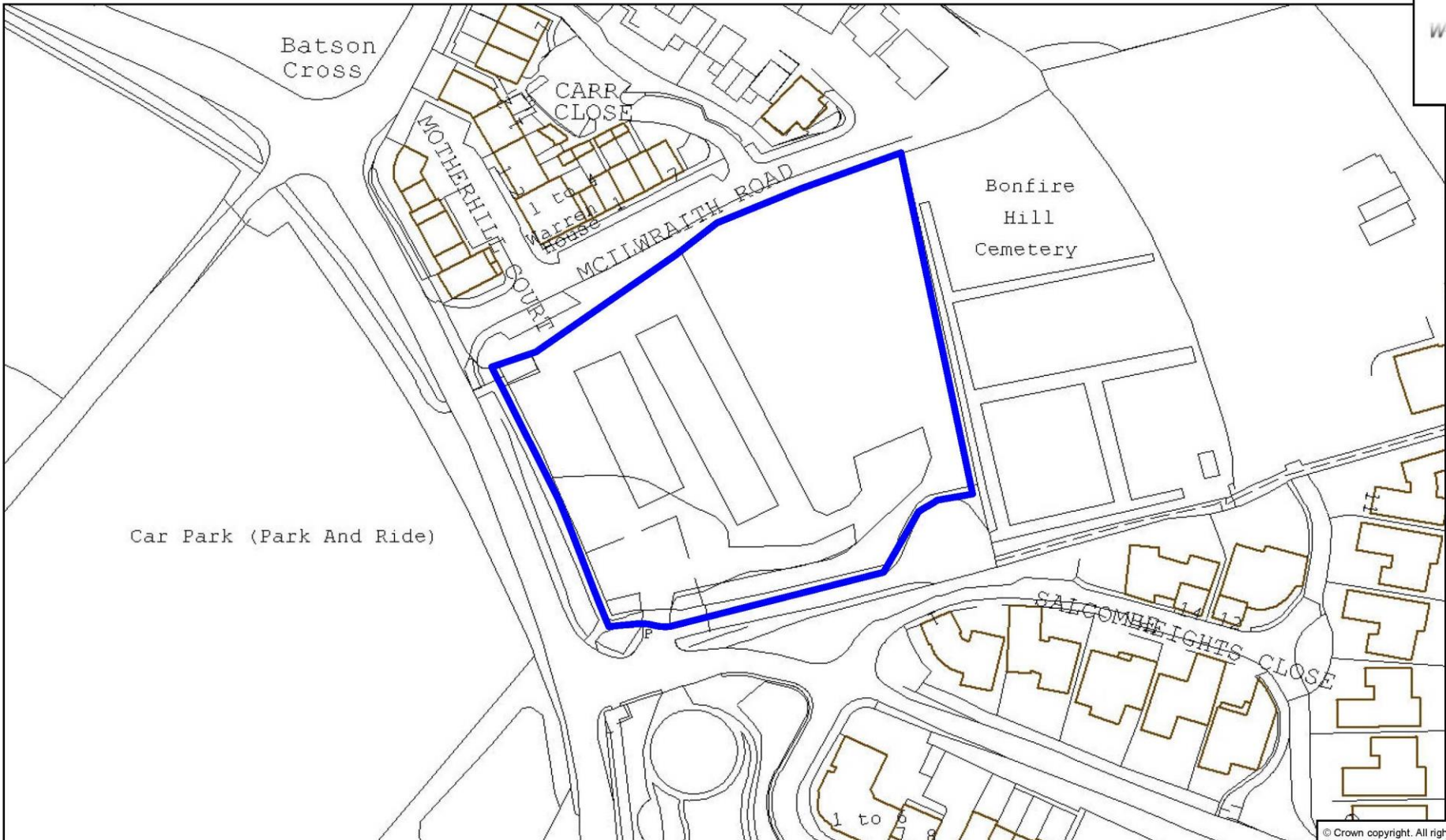

Car Park (Park And Ride)

© Crown copyright. All rights reserved. 100019783. 2023

Do not scale from this drawing in either hard or electronic format. No responsibility is accepted where this drawing is used in circumstances other than that for which it was originally prepared and issued.



Meg Booth
Director for Climate Change,
Environment & Transport

TRAFFIC MANAGEMENT TEAM
DEVON COUNTY COUNCIL
COUNTY HALL
TOPSHAM ROAD
EXETER
EX2 4GD
Telephone 0345 155 1004

SCHEME

OFF STREET PARKING PLACES

DRAWING

SALCOMBE BONFIRE HILL CAR PARK

drawn by

JPB

scale

1:1250

date

05-Jun-2023

O.S.Ref

273304,39306

drawing number

PLAN 1J



© Crown copyright. All rights reserved. 100019783. 2023

Do not scale from this drawing in either hard or electronic format. No responsibility is accepted where this drawing is used in circumstances other than that for which it was originally prepared and issued.



Meg Booth
Director for Climate Change,
Environment & Transport

TRAFFIC MANAGEMENT TEAM
DEVON COUNTY COUNCIL
COUNTY HALL
TOPSHAM ROAD
EXETER
EX2 4GD
Telephone 0345 155 1004

SCHEME

OFF STREET PARKING PLACES

DRAWING

STOVER COUNTRY PARK
CAR PARK

drawn by

JPB

scale

1:1500

date

05-Jun-2023

O.S.Ref

283230,74946

drawing number

PLAN 1K

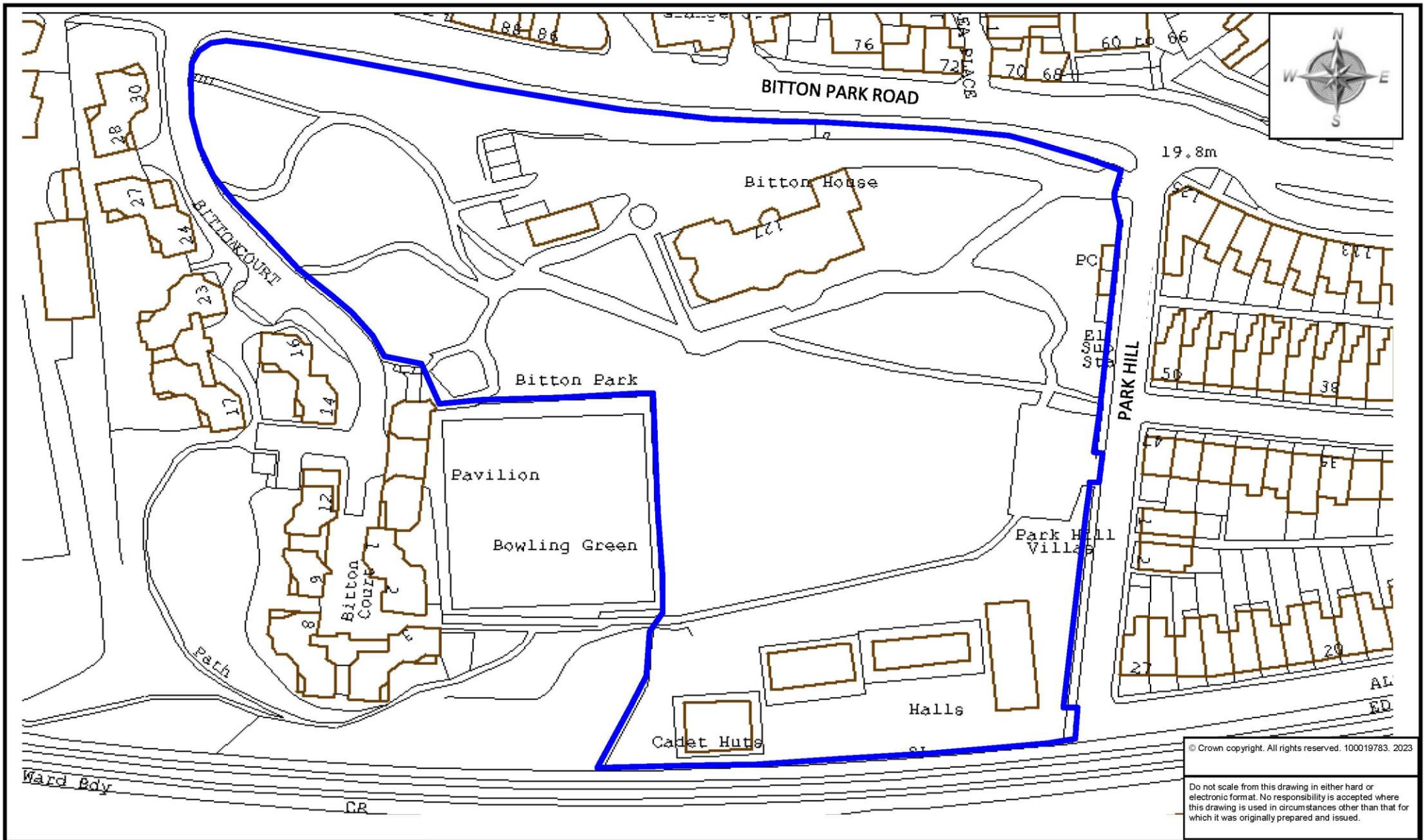

© Crown copyright. All rights reserved. 100019783. 2023

Do not scale from this drawing in either hard or electronic format. No responsibility is accepted where this drawing is used in circumstances other than that for which it was originally prepared and issued.



Meg Booth
Director for Climate Change,
Environment & Transport

TRAFFIC MANAGEMENT TEAM
DEVON COUNTY COUNCIL
COUNTY HALL
TOPSHAM ROAD
EXETER
EX2 4GD
Telephone 0345 155 1004

SCHEME	OFF STREET PARKING PLACES	
DRAWING	TEIGNMOUTH BITTON HOUSE CAR PARK	
drawn by	scale	JPB 1:1000
date	O.S.Ref	05-Jun-2023 293491,73063
drawing number	PLAN 1L	

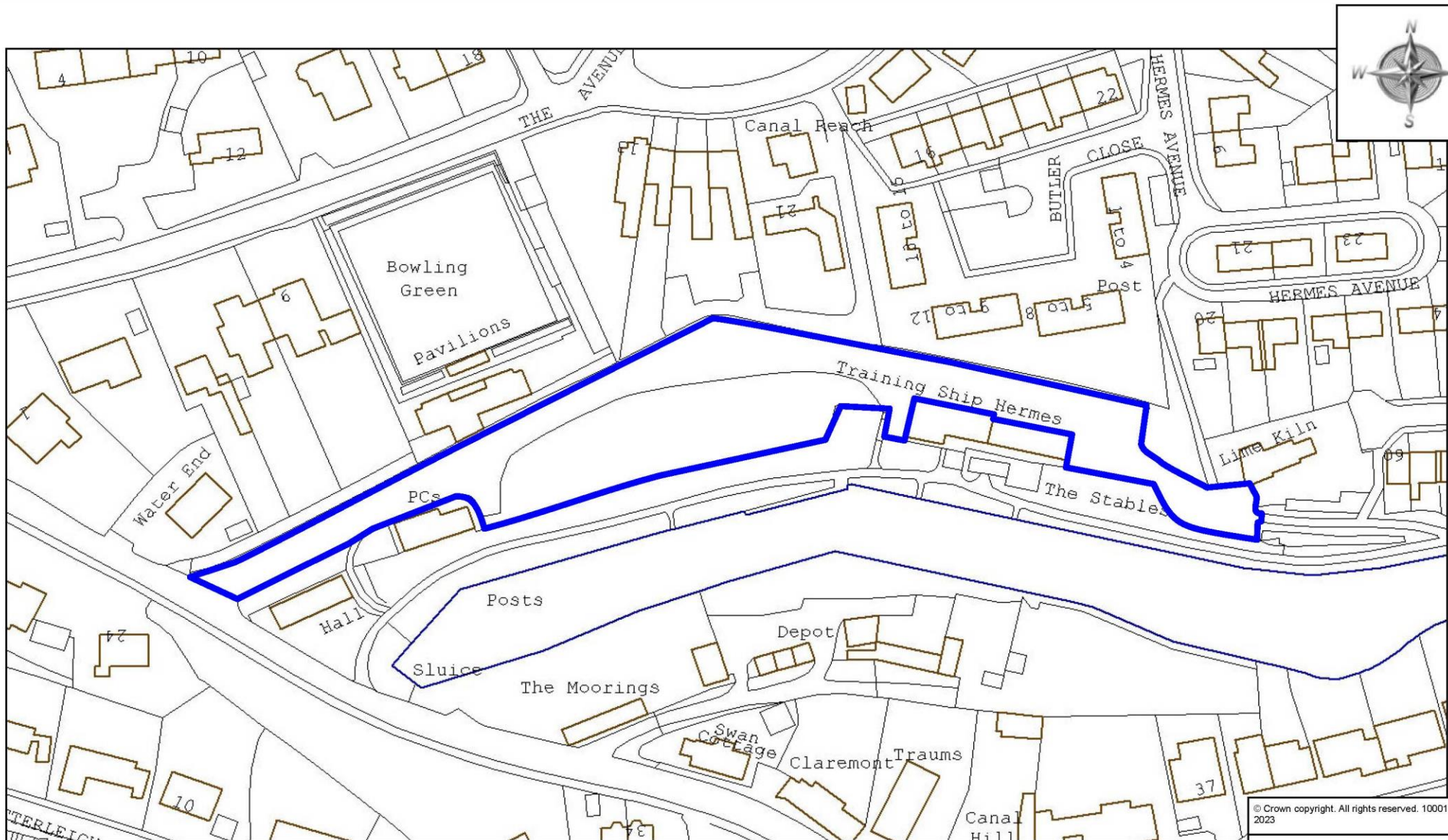

© Crown copyright. All rights reserved. 100019783. 2023

Do not scale from this drawing in either hard or electronic format. No responsibility is accepted where this drawing is used in circumstances other than that for which it was originally prepared and issued.



Meg Booth
Director for Climate Change,
Environment & Transport

TRAFFIC MANAGEMENT TEAM
DEVON COUNTY COUNCIL
COUNTY HALL
TOPSHAM ROAD
EXETER
EX2 4QD
Telephone 0345 155 1004

SCHEME

OFF STREET PARKING PLACES

DRAWING

TIVERTON GRAND WESTERN CANAL COUNTRY PARK
CAR PARK

drawn by

JPB

scale

1:1250

date

05-Jun-2023

O.S.Ref

296336,112432

drawing number

PLAN 1M

SCHEDULE 2
No Waiting At Any Time

Index of Plans

Plan 2A	Exeter County Hall
Plan 2B	Exeter County Hall

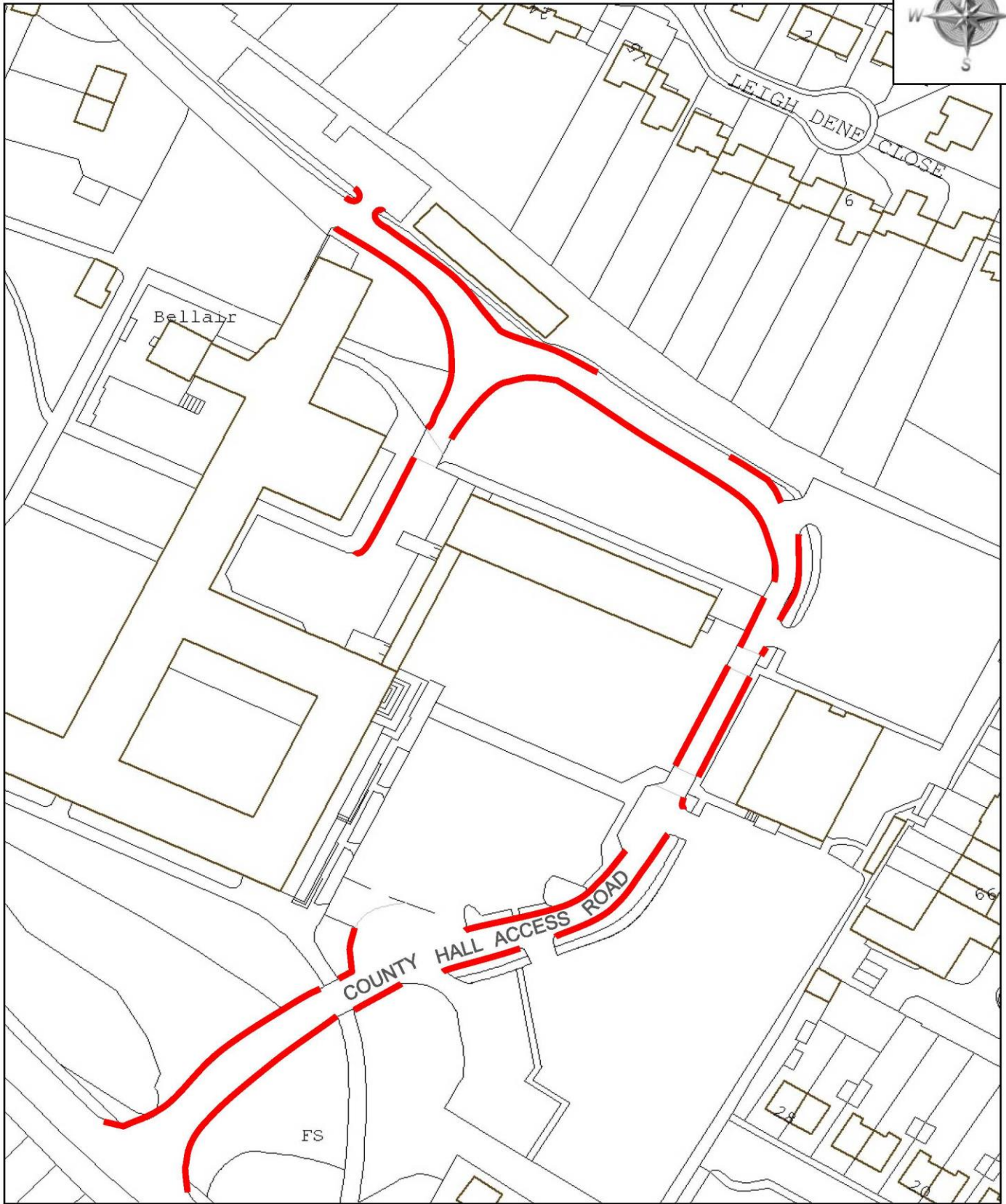

Key
 No Waiting At Any Time

© Crown copyright. All rights reserved. 100019783. 2023

Do not scale from this drawing in either hard or electronic format. No responsibility is accepted where this drawing is used in circumstances other than that for which it was originally prepared and issued.



Meg Booth
 Director for Climate Change,
 Environment & Transport
 TRAFFIC MANAGEMENT TEAM
 DEVON COUNTY COUNCIL
 COUNTY HALL
 TOPSHAM ROAD
 EXETER
 EX2 4GD
 Telephone 0345 155 1004

SCHEME

OFF STREET PARKING PLACES

DRAWING

EXETER COUNTY HALL
 NO WAITING AT ANY TIME

drawn by	scale
JPB	1:1250
date	O.S.Ref
05-Jun-2023	293061,91596
drawing number	
PLAN 2A	

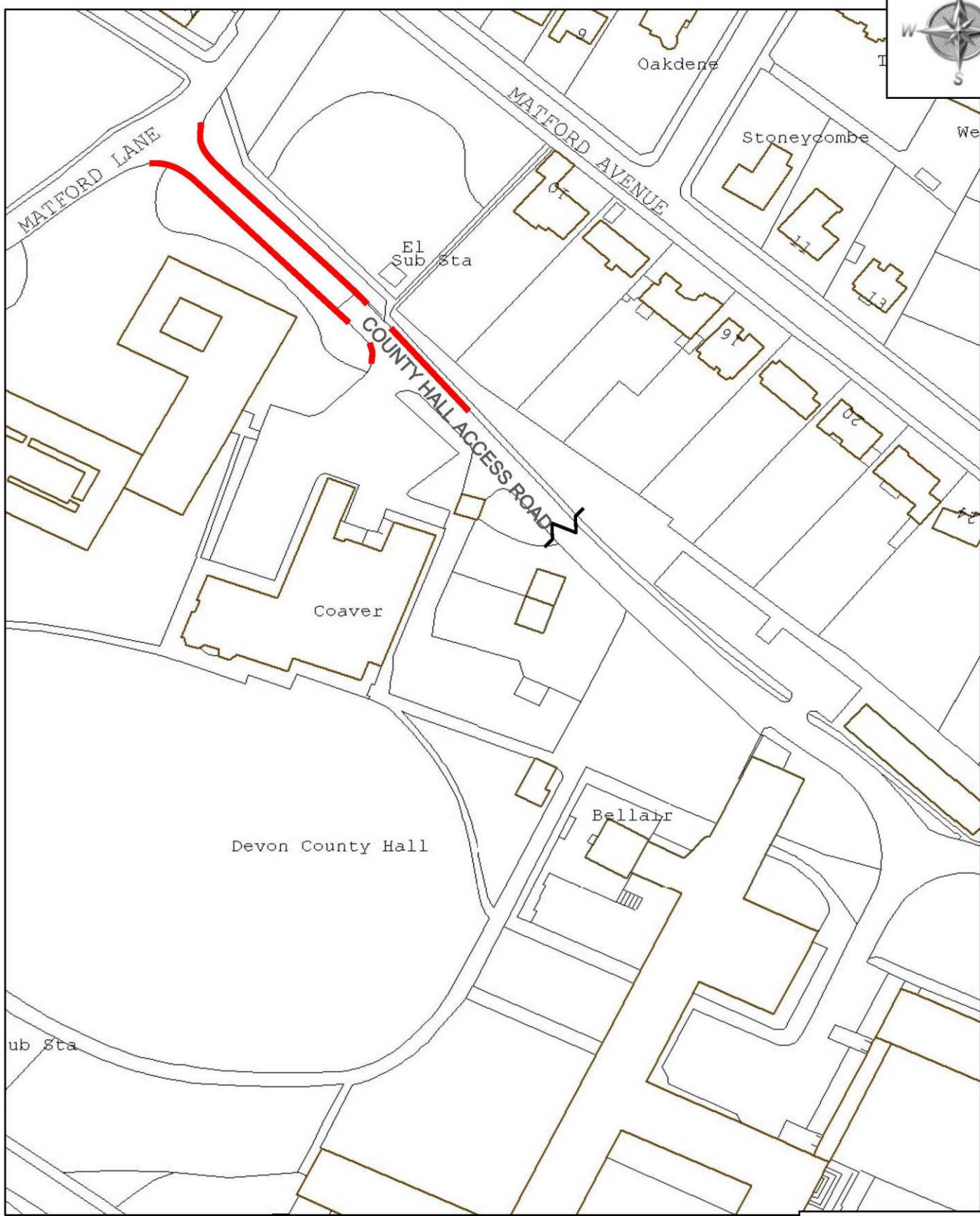

Key
 No Waiting At Any Time

© Crown copyright. All rights reserved. 100019783. 2023

Do not scale from this drawing in either hard or electronic format. No responsibility is accepted where this drawing is used in circumstances other than that for which it was originally prepared and issued.



Meg Booth
 Director for Climate Change,
 Environment & Transport
 TRAFFIC MANAGEMENT TEAM
 DEVON COUNTY COUNCIL
 COUNTY HALL
 TOPSHAM ROAD
 EXETER
 EX2 4QD
 Telephone 0345 155 1004

SCHEME
OFF STREET PARKING PLACES

DRAWING
**EXETER COUNTY HALL
 NO WAITING AT ANY TIME**

drawn by | scale
 JPB | 1:1250

date | O.S.Ref
 05-Jun-2023 | 292886,91855

drawing number
PLAN 2B

SCHEDULE 3
Permits

Permit Type	Valid within Parking Place	Persons eligible to apply for permit	Charge
<i>Column 1</i>	<i>Column 2</i>	<i>Column 3</i>	<i>Column 4</i>
Barnstaple Civic Centre	<ul style="list-style-type: none"> Barnstaple Civic Centre 	All	Free
Brunel Road	<ul style="list-style-type: none"> Newton Abbot Brunel Road 	Authorised staff working at Estuary House, Collett Way	Free
Cullompton St Andrews Road Daytime	<ul style="list-style-type: none"> Cullompton St Andrews Road 	All	£250
Park & Cycle	<ul style="list-style-type: none"> Exeter Digby Park & Ride Exeter Honiton Road Park & Ride Exeter Sowton Park & Ride <p><i>Note: Permits are also issued for Exeter Matford Park & Ride which is operated by Exeter City Council</i></p>	All	Free
Salcombe Bonfire Hill Car Park Annual	<ul style="list-style-type: none"> Salcombe Bonfire Hill Car Park 	Properties determined by Salcombe Town Council ¹	£350
Salcombe Bonfire Hill Car Park 6 Month	<ul style="list-style-type: none"> Salcombe Bonfire Hill Car Park 	Properties determined by Salcombe Town Council ¹	£200
Stover Country Park	<ul style="list-style-type: none"> Stover Country Park Car Park 	All	£24
Teignmouth Bitton House Car Park Annual	<ul style="list-style-type: none"> Teignmouth Bitton House Car Park 	All	£520 ²
Teignmouth Bitton House Car Park 6 month	<ul style="list-style-type: none"> Teignmouth Bitton House Car Park 	All	£280
Teignmouth Bitton House Car Park 3 month	<ul style="list-style-type: none"> Teignmouth Bitton House Car Park 	All	£145
Teignmouth Bitton House Car Park Daytime	<ul style="list-style-type: none"> Teignmouth Bitton House Car Park 	All	£350
Teignmouth Bitton House Car Park Overnight	<ul style="list-style-type: none"> Teignmouth Bitton House Car Park 	All	£250
Tiverton Grand Western Canal	<ul style="list-style-type: none"> Tiverton Grand Western Canal 	All	£24

¹ A maximum number of Salcombe Bonfire Hill Car Park permits allowed at any time (Annual & 6 months) may be set by Salcombe Town Council

² A price of £440 will apply to legacy permit holders as determined by Teignmouth Town Council

dated 20th March 2024

The COMMON SEAL of)
Devon County Council)
was hereunto affixed)
in the presence of)



Megan
MEGAN WOS

duly authorised signatory

document number 520171

reference imr/DEV001/647

website reference 6116