

**DATED 22 AUGUST 2013**

**THE DERBYSHIRE COUNTY COUNCIL**

**ROAD TRAFFIC REGULATION ACT 1984**

**THE DERBYSHIRE COUNTY COUNCIL**

**(SHEFFIELD ROAD, DRONFIELD)**

**(WAITING RESTRICTIONS) ORDER 2013**

**J McElvaney**

**MATLOCK**

**Z3054**

# INDEX

## Article

- 1 Citation and Commencement
- 2 Interpretation
- 3 Waiting Restrictions
- 4 General Exemptions
- 5 Disabled Persons' Exemptions
- 6 Public Service Vehicles
- 7 Effect of Order
- 8 Revocations and Amendments to previous Orders

**THE DERBYSHIRE COUNTY COUNCIL**  
**ROAD TRAFFIC REGULATION ACT 1984**  
**(SHEFFIELD ROAD, DRONFIELD)**  
**(WAITING RESTRICTIONS) ORDER 2013**

The Derbyshire County Council in exercise of its powers under Sections 1(1), and 2(1) to (3) of the Road Traffic Regulation Act 1984 ("the Act") and of all other enabling powers, after consultation with the Chief Officer of Police in accordance with Part III of Schedule 9 to the Act hereby makes the following Order:-

**1 CITATION AND COMMENCEMENT**

This Order shall come into operation on the Second day of September Two Thousand and Thirteen and may be cited as The Derbyshire County Council (Sheffield Road, Dronfield) (Waiting Restrictions) Order 2013.

**2 INTERPRETATION**

In this Order:-

2.1 "the County Council" means Derbyshire County Council.

2.2 "Carriageway" means a way constituting or comprised in a highway being a way (other than a cycle track) over which the public have a right of way for the passage of Vehicles, as in Section 329(1) of the Highways Act 1980.

2.3 "Pavement" means the remainder of the surfaced highway that is not constructed and used as Carriageway.

2.4 "Owner" in relation to a Vehicle, means the person by whom such Vehicle is kept and used.

2.5 "Vehicle" for the purposes of this Order means a "Motor Vehicle" or "Cycle"

2.6 "Motor Vehicle" means any mechanically propelled vehicle intended or adapted for use on roads.

2.7 "Cycle" means a bicycle, tricycle or a cycle having four or more wheels, not being in any case a Motor Vehicle.



2.8 "Public Service Vehicle" has the meaning ascribed to it by Section 1 of the Public Passenger Vehicles Act 1981, that is to say it shall mean a motor vehicle (other than a tramcar) which –

- (i) being a Vehicle adapted to carry more than eight passengers, is used for carrying passengers for hire or reward; or
- (ii) being a Vehicle not so adapted, is used for carrying passengers for hire or reward at separate fares in the course of a business or carrying passengers.

2.9 "Pedal Cycle" means a cycle (which has the same meaning as that ascribed to it in Section 192 of The Road Traffic Act 1988).

2.10 "Disabled Person's Badge" has the same meaning as in the Disabled Persons (Exemption for Disabled Persons) (England) Regulations 2000.

2.11 "Disabled Person's Vehicle" means a Vehicle displaying Disabled Persons Badge in the relevant position as set out under Regulation 4 of the Local Authorities Orders (Exemption for Disabled Persons) (England) Regulations 2000.

2.12 "CEO" means Civil Enforcement Officer and has the same meaning as in Section 76 of The 2004 Act

2.13 "The 2004 Act" means the Traffic Management Act 2004.

2.14 "Electronic Communications Apparatus", "Electronic Communications Network" and any "Electronic Communications Line" shall have the same meaning as in the Communications Act 2003.

### **3 WAITING RESTRICTIONS**

3.1 Save as provided in articles 4, 5 and 6 of this Order no person shall except upon the direction or with the permission of a Police Constable in uniform, or a CEO, cause or permit any Vehicle to wait between the hours of 8am and 6pm on any day (other than a Sunday) for longer than 2 hours (no return within 1 hour) on the length of road specified in the Schedule to this Order.

### **4 GENERAL EXEMPTIONS**

4.1 Nothing in Article 3 shall render it unlawful to cause or permit any Vehicle to wait in the lengths of road referred to therein for so long as may be necessary to enable:-

- (i) a person to board or alight from the Vehicle;
- (ii) the Vehicle, if it cannot conveniently be used for such purpose in any other road, to be used in connection with any of the following operations namely:-

- (a) building, industrial or demolition operations;
  - (b) the removal of any obstruction to traffic;
  - (c) the maintenance, improvement or reconstruction of the said lengths of road; or
  - (d) the laying, erection, alteration or repair in, or on land adjacent to the said lengths of road of any sewer or of any main, pipe or apparatus for the supply of gas, water or electricity or of any Electronic Communications Line;
- (iii) the Vehicle, if it cannot conveniently be used for such purpose in any other road, to be used in the service of a local authority or a water authority in pursuance of statutory powers or duties;
- (iv) the Vehicle of a universal service provider (as defined in Section 4 of The Postal Services Act 2000) to be used for the purpose of delivering or collecting mail;
- (v) the Vehicle to take in petrol, oil, water or air from any garage situated on or adjacent to the said lengths of road;
- (vi) any Vehicle, other than a privately owned Vehicle, which is being used as an official Vehicle for the purposes of a wedding (bridal vehicle) or a funeral (hearse and cortege) at a Church or place of worship
- (vii) the Vehicle to be used for fire brigade, ambulance or police purposes;
- or
- (viii) goods to be loaded or unloaded from the Vehicle.

## **5 DISABLED PERSONS' EXEMPTIONS**

5.1 Nothing in Article 3.1 shall render it unlawful to cause or permit a Disabled Person's Vehicle which displays in the relevant position a Disabled Person's Badge, and a parking disc (on which the driver, or other person in charge of the Vehicle, has marked the time at which the period of waiting began) to wait in the lengths of road referred to in that Article.

5.2 A vehicle displays a Disabled Person's Badge in the relevant position if:-

- (i) in the case of a Vehicle fitted with a front windscreen, the badge is exhibited thereon on the near side of and immediately behind the windscreen and with its front facing forward so as to be legible from outside the Vehicle; or
- (ii) in the case of a Vehicle not fitted with a front windscreen, the badge is exhibited in a conspicuous position on the Vehicle.

5.3 A Vehicle displays a Disabled Person's Badge in the relevant position if:-



- (i) in the case of a Vehicle fitted with a dashboard or fascia panel, the badge is exhibited thereon so that Part I of the badge is legible from outside the Vehicle; or
- (ii) in the case of a Vehicle not fitted with a dashboard or fascia panel, the badge is exhibited in a conspicuous position on the Vehicle so that Part I of the badge is legible from outside the vehicle.

5.4 A Vehicle displays a parking disc in the relevant position if:-

- (i) in the case of a Vehicle fitted with a dashboard or fascia panel, the disc is exhibited thereon so that the quarter-hour period during which the period of waiting began is legible from outside the Vehicle; or
- (ii) in the case of a Vehicle not so fitted, the disc is exhibited in a conspicuous position on the Vehicle so that the quarter-hour period during which the period of waiting began is legible from outside the Vehicle".

## **6 PUBLIC SERVICE VEHICLES**

6.1 Nothing in Article 3 shall apply to a Public Service Vehicle.

## **7 EFFECT OF ORDER**

7.1 The prohibitions and restrictions imposed by this Order shall be in addition to and not in derogation from any restrictions or requirements imposed by any regulations made or having effect as if made under the Act of 1984 or by or under any other enactment.

## **8 REVOCATIONS OF PREVIOUS ORDERS**

8.1 Any permanent Traffic Regulation Orders made prior to this Order, insofar as they relate to the lengths of road listed below, insofar as they relate to the prohibitions and restrictions listed below, are hereby revoked.

**Limited Waiting 45 minutes no return within 1 hour**  
**Mon - Sat 8am – Midnight**

**Sheffield Road, Dronfield**  
**North East Side**

From a point 27 metres south east of its junction with Snape Hill Lane in a south easterly direction for a distance of 81 metres.

# SCHEDULE

Limited Waiting 2 hours no return within 1 hour  
Monday – Saturday 8am – 6pm

Sheffield Road, Dronfield  
North East Side

From a point 27 metres south east of its junction with Snape Hill Lane in a south easterly direction for a distance of 81 metres.

As shown for illustration purposes only on the attached plan.

THE COMMON SEAL of the Derbyshire )  
County Council was hereunto affixed )  
the Twenty-Second day of August Two )  
thousand and Thirteen in the presence of:- )

*AWL*

*PP* Director of Legal Services

Number in Seal  
Book

2013/848



# LOCATION PLAN

NOT TO SCALE

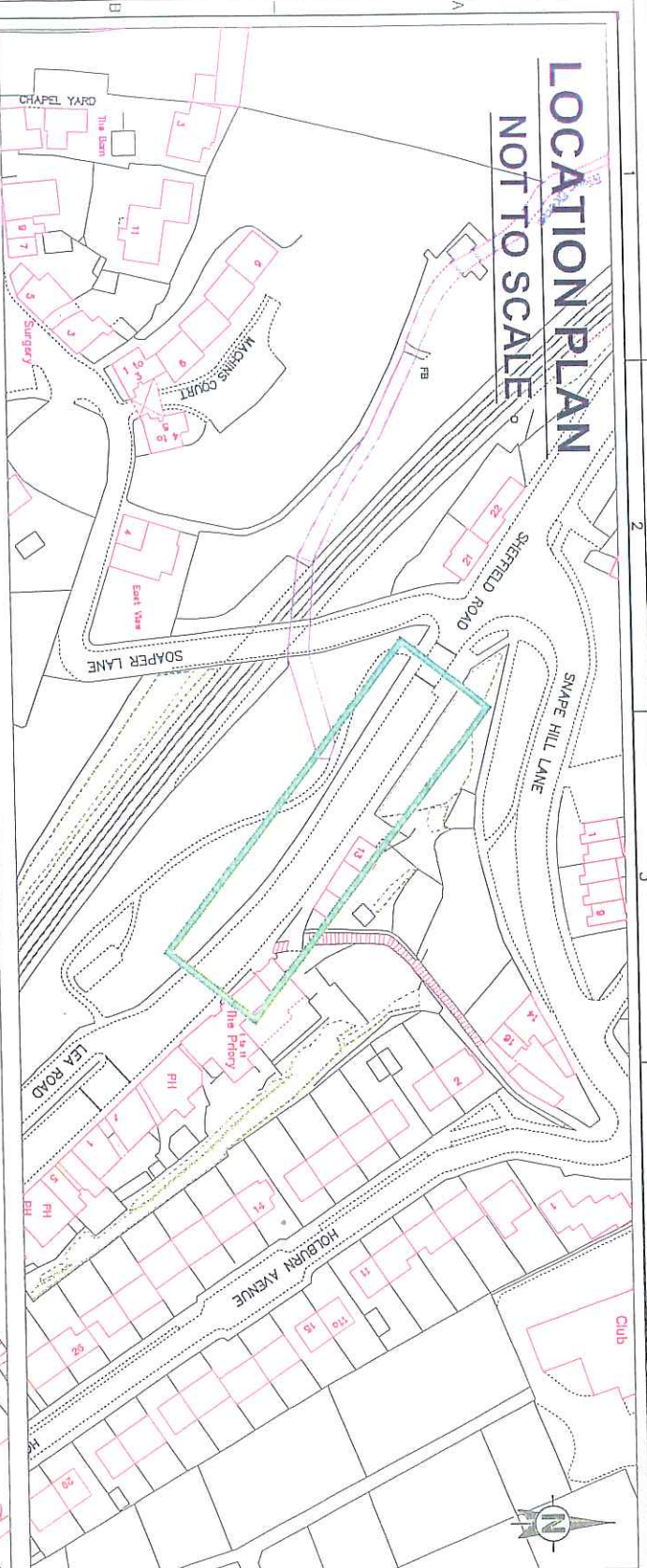

# LAYOUT PLAN

NOT TO SCALE

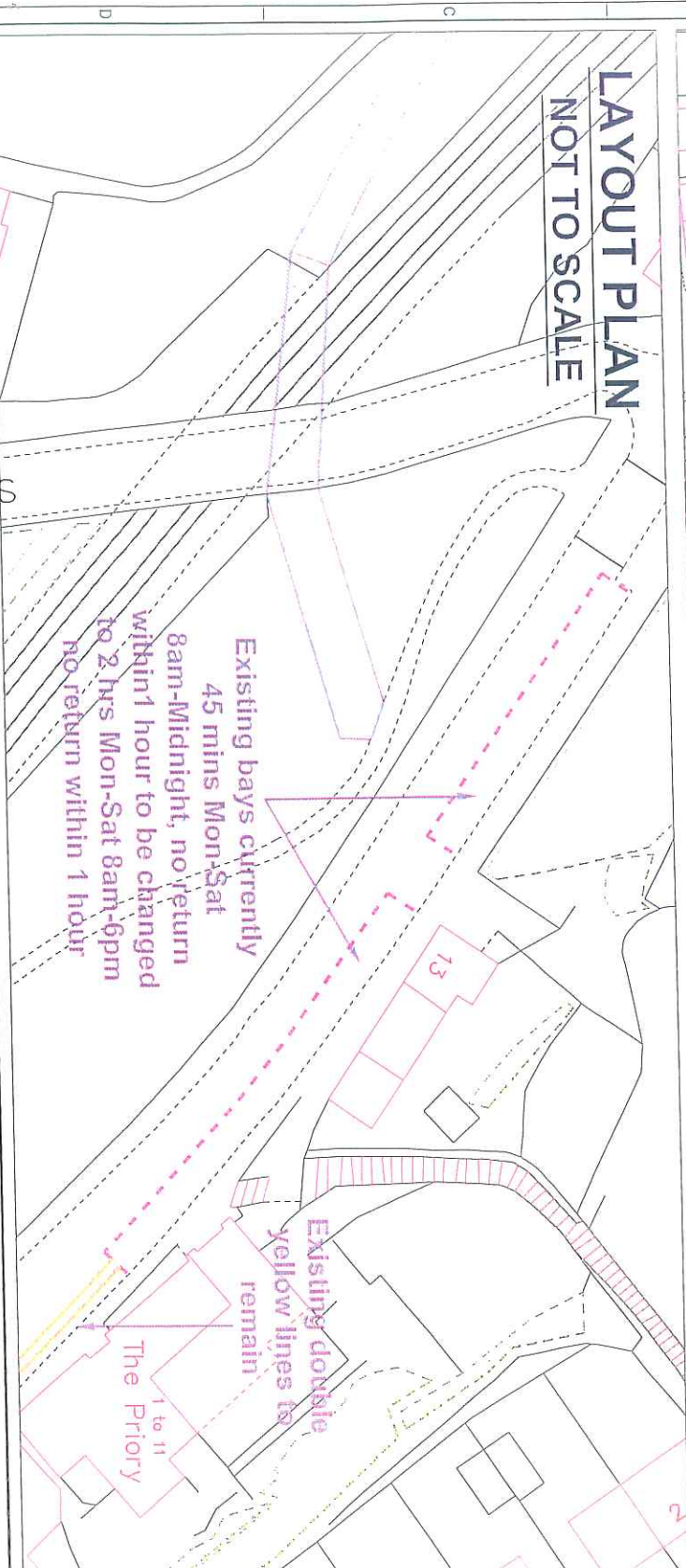

## KEY

Existing limited waiting to be changed from 45 minutes Mon-Sat, 8am-Midnight no return within 1 hour to 2 hours Mon-Sat, 8am-6pm no return within 1 hour

Existing double yellow lines to remain

Referenced from the Ordnance Survey map, 1:50,000 scale, with the permission of the Ordnance Survey, 2009. All rights reserved. Crown Copyright and may not be reproduced or used in any form without the permission of the Ordnance Survey, 2009.

AMENDMENT DETAILS		By	Date	No.
Drawn by	SH			
Scale	NTS			
Date	15/05/13			
ORIGINAL DRAWING SIZE 210 x 298 (A4)				

**DERBYSHIRE**  
COUNTY COUNCIL  
IAN W STEPHENSON  
BSc, CEng, MICE, MAIT  
STRATEGIC DIRECTOR OF ENVIRONMENTAL SERVICES

**PROJECT TITLE**  
SHEFFIELD ROAD  
DRONFIELD

**DRAWING TITLE**  
PROPOSED CHANGES  
TO EXISTING LIMITED  
WAITING RESTRICTION  
DRAWING No.  
NTA/SMP/20/13



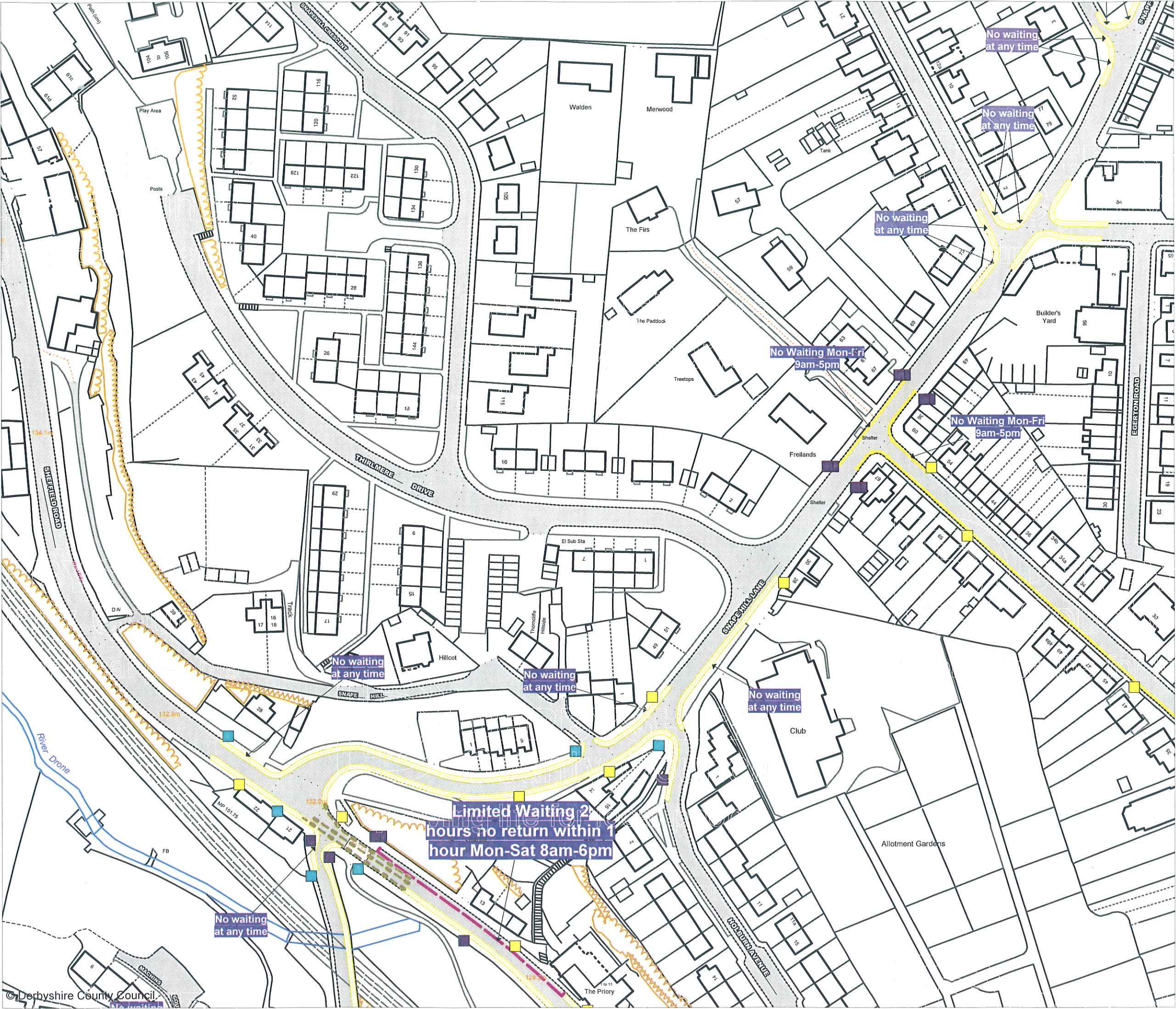

# Prohibition and Restriction of Waiting, On Street Parking and Clearways.

This map is reproduced from Ordnance Survey material with the permission of Ordnance Survey on behalf of the Controller of Her Majesty's Stationery Office (c) Crown Copyright. Unauthorised reproduction infringes Crown copyright and may lead to prosecution or civil proceedings.  
Derbyshire County Council  
Licence No: 100023251 2009

CONFIRMED





**DERBYSHIRE**  
County Council  
Improving life for local people

**IAN W. STEPHENSON** BSc., CEng, MICE, MIHT  
Strategic Director of Environmental Services

DRAWING TITLE	
Tile Ref: BW96	
SCALE	1 : 1250
DATE	02/09/2013
DRAWING No.	2
DRAWN BY	