

**DATED 28 JULY 2011**

**THE DERBYSHIRE COUNTY COUNCIL**

**ROAD TRAFFIC REGULATION ACT 1984**

**THE DERBYSHIRE COUNTY COUNCIL**

**(VARIOUS STREETS, CHESTERFIELD)**

**(PROHIBITION OF WAITING) ORDER 2011**

**J McELVANEY**

**MATLOCK**

**Z2903**

**THE DERBYSHIRE COUNTY COUNCIL**  
**ROAD TRAFFIC REGULATION ACT 1984**  
**(VARIOUS STREETS, CHESTERFIELD)**  
**(PROHIBITION OF WAITING) ORDER 2011**

The Derbyshire County Council in exercise of its powers under Sections 1, 2 and 4 of the Road Traffic Regulation Act 1984 (as amended) ("the Act") and of all other enabling powers, after consultation with the Chief Officer of Police in accordance with Part III of Schedule 9 to the Act hereby makes the following Order:-

**1 CITATION**

This Order shall come into operation on the Eighth day of August Two Thousand and Eleven and may be cited as "The Derbyshire County Council (Various Streets, Chesterfield) (Prohibition of Waiting) Order 2011".

**2 INTERPRETATION**

In this Order:-

2.1 "Motor Vehicle" means any mechanically propelled vehicle intended or adapted for use on roads.

2.2 "Cycle" means a bicycle, tricycle or a cycle having four or more wheels, not being in any case a Motor Vehicle.

2.3 "Vehicle" for the purposes of this Order means a "Motor Vehicle" or "Cycle".

2.4 "Public Service Vehicle" has the meaning ascribed to it by Section 1 of the Public Passenger Vehicles Act 1981, that is to say it shall mean a motor Vehicle (other than a tramcar) which –

(i) being a Vehicle adapted to carry more than eight passengers, is used for carrying passengers for hire or reward; or

(ii) being a Vehicle not so adapted, is used for carrying passengers for hire or reward at separate fares in the course of a business of carrying passengers.

2.5 "Disabled Person's Badge" has the same meaning as in the Disabled Persons (Exemptions for Disabled Persons) (England) Regulations 2000.

2.6 "Disabled Person's Vehicle" means a Vehicle displaying a Disabled Person's Badge in the relevant position as set out under Regulation 4 of the Local Authorities Orders (Exemptions for Disabled Persons) (England) Regulations 2000.

2.7 "The 2004 Act" means Traffic Management Act 2004.

2.8 "CEO" means Civil Enforcement Officer and has the same meaning as in Section 76 of the 2004 Act.

2.9 "Goods" means goods or burden of any description

2.10 "Loading and Unloading" means the transference, from or to a Vehicle, to or from premises, of Goods.

### **3 WAITING RESTRICTIONS**

3.1 Save as provided in articles 4, 5 and 6 of this Order no person shall except upon the direction or with the permission of a Police Constable in uniform, or a CEO, cause or permit any Vehicle to wait at any time on any day on the length of road specified in the Schedule to this Order.

### **4 GENERAL EXEMPTIONS**

4.1 Nothing in Article 3 shall render it unlawful to cause or permit any Vehicle to wait in the lengths of road referred to therein for so long as may be necessary to enable:-

- (i) a person to board or alight from the Vehicle;
- (ii) the Vehicle, if it cannot conveniently be used for such purpose in any other road, to be used in connection with any of the following operations namely:-
  - (a) building, industrial or demolition operations;
  - (b) the removal of any obstruction to traffic;
  - (c) the maintenance, improvement or reconstruction of the said lengths of road; or
  - (d) the laying, erection, alteration or repair in, or on land adjacent to the said lengths of road of any sewer or of any main, pipe or apparatus for the supply of gas, water or electricity or of any telecommunication apparatus as defined in the Telecommunications Act 1984;
- (iii) the Vehicle, if it cannot conveniently be used for such purpose in any other road, to be used in the service of a local authority or a water authority in pursuance of statutory powers or duties;
- (iv) the Vehicle to be used for the purpose of delivering or collecting postal packets as defined in The Postal Services Act 2000;
- (v) the Vehicle to take in petrol, oil, water or air from any garage situated on or adjacent to the said lengths of road;
- (vi) the Vehicle to wait at or near to any premises situated on or adjacent to the said lengths of road for so long as such waiting by that Vehicle is reasonably necessary in connection with any wedding or funeral;
- (vii) the Vehicle to be used for fire brigade, ambulance or police purposes; or
- (viii) Goods to be Loaded or Unloaded from the Vehicle.

## **5 DISABLED PERSONS' EXEMPTIONS**

5.1 Nothing in Article 3.1 shall render it unlawful to cause or permit a Disabled Person's Vehicle which displays in the relevant position a Disabled Person's Badge, and a parking disc (on which the driver, or other person in charge of the Vehicle, has marked the time at which the period of waiting began) to wait in the lengths of road referred to in that Article for a period not exceeding three hours (not being a period separated by an interval of less than one hour from a previous period of waiting by the same Vehicle in the same length or on the same side of road on the same day).

5.2 A Vehicle displays a Disabled Person's Badge in the relevant position if:-

(i) in the case of a Vehicle fitted with a front windscreen, the badge is exhibited thereon on the near side of and immediately behind the windscreen and with its front facing forward so as to be legible from outside the Vehicle; or

(ii) in the case of a Vehicle not fitted with a front windscreen, the badge is exhibited in a conspicuous position on the Vehicle.

5.3 A Vehicle displays a Disabled Person's Badge in the relevant position if:-

(i) in the case of a Vehicle fitted with a dashboard or fascia panel, the badge is exhibited thereon so that Part I of the badge is legible from outside the Vehicle; or

(ii) in the case of a Vehicle not fitted with a dashboard or fascia panel, the badge is exhibited in a conspicuous position on the Vehicle so that Part I of the badge is legible from outside the Vehicle.

5.4 A Vehicle displays a parking disc in the relevant position if:-

(i) in the case of a Vehicle fitted with a dashboard or fascia panel, the disc is exhibited thereon so that the quarter-hour period during which the period of waiting began is legible from outside the Vehicle; or

(ii) in the case of a Vehicle not so fitted, the disc is exhibited in a conspicuous position on the Vehicle so that the quarter-hour period during which the period of waiting began is legible from outside the Vehicle".

## **6 PUBLIC SERVICE VEHICLES**

6.1 Nothing in Article 3 shall apply to a Public Service Vehicle.

## **7 EFFECT OF ORDER**

7.1 The prohibitions and restrictions imposed by this Order shall be in addition to and not in derogation from any restrictions or requirements imposed by any regulations made or having effect as if made under the Act of 1984 or by or under any other enactment.



## **8 REVOCATIONS OF PREVIOUS ORDERS**

8.1 Any permanent Traffic Regulation Orders made prior to this Order, insofar as they relate to the lengths of road listed below, insofar as they relate to the prohibitions and restrictions listed below, are hereby revoked.

### **SCHEDULE**

#### **NO WAITING AT ANY TIME**

##### **Chantrey Avenue**

###### **Both sides**

From its junction with Highfield Lane in a southerly direction for a distance of 15 metres.

###### **South eastern side**

From a point 15 metres north west of its junction with Whitworth Road to a point 15 metres south east of its junction with Whitworth Road.

From a point 13 metres north west of its junction with Flamsteed Crescent to a point 12 metres south east of its junction with Flamsteed Crescent.

###### **North western side**

From a point 15 metres south east of its junction with Outram Road to a point 13 metres north west of its junction with Outram Road.

From a point 10 metres north west of its junction with Malson Way to a point 10 metres south east of its junction with Malson Way.

##### **Douglas Road**

###### **West side**

From a point 10 metres south of its junction with Muirfield Close to a point 34 metres north east of its junction with Muirfield Close

###### **East side**

From a point 1 metres north of the southern kerb line of its junction with Muirfield Close in a northerly direction for a distance of 40 metres.

##### **Elm Lodge Farm Close**

###### **Both sides**

From its junction with Stand Road in a southerly direction for a distance of 9 metres.

### **Flamsteed Crescent**

#### **Both sides**

From its junction with Chantrey Avenue in a north easterly direction for a distance of 11 metres.

### **Greenside Avenue**

#### **Both sides**

From its junction with Peveril Road in an easterly direction for a distance of 20 metres.

### **Hastings Close**

#### **West side**

From its junction with Newbold Road in a south westerly direction for a distance of 7 metres.

### **Highfield Lane**

#### **South side**

From a point 13 metres north east of its junction with Chantrey Avenue to a point 14 metres south west of its junction with Chantrey Avenue.

From a point 21 metres east of its junction with Newbold Road for a distance of 20 metres.

#### **North side**

From its junction with Newbold Road in an easterly direction for a distance of 21 metres.

#### **Both sides**

From its junction with Peveril Road in a westerly direction for a distance of 25 metres.

### **Lockoford Lane**

#### **Both sides**

From its junction with the Lockoford Lane Roundabout in a north easterly direction for a distance of 51 metres.

#### **North side**

From a point 154 metres east of its junction with the Lockoford Lane Roundabout in an easterly direction for a distance of 68 metres.

#### South side

From a point 157 metres east of its junction with the Lockoford Lane Roundabout in an easterly direction for a distance of 23 metres.

#### **Malson Way**

##### Both sides

From its junction with Chantrey Avenue in a south westerly direction for a distance of 10 metres.

#### **Muirfield Close**

##### Both sides

From its junction with Lockoford Lane in a westerly direction for a distance of 10 metres.

#### **Nelson Street**

##### North side

From its junction with Peveril Road in an easterly direction for a distance of 6 metres.

##### South side

From its junction with Peveril Road in an easterly direction for a distance of 10 metres.

##### South west side

From its junction with Sheffield Road in a south westerly direction for a distance of 10 metres.

##### North east side

From its junction with Sheffield Road in a south westerly direction for a distance of 12 metres.

---

#### **Newbold Road**

##### North west side

From its junction with Hastings Close in a north westerly direction for a distance of 27 metres.

##### South east side

From its junction with Highfield Lane in a northerly direction for a distance of 15 metres.

### **Occupation Road**

#### **Both sides**

From its junction with Stand Road in a northerly direction for a distance of 14 metres.

### **Outram Road**

#### **Both sides**

From its junction with Chantrey Avenue in a southerly direction for a distance of 12 metres.

### **Park Lane**

#### **Both sides**

From its junction with Peveril Road in a southerly direction for a distance of 28 metres.

### **Peveril Road**

#### **East Side**

From its junction with Park Lane in a south westerly direction for a distance of 30 metres.

From its junction with Park Lane in a northerly direction for a distance of 18 metres.

From its junction with Stand Road in a southerly direction for a distance of 42 metres.

#### **(East side of road to east of triangular island)**

From its junction with Stand Road in a south westerly direction for a distance of 17 metres.

From a point 36 metres south west of its junction with Stand Road in a south westerly direction for a distance of 24 metres.

#### **(West side of road to east of triangular island)**

From its junction with Stand Road in a south westerly direction for a distance of 13 metres.

From a point 33 metres south west of its junction with Stand Road in a south westerly direction for a distance of 11 metres.

#### **West side**

From its junction with Stand Road in a southerly direction for a distance of 52 metres.

#### North west side

From its junction with Sheffield Road in a north westerly direction for a distance of 97 metres.

From a point 30 metres south of its junction with Highfield Lane to a point 97 metres north of its junction with Highfield Lane

#### South east side

From a point 37 metres north of its junction with Greenside Avenue to a point 95 metres south of its junction with Greenside Avenue

From its junction with Sheffield Road in a north westerly direction to a point 24 metres north west of its junction with Sanforth Street

#### **Peveril Road (Service Road)**

##### Both sides

From its junction with Greenside Avenue in a southerly direction for a distance of 8 metres.

#### **Sanforth Street**

##### Both sides

From its junction with Sheffield Road in a south westerly direction for a distance of 10 metres.

From its junction with Peveril Road in an easterly direction for a distance of 12 metres.

#### **Stand Road**

##### Both sides

From its junction with Occupation Road in an easterly direction for a distance of 12 metres.

---

#### **South side**

From a point 206 metres west of its junction with Sheffield Road in a westerly direction for a distance of 153 metres.

From its junction with Peveril Road in an easterly direction for a distance of 29 metres.

From its junction with Peveril Road in a westerly direction for a distance of 15 metres.

From a point 16 metres east of its junction with Elm Lodge Farm Close to a point 10 metres west of its junction with Elm Lodge Farm Close.

North side

From its junction with Occupation Road in a westerly direction for a distance of 5 metres.

**Tapton Lock Hill**

North side

From its junction with Meltham Lane in an easterly direction for a distance of 46 metres.

From a point 116 metres east of its junction with Meltham Lane in a southerly direction for a distance of 112 metres.

South side

From its junction with Meltham Lane in an easterly direction for a distance of 143 metres.

From a point 219 metres east of its junction with Meltham Lane in a southerly direction for a distance of 26 metres.

**Whitworth Road**

Both sides

From its junction with Chantrey Avenue in a north easterly direction for a distance of 15 metres.

As shown for illustration purposes only on the attached plan.

THE COMMON SEAL of the Derbyshire )  
County Council was hereunto affixed )  
the Twenty-eighth day of July Two )  
Thousand and Eleven in the presence of:-)

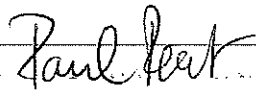



Director of Legal Services

Number in Seal  
Book - 2011/801

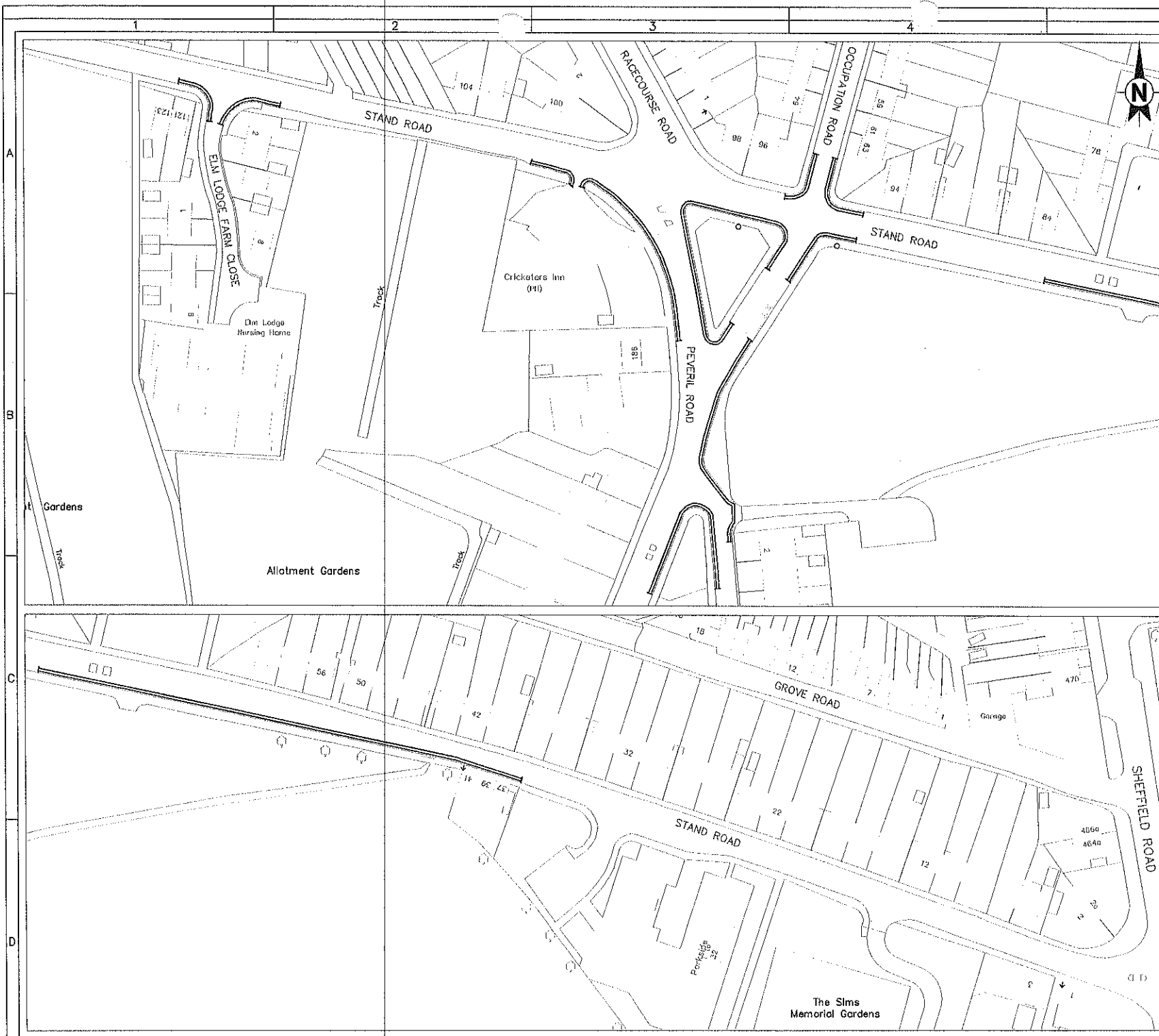

Reproduced from the Ordnance Survey mapping with the permission of the controller of Her Majesty's Stationary Office. © Crown Copyright. Unauthorised reproduction infringes Crown Copyright and may lead to prosecution or civil proceedings. 100026261 2010.

## KEY

**Proposed No Waiting  
at Any Time (Double  
Yellow Lines)**

**Existing lining to  
remain**

AMENDMENT DETAILS

By	Date	No.
Drawn by <b>S. MUIR</b>	Scale <b>NTS</b>	
Date <b>JULY 2011</b>		

ORIGINAL DRAWING SIZE 297 x 420 (A3)

**DERBYSHIRE  
COUNTY COUNCIL**

**IAN W STEPHENSON**  
BSc C.Eng M.I.C.E M.I.H.T.  
STRATEGIC DIRECTOR OF ENVIRONMENTAL SERVICES

PROJECT TITLE  
**AREA.1  
PROPOSED\_TRAFFIC  
REGULATION\_ORDERS**

DRAWING TITLE  
**STAND\_ROAD\_&  
PEVERIL\_ROAD  
CHESTERFIELD**

DRAWING No.  
**NTA/SM/151/11**



Reproduced from the Ordnance Survey mapping with the permission of the Controller of Her Majesty's Stationery Office. © Crown Copyright. Unauthorised reproduction infringes Crown Copyright and may lead to prosecution or civil proceedings. 100023261 2010.

## KEY

**Proposed No Waiting at Any Time (Double Yellow Lines)**

**Existing lining to remain**

AMENDMENT DETAILS By Date No.

DRAWN BY S. MUIR

SCALE

DATE JULY 2011

NTS

ORIGINAL DRAWING SIZE 297 x 420 (A3)

**DERBYSHIRE**  
COUNTY COUNCIL

IAN W STEPHENSON

BS: C.Eng M.I.C.E M.I.H.T

STRATEGIC DIRECTOR OF ENVIRONMENTAL SERVICES

PROJECT TITLE

AREA.3  
PROPOSED\_TRAFFIC  
REGULATION\_ORDER

DRAWING TITLE

VARIOUS\_STREETS  
STONEGRAVELS\_AREA  
CHESTERFIELD

DRAWING No.

NTA/SM/153/11



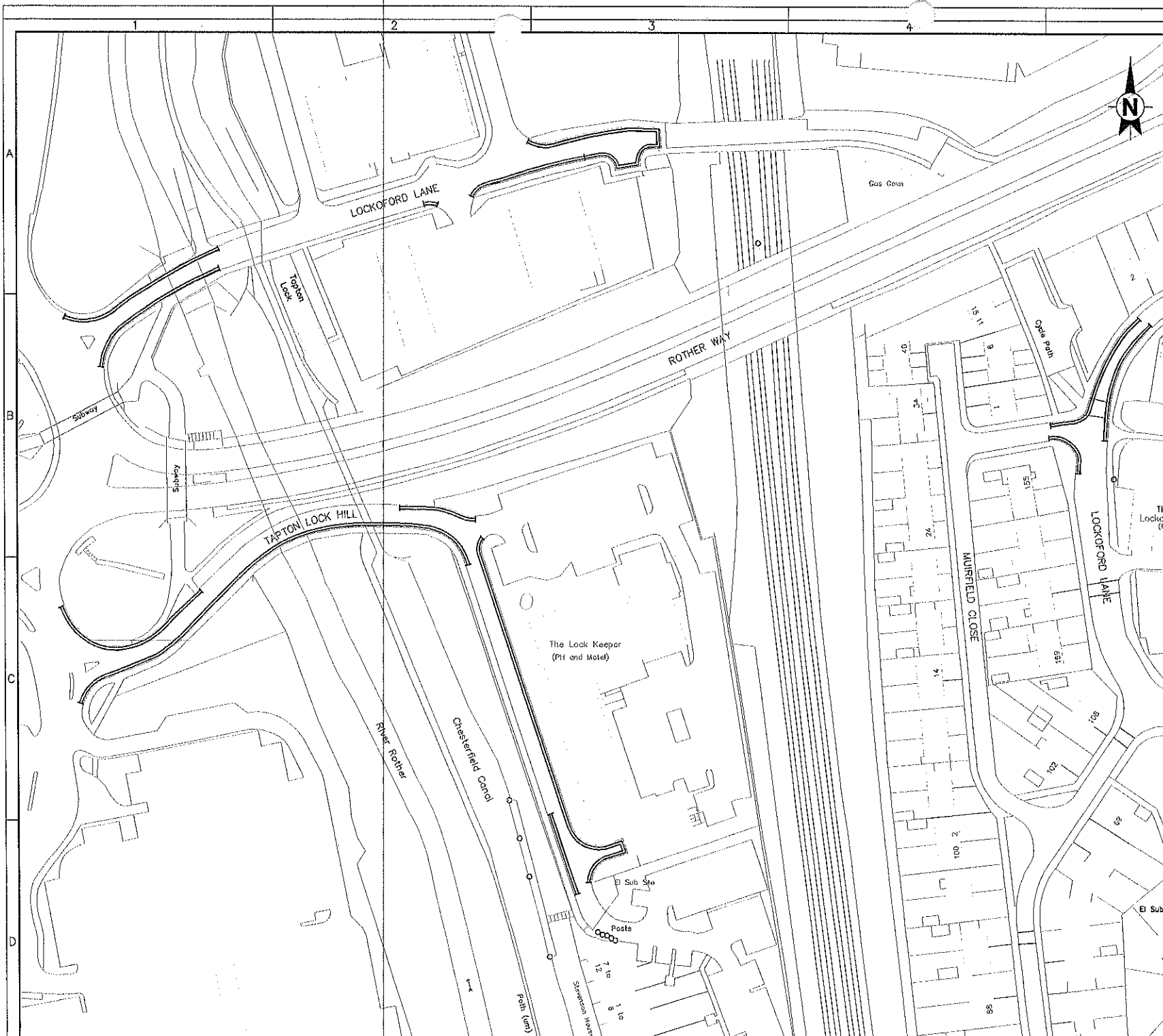

Reproduced from the Ordnance Survey mapping with the permission of the controller of Her Majesty's Stationary Office. © Crown Copyright. Unauthorised reproduction infringes Crown Copyright and may lead to prosecution or civil proceedings. 100025261 2010.

## KEY

Proposed No Waiting at Any Time (Double Yellow Lines)

Existing lining to remain

Existing lining to be removed

AMENDMENT DETAILS By Date No.

DRAWN BY S.MUIR SCALE

DATE JULY 2011 NTS

ORIGINAL DRAWING SIZE 297 x 420 (A3)



DERBYSHIRE  
COUNTY COUNCIL

IAN W STEPHENSON

BSc C.Eng M.I.C.E M.A.H.T

STRATEGIC DIRECTOR OF ENVIRONMENTAL SERVICES

PROJECT TITLE

AREA.4  
PROPOSED\_TRAFFIC  
REGULATION\_ORDER

DRAWING TITLE

LOCKOFORD\_&\_MUIRFIELD  
&\_TAPTON\_LOCK\_HILL  
CHESTERFIELD

DRAWING No.

NTA/SM/154/11

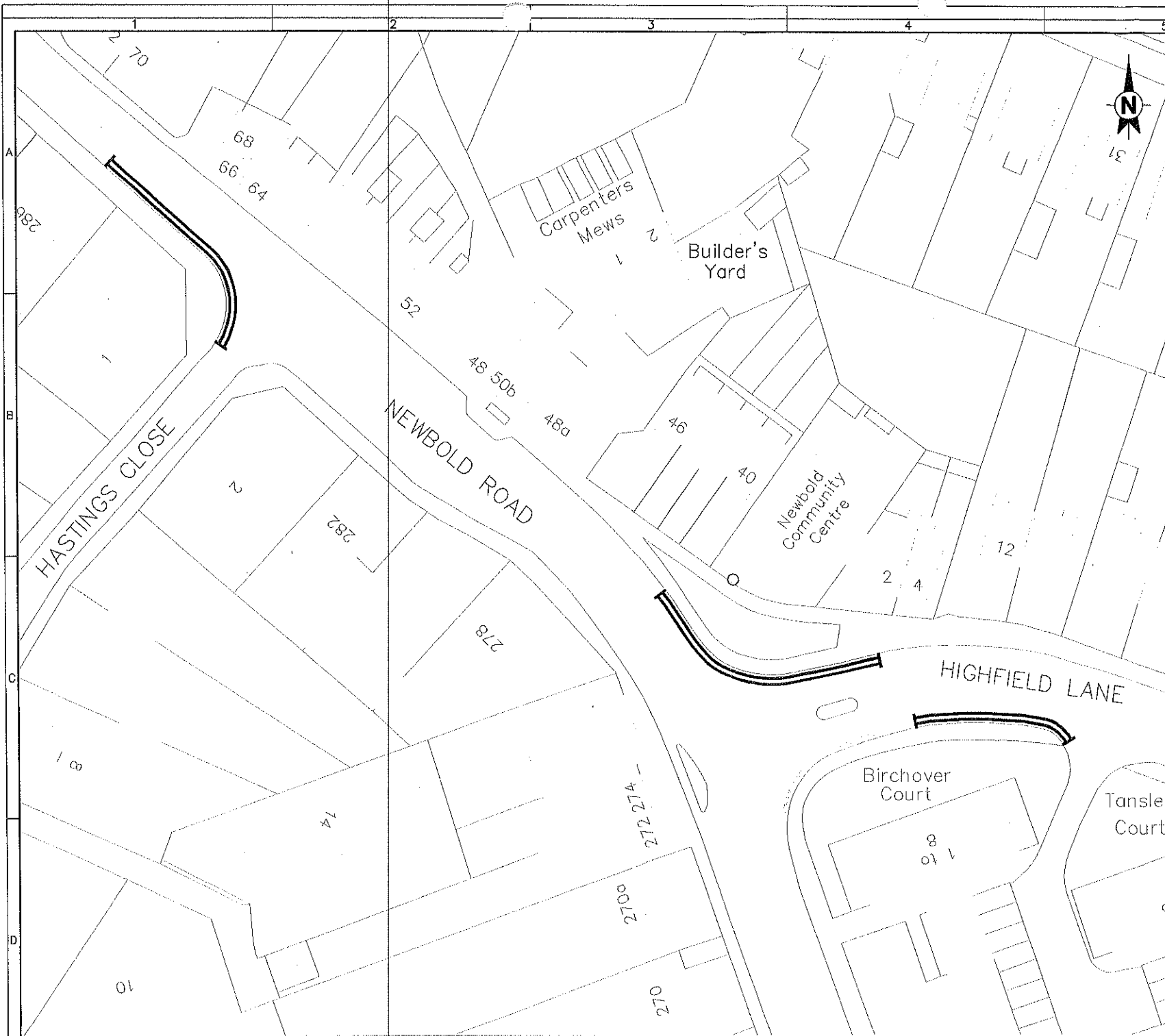

Reproduced from the Ordnance Survey mapping with the permission of the controller of Her Majesty's Stationery Office. © Crown Copyright. Unauthorised reproduction infringes Crown Copyright and may lead to prosecution or civil proceedings. 100023261 2010.

# KEY

Proposed No Waiting  
at Any Time (Double  
Yellow Lines)

Existing lining to  
remain

AMENDMENT DETAILS		By	Date	No.
DRAWN BY	S.MUIR	NTS		
DATE	JULY_2011			
ORIGINAL DRAWING SIZE 297 x 420 (A3)				

**D** DERBYSHIRE  
COUNTY COUNCIL  
IAN W STEPHENSON  
BSO C.Eng M.I.C.E M.I.H.T.  
STRATEGIC DIRECTOR OF ENVIRONMENTAL SERVICES

PROJECT TITLE  
AREA.2  
PROPOSED\_TRAFFIC  
REGULATION\_ORDER

DRAWING TITLE  
NEWBOLD\_ROAD\_&  
HIGHFIELD\_LANE  
CHESTERFIELD

DRAWING No.  
NTA/SM/152/11



Reproduced from the Ordnance Survey mapping with the permission of the Controller of Her Majesty's Stationery Office. © Crown Copyright. Unauthorised reproduction infringes Crown Copyright and may lead to prosecution or civil proceedings. 100023261 2010.

## KEY

**Proposed No Waiting at Any Time (Double Yellow Lines)**

**Existing lining to remain**

AMENDMENT DETAILS By Date No.

DRAWN BY S. MUIR

SCALE

DATE JULY 2011

NTS

ORIGINAL DRAWING SIZE 297 x 420 (A3)

**DERBYSHIRE**  
COUNTY COUNCIL

IAN W STEPHENSON

BS: C.Eng M.I.C.E M.I.H.T

STRATEGIC DIRECTOR OF ENVIRONMENTAL SERVICES

PROJECT TITLE

AREA.3  
PROPOSED\_TRAFFIC  
REGULATION\_ORDER

DRAWING TITLE

VARIOUS\_STREETS  
STONEGRAVELS\_AREA  
CHESTERFIELD

DRAWING No.

NTA/SM/153/11

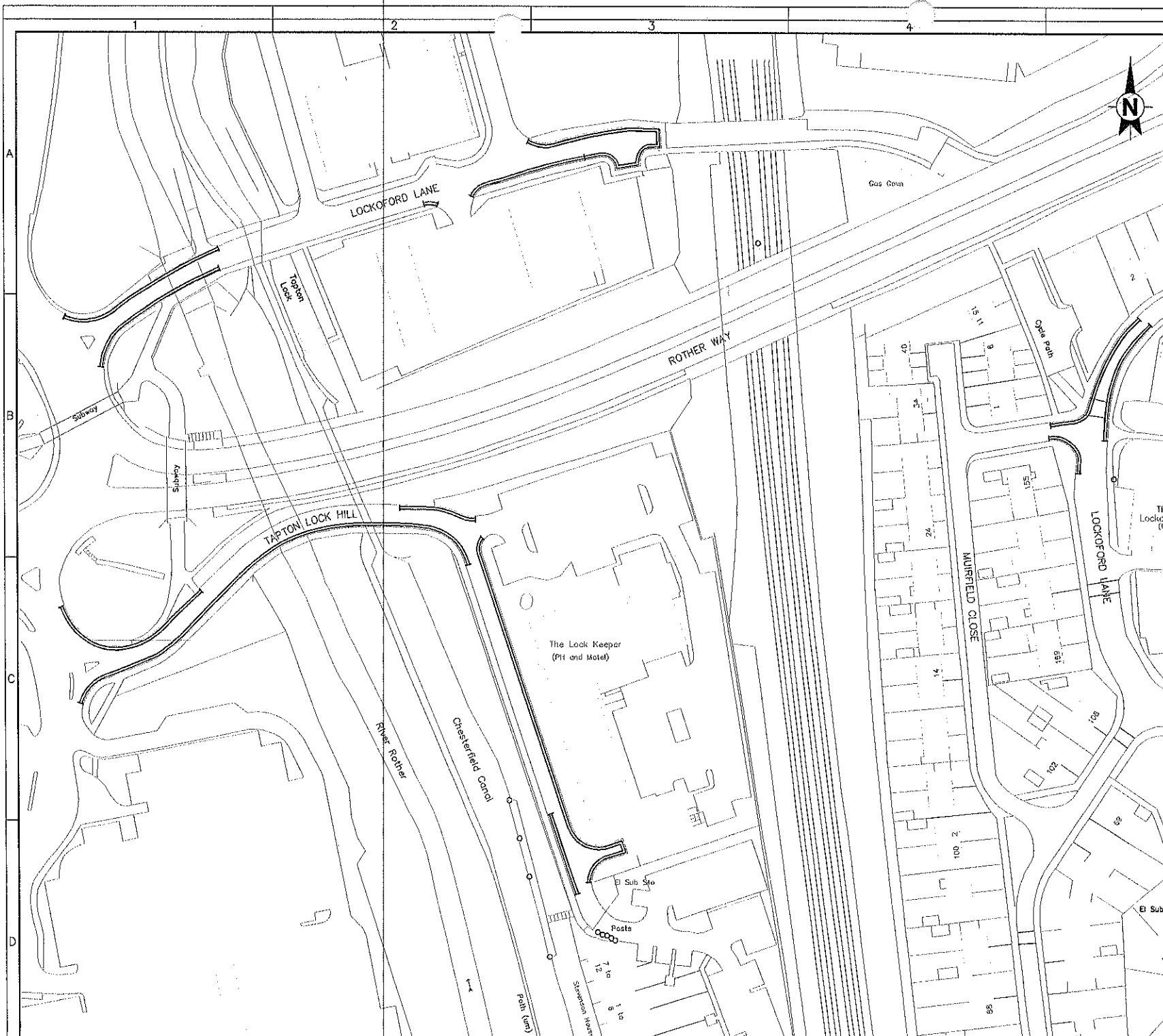

Reproduced from the Ordnance Survey mapping with the permission of the controller of Her Majesty's Stationary Office. © Crown Copyright. Unauthorised reproduction infringes Crown Copyright and may lead to prosecution or civil proceedings. 100025261 2010.

## KEY

Proposed No Waiting at Any Time (Double Yellow Lines)

Existing lining to remain

Existing lining to be removed

AMENDMENT DETAILS By Date No.

DRAWN BY S.MUIR SCALE

DATE JULY 2011 NTS

ORIGINAL DRAWING SIZE 297 x 420 (A3)



DERBYSHIRE  
COUNTY COUNCIL

IAN W STEPHENSON

BSc C.Eng M.I.C.E M.A.H.T

STRATEGIC DIRECTOR OF ENVIRONMENTAL SERVICES

PROJECT TITLE

AREA.4  
PROPOSED\_TRAFFIC  
REGULATION\_ORDER

DRAWING TITLE

LOCKOFORD\_&\_MUIRFIELD  
&\_TAPTON\_LOCK\_HILL  
CHESTERFIELD

DRAWING No.

NTA/SM/154/11

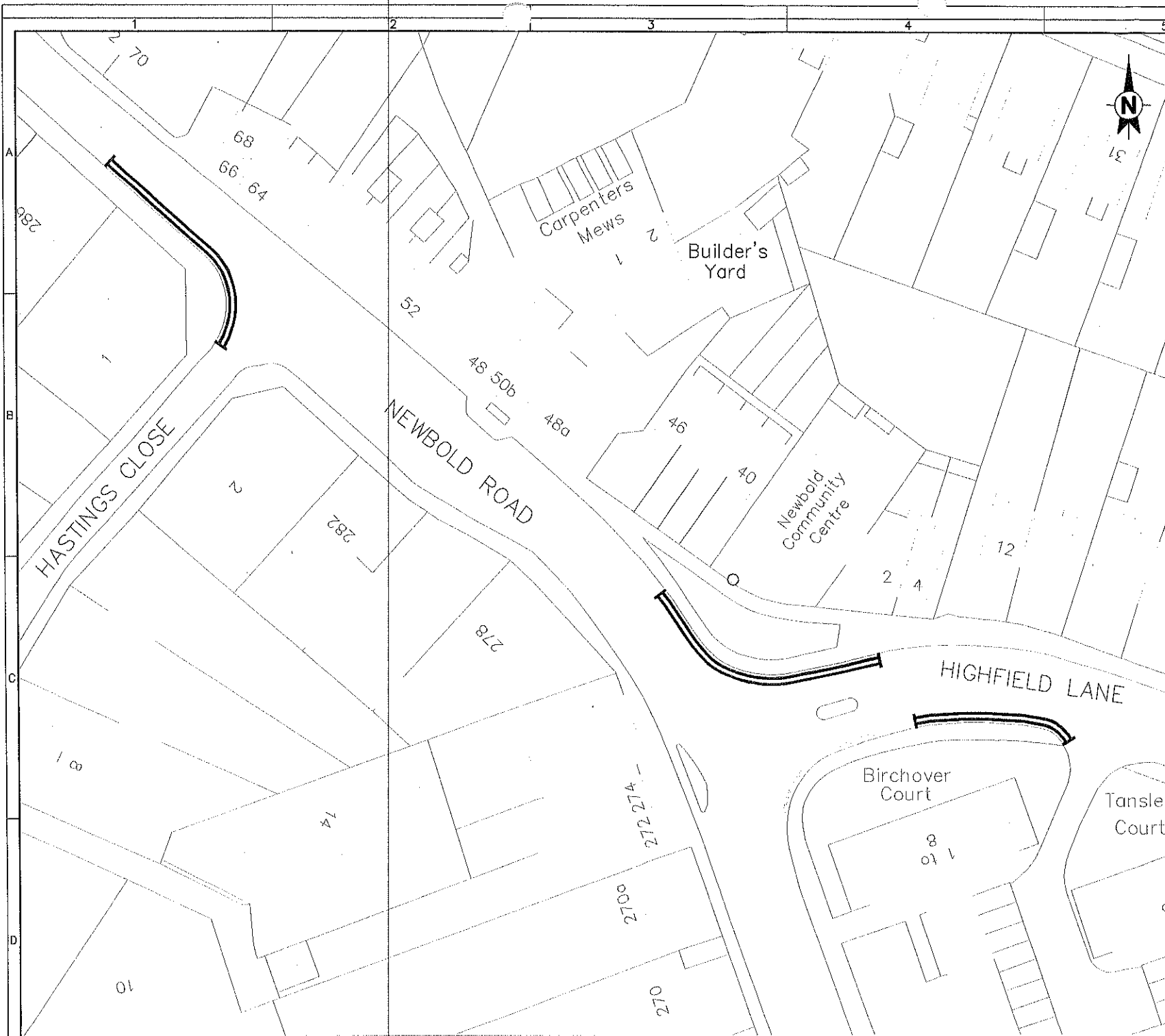

Reproduced from the Ordnance Survey mapping with the permission of the controller of Her Majesty's Stationery Office. © Crown Copyright. Unauthorised reproduction infringes Crown Copyright and may lead to prosecution or civil proceedings. 100023261 2010.

# KEY

**Proposed No Waiting at Any Time (Double Yellow Lines)**

**Existing lining to remain**

AMENDMENT DETAILS		By	Date	No.
DRAWN BY	S.MUIR	SCALE NTS		
DATE	JULY_2011			
ORIGINAL DRAWING SIZE 297 x 420 (A3)				

**DERBYSHIRE**  
COUNTY COUNCIL  
IAN W STEPHENSON  
BSO C.Eng M.I.C.E M.I.H.T.  
STRATEGIC DIRECTOR OF ENVIRONMENTAL SERVICES

PROJECT TITLE  
**AREA.2  
PROPOSED\_TRAFFIC  
REGULATION\_ORDER**

DRAWING TITLE  
**NEWBOLD\_ROAD\_&  
HIGHFIELD\_LANE  
CHESTERFIELD**

DRAWING No.  
**NTA/SM/152/11**





# Prohibition and Restriction of Waiting, On Street Parking and Clearways.

This map is reproduced from Ordnance Survey material with the permission of Ordnance Survey on behalf of the Controller of Her Majesty's Stationery Office (c) Crown Copyright. Unauthorised reproduction infringes Crown copyright and may lead to prosecution or civil proceedings.  
Derbyshire County Council  
Licence No: 100023251 2009

CONFIRMED

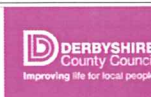

IAN W. STEPHENSON BSc., CEng, MICE, MIHT  
Strategic Director of Environmental Services

DRAWING TITLE

Tile Ref: CN100

SCALE 1 : 1250

DATE 08/08/2011

DRAWING No. 1

DRAWN BY

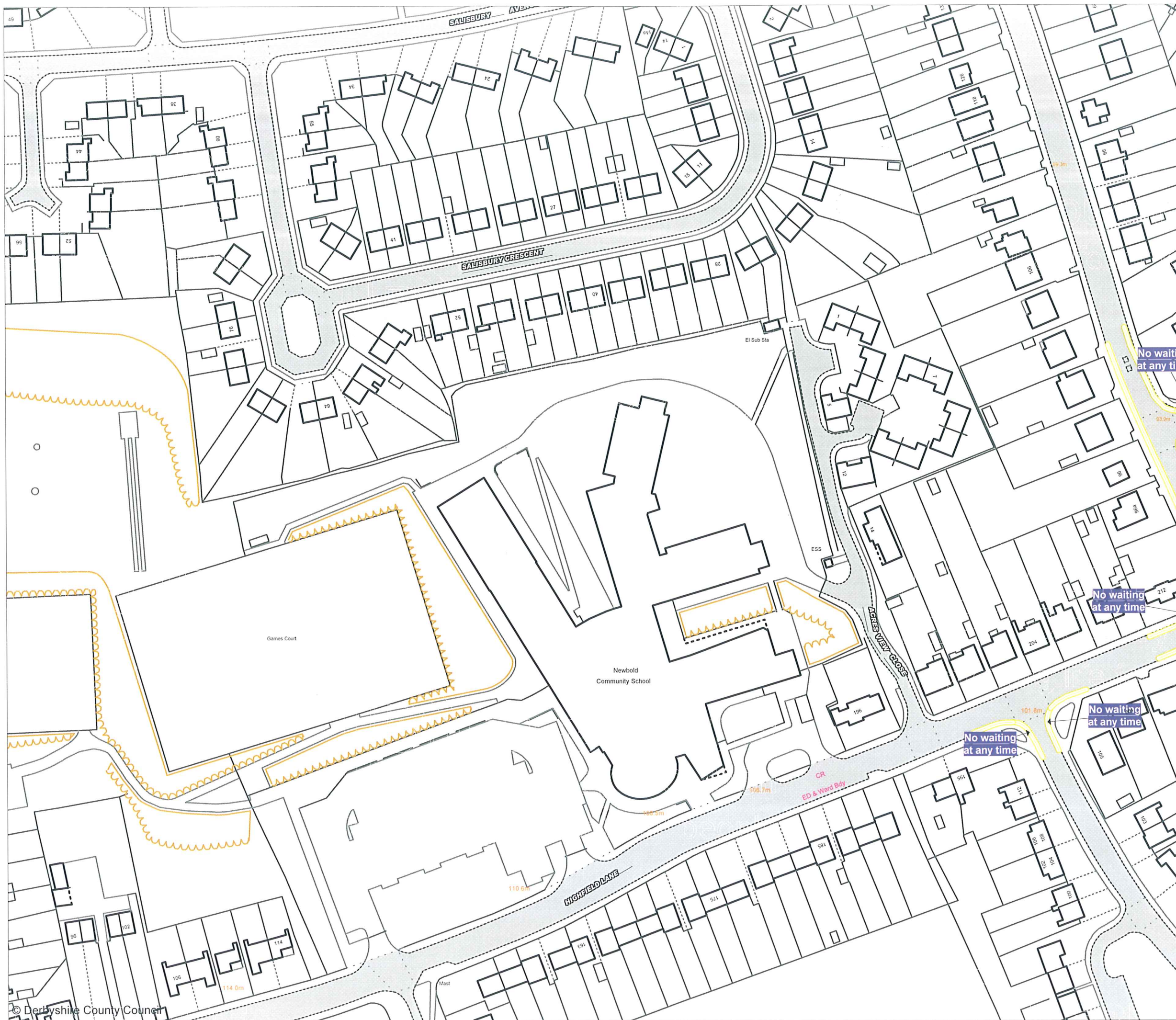

# Prohibition and Restriction of Waiting, On Street Parking and Clearways.

This map is reproduced from Ordnance Survey material with the permission of Ordnance Survey on behalf of the Controller of Her Majesty's Stationery Office (c) Crown Copyright. Unauthorised reproduction infringes Crown Copyright and may lead to prosecution or civil proceedings.  
Derbyshire County Council  
Licence No: 100023251 2009

CONFIRMED



IAN W. STEPHENSON BSc., CEng, MICE, MIHT  
Strategic Director of Environmental Services

DRAWING TITLE

Tile Ref: CN102

SCALE	1 : 1250
DATE	08/08/2011
DRAWING No.	1
DRAWN BY	



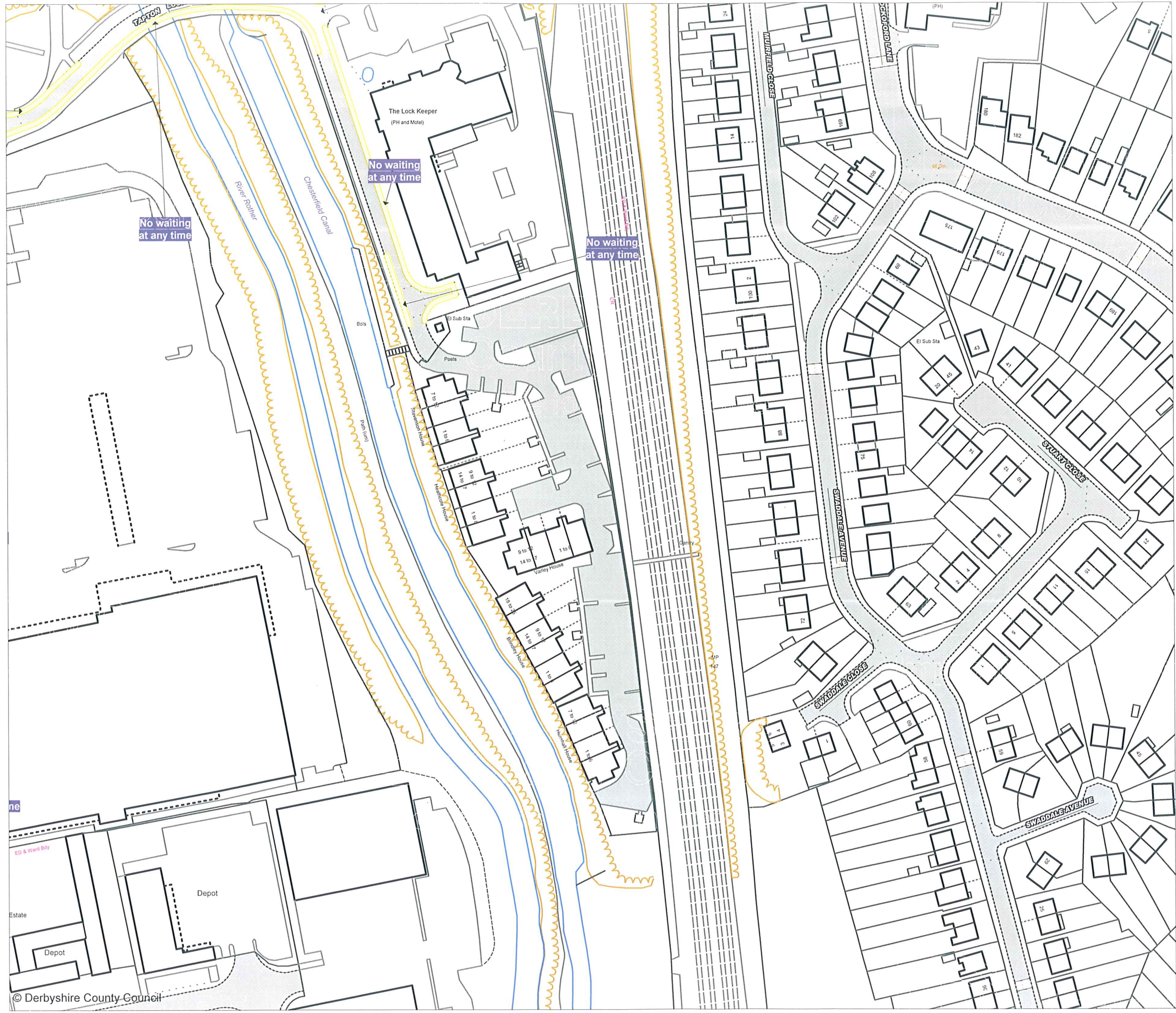

**Prohibition and Restriction  
of Waiting, On Street  
Parking and Clearways.**

This map is reproduced from Ordnance Survey material with the permission of Ordnance Survey on behalf of the Controller of Her Majesty's Stationary Office (c) Crown Copyright. Unauthorised reproduction infringes Crown copyright and may lead to prosecution or civil proceedings.  
Derbyshire County Council  
Licence No: 100023251 2009

CONFIRMED



IAN W. STEPHENSON BSc., CEng MICE MIHT  
Strategic Director of Environmental Services

DRAWING TITLE

Tile Ref: CO105

SCALE	1 : 1250
DATE	08/08/2011
DRAWING No.	1
DRAWN BY	



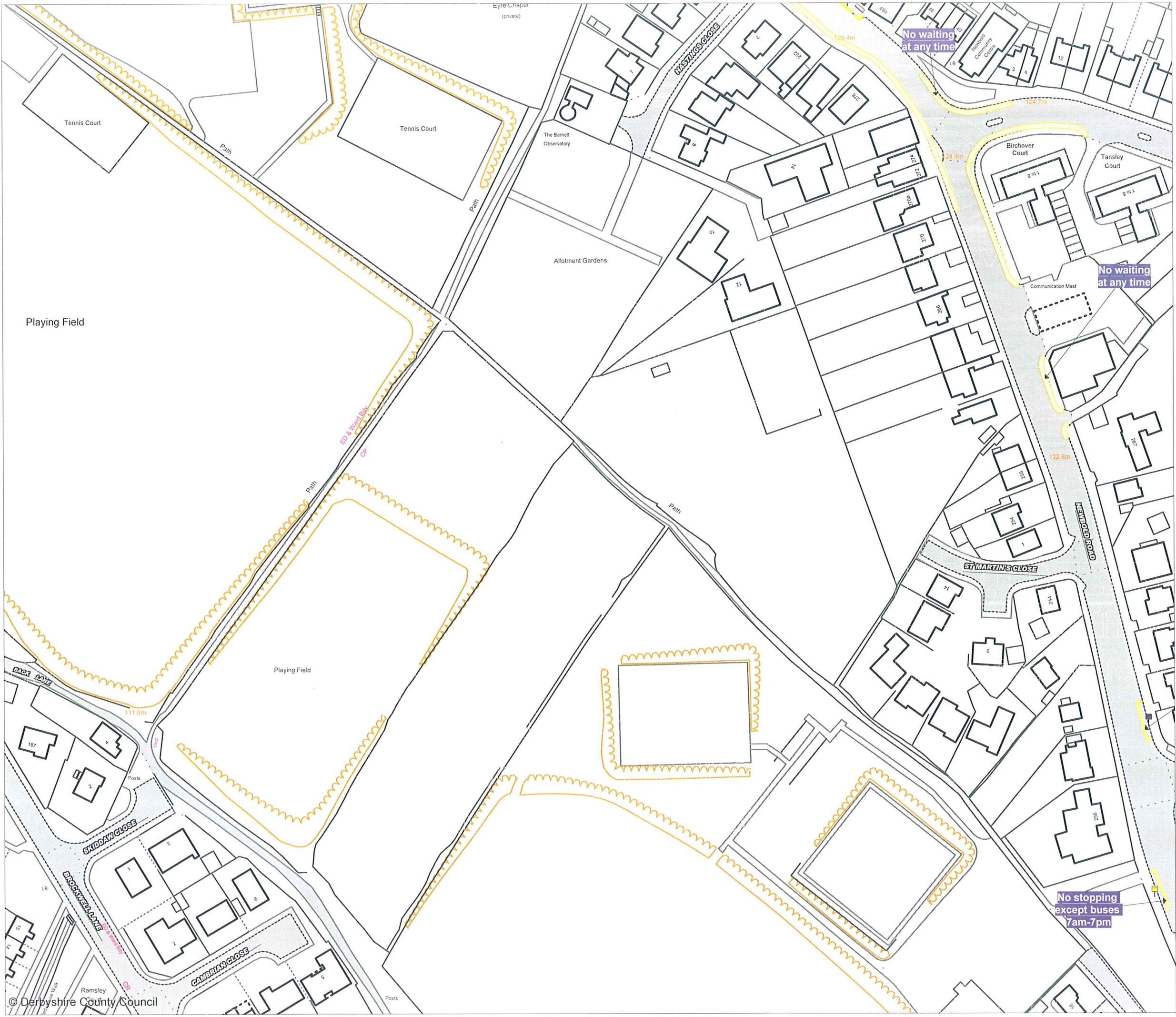

**Prohibition and Restriction  
of Waiting, On Street  
Parking and Clearways.**

This map is reproduced from Ordnance Survey material with the permission of Ordnance Survey on behalf of the Controller of Her Majesty's Stationary Office (c) Crown Copyright. Unauthorised reproduction infringes Crown copyright and may lead to prosecution or civil proceedings.  
Derbyshire County Council  
Licence No: 100023251 2009

CONFIRMED



IAN W.STEPHENSON BSc., CEng MICE MIHT  
Strategic Director of Environmental Services

DRAWING TITLE

Tile Ref: CO100

SCALE 1 : 1250

DATE 08/08/2011

DRAWING No. 1

DRAWN BY



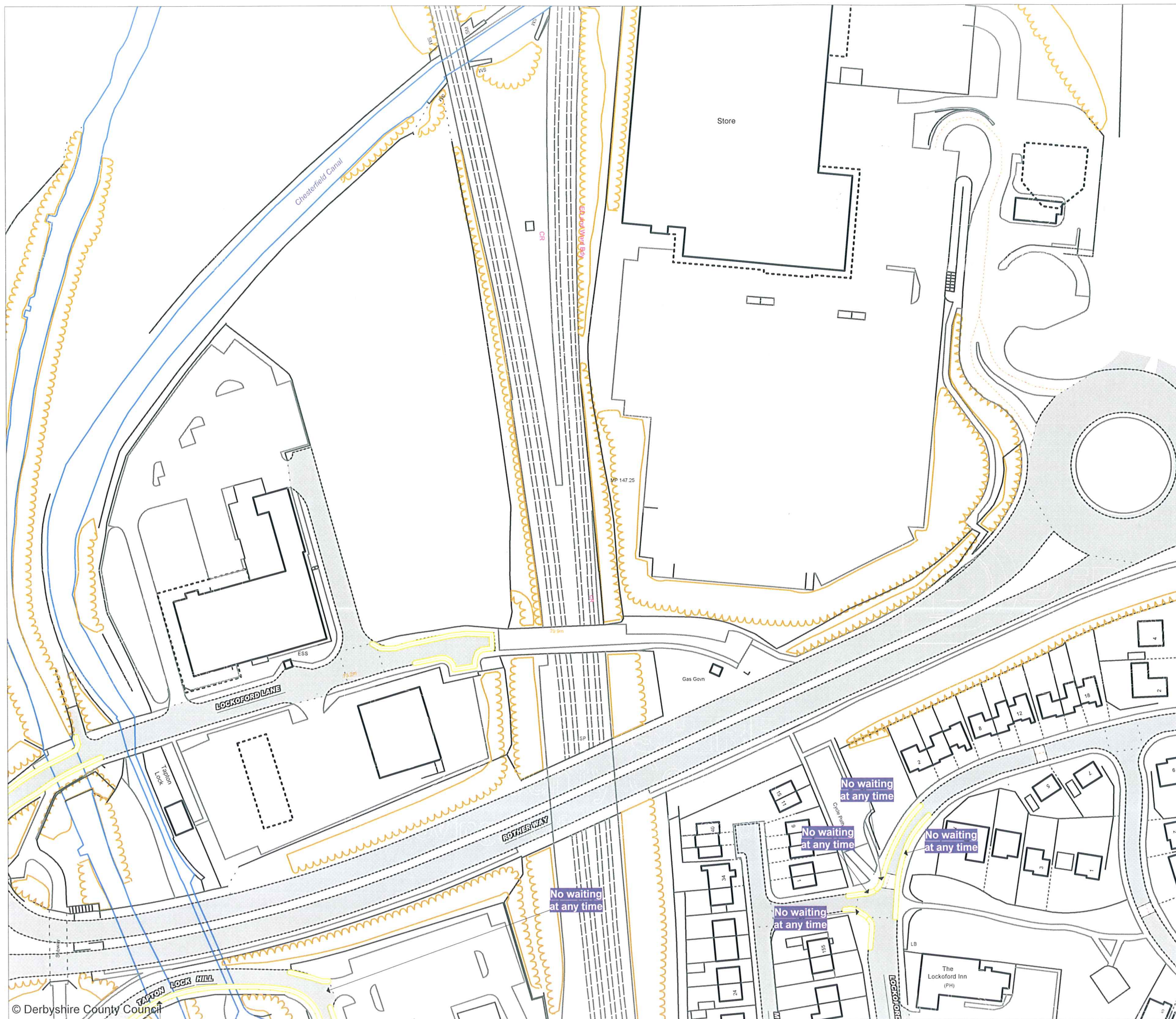

# Prohibition and Restriction of Waiting, On Street Parking and Clearways.

This map is reproduced from Ordnance Survey material with the permission of Ordnance Survey on behalf of the Controller of Her Majesty's Stationery Office (c) Crown Copyright. Unauthorised reproduction infringes Crown copyright and may lead to prosecution or civil proceedings.  
Derbyshire County Council  
Licence No: 100023251 2009

CONFIRMED



IAN W. STEPHENSON BSc., CEng, MICE, MIHT  
Strategic Director of Environmental Services

DRAWING TITLE

Tile Ref: CN105

SCALE 1 : 1250

DATE 08/08/2011

DRAWING No. 1

DRAWN BY



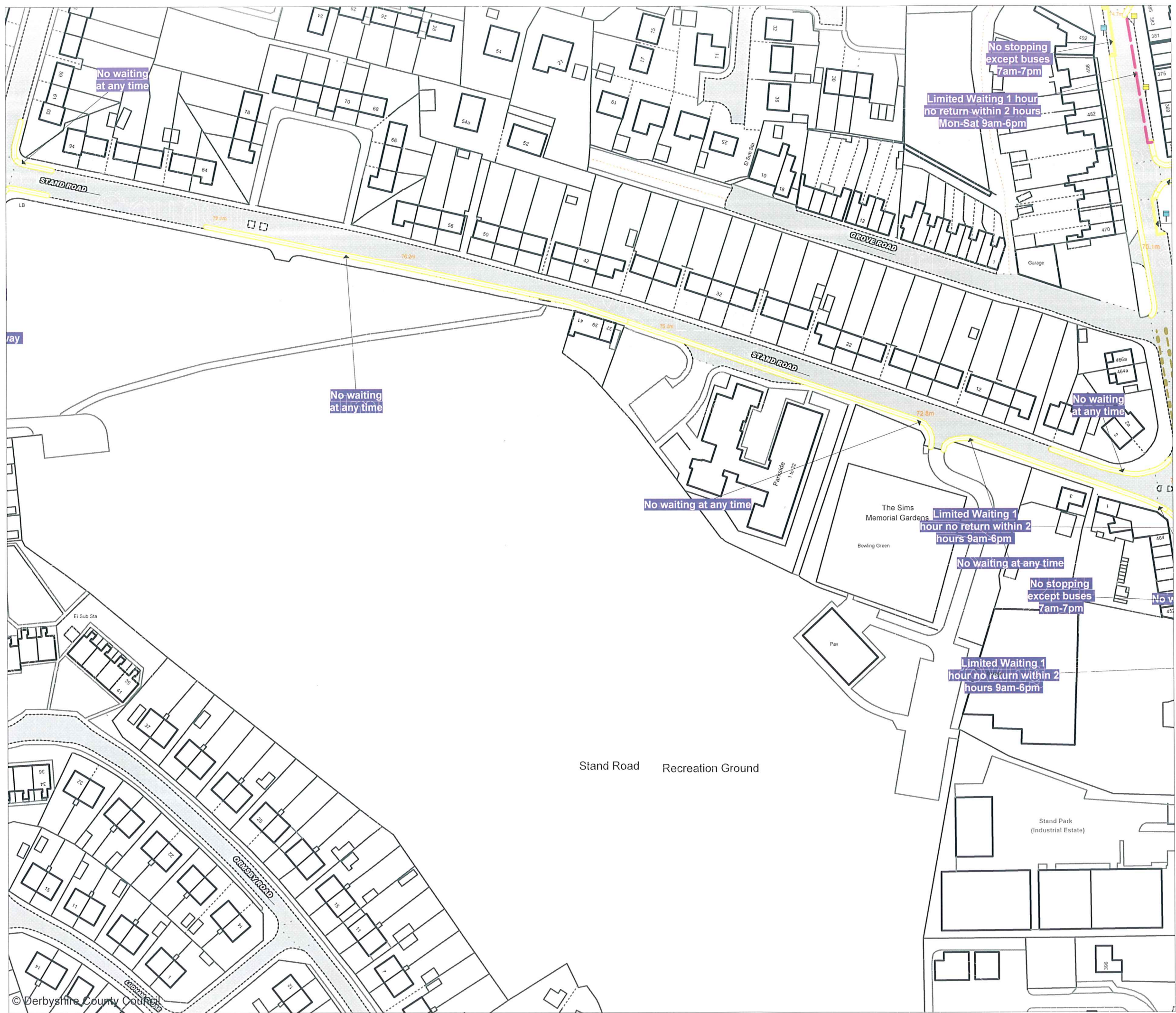

# Prohibition and Restriction of Waiting, On Street Parking and Clearways.

This map is reproduced from Ordnance Survey material with the permission of Ordnance Survey on behalf of the Controller of Her Majesty's Stationary Office (c) Crown Copyright. Unauthorised reproduction infringes Crown copyright and may lead to prosecution or civil proceedings.  
Derbyshire County Council  
Licence No: 100023251 2009

CONFIRMED



IAN W. STEPHENSON BSc., CEng, MICE, MIHT  
Strategic Director of Environmental Services

DRAWING TITLE

Tile Ref: CM103

SCALE	1 : 1250
DATE	08/08/2011
DRAWING No.	1
DRAWN BY	



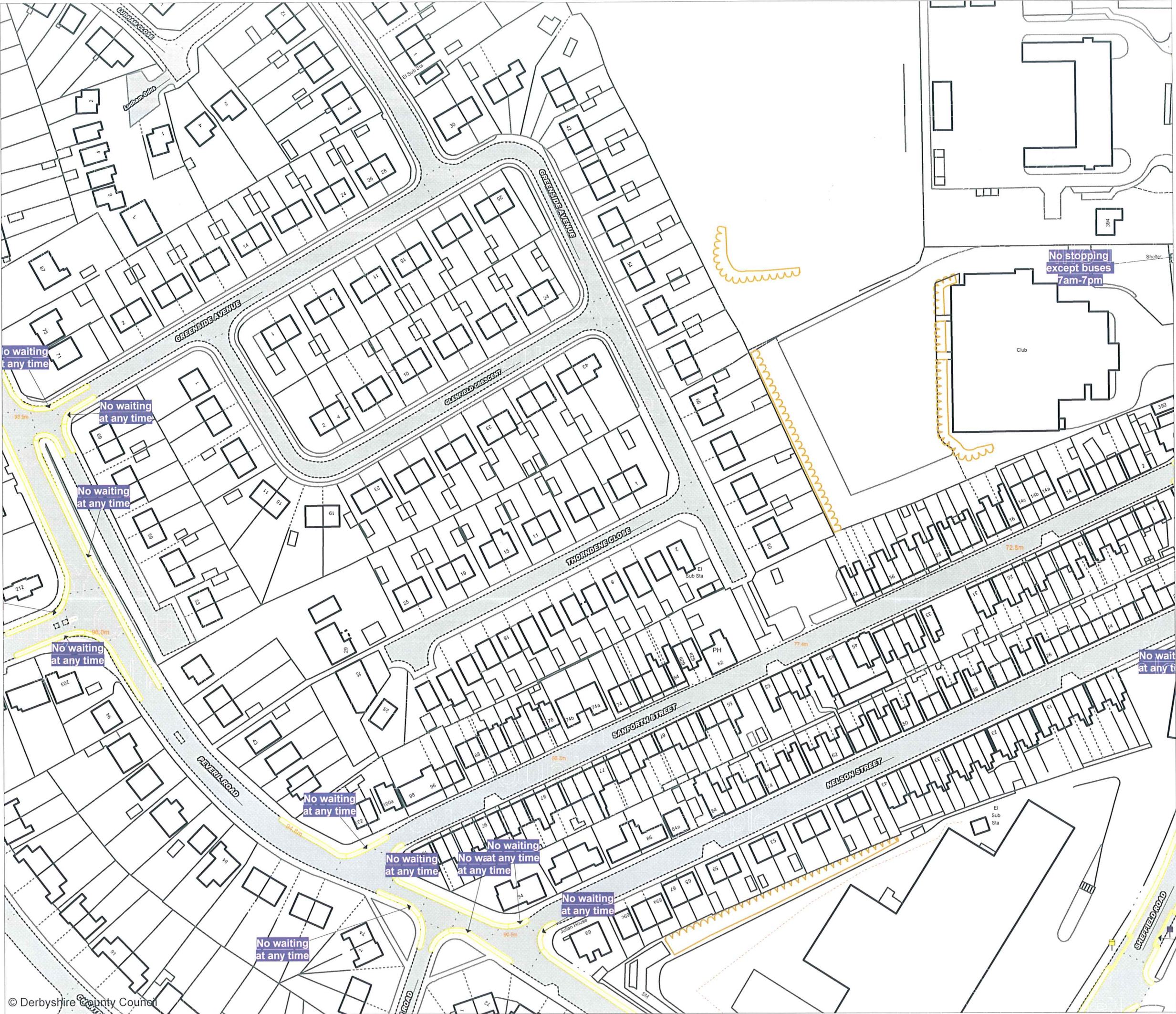

# Prohibition and Restriction of Waiting, On Street Parking and Clearways.

This map is reproduced from Ordnance Survey material with the permission of Ordnance Survey on behalf of the Controller of Her Majesty's Stationary Office (c) Crown Copyright. Unauthorised reproduction infringes Crown copyright and may lead to prosecution or civil proceedings.  
Derbyshire County Council  
Licence No: 100023251 2009

CONFIRMED



IAN W.STEPHENSON BSc., CEng, MICE, MIHT  
Strategic Director of Environmental Services

DRAWING TITLE

Tile Ref: CN103

SCALE	1 : 1250
DATE	08/08/2011
DRAWING No.	2
DRAWN BY	



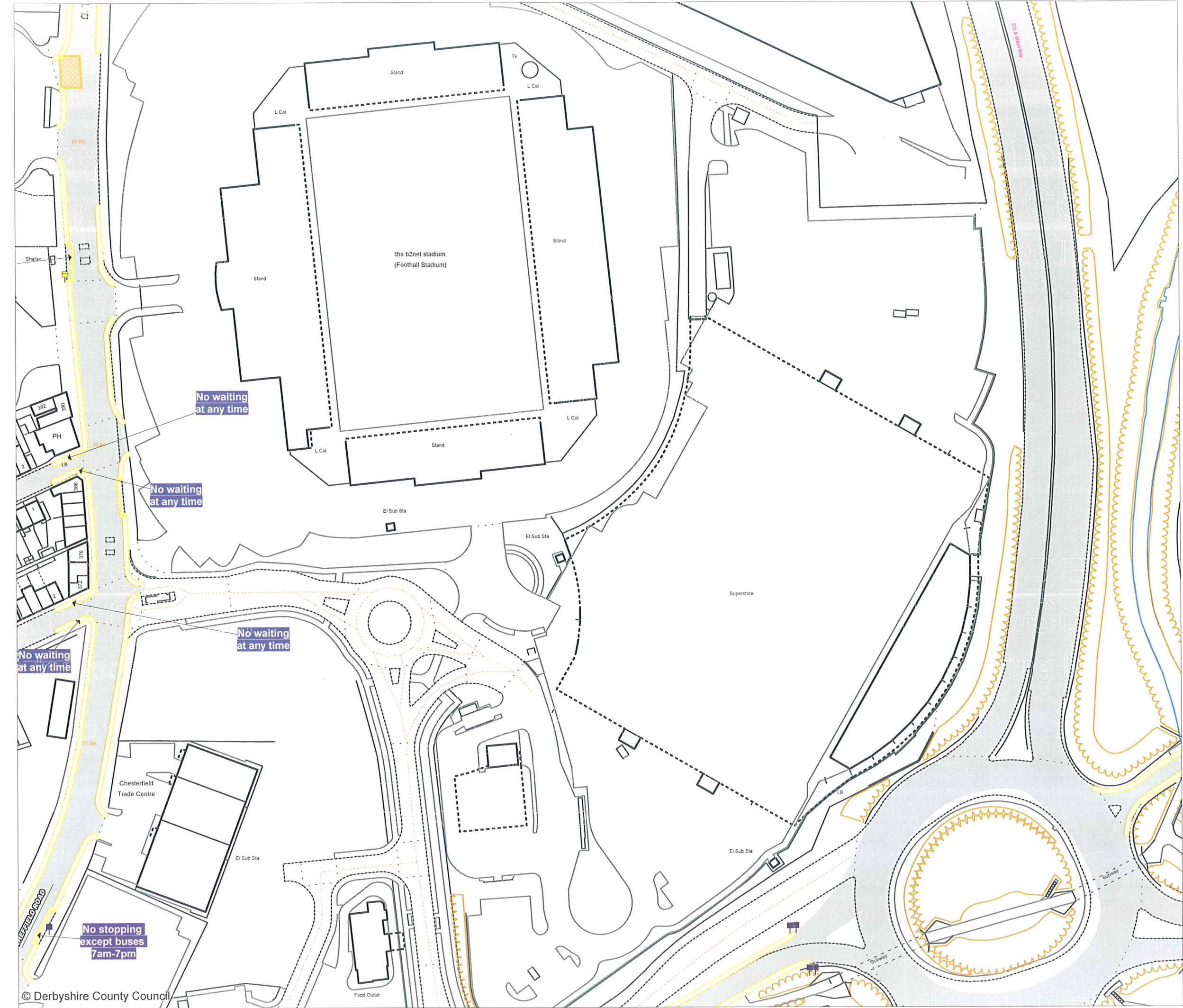

# Prohibition and Restriction of Waiting, On Street Parking and Clearways.

This map is reproduced from Ordnance Survey material with the permission of Ordnance Survey on behalf of the Controller of Her Majesty's Stationery Office (c) Crown Copyright. Unauthorised reproduction infringes Crown copyright and may lead to prosecution or civil proceedings. Derbyshire County Council Licence No: 100023251 2009

CONFIRMED



IAN W.STEPHENSON BSc., CEng, MICE, MIHT  
Strategic Director of Environmental Services

DRAWING TITLE

Tile Ref: CN104

SCALE 1 : 1250

DATE 08/08/2011

DRAWING No. 1

DRAWN BY





# Prohibition and Restriction of Waiting, On Street Parking and Clearways.

This map is reproduced from Ordnance Survey material with the permission of Ordnance Survey on behalf of the Controller of Her Majesty's Stationery Office (c) Crown Copyright. Unauthorised reproduction infringes Crown copyright and may lead to prosecution or civil proceedings.  
Derbyshire County Council  
Licence No: 100023251 2009

CONFIRMED



IAN W. STEPHENSON BSc., CEng, MICE, MIHT  
Strategic Director of Environmental Services

DRAWING TITLE

Tile Ref: CO104

SCALE	1 : 1250
DATE	08/08/2011
DRAWING No.	1
DRAWN BY	





# Prohibition and Restriction of Waiting, On Street Parking and Clearways.

This map is reproduced from Ordnance Survey material with the permission of Ordnance Survey on behalf of the Controller of Her Majesty's Stationery Office (c) Crown Copyright. Unauthorised reproduction infringes Crown copyright and may lead to prosecution or civil proceedings.  
Derbyshire County Council  
Licence No: 100023251 2009

CONFIRMED



IAN W. STEPHENSON BSc., CEng, MICE, MIHT  
Strategic Director of Environmental Services

DRAWING TITLE

Tile Ref: CO103

SCALE	1 : 1250
DATE	08/08/2011
DRAWING No.	1
DRAWN BY	



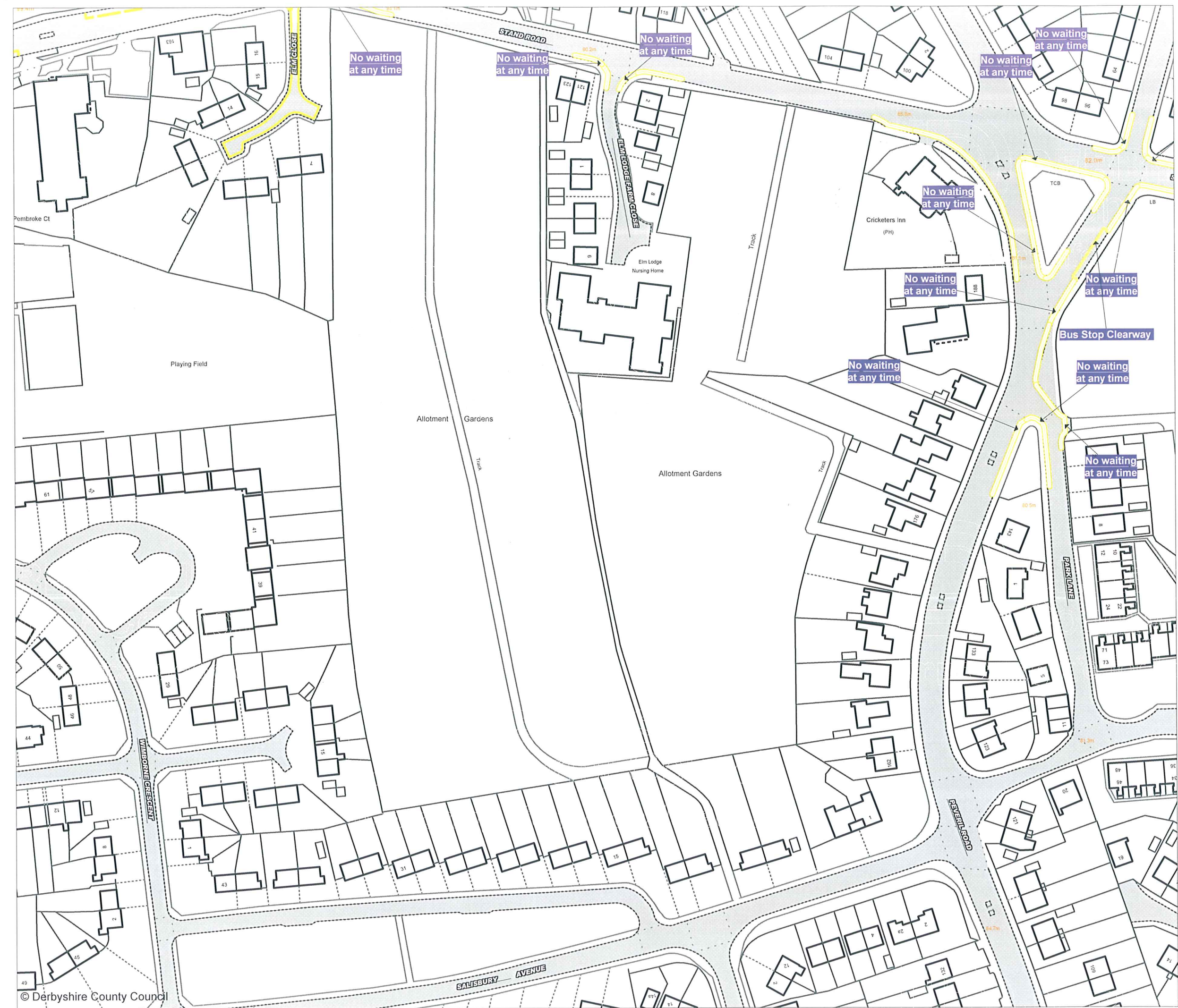

# Prohibition and Restriction of Waiting, On Street Parking and Clearways.

This map is reproduced from Ordnance Survey material with the permission of Ordnance Survey on behalf of the Controller of Her Majesty's Stationary Office (c) Crown Copyright. Unauthorised reproduction infringes Crown copyright and may lead to prosecution or civil proceedings.  
Derbyshire County Council  
Licence No: 100023251 2009

CONFIRMED



IAN W.STEPHENSON BSc., CEng, MICE, MIHT  
Strategic Director of Environmental Services

DRAWING TITLE

Tile Ref: CM102

SCALE 1 : 1250

DATE 08/08/2011

DRAWING No. 2

DRAWN BY