

<sup>1 Ref</sup>  
**DATED 09 JUNE 2010**

**THE DERBYSHIRE COUNTY COUNCIL**

**ROAD TRAFFIC REGULATION ACT 1984**

**THE DERBYSHIRE COUNTY COUNCIL**

**(BRACKEN CLOSE AND BRACKEN ROAD,  
LONG EATON)**

**(PROHIBITION OF WAITING AND PROHIBITION  
OF STOPPING ON SCHOOL KEEP CLEAR  
MARKINGS) ORDER 2011**

**J McELVANEY**

**MATLOCK**

**THE DERBYSHIRE COUNTY COUNCIL**  
**ROAD TRAFFIC REGULATION ACT 1984**  
**(BRACKEN CLOSE AND BRACKEN ROAD,**  
**LONG EATON)**  
**(PROHIBITION OF WAITING AND PROHIBITION**  
**OF STOPPING ON SCHOOL KEEP CLEAR**  
**MARKINGS) ORDER 2011**

The Derbyshire County Council in exercise of its powers under Sections 1, 2 and 4 of the Road Traffic Regulation Act 1984 ("the Act") and of all other enabling powers, after consultation with the Chief Officer of Police in accordance with Part III of Schedule 9 to the Act hereby makes the following Order:-

**1 CITATION AND COMMENCEMENT**

This Order shall come into operation on the Twentieth day of June Two thousand and Eleven and may be cited as "The Derbyshire County Council (Bracken Close and Bracken Road, Long Eaton) (Prohibition of Waiting and Prohibition of Stopping on School Keep Clear Markings) Order 2011".

**2 INTERPRETATION**

In this Order:-

2.1 "the County Council" means Derbyshire County Council.

2.2 "Carriageway" means a way constituting or comprised in a highway being a way (other than a cycle track) over which the public have a right of way for the passage of Vehicles, as in Section 329(1) of the Highways Act 1980.

2.3 "Pavement" means the remainder of the surfaced highway that is not constructed and used as Carriageway.

2.4 "Owner" in relation to a Vehicle, means the person by whom such Vehicle is kept and used.

2.5 "Vehicle" means any mechanically propelled Vehicle intended or adapted for use on roads.

2.6 "Public Service Vehicle" has the meaning ascribed to it by Section 1 of the Public Passenger Vehicles Act 1981, that is to say it shall mean a motor vehicle (other than a tramcar) which –

(i) being a Vehicle adapted to carry more than eight passengers, is used for carrying passengers for hire or reward; or

(ii) being a Vehicle not so adapted, is used for carrying passengers for hire or reward at separate fares in the course of a business or carrying passengers.

2.7 "Pedal Cycle" means a cycle (which has the same meaning as that ascribed to it in Section 192 of The Road Traffic Act 1988).

2.8 "Disabled Person's Badge" has the same meaning as in the Disabled Persons (Exemption for Disabled Persons) (England) Regulations 2000.

2.9 "Disabled Person's Vehicle" means a Vehicle displaying Disabled Persons Badge in the relevant position as set out under Regulation 4 of the Local Authorities Orders (Exemption for Disabled Persons) (England) Regulations 2000.

2.10 "CEO" means Civil Enforcement Officer and has the same meaning as in Section 76 of The 2004 Act

2.11 "The 2004 Act" means the Traffic Management Act 2004.

2.12 "Electronic Communications Apparatus", "Electronic Communications Network" and any "Electronic Communications Line" shall have the same meaning as in the Communications Act 2003.

### **3 SCHOOL KEEP CLEAR AND WAITING RESTRICTIONS**

3.1 Save as provided in Articles 4.1 and 4.2 of this Order, no Vehicle shall stop or wait on the School Keep Clear Markings indicated by road markings complying with diagram 1027.1 in Schedule 6 of the 2002 Regulations when it is used on conjunction with Traffic Sign diagram 642.2A in Schedule 2 of the 2002 Regulations, or permitted variants thereof, between the hours of 8am and 4pm, (Monday to Friday Only), on the lengths of road specified in Schedule 1 to this Order.

3.2 Save as provided in articles 4, 5 and 6 of this Order no person shall except upon the direction or with the permission of a Police Constable in uniform, or a CEO, cause or permit any Vehicle to wait between the hours of 8am and 9.15am and 2.45pm and 3.45pm (Monday to Friday only) on the lengths of road specified in Schedule 2 to this Order.

### **4 GENERAL EXEMPTIONS**

4.1 The controls specified in Article 3 do not apply in the respect of a Vehicle stopping or waiting;

a) if the person in control of the Vehicle is

- (i) required by law to stop or not to proceed;
- (ii) obliged to stop so as to avoid an accident;
- (iii) prevented from proceeding by circumstances beyond the person's control;

b) for so long as may be necessary to enable the Vehicle, if it cannot conveniently be used for such purpose in any other road, to be used

- (i) in connection with any building operation or demolition;
- (ii) in connection with the removal of any obstruction to traffic;

- (iii) opening or closing a gate or other barrier at the entrance to premises to which the Vehicle is being driven from or from which it has emerged if it is not reasonably practicable to cause the Vehicle to stop elsewhere for the purpose;
- (iv) using the Vehicle for fire brigade, ambulance or police purposes;
- (v) using the Vehicle in connection with the maintenance, improvement or reconstruction of the highway comprising or including the Carriageway;
- (vi) using the Vehicle in the service of a local authority or of a water company in pursuance of statutory duties or powers.
- (vii) in connection with the laying, erection, alteration or repair in or near such road of any sewer or of any main, pipe or apparatus for the supply of gas, water or electricity or of any Electronic Communications Line;

4.2 The controls specified in Article 3 of this Order do not apply in respect of a Vehicle which is waiting at the edge of the carriageway for as long as may be necessary for the purpose of delivering or collecting postal packets as defined in the Postal Services Act 2000.

4.3 Nothing in Article 3.2 shall render it unlawful to cause or permit any Vehicle to wait in the lengths of road referred to therein for so long as may be necessary to enable:-

- (i) a person to board or alight from the Vehicle;
- (ii) the Vehicle to take in petrol, oil, water or air from any garage situated on or adjacent to the said lengths of road;
- (iii) any Vehicle, other than a privately owned Vehicle, which is being used as an official Vehicle for the purposes of a wedding (bridal vehicle) or a funeral (hearse and cortege) at a Church or place of worship
- (iv) Goods to be Loaded or Unloaded from the Vehicle.

## **5 DISABLED PERSONS' EXEMPTIONS**

5.1 Nothing in Article 3.2 shall render it unlawful to cause or permit a Disabled Person's Vehicle which displays in the relevant position a Disabled Person's Badge, and a parking disc (on which the driver, or other person in charge of the Vehicle, has marked the time at which the period of waiting began) to wait in the lengths of road referred to in that Article for a period not exceeding three hours (not being a period separated by an interval of less than one hour from a previous period of waiting by the same Vehicle in the same length or on the same side of road on the same day).

5.2 Nothing in Article 3.2 shall render it unlawful to cause or permit a Disabled Person's Vehicle which displays in the relevant position a Disabled Person's Badge to wait in the lengths of road referred to in that Article.

5.3 A Vehicle displays a Disabled Person's Badge in the relevant position if:-

- (i) in the case of a Vehicle fitted with a front windscreen, the badge is exhibited thereon on the near side of and immediately behind the windscreen and with its front facing forward so as to be legible from outside the Vehicle; or

(ii) in the case of a Vehicle not fitted with a front windscreen, the badge is exhibited in a conspicuous position on the Vehicle.

5.4 A Vehicle displays a Disabled Person's Badge in the relevant position if:-

(i) in the case of a Vehicle fitted with a dashboard or fascia panel, the badge is exhibited thereon so that Part I of the badge is legible from outside the Vehicle; or

(ii) in the case of a Vehicle not fitted with a dashboard or fascia panel, the badge is exhibited in a conspicuous position on the Vehicle so that Part I of the badge is legible from outside the Vehicle.

5.5 A vehicle displays a parking disc in the relevant position if:-

(i) in the case of a Vehicle fitted with a dashboard or fascia panel, the disc is exhibited thereon so that the quarter-hour period during which the period of waiting began is legible from outside the Vehicle; or

(ii) in the case of a Vehicle not so fitted, the disc is exhibited in a conspicuous position on the Vehicle so that the quarter-hour period during which the period of waiting began is legible from outside the Vehicle".

## **6 PUBLIC SERVICE VEHICLES**

6.1 Nothing in Article 3.2 shall apply to a Public Service Vehicle.

## **7 EFFECT OF ORDER**

7.1 The prohibitions and restrictions imposed by this Order shall be in addition to and not in derogation from any restrictions or requirements imposed by any regulations made or having effect as if made under the Act of 1984 or by or under any other enactment.

# **SCHEDULE 1**

## **SCHOOL KEEP CLEAR RESTRICTIONS**

**NO STOPPING 8 AM TO 4 PM**

**MONDAY TO FRIDAY**

**ON SCHOOL KEEP CLEAR MARKINGS**

**Bracken Road, Long Eaton**

East side

From a point 118 metres south of its junction with Briar Gate in a southerly direction for a distance of 26 metres.

From a point 181 metres south of its junction with Briar Gate in a southerly direction for a distance of 27 metres.

## SCHEDULE 2

NO WAITING 8AM TO 9.15AM TO 2.45PM TO 3.45PM  
MONDAY TO FRIDAY

### Bracken Close, Long Eaton

Both sides

From its junction with Bracken Road in a westerly direction for a distance of 10 metres.

### Bracken Road, Long Eaton

West side

From a point 10 metres south of its junction with Bracken Close in a northerly direction to a point 10 metres north of that junction.

As shown for illustration purposes only on the attached plan.

THE COMMON SEAL of the Derbyshire )  
County Council was hereunto affixed )  
the Ninth day of June Two Thousand )  
and Eleven in the presence of:- )

  
 Director of Legal Services

Number in Seal  
Book 2011/613

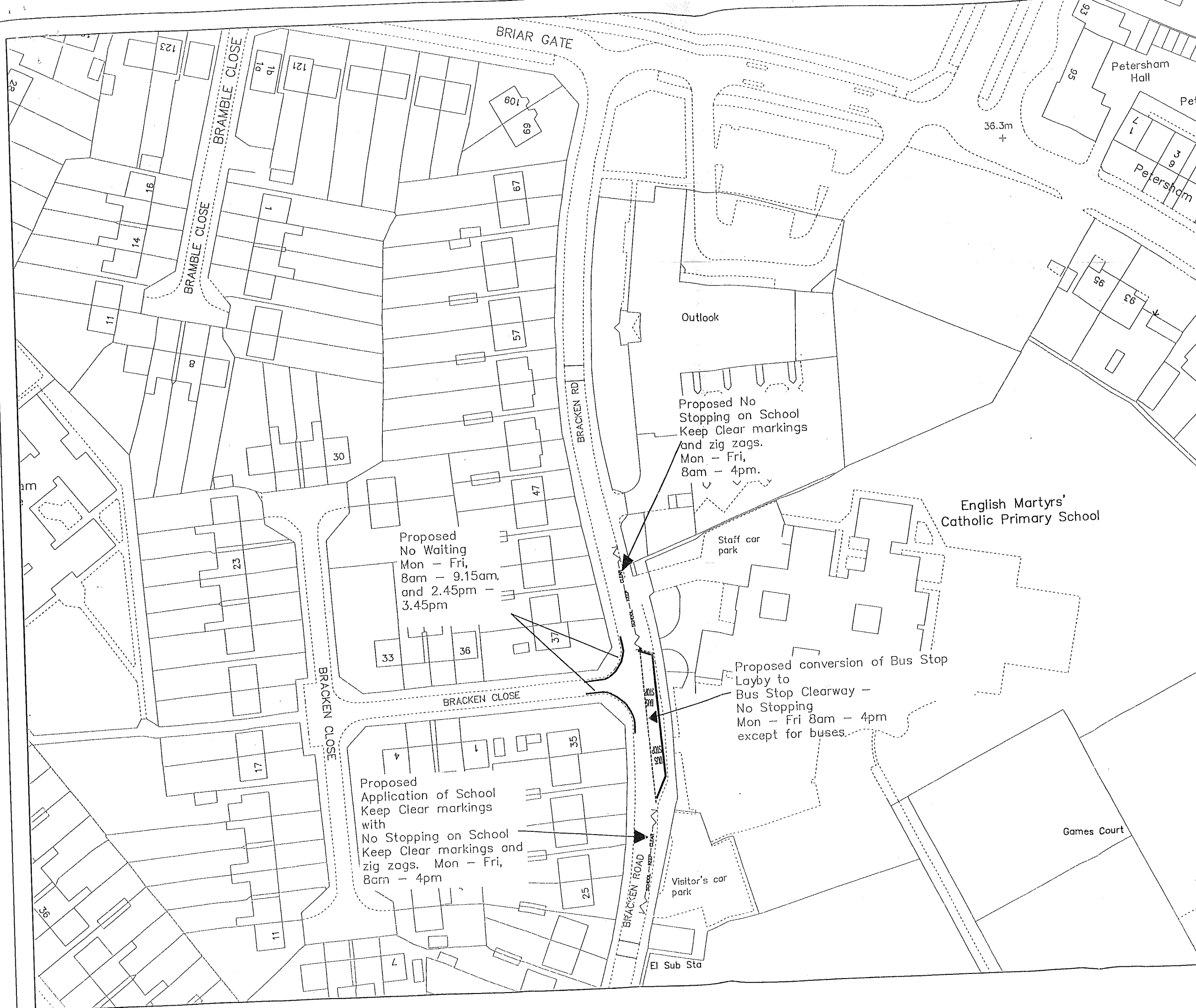

Bracken Road and Bracken close, Long Eaton

Proposed waiting restrictions

SCHOOL - KEEP CLEAR - SCHOOL - KEEP CLEAR  
School Keep Clear markings and zig zags  
Monday - Friday, 8am - 4pm

No Waiting  
Monday - Friday  
8.45 - 9.15 am and 2.45 - 3.45 pm

Bus Stop Clearway  
Monday - Friday  
8am - 4pm

Proposed No Stopping on School  
Keep Clear markings and zig zags.  
Mon - Fri, 8am - 4pm.

Proposed No Waiting  
Mon - Fri, 8am - 9.15am, and 2.45pm - 3.45pm

Proposed conversion of Bus Stop Layby to Bus Stop Clearway - No Stopping Mon - Fri 8am - 4pm except for buses.

Proposed Application of School Keep Clear markings with No Stopping on School Keep Clear markings and zig zags. Mon - Fri, 8am - 4pm

AMENDMENT DETAILS				BY	DATE	No.
DRAWN BY	CHECKED BY	APPROVED BY	SCALE			
K Hair			N.T.S.			
DATE	DATE	DATE				
14th Dec 2009						

**DERBYSHIRE**  
COUNTY COUNCIL

Ian Stephenson BSc, C.Eng., MICE, MHT.  
Strategic Director of Environmental Services

This map is reproduced from the Ordnance Survey material with the permission of Ordnance Survey on behalf of the Controller of Her Majesty's Stationary Office. © Crown Copyright. Unauthorised reproduction infringes Crown Copyright and may lead to prosecution or civil proceedings. 100023251 2008

Proposed Prohibition of Waiting and Stopping

English Martyrs' Catholic Primary School, Bracken road, Long Eaton

Drawing No.  
SET/KH/509/09





## Prohibition and Restriction of Waiting, On Street Parking and Clearways.

This map is reproduced from Ordnance Survey material with the permission of Ordnance Survey on behalf of the Controller of Her Majesty's Stationery Office (c) Crown Copyright. Unauthorised reproduction infringes Crown copyright and may lead to prosecution or civil proceedings.  
Derbyshire County Council  
Licence No: 100023251 2009

CONFIRMED



IAN W.STEPHENSON BSc., CEng.,MICE,MIHT  
Strategic Director of Environmental Services

DRAWING TITLE

Tile Ref: GY127

SCALE 1 : 1250

DATE 20/06/2011

DRAWING No. 4

DRAWN BY



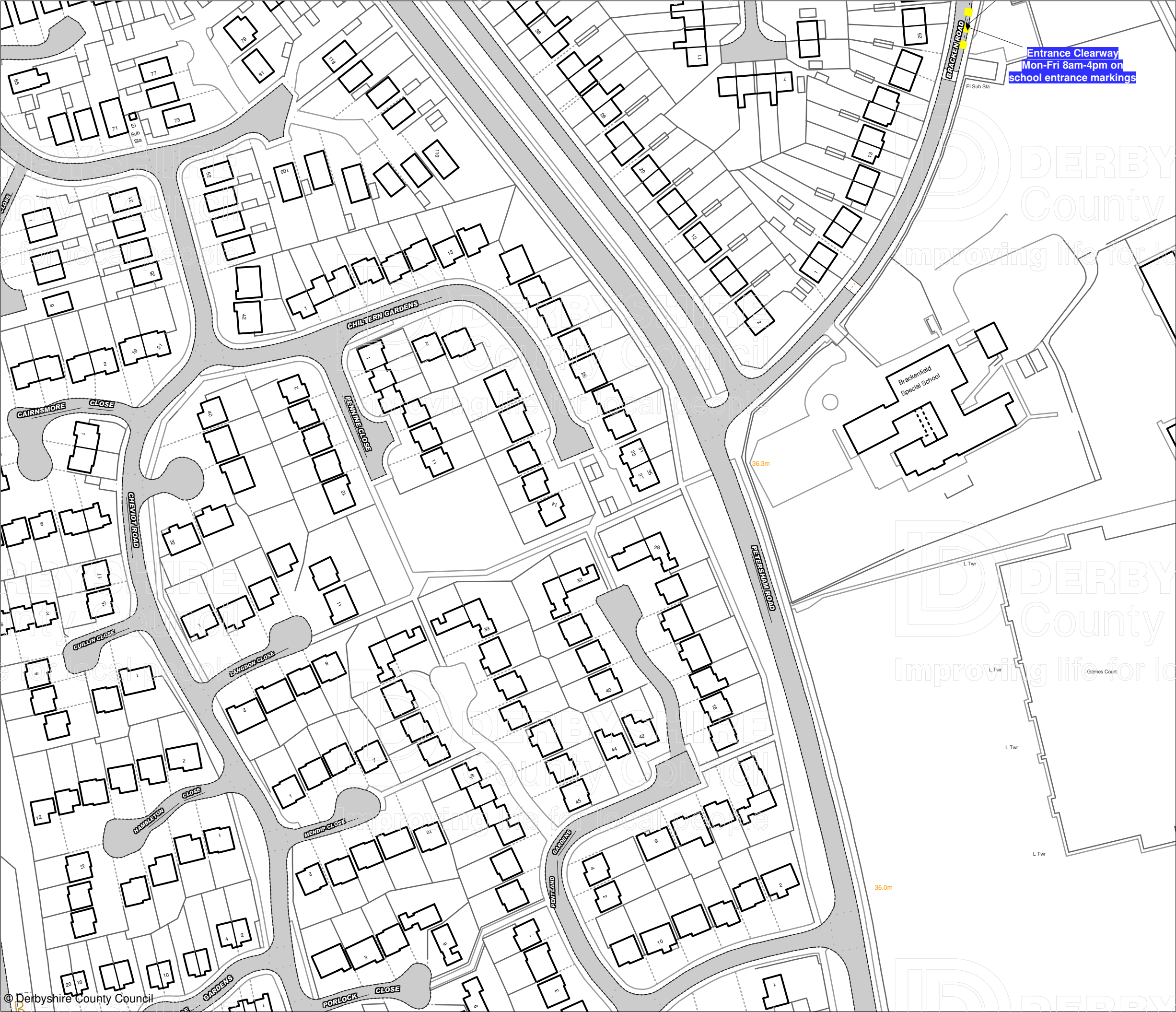

Prohibition and Restriction  
of Waiting, On Street  
Parking and Clearways.

This map is reproduced from Ordnance Survey material with the permission of Ordnance Survey on behalf of the Controller of Her Majesty's Stationery Office (c) Crown Copyright. Unauthorised reproduction infringes Crown copyright and may lead to prosecution or civil proceedings.  
Derbyshire County Council  
Licence No: 100023251 2009

CONFIRMED



IAN W.STEPHENSON BSc., CEng.,MICE,MIHT  
Strategic Director of Environmental Services

DRAWING TITLE

Tile Ref: GZ127

SCALE 1 : 1250

DATE 20/06/2011

DRAWING No. 2

DRAWN BY
