

DATED 10 JUNE 2010

THE DERBYSHIRE COUNTY COUNCIL

ROAD TRAFFIC REGULATION ACT 1984

THE DERBYSHIRE COUNTY COUNCIL

(LANSDOWNE ROAD, BUXTON)

(PROHIBITION OF WAITING) ORDER 2010

D W TYSOE

MATLOCK

Z2808

**THE DERBYSHIRE COUNTY COUNCIL
ROAD TRAFFIC REGULATION ACT 1984
(LANSDOWNE ROAD, BUXTON)
(PROHIBITION OF WAITING) ORDER 2010**

The Derbyshire County Council in exercise of its powers under Sections 1, 2 and 4 of the Road Traffic Regulation Act 1984 (as amended) ("the Act") and of all other enabling powers, after consultation with the Chief Officer of Police in accordance with Part III of Schedule 9 to the Act hereby makes the following Order:-

1 CITATION

This Order shall come into operation on the Twenty-first day of June Two thousand and Ten and may be cited as "The Derbyshire County Council (Lansdowne Road, Buxton) (Prohibition of Waiting) Order 2010".

2 INTERPRETATION

In this Order:-

2.1 "Vehicle" means any mechanically propelled vehicle intended or adapted for use on roads.

2.2 "Public Service Vehicle" has the meaning ascribed to it by Section 1 of the Public Passenger Vehicles Act 1981, that is to say it shall mean a motor vehicle (other than a tramcar) which –

(i) being a vehicle adapted to carry more than eight passengers, is used for carrying passengers for hire or reward; or

(ii) being a vehicle not so adapted, is used for carrying passengers for hire or reward at separate fares in the course of a business or carrying passengers.

2.3 "Disabled person's badge" has the same meaning as in the Disabled Persons (Exemptions for Disabled Persons) (England) Regulations 2000.

2.4 "Disabled person's vehicle" means a vehicle displaying a disabled person's badge in the relevant position as set out under Regulation 4 of the Local Authorities Orders (Exemptions for Disabled Persons) (England) Regulations 2000.

2.5 "The 2004 Act" means Traffic Management Act 2004.

2.6 "CEO" means Civil Enforcement Officer and has the same meaning as in Section 76 of the 2004 Act.

3 WAITING RESTRICTIONS

3.1 Save as provided in articles 4, 5 and 6 of this Order no person shall except upon the direction or with the permission of a Police Constable in uniform cause or permit any vehicle to wait at any time on any day on the length of road specified in the Schedule to this Order.

4 GENERAL EXEMPTIONS

4.1 Nothing in Article 3 shall render it unlawful to cause or permit any vehicle to wait in the lengths of road referred to therein for so long as may be necessary to enable:-

- (i) a person to board or alight from the vehicle;
 - (ii) the vehicle, if it cannot conveniently be used for such purpose in any other road, to be used in connection with any of the following operations namely:-
 - (a) building, industrial or demolition operations;
 - (b) the removal of any obstruction to traffic;
 - (c) the maintenance, improvement or reconstruction of the said lengths of road; or
 - (d) the laying, erection, alteration or repair in, or on land adjacent to the said lengths of road of any sewer or of any main, pipe or apparatus for the supply of gas, water or electricity or of any telecommunication apparatus as defined in the Telecommunications Act 1984;
 - (iii) the vehicle, if it cannot conveniently be used for such purpose in any other road, to be used in the service of a local authority or a water authority in pursuance of statutory powers or duties;
 - (iv) the vehicle to be used for the purpose of delivering or collecting postal packets as defined in The Postal Services Act 2000;
 - (v) the vehicle to take in petrol, oil, water or air from any garage situated on or adjacent to the said lengths of road;
 - (vi) the vehicle to wait at or near to any premises situated or adjacent to the said lengths of road for so long as such waiting by that vehicle is reasonably necessary in connection with any wedding or funeral;
 - (vii) the vehicle to be used for fire brigade, ambulance or police purposes;
- or
- (viii) goods to be loaded or unloaded from the vehicle.

5 DISABLED PERSONS' EXEMPTIONS

5.1 Nothing in Article 3.1 shall render it unlawful to cause or permit a disabled person's vehicle which displays in the relevant position a disabled person's badge, and a parking disc (on which the driver, or other person in charge of the vehicle, has marked the time at which the period of waiting began) to wait in the lengths of road referred to in that Article for a period not exceeding three hours (not being a period separated by an interval of less than one hour from a previous period of waiting by the same vehicle in the same length or on the same side of road on the same day).

5.2 A vehicle displays a disabled person's badge in the relevant position if:-

- (i) in the case of a vehicle fitted with a front windscreen, the badge is exhibited thereon on the near side of and immediately behind the windscreen and with its front facing forward so as to be legible from outside the vehicle; or
- (ii) in the case of a vehicle not fitted with a front windscreen, the badge is exhibited in a conspicuous position on the vehicle.

5.3 A vehicle displays a disabled person's badge in the relevant position if:-

- (i) in the case of a vehicle fitted with a dashboard or fascia panel, the badge is exhibited thereon so that Part I of the badge is legible from outside the vehicle; or
- (ii) in the case of a vehicle not fitted with a dashboard or fascia panel, the badge is exhibited in a conspicuous position on the vehicle so that Part I of the badge is legible from outside the vehicle.

5.4 A vehicle displays a parking disc in the relevant position if:-

- (i) in the case of a vehicle fitted with a dashboard or fascia panel, the disc is exhibited thereon so that the quarter-hour period during which the period of waiting began is legible from outside the vehicle; or
- (ii) in the case of a vehicle not so fitted, the disc is exhibited in a conspicuous position on the vehicle so that the quarter-hour period during which the period of waiting began is legible from outside the vehicle".

6 PUBLIC SERVICE VEHICLES

6.1 Nothing in Article 3 shall apply to a Public Service Vehicle.

7 EFFECT OF ORDER

7.1 The prohibitions and restrictions imposed by this Order shall be in addition to and not in derogation from any restrictions or requirements imposed by any regulations made or having effect as if made under the Act of 1984 or by or under any other enactment.

SCHEDULE

NO WAITING AT ANY TIME

Lansdowne Road, Buxton

North west side

From a point 27 metres north east of its junction with Lascelles Road in a north easterly direction for a distance of 12 metres.

THE COMMON SEAL of the Derbyshire)
County Council was hereunto affixed)
the Tenth day of June Two thousand)
and Ten in the presence of:-)

Jacqueline Austin

Jacqueline Austin County Secretary

Number in Seal

Book 2010/575

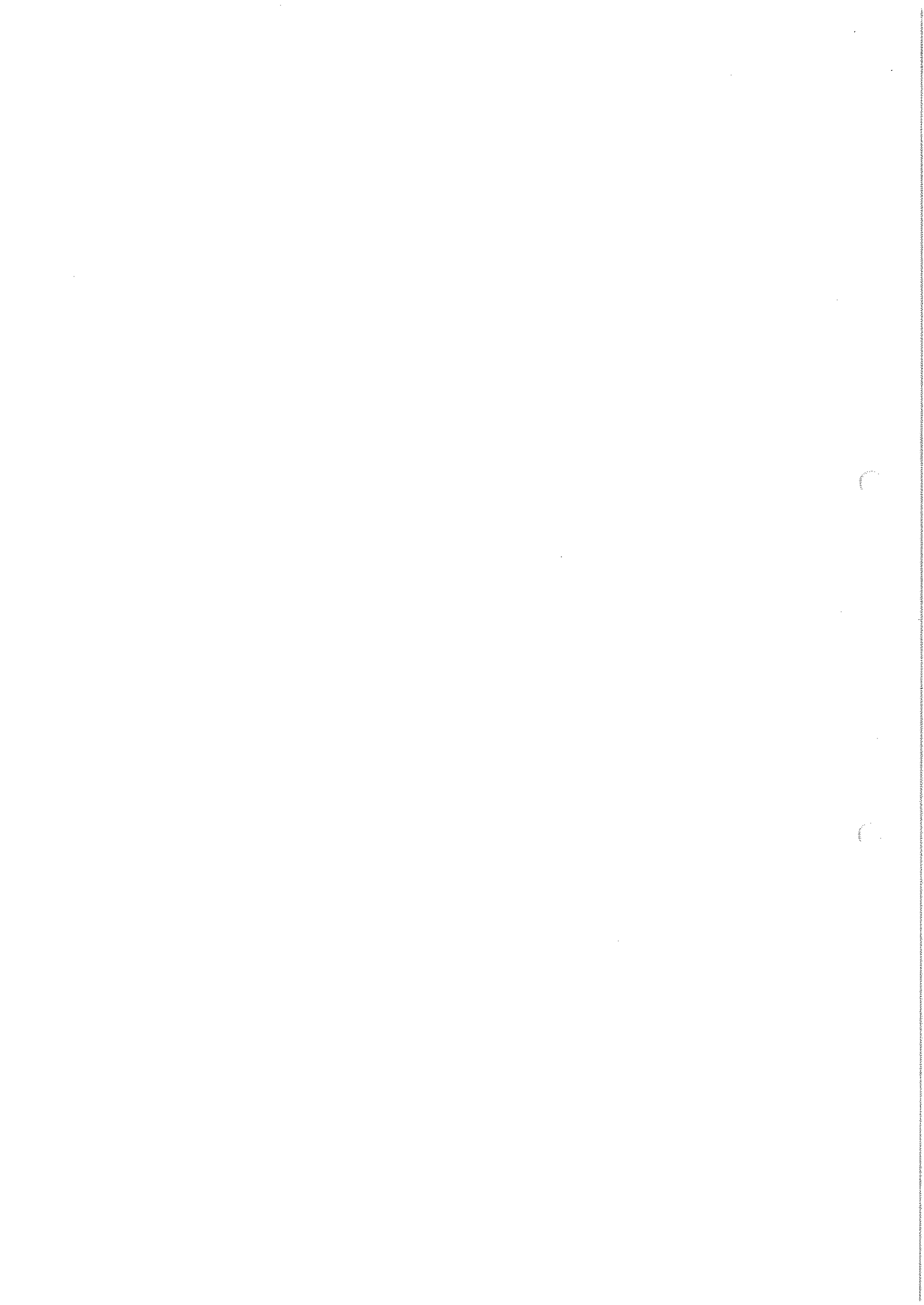

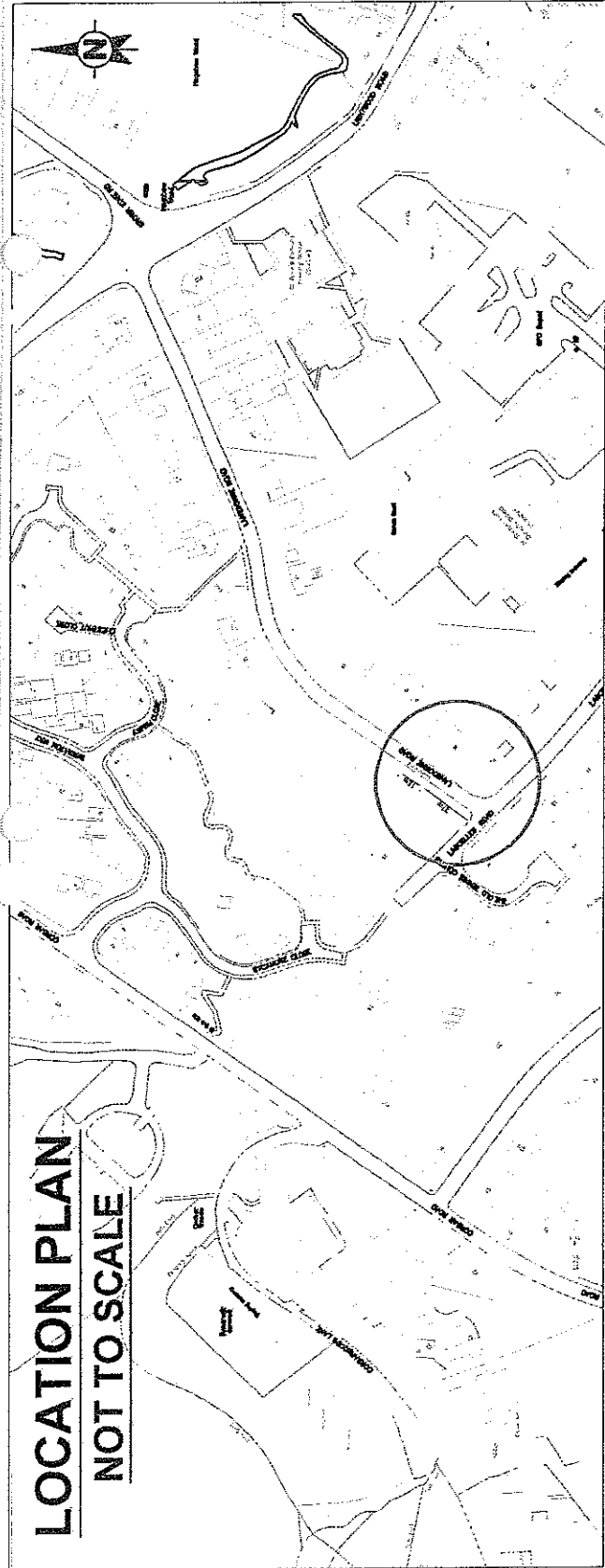

LOCATION PLAN
NOT TO SCALE

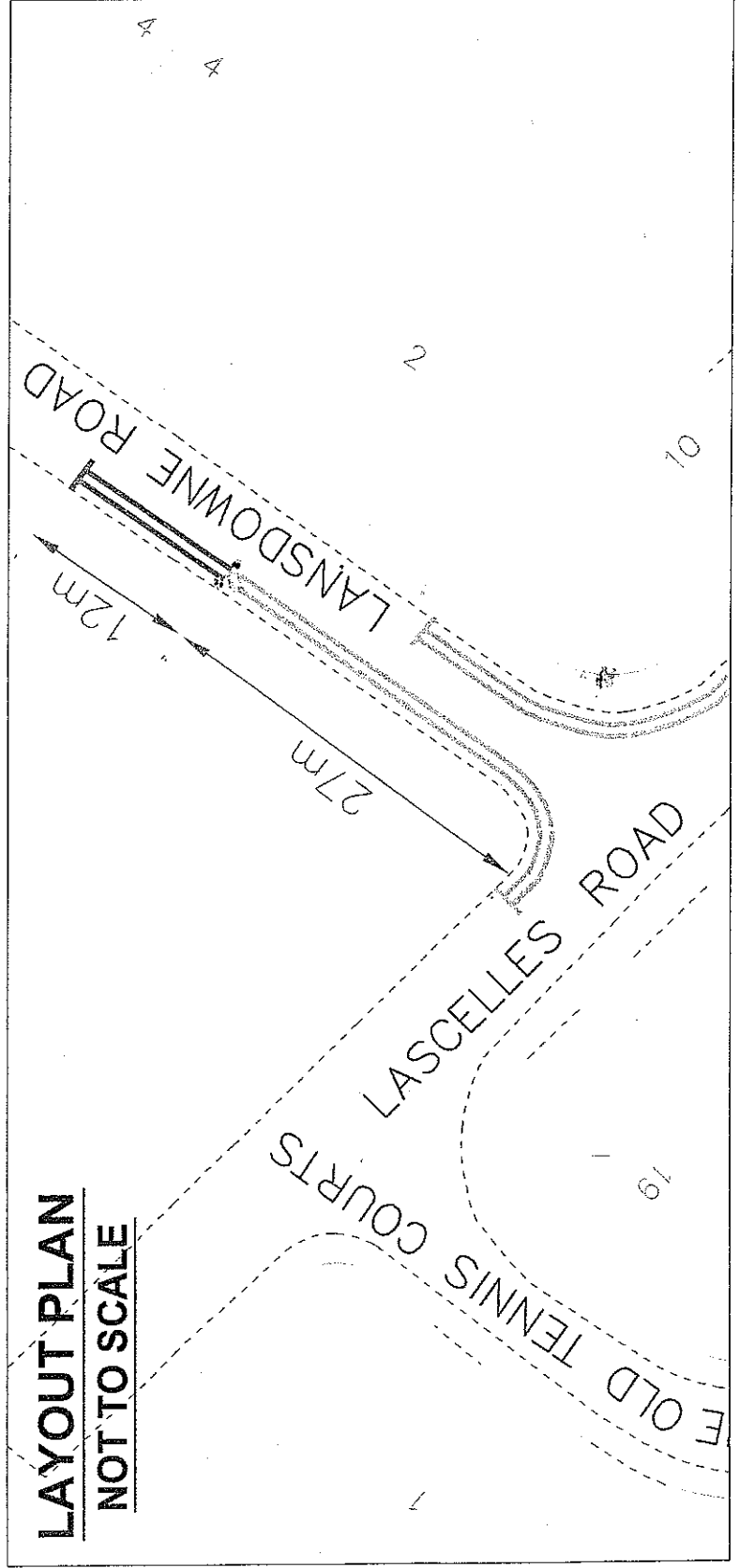

LAYOUT PLAN
NOT TO SCALE



KEY

-  Existing No Waiting at any time
-  Proposed No Waiting at any time restrictions

AMENDMENT DETAILS		By	Date	No.
DRAWN BY SM				
DATE		SCALE		
4/03/10		NTS		
ORIGINAL DRAWING SIZE 210 x 296 (A4)				
 DERBYSHIRE COUNTY COUNCIL IAN W STEPHENSON BSC CEMO HAUGE BAHT STRATEGIC DIRECTOR OF ENVIRONMENTAL SERVICES				
PROJECT TITLE				
LANSDOWNE ROAD BUXTON				
DRAWING TITLE				
PROPOSED NO WAITING AT ANY TIME RESTRICTION				
DRAWING No.				
NTA/SM/46/10				

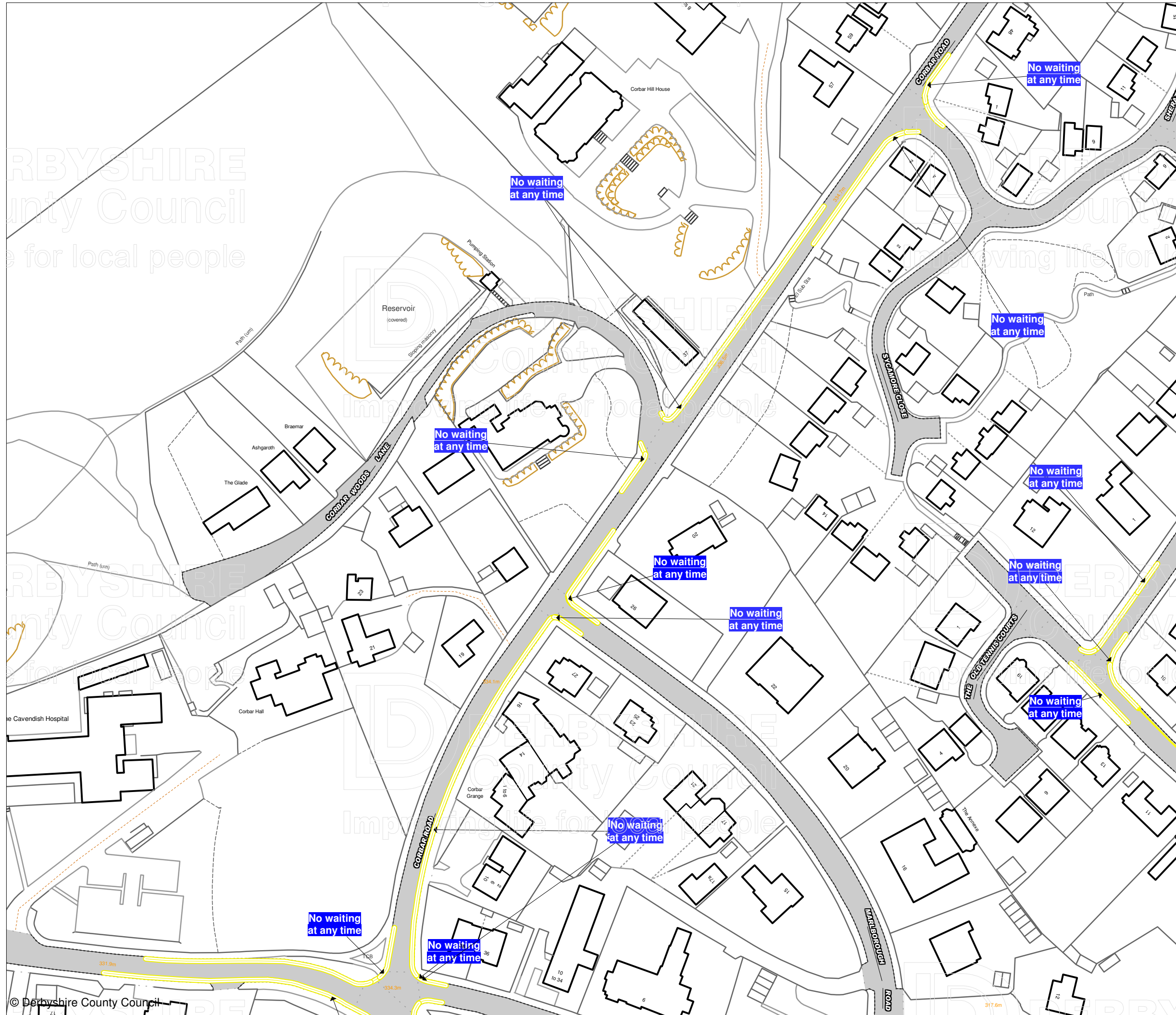

Prohibition and Restriction of Waiting, On Street Parking and Clearways.

This map is reproduced from Ordnance Survey material with the permission of Ordnance Survey on behalf of the Controller of Her Majesty's Stationery Office (c) Crown Copyright. Unauthorised reproduction infringes Crown copyright and may lead to prosecution or civil proceedings.
Derbyshire County Council
Licence No: 100023251 2009

CONFIRMED



DERBYSHIRE
 County Council
 Improving life for local people
 IAN W. STEPHENSON BSc., CEng., MICE, MIHT
 Strategic Director of Environmental Services

DRAWING TITLE	
Tile Ref: CK20	
SCALE	1 : 1250
DATE	21/06/2010
DRAWING No.	2
DRAWN BY	