

THE DERBYSHIRE COUNTY COUNCIL
ROAD TRAFFIC REGULATION ACT 1984
(BURLINGTON AVENUE, EAST VIEW AND
RIDGEWAY, LANGWITH JUNCTION)
(PROHIBITION OF WAITING A) ORDER 2010

The Derbyshire County Council in exercise of its powers under Sections 1 2 and 4 of the Road Traffic Regulation Act 1984 (as amended) ("the Act") and of all other enabling powers, after consultation with the Chief Officer of Police in accordance with Part III of Schedule 9 to the Act hereby makes the following Order:-

1 CITATION

This Order shall come into operation on the Twenty-third day of August Two thousand and Ten and may be cited as "The Derbyshire County Council (Burlington Avenue, East View and Ridgeway, Langwith Junction) (Prohibition of Waiting A) Order 2010".

2 INTERPRETATION

In this Order:-

2.1 "Vehicle" means any mechanically propelled vehicle intended or adapted for use on roads.

2.2 "Public Service Vehicle" has the meaning ascribed to it by Section 1 of the Public Passenger Vehicles Act 1981, that is to say it shall mean a motor vehicle (other than a tramcar) which –

(i) being a vehicle adapted to carry more than eight passengers, is used for carrying passengers for hire or reward; or

(ii) being a vehicle not so adapted, is used for carrying passengers for hire or reward at separate fares in the course of a business or carrying passengers.

2.3 "Disabled person's badge" has the same meaning as in the Disabled Persons (Exemptions for Disabled Persons) (England) Regulations 2000.

2.4 "Disabled person's vehicle" means a vehicle displaying a disabled person's badge in the relevant position as set out under Regulation 4 of the Local Authorities Orders (Exemptions for Disabled Persons) (England) Regulations 2000.

2.5 "The 2004 Act" means Traffic Management Act 2004.

2.6 "CEO" means Civil Enforcement Officer and has the same meaning as in Section 76 of the 2004 Act.

2.7 "Goods" means goods or burden of any description.

2.8 "Loading and Unloading" means the transference, from or to a Vehicle, to or from premises, of goods.

3 WAITING RESTRICTIONS

3.1 Save as provided in articles 4, 5 and 6 of this Order no person shall except upon the direction or with the permission of a Police Constable in uniform, or a CEO or a Parking Attendant, cause or permit any vehicle to wait at any time on any day on the length of road specified in the Schedule to this Order.

4 GENERAL EXEMPTIONS

4.1 Nothing in Article 3 shall render it unlawful to cause or permit any vehicle to wait in the lengths of road referred to therein for so long as may be necessary to enable:-

- (i) a person to board or alight from the vehicle;**
 - (ii) the vehicle, if it cannot conveniently be used for such purpose in any other road, to be used in connection with any of the following operations namely:-**
 - (a) building, industrial or demolition operations;**
 - (b) the removal of any obstruction to traffic;**
 - (c) the maintenance, improvement or reconstruction of the said lengths of road; or**
 - (d) the laying, erection, alteration or repair in, or on land adjacent to the said lengths of road of any sewer or of any main, pipe or apparatus for the supply of gas, water or electricity or of any telecommunication apparatus as defined in the Telecommunications Act 1984;**
 - (iii) the vehicle, if it cannot conveniently be used for such purpose in any other road, to be used in the service of a local authority or a water authority in pursuance of statutory powers or duties;**
 - (iv) the vehicle to be used for the purpose of delivering or collecting postal packets as defined in The Postal Services Act 2000;**
 - (v) the vehicle to take in petrol, oil, water or air from any garage situated on or adjacent to the said lengths of road;**
 - (vi) the vehicle to wait at or near to any premises situated or adjacent to the said lengths of road for so long as such waiting by that vehicle is reasonably necessary in connection with any wedding or funeral;**
 - (vii) the vehicle to be used for fire brigade, ambulance or police purposes;**
- or**
- (viii) goods to be loaded or unloaded from the vehicle.**

5 DISABLED PERSONS' EXEMPTIONS

5.1 Nothing in Article 3 shall render it unlawful to cause or permit a disabled person's vehicle which displays in the relevant position a disabled person's badge, and a parking disc (on which the driver, or other person in charge of the vehicle, has marked the time at which the period of waiting began) to wait in the lengths of road referred to in that Article for a period not exceeding three hours (not being a period separated by an interval of less than one hour from a previous period of waiting by the same vehicle in the same length or on the same side of road on the same day).

5.2 A vehicle displays a disabled person's badge in the relevant position if:-

- (i)** in the case of a vehicle fitted with a front windscreen, the badge is exhibited thereon on the near side of and immediately behind the windscreen and with its front facing forward so as to be legible from outside the vehicle; or
- (ii)** in the case of a vehicle not fitted with a front windscreen, the badge is exhibited in a conspicuous position on the vehicle.

5.3 A vehicle displays a disabled person's badge in the relevant position if:-

- (i)** in the case of a vehicle fitted with a dashboard or fascia panel, the badge is exhibited thereon so that Part I of the badge is legible from outside the vehicle; or
- (ii)** in the case of a vehicle not fitted with a dashboard or fascia panel, the badge is exhibited in a conspicuous position on the vehicle so that Part I of the badge is legible from outside the vehicle.

5.4 A vehicle displays a parking disc in the relevant position if:-

- (i)** in the case of a vehicle fitted with a dashboard or fascia panel, the disc is exhibited thereon so that the quarter-hour period during which the period of waiting began is legible from outside the vehicle; or
- (ii)** in the case of a vehicle not so fitted, the disc is exhibited in a conspicuous position on the vehicle so that the quarter-hour period during which the period of waiting began is legible from outside the vehicle".

6 PUBLIC SERVICE VEHICLES

6.1 Nothing in Article 3 shall apply to a Public Service Vehicle.

7 EFFECT OF ORDER

7.1 The prohibitions and restrictions imposed by this Order shall be in addition to and not in derogation from any restrictions or requirements imposed by any regulations made or having effect as if made under the Act of 1984 or by or under any other enactment.

8 REVOCATION OF PREVIOUS ORDERS

8.1 The Derbyshire County Council (Burlington Avenue, East View and Ridgeway, Langwith Junction) (Prohibition of Waiting) Order 2010 is hereby revoked in its entirety.

SCHEDULE

NO WAITING AT ANY TIME

Burlington Avenue, Langwith Junction

North side

From a point 223 metres east of its junction with Primrose Way for a distance of 24 metres.

From its junction with East View to a point 33 metres south of that junction, a distance of 33 metres.

South side

From its junction with Stubbin Wood School and Brookfield Primary School in both directions for a distance of 10 metres.

East View, Langwith Junction

East side

From its junction with Burlington Avenue to a point 16 metres south of that junction, a distance of 16 metres.

Ridgeway, Langwith Junction

North side

From its junction with Burlington Avenue to a point 10 metres west of that junction, a distance of 10 metres.

South side

From its junction with Burlington Avenue to a point 10 metres west of that junction, a distance of 10 metres.

THE COMMON SEAL of the Derbyshire)
County Council was hereunto affixed)
the Twelfth day of August Two)
thousand and Ten in the presence of:-)

Jaqueline Arwin
Arwin

Director of Legal Services

Number in Seal
Book - 2010/814

Key

-  Proposed Parking Bay
-  Proposed 'at any time' restriction

AMENDMENT DETAILS

DRAWN - FS	CHECKED	APPROVED
Date	Date	Date
May 2010		



IAN STEPHENSON
Strategic Director
Environmental Services

NORTH NETWORK MANAGEMENT

Burlington Avenue & Langwith Junction
Langwith Junction

NO WAITING AT ANY TIME
Page 2 of 2

DRAWING NUMBER - NTA/FS/15009/2

1:1250

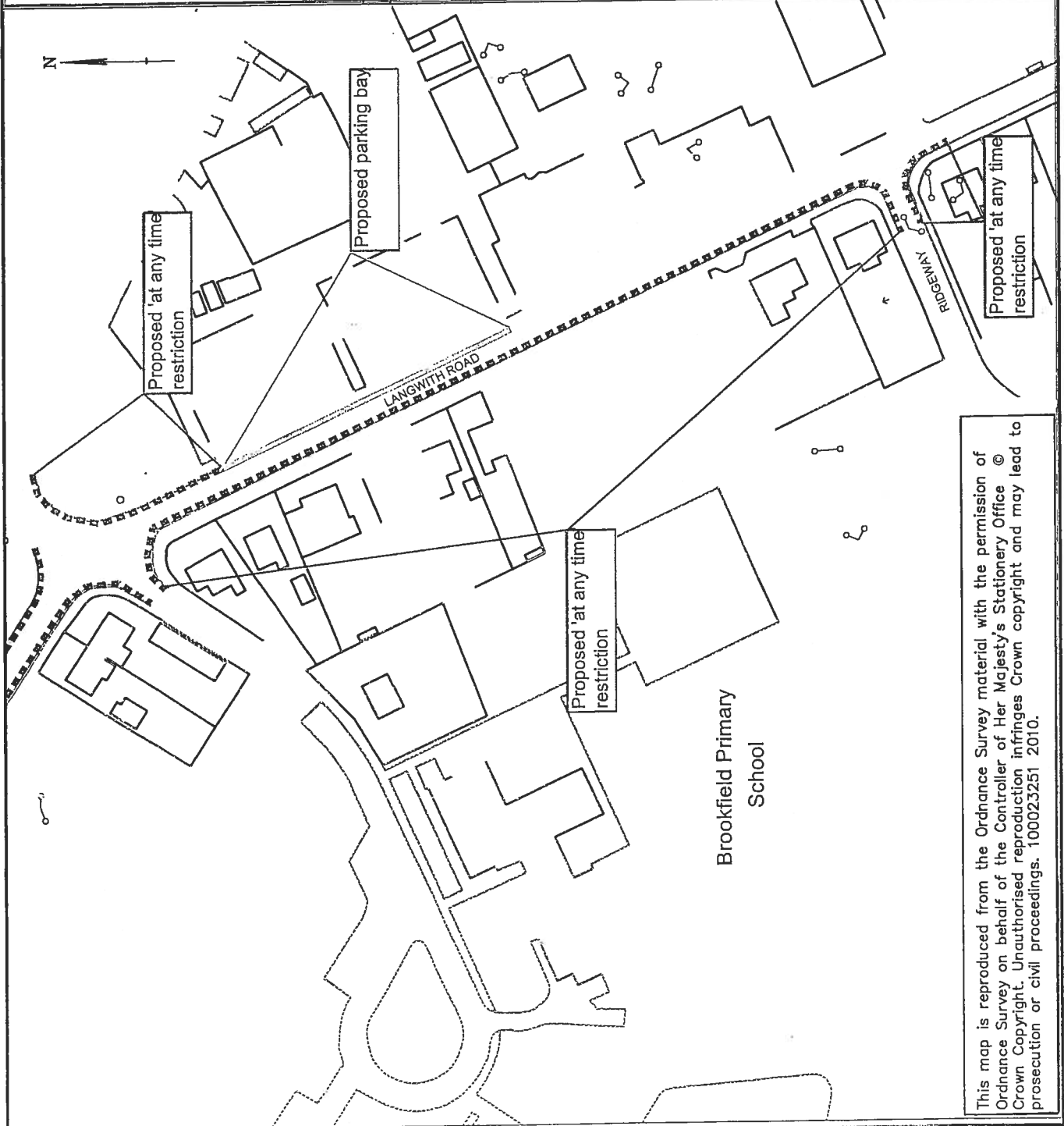

This map is reproduced from the Ordnance Survey material with the permission of Ordnance Survey on behalf of the Controller of Her Majesty's Stationary Office © Crown Copyright. Unauthorised reproduction infringes Crown copyright and may lead to prosecution or civil proceedings. 100023251 2010.

Key

- Proposed Parking Bay
- Proposed 'at any time' restriction
- Existing bus stop

AMENDMENT DETAILS

DRAWN - FS	CHECKED	APPROVED
Date May 2010	Date	Date



IAN STEPHENSON
Strategic Director
Environmental Services

NORTH NETWORK MANAGEMENT

Burlington Avenue & Langwith Junction
Langwith Junction

NO WAITING AT ANY TIME
Revised Proposals 1 of 2

DRAWING NUMBER - NTA/FS/150/09/1A

1:1250



Proposed 'at any time' restriction

Proposed parking bay

Proposed 'at any time' restriction

Proposed parking bay

Stubbin Wood School

BURLINGTON AVENUE

EAST VIEW

LANGWITH ROAD

This map is reproduced from the Ordnance Survey material with the permission of Ordnance Survey on behalf of the Controller of Her Majesty's Stationery Office © Crown Copyright. Unauthorised reproduction infringes Crown copyright and may lead to prosecution or civil proceedings. 100023251 2010.

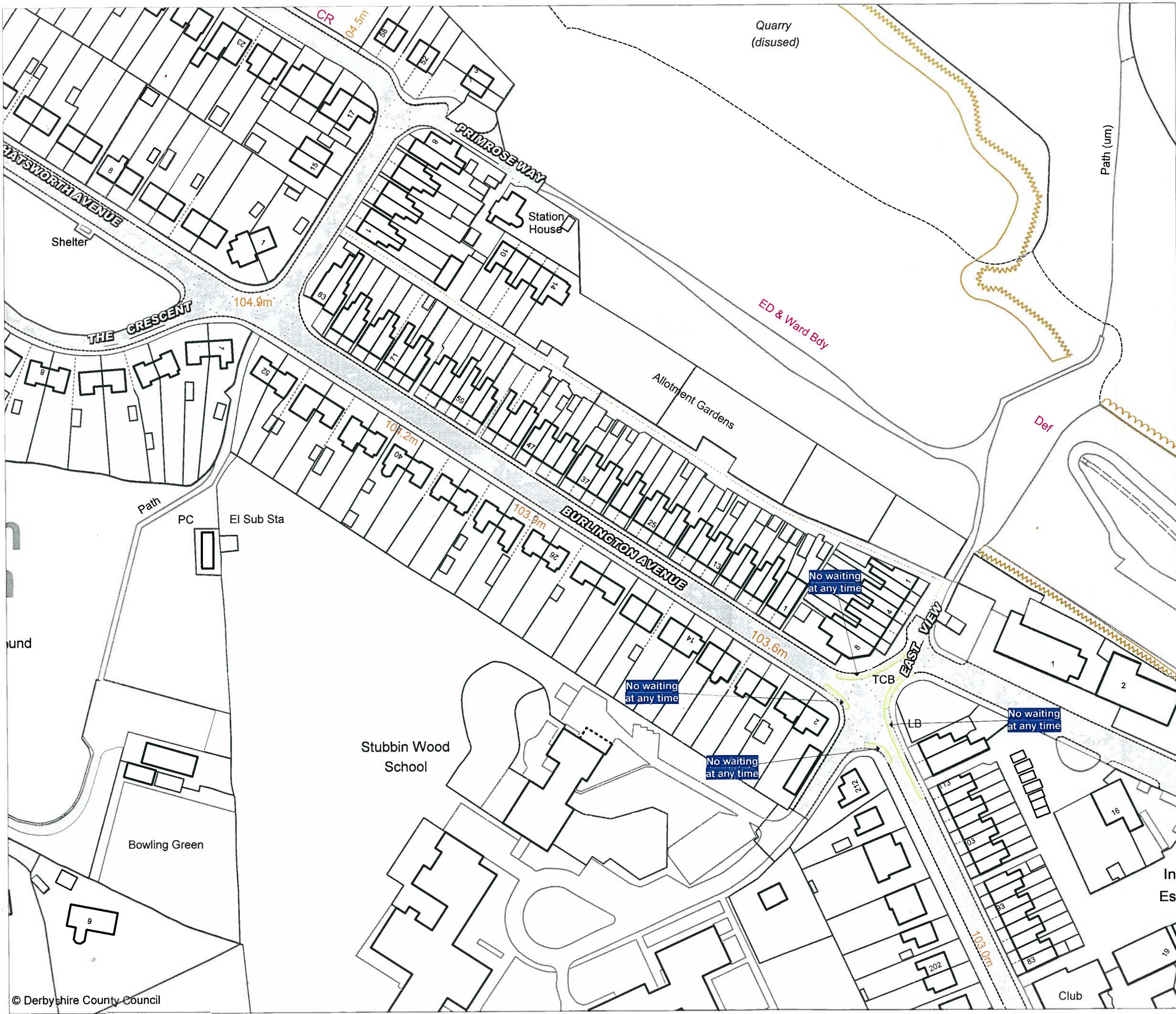

**Prohibition and Restriction
of Waiting, On Street
Parking and Clearways.**

This map is reproduced from Ordnance Survey material with the permission of Ordnance Survey on behalf of the Controller of Her Majesty's Stationery Office (c) Crown Copyright. Unauthorised reproduction infringes Crown copyright and may lead to prosecution or civil proceedings.
Derbyshire County Council
Licence No: 100023251 2009



DERBYSHIRE
County Council
Improving life for local people
IAN W. STEPHENSON BSc. CEng MICE MIHT
Strategic Director of Environmental Services

DRAWING TITLE	
Tile Ref: DA140	
SCALE	1 : 1250
DATE	23/08/2010
DRAWING No.	
DRAWN BY	

