

DC212

STATEMENT OF REASONS

THE HERTFORDSHIRE (SUNNYHILL ROAD, GLENVIEW ROAD, GLENDALE, ASHTREE WAY AND GRAVEL HILL TERRACE, HEMEL HEMPSTEAD) (RESTRICTION OF WAITING) ORDER 2019

The Hertfordshire County Council is proposing to introduce waiting restrictions in order to improve road safety in parts of Hemel Hempstead.

The proposals include:

- 'No waiting at any time' restrictions on parts of Sunnyhill Road, Glenview Road, Glendale, Ashtree Way and Gravel Hill Terrace.

Vehicles have been recorded parking close to junctions, or on near bends, obscuring oncoming traffic. These proposals are to prevent vehicles parking in contravention of the recommendations of the Highway Code (mainly Clause 243), thereby ensuring visibility of vehicles and pedestrians is maintained, plus keeping the road clear so passage of vehicles is less restricted.

There are existing restrictions on the south side of Glenview Road j/w Sunnyhill Road. The restrictions at Gravel Hill Terrace will tie in with existing restrictions from Green End Road.

Therefore, having also considered the duty imposed under Section 122 Road Traffic Regulation Act 1984, it appears to the Highway Authority that it is necessary and expedient to make an Order in the interests of avoiding danger to persons or other traffic using the road or any other road or for preventing the likelihood of any such danger arising and for facilitating the passage on the road or any other road of any class of traffic (including pedestrians).

The proposal has been subject to consultation with local and County Councillors representing the area and Dacorum Borough Council. The local Police, Ambulance, Fire and Rescue Services, Hertfordshire County Council Passenger Transport Unit and local residents have also been consulted.

HERTFORDSHIRE COUNTY COUNCIL

THE HERTFORDSHIRE (SUNNYHILL ROAD, GLENVIEW ROAD, GLENDALE, ASHTREE WAY AND GRAVEL HILL TERRACE, HEMEL HEMPSTEAD) (RESTRICTION OF WAITING) ORDER 2019

NOTICE is given that the Hertfordshire County Council has made an Order under the Road Traffic Regulation Act 1984 to introduce waiting restrictions in parts of Hemel Hempstead as specified in the Schedule to this Notice. The Order will come into effect on Monday 16 December 2019.

Documents giving more detailed particulars of the Order may be inspected from 4 December 2019 to 15 January 2020 during normal office hours, at the offices of Dacorum Borough Council, The Forum, Marlowes, Hemel Hempstead and at Main Reception, Hertfordshire County Council, County Hall, Pegs Lane, Hertford, or may be viewed online at www.hertfordshire.gov.uk/trafficorders by selecting Dacorum and looking at Ref: D00619.

Enquiries relating to the Order should be referred to the Highways Engineer concerned Lance Holman tel: 01992 658313 or lance.holman@hertfordshire.gov.uk

Any person wishing to question the validity of the Order, or of any provision contained in it, on the grounds that it is not within the powers conferred by the Road Traffic Regulation Act 1984, or on the grounds that any requirement of the Act or any Instrument made under it has not been complied with in relation to the Order, may within 6 weeks from the date of this Notice apply to the High Court for this purpose.

SCHEDULE: No waiting at any time – effecting those sections of road herein listed and as set out in the Order and accompanying plan - Parts of Sunnyhill Road, Glenview Road, Glendale, Ashtree Way and Gravel Hill Terrace.

County Hall
Hertford
Herts SG13 8DN

4 December 2019
Mark Kemp
Director of Environment and Infrastructure

HERTFORDSHIRE COUNTY COUNCIL
ROAD TRAFFIC REGULATION ACT 1984

ORIGINAL

Date of Order: **27 NOV 2019**
Order No: 8302

THE HERTFORDSHIRE (SUNNYHILL ROAD, GLENVIEW ROAD, GLENDALE, ASHTREE WAY AND GRAVEL HILL TERRACE, HEMEL HEMPSTEAD) (RESTRICTION OF WAITING) ORDER 2019

The Hertfordshire County Council in exercise of their powers under Sections 1, 2 and 3 of the Road Traffic Regulation Act 1984 (which said Act of 1984 is hereinafter referred to as "the Act of 1984"), and of all other enabling powers and after consultation with the Chief Officer of Police in accordance with Part III of Schedule 9 of the Act of 1984, hereby make the following Order:-

1. This Order may be cited as "The Hertfordshire (Sunnyhill Road, Glenview Road, Glendale, Ashtree Way and Gravel Hill Terrace, Hemel Hempstead) (Restriction of Waiting) Order 2019" and shall come into effect on Monday 16 December 2019.
2. Save as provided in Articles 3, 4 and 5 of this Order no person shall cause or permit any vehicle to wait at any time in those lengths of Sunnyhill Road, Glenview Road, Glendale, Ashtree Way and Gravel Hill Terrace, Hemel Hempstead as specified in the Schedule to this Order.
3. (1) Nothing in Article 2 of this Order applies to the lengths of road restricted by that Article (which said lengths of road are referred to in this Article as "the restricted area") in relation to –
 - (a) a vehicle being used for Fire and Rescue, Ambulance or Police purposes.
 - (b) anything done with the permission of or at the direction of a Police Constable in uniform; or with permission of a Civil Enforcement Officer as defined by the Traffic Management Act 2004 and appointed by Dacorum Borough Council.
 - (c) a vehicle which is prevented from proceeding by circumstances beyond the drivers control or which has stopped in order to avoid injury or damage to persons or property or when required to do so by law;
 - (d) a vehicle which is stationary in order that it may be used for one or more of the purposes specified in sub-Article (2) of this Article and which cannot reasonably be used for such a purpose without stopping in the restricted area;
 - (e) a marked vehicle which, whilst used by a universal service provider in the course of the provision of a universal postal service, is stationary only for so long as may be reasonably necessary for postal packets to be delivered or collected;

In this Article -

The expressions "universal service provider", "provision of a universal postal service" and "postal packet" shall bear the same meanings as in Section 65 of the Postal Services Act 2011.

- (2) The "purposes" referred to in sub-Article (1)(d) of this Article are –
 - (a) any operation involving building, demolition or excavation;
 - (b) the removal of any obstruction to traffic;
 - (c) the maintenance, improvement or reconstruction of a road;
 - (d) constructing, improving, maintaining, or cleaning of any street furniture; or
 - (e) the laying, erection, alteration, repair or cleaning of any sewer or of any main pipe or apparatus for the supply of gas, water or electricity, or of any

telecommunications apparatus kept or installed for the purposes of a telecommunications code system or of any other telecommunications apparatus lawfully kept installed in any position.

4. Nothing in Article 2 of this Order applies to the lengths of road restricted by that Article (which said lengths of road are referred to in this Article as “the restricted area”) so as to render it unlawful to cause or permit any vehicle to wait only for so long as may be reasonably necessary –
 - (a) to enable goods to be loaded on or unloaded from the vehicle from or to premises adjacent to the restricted area; or
 - (b) to enable a passenger to board or alight and to load and unload any luggage.
5. (1) Nothing in Article 2 of this Order shall render it unlawful to cause or permit a disabled person’s vehicle which displays in the relevant position a disabled person’s badge and a parking disc, to wait at any time in the lengths of road specified in the Schedule of this Order for a period not exceeding 3 hours (not being a period separated by an interval of less than 1 hour from a previous period of waiting by the same vehicle in the same length of road).
- (2) In this Article -
 - “disabled person’s vehicle” has the same meaning as in Section 142(1) of the Act of 1984;
 - “disabled person’s badge” has the same meaning as given in Regulation 3(1) of The Local Authorities’ Traffic Orders (Exemptions for Disabled Persons) (England) Regulations 2000
 - “parking disc” has the same meaning as given in Regulation 8(5) of The Local Authorities’ Traffic Orders (Exemptions for Disabled Persons) (England) Regulations 2000; and
 - “relevant position” has the same meaning as given in Regulation 4 of The Local Authorities’ Traffic Orders (Exemptions for Disabled Persons) (England) Regulations 2000
6. The Interpretation Act 1978 shall apply for the interpretation of this Order as it applies for the interpretation of an Act of Parliament.
7. The restrictions imposed by this Order shall be in addition to and not in derogation from any restriction or requirement imposed by any other regulations made or having effect as if made under the Act of 1984 or by or under any other enactment.

SCHEDULE

lengths of Sunnyhill Road, Glenview Road, Glendale, Ashtree Way and
Gravel Hill Terrace, Hemel Hempstead – no waiting at any time

Sunnyhill Road (north east side)	from a point in line with the projected north west kerbline of Glenview Road north westwards for approximately 12 metres to a point 3.5 metres south east of a point in line with the north west fascia wall of 28 Glenview Road.
Glenview Road (north west side)	from a point in line with the projected north east kerbline of Sunnyhill Road north eastwards for approximately 6 metres to a point 7 metres south west of a point in line with the boundary between 26 and 28 Glenview Road.
(west side)	<ol style="list-style-type: none">(a) from a point in line with the projected north kerbline of Glendale northwards for approximately 17.5 metres to a point 2.5 metres north of a point in line with the boundary between 62 and 64 Glenview Road.(b) from a point in line with the projected south west kerbline of Glendale south westwards for approximately 11 metres to a point 0.75 metres south of a point in line with the boundary between 23 and 24 Glenview Gardens.

Glendale (south west side)	from a point in line with the projected west kerblines of Glenview Road north westwards for approximately 11.5 metres to a point 9.5 metres south east of a point in line with the north west boundary of 29 Glenview Gardens.
(north side)	from a point in line with the projected west kerblines of Glenview Road westwards and north westwards for approximately 18.5 metres to a point 9.5 metres south east of a point in line with the boundary between 62 and 64 Glenview Road.
Ashtree Way (south side)	from a point 10 metres west of a point in line with the projected west kerblines of Green End Road westwards for approximately 9 metres to a point 6.25 metres east of a point in line with the boundary between 1 and 3 Ashtree Way.
Ashtree Way / Gravel Hill Terrace (north side)	from a point 6.25 metres east of a point in line with the boundary between 1 and 3 Ashtree Way eastwards and north eastwards for approximately 67 metres to a point 5 metres west of a point in line with the boundary between 58 and 60 Gravel Hill Terrace.
Gravel Hill Terrace (south side)	from a point 1.25 metres north east of a point in line with the north west facade wall of 51 Gravel Hill Terrace, north eastwards for approximately 23 metres to a point 4 metres west of a point in line with the boundary between 45 and 47 Gravel Hill Terrace.

Signed:

Quentin Baker

**Quentin Baker
Chief Legal Officer**

Dated: 27 NOV 2019

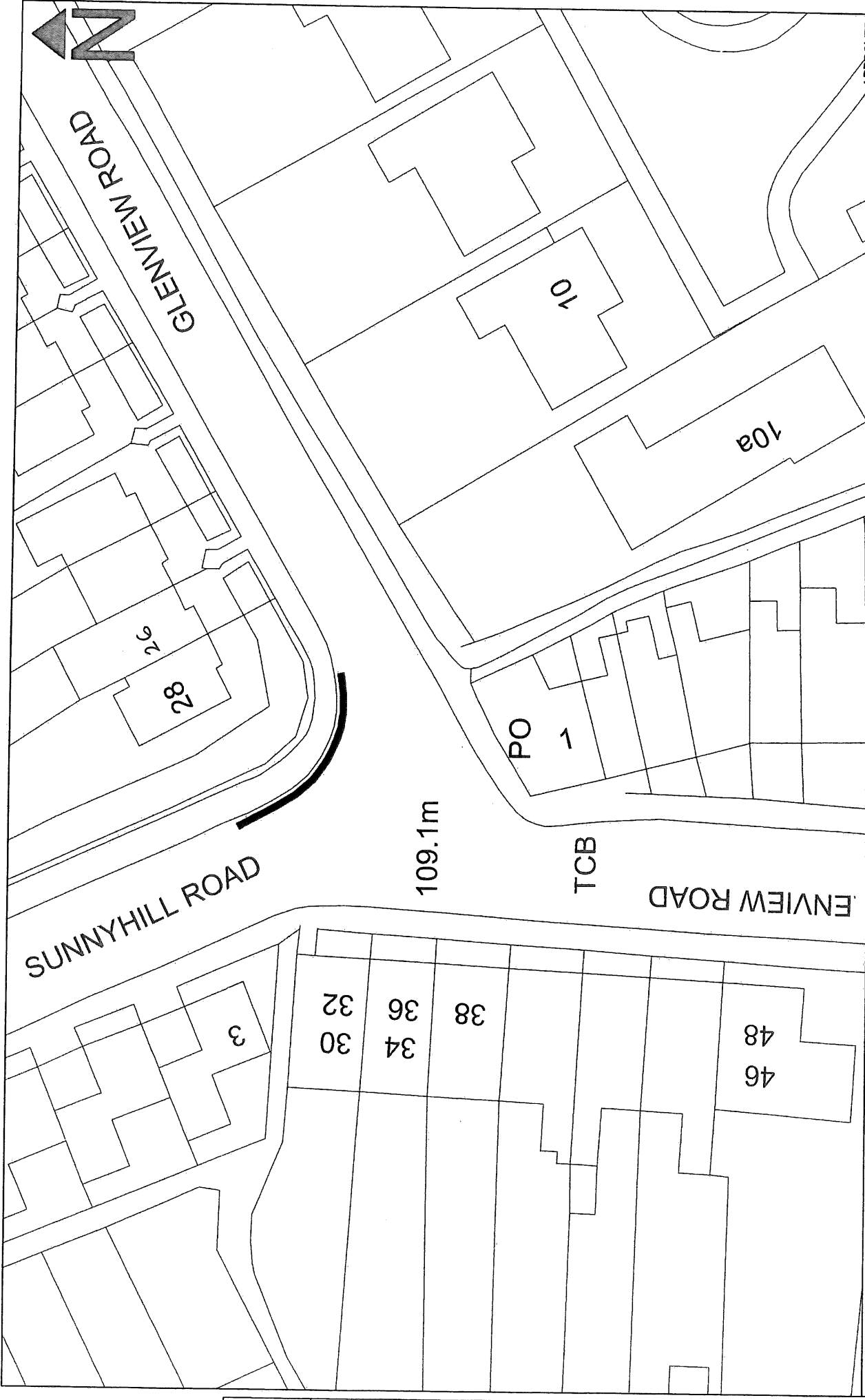

Key:
 Denotes double yellow line
 "No waiting at any time"

RT Proposal extents altered

Lot	Area	Area	Area
1	10	10a	26
28	30	32	34
36	38	46	48
PO 1			

COUNTY HALL
 Page Lane
 Harford, Hants
 SG13 8BN
 Phone: 01992 555555

HETLORDS
 1250
 1250

Division 14 Highway Locality Budget 2019/20
 Waiting Restrictions
 Glenview Road j/w Sunnyhill Road
 HC17000111401
 01 R0

© Crown copyright and database right to 2018 Ordnance Survey 1000 10000
 You are not permitted to copy, re-broadcast, distribute or sell any of the data in this
 document. You may only use the data in accordance with the terms of the licence.
 Licence: Ordnance Survey Licence for Local Authorities (OS/1000/1000)

