



Steve Barnes
Parking Development Manager
Dacorum Borough Council
The Forum
Marlowes
HEMEL HEMPSTEAD
HP1 1DN

Postal Point CHO242,
First Floor, East Link Corridor,
County Hall, Pegs Lane,
Hertford, Herts SG13 8DN

DX: 58237
Telephone: 01992 658237
Fax:
email: terry.curtis@hertfordshire.gov.uk
Contact: Terry Curtis

My ref: D/001A/17
Your ref:

Date: 10 July 2017

Dear Steve,

The Hertfordshire (Three Cherry Trees Lane, Swallowdale Lane, Finway Road, Boundary Way, Boundary Park, Buncefield Lane and Green Lane, Hemel Hempstead) (Prohibition of Waiting and Loading) (Experimental) Order 2017

I write to let you know that the above Order will come into effect on Tuesday 18 July 2017 and will replace the existing Experimental Order, originally published on 14 June 2017, on which an omission was discovered..

A Public Notice to advertise the making of the Order will appear in the Hemel Hempstead Gazette on 12 July 2017.

I enclose for your information a copy each of the Public Notice, Order(s), plan(s) and Statement of Reasons relating to the Order.

Yours sincerely,

Terry Curtis
Principal TRO Officer
Traffic Order Services
Highways Strategy & Compliance Group

HERTFORDSHIRE COUNTY COUNCIL

THE HERTFORDSHIRE (THREE CHERRY TREES LANE, FINWAY ROAD, SWALLOWDALE LANE, BOUNDARY WAY, BOUNDARY PARK, BUNCEFIELD LANE AND GREEN LANE, HEMEL HEMPSTEAD) (PROHIBITION OF WAITING and LOADING) (EXPERIMENTAL) ORDER 2017

NOTICE is given that the Hertfordshire County Council have made an Order under Section 9 of the Road Traffic Regulation Act 1984, to introduce experimental waiting restrictions in those lengths of road in Hemel Hempstead as specified in the Schedule to this Notice. The Order will come into effect on 18 July 2017, remain in effect for up to 18 months and will replace the existing Experimental Order.

Documents giving more detailed particulars of the Order may be inspected from 12 July 2017 during normal office hours, at the offices of Dacorum Borough Council, Civic Centre, Marlowes, Hemel Hempstead and at Main Reception, Hertfordshire County Council, County Hall, Pegs Lane, Hertford or viewed on line at www.hertfordshire.gov.uk/trafficorders by selecting Dacorum and looking at ref: D001A17

General enquiries relating to the proposals should be referred to the Highways Engineer concerned Ian Richardson tel: 01992 658486 or ian.richardson@hertfordshire.gov.uk

The Hertfordshire County Council will monitor the effects of the restrictions and may amend the experimental provisions, if considered necessary.

The Hertfordshire County Council will be considering in due course whether the provisions of this Order should be continued in force indefinitely. Objections to the provisions of this Order being continued in force indefinitely may be made in writing to Terry Curtis, Postal Point (CHO242), First Floor, East Link Corridor, County Hall, Pegs Lane, Hertford, Herts, SG13 8DN or tro.team@hertfordshire.gov.uk by 12 January 2018 stating the grounds on which they are made.

Any person wishing to question the validity of the Order, or of any provision contained in it on the grounds that it is not within the powers conferred by the Road Traffic Regulation Act 1984, or on the grounds that any requirement of the Act or any Instrument made under it has not been complied with in relation to the Order, may within 6 weeks from the date of this Notice, apply to the High Court for this purpose.

SCHEDULE: No waiting, loading or unloading at any time –effecting those sections of road herein listed and as set out in the Order and accompanying plan - Parts of Three Cherry Trees Lane, Finway Road, Swallowdale Lane, Buncefield Lane and Boundary Park and the whole of Boundary Way, and Green Lane.

County Hall
Hertford
Herts SG13 8DN

12 July 2017
John Wood
Chief Executive & Director of Environment

STATEMENT OF REASONS FOR MAKING

THE HERTFORDSHIRE (THREE CHERRY TREES LANE, FINWAY ROAD, SWALLOWDALE LANE, BOUNDARY WAY, BOUNDARY PARK, BUNCEFIELD LANE AND GREEN LANE, HEMEL HEMPSTEAD) (PROHIBITION OF WAITING and LOADING) (EXPERIMENTAL) ORDER 2017

Hertfordshire County Council is undertaking an experimental scheme of traffic control to evaluate the effect of the introduction of waiting restrictions in parts of Hemel Hempstead.

The experimental restrictions, which will prohibit the waiting and loading/unloading of vehicles, will be trialled in Three Cherry Trees Lane, Finway Road, Swallowdale Lane, Boundary Way, Boundary Park, Buncefield Lane and Green Lane, Hemel Hempstead.

These restrictions are to be introduced on an experimental basis in order that Officers can establish the effect on Central Maylands and surrounding residential areas caused by displacement of parked vehicles. If displacement of parked vehicles arises to such an extent, that large numbers of parked vehicles are displaced to the Central Maylands and other nearby residential areas, Officer will need to consider amendments to the Order as appropriate to address the issues. An Experimental Order will also test the effect on the wider network.

The experimental measures are also being considered as a means to protect the grass verges at the various locations and the results of the Experimental Order will need to be considered in order to establish if the provisions prevent vehicles causing damage.

This Order replaces the existing Order published on 14 June 2017. The original experimental Order was found to have an omission.

The duration of the experiment will be for an initial 6 months, while monitoring is undertaken, with any alterations being made in the subsequent 6 month period. A decision on whether to make the Order permanent will then be considered.

Therefore, it appears to the Highway Authority that it is necessary and expedient to make an Order for the purposes of carrying out an experimental scheme of traffic control.

The proposal has been subject to consultation with local and County Councillors representing the area and Dacorum Borough Council. The local Police, Ambulance, Fire and Rescue Service and Hertfordshire County Council Passenger Transport Unit have also been consulted.

HERTFORDSHIRE COUNTY COUNCIL
ROAD TRAFFIC REGULATION ACT 1984

Date of Order: 7 July 2017
Order No: 8103

**THE HERTFORDSHIRE (THREE CHERRY TREES LANE, FINWAY ROAD,
SWALLOWDALE LANE, BOUNDARY WAY, BOUNDARY PARK, BUNCEFIELD LANE
AND GREEN LANE, HEMEL HEMPSTEAD) (PROHIBITION OF WAITING and LOADING)
(EXPERIMENTAL) ORDER 2017**

The Hertfordshire County Council in exercise of their powers under Sections 9 and 10 of the Road Traffic Regulation Act 1984 (which said Act of 1984 is hereinafter referred to as "the Act of 1984") and Part IV of Schedule 9 of the Act of 1984 and of all other enabling powers and after consultation with the Chief Officer of Police in accordance with Part III of Schedule 9 of the Act of 1984, hereby make the following Order:-

1. This Order may be cited as "The Hertfordshire (Three Cherry Trees Lane, Finway Road, Swallowdale Lane, Boundary Way, Boundary Park, Buncefield Lane and Green Lane, Hemel Hempstead) (Prohibition of Waiting and Loading) (Experimental) Order 2017" and shall come into effect on Tuesday 18 July 2017 and remain in effect for a period of up to 18 months.
2. Save as provided in Article 3 of this Order no person shall cause or permit any vehicle to wait, load or unload at any time in those lengths of Three Cherry Trees Lane, Finway Road, Swallowdale Lane, Boundary Way, Boundary Park, Buncefield Lane and Green Lane, Hemel Hempstead as specified in the Schedule to this Order.
3. (1) Nothing in Article 2 of this Order applies to the lengths of road restricted by that Article (which said lengths of road are referred to in this Article as "the restricted area") in relation to –
 - (a) a vehicle being used for Fire and Rescue, Ambulance or Police purposes.
 - (b) anything done with the permission of or at the direction of a Police Constable in uniform; or with permission of a Civil Enforcement Officer as defined by the Traffic Management Act 2004 and appointed by Dacorum Borough Council.
 - (c) a vehicle which is prevented from proceeding by circumstances beyond the drivers control or which has stopped in order to avoid injury or damage to persons or property or when required to do so by law;
 - (d) a vehicle which is stationary in order that it may be used for one or more of the purposes specified in sub-Article (2) of this Article and which cannot reasonably be used for such a purpose without stopping in the restricted area;
 - (e) a marked vehicle which, whilst used by a universal service provider in the course of the provision of a universal postal service, is stationary only for so long as may be reasonably necessary for postal packets to be delivered or collected;

In this Article -
The expressions "universal service provider", "provision of a universal postal Service" and "postal packet" shall bear the same meanings as in Section 65 of the Postal Services Act 2011.
- (2) The "purposes" referred to in sub-Article (1)(d) of this Article are –
 - (a) any operation involving building, demolition or excavation;
 - (b) the removal of any obstruction to traffic;

- (c) the maintenance, improvement or reconstruction of a road;
 - (d) constructing, improving, maintaining, or cleaning of any street furniture; or
 - (e) the laying, erection, alteration, repair or cleaning of any sewer or of any main pipe or apparatus for the supply of gas, water or electricity, or of any telecommunications apparatus kept or installed for the purposes of a telecommunications code system or of any other telecommunications apparatus lawfully kept installed in any position.
4. The Interpretation Act 1978 shall apply for the interpretation of this Order as it applies for the interpretation of an Act of Parliament.
 5. The provisions of the following Orders are hereby suspended but only in so far as they are affected by the restrictions imposed by this Order and only whilst this Order remains in effect:

The Borough of Dacorum (Various Roads) (Prohibition and Restriction of Waiting) (No 2) Order 1993

The Borough of Dacorum (Various Roads) (prohibition and Restriction of Waiting) (No 2) Order 1996
 6. The Hertfordshire (Three Cherry Trees Lane, Swallowdale Lane, Boundary Way, Boundary Park, Buncefield Lane and Green Lane, Hemel Hempstead) (Prohibition of Waiting) (Experimental) Order 2017 is hereby revoked.
 7. The restrictions imposed by this Order shall be in addition to and not in derogation from any restriction or requirement imposed by any other regulations made or having effect as if made under the Act of 1984 or by or under any other enactment.

SCHEDULE

lengths of Three Cherry Trees Lane, Finway Road, Swallowdale Lane, Boundary Way, Boundary Park, Buncefield Lane, Green Lane, Hemel Hempstead – no waiting, loading and unloading at any time

| | |
|--|---|
| Three Cherry Trees Lane (north east side) | from a point 35 metres south east of a point in line with the projected east kerbline of Boundary Way north westwards for approximately 705 metres to a point 16 metres north west of a point in line with the projected north west kerbline of Finway Road. |
| (south west side) | <ol style="list-style-type: none"> (a) from a point in line with the projected south east kerbline of Swallowdale Lane south eastwards for approximately 308 metres to a point in line with the projected west kerbline of Boundary Way. (b) from a point in line with the projected east kerbline of Boundary Way south eastwards for 34 metres. (c) from a point in line with the projected south east kerbline of Finway Road south eastwards for approximately 262 metres to a point 72 metres north west of a point in line with the projected north west kerbline of Swallowdale Lane. |
| Finway Road (north west side) | from a point in line with the projected south west kerbline of Three Cherry Trees Lane south westwards for approximately 11 metres to a point 10 metres north east of a point in line with the south west boundary of 1 Finway Road. |
| (south east side) | from a point in line with the projected south west kerbline of Three Cherry Trees Lane south westwards for approximately 14 metres to a point 10 metres north east of a point in line with the south west boundary of 1 Finway Road. |

Swallowdale Lane
(south east side)

from a point in line with the projected south west kerblin of Three Cherry
Trees Lane south westwards for 30 metres.

Boundary Way
(both sides)

from a point in line with the projected south kerblin of Three Cherry Trees
Lane southwards and south eastwards for its entire length, including the
access road on its southern side leading to the Caravan Storage facility
and the entire circumference of the roundabout at its junction with
Buncefield Lane.

Boundary Way
(West spur)
(both sides)

from a point in line with the projected west kerblin of Boundary Way
westwards for 12 metres.

Boundary Park
(both sides)

from a point in line with the projected north east kerblin of Boundary
Way north eastwards for 12 metres.

Buncefield Lane
(south east side)

from a point in line with the projected south kerblin of Boundary Way south
westwards for 65 metres.

(north west side)

from a point in line with the projected south west kerblin of Boundary Way
south westwards for 35 metres.

(both sides)

from a point in line with the projected north east kerblin of Boundary Way
north eastwards for 12 metres.

Green Lane
(both sides)

from a point in line with the projected south west kerblin of Three Cherry
Trees Lane south westwards and southwards for its entire length to a point
in line with the projected north kerblin of Breakspear Way, including the
entire circumference of the roundabout at its junction with Boundary Way.

IN WITNESS whereof the Common Seal of the Hertfordshire County Council was
hereunto affixed this 7th day of July 2017.

The Common Seal of
Hertfordshire County Council
was hereunto affixed
in the presence of:-

) Mary Cormack
)
)
) 923/17

**Assistant
Chief Legal Officer**

Mary Cormack
Asst Chief Legal Officer

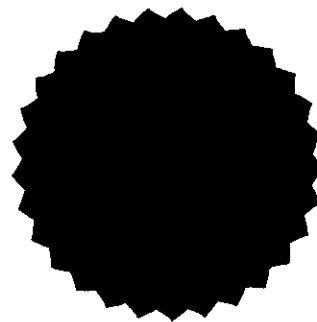

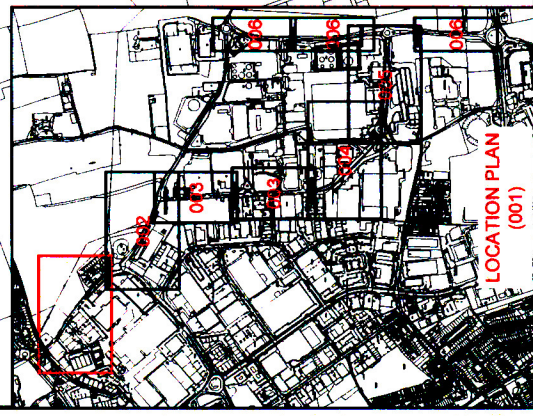
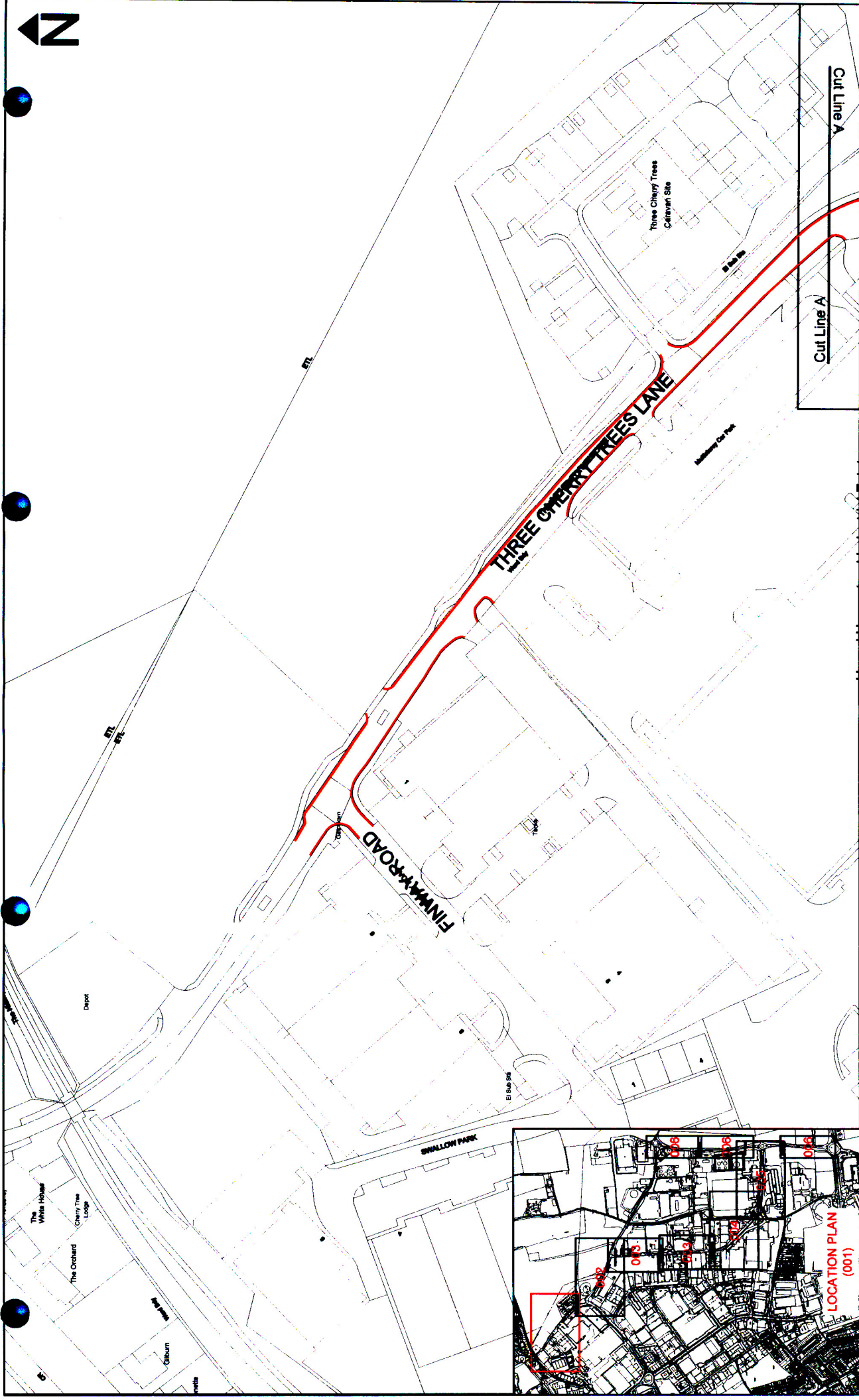

KEY:

No Waiting & Loading At Any Time Parking Restriction



© Crown copyright and database right is 2017 Ordnance Survey 100019806
You are not permitted to copy, sell, borrow, distribute or use any of the data in this product in any form.
This information is not appropriate for navigation and is intended for reference only.



MAYNARDS BUSINESS PARK, HERMEL HEMPSTEAD
EXPERIMENTAL TRO - VARIOUS ROADS

TRO DRAWINGS

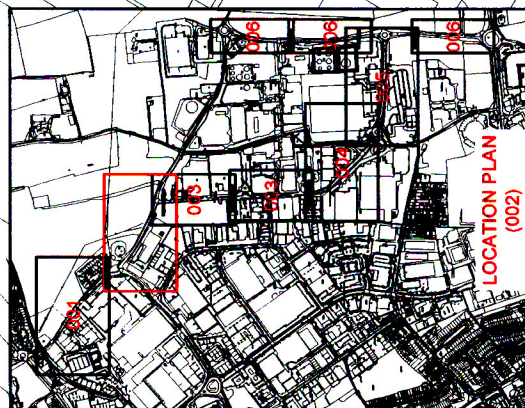
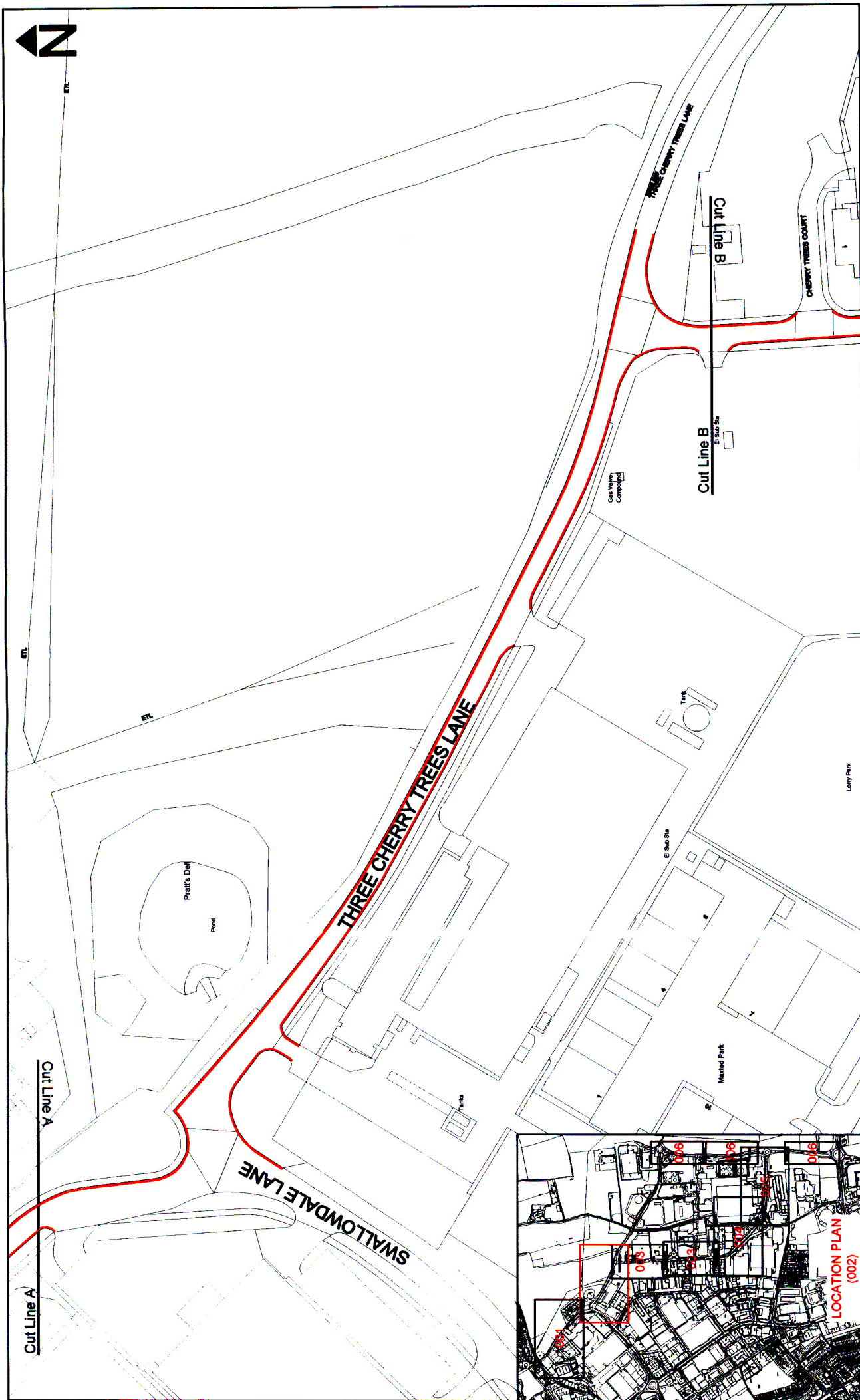

KEY:

— No Waiting & Loading At Any Time Parking Restriction

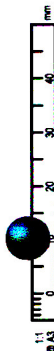

© Crown copyright and database right is 2017 Ordnance Survey 100049066

You are not permitted to copy, adapt, amend, distribute or sell any of the data in this product in any form.
(This restriction may not apply to LMS and its licensed contractors, agents & partners.)



TRO DRAWINGS

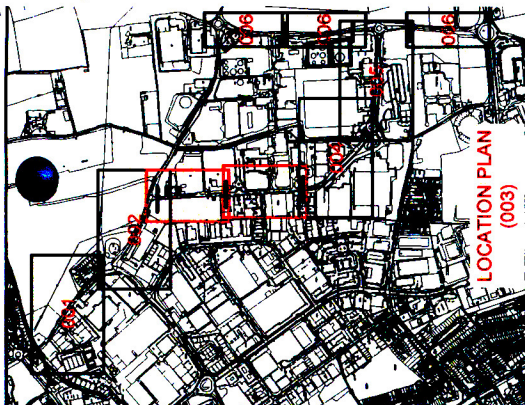

KEY:

— No Waiting & Loading
At Any Time Parking
Restriction



Herfordshire
COUNTY HALL
Page Lane
Herford, Herefordshire
HR13 5DN
Phone: 01982 855555

© Crown copyright and database right to 2017 Ordnance Survey 100018026

This plan is not permitted to copy, reproduce, distribute or use in any form without the prior written permission of the author.

(This restriction may not apply to the use of the plan in connection with a specific project.)

1:1250

MAYLANDS BUSINESS PARK
HEMEL Hempstead
EXPERIMENTAL TRO - VARIOUS ROADS

TRO DRAWINGS

003

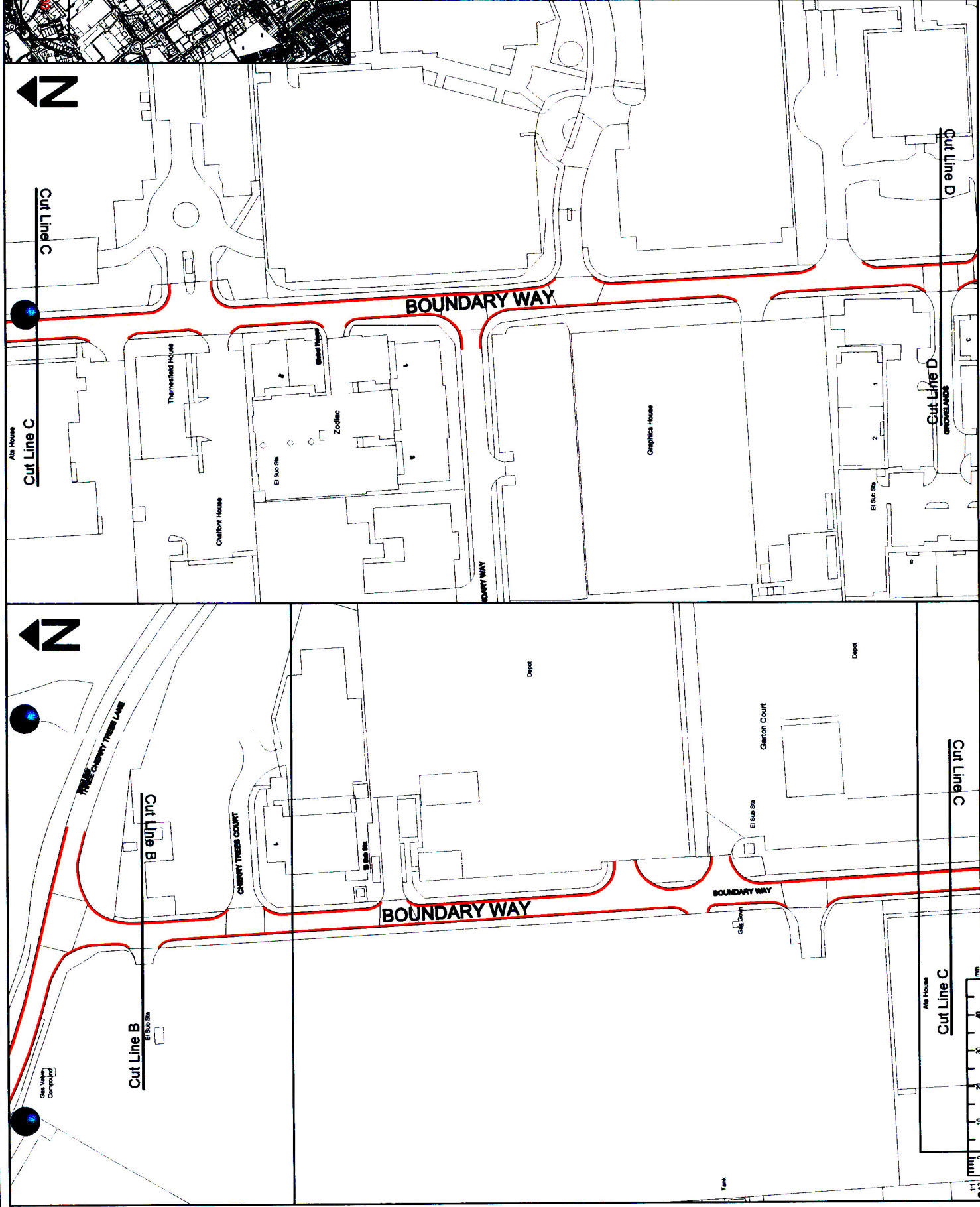

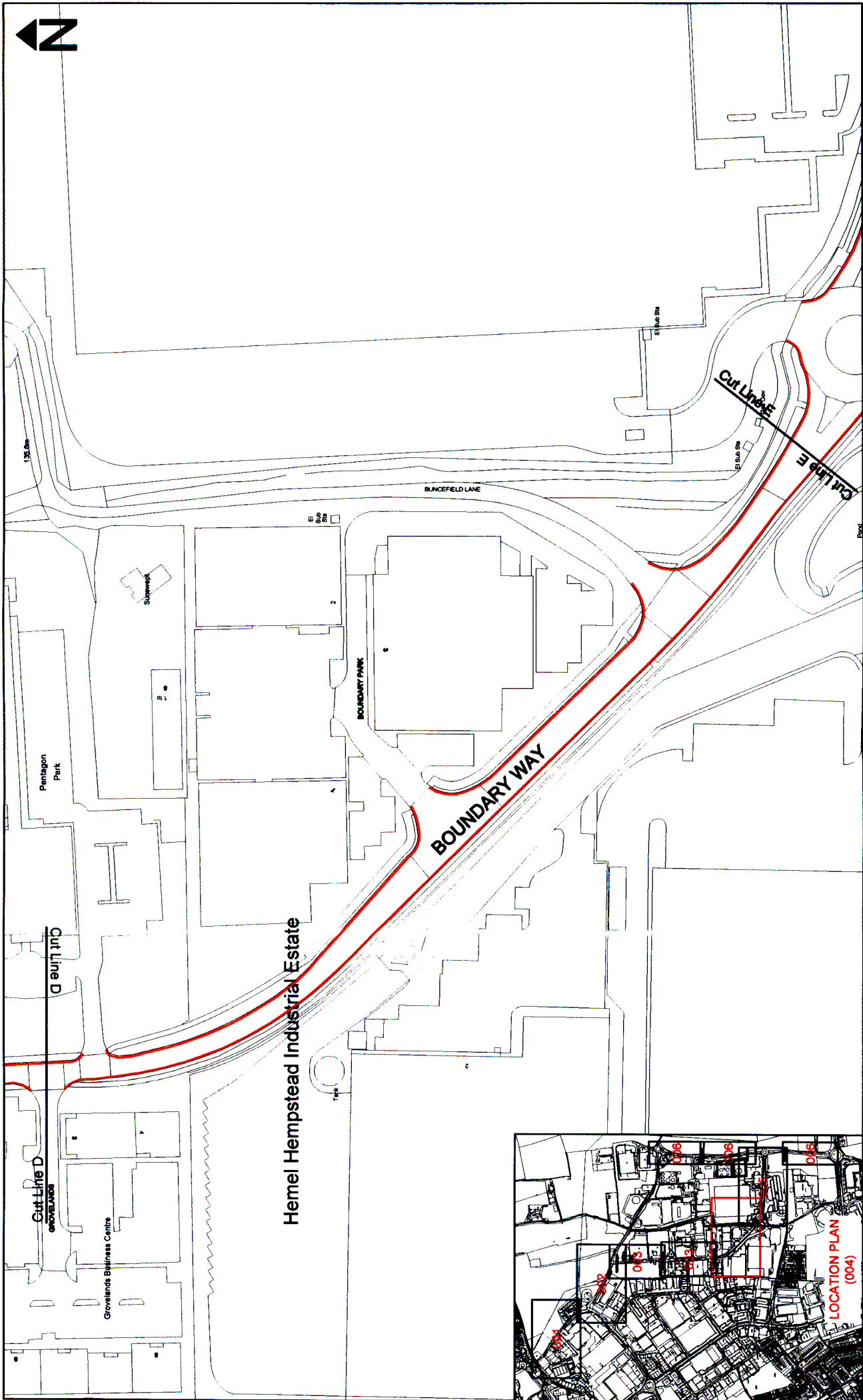

— No Waiting & Loading At Any Time Parking Restriction



Hertfordshire
COUNTY COUNCIL
Pegs Lane
Hertford, Herts
SG13 8DN
Phone: 01992 866666

© Crown copyright and database right to 2017 Ordnance Survey 100019606

You are not permitted to copy, sub-license, distribute or sell any of this data to third parties
any form.
(This restriction may not apply to HCC and its licensed contractors, agents & partners.)

| | | |
|----|--|-------|
| IR | | |
| IR | | 1:250 |

**MAYLANDS BUSINESS PARK, HEMEL HEMPSTEAD
EXPERIMENTAL TRO - VARIOUS ROADS**

TRO DRAWINGS

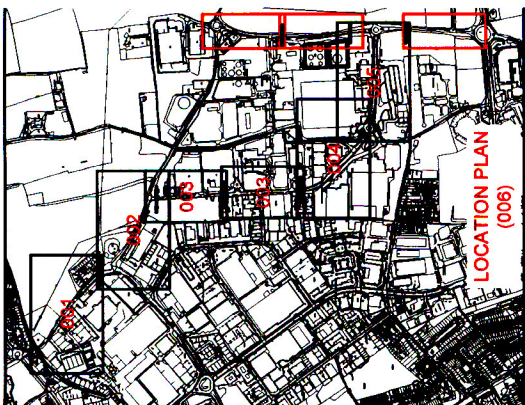

KEY:

— No Waiting & Loading
At Any Time Parking
Restriction



COUNTY HILL
Hertford, Herts
SG13 6BN
Phone: 01462 855555

© Crown copyright and database right is 2017 Ordnance Survey 100019808

You are not permitted to copy, re-produce, distribute or sell any of this data to third parties in any form.
(This restriction may not apply to AEC and its licensed contractors, agents & partners.)

1:1250
MAYLANDS BUSINESS PARK
HEMEL Hempstead
EXPERIMENTAL TR0 - VARIOUS ROADS

TRO DRAWINGS

