

**HERTFORDSHIRE COUNTY COUNCIL**  
**ROAD TRAFFIC REGULATION ACT 1984**

Date of Order: 23 February 2007  
 Order No: 7087

**THE HERTFORDSHIRE (HIGH STREET, KING STREET, GEORGE STREET and  
 SURSHAM COURT, MARKYATE) (RESTRICTION OF WAITING) ORDER 2006**

The Hertfordshire County Council in exercise of their powers under Sections 1, 2 and 3 of the Road Traffic Regulation Act 1984 (which said Act of 1984 is hereinafter referred to as "the Act of 1984"), and of all other enabling powers and after consultation with the Chief Officer of Police in accordance with Part III of Schedule 9 of the Act of 1984, hereby make the following Order:-

1. This Order may be cited as "The Hertfordshire (High Street, King Street, George Street and Sursham Court, Markyate) (Restriction of Waiting) Order 2006" and shall come into operation on Monday 5 March 2007.
2. Save as provided in Articles 3, 4 and 5 of this Order no person shall cause or permit any vehicle to wait at any time in those lengths of High Street, King Street, George Street and Sursham Court, Markyate specified in the Schedule to this Order.
- 3(1) Nothing in Article 2 of this Order applies to the lengths of road restricted by that Article (which said lengths of road are referred to in this Article as "the restricted area") in relation to –
  - (a) a vehicle being used for Fire and Rescue, Ambulance or Police purposes.
  - (b) anything done with the permission of or at the direction of –
    - (i) a police officer in uniform;
    - (ii) in respect of any of the lengths of road in the restricted area which are in a special parking area designated under Part II of the Road Traffic Act 1991 or Schedule 3 to that Act, a parking attendant appointed under Section 63A of the Act of 1984;
  - (c) a vehicle which is prevented from proceeding by circumstances beyond the drivers control or which has stopped in order to avoid injury or damage to persons or property or when required to do so by law;
  - (d) a vehicle which is stationary in order that it may be used for one or more of the purposes specified in sub-Article (2) of this Article and which cannot reasonably be used for such a purpose without stopping in the restricted area;
  - (e) a marked vehicle which, whilst used by a universal service provider in the course of the provision of a universal postal service, is stationary only for so long as may be reasonably necessary for postal packets to be delivered or collected;

In this Article -

The expressions "universal service provider", "provision of a universal postal Service" and "postal packet" shall bear the same meanings as in the Postal Services Act 2000.

- (2) The "purposes" referred to in sub-Article (1)(d) of this Article are –
  - (a) any operation involving building, demolition or excavation;
  - (b) the removal of any obstruction to traffic;

- (c) the maintenance, improvement or reconstruction of a road;
  - (d) constructing, improving, maintaining, or cleaning of any street furniture; or
  - (e) the laying, erection, alteration, repair or cleaning of any sewer or of any main pipe or apparatus for the supply of gas, water or electricity, or of any telecommunications apparatus kept or installed for the purposes of a telecommunications code system or of any other telecommunications apparatus lawfully kept installed in any position.
4. Nothing in Article 2 of this Order applies to the lengths of road restricted by that Article (which said lengths of road are referred to in this Article as "the restricted area") so as to render it unlawful to cause or permit any vehicle to wait only for so long as may be reasonably necessary –
- (a) to enable goods to be loaded on or unloaded from the vehicle from or to premises adjacent to the restricted area; or
  - (b) to enable a passenger to board or alight and to load and unload any luggage.
- 5.(1) Nothing in Article 2 of this Order shall render it unlawful to cause or permit a disabled person's vehicle which displays in the relevant position a disabled person's badge and a parking disc, to wait at any time in the length of road as specified in the Schedule of this Order for a period not exceeding 3 hours (not being a period separated by an interval of less than 1 hour from a previous period of waiting by the same vehicle in the same length of road).

(2) In this Article -

"disabled person's vehicle" has the same meaning as in Section 142(1) of the Act of 1984;

"disabled person's badge" has the same meaning as in Section 142(1) of the Act of 1984;

"parking disc" has the same meaning as given in Regulation 8(5) of The Local Authorities' Traffic Orders (Exemptions for Disabled Persons) (England) Regulations 2000; and

"relevant position" means

- i) A vehicle displays a disabled person's badge in the relevant position if:-
  - a) in the case of a vehicle fitted with a dashboard or facia panel, the badge is exhibited thereon so that Part 1 of the badge is legible from outside the vehicle; or
  - b) in the case of a vehicle not fitted with a dashboard or facia panel, the badge is exhibited in a conspicuous position on the vehicle so that Part 1 of the badge is legible from outside the vehicle;
- ii) A vehicle displays a parking disc in the relevant position if:-
  - a) in the case of a vehicle fitted with a dashboard or facia panel, the disc is exhibited thereon so that the quarter hour period during which the period of waiting began is legible from outside the vehicle; or
  - b) in the case of a vehicle not so fitted, the disc is exhibited in a conspicuous position on the vehicle so that the quarter hour period during which the period of waiting began is legible from outside the vehicle.

6. The Interpretation Act 1978 shall apply for the interpretation of this Order as it applies for the Interpretation of an Act of Parliament.
7. The restrictions imposed by this Order shall be in addition to and not in derogation from any restriction or requirement imposed by any other regulations made or having effect as if made under the Act of 1984 or by or under any other enactment.

### **SCHEDULE**

#### **lengths of High Street, King Street, George Street and Sursham Court, Markyate – no waiting at any time**

- High Street (south west side) (a) from its junction with the north west kerbline of King Street north westwards for 10 metres.
- (b) from its junction with the south east kerbline of King Street south eastwards for 10 metres.
- King Street (south east side) (a) from its junction with the south west kerbline of High Street south westwards for 21.5 metres.
- (b) from its junction with the north east kerbline of George Street north eastwards for 17 metres.
- (north west side) (a) from its junction with the south west kerbline of High Street south westwards for 13 metres.
- (b) from its junction with the north east kerbline of George Street north eastwards for 21 metres.
- George Street (north east side) (a) from its junction with the north west kerbline of King Street north westwards for 6 metres.
- (b) from its junction with the south east kerbline of King Street south eastwards for 16.5 metres.
- (south west side) from a point 3.5 metres south east of a point in line with the south east wall of 32 George Street south eastwards for 10 metres.
- Sursham Court (south west side) from a point in line with the south east wall of 52/54 George Street south eastwards for 7 metres.

IN WITNESS whereof the Common Seal of the Hertfordshire County Council was here unto affixed this 23<sup>rd</sup> day of February 2007.

The Common Seal of  
Hertfordshire County Council  
was hereunto affixed  
in the presence of:- )  
)  
)  
)

**ANDREW L DAYCOCK**  
**County Secretary**

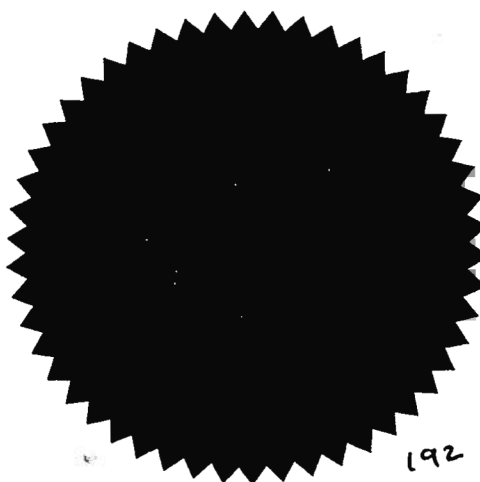



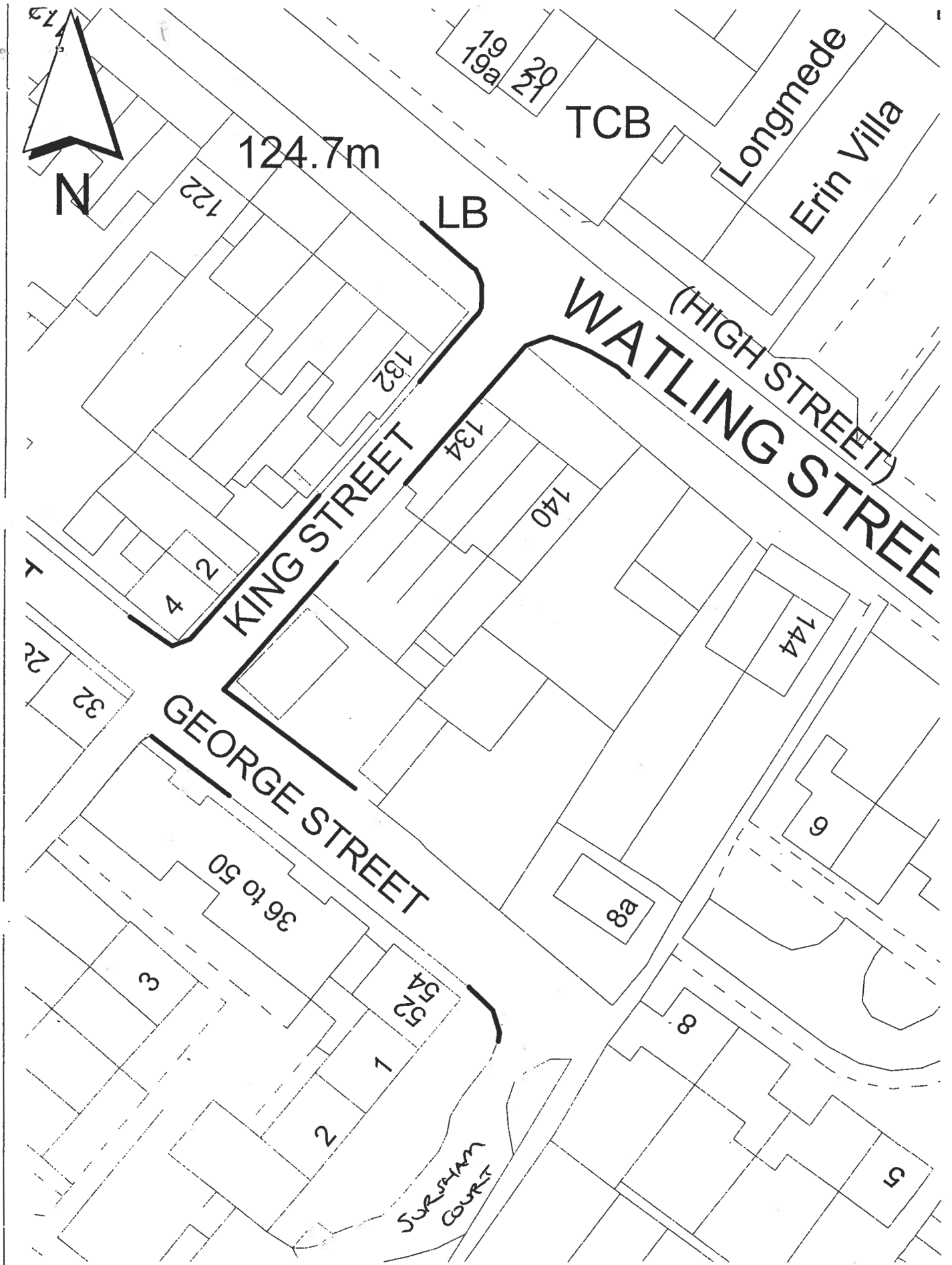

Project Title **PROPOSED 'NO WAITING  
AT ANY TIME, GEORGE  
STREET, MARKYATE**

Drawing Title

Drawing No

Scale **1:500**

Date **26/08/06**  
Drawn By



**MID-WEST HERTFORDSHIRE HIGHWAYS**  
2nd Floor Trident House  
42 - 48 Victoria Street  
St Albans  
Hertfordshire AL1 3 HZ

