

**The Essex County Council (Colchester Borough) (Waiting Restriction)
(Consolidation) (Amendment No.50) Order 2013**

WHEREAS the Essex County Council in exercise of its powers under Sections 1(1), 2(1) to (3), 4(1), 4(2), 32, 35, 45, 46, 49 and 53 of and Part IV of Schedule 9 to the Road Traffic Regulation Act 1984 ("the Act") and of all other enabling powers and after consultation with the Chief Officer of Police in accordance with Part III of Schedule 9 to the Act hereby makes the following Order:-

1. This Order may be cited as The Essex County Council (Colchester Borough) (Waiting Restriction) (Consolidation) (Amendment No 50) Order 2013 and shall come into operation on 28 October 2013.
2. The Essex County Council (Colchester Borough) (Waiting Restriction) (Consolidation) Order 2008 (hereinafter referred to as the '2008 Order'), is hereby varied to the extent detailed in the Schedule to this Order.
3. The prohibitions and restrictions imposed by this Order shall be in addition to and not in derogation from any restrictions or requirement imposed by any regulations made or having effect as if made under the Act or by any other enactment.

Sealed with the Common Seal of the Essex County Council this twenty-first day of October Two Thousand and Thirteen.

THE COMMON SEAL OF ESSEX)
COUNTY COUNCIL was hereunto)
affixed in the presence of:-)



Robert

Attesting Officer

Schedule

**No Waiting At Any Time restrictions to be introduced or revoked
(Existing restrictions contained within Schedule 1 of the 2008 Order)**

TO INTRODUCE:

BROOK STREET, WIVENHOE – South side from its junction with St John's Road eastwards to its junction with Anglesea Road.

TO REVOKE:

BROOK STREET, WIVENHOE – South side from its junction with Walter Radcliffe Way north and east to its junction with Anglesea Road.

TO INTRODUCE:

COOKS CRESCENT, WIVENHOE

- (i) North side from its junction with Walter Radcliffe Road northwards then eastwards for a distance of approximately 20 metres.
- (ii) North side from a point 36 metres north and east of its junction with Walter Radcliffe Road for the remainder of its length including the turning head.
- (iii) South side for its entire length.

ST JOHN'S ROAD, WIVENHOE

- (i) West side for its entire length.
- (ii) East side from its junction with Brook Street southwards for a distance of approximately 3 metres.
- (iii) East side from a point 14 metres south of its junction with Brook Street southwards for a distance of approximately 32 metres.
- (iv) East side from a point 61 metres south of its junction with Brook Street southwards to its junction with Walter Radcliffe Road.
- (v) South side from a point 14 metres south of Brook Street where the road widens into a square eastwards for a distance of approximately 3 metres.

WALTER RADCLIFFE ROAD, WIVENHOE

- (i) North side from its junction with St John's Road eastwards to its junction with Cooks Crescent.
- (ii) South side from its junction with St John's Road eastwards for a distance of approximately 8 metres.
- (iii) South side from a point 28 metres east of its junction with St John's Road eastwards for a distance of 10 metres.
- (iv) South side from a point 63 metres east of its junction with St John's Road eastwards to a point 1metre east of the western flank wall of No.40 Walter Radcliffe Road.
- (v) South and west side from a point 16 metres east of the western flank wall of No.40 Walter Radcliffe Road eastwards and southwards for the remainder of its length including the turning head.
- (vi) East side from its junction with Cooks Crescent southwards to a point 4 metres south of the northern flank wall of No.29 Walter Radcliffe Road
- (vii) East side from a point 19 metres south of the northern flank wall of No.29 Walter Radcliffe Road for the remainder of its length including the turning head.

ESSEX COUNTY COUNCIL	
Ordered to be Sealed	17 th July 2013
Number in Seal Book	3102.

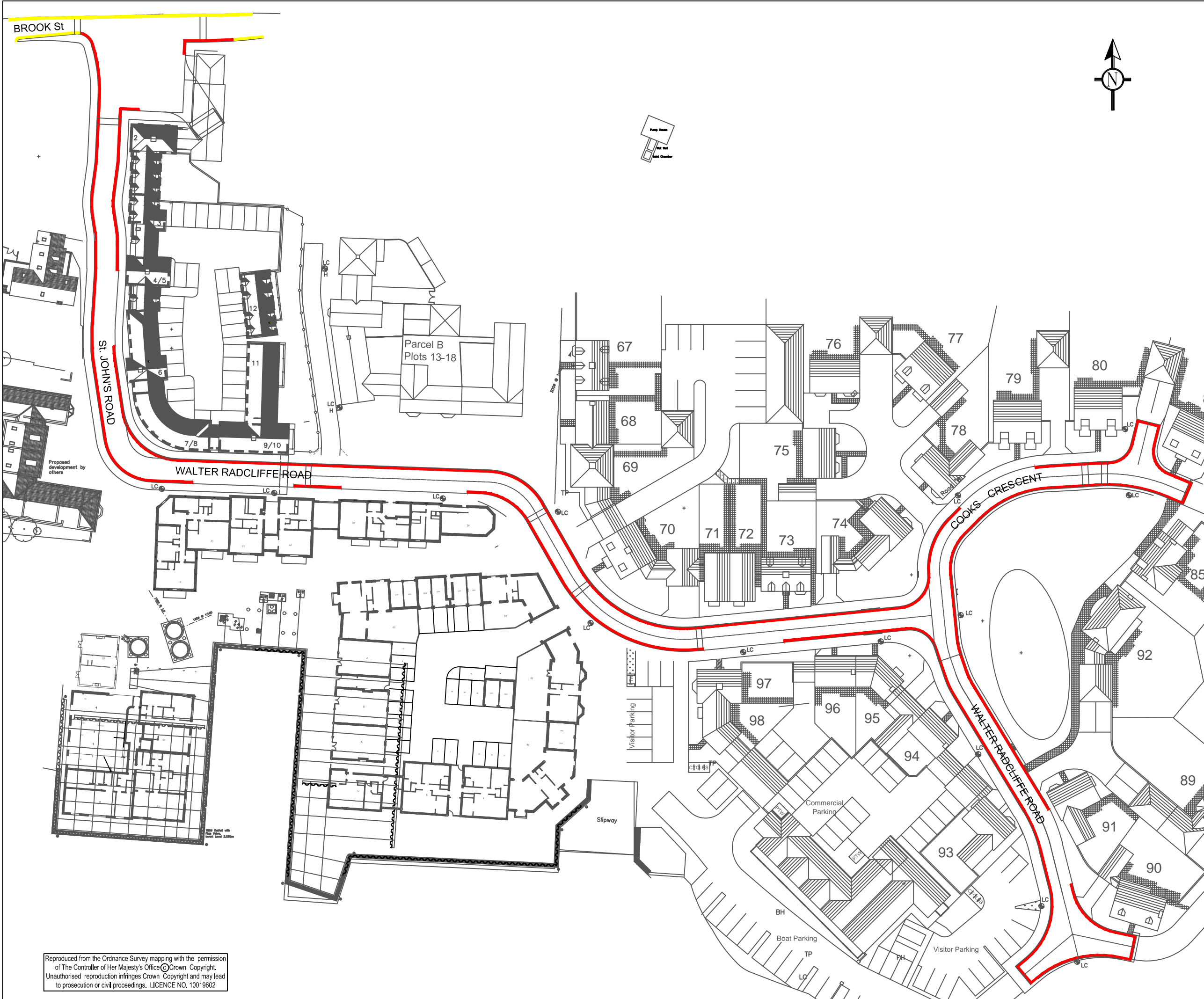

NOTES:

- PROPOSED NO WAITING AT ANY TIME
- EXISTING NO WAITING AT ANY TIME

A	Minor amendments to proposals	19/3/13	PTM	PB
Rev	Description	Date	Drawn	Chk'd

Essex County Council
 Robert Overall
 Executive Director for Environment
 Sustainability & Highways

Drawing Title:
**PROPOSED
 "NO WAITING AT ANY TIME"
 FORMER COOKS SHIPYARD,
 WIVENHOE**

Scale: 1:500@A2	Drawn By: RDJ
Date: 08/01/13	Chk'd By:
Apr'd By:	File Ref: PLA/3/45

East Area Highway Office
 910 The Crescent
 Colchester Business Park
 Colchester
 Essex CO4 9QQ
 Telephone : 0845 603 7620 Fax : 01206 838608

Drawing Number ECC/PLA/3/45/TRO/01	Revision: A
--	-----------------------

Reproduced from the Ordnance Survey mapping with the permission of The Controller of Her Majesty's Office © Crown Copyright. Unauthorised reproduction infringes Crown Copyright and may lead to prosecution or civil proceedings. LICENCE NO. 10019602

File Path: X:\EVE\MAN\SCHEMES\COLCHESTER\PLA-3-45