

## THE ESSEX COUNTY COUNCIL (CHELMSFORD CITY) (PROHIBITION OF WAITING, LOADING AND STOPPING) AND (ON-STREET PARKING PLACES) (CIVIL ENFORCEMENT AREA) (AMENDMENT NO.4) ORDER 2020

**NOTICE IS HEREBY GIVEN** that Chelmsford City Council acting on behalf of the South Essex Parking Partnership in exercise of the delegated powers of the traffic authority Essex County Council granted under an agreement dated 31 March 2011 (and subsequently varied by Deed of Variation on 15 June 2011 and 27 July 2012) proposes to make the above Order under Sections 1(1), 2 (1) to (3), 4(1), 4(2), 32(1), 35(1), 45, 46, 49, 53 and Parts III and IV of Schedule 9 of the Road Traffic Regulation Act 1984.

### Effect of the Order:

All measurements are taken as accurately as possible and are taken from the extended kerb line unless stated otherwise.

### 1. To revoke 'No Waiting at Any Time' on the following lengths of road in the City of Chelmsford

|                                 |   |
|---------------------------------|---|
| <b>Mildmay Road, Chelmsford</b> | <p><b>Northwest side</b> – from a point 10 metres southwest of its junction with Hall Street south-westwards for 13 metres.</p> <p><b>Southeast side</b> – from a point 10 metres northeast of its junction with Grove Road north-eastwards for 5 metres.</p> <p><b>Southeast side</b> – from a point 5 metres southwest of its junction with Grove Road south-westwards for 10 metres.</p> |
|---------------------------------|---|

### 2. To revoke 'Permit Holders Only Mon to Fri 10am-11am Zone 1' on the following lengths of road in the City of Chelmsford

|                                 |  |
|---------------------------------|--|
| <b>Maltese Road, Chelmsford</b> | <p><b>Northwest side</b> - from a point 157 metres north of its junction with Rainsford Road for a distance of 114 metres in a north-easterly direction.</p> <p><b>North side</b> - from a point 310 metres northeast of its junction with Rainsford Road in an easterly direction for a distance of 104 metres.</p> |
|---------------------------------|--|

### 3. To revoke 'Permit Holders Only Mon to Sat 8am-11pm Zone 4' on the following lengths of road in the City of Chelmsford

|                                 |   |
|---------------------------------|---|
| <b>Mildmay Road, Chelmsford</b> | <b>Southeast side</b> – from a point 58 metres southwest of its junction with Goldlay Road in a south-westerly direction for a distance of 14 metres. |
|---------------------------------|---|

### 4. To revoke 'No Waiting Mon to Fri 2pm-3pm' on the following lengths of road in the City of Chelmsford

|                                   |  |
|-----------------------------------|--|
| <b>Mandeville Way, Chelmsford</b> | <p><b>West side</b> – from a point 6 metres north of its junction with Warren Close northwards for a distance of 4 metres.</p> <p><b>West side</b> – from its junction with Warren Close southwards for a distance of 10 metres.</p> |
|-----------------------------------|--|

### 5. To revoke 'No Waiting Mon to Fri 10am-11am' on the following lengths of road in the City of Chelmsford

|                                   |   |
|-----------------------------------|---|
| <b>Mandeville Way, Chelmsford</b> | <b>West side</b> – from its junction with Warren Close northwards for a distance of 6 metres. |
|-----------------------------------|---|

### 6. To introduce 'No Waiting at Any Time' on the following lengths of roads in the City of Chelmsford

|                                   |   |
|-----------------------------------|---|
| <b>Mandeville Way, Broomfield</b> | <b>West side</b> – from a point 10 metres north of its junction with Warren Close to a point 10 metres south of its junction with Warren Close.   |
| <b>Honey Close, Chelmsford</b>    | <b>Both sides</b> – from its junction with Beehive Lane north-westwards for 25 metres.  |
| <b>Beehive Lane, Chelmsford</b>   | <b>Northwest side</b> – from a point 15 metres southwest of its junction with Honey Close north-eastwards for 42 metres.  |
| <b>Roxwell Road, Chelmsford</b>   | <b>South side</b> – from a point 15 metres west of its junction with Roxwell Avenue eastwards for 37 metres.  |
| <b>Roxwell Avenue, Chelmsford</b> | <b>Both sides</b> – from its junction with Roxwell Road south-eastwards for 15 metres.  |
| <b>Waterson Vale, Chelmsford</b>  | <p><b>Northeast side</b> – from the roundabout with Princes Road south-eastwards to a point 9 metres southeast of its junction with Burghley Way.</p> <p><b>Northeast side</b> – from a point 10 metres northwest of its junction with Moulsham</p> |

|                                 |   |
|---------------------------------|---|
|                                 | Chase south-eastwards to a point 10 metres southeast of its junction with Moulsham Chase.<br><b>Southwest side</b> - from the roundabout with Princes Road south-eastwards to a point 37 metres northwest of its junction with Burghley Way.<br><b>Southwest side</b> – from a point 15 metres northwest of its junction with Burghley Way south-eastwards for a distance of 87 metres. |
| <b>Mildmay Road, Chelmsford</b> | <b>Southeast side</b> – from a point 58 metres southwest of its junction with Goldlay Road in a south-westerly direction for a distance of 14 metres.   |

**7. To introduce 'Permit Holders Only Mon to Sat 8am-11pm Zone 4' on the following lengths of road in the City of Chelmsford**

|                                 |  |
|---------------------------------|--|
| <b>Mildmay Road, Chelmsford</b> | <b>Northwest side</b> – from a point 10 metres southwest of its junction with Hall Street south-westwards for 13 metres.<br><b>Southeast side</b> – from a point 10 metres northeast of its junction with Grove Road north-eastwards for 5 metres.<br><b>Southeast side</b> – from a point 5 metres southwest of its junction with Grove Road south-westwards for 10 metres. |
|---------------------------------|--|

**8. To introduce 'Permit Holders Only Mon to Fri 10am-2pm Zone 1' on the following lengths of road in the City of Chelmsford**

|                                 |   |
|---------------------------------|---|
| <b>Maltese Road, Chelmsford</b> | <b>Northwest side</b> - from a point 157 metres north of its junction with Rainsford Road for a distance of 114 metres in a north-easterly direction.<br><b>North side</b> - from a point 310 metres northeast of its junction with Rainsford Road for a distance of 104 metres in an easterly direction. |
|---------------------------------|---|

**9. To introduce a 'Permit Parking Area Mon to Fri 10am-11am & 2pm-3pm Zone 7' on the following lengths of road in the City of Chelmsford**

|                                 |  |
|---------------------------------|--|
| <b>Dixon Avenue, Chelmsford</b> | <b>Northwest side</b> – from a point 50 metres southwest of its junction with Kings Road south-westwards for 126 metres.<br><b>Northwest side</b> – from a point 7 metres northeast of its junction with Swiss Avenue north-eastwards for 13 metres.<br><b>Southeast side</b> - from a point 50 metres southwest of its junction with Kings Road south-westwards for 147 metres.<br><b>Both sides</b> - from a point 5 metres southwest of its junction with Swiss Avenue south-westwards for 28 metres. |
|---------------------------------|--|

**10. To introduce a 'Permit Parking Area Mon to Sat 8am-6pm Zone 5' on the following lengths of road in the City of Chelmsford**

|                                  |   |
|----------------------------------|---|
| <b>Hillary Close, Chelmsford</b> | <b>Both sides</b> – from a point 18 metres east of its southern junction with Arbour Lane north-eastwards, northwards and westwards to a point 15 metres east of its northern junction with Arbour Lane and including its two eastern arms. |
|----------------------------------|---|

**11. To introduce a 'Permit Parking Area Mon to Fri 8am-6pm Zone 7' on the following lengths of road in the City of Chelmsford**

|                                  |   |
|----------------------------------|---|
| <b>Darrell Close, Chelmsford</b> | <b>Both sides</b> - from a point 17 metres northwest of its junction with Broomfield Road north-westwards for its remaining length. |
|----------------------------------|---|

**12. To include the following residential properties the residents of which are eligible to apply for a parking permit for the applicable zone**

|                                  |                             |
|----------------------------------|-----------------------------|
| <b>Dixon Avenue, Chelmsford</b>  | All residential properties. |
| <b>Hillary Close, Chelmsford</b> | All residential properties. |
| <b>Darrell Close, Chelmsford</b> | All residential properties. |

This Order will be incorporated into The Essex County Council (Chelmsford City Council) (Prohibition of Waiting, Loading and Stopping) and (On-Street Parking Places) (Civil Enforcement Area) Consolidation Order 2019 by substituting tile numbers TL685 072 Rev 0 to Rev 1, TL695 075 Rev 0 to Rev 1, TL695 077 Rev 0 to Rev 1, TL700 075 Rev 0 to Rev 1, TL705 060 Rev 0 to Rev 1, TL705 087 Rev 1 to Rev 2, TL705 110 Rev 1 to Rev 2, TL710 055 Rev 0 to Rev 1, TL710 062 Rev 0 to Rev 1, TL715 045 Rev 0 to Rev 1, TL715 075 Rev 0 to Rev 1 and TL715 077 Rev 0 to Rev 1.

For information the cost of a resident or visitor permit is £26 annually for a passenger vehicle and £21 annually for a motorcycle. Visitor tickets are available. Full terms and conditions can be found at <http://www.chelmsford.gov.uk>

This Order will come into effect on **17 August 2020** and will be incorporated into the relevant Schedules to the Essex County Council (Chelmsford City) (Prohibition of Waiting, Loading and Stopping) and (On-street Parking Places) (Civil Enforcement Area) Consolidation Order 2019.

**Further details:** A copy of the Order and plans may be examined during normal office hours, following the current social distancing restrictions, at Civic Reception, Civic Centre, Chelmsford CM1 1JE. Alternatively, they can be viewed online at <http://www.chelmsford.gov.uk> or documents can be posted upon request or emailed to you or by emailing [trafficreg@chelmsford.gov.uk](mailto:trafficreg@chelmsford.gov.uk)

If you wish to question the validity of the Order or any provisions contained in it on the grounds that it is not within the powers conferred by the Road Traffic Regulation Act 1984, or on the grounds that any requirement of that Act, or of any instrument made under it, has not been complied with in relation to the Order, you may apply within 6 weeks from the date the Order was made, apply to the High Court for this purpose.

South Essex Parking Partnership Manager, South Essex Parking Partnership, Chelmsford City Council, Duke Street, Chelmsford CM1 1JE. **Dated: 16 July 2020**

**THE ESSEX COUNTY COUNCIL (CHELMSFORD CITY) (PROHIBITION OF WAITING,  
LOADING AND STOPPING) AND (ON-STREET PARKING PLACES)  
(CIVIL ENFORCEMENT AREA) (AMENDMENT No.4) ORDER 2020**

The Chelmsford City Council acting on behalf of the South Essex Parking Partnership in exercise of the delegated powers of the traffic authority Essex County Council granted under an agreement dated 31 March 2011 (and subsequently varied by Deed of Variation on 15 June 2011 and 27 July 2012) and after consultation with the Chief Officer of Police in accordance with Part III of Schedule 9 of the Road Traffic Regulation Act 1984 ("the Act") hereby makes the following Order under Sections 1(1), 2(1) to (3), 4(1) 4(2), 32(1), 35(1), 45, 46, 49, 53 and Parts III and Part IV of Schedule 9 of the Act and of all other enabling powers.

1. This Order shall come into operation for all purposes on the 17<sup>th</sup> day of August 2020 and may be cited as The Essex County Council (Chelmsford City) (Prohibition of Waiting, Loading and Stopping) and (On-street Parking places) (Civil Enforcement Area) (Amendment No.4) Order 2020.
2. This Order will be incorporated into The Essex County Council (Chelmsford City) (Prohibition of Waiting, Loading and Stopping) and (On-street Parking places) (Civil Enforcement Area) Consolidation Order 2019 by creating tile numbers:

|                          |                          |
|--------------------------|--------------------------|
| TL685 072 Rev 0 to Rev 1 | TL705 110 Rev 1 to Rev 2 |
| TL695 075 Rev 0 to Rev 1 | TL710 055 Rev 0 to Rev 1 |
| TL695 077 Rev 0 to Rev 1 | TL710 062 Rev 0 to Rev 1 |
| TL700 075 Rev 0 to Rev 1 | TL715 045 Rev 0 to Rev 1 |
| TL705 060 Rev 0 to Rev 1 | TL715 075 Rev 0 to Rev 1 |
| TL705 087 Rev 1 to Rev 2 | TL715 077 Rev 0 to Rev 1 |

3. The Essex County Council (Chelmsford City) (Prohibition of Waiting, Loading and Stopping) and (On-street Parking places) (Civil Enforcement Area) Consolidation Order 2019 Schedule 5 will be amended to include the following properties the residents of which are eligible to apply for a permit:

| STREET                    | ZONE | PROPERTIES                  |
|---------------------------|------|-----------------------------|
| Hillary Close, Chelmsford | 5    | All residential properties. |
| Dixon Avenue, Chelmsford  | 7    | All residential properties. |
| Darrell Close, Chelmsford | 7    | All residential properties. |



THE COMMON SEAL of THE  
CHELMSFORD CITY COUNCIL  
was hereunto affixed  
this 16<sup>th</sup> day of JULY 2020  
in the presence of: -

)  
)  
)  
)  
)



SEALING REFERENCE  
60 / 20

Authorised Officer

*W. J. Butler*

( WILLIAM BUTCHER )

Tile Reference:

TL685 072



The South Essex Parking Partnership  
Civic Centre  
Duke Street  
Chelmsford  
CM1 1JE



Essex County Council  
County Hall  
Chelmsford  
Essex

Sheet Revision Number: 1

Sheet Active From: 17/08/2020

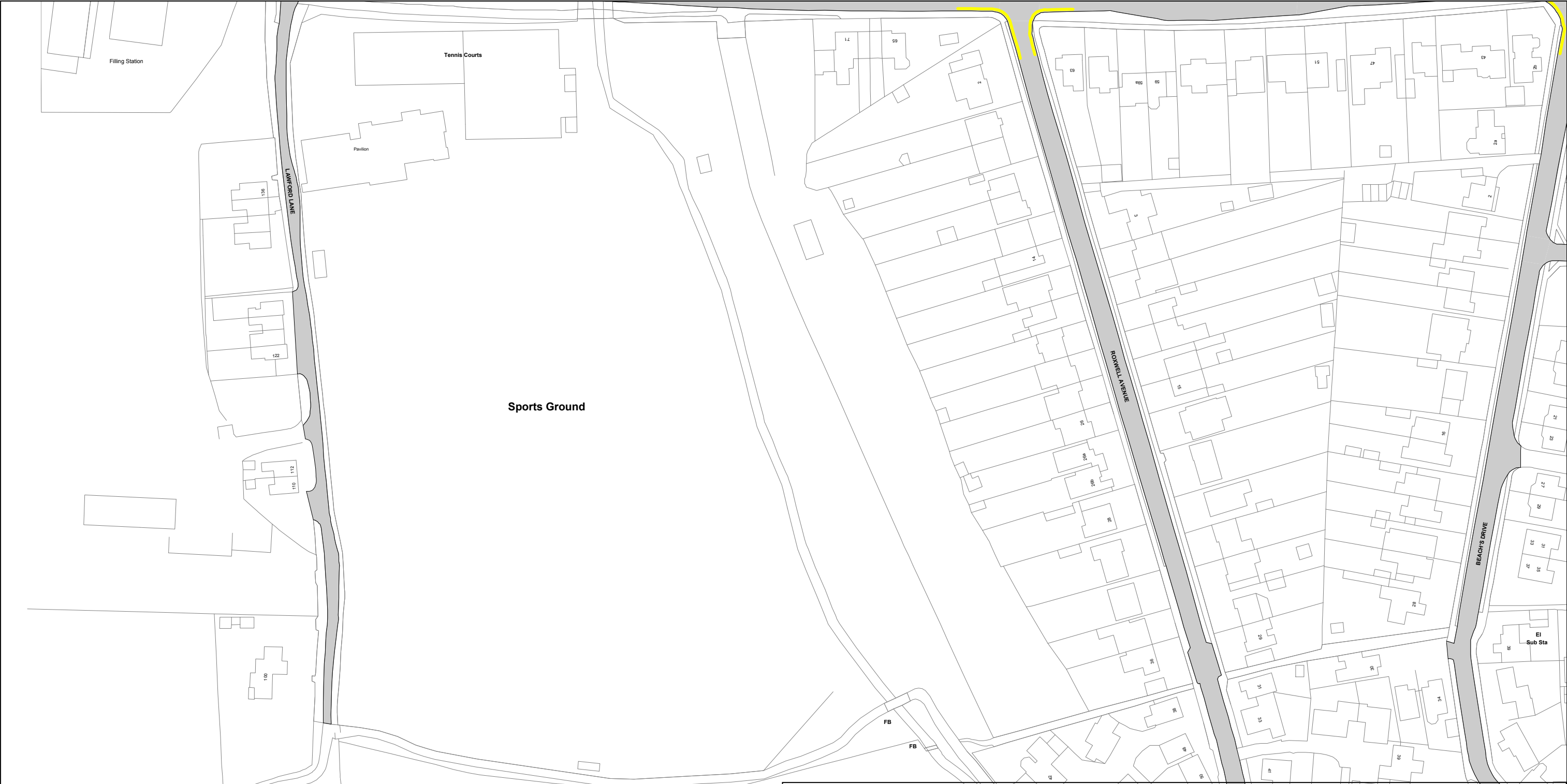

SEE STATIC MAP SCHEDULE LEGEND FOR RESTRICTIONS DISPLAYED



CONFIRMED

Scale - 1 : 1250 @ A3 0 Metres 100

Title - South Essex Partnership -Street Waiting, Loading and Parking Plans

Produced from Ordnance Survey 1:1250 mapping with permission of the Controller of Her Majesty's Stationary Office (c) Crown Copyright Licence No. 100019602  
Unauthorised reproduction infringes Crown Copyright and may lead to prosecution or Civil Proceedings

This copy has been made by or with the authority of the Head of Legal Services of Essex County Council, pursuant of section 47 of the Copyright, Designs and Patents Act 1988 ('the Act'). Unless the Act provides a relevent exception to copyright, the copy must not be copied without the prior permission of the copyright owner.

Tile Reference:

TL695 075



The South Essex Parking Partnership  
Civic Centre  
Duke Street  
Chelmsford  
CM1 1JE



Essex County Council  
County Hall  
Chelmsford  
Essex

Sheet Revision Number: 1

Sheet Active From: 17/08/2020

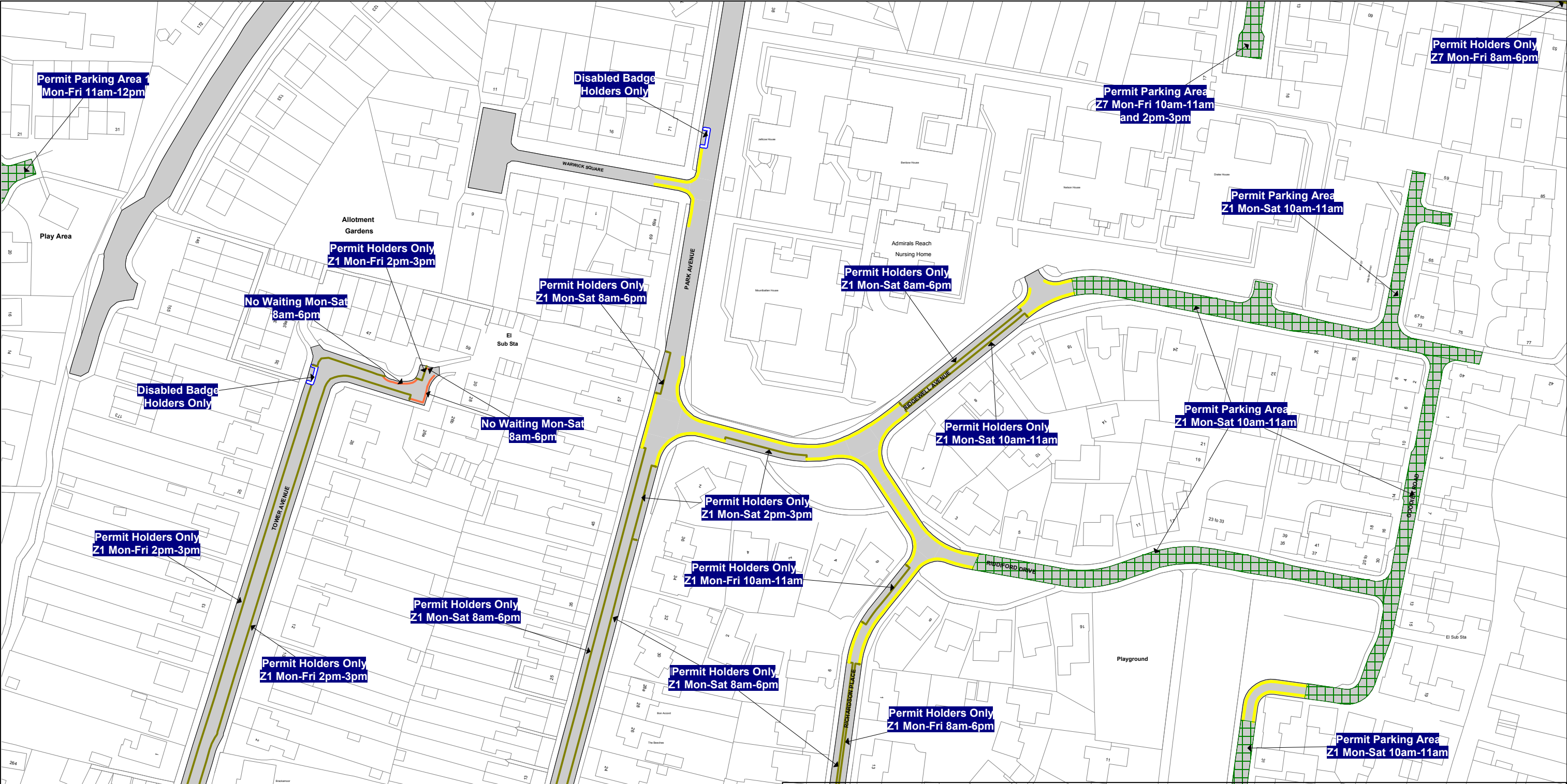

SEE STATIC MAP SCHEDULE LEGEND FOR RESTRICTIONS DISPLAYED



CONFIRMED

Scale - 1 : 1250 @ A3 0 Metres 100

Title - South Essex Partnership -Street Waiting, Loading and Parking Plans

Produced from Ordnance Survey 1:1250 mapping with permission of the Controller of Her Majesty's Stationary Office (c) Crown Copyright Licence No. 100019602  
Unauthorised reproduction infringes Crown Copyright and may lead to prosecution or Civil Proceedings

This copy has been made by or with the authority of the Head of Legal Services of Essex County Council, pursuant of section 47 of the Copyright, Designs and Patents Act 1988 ('the Act'). Unless the Act provides a relevent exception to copyright, the copy must not be copied without the prior permission of the copyright owner.



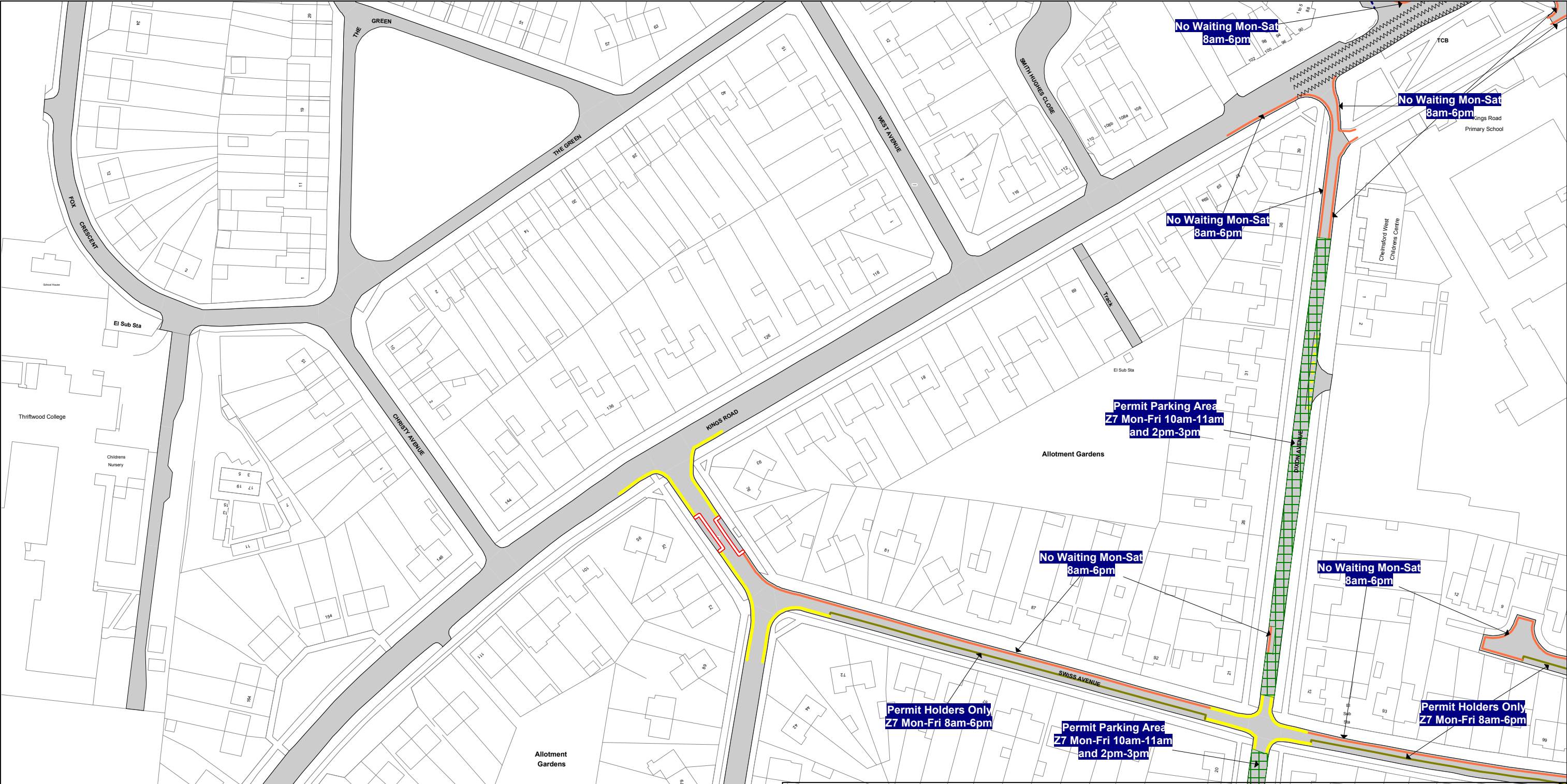

SEE STATIC MAP SCHEDULE LEGEND FOR RESTRICTIONS DISPLAYED



CONFIRMED

Scale - 1 : 1250 @ A3 0 Metres 100

Title - South Essex Partnership -Street Waiting, Loading and Parking Plans

Produced from Ordnance Survey 1:1250 mapping with permission of the Controller of Her Majesty's Stationary Office (c) Crown Copyright Licence No. 100019602  
Unauthorised reproduction infringes Crown Copyright and may lead to prosecution or Civil Proceedings

This copy has been made by or with the authority of the Head of Legal Services of Essex County Council, pursuant of section 47 of the Copyright, Designs and Patents Act 1988 ('the Act'). Unless the Act provides a relevent exception to copyright, the copy must not be copied without the prior permission of the copyright owner.



Tile Reference:

TL700 075



The South Essex Parking Partnership  
Civic Centre  
Duke Street  
Chelmsford  
CM1 1JE



Essex County Council  
County Hall  
Chelmsford  
Essex

Sheet Revision Number: 1

Sheet Active From: 17/08/2020

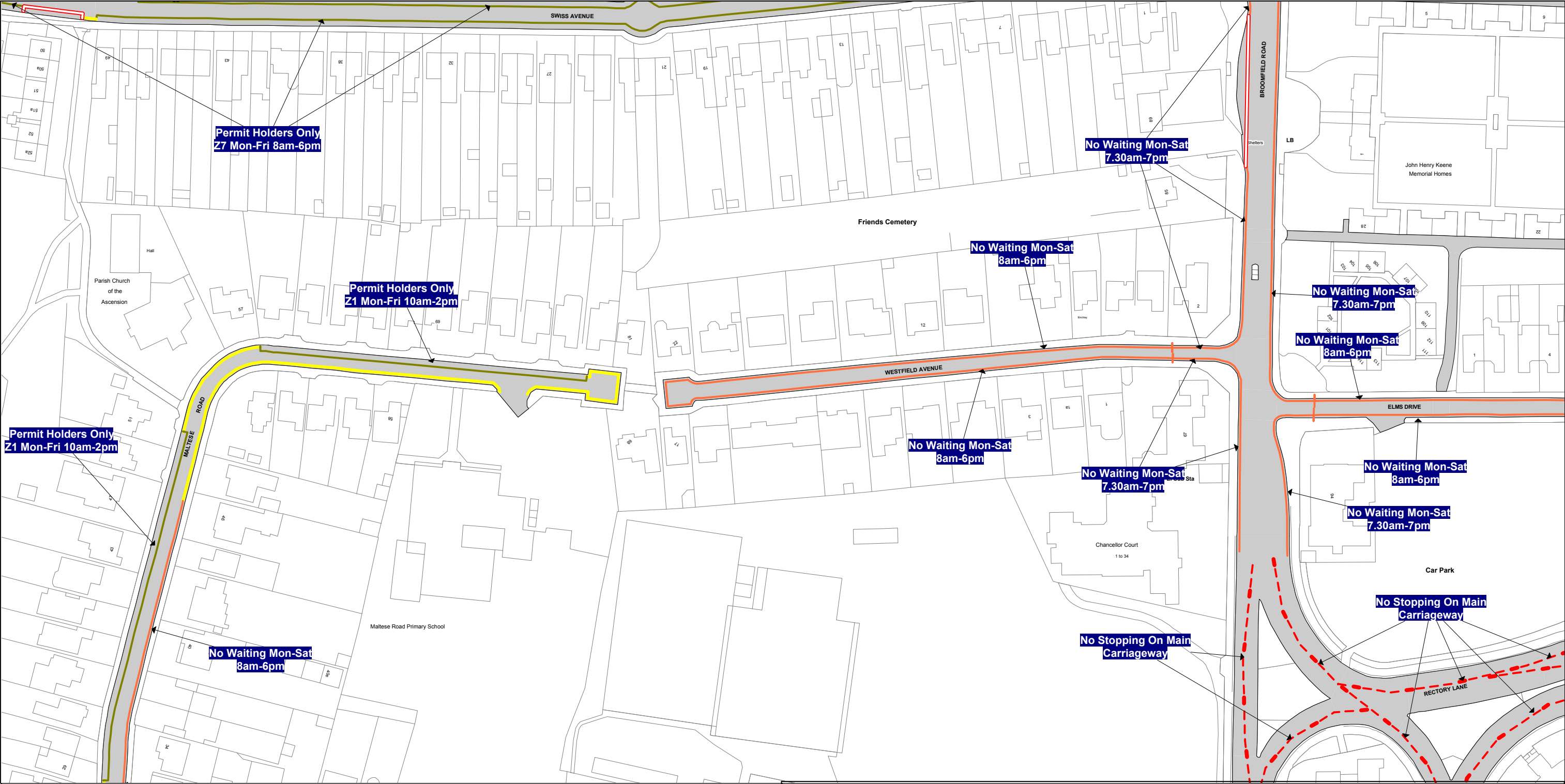

SEE STATIC MAP SCHEDULE LEGEND FOR RESTRICTIONS DISPLAYED



CONFIRMED

Scale - 1 : 1250 @ A3 0 Metres 100

Title - South Essex Partnership -Street Waiting, Loading and Parking Plans

Produced from Ordnance Survey 1:1250 mapping with permission of the Controller of Her Majesty's Stationary Office (c) Crown Copyright Licence No. 100019602  
Unauthorised reproduction infringes Crown Copyright and may lead to prosecution or Civil Proceedings

This copy has been made by or with the authority of the Head of Legal Services of Essex County Council, pursuant of section 47 of the Copyright, Designs and Patents Act 1988 ('the Act'). Unless the Act provides a relevent exception to copyright, the copy must not be copied without the prior permission of the copyright owner.





The South Essex Parking Partnership  
Civic Centre  
Duke Street  
Chelmsford  
CM1 1JE



Essex County Council  
County Hall  
Chelmsford  
Essex

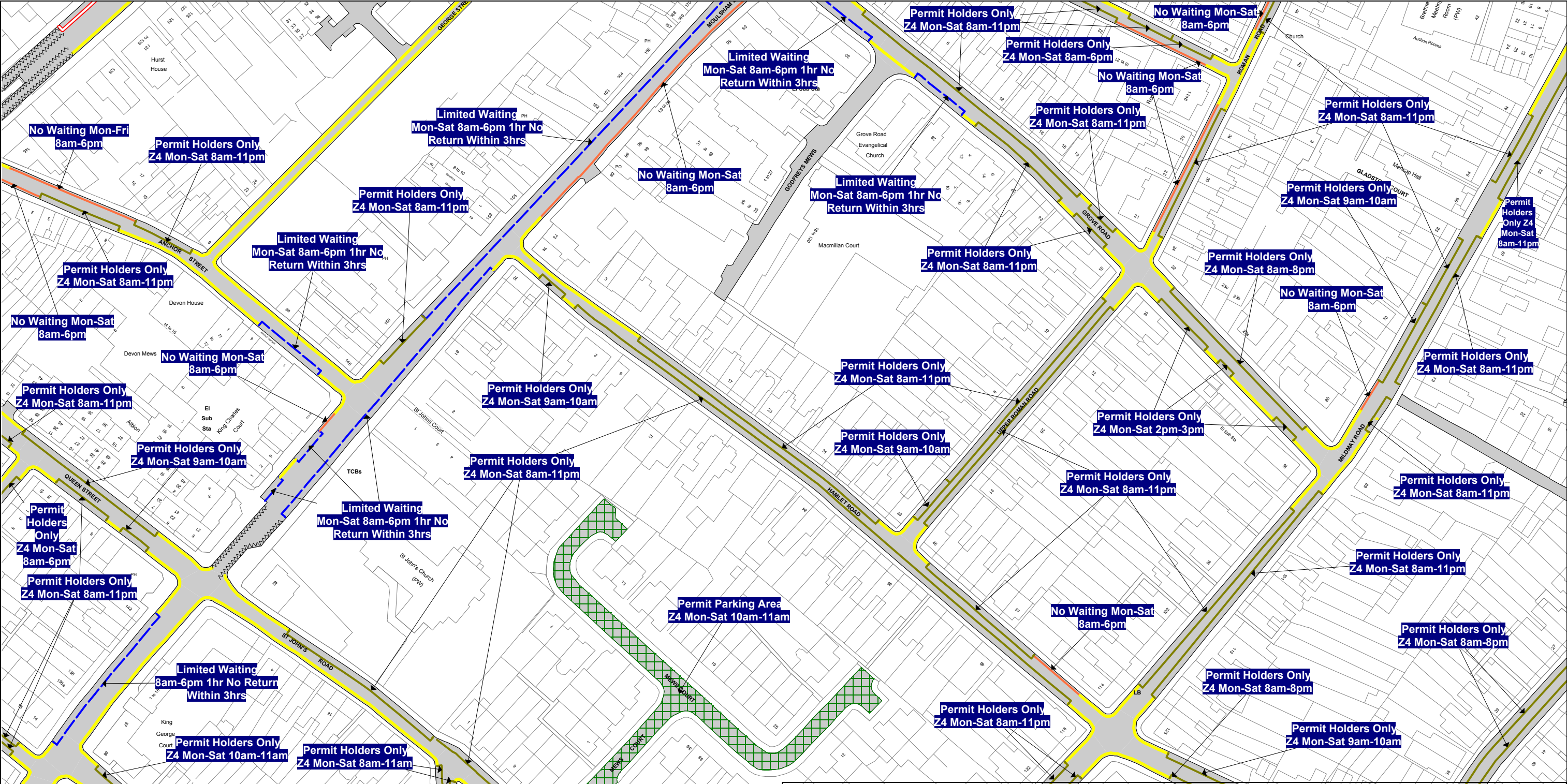

SEE STATIC MAP SCHEDULE LEGEND FOR RESTRICTIONS DISPLAYED



CONFIRMED

Scale - 1 : 1250 @ A3 0 Metres 100

Title - South Essex Partnership -Street Waiting, Loading and Parking Plans

Produced from Ordnance Survey 1:1250 mapping with permission of the Controller of Her Majesty's Stationary Office (c) Crown Copyright Licence No. 100019602  
Unauthorised reproduction infringes Crown Copyright and may lead to prosecution or Civil Proceedings

This copy has been made by or with the authority of the Head of Legal Services of Essex County Council, pursuant of section 47 of the Copyright, Designs and Patents Act 1988 ('the Act'). Unless the Act provides a relevent exception to copyright, the copy must not be copied without the prior permission of the copyright owner.



## TL705 087



**The South Essex Parking Partnership  
Civic Centre  
Duke Street  
Chelmsford  
CM1 1JE**



**Essex County Council  
County Hall  
Chelmsford  
Essex**

Sheet Revision Number: 2

Sheet Active From: 17/08/2020

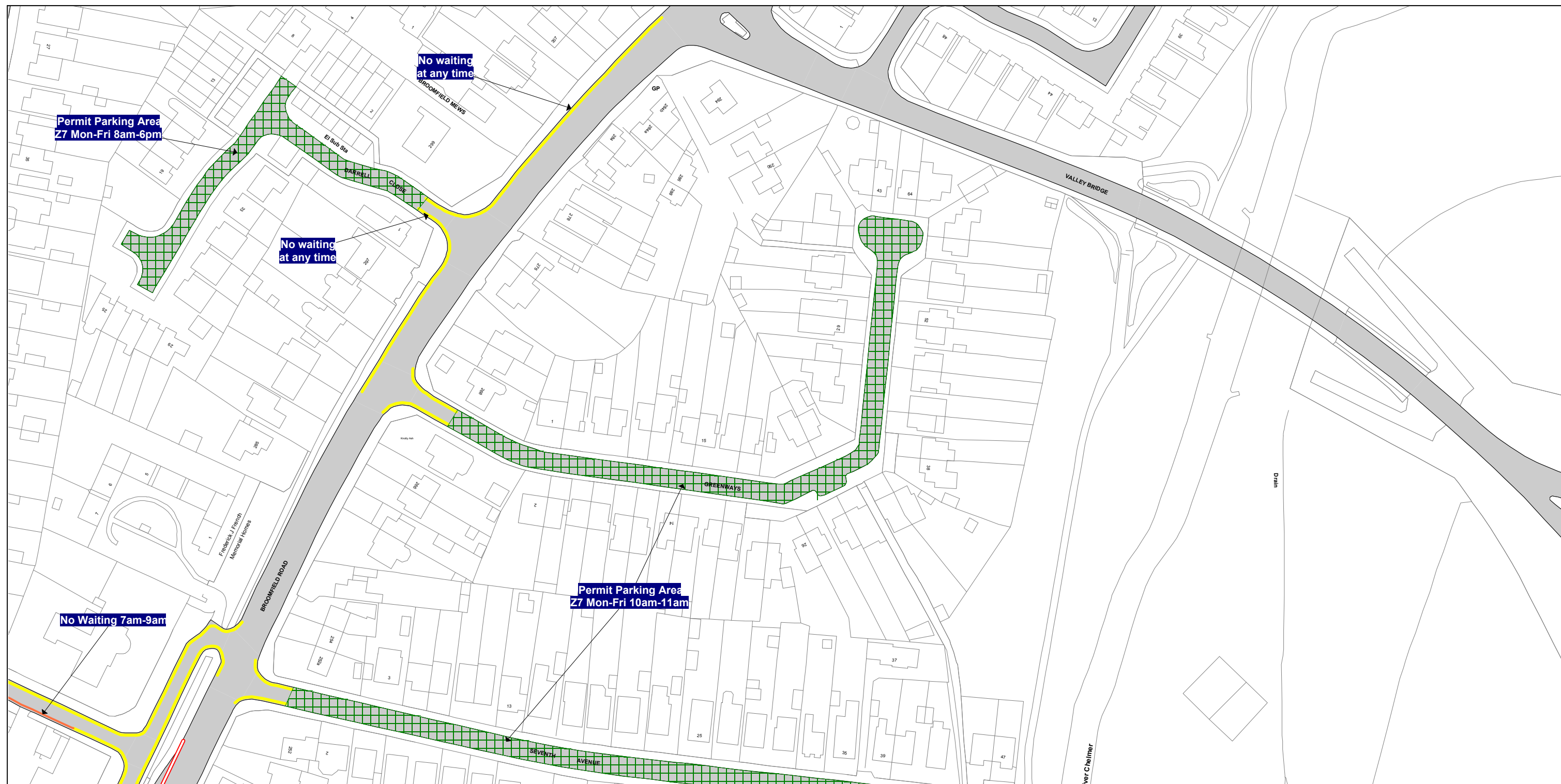

**SEE STATIC MAP SCHEDULE LEGEND FOR RESTRICTIONS DISPLAYED**



CONFIRMED

**Scale -** 1 : 1250      **@ A3**      0      Metres      100

**Title - South Essex Partnership -Street Waiting, Loading and Parking Plans**

Produced from Ordnance Survey 1:1250 mapping with permission of the Controller of  
Her Majesty's Stationary Office (c) Crown Copyright Licence No. 100019602  
Unauthorised reproduction infringes Crown Copyright and may lead to prosecution or Civil Proceedings

This copy has been made by or with the authority of the Head of Legal Services of Essex County Council, pursuant of section 47 of the Copyright, Designs and Patents Act 1988 ('the Act'). Unless the Act provides a relevant exception to copyright, the copy must not be copied without the prior permission of the copyright owner.



Tile Reference:

TL705 110



The South Essex Parking Partnership  
Civic Centre  
Duke Street  
Chelmsford  
CM1 1JE



Essex County Council  
County Hall  
Chelmsford  
Essex

Sheet Revision Number: 2  
Sheet Active From: 17/08/2020

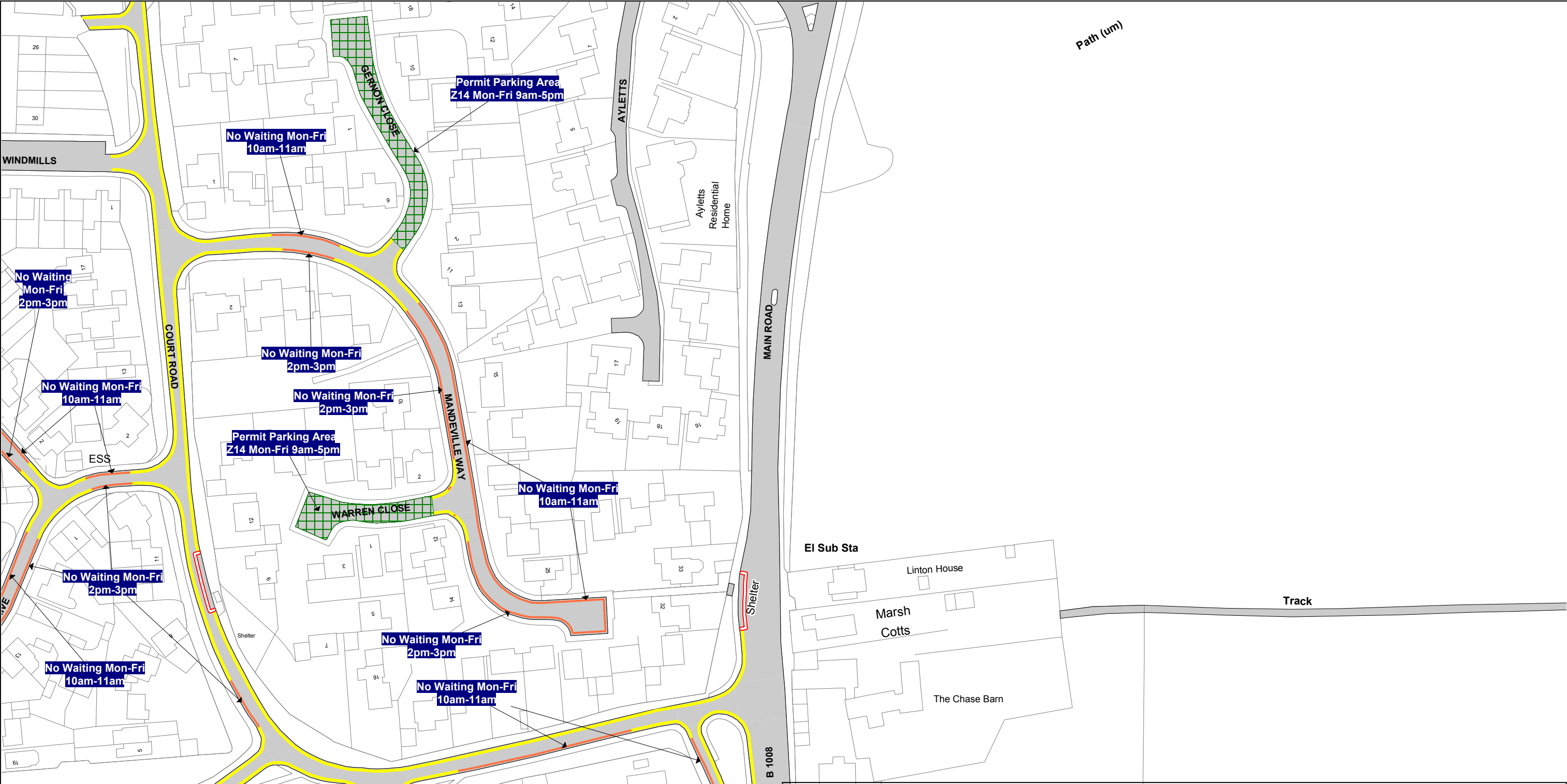

SEE STATIC MAP SCHEDULE LEGEND FOR RESTRICTIONS DISPLAYED



CONFIRMED

Scale - 1 : 1250 @ A3 0 Metres 100

Title - South Essex Partnership -Street Waiting, Loading and Parking Plans

Produced from Ordnance Survey 1:1250 mapping with permission of the Controller of Her Majesty's Stationary Office (c) Crown Copyright Licence No. 100019602  
Unauthorised reproduction infringes Crown Copyright and may lead to prosecution or Civil Proceedings

This copy has been made by or with the authority of the Head of Legal Services of Essex County Council, pursuant of section 47 of the Copyright, Designs and Patents Act 1988 ('the Act'). Unless the Act provides a relevent exception to copyright, the copy must not be copied without the prior permission of the copyright owner.

Tile Reference:

TL710 055



The South Essex Parking Partnership  
Civic Centre  
Duke Street  
Chelmsford  
CM1 1JE



Essex County Council  
County Hall  
Chelmsford  
Essex

Sheet Revision Number: 1

Sheet Active From: 17/08/2020

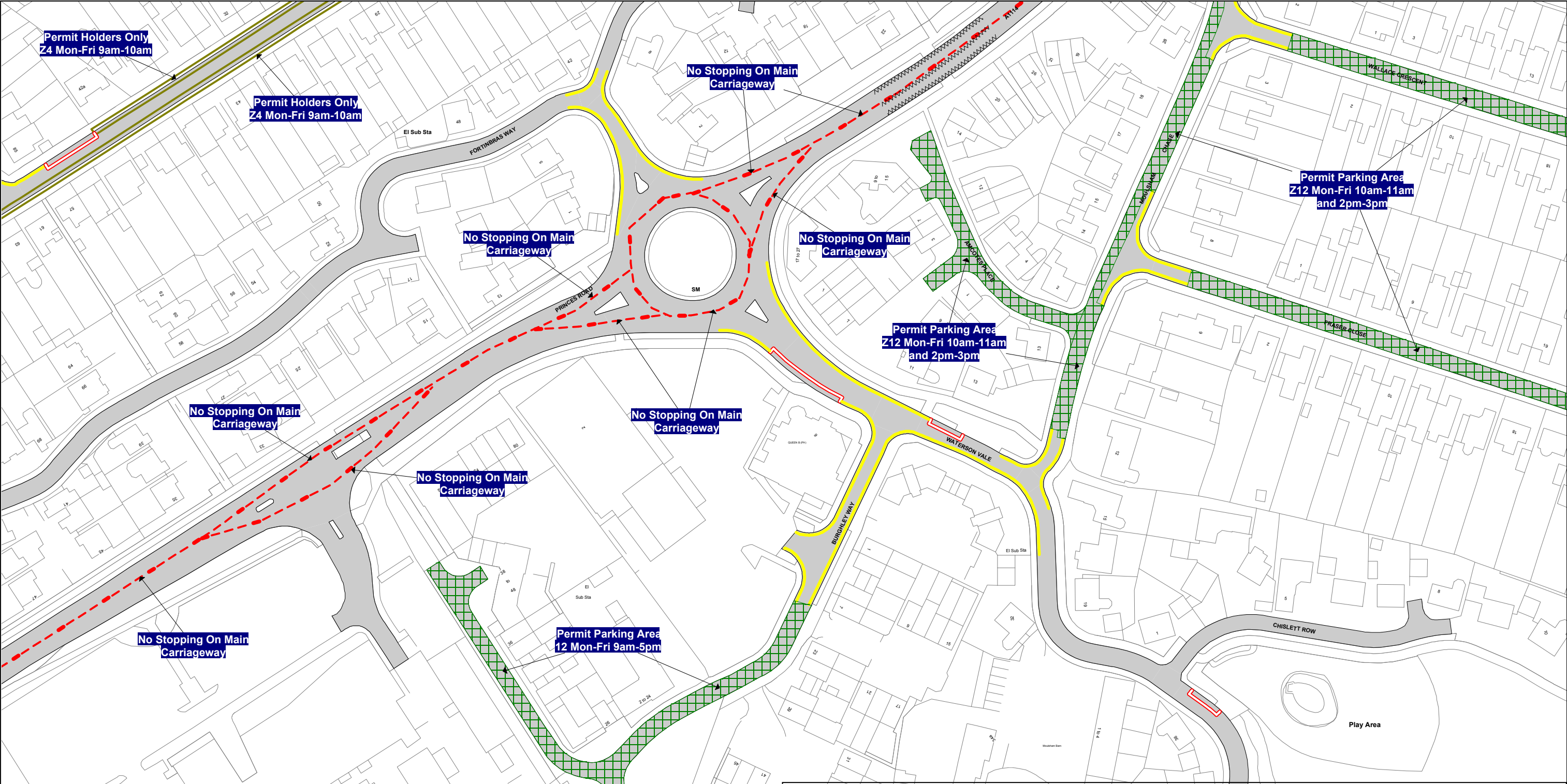

SEE STATIC MAP SCHEDULE LEGEND FOR RESTRICTIONS DISPLAYED



CONFIRMED

Scale - 1 : 1250 @ A3 0 Metres 100

Title - South Essex Partnership -Street Waiting, Loading and Parking Plans

Produced from Ordnance Survey 1:1250 mapping with permission of the Controller of Her Majesty's Stationary Office (c) Crown Copyright Licence No. 100019602  
Unauthorised reproduction infringes Crown Copyright and may lead to prosecution or Civil Proceedings

This copy has been made by or with the authority of the Head of Legal Services of Essex County Council, pursuant of section 47 of the Copyright, Designs and Patents Act 1988 ('the Act'). Unless the Act provides a relevent exception to copyright, the copy must not be copied without the prior permission of the copyright owner.



Tile Reference:

TL710 062



The South Essex Parking Partnership  
Civic Centre  
Duke Street  
Chelmsford  
CM1 1JE



Essex County Council  
County Hall  
Chelmsford  
Essex

Sheet Revision Number: 1

Sheet Active From: 17/08/2020

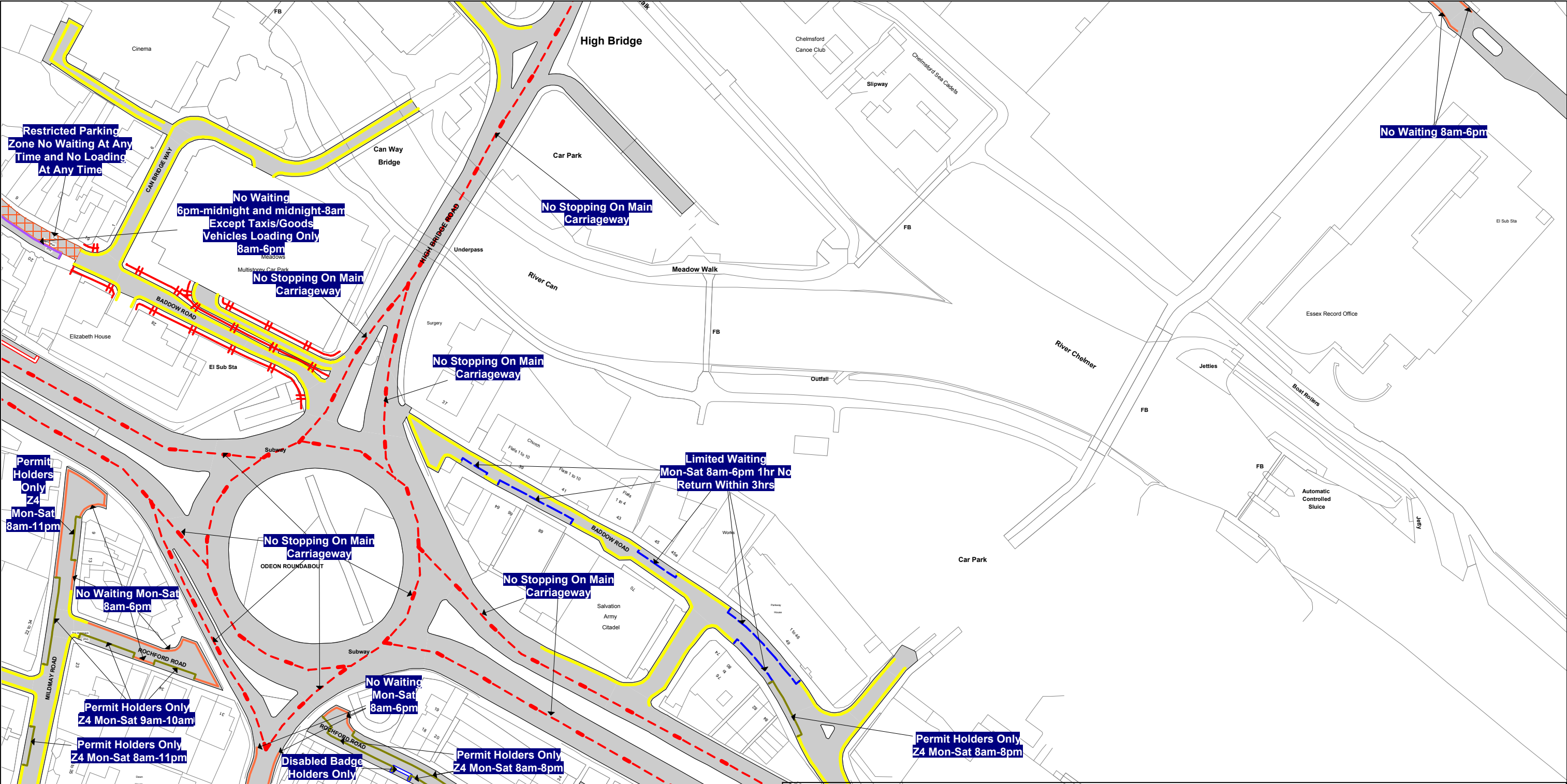

SEE STATIC MAP SCHEDULE LEGEND FOR RESTRICTIONS DISPLAYED



CONFIRMED

Scale - 1 : 1250 @ A3 0 Metres 100

Title - South Essex Partnership -Street Waiting, Loading and Parking Plans

Produced from Ordnance Survey 1:1250 mapping with permission of the Controller of Her Majesty's Stationary Office (c) Crown Copyright Licence No. 100019602  
Unauthorised reproduction infringes Crown Copyright and may lead to prosecution or Civil Proceedings

This copy has been made by or with the authority of the Head of Legal Services of Essex County Council, pursuant of section 47 of the Copyright, Designs and Patents Act 1988 ('the Act'). Unless the Act provides a relevent exception to copyright, the copy must not be copied without the prior permission of the copyright owner.



Tile Reference:

TL715 045



The South Essex Parking Partnership  
Civic Centre  
Duke Street  
Chelmsford  
CM1 1JE



Essex County Council  
County Hall  
Chelmsford  
Essex

Sheet Revision Number: 1

Sheet Active From: 17/08/2020



SEE STATIC MAP SCHEDULE LEGEND FOR RESTRICTIONS DISPLAYED



CONFIRMED

Scale - 1 : 1250 @ A3 0 Metres 100

Title - South Essex Partnership -Street Waiting, Loading and Parking Plans

Produced from Ordnance Survey 1:1250 mapping with permission of the Controller of Her Majesty's Stationary Office (c) Crown Copyright Licence No. 100019602  
Unauthorised reproduction infringes Crown Copyright and may lead to prosecution or Civil Proceedings

This copy has been made by or with the authority of the Head of Legal Services of Essex County Council, pursuant of section 47 of the Copyright, Designs and Patents Act 1988 ('the Act'). Unless the Act provides a relevent exception to copyright, the copy must not be copied without the prior permission of the copyright owner.

Tile Reference:

TL715 075



The South Essex Parking Partnership  
Civic Centre  
Duke Street  
Chelmsford  
CM1 1JE



Essex County Council  
County Hall  
Chelmsford  
Essex

Sheet Revision Number: 1

Sheet Active From: 17/08/2020

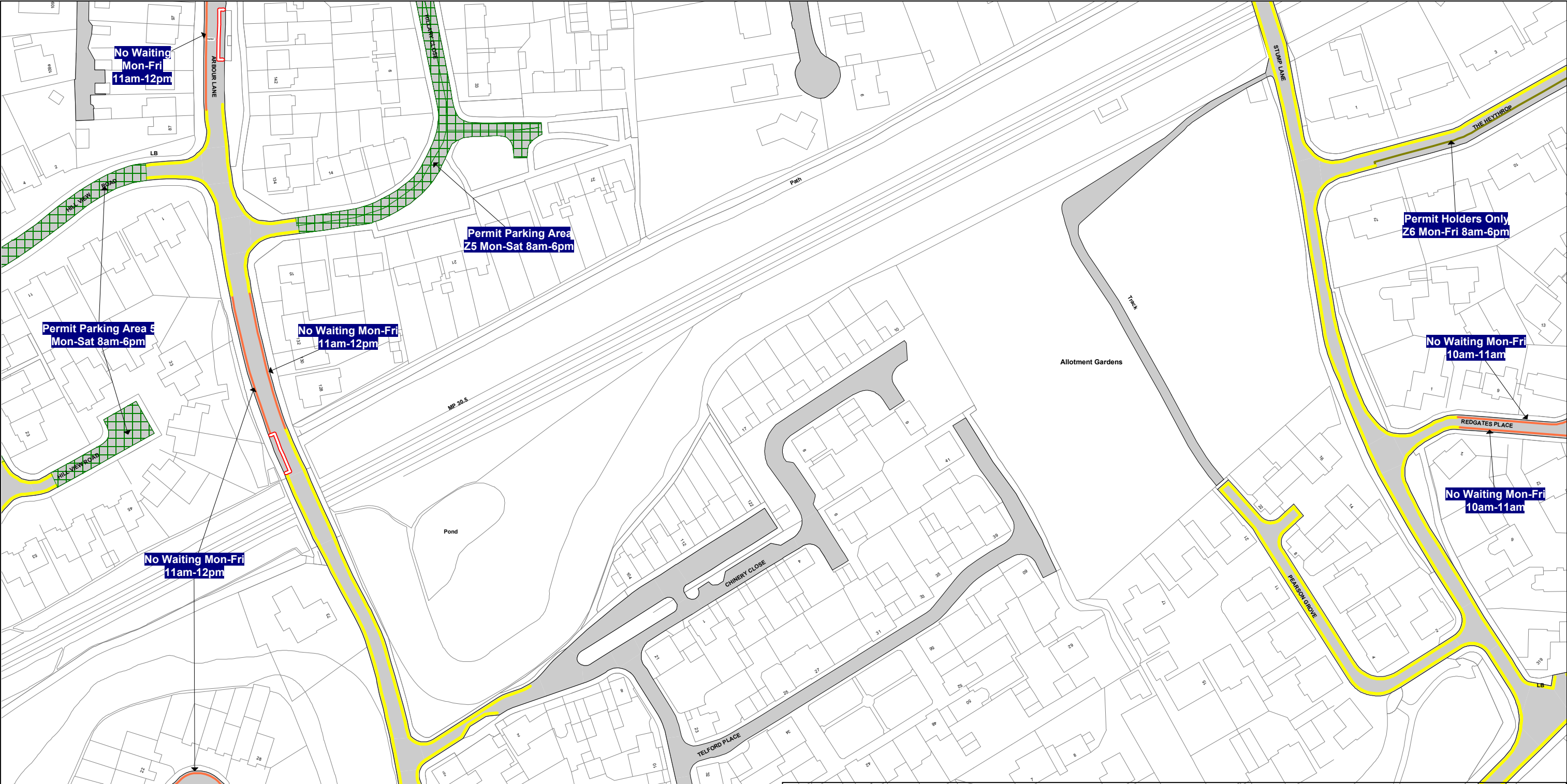

SEE STATIC MAP SCHEDULE LEGEND FOR RESTRICTIONS DISPLAYED



CONFIRMED

Scale - 1 : 1250 @ A3 0 Metres 100

Title - South Essex Partnership -Street Waiting, Loading and Parking Plans

Produced from Ordnance Survey 1:1250 mapping with permission of the Controller of Her Majesty's Stationary Office (c) Crown Copyright Licence No. 100019602  
Unauthorised reproduction infringes Crown Copyright and may lead to prosecution or Civil Proceedings

This copy has been made by or with the authority of the Head of Legal Services of Essex County Council, pursuant of section 47 of the Copyright, Designs and Patents Act 1988 ('the Act'). Unless the Act provides a relevent exception to copyright, the copy must not be copied without the prior permission of the copyright owner.





The South Essex Parking Partnership  
Civic Centre  
Duke Street  
Chelmsford  
CM1 1JE



Essex County Council  
County Hall  
Chelmsford  
Essex

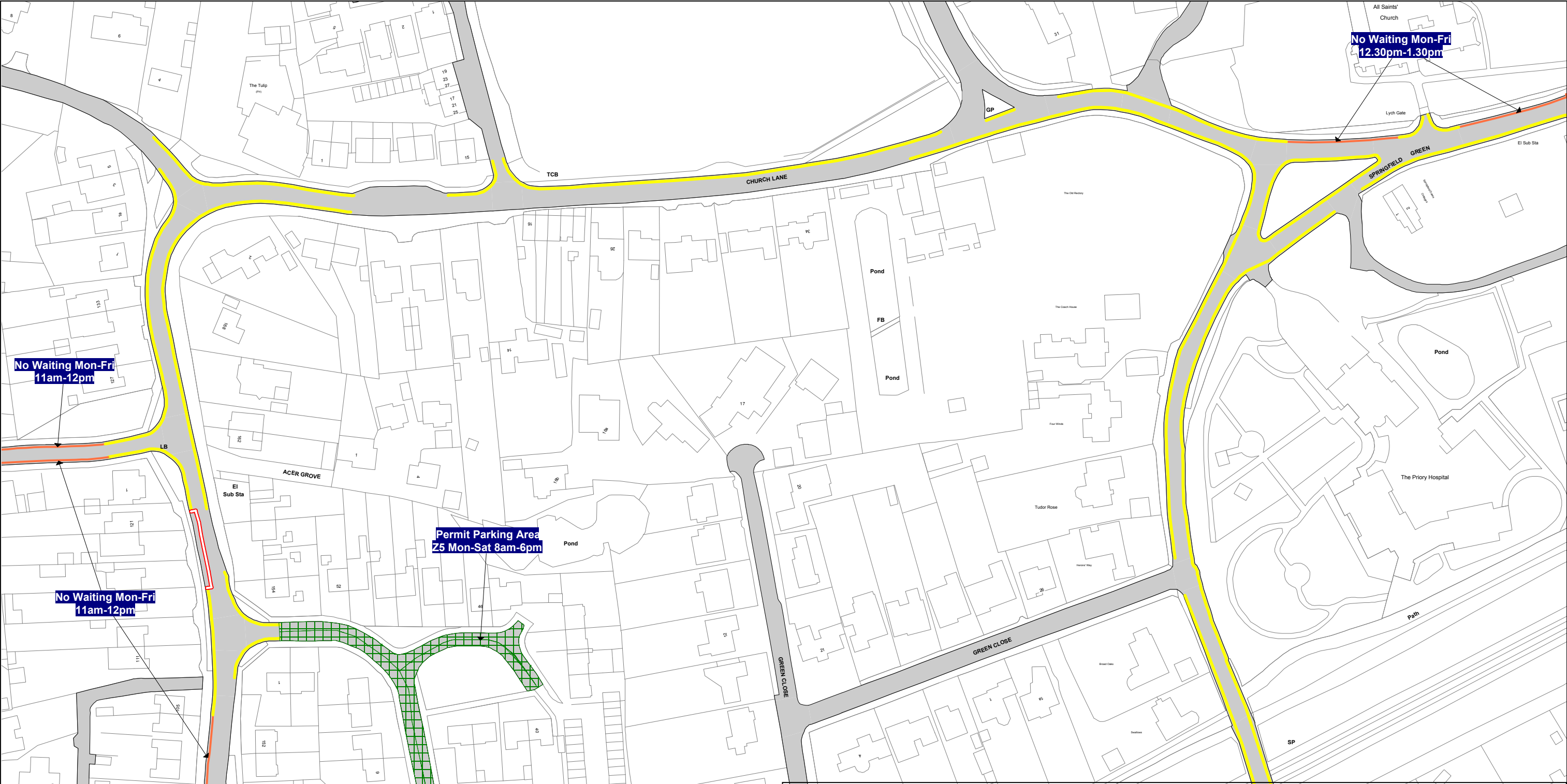

SEE STATIC MAP SCHEDULE LEGEND FOR RESTRICTIONS DISPLAYED



CONFIRMED

Scale - 1 : 1250 @ A3 0 Metres 100

Title - South Essex Partnership -Street Waiting, Loading and Parking Plans

Produced from Ordnance Survey 1:1250 mapping with permission of the Controller of Her Majesty's Stationary Office (c) Crown Copyright Licence No. 100019602  
Unauthorised reproduction infringes Crown Copyright and may lead to prosecution or Civil Proceedings

This copy has been made by or with the authority of the Head of Legal Services of Essex County Council, pursuant of section 47 of the Copyright, Designs and Patents Act 1988 ('the Act'). Unless the Act provides a relevent exception to copyright, the copy must not be copied without the prior permission of the copyright owner.