

**HERTFORDSHIRE COUNTY COUNCIL**

**ROAD TRAFFIC REGULATION ACT 1984**

Date of Order: 18 August 2006

Order No. : 7008

**THE HERTFORDSHIRE (VARIOUS ROADS, CHESHUNT)  
(RESTRICTION OF WAITING) ORDER 2006**

The Hertfordshire County Council in exercise of their powers under Sections 1, 2 and 3 of the Road Traffic Regulation Act 1984 (which said Act of 1984 is hereinafter referred to as "the Act of 1984"), and Part IV of the Act of 1984 and of all other enabling powers and after consultation with the Chief Officer of Police in accordance with Part III of Schedule 9 of the Act of 1984, hereby make the following Order:-

1. This Order may be cited as "The Hertfordshire (Various Roads, Cheshunt) (Restriction of Waiting) Order 2006" and shall come into operation on Tuesday 29 August 2006.
  2. Save as provided in Article 4, 5 and 6 of this Order no person shall cause or permit any vehicle to wait at any time in those lengths of roads in Cheshunt specified in Schedule 1 to this Order.
  3. Save as provided in Articles 4, 5 and 6 of this Order, no person shall cause or permit any vehicle to wait between the hours of 8:00am to 6:30pm Monday to Friday in those lengths of Cadmore Lane, Cheshunt specified in Schedule 2 to this Order.
- 4(1) Nothing in Articles 2 or 3 of this Order applies to the lengths of road restricted by those Articles (which said lengths of road are referred to in this Article as "the restricted area") in relation to –
- (a) a vehicle being used for Fire and Rescue, Ambulance or Police purposes.
  - (b) anything done with the permission of or at the direction of –
    - (i) a police officer in uniform;
    - (ii) in respect of any of the lengths of road in the restricted area which are in a special parking area designated under Part II of the Road Traffic Act 1991 or Schedule 3 to that Act, a parking attendant appointed under Section 63A of the Act of 1984;
  - (c) a vehicle which is prevented from proceeding by circumstances beyond the drivers control or which has stopped in order to avoid injury or damage to persons or property or when required to do so by law;
  - (d) a vehicle which is stationary in order that it may be used for one or more of the purposes specified in sub-Article (2) of this Article and which cannot reasonably be used for such a purpose without stopping in the restricted area;
  - (e) a marked vehicle which, whilst used by a universal service provider in the course of the provision of a universal postal service, is stationary only for so long as may be reasonably necessary for postal packets to be delivered or collected;

In this Article -

The expressions "universal service provider", "provision of a universal postal Service" and "postal packet" shall bear the same meanings as in the Postal Services Act 2000.

(2) The "purposes" referred to in sub-Article (1)(d) of this Article are –

- (a) any operation involving building, demolition or excavation;
- (b) the removal of any obstruction to traffic;
- (c) the maintenance, improvement or reconstruction of a road;
- (d) constructing, improving, maintaining, or cleaning of any street furniture; or
- (e) the laying, erection, alteration, repair or cleaning of any sewer or of any main pipe or apparatus for the supply of gas, water or electricity, or of any telecommunications apparatus kept or installed for the purposes of a telecommunications code system or of any other telecommunications apparatus lawfully kept installed in any position.

5. Nothing in Articles 2 and 3 of this Order applies to the lengths of road restricted by those Articles (which said lengths of road are referred to in this Article as "the restricted area") so as to render it unlawful to cause or permit any vehicle to wait only for so long as may be reasonably necessary –

- (a) to enable goods to be loaded on or unloaded from the vehicle from or to premises adjacent to the restricted area; or
- (b) to enable a passenger to board or alight and to load and unload any luggage.

6.(1) Nothing in Articles 2 or 3 of this Order shall render it unlawful to cause or permit a disabled person's vehicle which displays in the relevant position a disabled person's badge and a parking disc, to wait at any time in the length of road as specified in Schedules 1 or 2 of this Order for a period not exceeding 3 hours (not being a period separated by an interval of less than 1 hour from a previous period of waiting by the same vehicle in the same length of road).

(2) In this Article -

"disabled person's vehicle" has the same meaning as in Section 142(1) of the Act of 1984;

"disabled person's badge" has the same meaning as in Section 142(1) of the Act of 1984;

"parking disc" has the same meaning as given in Regulation 8(5) of The Local Authorities' Traffic Orders (Exemptions for Disabled Persons) (England) Regulations 2000; and

"relevant position" means

- i) A vehicle displays a disabled person's badge in the relevant position if:-
  - a) in the case of a vehicle fitted with a dashboard or facia panel, the badge is exhibited thereon so that Part 1 of the badge is legible from outside the vehicle; or
  - b) in the case of a vehicle not fitted with a dashboard or facia panel, the badge is exhibited in a conspicuous position on the vehicle so that Part 1 of the badge is legible from outside the vehicle;
- ii) A vehicle displays a parking disc in the relevant position if:-

- a) in the case of a vehicle fitted with a dashboard or facia panel, the disc is exhibited thereon so that the quarter hour period during which the period of waiting began is legible from outside the vehicle; or
  - b) in the case of a vehicle not so fitted, the disc is exhibited in a conspicuous position on the vehicle so that the quarter hour period during which the period of waiting began is legible from outside the vehicle.
7. The Interpretation Act 1978 shall apply for the interpretation of this Order as it applies for the interpretation of an Act of Parliament.
8. The provisions of the following Order are hereby revoked only in so far as they are affected by the restrictions imposed by this Order –
- The Borough of Broxbourne Council (Control of Parking) (Consolidation) Order 2005
9. The restrictions imposed by this Order shall be in addition to and not in derogation from any restriction or requirement imposed by any other regulations made or having effect as if made under the Act of 1984 or by or under any other enactment.

#### **SCHEDULE 1**

##### lengths of road in Cheshunt – no waiting at any time

- |                                    |   |
|------------------------------------|---|
| Mylne Close<br>(north side)        | from a point 10 metres south west of its junction with the west kerbline of Halfhide Lane westwards and northwards for approximately 38 metres to a point 3 metres south west of a point in line with the north wall of 2 Mylne Close.                  |
| (south side)                       | from a point 10 metres north west of its junction with the north west kerbline of Halfhide Lane north westwards and south westwards for approximately 36 metres to a point 6 metres north east of a point in line with the north wall of 3 Mylne Close. |
| (north west side)                  | (a) from a point 3 metres south west of a point in line with the north east wall of 18 Mylne Close south westwards for 24 metres.   |
|                                    | (b) from a point in line with the boundary between 11 and 15 Mylne Close south westwards and north westwards for 11 metres.   |
|                                    | (c) from a point in line with the boundary between 17 and 19 Mylne Close north eastwards and north westwards for 14 metres.   |
|                                    | (d) from a point 8 metres south west of a point in line with the boundary between 50 and 52 Mylne Close south westwards and north westwards for 13 metres.  |
| (south east side)                  | from a point 11 metres south west of a point in line with the north east wall of 25 Mylne Close south westwards and southwards for 11 metres.   |
| Halfhide Lane<br>(south east side) | from its junction with the north east kerbline of Brookfield Lane West north eastwards for 10 metres.   |

- Brookfield Lane West  
(north east side) (a) from its junction with the south east kerbline of Halfhide Lane south eastwards for 29 metres.
- (b) from its junction with the west kerbline of Lower Meadow westwards for 15 metres.
- (c) from its junction with the east kerbline of Lower Meadow eastwards for 14 metres.
- (north side) (a) from its junction with the west kerbline of Beeston Drive westwards for 14.5 metres.
- (b) from its junction with the east kerbline of Beeston Drive eastwards for 14 metres.
- (c) from a point 3.5 metres west of a point in line with the boundary between 58 and 59 Beeston Drive eastwards for approximately 45 metres to a point 16 metres north west of its junction with the north west kerbline of Great Cambridge Road.
- (south west side)(a)from a point 47 metres north west of its junction with the north west kerbline of Welsummer Way north westwards and south westwards for approximately 45 metres.
- (b)from its junction with the north west kerbline of Welsummer Way north westwards for 11 metres.
- (c)from its junction with the south east kerbline of Welsummer Way south eastwards for 10 metres.
- (south side) (a) from its junction with the west kerbline of Southbrook Drive westwards for 12 metres.
- (b) from its junction with the east kerbline of Southbrook Drive eastwards for approximately 32 metres to a point 14 metres north west of its junction with the north west kerbline of Great Cambridge Road.
- Lower Meadow  
(both sides) from its junction with the north east kerbline of Brookfield Lane West north eastwards for 12 metres.
- Beeston Drive  
(both sides) from its junction with the north kerbline of Brookfield Lane West northwards for 10 metres.
- Welsummer Way  
(both sides) from its junction with south west kerbline of Brookfield Lane West south westwards for 14 metres.
- Southbrook Drive  
(both sides) from its junction with the south kerbline of Brookfield Lane West southwards for 15 metres.
- Delamare Road  
(east side) from its junction with the north kerbline of Windmill Lane northwards for 12 metres.
- (south east side)(a) from a point 14 metres north east of a point in line with the north wall of 19/20 Delamare Road north eastwards for 16 metres.

- (b) from a point in line with the south west kerbline of the entrance to Hales Waste Control south westwards for 17 metres.

**SCHEDULE 2**

lengths of road in Cheshunt – no waiting 8:00am to 6:30pm Monday to Friday

Cadmore Lane (a) from a point 12 metres south east of its junction with the south (north east side) east kerbline of Elm Drive south eastwards for approximately 245 metres to a point 12 metres north west of its junction with the west kerbline of Stains Close.

- (b) from a point 7 metres south east of its junction with the east kerbline of Stains Close south eastwards for approximately 71 metres to a point 19 metres north west of its junction with the west kerbline of Fieldings Road.

IN WITNESS whereof the Common Seal of the Hertfordshire County Council was here unto affixed this xx day of August 2006.

The Common Seal of )  
Hertfordshire County Council )  
was hereunto affixed )  
in the presence of: )

**County Secretary**







**Herfordshire Highways**  
 The Redwada  
 Old London Road  
 Herford  
 SG13 7TP  
 Tel: 01928 620000  
 Fax: 01928 620002

Project No.	737186
Project Title	Broxbourne Parking Controls 2005/2006
Dwg. No.	737186/CLD01
Rev.	

Scale	1:1250
Sheet No.	1 of 1
Drawing Title	Cadmore Lane, Chestnut

Project No.	737186
Dwg. No.	737186/CLD01
Rev.	



Notes  
 1. All existing restrictions outside the extents of the proposals shown are to remain unchanged.

Notes on the drawing apply to all drawings. The drawing is the property of the client and is not to be used for any other purpose without the written consent of the client. The drawing is not to be used for any other purpose without the written consent of the client. The drawing is not to be used for any other purpose without the written consent of the client.



Based upon the Ordnance Survey material with the permission of Ordnance Survey on behalf of the Controller of Her Majesty's Stationery Office © Crown copyright. Unauthorised reproduction infringes Crown copyright and may lead to prosecution or civil proceedings. Hertfordshire County Council, 100019606 2005

**Key**

 No Waiting At Any Time (Double yellow lines)  
 Single yellow line to be rescinded

Project No. 737186

Drg No. 737186/WL/02

Revisions with Dates

Project Title  
 Broxbourne Parking Controls  
 2005 / 2006

Drawn	Checked	Approved	Sheet No.
AD	AD	PS	1 of 1
Date	Scale		
10/05	1:1000		

Drawing Title  
 Windmill Lane / Delamare Road, Cheshunt



**Hertfordshire Highways**

The Rotunda  
 Old London Road  
 Hertford  
 SG13 7XP

Tel: 01992 529000  
 Fax: 01992 526002





**Herfordshire Highways**

The Research  
 800 London Road  
 Hereford  
 HR12 7JF  
 Tel: 01924 629010  
 Fax: 01924 629022

Project No.	737186	Dwg. No.	M737186/BLW02	Rev.	
Project Title	Brookfield Parking Controls 2005/2006				
Scale	1 of 1	Drawing Title	Brookfield Lane West, Chestnut		
Scale	1:1000				

Rev.	1	Date	10/10/05	By	AD	Check	AD
Rev.	2	Date	10/10/05	By	AD	Check	AD
Rev.	3	Date	10/10/05	By	AD	Check	AD
Rev.	4	Date	10/10/05	By	AD	Check	AD

**Notes**

- All existing restrictions outside the extent of the proposals shown are to remain unchanged.

Please note that this drawing is not to be used for any other purpose without the written consent of the author. It is the responsibility of the user to ensure that the drawing is used in accordance with the terms and conditions of the contract.

All Original Drawing Size This Line Measures 100mm

Original Drawing Size

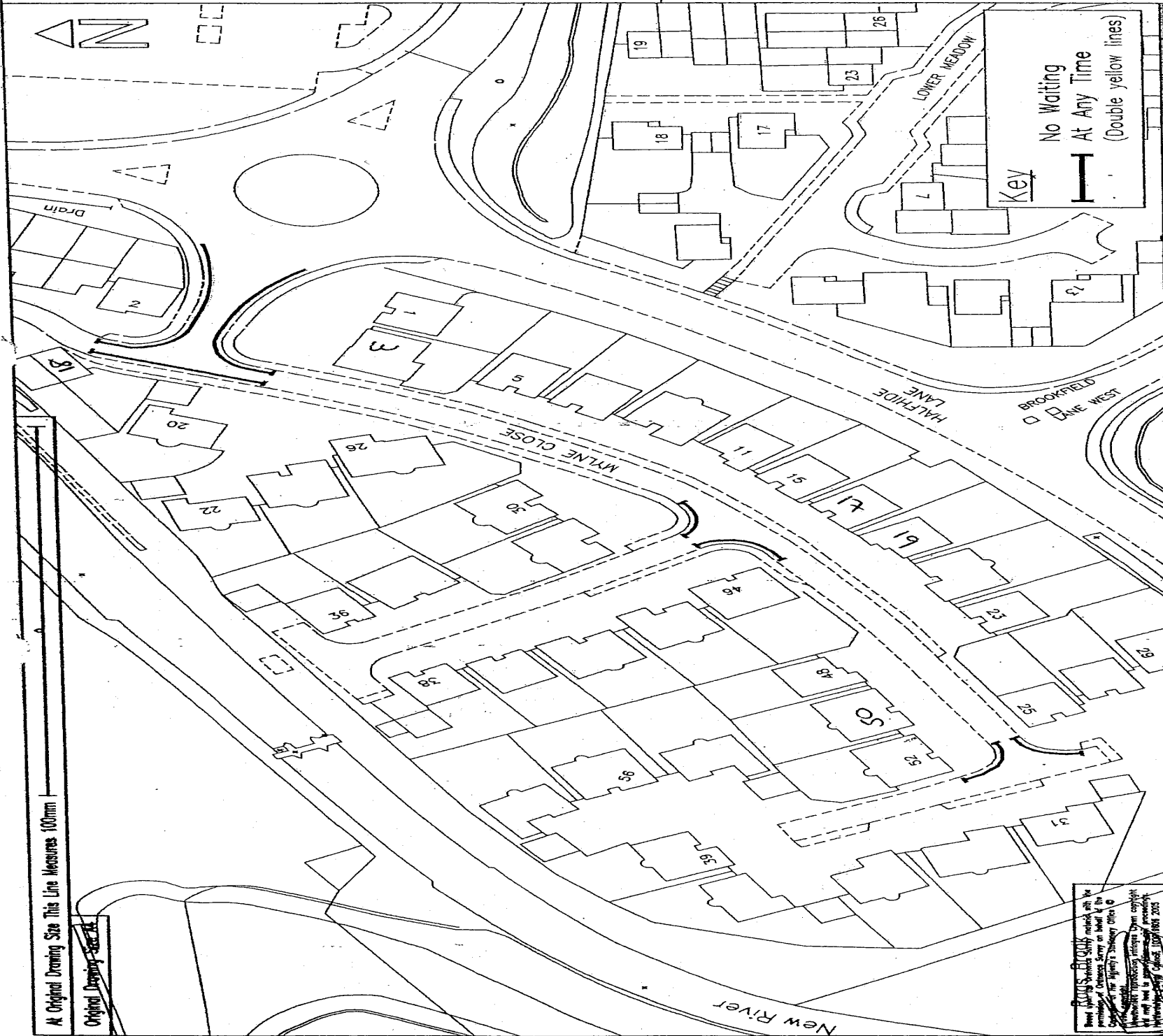

Best planning decisions shall match with the  
 permission of Hertfordshire County Council  
 and the Hertfordshire Planning Committee  
 and may not be used for any other purpose  
 without the written consent of Hertfordshire  
 County Council. 10/2/2005 10/2/2005 2005

Notes	Revision with Dates		Project No.	737186	Dwg. No.	M/737186/MC/02	Rev.
	1. All existing restrictions outside the extents of the proposals shown are to remain unchanged.		Site No.	1011	Project Title		Broxbourne Parking Controls 2005 / 2006
			Scale	1:1000	Drawing Title		Mylne Close, Chestnut
					<b>Hertfordshire Highways</b> The Bermuda 601 London Road Hemel Hempstead Herts. SG9 7JZ Tel: 01992 628000 Fax: 01992 628092		

This drawing is the copyright of Hertfordshire County Council and must not be reproduced without written permission.