

BOROUGH OF BROXBOURNE
ROAD TRAFFIC REGULATION ACT 1984
THE BOROUGH OF BROXBOURNE (VARIOUS ROADS)
(DISABLED PERSONS' PARKING PLACES) ORDER 2005 No. 2

THE COUNCIL OF THE BOROUGH OF BROXBOURNE, pursuant to arrangements made with the Hertfordshire County Council under Section 101 of the Local Government Act 1972, and in exercise of its powers under Sections 32(1) and 35(1) of the Road Traffic Regulation Act 1984, (hereinafter called the Act of 1984) and of all other enabling powers, and after consultation with the Chief Officer of Police in accordance with Part III of Schedule 9 of the Act of 1984, hereby make the following Order:

1(1) In this Order

"driver", in relation to a vehicle waiting in a parking place, means the person driving the vehicle at the time it was left in the parking place

"parking place" means any part of a road authorised by this Order to be used as a parking place.

"Disabled person's vehicle" has the same meaning as in The Local Authorities' Traffic Orders (Exemptions for Disabled Persons) (England and Wales) Regulations 1986 as amended by The Local Authorities Traffic Orders (Exemption for Disabled Persons) (England and Wales) (Amendment) Regulations 1991.

"Disabled person's badge" has the same meaning as in The Disabled Persons (Badges for Motor Vehicles) Regulations 1982 as amended by the Disabled Persons (Badges for Motor Vehicles) (Amendment) Regulations 1991.

(2) For the purposes of this Order a vehicle shall be regarded as displaying a disabled person's badge in the relevant position if:

- (i) in the case of a vehicle fitted with a dashboard or fascia panel, the badge is exhibited thereon so that Part 1 of the badge is legible from outside the vehicle; or
- (ii) in the case of a vehicle not fitted with a dashboard or fascia panel, the badge is exhibited in a conspicuous position on the vehicle so that Part 1 of the badge is legible from outside the vehicle.

2(1) Those parts of the roads specified in column 1 of the Schedule to this Order are authorised to be used in a position specified in column 2 of the Schedule, and subject to the following provisions of this Order, as parking places at any time for disabled person's vehicles which display in the relevant position a disabled person's badge.

(2) Nothing in paragraph (1) of this Article shall restrict the power of the Council, for preventing obstruction of the roads, by order, or by notice on the occasion of any public procession, rejoicing or illumination, or when the roads are thronged or liable to be obstructed, to close the parking place.

3. Where in column 1 of the Schedule to this Order a parking place is described as available for a disabled person's vehicle which displays in the relevant position a disabled person's badge, the driver of a vehicle shall not permit it to wait in that parking place unless it is:
 - (a) a disabled person's vehicle on which is displayed in the relevant position a disabled persons badge, and
 - (b) wholly within the limits of the parking place.
4. A driver of a vehicle shall not use a parking place:-
 - (a) so as unreasonably to prevent access to any premises adjoining the road, or the use of the road by other persons, or so as to be a nuisance;
 - (b) when for preventing obstruction of the road the Council shall by order or by notice made on the occasion of any public procession, rejoicing or illumination or when the roads are thronged or liable to be obstructed have closed that parking place and exhibited notice of such closing on or near the parking place.
5. The driver of a motor vehicle using a parking place shall stop the engine as soon as the vehicle is in a position in the parking place, and shall not start the engine except when about to change the position of the vehicle in or to depart from the parking place.
6. No person shall use a vehicle, while it is in a parking place, in connection with the sale of any article to persons in or near the parking place or in connection with the selling or offering for hire of his skill or service.
7. Subject to the proviso hereto, when a vehicle is left in a parking place in contravention of any of the provisions contained in Articles 3 and 4 of this Order a person authorised in that behalf by the Council may remove the vehicle or arrange for it to be removed from that parking place provided that when a vehicle is waiting in a parking place in contravention of the provisions of Articles 3 and 4 of this Order, a person authorised in that behalf by the Council may alter or cause to be altered the position of the vehicle in order that its position shall comply with that provision.
8. Any person removing a vehicle or altering its position by virtue of the last preceding Article of this Order may do so by towing or driving the vehicle or in such other manner as he may think necessary and may take such measures in relation to the vehicle as he may think necessary to enable him to remove it or alter its position, as the case may be.
9. When a person authorised by the Council removes or makes arrangements for the removal of a vehicle from a parking place by virtue of Article 7 of this Order, he shall make such arrangements as may be reasonably necessary for safe custody of the vehicle.
10. The paragraph numbered 7 in the Schedule to the Borough of Broxbourne (Various Roads)(Disabled Persons Parking Places) Order 1991 is hereby revoked.
11. The paragraph numbered 5 in the Schedule to the Borough of Broxbourne (Various Roads)(Disabled Persons Parking Places) Order 1994 is hereby revoked.

12. The paragraph numbered 4 in the Schedule to the Borough of Broxbourne (Various Roads)(Disabled Persons Parking Places) Order No 2 1995 is hereby revoked.
13. The paragraph numbered 15 in the Schedule to the Borough of Broxbourne (Various Roads)(Disabled Persons Parking Places) Order No 2 1996 is hereby revoked.
14. The paragraph numbered 19 in the Schedule to the Borough of Broxbourne (Various Roads)(Disabled Persons Parking Places) Order 1997 is hereby revoked.
15. The paragraphs numbered 4, 5 and 10 in the Schedule to the Borough of Broxbourne (Various Roads)(Disabled Persons Parking Places) Order No 2 1997 are hereby revoked.
16. The paragraph numbered 9 in the Schedule to the Borough of Broxbourne (Various Roads)(Disabled Persons Parking Places) Order 1998 is hereby revoked.
17. The paragraphs numbered 6 and 13 in the Schedule to the Borough of Broxbourne (Various Roads)(Disabled Persons Parking Places) Order No 2 1998 are hereby revoked.
18. The paragraph numbered 15 in the Schedule to the Borough of Broxbourne (Various Roads)(Disabled Persons Parking Places) Order 1999 is hereby revoked.
19. The paragraph numbered 33 in the Schedule to the Borough of Broxbourne (Various Roads)(Disabled Persons Parking Places) Order No 3 1999 is hereby revoked.
20. The paragraph numbered 16 in the Schedule to the Borough of Broxbourne (Various Roads)(Disabled Persons Parking Places) Order No 2 2000 is hereby revoked.
21. The paragraph numbered 25 in the Schedule to the Borough of Broxbourne (Various Roads)(Disabled Persons Parking Places) Order No 2 2001 is hereby revoked.
22. The paragraph numbered 15 in the Schedule to the Borough of Broxbourne (Various Roads)(Disabled Persons Parking Places) Order 2003 is hereby revoked.
23. The paragraph numbered 30 in the Schedule to the Borough of Broxbourne (Various Roads)(Disabled Persons Parking Places) Order No 2 2003 is hereby revoked.
24. The paragraph numbered 22 in the Schedule to the Borough of Broxbourne (Various Roads)(Disabled Persons Parking Places) Order 2004 is hereby revoked.
15. This Order shall come into operation on the 21st November 2005 and may be cited as the Borough of Broxbourne (Various Roads)(Disabled Person's Parking Places) Order No 2 2005

SCHEDULE

Column 1

Column 2

	Description of the parking place	Position in which the vehicle may wait
1	Brookfield Lane East CHESHUNT North side, from a point 3 metres south of a point in line with the southern flank wall of No. 18 southwards for a distance of 6 metres	Parallel and adjacent to the kerb
2	Cromwell Avenue CHESHUNT south side, from a point in line with the boundary wall between Nos 73 & 75 Westwards for a distance of 6 metres	Parallel and adjacent to the kerb
3	Cunningham Road CHESHUNT north side from a point 3.8 metres east of a point in line with the eastern flank wall of No. 63 westward for a distance of 6 metres	Parallel and adjacent to the kerb
4	Downfield Road, CHESHUNT North side from a point 4 metres west of a point in line with the eastern flank wall of Nos 131-149 westward for a distance of 6 metres	Parallel and adjacent to the kerb
5	Elderbeck CHESHUNT west side from a point in line with the boundary wall between Nos 23 & 24 eastwards for a distance of 3 metres	Lengthwise at 90° to the kerb in a West/East direction
6	Green Close CHESHUNT west side from a point in line with the boundary wall between Nos 3 & 4 southwards for a distance of 6 metres	Parallel and adjacent to the kerb
7	Holme Close CHESHUNT west side from a point 2 metres north of a point in line with the northern flank wall of No 23 northwards for a distance of 6 metres	Parallel and adjacent to the kerb.
8	Hampden Crescent CHESHUNT east side from a point 1 metre north of a point in line with the boundary wall between Nos 26 & 28 southwards for a distance of 6 metres	Parallel and adjacent to the kerb

- | | | |
|----|---|---|
| 9 | Lilac Close CHESHUNT west side from a point in line with the southern flank wall of No 11 southwards for a distance of 3 metres | Lengthwise at 90° to the kerb in a West/East direction |
| 10 | McGreedy CHESHUNT west side from a point in line with the southern flank wall of No 17 southwards for a distance of 3 metres | Lengthwise at 90° to the kerb in a West/East direction |
| 11 | Park Lane CHESHUNT south side from a point in line with the boundary wall between Nos 49 & 51 westwards for a distance of 5 metres | Parallel and adjacent to the kerb. |
| 12 | Tudor Avenue CHESHUNT east side from a point in line with a point 2 metres south of the southern flank wall of No 23 southwards for a distance of 6 metres | Parallel and adjacent to the kerb |
| 13 | Castle Close HODDESDON east side from a point in line with the boundary wall between Nos 17 & 19 southwards for a distance of 6 metres | Parallel and adjacent to the kerb |
| 14 | Chittenden Close HODDESDON east side from a point 1 metre south of a point in line with boundary wall between of Nos 3 & 4 southwards for a distance of 3 metres | Lengthwise at 90° to the kerb in a East/West direction. |
| 15 | Norris Rise HODDESDON south side from a point 1 metre west of a the flank wall of No 11 eastwards for a distance of 6 metres | Parallel and adjacent to the kerb |
| 16 | Whitley Road HODDESDON north side from a point in line with the boundary between Nos 86 & 88 westwards for a distance of 6 metres | Parallel and adjacent to the kerb |
| 17 | Burleigh Road WALTHAM CROSS west side from a point in line with boundary wall between Nos 1 & 2 northwards for a distance of 5 metres | Parallel and adjacent to the kerb |
| 18 | Cameron Drive WALTHAM CROSS south side from a point 1.5 metres from a point in line with the western flank wall of the school westward for a distance of 6 metres | Parallel and adjacent to the kerb |

- 19 Park Lane WALTHAM CROSS north side from a point in line with the boundary wall between Nos 78 & 80 westwards for a distance of 6 metres Parallel and adjacent to the kerb
- 20 Park Lane WALTHAM CROSS north side from a point 3m east of a point in line with the boundary wall between Nos 86 & 88 westwards for a distance of 6 metres Parallel and adjacent to the kerb
- 21 Sterling Avenue WALTHAM CROSS east side from a point in line with boundary wall between of Nos 23 & 25 northwards for a distance of 6 metres Parallel and adjacent to the kerb

IN WITNESS whereof the Common Seal of the Council of the Borough of Broxbourne has hereunto been affixed this 14th November 2005

The Common Seal of the COUNCIL OF THE BOROUGH OF BROXBOURNE was hereunto affixed in the presence of:-



 C1473
Chief Executive Officer

Dated 14th November 2005

ROAD TRAFFIC REGULATION ACT 1984

THE BOROUGH OF BROXBOURNE
(VARIOUS ROADS)(DISABLED PERSONS
PARKING PLACES) ORDER 2005/2

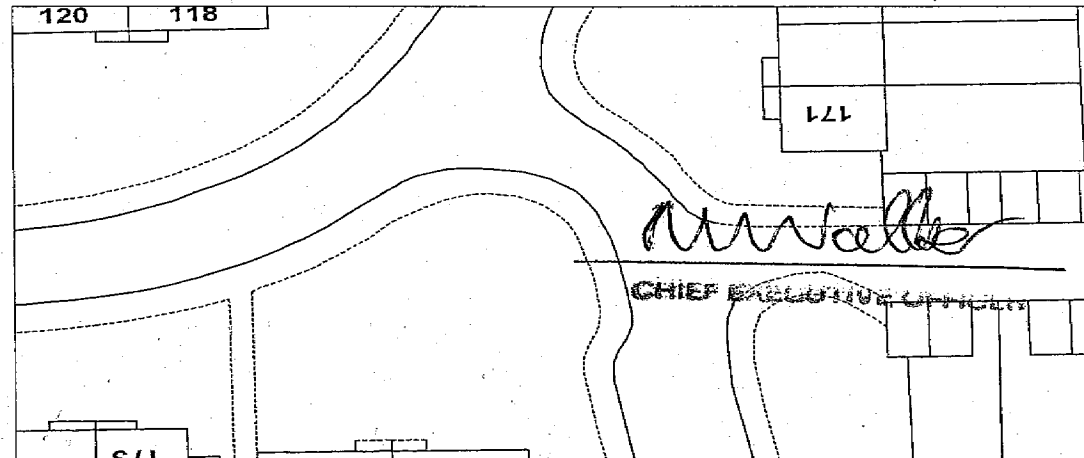
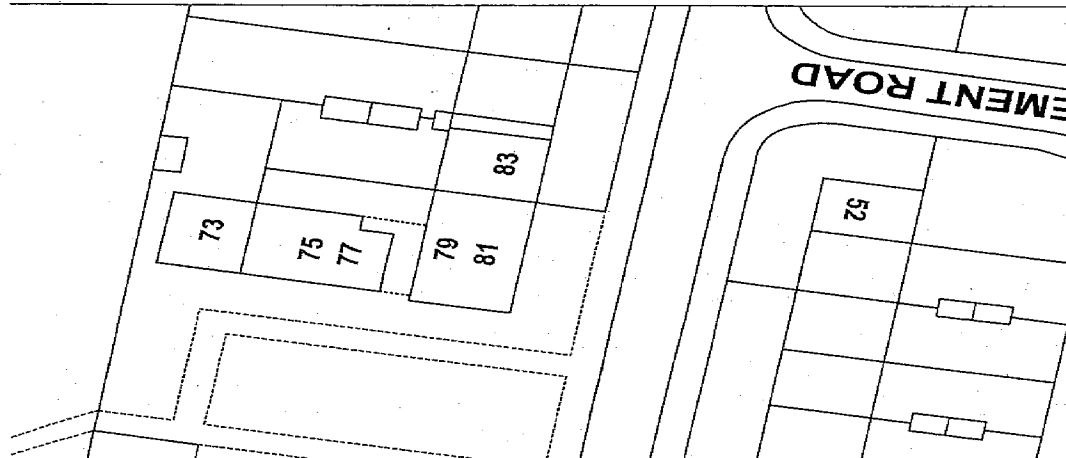
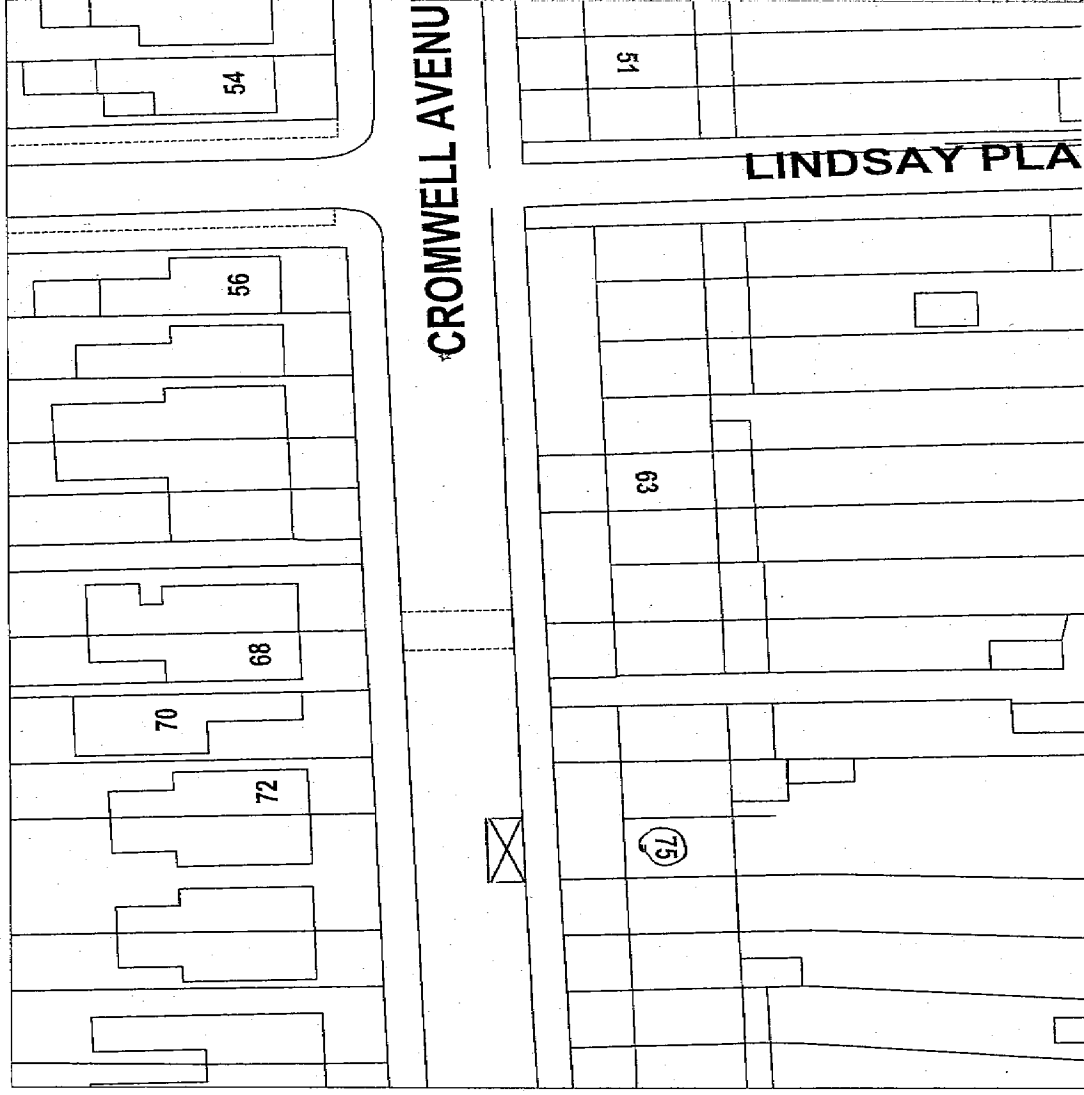
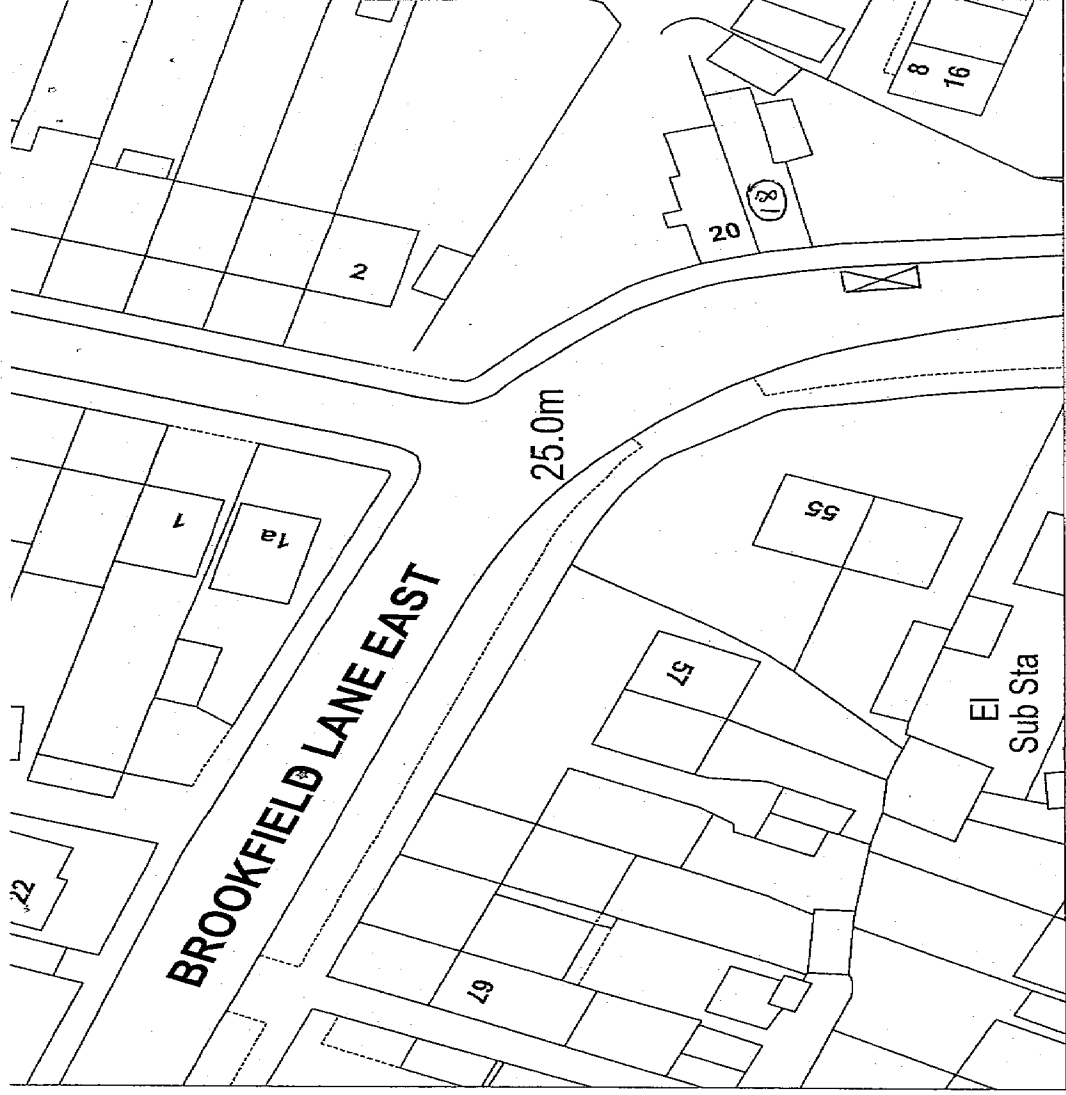

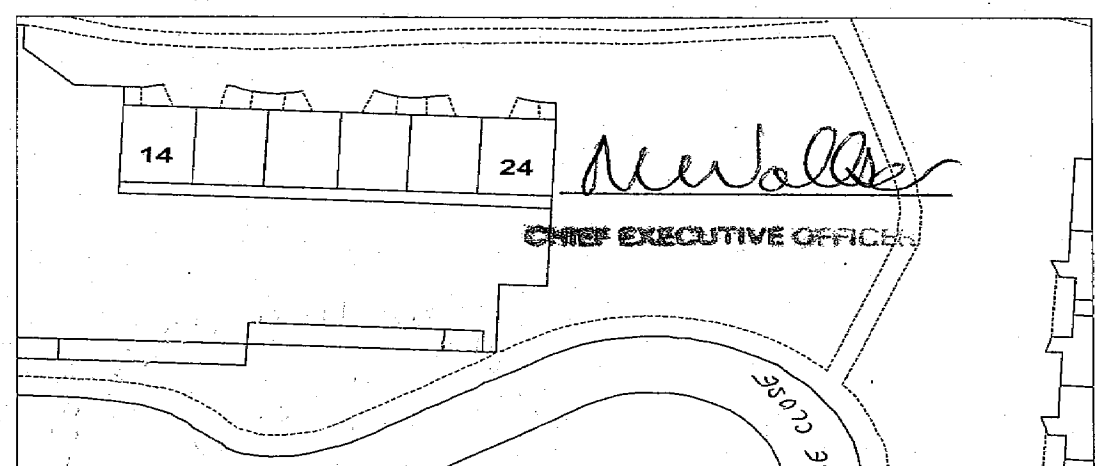
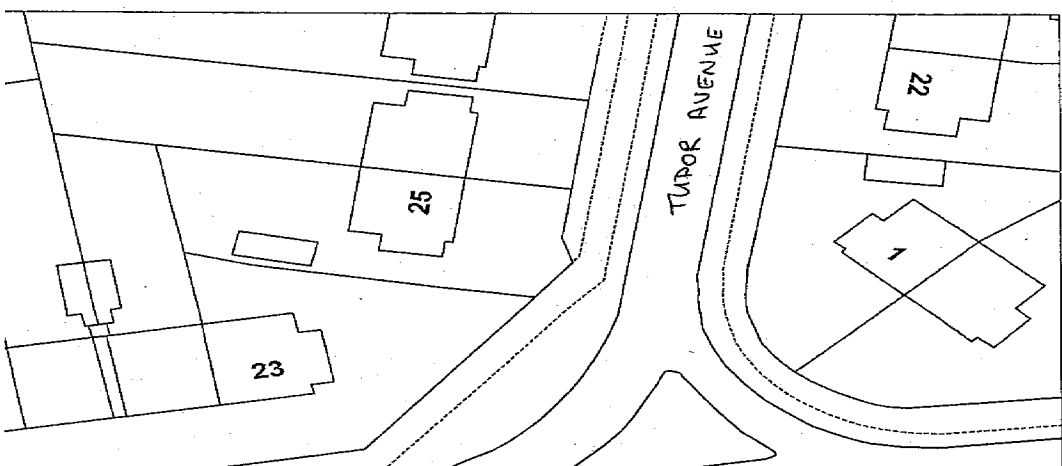
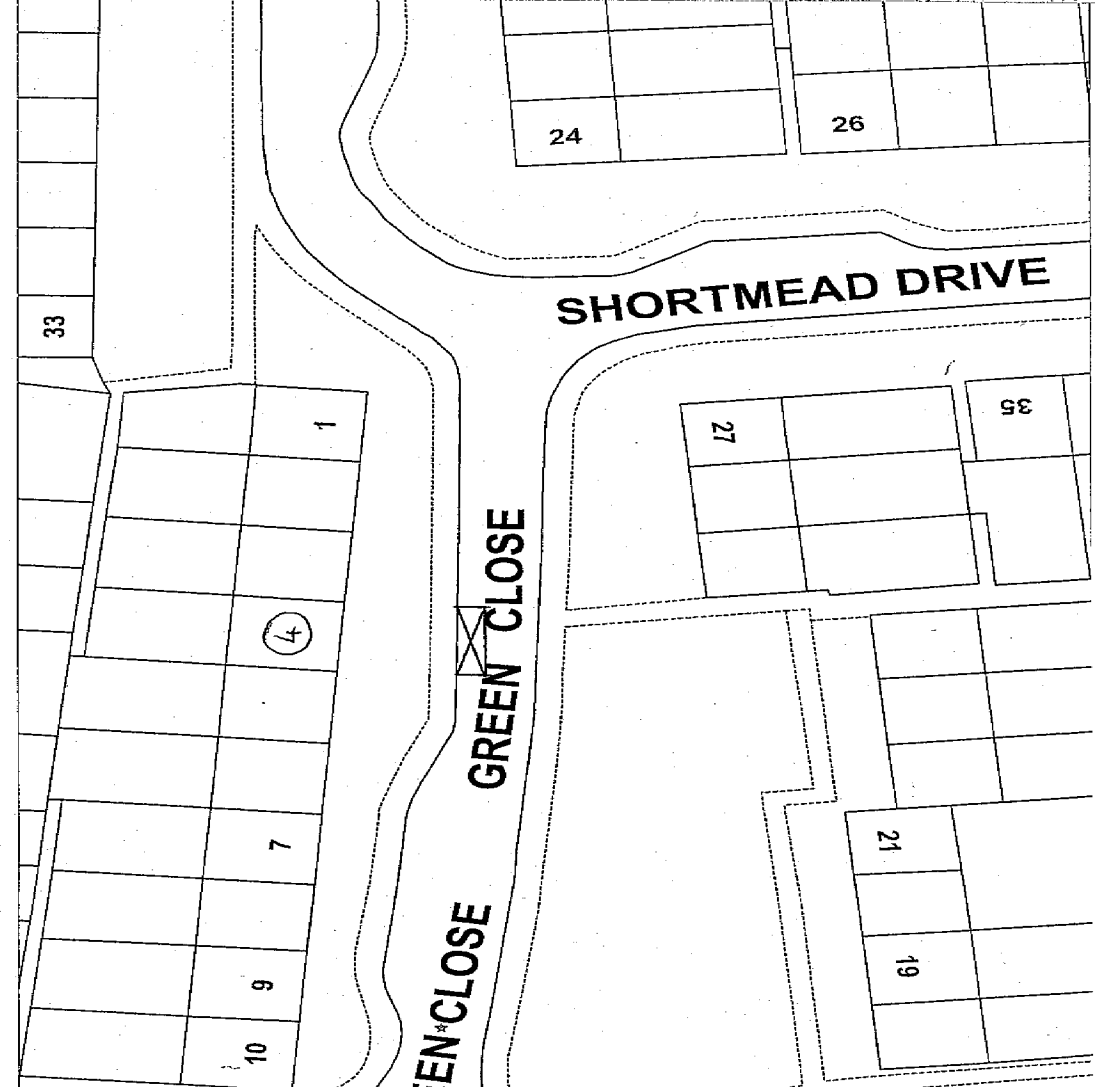
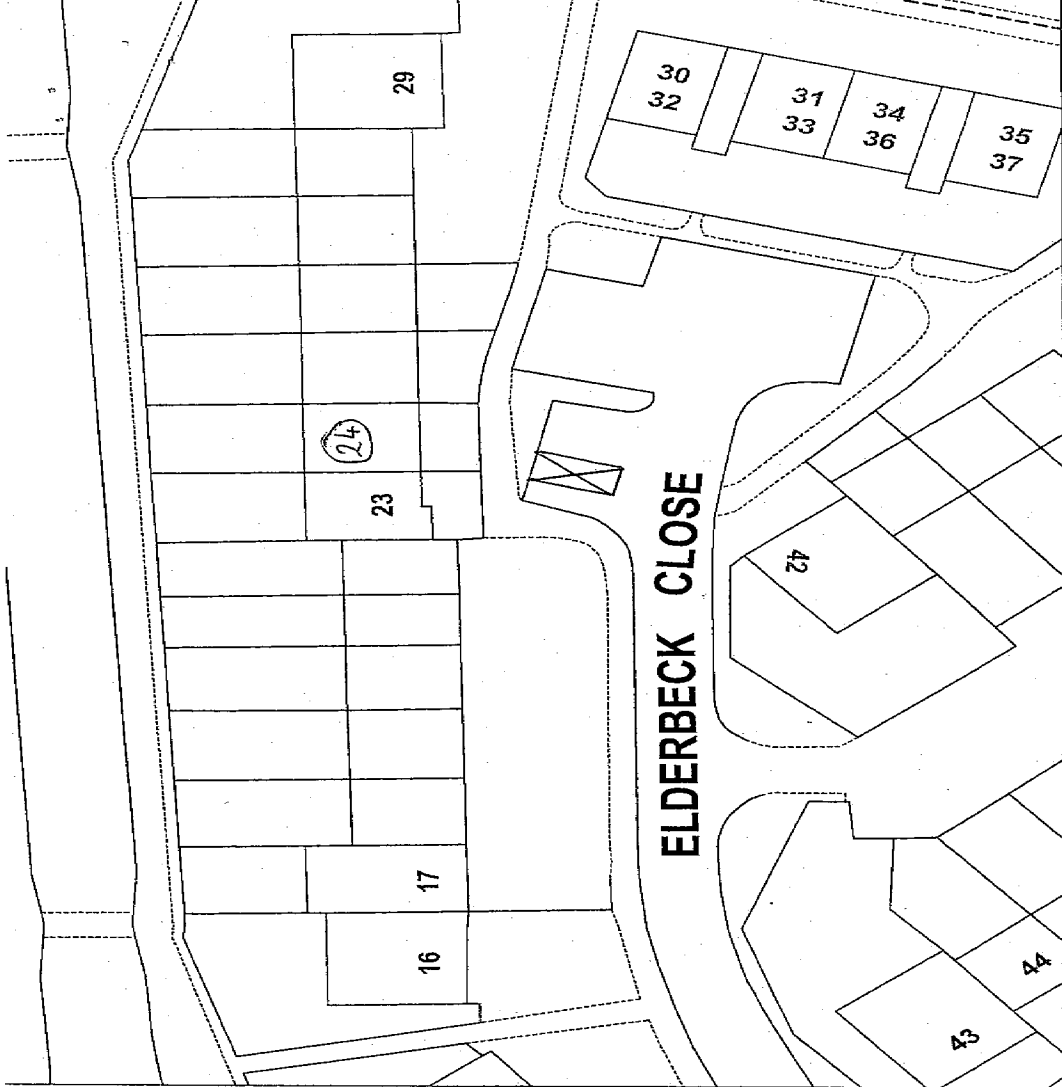

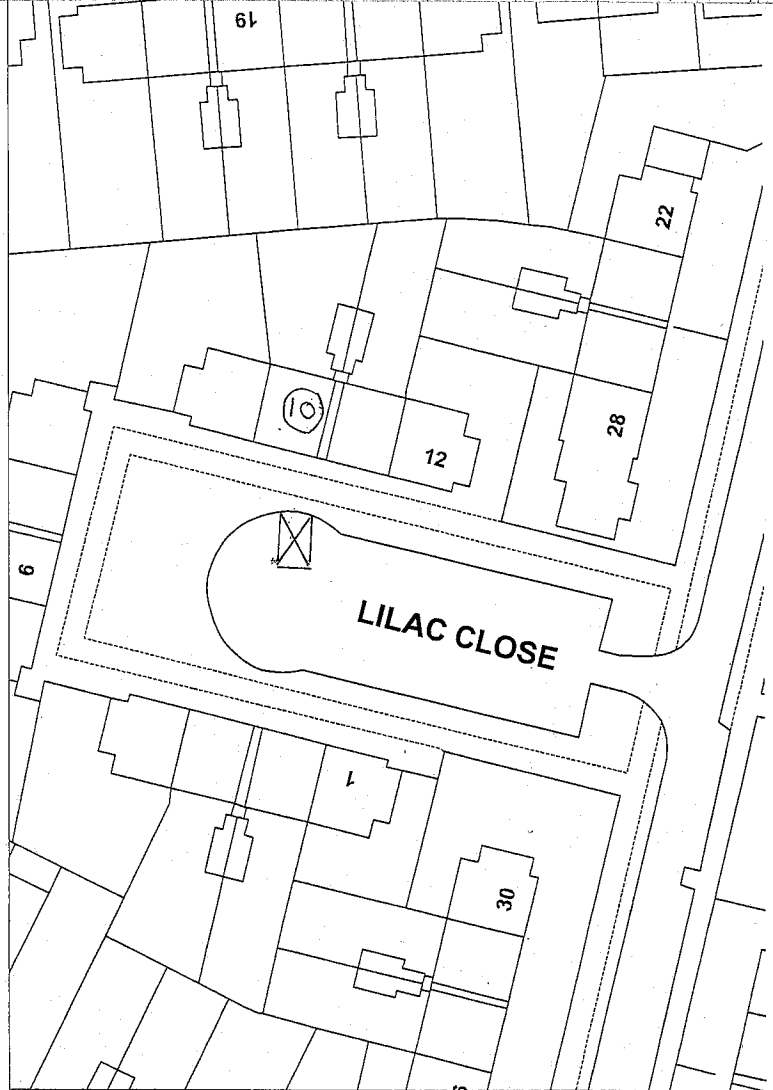
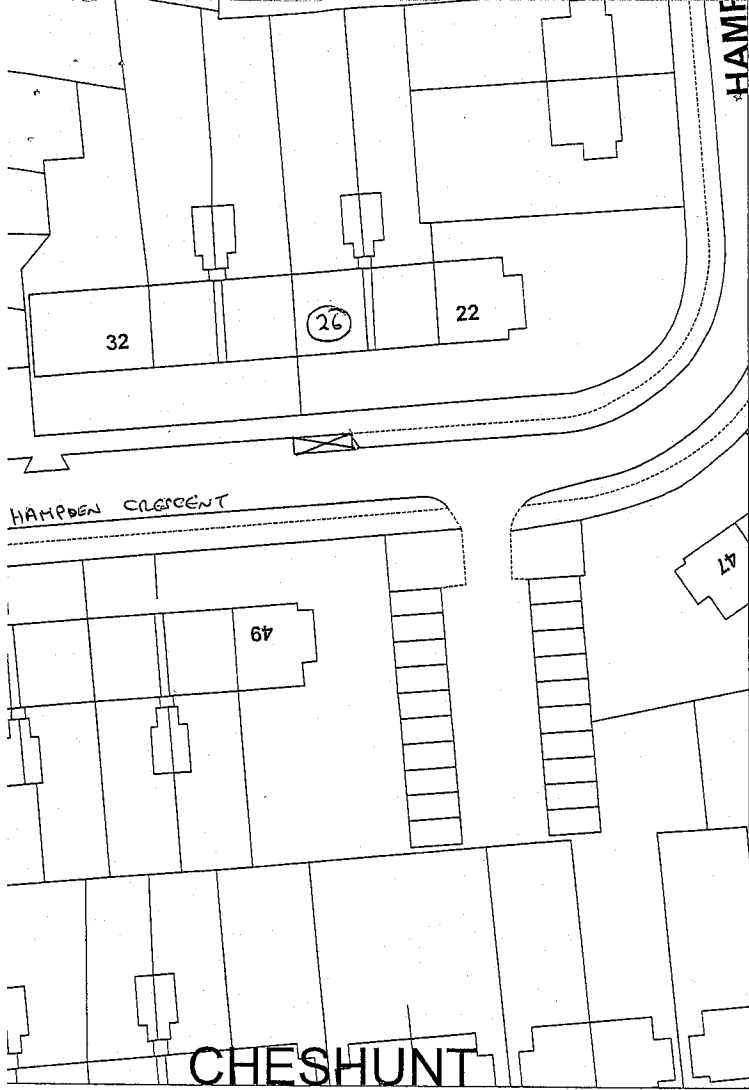

OXGLOVE

CASTLE CLOSE

CHITTENDEN CLOSE

NORRIS LANE

WHITLEY ROAD

CHIEF EXECUTIVE OFFICER

M. Walker



