

**BRIDGEND COUNTY BOROUGH COUNCIL
(OFF-STREET PARKING PLACES)
(CIVIL ENFORCEMENT) ORDER 2013**

BRIDGEND COUNTY BOROUGH COUNCIL
(OFF-STREET PARKING PLACES)
(CIVIL ENFORCEMENT) ORDER 2013

Bridgend County Borough Council in exercise of its powers under Sections 32, 35 and Part IV of Schedule 9 of the Road Traffic Regulation Act 1984, as amended ("the Act of 1984") and of all other enabling powers, after consultation with the Chief Constable of Police in accordance with Part III of Schedule 9 to the 1984 Act hereby makes the following Order.

PART 1
GENERAL

Commencement and Citation

1. This Order shall come into operation on the 1st day of April 2013 and may be cited as the Bridgend County Borough Council (Off-Street Parking Places) (Civil Enforcement) Order 2013.
- 2 The Bridgend County Borough Council (Prohibition and Restriction of Waiting and Loading and Parking Places) (Civil Enforcement) Order 2013, Order Plans including the key (the "Plans") are incorporated into this Order as Schedule 2.

Interpretation

3. In this Order, except where the context otherwise requires, the following expressions have the meanings respectively assigned to them:

"alternative approved method of payment" means cashless payments, pay by phone, payment by debit or credit card facilitated by on site or remote verification by, for example, card reader or mobile phone text or phone call or decrementing card;

"authorised officer" means a person authorised by or on behalf of the Council to supervise any parking place and enforce the provisions of this Order;

“charging days”, means those days other than Christmas Day and Easter Sunday, which are as specified at each parking place respectively;

“charging hours” means the period as specified at each parking place on all charging days;

“Council” means Bridgend County Borough Council or any of its successor authorities and includes any parking services contractors or authorised agent appointed by or acting on behalf of the Council for the purposes of any function under the provisions of this Order;

“daily charge” means the charge imposed by the Council for parking in a parking place on any one day and for a specified period of time as is identified in the scale of charges specified in Schedule 1 and by notice on site;

“disabled person’s badge” has the same meaning as in the Disabled Persons (Badges for Motor Vehicles) (Wales) Regulations 2000 (S.I. 2000/1786 (W.123)) as amended;

“disabled person’s vehicle” means a vehicle displaying in the relevant position a disabled person’s badge in accordance with the Local Authorities’ Traffic Orders (Exemptions for Disabled Persons) (Wales) Regulations 2000;

“enactment” means any enactment, whether public, general or local, and includes any order, byelaw rule, regulation, scheme or other instrument having effect by virtue of an enactment;

“expiry time” is the time indicated on the pay and display ticket and is the time by which the vehicle must leave the parking place;

“loading/unloading” refers to when a vehicle is parked wholly in a parking place or bay marked for that purpose on site, for the purpose of delivering or collecting goods or merchandise or loading or unloading the vehicle at premises adjacent to the

parking place or bay and the vehicle does not park for more than twenty minutes or such longer period as an authorised officer may specify;

“motor-cycle” has the same meaning as that in S136 of the Act of 1984;

“owner” in relation to a vehicle, means the person by whom such vehicle is kept and used and in determining who was the owner at any time it shall be presumed that the owner was the person named in the vehicle registration document as the registered keeper of the vehicle or the person who has the use of such vehicle in the course of his / her employment and who is entitled to use such vehicle as though he / she were the registered keeper thereof;

“park” and “parked” refer to the stopping of a vehicle and it remaining at rest for some time whether or not the driver is still in the vehicle and a vehicle shall be deemed to be parked for any period in the same parking place or parking bay (as the case may be) if any part of it is below the vehicle or the vehicle’s load (if any) whether or not the vehicle is moved during that period;

“parking bay” means an area of a parking place, which is provided for the leaving of a vehicle of a class specified and indicated by markings on the surface of the parking place or signed or otherwise indicated by signs in the parking place;

“parking place” means an area of land provided by the Council pursuant to the Act of 1984 for the purpose of parking of vehicles of specific classes and not closed (in part or in whole) by a notice erected thereon by authority of the Council;

“pay and display ticket” means a ticket issued by a ticket machine located in the parking place in which the vehicle has been parked or issued by a person nominated by the Council on payment of a charge and valid for a parking period as displayed at that parking place;

“pay by phone” means a method of payment of the parking charge involving registration of payment by phone or electronic means and, on first use, registration of the relevant registration number of the vehicle, location of the parking place, credit or debit card details or any such other details as the Council may from time to time

require which is accepted by the Council as a valid method of payment for the relevant time of use of the parking place;

“penalty charge” has the same meaning as in section 92 of the Traffic Management Act 2004 or any subsequent legislation so enabling;

“permit” means any permit issued by the Council under the provisions of this Order;

“relevant position” means

- (a) in respect of a disabled persons vehicle displaying a valid disabled person’s badge -
 - (i) in the case of a vehicle fitted with a dashboard or fascia panel, the badge is exhibited thereon so that Part 1 (the front of the badge), is legible from outside the vehicle; or
 - (ii) in the case of a vehicle not fitted with a dashboard or fascia panel, the badge is exhibited in a conspicuous position on the vehicle so that Part 1 of the badge is legible from outside the vehicle;
- (b) in respect of a vehicle displaying a pay and display ticket or permit -
 - (i) the ticket or permit is exhibited on the inside surface of the windscreen or in a clearly visible position so that it is facing forwards and can be easily seen and read from the front or side of the vehicle.
 - (ii) in the case of a vehicle that is not fitted with a transparent windscreen, the ticket or permit is exhibited on the front of the vehicle facing forwards and clearly visible; or

“ticket machine” means an apparatus of a type and design approved by the appropriate Minister for the purpose of the Act of 1984, being apparatus designed to indicate the time by a clock and to issue parking tickets which show that a payment has been made of an amount or for a period specified thereon and which specify the date and, either the time of such payment, or the expiry time of the parking period for which payment has been made;

“vehicle” means a motor vehicle or a trailer and “motor vehicle” and “trailer” have the same meaning as that assigned to motor vehicle in section 136 of the Act of 1984;

“virtual parking permit” means an electronic record of parking ticket, permit or dispensation issued and confirmed by the Council to exempt a vehicle from a restriction in the provisions of this Order, under the terms applicable at the time of issue;

“wait” and “waiting” refer to the stopping of a vehicle and it remaining at rest whether or not the driver is still in the vehicle; “Wait” and “waiting” apply as for “park” and “parked”.

4. Except where the context requires otherwise, any reference in this Order to a numbered Article shall be construed as a reference to the Article bearing that number in this Order.
5. Any reference in this Order to any enactment shall be construed as a reference to that enactment as amended, applied, consolidated, re-enacted by or as having effect by virtue of any subsequent enactment.
6. Unless the context otherwise requires, words denoting the singular shall include the plural and vice versa and words denoting persons shall include either gender, bodies corporate, unincorporated associations and partnerships.
7. The Interpretation Act 1978 shall apply for the interpretation of this Order as it applies for the Interpretation of an Act of Parliament and as if for the purposes of Section 21 of that Act this Order were an Act of Parliament and the Orders revoked by this Order were Acts of Parliament thereby repealed.
8. The restrictions prohibitions and requirements imposed by this Order shall be in addition to and not in derogation from any restriction or requirements imposed by any regulations or Order made or having effect as if made under the Act of 1984 or by or under any other enactment.
9. If a court, the Department for Transport, the Welsh Government, the Traffic Penalty Tribunal or the Traffic Enforcement Centre declares any part of this Order to be invalid or un-enforceable, such declaration shall not invalidate the remainder of the Order.

PART 2

DESIGNATION AND USE OF PARKING PLACES

Designation

10. Each area of land or building named and specified on the Plans in Schedule 2 may be used, subject to the provisions of this Order, as a place to park vehicles of such classes, in such positions, on such days, during such hours, for such period as are displayed at each parking place and on payment of such charges as stated in Schedule 1 and as displayed on site and for the avoidance of doubt the full area of land designated as a parking place on the plans in Schedule 2 is covered by the provisions of this Order.

Class and position of vehicle

11. Where by notice at a parking place, the parking place, or any parking bay within the parking place, is described as available for vehicles of a specified class or vehicles to be parked in a specified location, no person shall cause or permit a vehicle to be parked in that parking place or in any parking bay within the parking place
- (i) if it is in a position other than that specified; or
 - (ii) it is there for a purpose other than provided for in this Order.

Classes of vehicle

12. No person shall cause or permit a vehicle to be parked in a parking bay unless it is of a class of vehicle specified in the Schedules or as displayed on site.

Position of vehicle

13. If parking bays are marked out in a parking place the driver of a vehicle shall ensure that it is not parked beyond the parking bay markings and shall not permit it to wait in that parking place unless it is so positioned.
14. If parking bays are not marked out in a parking place the driver of a vehicle shall ensure that it is positioned so that it does not obstruct other vehicles using the parking

place, the free flow of traffic circulating within the parking place and the entrances to and exits from the parking place.

Disabled person's parking bays

15. No person shall cause or permit a vehicle to be parked in a parking bay marked for disabled persons unless the vehicle is a disabled persons vehicle and displays a valid disabled person's badge in the relevant position and immediately before or immediately after the act of parking the vehicle has been or is about to be used by the person(s) in respect of whom the disabled person's badge has been issued.

Permit parking bays

16. No person shall cause or permit a vehicle to park in a parking bay marked for permit holders unless the vehicle is displaying a permit valid for that time and that parking bay. Where a virtual parking permit has been obtained as an alternative to a parking ticket and remains valid, any requirement in this Order for the permit to be displayed on the vehicle to which it relates shall not apply.

Loading and unloading bays

17. No person shall cause or permit a vehicle to park in any area marked as a loading bay unless the vehicle is being used for the purpose of loading or unloading.

Motor cycle parking bays

18. No person shall cause or permit a vehicle to park in a parking bay marked for motor cycles unless the vehicle is a motor cycle.

Hours of operation and maximum period of stay

19. Where in the Schedules and as displayed on site, a parking place or any parking bay within the parking place is described as being in operation on specified days, during specified hours or for a maximum period of stay, no person shall cause or permit a vehicle to be parked in that parking place or in any parking bay within the parking

place on any day, during such hours or for any period other or longer than those specified.

Period of no return

20. Where in the Schedules, and as displayed on site a parking place is described as having a period within which a vehicle may not return, no person shall cause or permit a vehicle to be parked again in that parking place on any day, during such hours within which the vehicle is excluded from waiting in the parking place.

Power to close or suspend parking places

21. Nothing in this Order shall prevent the Council by notice, sign or barrier displayed or erected in a parking place:
- (i) from closing a parking place or any part thereof for any period; and/or
 - (ii) from setting aside a parking place or any part or parts thereof on all days or on certain days or during certain parts of days for use only by particular vehicles or organisations.
22. Any person closing or suspending the use of a parking place or any part thereof shall thereupon place or cause to be placed in or adjacent to that parking place or that part thereof a notice or traffic sign indicating that that parking place or that part thereof is closed or the use is suspended and that parking by vehicles is prohibited.
23. No person shall cause or permit a vehicle to be parked in a parking place or any part thereof during such periods that the parking place or that part thereof is closed or the use is suspended or during such period as there is in or adjacent thereto a notice or traffic sign indicating the closure or suspension placed by or on behalf of the Council.

Sale of Goods

24. No person shall in a parking place without the express written permission of the Council, use a vehicle, in connection with the sale of any article, including the vehicle itself, to any person in or near the parking place or in connection with the selling or offering for hire of skill or services in any other capacity.

Parked with engine running

25. The driver of a vehicle using a parking place shall stop the engine as soon as the vehicle is in a parking bay and shall not start the engine or sound any horn or similar instrument except when about to change the position of the vehicle in or to depart from the parking place.

Parked causing an obstruction

26. No person shall in a parking place park the vehicle in such a manner or place where it causes an obstruction to any other users of the parking place.

PART 3 CHARGES FOR PARKING

Payment

27. No person shall cause or permit any vehicle to be parked in a parking place without arranging for the appropriate charge (if any) to be paid in accordance with the scale of current charges as stated in Schedule 1 and as displayed at the parking place.

Means of payment

28. The charges referred to in the preceding Article shall be payable in the manner as displayed at that parking place.

Pay and display parking places

29. The person in charge of a vehicle, upon parking the vehicle in a parking bay, shall immediately
- (i) arrange for the purchase of a pay and display ticket from a ticket machine situated at that parking place at the level of charge and for the period required in accordance with the scale of daily charges as stated in Schedule 1 and as displayed on site

- or
- (ii) make arrangements to pay the appropriate fee through an alternative approved method of payment at the level of the daily charge and for the period required in accordance with the scale of charges as stated in Schedule 1 and as displayed on site.

Display of ticket

30. Save where payment has been made by an alternative approved method of payment, once a vehicle has been parked within a pay and display parking place the person in charge of the vehicle shall ensure that:
- (i) a valid pay and display ticket has been obtained to cover the entire period that the vehicle is parked in the parking place, and
 - (ii) the valid pay and display ticket is displayed in the relevant position on the vehicle in respect of which it was issued at all times the vehicle is parked.

Validity of pay and display tickets

31. A pay and display ticket is not transferable from one vehicle to another and on transfer the pay and display ticket ceases to be valid.
32. A pay and display ticket is valid only in the parking place in which it was issued. This is defined by the reference code of the ticket machine located in that parking place printed on the pay and display ticket.

Expiry of parking period

33. The expiry of the period for which the appropriate charge has been paid shall be
- (i) where a pay and display ticket has been purchased, when the time shown on the clock of the issuing ticket machine is later than the expiry time shown on the pay and display ticket displayed, or
 - (ii) where an alternative approved method of payment has been used, when the period for which payment has been made and recorded has been exceeded.

No pay and display ticket displayed

34. If at any time while a vehicle is parked in a parking place, no pay and display ticket is displayed on that vehicle in the relevant position and in accordance with the provisions of this Order, it shall be deemed that the charge has not been paid save as where a virtual parking permit has been issued and remains valid or where there has been payment by some alternative approved method of payment such that any requirement under this Order for the pay and display ticket to be displayed on the vehicle to which it relates shall not apply.
35. If at the time when a vehicle is parked during the charging hours in a parking place and the nearest ticket machine in that parking place is out of order, then a ticket shall be obtained from another ticket machine within the same parking place (where provided) or as directed in the parking place.
36. Where no valid pay and display ticket can be obtained from a ticket machine within a parking place, vehicles may be parked in a parking place but may not be parked for longer than the maximum period of parking in that parking place as displayed at the parking place.

Permits

37. Permits are available from the Council at the appropriate fee (if applicable), for a vehicle of a specific class and for a specific parking place subject to conditions determined by the Council.
38. A permit is only valid in the parking place(s) in respect of which it was issued, for the vehicle in respect of which it was issued and up to the date of expiry shown on the permit.
39. The driver shall abide by the terms stipulated by the Council for the use of the permit.

Display of permit

40. A permit shall be displayed in the relevant position on the vehicle in respect of which it was issued at all times during which the vehicle is parked in the parking place. Where

a virtual parking permit has been obtained as an alternative to a parking ticket and remains valid, any requirement in this Order for the parking ticket to be displayed on the vehicle to which it relates shall not apply.

Replacement permits

41. Damaged or lost permits will be replaced on application to the Council and on payment of an administration fee in accordance with Council procedure. The damaged or lost permit will then become immediately invalid.

Surrender and refunds

42. A permit remains the property of the Council and must be surrendered on request.
43. The holder of a permit may, on surrendering the permit, be entitled to a refund in accordance with Council procedure in place at that time.

Restriction on removal

44. When a pay and display ticket or permit has been exhibited on a vehicle in the relevant position no person shall remove the pay and display ticket or permit from the vehicle until the vehicle is removed from the parking place.

PART 4 EXEMPTIONS

Exemption from daily charge

45. No daily charge shall be payable in respect of;
- (i) a disabled persons vehicle which displays in the relevant position a valid disabled person's badge provided that the vehicle immediately before or after the act of parking has been used or is about to be used by the person(s) in respect of whom the badge is issued;
 - (ii) a motor cycle;

- (iii) a vehicle parked displaying in the relevant position a permit valid for that parking place.

Absence of Ticket machine

46. If at the time when a vehicle is parked in a parking place during the charging hours there is no ticket machine at the parking place, or all the ticket machines at that parking place carry notices placed upon them by an authorised officer indicating that they are out of order, the driver of that vehicle shall be exempt from purchasing a pay and display ticket.

Payment by alternative approved method of payment

47. Where arrangements to pay the daily charge have been made through an alternative approved method of payment and no pay and display ticket is produced following the process, the driver of a vehicle shall be exempt from the requirement to display such a ticket.

PART 5 RELOCATION, REMOVAL AND DISPOSAL OF VEHICLES

Emergencies

48. An authorised officer or a police officer in uniform may, using such measures as are appropriate, move or cause to be moved in the case of an emergency to any place he/she thinks fit, any vehicle parked in a parking place.

Contraventions in suspended parking place

49. An authorised officer may, using such measures as are appropriate, move or cause to be moved to any place he/she thinks fit, any vehicle parked in a parking place which has been closed or suspended in whole or in part by the Council and the cost of movement or removal and safe keeping shall be the liability of the owner of the vehicle.

Safe keeping

50. Any person removing or arranging the removal of a vehicle from a parking place under the provisions of this Order shall make such arrangements as may be reasonably necessary to provide for the safe keeping of the vehicle save that the Council or its duly authorised agents shall not be liable for any loss or damage caused to the vehicle or its contents as a result of the vehicle being removed from the parking place under the provisions of this Order unless they have acted negligently.

Disposal of vehicles abandoned in parking places

51. The Council may sell or otherwise dispose of, in accordance with current legislation, a vehicle which has been, or could at any time be, removed from a parking place if the vehicle appears to have been abandoned.

PART 6 CONTRAVENTION AND PENALTY CHARGE

Contravention

52. Save for the provisions in Part 7, if a vehicle is parked in a parking place without complying with the requirements of this Order, a contravention shall have occurred and a penalty charge shall be payable.

Indications as to Evidence

53. The particulars given in any notice of penalty charge served on a vehicle in accordance with the provisions of this Order shall be treated as evidence in any proceedings relating to failure to pay the penalty charge.

Restriction on removal of notices

54. Any notice fixed to a vehicle in accordance with this Order shall not be removed or interfered with except by or under the authority of:
- (i) the owner, or person in charge of, the vehicle;
 - (ii) the Council.

PART 7

LIABILITY AND OTHER PROVISIONS

Liability

55. The Council accepts no liability for the loss or damage to vehicles or other property left in any of the parking places to which this Order applies save for that arising from the negligence of the Council.

Driving within a parking place

56. Where in a parking place signs are erected or surface markings are laid for the purpose of
- (i) indicating the entrance to or exit from the parking place, or
 - (ii) indicating that a vehicle using the parking place shall proceed in a specified direction within the parking place,
- any person who drives or permits to be driven any vehicle
- (iii) so that it enters the parking place otherwise than by an entrance or leaves the parking place otherwise than by an exit, so indicated, or
 - (iv) in a direction other than so specified
- shall be liable to prosecution.
57. Any person who, without with the permission of a person authorised by the Council in that behalf, drives or permits to be driven any vehicle in a parking place for any purpose other than the purpose of leaving that vehicle in the parking place in accordance with the provisions of this Order or for the purpose of departing from the parking place shall be liable to prosecution.

Wilful damage

58. Any person who with intent to defraud interferes with a ticket machine or operates or attempts to operate it by the insertion of objects other than undamaged and unaltered coins of legal tender and of the appropriate denomination, shall be liable to prosecution.

Domestic purposes

59. Any person who uses any part of the parking place or any vehicle parked in a parking place
- (i) for sleeping or camping or cooking, or
 - (ii) for the purpose of servicing or washing any vehicle or part thereof other than is reasonably necessary to enable the vehicle to depart from the parking place,
- shall be liable to prosecution.

Behaviour

60. Any person who wilfully sounds any horn or any other similar instrument on a vehicle except when about to change the position of the vehicle in or to depart from the parking place shall be liable to prosecution.
61. Any person who in a parking place shouts or otherwise makes any loud noise to the disturbance or annoyance of users of the parking place or residents or premises in the neighbourhood shall be liable to prosecution.
62. Any person who in a parking place uses any threatening, abusive or insulting language, gesture or conduct with intent to put any person in fear or so as to occasion a breach of the peace or whereby a breach of the peace is likely to be occasioned shall be liable to prosecution.

Other activities

63. Any person who in a parking place
- (i) erects or causes or permits to be erected any tent, booth, stand, building or other structure without the written consent of the Council, or

- (ii) lights or causes to be lit any fire,
 - (iii) causes wilful or deliberate damage to the fabric of the car park
 - (iv) cycles or skateboards in the car park
- shall be liable to prosecution.

PART 8

REVOCATIONS

Revocations

64. All Orders made by the Council including any amendments thereof, relating to the off-street parking places specified in the Schedules prior to the making of this Order are hereby revoked.

Dated this 18th day of MARCH 2013

EXECUTED as a Deed by affixing the COMMON SEAL
of BRIDGEND COUNTY BOROUGH COUNCIL was
hereunto affixed in the presence of



Dovey
Mayor

A black ink signature, likely of the Mayor, written over a horizontal line.

Authorised Signatory

A blue ink signature, likely of an authorised signatory, written in a cursive style.

BRIDGEND COUNTY BOROUGH COUNCIL

(OFF-STREET PARKING PLACES)

(CIVIL ENFORCEMENT) ORDER 2013

SCHEDULE 1

PAYMENT PARKING PLACES

<u>Parking Place</u>	<u>Drawing no</u>	<u>Classes of Vehicle</u>	<u>Days of Operation</u>	<u>Hours of Operation</u>	<u>Scale of Charges</u>	<u>Season Tickets</u>	<u>Max period a vehicle may wait</u>
Brackla No 1 Multi Storey, Cheapside, Bridgend	T1784-01	All classes except vehicles with gross laden weight in excess of 3.5 Tonnes	Mon to Sat	8am to 6pm	0 -1 Hour 70p 1 to 2 hr £1.50 2 to 3hr £2.50 3 hrs & over £3.00	Mon to Fri 4 Weekly £48 Quarterly £126 Mon to Sat 4 Weekly £57.60 Quarterly £151.20	24 Hours

Treman Road, Bridgend	T1784-04	All classes except vehicles with gross laden weight in excess of 3.5 Tonnes	Mon to Sat	8am to 6pm	<p>White Bays 0 -1/2 Hour 30p 1/2 to 1 hr 70p 1 to 2hr £1.50 2 to 3hr £2.50 3 to 4hr £4.00 4 hrs & over £6.00</p> <p>Red Bays 0 to 1 Hr 70p 1 to 3 Hrs £1.50 3 Hrs and Over £3.00</p>	<p>Red Bays Only Mon to Fri 4 Weekly £48 Quarterly £126</p> <p>Mon to Sat 4 Weekly £57.60 Quarterly £151.20</p>	24 Hours
Bowls Car Park, Angel Street, Bridgend	T1784-05	All classes except vehicles with gross laden weight in excess of 3.5 Tonnes	Mon to Sat	8am to 6pm	<p>White Bays 0 -1/2 Hour 30p 1/2 to 1 hr 70p 1 to 2hr £1.50 2 to 3hr £2.50 3 to 4hr £4.00 4 hrs & over £6.00</p> <p>Red Bays 0 to 1 Hr 70p 1 to 3 Hrs £1.50 3 Hrs and Over £3.00</p>	<p>Red Bays Only Mon to Fri 4 Weekly £48 Quarterly £126</p> <p>Mon to Sat 4 Weekly £57.60 Quarterly £151.20</p>	24 Hours
Leisure Pool, Angel Street, Bridgend	T1784-05	All classes except vehicles with gross laden weight in excess of 3.5 Tonnes	Mon to Sat	8am to 6pm	<p>0 -1 Hour 70p 1 to 2 hr £1.50 3 hrs & over £3.00</p>	<p>Mon to Fri 4 Weekly £48 Quarterly £126</p> <p>Mon to Sat 4 Weekly £57.60 Quarterly £151.20</p>	24 Hours

Brackla No 3, Brackla Street, Bridgend	T1784-02	All classes except vehicles with gross laden weight in excess of 3.5 Tonnes	Mon to Sat	8am to 6pm	0 -1/2 Hour 30p 1/2 to 1 hr 70p 1 to 2hr £1.50 2 to 3hr £2.50 3 to 4hr £4.00 4 hrs & over £6.00		24 Hours
The Rhiw Multi Storey, Bridgend	T1784-03	All classes except vehicles with gross laden weight in excess of 3.5 Tonnes	Mon to Sat	8am to 6pm	0 -1/2 Hour 30p 1/2 to 1 hr 70p 1 to 2hr £1.50 2 to 3hr £2.50 3 to 4hr £4.00 4 hrs & over £6.00		24 Hours
Brewery Lane, Bridgend	T1784-06	All classes except vehicles with gross laden weight in excess of 3.5 Tonnes	Mon to Sat	8am to 6pm	0 -1 Hour 70p 1 to 2 hr £1.50 3 hrs & over £3.00	Mon to Fri 4 Weekly £48 Quarterly £126 Mon to Sat 4 Weekly £57.60 Quarterly £151.20	24 Hours
Recreation Centre car park, Angel Street, Bridgend	T1784-05	All classes except vehicles with gross laden weight in excess of 3.5 Tonnes	Mon to Sat	8am to 6pm	0 -1/2 Hour 30p 1/2 to 1 hr 70p 1 to 2hr £1.50 2 to 3hr £2.50 3 to 4hr £4.00 4 hrs & over £6.00		24 Hours

Hillsbro Place, Porthcawl	T1784-07	All classes except vehicles with gross laden weight in excess of 3.5 Tonnes	<p>All days 1st April to 30 th September</p> <p>Mon to Sat 1st Oct to 31st March</p>	8am to 6pm	0 -1 Hour 70p 1 to 3 hr £1.50 3 hrs & over £3.00	<p>1st October to 31st March Mon to Fri 4 Weekly £48 Quarterly £126</p> <p>Mon to Sat 4 Weekly £57.60 Quarterly £151.20</p> <p>1st April to 30th September Mon to Fri 4 Weekly £48 Quarterly £126</p> <p>Mon to Sat 4 Weekly £57.30 Quarterly £151.20</p> <p>Mon to Sun 4 Weekly £56.00 Quarterly £124.00</p>	24 Hours
John Street, Porthcawl	T1784-08	All classes except vehicles with gross laden weight in excess of 3.5 Tonnes	<p>All days 1st April to 30 th September</p> <p>Mon to Sat 1st Oct to 31st March</p>	8am to 6pm	0 -1/2 Hour 30p 1/2 to 1 hr 70p 1 to 2hr £1.50 2 to 3hr £2.50 3 to 4hr £4.00 4 hrs & over £6.00		24 Hours

Rest Bay, Porthcawl	T1784-09	All classes except vehicles with gross laden weight in excess of 3.5 Tonnes	All Days	8am to 6pm	1st April to 30th Sept 0 to 1 Hr £1.00 1 to 13 Hr £2.80 1st October to 31st March Daily Charge £1	Mon to Sun 1st Apr to 30th Sept £90 Mon to Sun 1st October to 31st March £40	24 Hours
---------------------	----------	---	----------	------------	--	---	----------

BRIDGEND COUNTY BOROUGH COUNCIL
(OFF-STREET PARKING PLACES)
(CIVIL ENFORCEMENT) ORDER 2013

SCHEDULE 2

PLANS OF THE CAR PARKS / PARKING AREAS

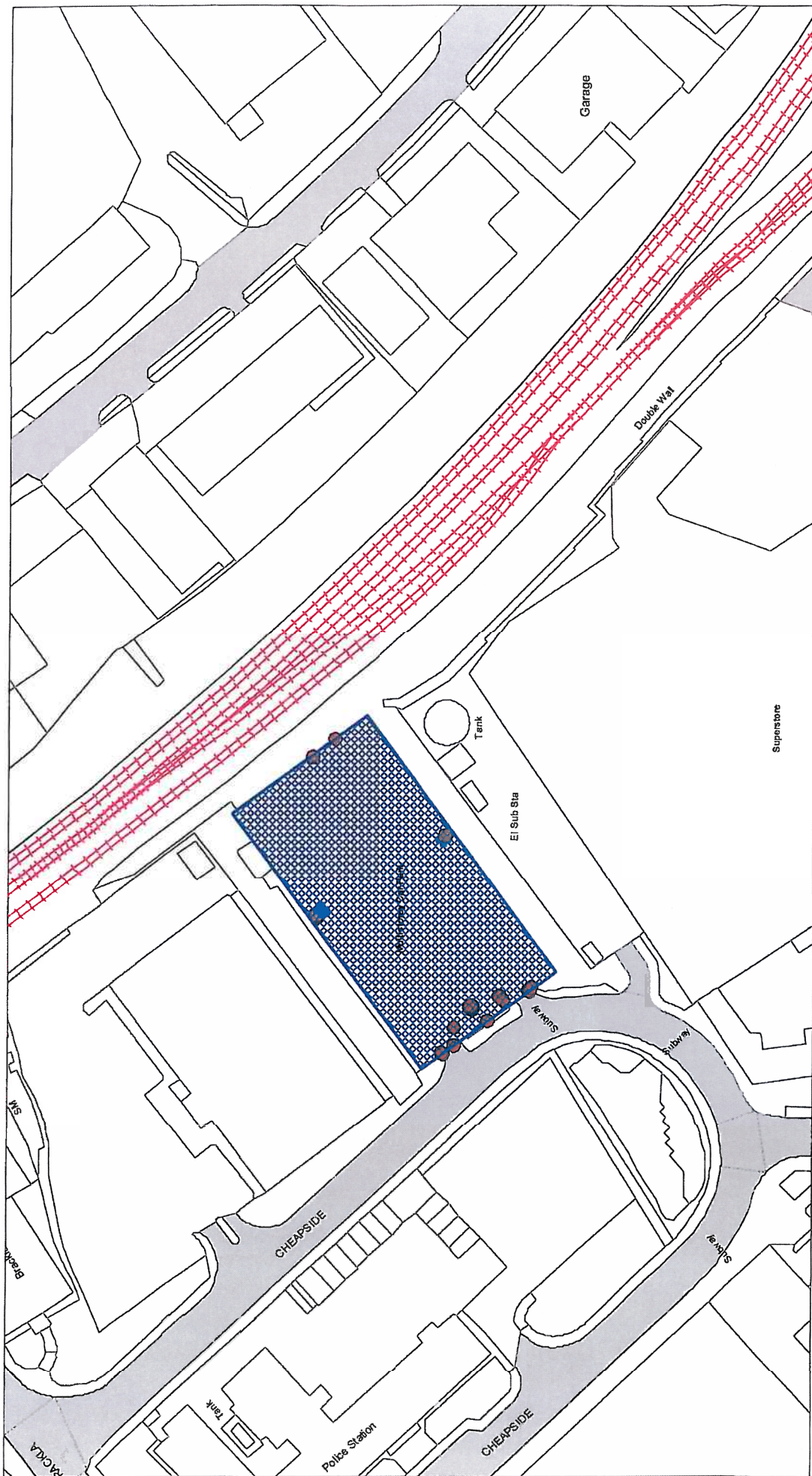

BRACKLA 1, CHEAPSIDE, BRIDGEND.

SCALE	1 : 1000
DATE	14/12/2012
DRAWING No.	T1784 - 01
DRAWN BY	KW

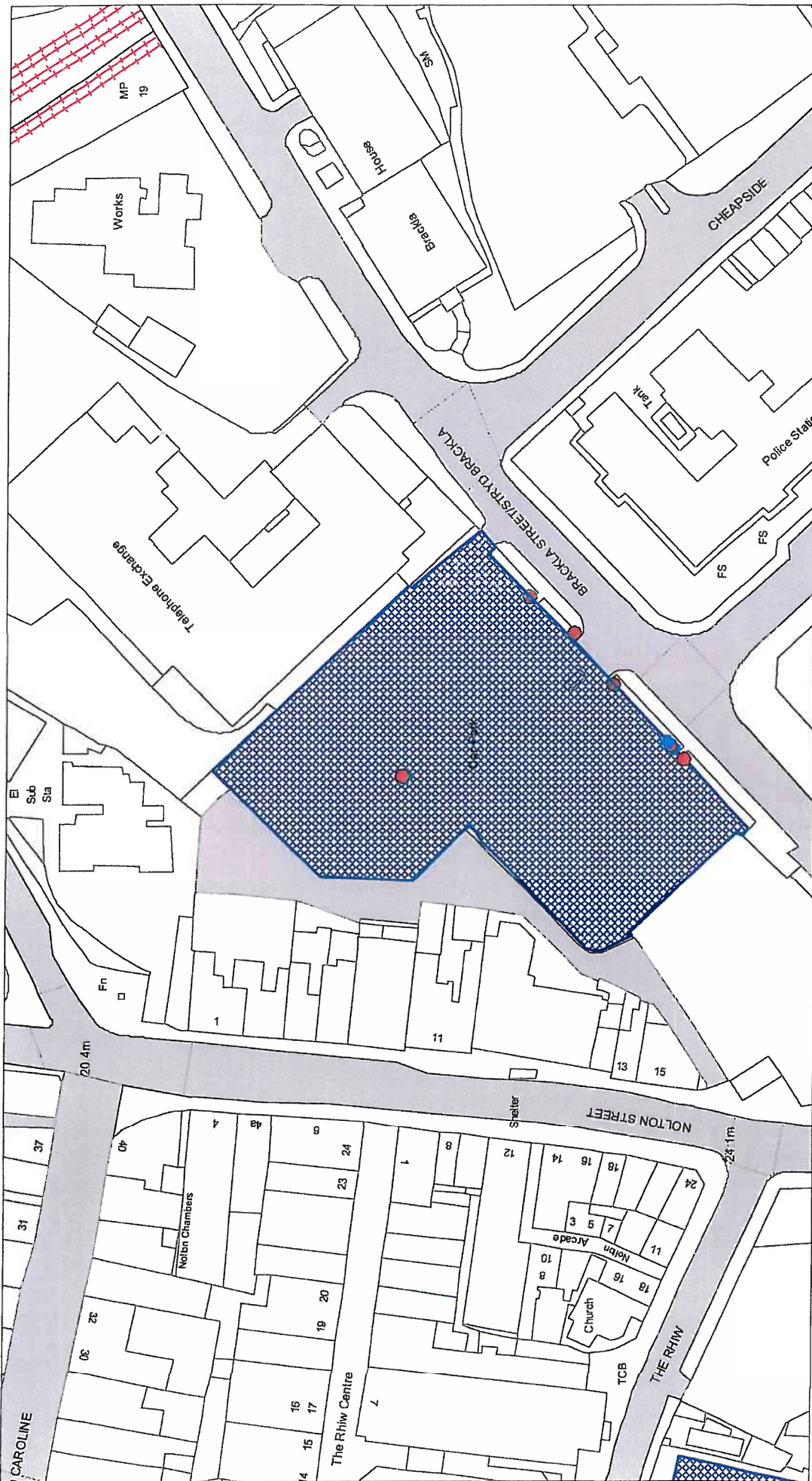

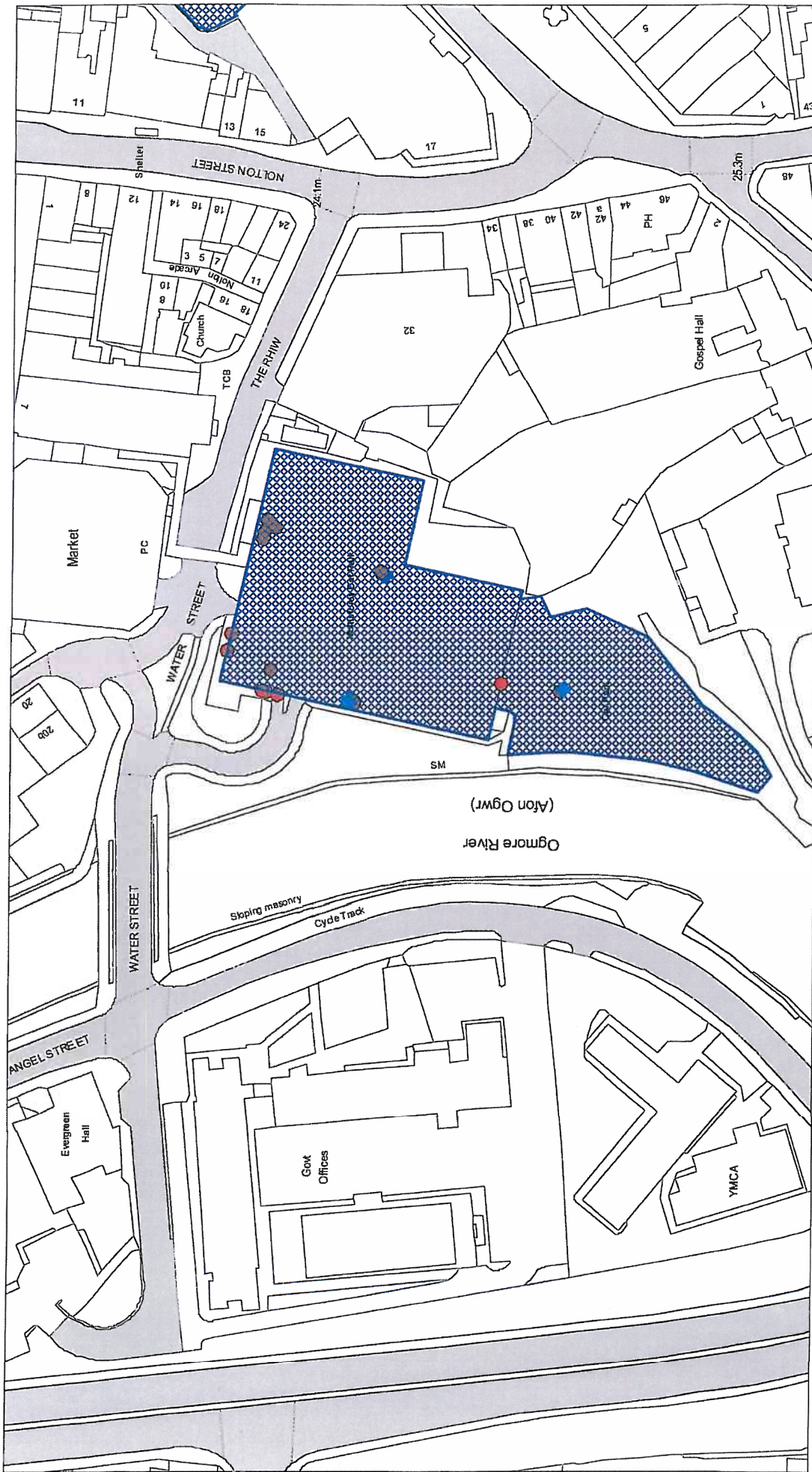

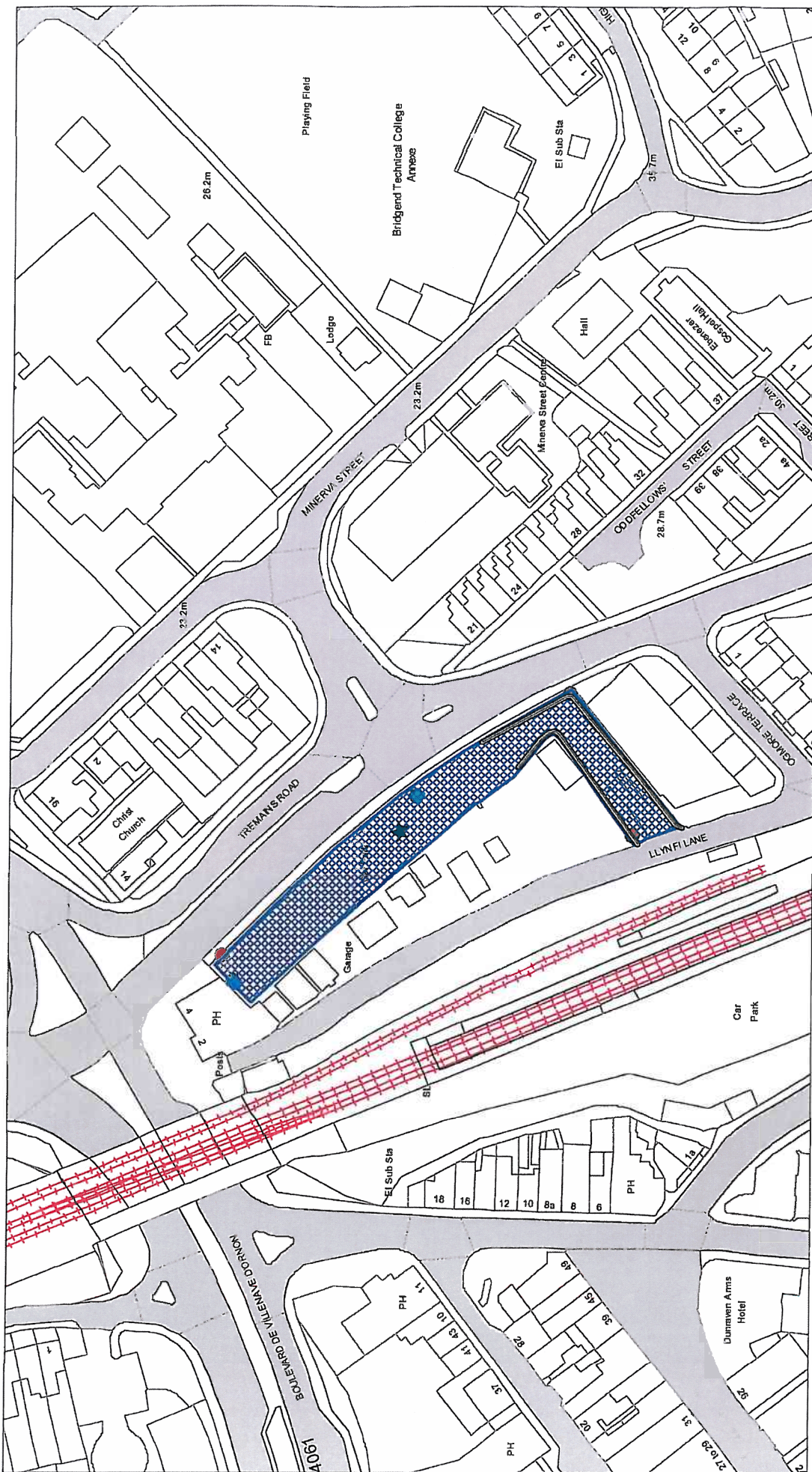

BRIDGENID
CITY BOARDS OF STUDY

© Crown copyright. All rights reserved
Bridgend County Borough Council
Licence No. 2012

REMAINS ROAD CAR PARK, BRIDGEND

SCALE	1 : 1260
DATE	14/12/2012
DRAWING No.	T1784 - 04
DRAWN BY	KW

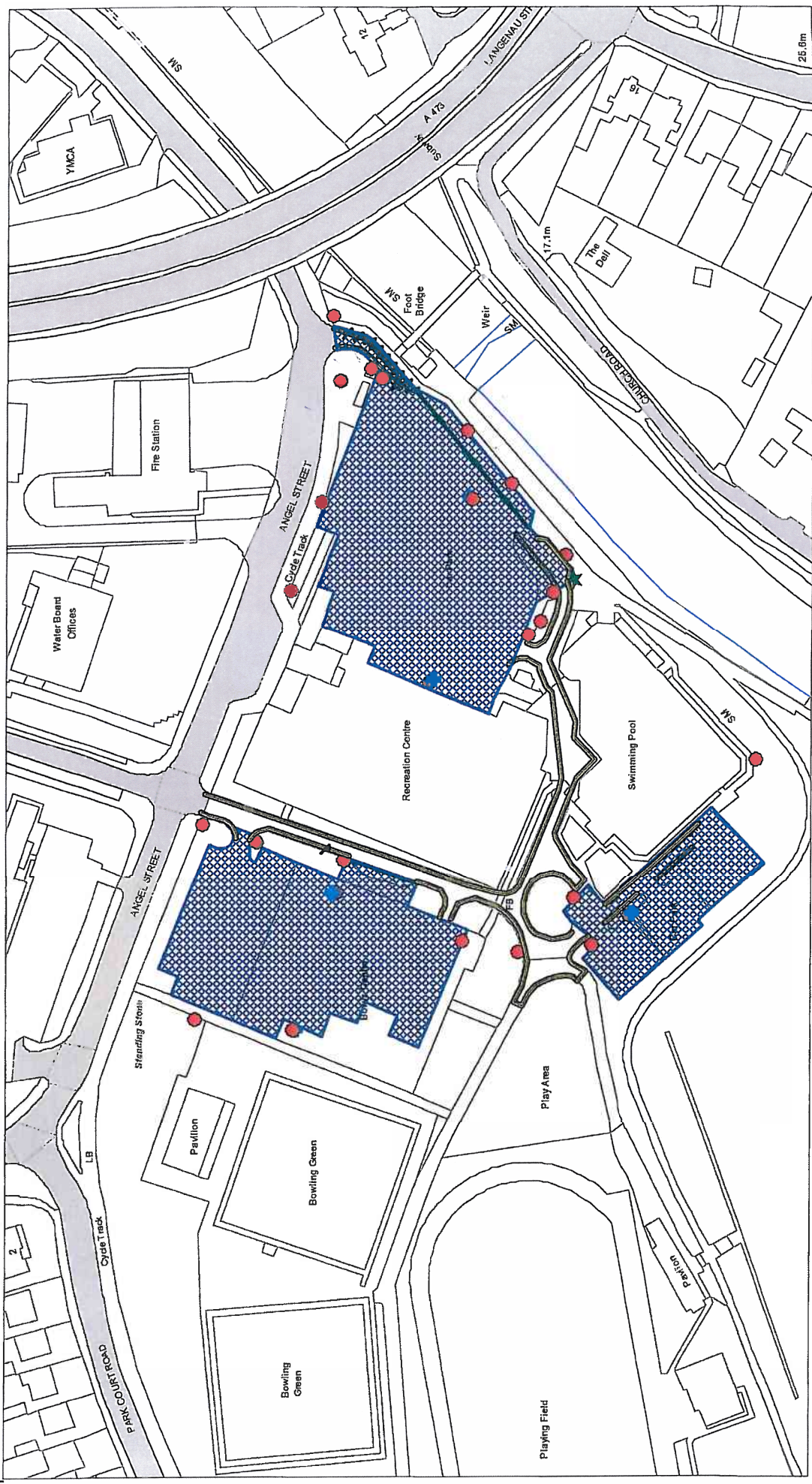

© Crown copyright. All rights reserved
Bridgend County Borough Council
Licence No. 2012

RECREATION CENTRE/BOWLS CENTRE/LEISURE POOL,
ANGEL STREET, BRIDGEND.

SCALE	1 : 1392
DATE	14/12/2012
DRAWING No.	T1784 -OS
DRAWN BY	KW

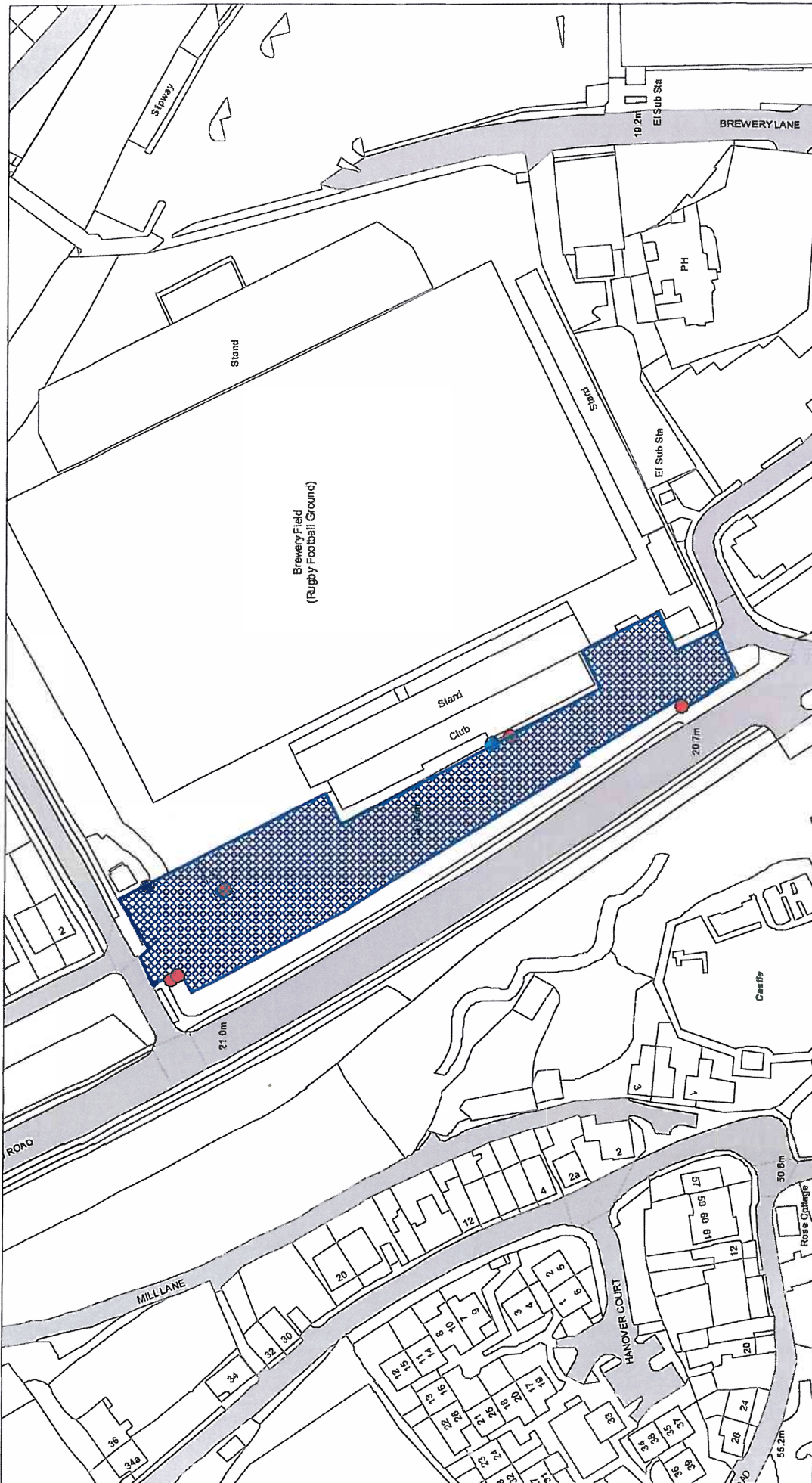

© Crown copyright. All rights reserved
Bridgend County Borough Council
Licence No. 2012

BREWERY LANE, BRIDGEND.

SCALE	1 : 1260
DATE	14/12/2012
DRAWING No.	T17844 - 06
DRAWN BY	KW

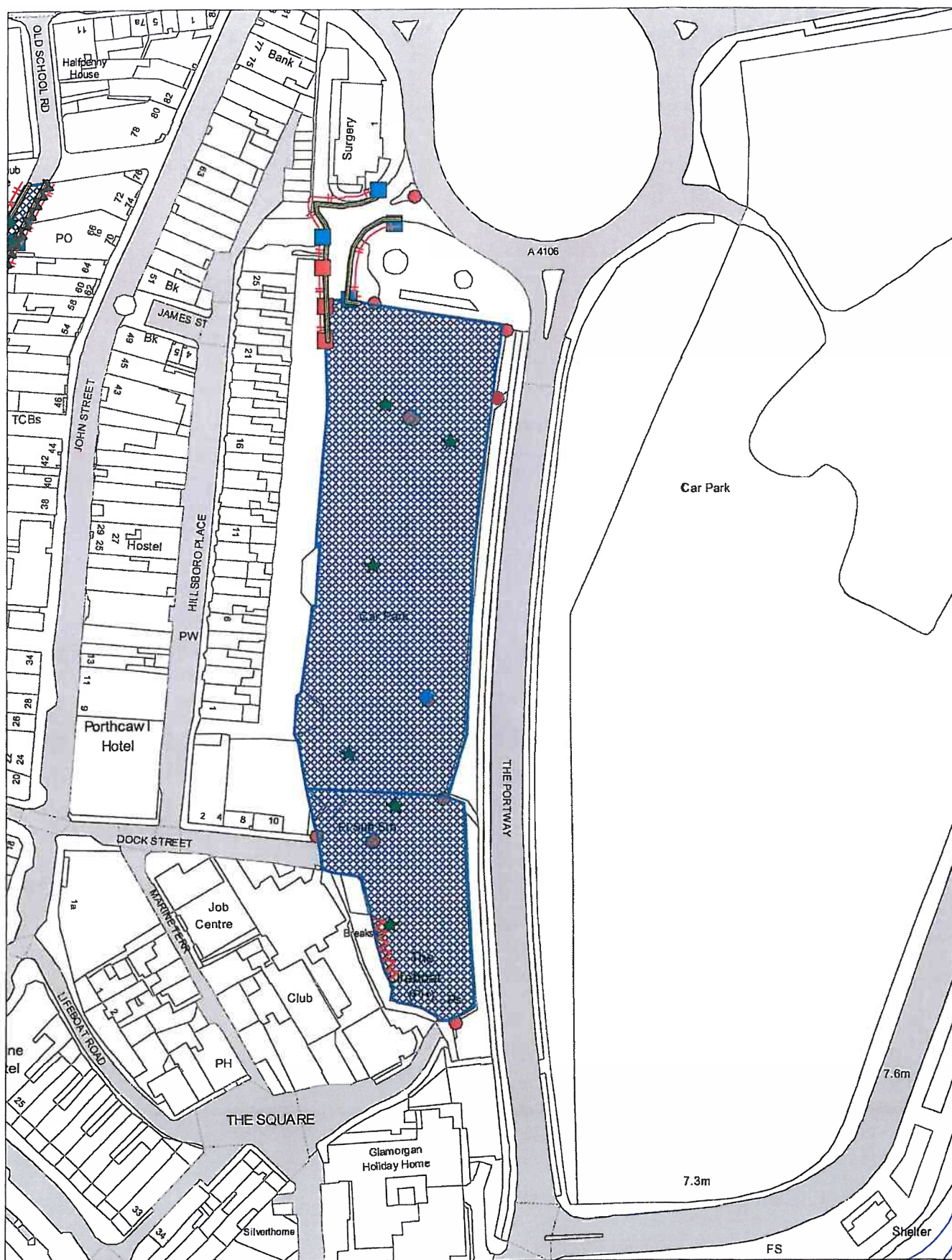

© Crown copyright. All rights reserved
Bridgend County Borough Council
Licence No. 2012
HILLSBORO PLACE, PORTHCOWL

SCALE	1 : 1553
DATE	14/12/2012
DRAWING No.	T1784-07
DRAWN BY	KW



© Crown copyright. All rights reserved
Bridgend County Borough Council
Licence No. 2012

JOHN STREET, PORTHCAWL

SCALE	1 : 716
DATE	14/12/2012
DRAWING No.	T1784-08
DRAWN BY	KW

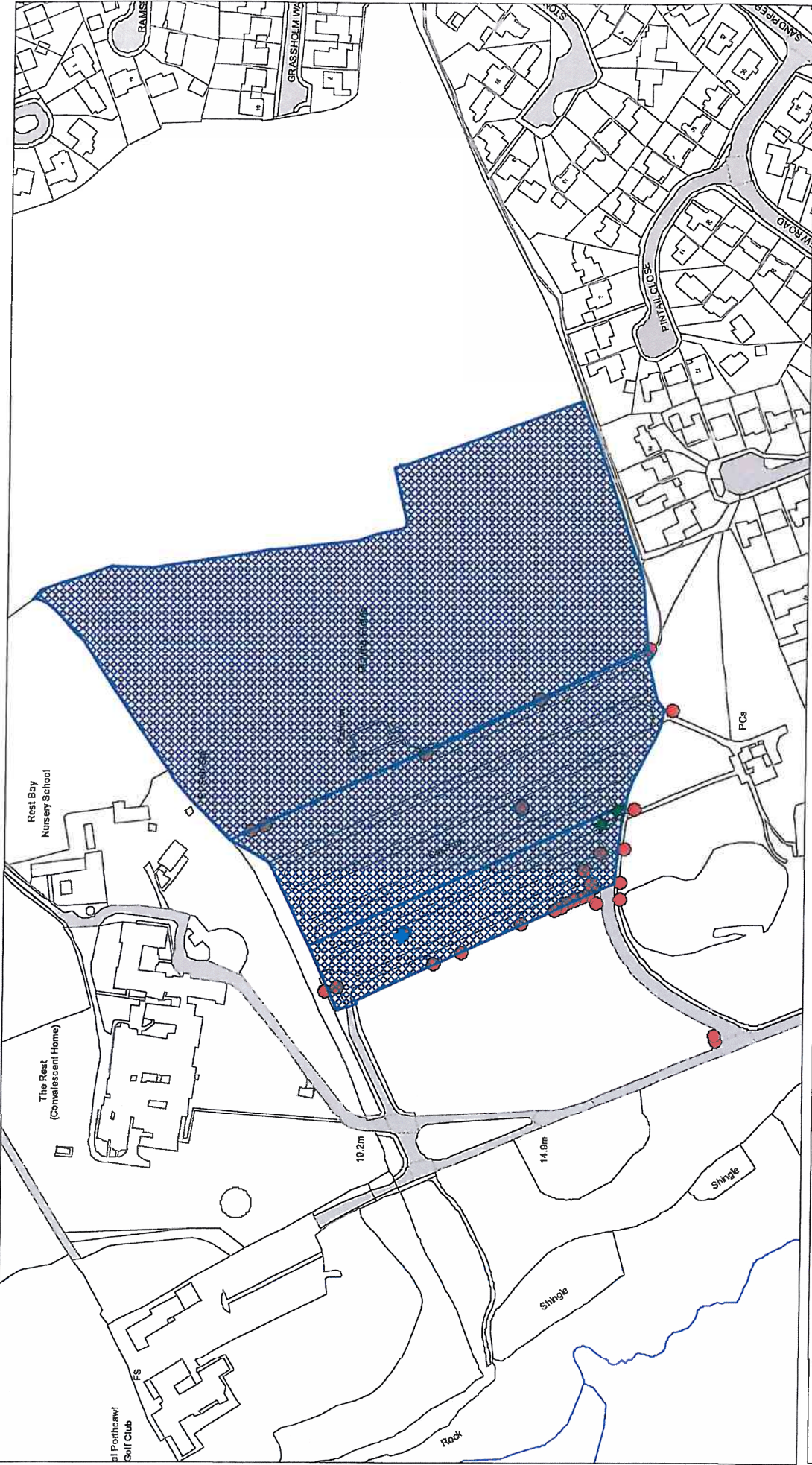

 © Crown copyright. All rights reserved Bridgend County Borough Council Licence No. 2012	REST BAY , PORTHCRAWL	
	SCALE	1 : 2529
	DATE	14/12/2012
	DRAWING No.	T1784-09
	DRAWN BY	KW

