

BRIDGEND COUNTY BOROUGH COUNCIL (PROHIBITION AND RESTRICTION OF WAITING AND LOADING AND PARKING PLACES)(CIVIL ENFORCEMENT) ORDER 2013 (AMENDMENT No.14B) ORDER 2021

The Bridgend County Borough Council (hereinafter referred to as "the Council") as the Highway Authority for Bridgend, hereby make the following Order in exercise of their powers under Sections 1, 2, 3, 4, 32, 35, 124 and Part IV of the Road Traffic Regulation Act 1984 ("the Act") and the Traffic Management Act 2004 and of all other enabling powers and after consultation with the Chief Officer of Police in accordance with Part III of Schedule 9 to the Act the effect of which is as follows:-

1. The BRIDGEND COUNTY BOROUGH COUNCIL (PROHIBITION AND RESTRICTION OF WAITING AND LOADING AND PARKING PLACES) (CIVIL ENFORCEMENT) ORDER 2013, as amended, ("the 2013 Order") is hereby further amended by the revocation of the Order Plans specified in Column 1 of the Schedule to this Order and the insertion of the revised Order Plans specified in Column 2 of the Schedule to this Order.
2. The Order Plans specified in Column 2 of the First Schedule to this Order are from the date that this Order takes effect incorporated into "the Plans" as defined in the 2013 Order and contained in Schedule 2 of the 2013 Order.
3. Insofar as any provision of this Order conflicts with a provision which is contained in an Order made or having effect as if made under the Act and existing at the time when this Order comes into operation and which imposes a restriction on vehicles in the lengths of roads and sides of lengths of roads delineated on the Order Plans specified in the Schedule of this Order that provision of this Order shall prevail.
4. The restrictions prohibitions and requirements imposed by this Order shall be in addition to and not in derogation from any restriction or requirements imposed by any regulations or Order made or having effect as if made under the Act or by or under any other enactment.
5. Any reference in this Order to any enactment shall be construed as a reference to that enactment as amended, applied, consolidated, re-enacted by or as having effect by virtue of any subsequent enactment.
6. The Interpretation Act 1978 shall apply to the interpretation of this Order as it applies to the interpretation of an Act of Parliament.
7. This Order shall come into force on the 05/11/2021 and may be cited as the "*Bridgend County Borough Council (Prohibition And Restriction of Waiting And Loading And Parking Places)(Civil Enforcement) Order 2013 (Amendment No.14B) Order 2021*".

Dated this 26 day of October 2021

THE COMMON SEAL of BRIDGEND)
COUNTY BOROUGH COUNCIL)
was hereunto affixed in the presence of:-)



Authorised Signatory:

A handwritten signature in black ink, appearing to read 'L. M. Thomas'.

<u>SCHEDULE</u>			
<u>Column One</u>	<u>Date</u>	<u>Column Two</u>	<u>Date</u>
<u>Map Schedule</u>		<u>Map Schedule</u>	
BQ27 REV 0	01.04.2013	BQ27 REV 1	28.04.2021
BQ28 REV 0	01.04.2013	BQ28 REV 1	28.04.2021

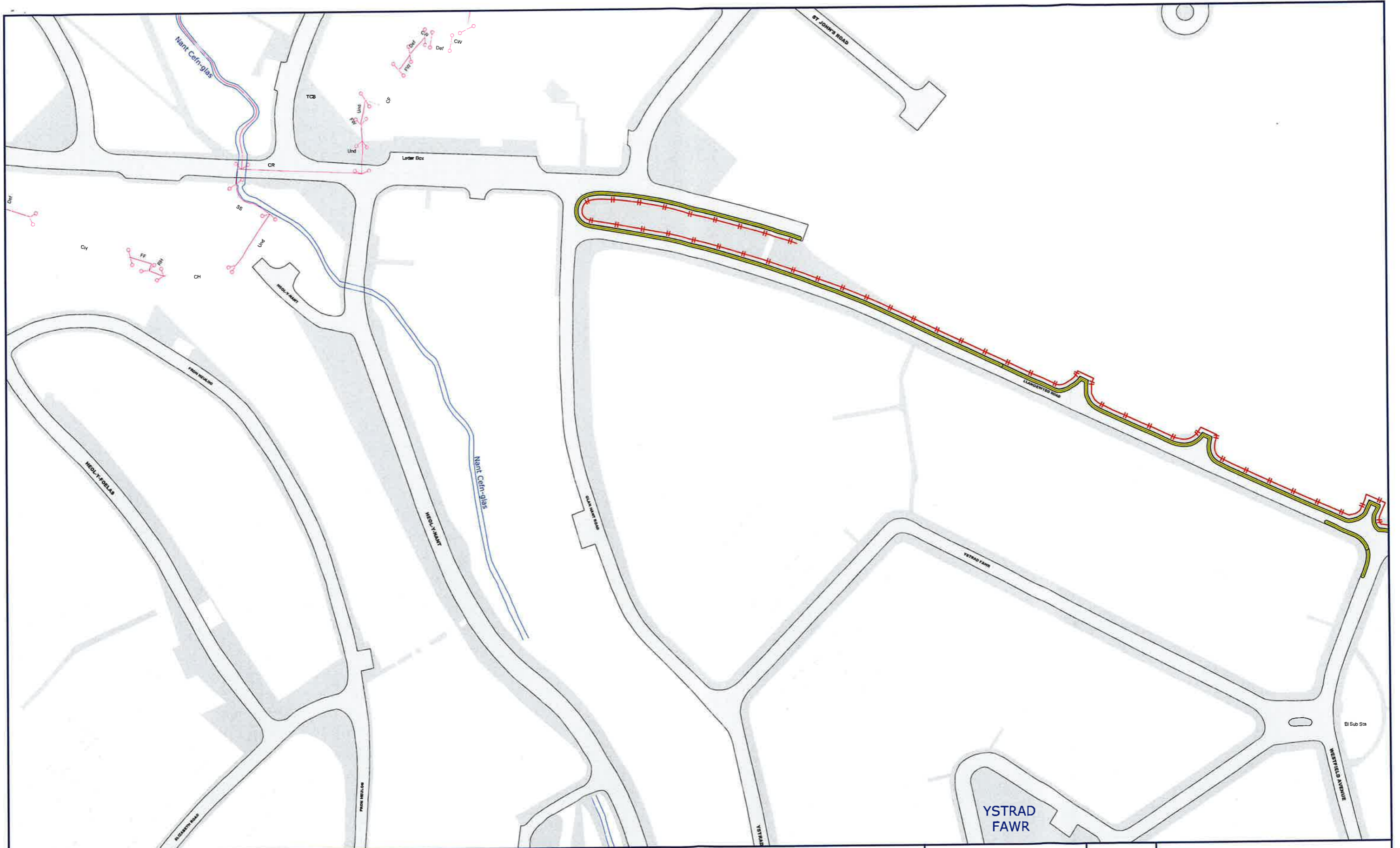

Bridgend County Borough Council



Civic Offices
Angel Street
Bridgend
CF31 4WB

Title: Bridgend County Borough Council (Prohibition and Restriction of Waiting and Loading and Parking Places) (Revocation) (Civil Enforcement Order 2013)

Key to TRO Restriction Types

	No Waiting At Any Time		Charged Parking		Motorcycle Parking Bay
	No Waiting		No Waiting HGV's		Loading Bay (any vehicle)
	No Loading At Any Time		Limited Waiting Bay		Loading Bay (goods vehicle)
	No Loading		Taxi Rank		Other Parking Bay
	School Entrance Marking		Disabled Parking Bay		Pedestrian Zone
			Residents Parking Bay		Clearway
			Shared Use Bay (Permit/LW)		

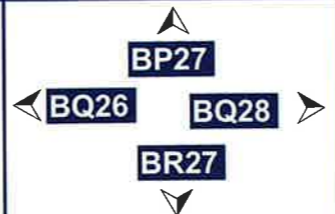

© Crown Copyright and database right 2021. Ordnance Survey 100023405.
© Hawifraint a hawliau cronfa ddala'r Goron 2021. Rhif Trwydded yr Arolwg Ordnans 100023405.
Licence No: 100023405 2021

SCALE	1 : 1250 @ A3
DATE	28/04/2021
MAP	Tile Ref: BQ27
REVISION	1

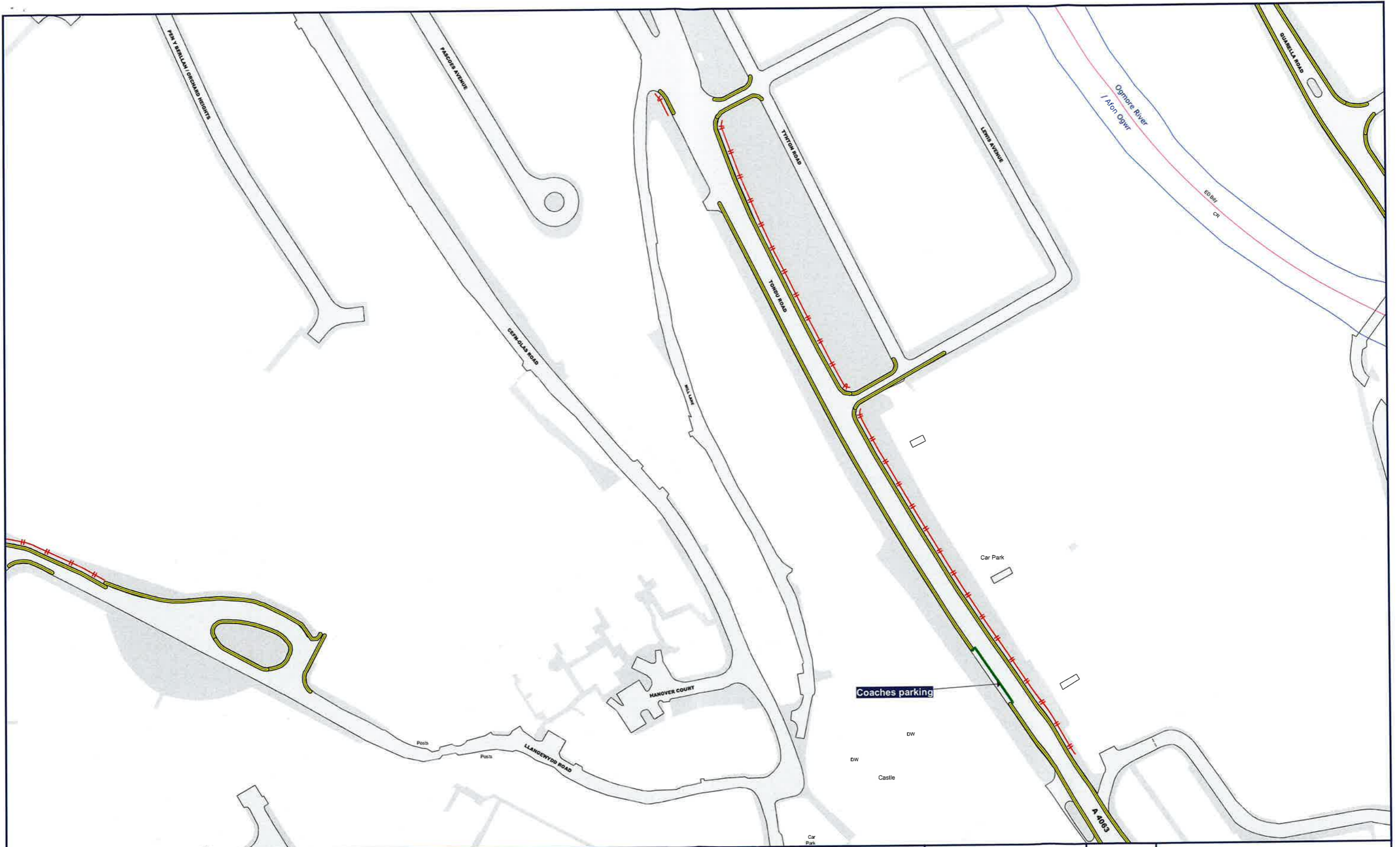

Bridgend County Borough Council



**Civic Offices
Angel Street
Bridgend
CF31 4WB**

Title: Bridgend County Borough Council (Prohibition and Restriction of Waiting and Loading and Parking Places) (Revocation) (Civil Enforcement Order 2013)

Key to TRO Restriction Types

	No Waiting At Any Time		Charged Parking		Motorcycle Parking Bay
	No Waiting		No Waiting HGV's		Loading Bay (any vehicle)
	No Loading At Any Time		Limited Waiting Bay		Loading Bay (goods vehicle)
	No Loading		Taxi Rank		Other Parking Bay
	School Entrance Marking		Disabled Parking Bay		Pedestrian Zone
			Residents Parking Bay		Clearway
			Shared Use Bay (Permit/LW)		

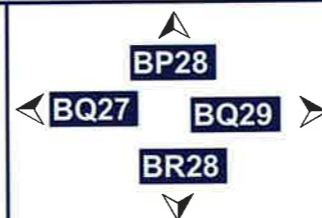

© Crown Copyright and database right 2021. Ordnance Survey 100023405.

© Hawlfraint a hawliau cronfa ddata'r Goron 2021. Rhif Trwydded yr Arolwg Ordnans 100023405.

Licence No: 100023405 2021

SCALE 1 : 1250 @ A3

DATE 28/04/2021

MAP Tile Ref: BQ28

REVISION 1