

**BRECKLAND DISTRICT COUNCIL**  
**(OFF-STREET PARKING PLACES) ORDER 2014**

Breckland District Council, in exercise of their powers under sections 32, 35, 38 and with the consent of Norfolk County Council under section 39 of the Road Traffic Regulation Act, 1984 (hereinafter referred to as "the 1984 Act"), the Traffic Management Act 2004 ("hereinafter referred to as the 2004 Act") and of all other enabling powers, and after consultation with the Chief Officer of Police in accordance with Parts I to III of Schedule 9 to the 1984 Act, hereby make the following Order.

**PART 1**  
**GENERAL**

**Commencement and Citation**

- 1 This Order shall come into operation on the 1<sup>st</sup> day of November 2014, and may be cited as Breckland District Council (Off-Street Parking Places) Order 2014.

**Interpretation**

2. In this Order:-

Any reference in this Order to any enactment shall be construed as a reference to that enactment as amended, applied, consolidated, re-enacted by or as having effect by virtue of any subsequent enactment. Where in this Order the context otherwise requires the following expressions have the meaning hereby respectively assigned to them.

"agent" means a person or organisation appointed by the Council to undertake Civil Enforcement of the parking places specified in the Schedules to this Order.

"authorised taxi rank" means any area of carriageway which is comprised within and indicated by a road marking complying with diagram 1028.2 in Schedule 6 to the Traffic Signs Regulations and General Directions 2002;

"bus" has the same meaning as in Regulation 22(2) of the Traffic Signs Regulations and General Directions 2002";

"Council" means Breckland District Council;

"Civil Enforcement Officer" has the same meaning as in section 76 of the 2004 Act;

"Driver" in relation to a vehicle waiting in a parking place, means the person driving the vehicle at the time it was left in the parking place, or the person deemed to be the driver under the terms of this Order;

"Disabled Parking Bay" means an area of the parking place indicated as such as an area where a vehicle, in accordance with the provisions of this Order, may be stationed;

"Disabled Persons Badge" has the same meaning as in the Disabled Persons (Badges for Motor Vehicles)(England) Regulations 2000 and any statutory modifications or re-enactments thereof; and

"Parking Disc" means a disc, issued by a local authority, complying with the requirements of the British Standard Specification for Parking Discs (BS No 3551 : 1970), but coloured blue and capable of showing the quarter hours period during which a period of waiting begins; and

for the purposes of this Order a vehicle shall be regarded as displaying a disabled person's badge or parking disc in the relevant position, when

(a) in the case of a vehicle fitted with a front windscreen

- (i) the badge is exhibited facing forwards of the near side of and immediately behind the windscreen, or
- (ii) the parking disc is exhibited in the relevant position with the side which shows the time facing forwards or outwards and immediately behind the windscreen, and

(b) in the case of a vehicle not fitted with a front windscreen the badge or disc is exhibited in a conspicuous position on the side of the vehicle.

"Disabled Person's Vehicles" has the same meaning as in the Local Authorities' Traffic Orders (Exemptions for Disabled Persons) (England) Regulations 2000;

"Enforcement Authority" means the Council or their appointed agent;

"Excursion or tour has the same meaning as in section 137(1) of the Transport Act 1985(a);

"General Directions" shall mean The Traffic Signs Regulations and General Directions Regulations 2002";

"General Regulations 2007" shall mean The Civil Enforcement of Parking Contraventions (England) General Regulations 2007;

"hackney carriage" has the meaning as in Section 38 of the Town Police Clauses Act 1847;

"Heavy Commercial Vehicle" has the same meaning as in section 138 of the 1984 Act;

"Market" means the Market maintained by Dereham Town Council in accordance with their Bylaw confirmed February 2010 and held on the Market Place in the Town of Dereham;

"Market Day" means Tuesday or Friday from 6.00 a.m. to 6.00 p.m.;

"Market Trader" means a person authorised to sell goods at the Market;

"Market Trader Parking Permit" means a Parking Permit issued by the Council or its Permit Agent in accordance with Article 9 of this Order, which permits a Market Trader to leave the designated vehicle stationed over the surface markings of more than one Parking Bay in Parking Place No 5 in the Schedule to this Order during the operational hours of the Market on Market Day;

"Mini-cab" means a "private hire vehicle" as defined in Section 80, and licensed as specified in Section 48 of the Local Government (Miscellaneous Provisions) Act 1976.

"Motor Car", "Motor Cycle" and "Invalid Carriage" shall have the same meaning as in section 136 of the 1984 Act;

"Motor Cycle Parking Area" means an area of the parking place indicated as such as an area where a motor cycle, in accordance with the provisions of this Order, may be stationed;

"Parking Bay" means an area of the parking place indicated by markings on the surface of the parking place as an area where a vehicle, in accordance with the provisions of this Order, may be stationed;

"authorised parking place" means any parking place on a road authorised or designated by an order made or having effect as if made under the 1984 Act;

"Penalty Charge Notice" has the same meaning as in section 8 of the General Regulations 2007;

"Parking Permit" means a Market Trader Parking Permit;

"Parking Place" means the area of land specified by name in Column 1 of the Schedule to this Order provided by the Council for use as a parking place;

"Permit Agent" for issue of a Market Trader Parking Permit for Parking Place No 5 shall be Breckland District Council or it's appointed Parking Permit issuer;

"private service vehicle" means a bus being used as part of an excursion or tour;

"public service vehicle" has the same meaning as section 1 of the Public Passenger Vehicles Act 1981".

## **PART II DESIGNATION, AND PENALTY CHARGES**

### **Classes and Position of Vehicles**

- 3 Each Parking Place may be used, subject to provisions of this Order, as a parking place for the classes of vehicles to be stationed in the appropriate parking bays on the days, during the hours and for the permitted periods as specified in relation to the parking place in the Schedules to this Order.
- 4 Where in the Schedules to this Order the Parking Place is described, or where a Parking Bay is designated by surface or other markings, as available for vehicles of a specified class, the driver of a vehicle shall not permit it to wait in the parking place, or parking bay, unless it is of that specified class.
- 5 The driver of a vehicle shall not permit it to wait in a parking place for longer than the maximum period permitted for waiting specified in the Schedule to this Order in relation to that parking place.
- 6(1) Subject to the Parking Place having marked Parking Bays, no vehicles shall be left in the Parking Place other than wholly within a Parking Bay, except in accordance with Article 9 of this Order, and in particular no vehicle shall be left or allowed to stand in the Parking Place in such a position as to obstruct:-
  - (i) the entrance thereto or exit therefrom the Parking Place, nor
  - (ii) the waste and recycling receptacles within the Parking Place, nor
  - (iii) in such a position as to prevent the driving away of any vehicle already standing in the Parking Place or in such a position as to cause an obstruction to other vehicles generally.

### **Undertakers Vehicles**

- 6(2) Nothing in Article 6(1) of this Order shall apply to a vehicle being used by R J Bartram and Sons Funeral Service, where it is deemed necessary and for so long as is deemed necessary, for that vehicle to wait along the double yellow lines at the southern end of Parking Place No 5 and it would not be appropriate for that vehicle to wait wholly within a Parking Bay at that time.

### **Disabled Person's Parking**

- 7 Subject to compliance with all other provisions of this Order, the driver of a vehicle displaying a disabled person's badge and parking disc may park that vehicle in a designated disabled parking bay provided that:
  - (a) the driver of the vehicle is a disabled person to whom the badge was issued in respect of that vehicle,
  - (b) the vehicle is being used for the carriage of a disabled person to whom the badge was issued,



- (c) the vehicle is one being used for the carriage of disabled persons by an institution to whom the badge was issued in respect of that vehicle; or
- (d) the time during which the vehicle will be parked in the said parking bay is indicated on the parking disc provided by local authority for that purpose.

8 Subject to compliance with all other provisions of this Order, the driver of a Disabled Persons Vehicle may permit a vehicle to wait in:-

- (i) a disabled parking bay within the parking place provided the driver displays a valid disabled persons badge and parking disc in accordance with Article 2 of this Order; or
- (ii) a parking bay within the parking place provided that vehicle displays a valid disabled persons badge and parking disc, in accordance with Article 2 of this Order, when no disabled parking bays are available;

for an additional 30 minutes to the maximum waiting time permitted at all parking places before a Penalty Charge Notice may be issued.

#### **Permit Parking for Market Traders in Parking Place No 5**

- 9(1). The Driver of a vehicle, being a Market Trader, may, subject to the Council's discretion and on application to the Council or its Permit Agent acquire a Market Trader Parking Permit in respect of a designated vehicle to wait on Market Day in Parking Place No 5 in the Schedule to this Order.
- 9(2) A Market Trader whose vehicle displays a Market Trader Parking Permit in accordance with Article 9(1), may leave that vehicle stationed over the surface markings of more than one Parking Bay but not so as to cause obstruction as specified in Article 6(1).
- 10. A Market Trader Parking Permit will be valid for a period of twelve months.
- 11. The Driver of a vehicle, being a Market Trader, using Parking Place 5 in accordance with Article 9 of this Order and:-
  - (i) which vehicle possesses a windscreen shall display the Market Trader Parking Permit within the vehicle by attaching the Parking Permit firmly to the front windscreen or by placing it on the dashboard of the vehicle;
  - (ii) which vehicle does not possess a windscreen shall display the Parking Permit in a conspicuous position, so that the Parking Permit is clearly visible from outside the vehicle during the entire period the vehicle is waiting in the Parking Place. A Parking Permit not displayed in accordance with this clause is not valid.
- 12. A Market Trader Parking Permit issued in accordance with Article 9 of this Order shall not be valid on any vehicle other than that vehicle for which it was originally purchased (whether or not that other vehicle is owned or is under the control of the driver).

13. A Market Trader Parking Permit issued to a Market Trader remains the property of the Council and must be surrendered upon request.
14. A damaged or lost Market Trader Parking Permit will be replaced by the Council free of charge. The damaged or lost Parking Permit will then be invalid.
15. If, in the reasonable opinion of the Council, A Market Trader uses a Market Trader Parking Permit in such a way as to cause a nuisance to other users of Parking Place 5 or to the owners or occupiers of adjoining property, the Council or its Permit Agent may cancel that Parking Permit by way of notice in writing to the holder of the Parking Permit.

### **Penalty Charge and Penalty Charge Notice**

- 16(1) Where a driver has left a vehicle in a Parking Place in contravention of this Order a Penalty Charge shall become payable. A Penalty Charge Notice to that effect will be attached to the vehicle or handed to the driver by a Civil Enforcement Officer, in accordance with Article 16(4) of this Order.
- 16(2) A Penalty Charge shall be payable to the Enforcement Authority.
- 16(3) In the event of payment of the Penalty Charge being received by the Enforcement Authority within 14 days of the day in which it was incurred the amount of penalty charge will be discounted in accordance with Regulation 5 of the General Regulations 2007.
- 16(4) A Penalty Charge Notice referred to in Article 16(1) and issued by a Civil Enforcement Officer shall include the following particulars:
  - (a) the enforcement authority,
  - (b) the parking place at which the contravention occurred,
  - (c) the registration mark of the vehicle or when the vehicle is being used under a trade licence, the registration mark of that trade licence,
  - (d) the date, time at which the Penalty Charge was seen to be payable,
  - (e) the grounds on which the Civil Enforcement Officer serving the Penalty Charge Notice believes that a Penalty Charge is payable,
  - (f) the amount of the Penalty Charge,
  - (g) the manner in which and time within which the Penalty Charge shall be payable,
  - (h) a statement that a reduced charge may be payable if payment is made within fourteen days of the Penalty Charge Notice being incurred,

- (i) a statement to the effect that if the Penalty Charge is not paid before the end of the period of 28 days a notice to owner may be served by the Enforcement Authority on the owner of the vehicle.
- 17(1) Where a driver has left a vehicle in a Parking Place in contravention of this Order and a Penalty Charge Notice could not be issued as specified in Article 16(1) of this Order a Penalty Charge Notice may be issued by post by the enforcement authority in accordance with section 10 of the General Regulations 2007.
- 17(2) Any Penalty Charge Notice issued in accordance with Article 17(1) of this Order shall, in addition to the particulars specified in 16(4)(a), (b), (c), (d), (f) and (g) include the particulars specified in paragraph 2 of the Schedule to the General Regulations 2007.
- 18(1) The Penalty Charge referred to in Articles 16(1) and 17(1) shall be paid to the Enforcement Authority or an agent acting on behalf of the Enforcement Authority in accordance with the instructions on the reverse of the Penalty Charge Notice.
- 18(2) The driver of a vehicle in respect of which a Penalty Charge has been incurred shall pay the Penalty Charge or provide proof of payment of the Penalty Charge to the Enforcement Authority as detailed on the reverse of the Penalty Charge Notice within 28 days of the date on which the Penalty Charge Notice is served. If payment is received within a period of 14 days beginning with the date on which the Penalty Charge Notice is served the amount of the said charge shall be reduced by 50% (provided that if the fourteenth day falls upon a day on which the Enforcement Authority's offices are closed the period within which payment of the said charge is due shall be extended to 1.00 p.m. on the next full day on which the office is open).
- 18(3) Where a driver of a vehicle fails to pay the Penalty Charge as specified in Articles 18(1) and 18(2) the Enforcement Authority may follow the procedures set out in the General Regulations 2007 to recover the Penalty Charge.
- 18(4) A driver who desires to make representation to or appeal against a Penalty Charge Notice issued to him may make representation or appeal to the Enforcement Authority pursuant to the procedures set out in the Civil Enforcement of Parking Contraventions (England) Representations and Appeals Regulations 2007.
19. When a Penalty Charge Notice has been attached to a vehicle in accordance with the provisions of Article 16(1) no person, not being the driver of the vehicle or a person duly authorised by the Council shall remove the Notice from the vehicle unless authorised to do so by the driver.

### **PART III**

#### **USE OF PARKING PLACES**

20. The driver of a vehicle using the Parking Place shall stop the engine as soon as the vehicle is in position in a designated parking bay and shall not start the engine except when about to change the position of the vehicle in the parking bay, or to depart from the Parking Place.

21. Except with the authority of the Council or person authorised on behalf of the Council, no person shall use a vehicle, whilst it is in the Parking Place, in connection with the sale of any article to persons in or near the parking place or in connection with the selling or offering for hire of his skill or services.
22. Except with the authority of the Council or person authorised on behalf of the Council, no person distribute any advertising material or shall affix or cause to be affixed any advertising material to any vehicle left in the parking place.
23. Subject to the proviso hereto, when a vehicle is left in the parking place in contravention of any of the provisions of Articles 3, 4, 5, 6 and 9 of this Order, or it is necessary to meet the requirements of an emergency, a person authorised on behalf of the Council, the Enforcement Authority or a Civil Enforcement Officer may remove the vehicle or arrange for it to be removed from the Parking Place, or may alter or cause to be altered the position of the vehicle in order that its position shall comply with those provisions or meet the requirements of the emergency.
24. Any person removing or altering the position of a vehicle by virtue of Article 23 of this Order may do so by towing or driving the vehicle or in such other manner as that person may think necessary and may take such measures in relation to the vehicle as that person may think necessary to enable that person to remove or alter its position.
25. When a person authorised by the Council, the Enforcement Authority or a Civil Enforcement Officer removes or makes arrangements for the removal of a vehicle from the parking place by virtue of Articles 23 and 24 of this Order, that person shall make such arrangements as may be reasonably necessary for the safe custody of the vehicle.
26. Where a vehicle has been removed in accordance with Articles 23, 24 and 25 of this Order the charges as specified in section 3 of the Civil Enforcement of Parking Contraventions (Guidelines on Levels of Charges)(England) Order 2007 shall become payable.
27. Neither such person nor the Council shall be responsible for any loss or damage to the vehicle or to anything contained therein or attached thereto arising from or in consequence of the exercise of the powers in Articles 23, 24, 25 and 26.
28. The driver of a motor vehicle using the Parking Place shall not sound any horn or other similar instrument except when about to change the position of the vehicle in or to depart from the Parking Place.
29. No person shall, except with the permission of any person duly authorised by the Council, or a Civil Enforcement Officer, drive any vehicle in the Parking Place other than for the purpose of leaving that vehicle in the Parking Place in accordance with the provisions of this Order or for the purpose of departing from the Parking Place.
30. No person shall, in the Parking Place, wantonly shout or otherwise make a loud noise to the disturbance or annoyance of users of the parking place or residents of premises in the neighbourhood.

31. No person shall in the Parking Place use any threatening, abusive or insulting language, gesture or conduct with intent to put any person in fear or so occasion a breach of the peace or whereby a breach of the peace is likely to be occasioned.
32. No person shall use any part of the Parking Place or any vehicle left in the Parking Place:
  - (a) for sleeping or camping purposes;
  - (b) for eating or cooking purposes;
  - (c) for the purpose of servicing or washing any vehicle or part thereof other than is reasonably necessary to enable that vehicle to depart from the Parking Place;
  - (d) for skateboarding, roller skating or wheeled activities which may be hazardous to pedestrians;
  - (e) for the instruction of pupils whilst undertaking driving lessons.
33. No person shall play or take part in any game in the Parking Place.
34. No person shall use the Parking Place as a means of passing or proceeding from one road to another road.
35. Where in the Parking Place signs are erected or surface markings are laid for the purpose of:
  - (a) indicating the entrance to or exit from the Parking Place; or
  - (b) indicating that a vehicle using the Parking Place shall proceed in a specified direction within the Parking Placeno person shall drive or cause or permit to be driven any vehicle so that it
  - (i) enters the Parking Place otherwise than by an entrance or leave the Parking Place otherwise than by an exit so indicated or
  - (ii) is in a direction other than that specifiedas the case may be.
36. In the Parking Place no person shall:
  - (a) erect or cause or permit to be erected any tent, booth, stand, building or other structure except with the authority of the Council or person authorised on behalf of the Council;
  - (b) light or cause or permit to be lit any fire.

37. No person shall proceed to enter the Parking Place whilst towing any vehicle except:
- (i) where the towed vehicle is required in order that a vehicle may be removed in accordance with Article 15 of this Order,
  - (ii) where the towed vehicle is carrying equipment required by the driver for ground maintenance at the Parking Place,
  - (iii) where the towed vehicle is required for remedial works at or to the Parking Place by Statutory Utilities Staff,
  - (iv) where permission has been granted by the Council or an agent acting on behalf of the Council or a Police Constable in uniform,
  - (v) where the towed vehicle is attached to a motor vehicle displaying a Market Trader Parking Permit and is parked in accordance with Articles 9 to 15 of this Order.
38. Except in Parking Places numbered 5, 12 and 17, no person shall leave stationed a vehicle with a maximum gross vehicle weight greater than 3050 kg except upon the direction or with the permission of the Council or a Civil Enforcement Officer.
39. By conspicuous notices to the effect the Council may suspend Parking on the Parking Place or part thereof and failure to observe such notices shall be a contravention of this Order.
- 40.. The following Orders will become revoked on the date of commencement of this Order as follows:-
- "The Breckland District Council (Off-Street Parking Places) Consolidation Order 2012" - in its entirety;
41. Insofar as any provision of this Order conflicts with any provision of any previous Order relating to the off-street car parking places specified in the Schedules to this Order, that provision of this Order shall prevail.

**IN THE TOWN OF ATTLEBOROUGH**  
**SCHEDULE 1**

1	2	3	4	5	6
Name and Location of Parking Place	Classes of Vehicles	Position in which Vehicles may wait	Days of Operation of Parking Place	Hours of Operation of Parking Place	Maximum period for which vehicles may wait
1. Edenside Car Park Attleborough (access from Edenside Drive) Plan No 1 – edged red	Motor car, motor cycle and disabled persons vehicle displaying a disabled person's badge and parking disc	Wholly within the parking bays where marked at the parking place	Monday to Sunday	At All Times	Waiting unlimited
2. Horse Pit Car Park Attleborough (access from Chapel Road) Plan No 2 – edged red	Motor car, motor cycle and disabled person's vehicle displaying a disabled person's badge and parking disc	Wholly within the parking bays where marked at the parking place	Monday to Sunday	At All Times	Waiting unlimited

**IN THE TOWN OF ATTLEBOROUGH**  
**SCHEDULE 1**

1	2	3	4	5	6
Name and Location of Parking Place	Classes of Vehicles	Position in which Vehicles may wait	Days of Operation of Parking Place	Hours of Operation of Parking Place	Maximum period for which vehicles may wait
3. Queens Square Car Park Attleborough (access from Queen's Square) Plan No 3 – edged red	Motor car, motor cycle and disabled person's vehicle displaying a disabled person's badge and parking disc	Wholly within the parking bays where marked at the parking place	Monday, Tuesday, Wednesday, Friday, Saturday and Sunday  Thursday (Bays which are clearly marked and designated for use by Market Stallholders)  Thursday (Bays which have no marking)	At All Times  1400 hrs to midnight  At All Times	Waiting unlimited  Waiting unlimited within the operational period  Waiting unlimited



$$\begin{array}{r} 1 \\ 2 \\ 3 \\ \hline 4 \\ 5 \\ 6 \end{array}$$
$$\begin{array}{r} 1 \\ 2 \\ 3 \\ \hline 4 \\ 5 \\ 6 \end{array}$$

**IN THE TOWN OF DEREHAM**  
**SCHEDULE 2**

1	2	3	4	5	6
Name and Location of Parking Place	Classes of Vehicles	Position in which Vehicles may wait	Days of Operation of Parking Place	Hours of Operation of Parking Place	Maximum period for which vehicles may wait
6. Cowper Road Car Park Dereham (access from Georges Road and Nunns Way) Plan No 6 – edged red	Motor car, motor cycle and disabled person's vehicle displaying a disabled person's badge and parking disc	Wholly within the parking bays where marked at the parking place	Monday to Saturday	0800 hrs to 1800 hrs	Waiting limited to 2 hours with no return within 1 hour
7. Swaffham Hill Car Park Dereham (access from Old Becclesgate) Plan No 7 – edged red	Motor car, motor cycle and disabled persons vehicle displaying a disabled person's badge and parking disc	Wholly within the parking bays where marked at the parking place	Monday to Saturday Sunday Monday to Sunday	1800 hrs to 0800 hrs At All Times At All Times	Waiting unlimited  Waiting unlimited
8. The Guildhall Car Park Dereham (access from St Withburga Lane) Plan No 4 – edged red	Motor car, motor cycle and disabled person's vehicle displaying a disabled person's badge and parking disc	Wholly within the parking bays where marked at the parking place	Monday to Saturday  Monday to Saturday Sunday	0800 hrs to 1800 hrs  1800 hrs to 0800 hrs At All Times	Waiting limited to 2 hours with no return within 1 hour  Waiting unlimited

**IN THE TOWN OF SWAFFHAM**

## SCHEDULE 3

1	2	3	4	5	6
Name and Location of Parking Place	Classes of Vehicles	Position in which Vehicles may wait	Days of Operation of Parking Place	Hours of Operation of Parking Place	Maximum period for which vehicles may wait
9. Lynn Street Car Park Swaffham (access from Lynn Street) Plan No 8 – edged red	Motor car, motor cycle and disabled persons vehicle displaying a disabled person's badge and parking disc	Wholly within the parking bays where marked at the parking place	Monday to Sunday	At All Times	Waiting unlimited
10. Pedlars Car Park Market Place Swaffham (access opposite The Shambles) Plan No 9 – edged red	Motor car, motor cycle and disabled person's vehicle displaying a disabled person's badge and parking disc	Wholly within the parking bays where marked at the parking place	Monday to Saturday	0800 hrs to 1800 hrs	Waiting limited to 2 hours with no return within 1 hour
			Monday to Saturday Sunday	1800 hrs to 0800 hrs At All Times	Waiting unlimited
11. Pit Lane Car Park Swaffham (access from the A1065) Plan No 9 – edged green	Motor car, motor cycle and disabled person's vehicle displaying a disabled person's badge and parking disc	Wholly within the parking bays where marked at the parking place	Monday to Friday	0800 hrs to 1800 hrs	Waiting limited to 2 hours with no return within 1 hour
			Monday to Friday Saturday Sunday	1800 hrs to 0800 hrs 0001 hrs to 0600 hrs 1800 hrs to midnight At All Times	Waiting unlimited

**IN THE TOWN OF SWAFFHAM**

**SCHEDULE 3**

6

5

4

3

2

1

Name and Location of Parking Place	Classes of Vehicles	Position in which Vehicles may wait	Days of Operation of Parking Place	Hours of Operation of Parking Place	Maximum period for which vehicles may wait
12. Station Street Car Park Swaffham (access from Station Street) Plan No 10 – edged red	Motor car, motor cycle and disabled person's vehicle displaying a disabled person's badge and parking disc Heavy Commercial Vehicles Public Service Vehicles	Wholly within the designated parking bays marked at the parking place	Monday to Sunday	At All Times	Waiting unlimited
13. Theatre Street Car Park Swaffham (access from Theatre Street) Plan No 11 – edged red	Motor car, motor cycle and disabled person's vehicle displaying a disabled person's badge and parking disc	Wholly within the parking bays where marked at the parking place	Monday to Sunday	At All Times	Waiting unlimited

**IN THE TOWN OF SWAFFHAM**  
**SCHEDULE 3**

1	2	3	4	5	6
Name and Location of Parking Place	Classes of Vehicles	Position in which Vehicles may wait	Days of Operation of Parking Place	Hours of Operation of Parking Place	Maximum period for which vehicles may wait
14. The Market Place Car Park Swaffham (access from the A1065) Plan No 9 – edged blue	Motor car, motor cycle and disabled person's vehicle displaying a disabled person's badge and parking disc	Wholly within the parking bays where marked at the parking place	Monday to Friday  Saturday  1 <sup>st</sup> and 3 <sup>rd</sup> Sunday of each month  2 <sup>nd</sup> , 4 <sup>th</sup> and 5 <sup>th</sup> Sunday of each month	0800 hrs to 1800 hrs  1800 hrs to 0800 hrs  0001 hrs to 0600 hrs 1800 hrs to midnight  0001 hrs to 0800 hrs 1700 hrs to midnight  At All Times	Waiting limited to 2 hours with no return within 1 hour Waiting unlimited  Waiting unlimited within the operational periods only on Saturday and Sunday

7

Name and Location of Parking Place	Classes of Vehicles	Position in which Vehicles may wait	Days of Operation of Parking Place	Hours of Operation of Parking Place	Maximum period for which vehicles may wait
15. Breckland Business Centre Car Park Thetford (access from St Nicholas Street) Plan No 12 – edged blue	Motor car, motor cycle and disabled person's vehicle displaying a disabled person's badge and parking disc	Wholly within the parking bays where marked at the parking place	Friday Saturday Sunday Monday	2000 hrs to midnight At All Times At All Times 0001 hrs to 0800 hrs	Waiting unlimited within the operational periods
16. Breckland Business Centre Court Yard Thetford (access from St Nicholas Street) Plan No 12 – edged green	Disabled person's vehicle displaying a disabled person's badge and parking disc	Wholly within the parking bays where marked at the parking place	Monday to Friday	0800 hrs to 1800 hrs	Waiting unlimited within the operational period
17. Bridge Street Car Park Thetford (access from Bridge Street) Plan No 13 – edged red	Motor car, motor cycle and disabled persons vehicle displaying a disabled persons badge and parking disc Hackney Carriage Mini-Cab Bus	Wholly within the designated parking bays marked at the parking place	Monday to Sunday	At All Times	Waiting unlimited

**IN THE TOWN OF THETFORD**  
**SCHEDULE 4**

1	2	3	4	5	6
Name and Location of Parking Place	Classes of Vehicles	Position in which Vehicles may wait	Days of Operation of Parking Place	Hours of Operation of Parking Place	Maximum period for which vehicles may wait
18. Bury Road Car Park Thetford (access from Bury Road) Plan No 14 – edged Red	Motor car, motor cycle and disabled persons vehicle displaying a disabled person's badge	Wholly within the parking bays where marked at the parking place	Monday to Sunday	At All Times	Waiting unlimited
19. Cage Lane Car Park Thetford (access from Cage Lane) Plan No 15 – edged red	Motor car, motor cycle and disabled persons vehicle displaying a disabled person's badge and parking disc	Wholly within the parking bays where marked at the parking place	Monday to Sunday	At All Times	Waiting unlimited
20. Castle Street Car Park Thetford (access from Castle Street) Plan No 16 – edged red	Motor car, motor cycle and disabled person's vehicle displaying a disabled person's badge and parking disc	Wholly within the parking bays where marked at the parking place	Monday to Sunday	At All Times	Waiting unlimited

# **IN THE TOWN OF THETFORD**

## **SCHEDULE 4**

1

2

3

4

5

6

Name and Location of Parking Place	Classes of Vehicles	Position in which Vehicles may wait	Days of Operation of Parking Place	Hours of Operation of Parking Place	Maximum period for which vehicles may wait
21. Pike Lane Car Park Thetford (access from Pike Lane) Plan No 17 – edged red	Motor car, motor cycle and disabled persons vehicle displaying a disabled person's badge Hackney Carriage Mini-Cab	Wholly within the designated parking bays where marked at the parking place	Monday to Sunday	At All Times	Waiting unlimited
22. St Giles Lane Car Park Thetford (access from St Giles Lane) Plan No 18 – edged red	Motor car, motor cycle and disabled persons vehicle displaying a disabled person's badge and parking disc	Wholly within the parking bays where marked at the parking place	Monday to Sunday	At All Times	Waiting unlimited
23. St Nicholas Street Car Park Thetford (access from St Nicholas Street) Plan No 12 – edged red	Motor car, motor cycle and disabled person's vehicle displaying a disabled person's badge and parking disc	Wholly within the parking bays where marked at the parking place	Monday to Friday Saturday Sunday	0800 hrs to 1800 hrs  1800 hrs to 0800 hrs At All Times At All Times	Waiting limited to 2 hours with no return within 1 hour  Waiting unlimited



**IN THE TOWN OF THETFORD**  
**SCHEDULE 4**

1	2	3	4	5	6
Name and Location of Parking Place	Classes of Vehicles	Position in which Vehicles may wait	Days of Operation of Parking Place	Hours of Operation of Parking Place	Maximum period for which vehicles may wait
24. School Lane Car Park Thetford (access from School Lane) Plan No 19 – edged red	Motor car, motor cycle and disabled persons vehicle displaying a disabled person's badge	Wholly within the parking bays where marked at the parking place	Monday to Sunday	At All Times	Waiting unlimited
25. Tanner Street North Car Park Thetford (access from Tanner Street) Plan No 20 – edged red	Motor car, motor cycle and disabled persons vehicle displaying a disabled person's badge and parking disc	Wholly within the parking bays where marked at the parking place	Monday to Sunday	At All Times	Waiting unlimited
26. Tanner Street South Car Park Thetford (access from Tanner Street) Plan No 20 – edged blue	Motor car, motor cycle and disabled person's vehicle displaying a disabled person's badge and parking disc	Wholly within the parking bays where marked at the parking place	Monday to Sunday	At All Times	Waiting unlimited

**IN THE TOWN OF THETFORD**  
**SCHEDULE 4**

1	2	3	4	5	6
Name and Location of Parking Place	Classes of Vehicles	Position in which Vehicles may wait	Days of Operation of Parking Place	Hours of Operation of Parking Place	Maximum period for which vehicles may wait
27. The Link Car Park Thetford (access from The Link) Plan No 21 – edged red	Motor car, motor cycle and disabled persons vehicle displaying a disabled person's badge	Wholly within the parking bays where marked at the parking place	Monday to Sunday	At All Times	Waiting unlimited
28. The Market Place Car Park Thetford (access from Market Place) Plan No 22 – edged red	Motor car, motor cycle and disabled persons vehicle displaying a disabled person's badge and parking disc	Wholly within the parking bays where marked at the parking place	Monday, Wednesday, Thursday, Friday and Sunday  Tuesday and Saturday	At All Times  0001 hrs to 0630 hrs 1700 hrs to midnight	Waiting unlimited  Waiting unlimited within the operational period only
29. White Hart Street Car Park Thetford (access from White Hart Street) Plan No 23 – edged red	Motor car, motor cycle and disabled person's vehicle displaying a disabled person's badge and parking disc	Wholly within the parking bays where marked at the parking place	Monday to Sunday	At All Times	Waiting unlimited



**IN THE TOWN OF WATTON**  
**SCHEDULE 5**

1	2	3	4	5	6
Name and Location of Parking Place	Classes of Vehicles	Position in which Vehicles may wait	Days of Operation of Parking Place	Hours of Operation of Parking Place	Maximum period for which vehicles may wait
30. High Street Car Park Watton (access from High Street) Plan No 24 – edged red	Motor car, motor cycle and disabled persons vehicle displaying a disabled person's badge	Wholly within the parking bays where marked at the parking place	Monday to Sunday	At All Times	Waiting unlimited
31. Thetford Road Car Park Watton (access from Thetford Road) Plan No 25 – edged red	Motor car, motor cycle and disabled persons vehicle displaying a disabled person's badge and parking disc	Wholly within the parking bays where marked at the parking place	Monday to Sunday	At All Times	Waiting unlimited
32. Kittel Close Car Park Watton (access from Kittel Close) Plan No 26 – edged red	Motor car, motor cycle and disabled person's vehicle displaying a disabled person's badge and parking disc Public Service Vehicles	Wholly within the parking bays where marked at the parking place	Monday to Sunday	At All Times	Waiting unlimited

Dated this 20th day of OCTOBER 2014

THE COMMON SEAL of  
BRECKLAND DISTRICT COUNCIL  
was hereunto affixed in the  
presence of

)  
)  
)  
)

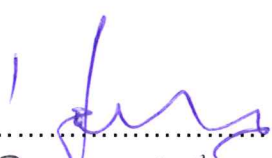

Authorised Signatory ..... 

Position of Authority ..... SOLICITOR TO THE COUNCIL







TITLE

**BRECKLAND DISTRICT COUNCIL  
(OFF-STREET PARKING PLACES)  
CONSOLIDATION ORDER 2011**

DRAWING DETAILS

**SCHEDULE 1  
PLAN 1**



This drawing and the works depicted thereon are the copyright of Breckland District Council. Unauthorised reproduction infringes copyright.

PRODUCED BY	DATE	SCALES
PRD	Sep 2011	1:1250
DRAWING No.	Rev.	
	<b>PLAN 1</b>	



Asset Management

*a better place, a brighter future*  
**Breckland**  
COUNCIL

Elizabeth House  
Walpole Lake  
Dereham  
Norfolk  
NR19 1EE

Tel: 01362 656870 Fax: 01362 656877





TITLE

**BRECKLAND DISTRICT COUNCIL  
(OFF-STREET PARKING PLACES)  
CONSOLIDATION ORDER 2011**

DRAWING DETAILS

**SCHEDULE 1  
PLAN 2**



This drawing and the works depicted thereon are the copyright of Breckland District Council. Unauthorised reproduction infringes copyright.

PRODUCED BY

DATE

SCALES

PRD

Sep 2011

1:1250

DRAWING No.

Rev.

**PLAN 2**



Asset Management

Elizabeth House  
Walpole Lake  
Dereham  
Norfolk  
NR19 1EE

**Breckland**  
COUNCIL

Tel: 01362 656870 Fax: 01362 656877



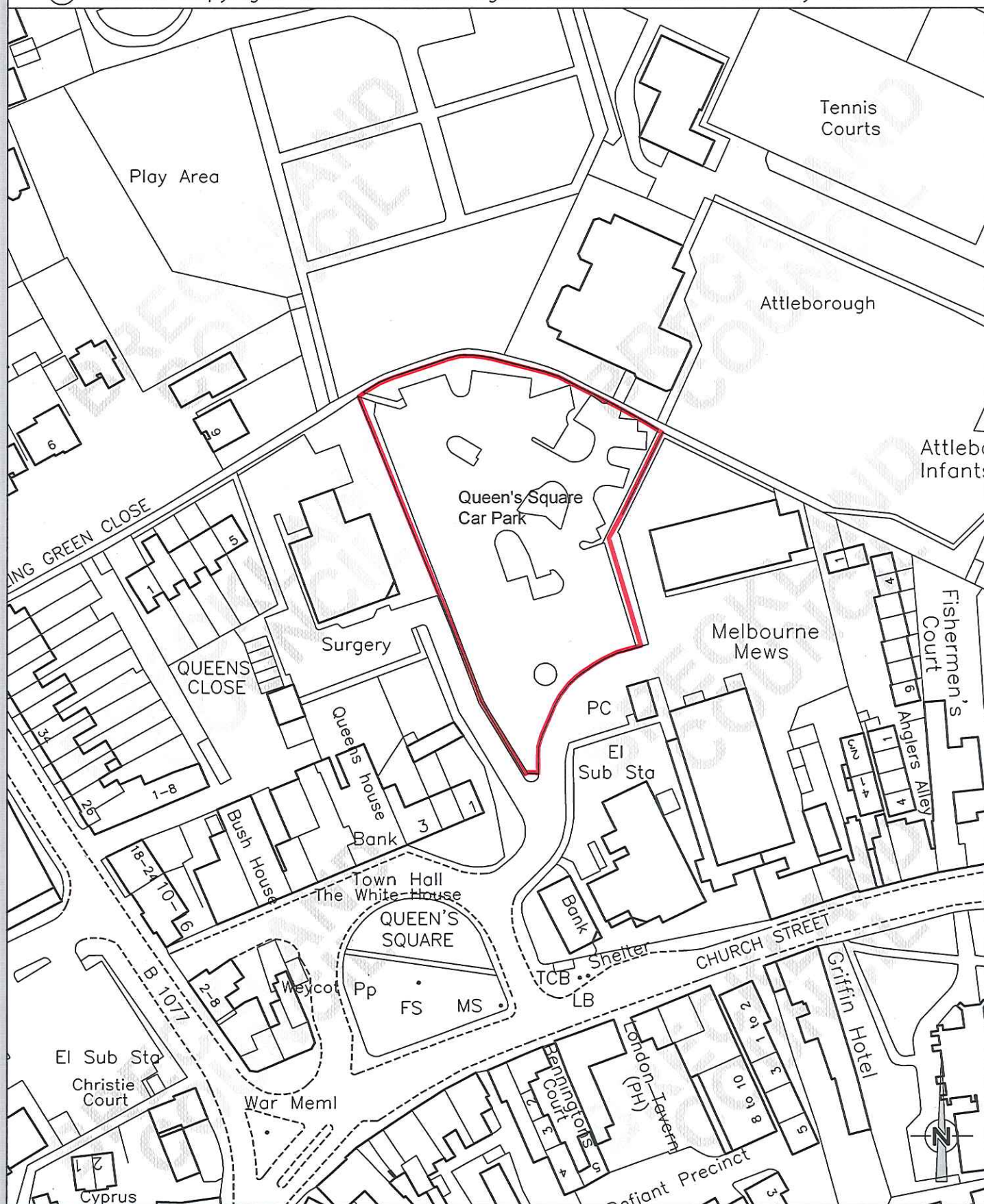

Asset Management

Elizabeth House  
Walpole Lake  
Dereham  
Norfolk  
NR19 1EE

Tel: 01362 656870 Fax: 01362 656877

**BRECKLAND DISTRICT COUNCIL  
(OFF-STREET PARKING PLACES)  
CONSOLIDATION ORDER 2011**

DRAWING DETAILS

**SCHEDULE 1  
PLAN 3**



This drawing and the works depicted thereon are the copyright of Breckland District Council. Unauthorised reproduction infringes copyright.

PRODUCED BY	DATE	SCALES
PRD	Sep 2011	1:1250
DRAWING No.	Rev.	
	<b>PLAN 3</b>	



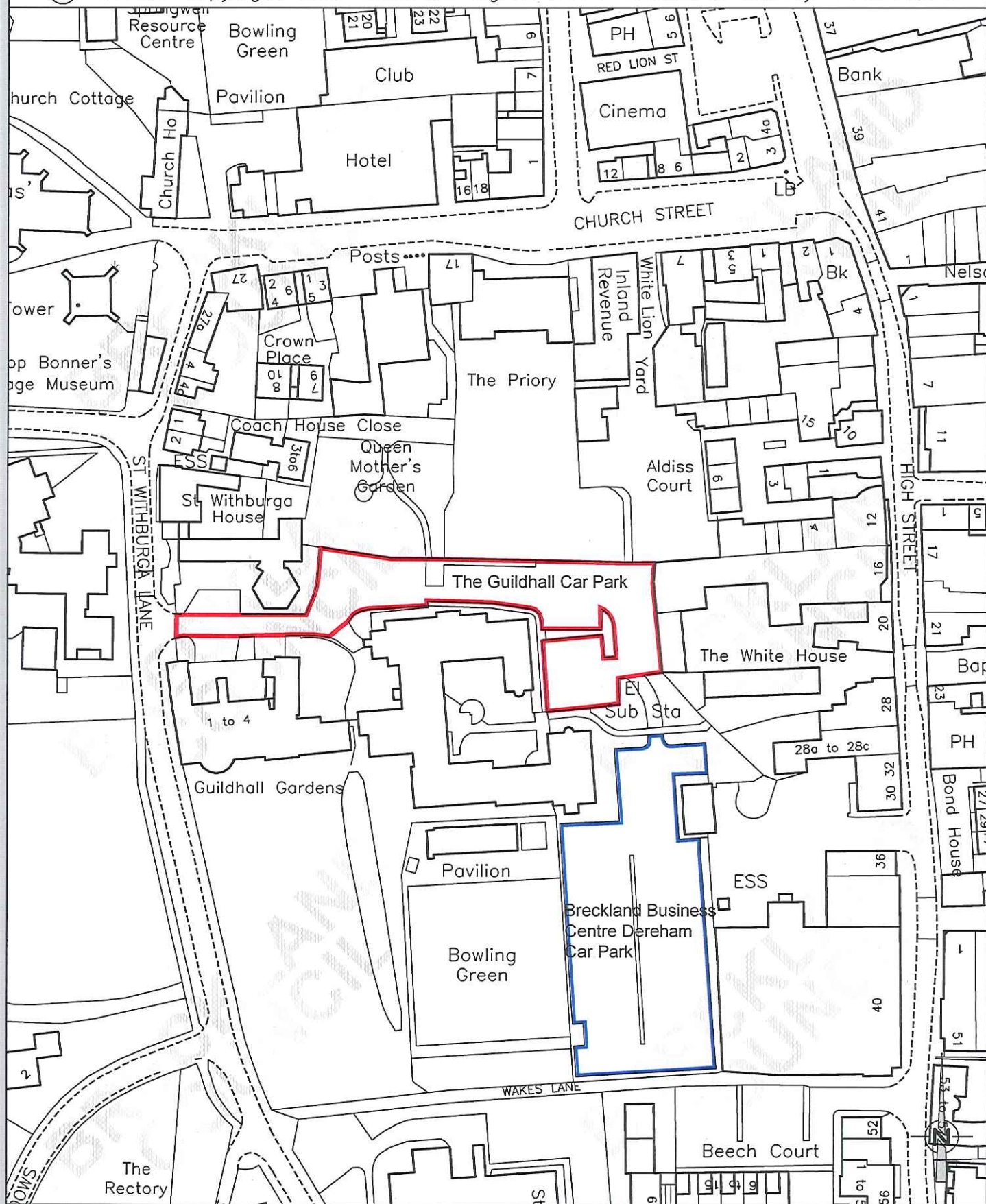

Asset Management

Elizabeth House  
Walpole Lake  
Dereham  
Norfolk  
NR19 1EE

Tel: 01362 656870 Fax: 01362 656877

**BRECKLAND DISTRICT COUNCIL  
(OFF-STREET PARKING PLACES)  
CONSOLIDATION ORDER 2011**

DRAWING DETAILS

**SCHEDULE 2  
PLAN 4**



This drawing and the works depicted thereon are the copyright of Breckland District Council. Unauthorised reproduction infringes copyright.

PRODUCED BY	DATE	SCALES
PRD	Sep 2011	1:1250
DRAWING No.	Rev.	
	<b>PLAN 4</b>	



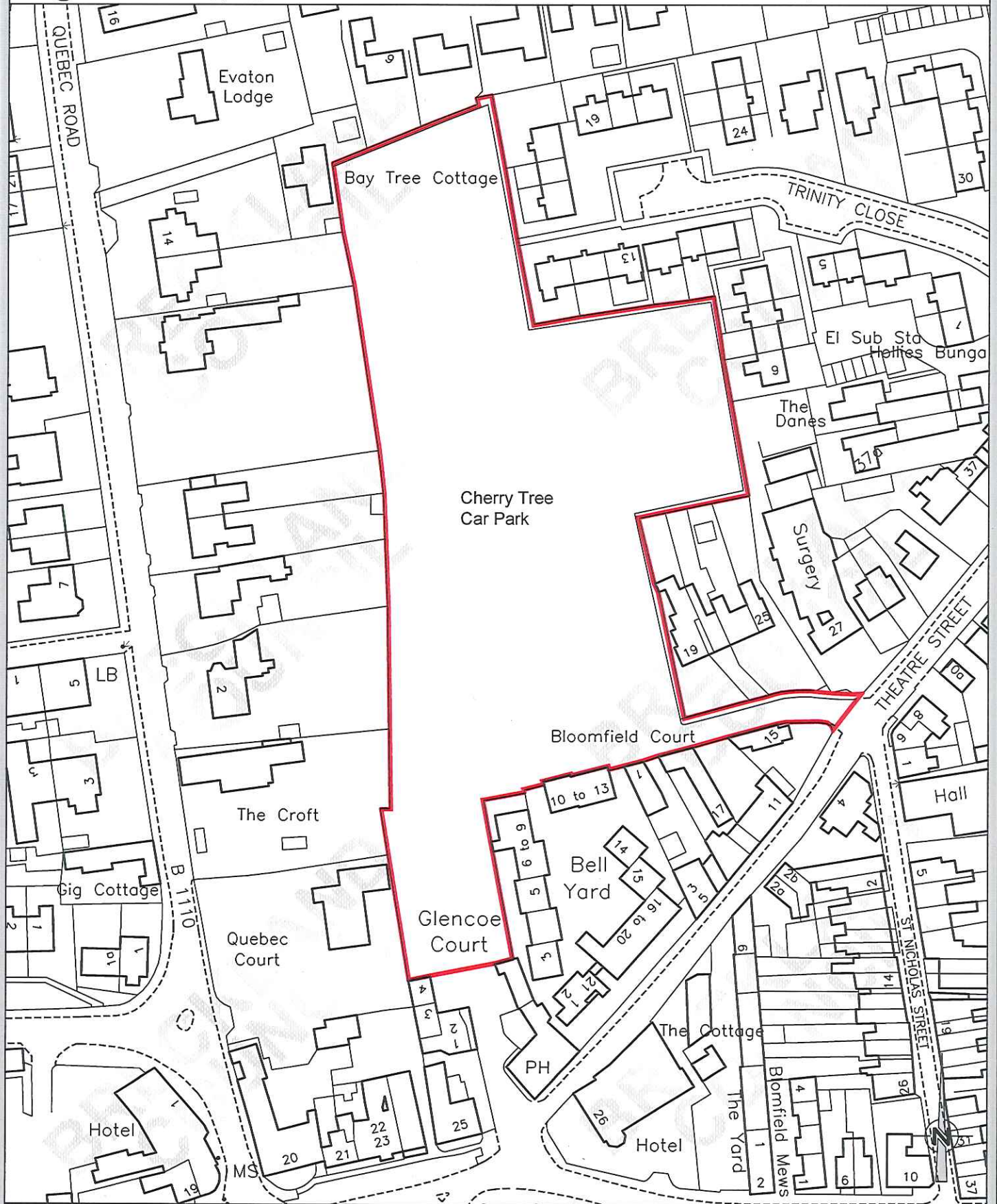

TITLE



Asset Management

Elizabeth House  
Walpole Lake  
Dereham  
Norfolk  
NR19 1EE

Tel: 01362 656870 Fax: 01362 656877

**BRECKLAND DISTRICT COUNCIL  
(OFF-STREET PARKING PLACES)  
CONSOLIDATION ORDER 2011**

DRAWING DETAILS

**SCHEDULE 2  
PLAN 5**



This drawing and the works depicted thereon are the copyright of Breckland District Council. Unauthorised reproduction infringes copyright.

PRODUCED BY	DATE	SCALES
PRD	Sep 2011	1:1250
DRAWING No.		Rev.
<b>PLAN 5</b>		



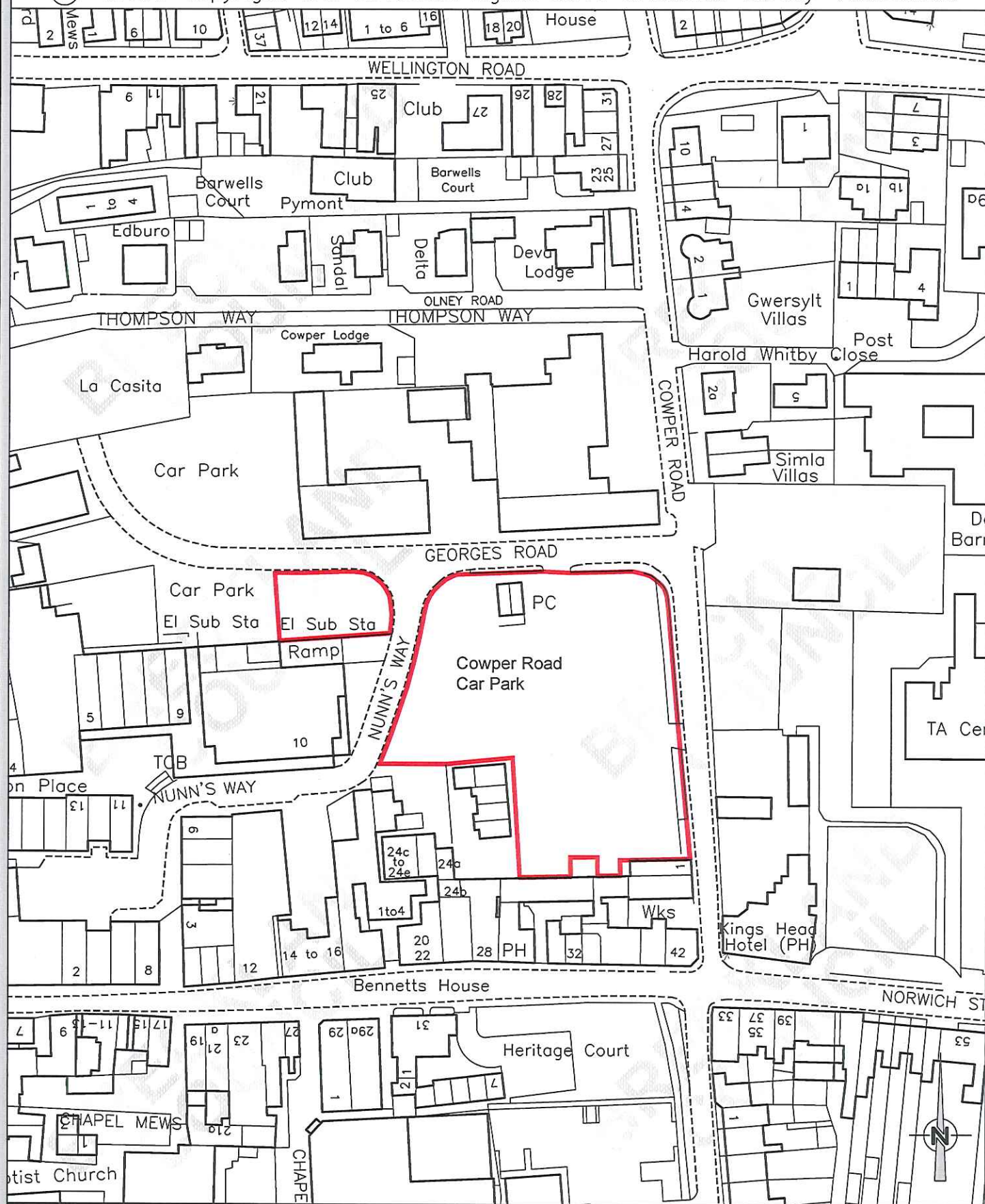

TITLE

**BRECKLAND DISTRICT COUNCIL  
(OFF-STREET PARKING PLACES)  
CONSOLIDATION ORDER 2011**

DRAWING DETAILS

**SCHEDULE 2  
PLAN 6**



This drawing and the works depicted thereon are the copyright of Breckland District Council. Unauthorised reproduction infringes copyright.

PRODUCED BY	DATE	SCALES
PRD	Sep 2011	1:1250
DRAWING No.		Rev.
<b>PLAN 6</b>		



Asset Management

Elizabeth House  
Walpole Lake  
Dereham  
Norfolk  
NR19 1EE

Tel: 01362 656870 Fax: 01362 656877





TITLE

**BRECKLAND DISTRICT COUNCIL  
(OFF-STREET PARKING PLACES)  
CONSOLIDATION ORDER 2011**

DRAWING DETAILS

**SCHEDULE 2  
PLAN 7**



This drawing and the works depicted thereon are the copyright of Breckland District Council. Unauthorised reproduction infringes copyright.

PRODUCED BY	DATE	SCALES
PRD	Sep 2011	1:1250
DRAWING No.	Rev.	
	<b>PLAN 7</b>	



Asset Management

Elizabeth House  
Walpole Lake  
Dereham  
Norfolk  
NR19 1EE

Tel: 01362 656870 Fax: 01362 656877



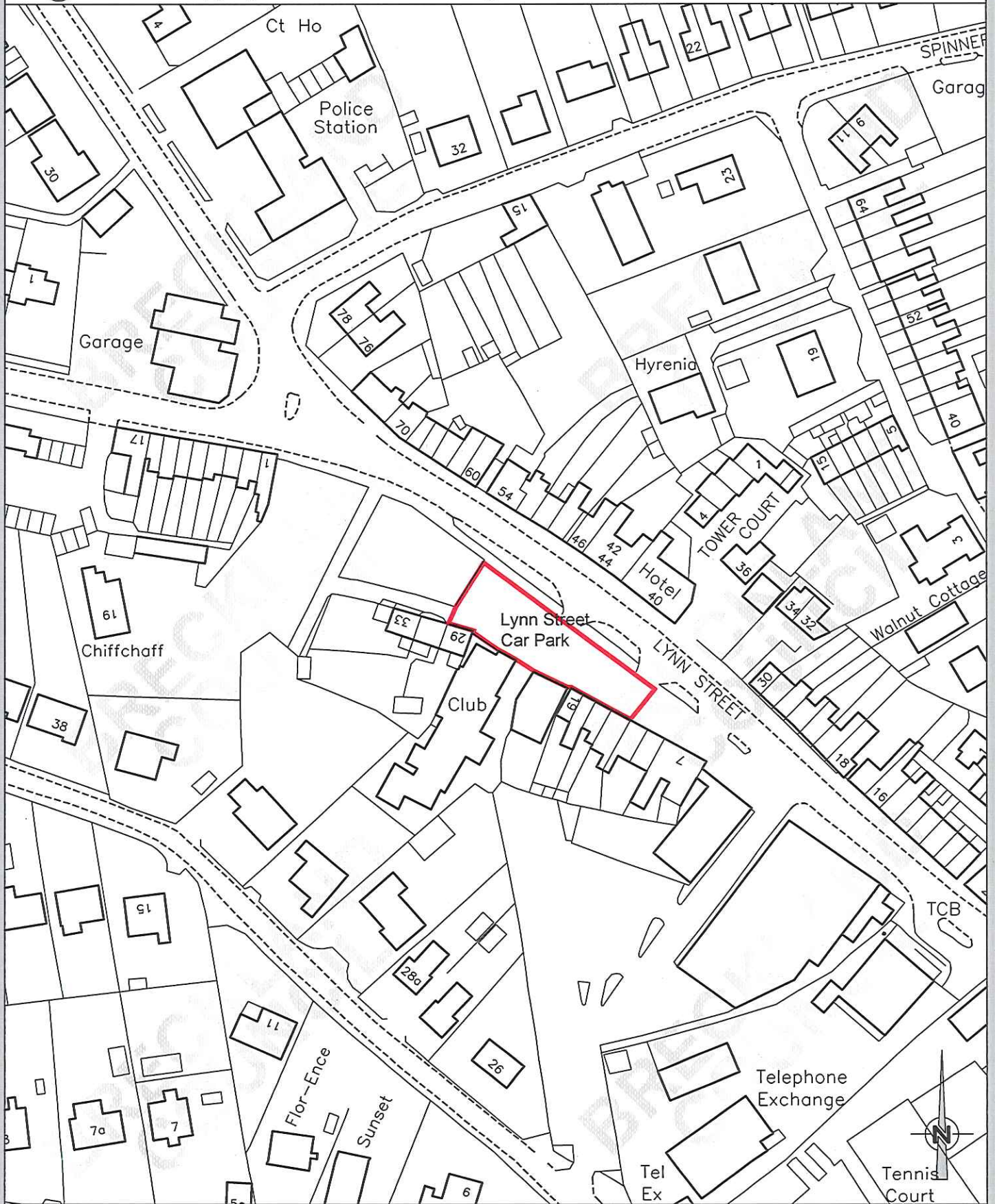

Asset Management

Elizabeth House  
Walpole Lake  
Dereham  
Norfolk  
NR19 1EE

Tel: 01362 656870 Fax: 01362 656877

**BRECKLAND DISTRICT COUNCIL  
(OFF-STREET PARKING PLACES)  
CONSOLIDATION ORDER 2011**

DRAWING DETAILS

**SCHEDULE 3  
PLAN 8**



This drawing and the works depicted thereon are the copyright of Breckland District Council. Unauthorised reproduction infringes copyright.

PRODUCED BY	DATE	SCALES
PRD	Sep 2011	1:1250
DRAWING No.	Rev.	
	<b>PLAN 8</b>	





## Asset Management

Elizabeth House  
Walpole Loke  
Dereham  
Norfolk  
NR19 1EE

Tel: 01362 656870 Fax: 01362 656877

**BRECKLAND DISTRICT COUNCIL  
(OFF-STREET PARKING PLACES)  
CONSOLIDATION ORDER 2011**

## DRAWING DETAILS

### SCHEDULE 3

PLAN 9

©

This drawing and the works depicted thereon are the copyright of Breckland District Council. Unauthorised reproduction infringes copyright.

PRODUCED BY

DATE \_\_\_\_\_

## SCALES

PRD

Sep 2011

1:1250

DRAWING No.

Rev.

## PLAN 9



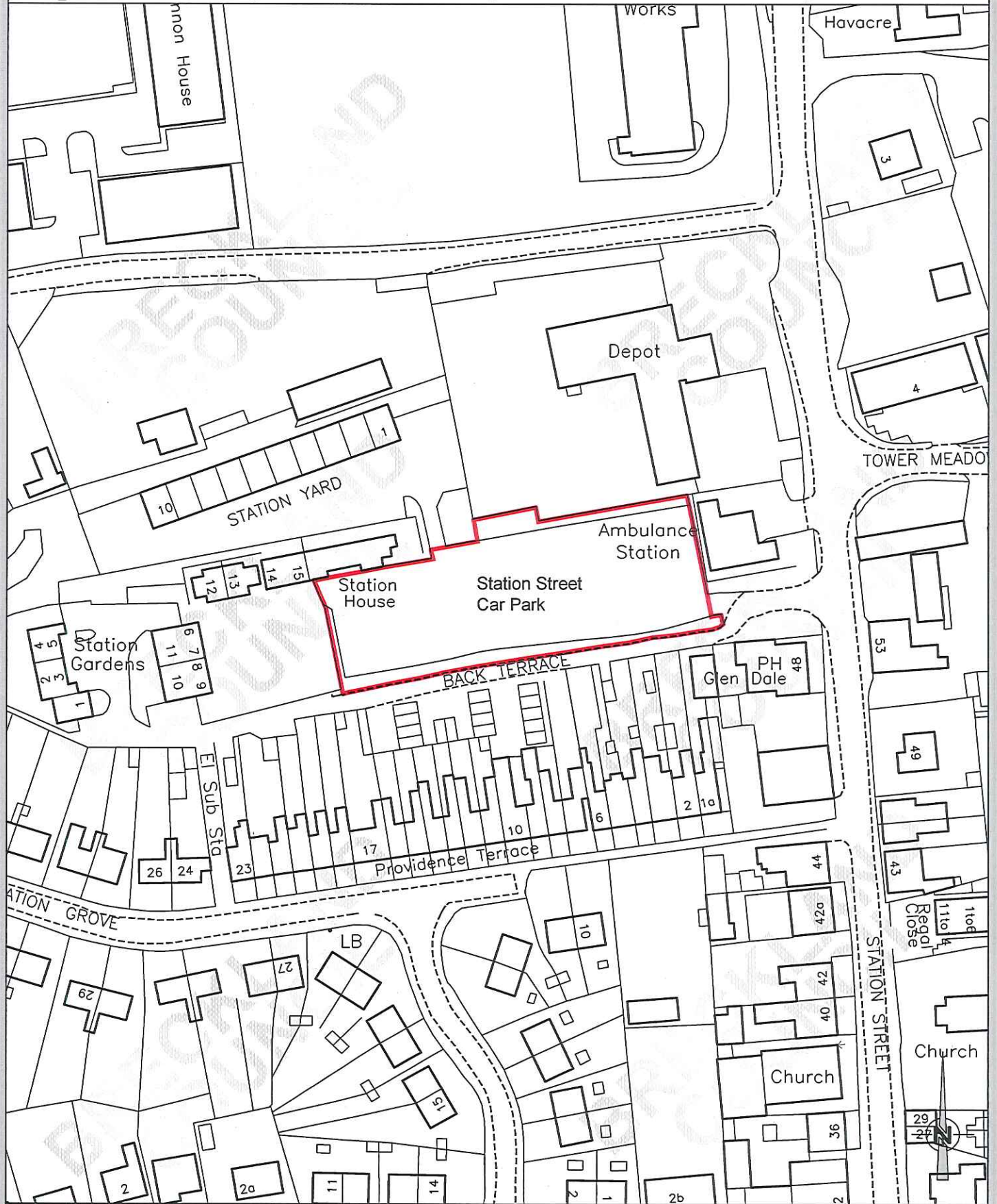

TITLE



Asset Management

Elizabeth House  
Walpole Lake  
Dereham  
Norfolk  
NR19 1EE

Tel: 01362 656870 Fax: 01362 656877

**BRECKLAND DISTRICT COUNCIL  
(OFF-STREET PARKING PLACES)  
CONSOLIDATION ORDER 2011**

DRAWING DETAILS

**SCHEDULE 3  
PLAN 10**



This drawing and the works depicted thereon are the copyright of Breckland District Council. Unauthorised reproduction infringes copyright.

PRODUCED BY	DATE	SCALES
PRD	Sep 2011	1:1250
DRAWING No.		Rev.
<b>PLAN 10</b>		



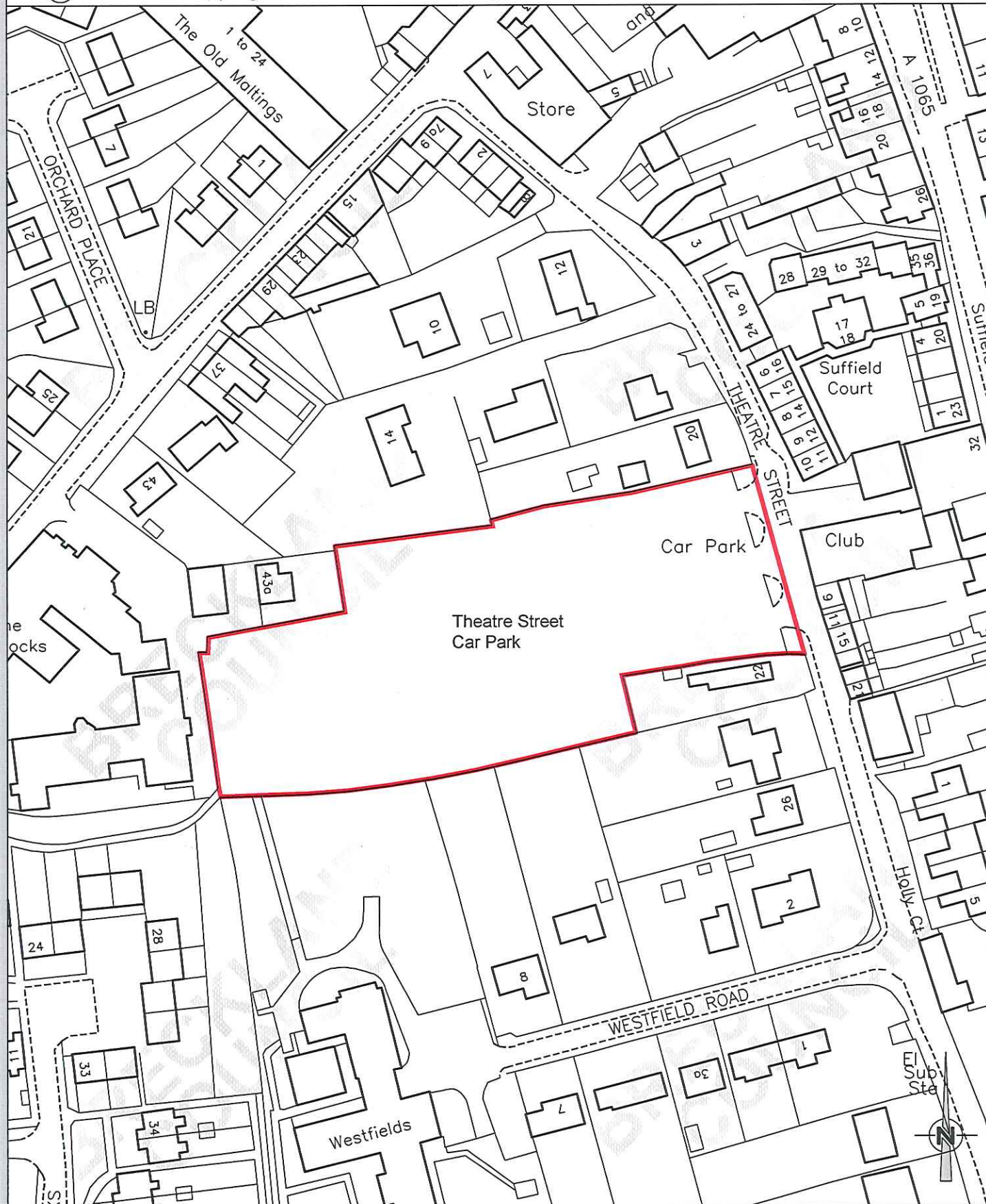

TITLE

**BRECKLAND DISTRICT COUNCIL  
(OFF-STREET PARKING PLACES)  
CONSOLIDATION ORDER 2011**

DRAWING DETAILS

**SCHEDULE 3  
PLAN 11**



This drawing and the works depicted thereon are the copyright of Breckland District Council. Unauthorised reproduction infringes copyright.

PRODUCED BY	DATE	SCALES
PRD	Sep 2011	1:1250
DRAWING No.		Rev.
<b>PLAN 11</b>		



Asset Management

Elizabeth House  
Walpole Lake  
Dereham  
Norfolk  
NR19 1EE

*a better place, a brighter future*  
**Breckland  
COUNCIL**

Tel: 01362 656870 Fax: 01362 656877



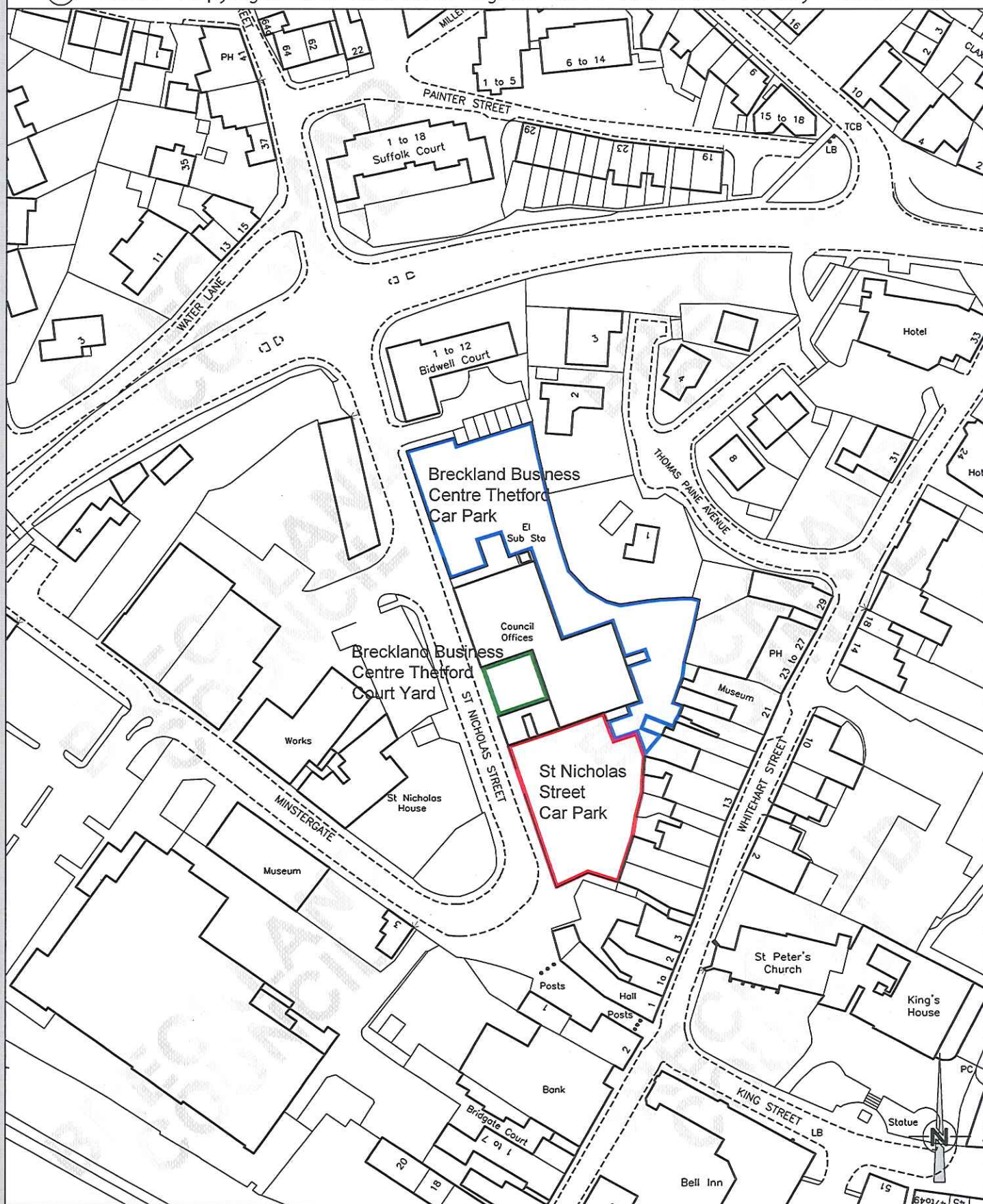

TITLE

**BRECKLAND DISTRICT COUNCIL  
(OFF-STREET PARKING PLACES)  
CONSOLIDATION ORDER 2011**

DRAWING DETAILS  
**SCHEDULE 4  
PLAN 12**



This drawing and the works depicted thereon are the copyright of Breckland District Council. Unauthorised reproduction infringes copyright.

PRODUCED BY	DATE	SCALES
PRD	Sep 2011	1:1250
DRAWING No.		Rev.
<b>PLAN 12</b>		



Asset Management

Elizabeth House  
Walpole Loke  
Dereham  
Norfolk  
NR19 1EE

Tel: 01362 656870 Fax: 01362 656877



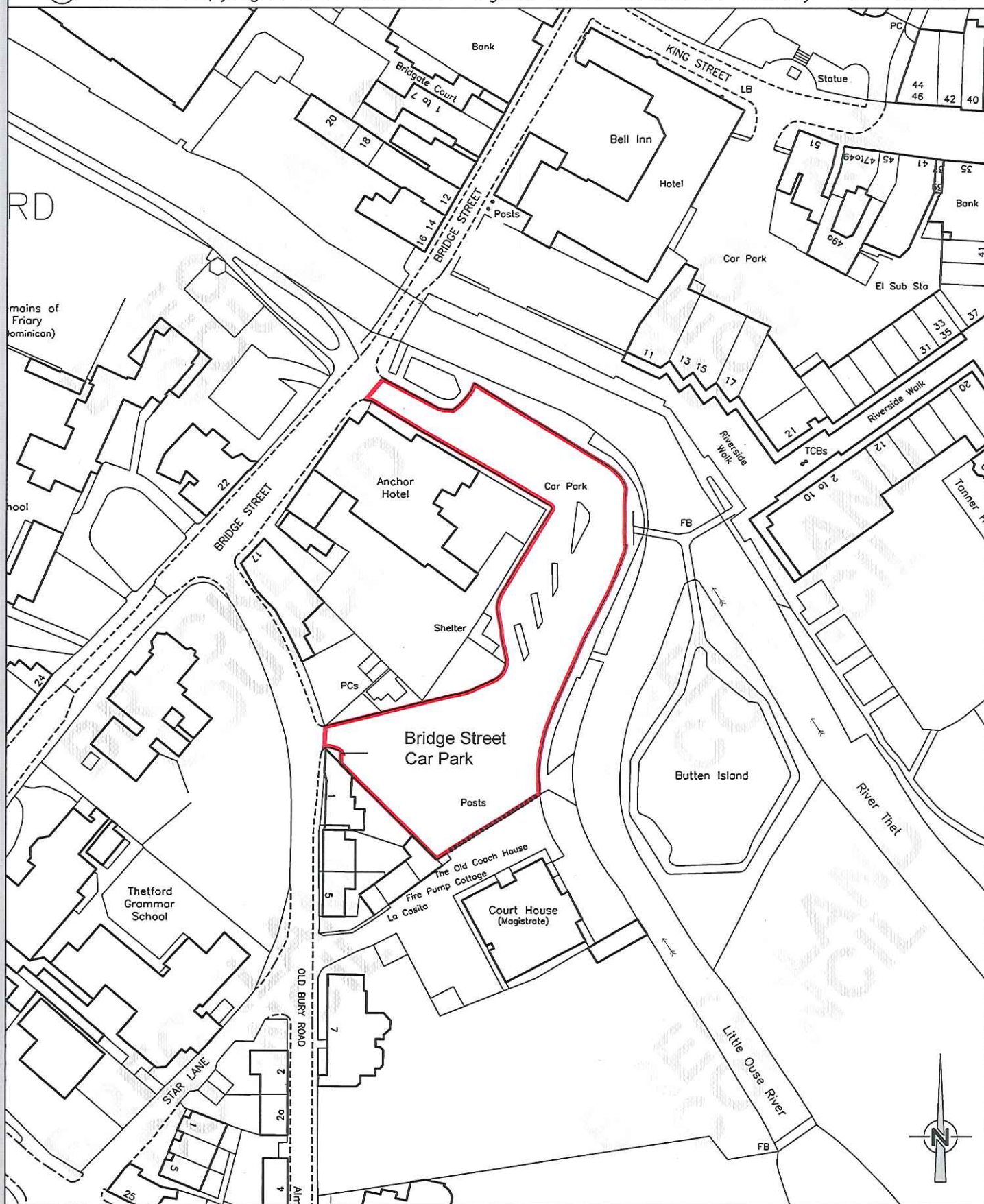

Asset Management

Elizabeth House  
Walpole Lake  
Dereham  
Norfolk  
NR19 1EE

Tel: 01362 656870 Fax: 01362 656877

TITLE  
**BRECKLAND DISTRICT COUNCIL  
(OFF-STREET PARKING PLACES)  
CONSOLIDATION ORDER 2011**

DRAWING DETAILS  
**SCHEDULE 4  
PLAN 13**



This drawing and the works depicted thereon are the copyright of Breckland District Council. Unauthorised reproduction infringes copyright.

PRODUCED BY	DATE	SCALES
PRD	Sep 2011	1:1250
DRAWING No.		Rev.
<b>PLAN 13</b>		



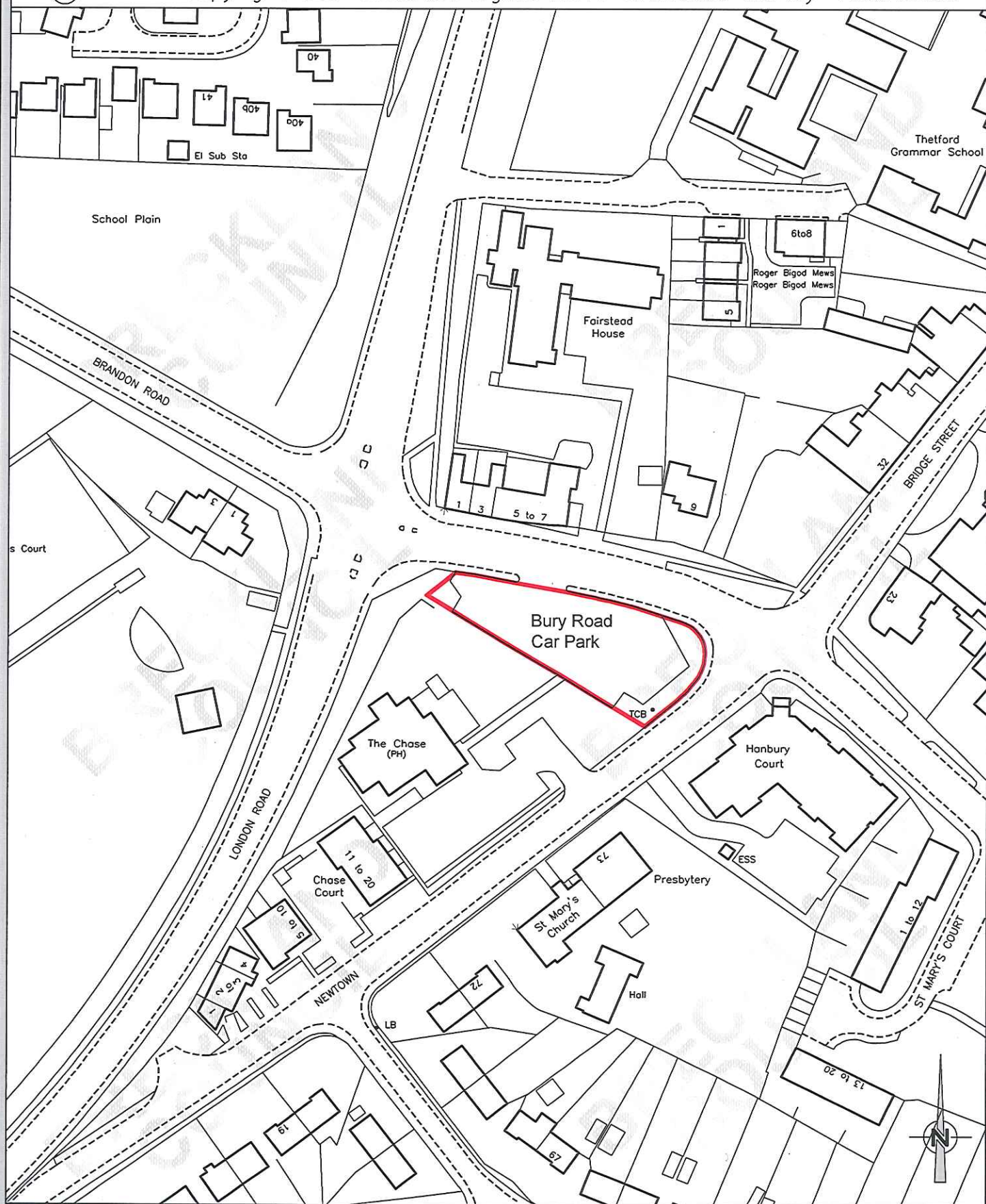

TITLE

**BRECKLAND DISTRICT COUNCIL  
(OFF-STREET PARKING PLACES)  
CONSOLIDATION ORDER 2011**

DRAWING DETAILS

**SCHEDULE 4  
PLAN 14**



This drawing and the works depicted thereon are the copyright of Breckland District Council. Unauthorised reproduction infringes copyright.

PRODUCED BY

DATE

SCALES

PRD

Sep 2011

1:1250

DRAWING No.

Rev.

**PLAN 14**



*a better place, a brighter future*  
**Breckland  
COUNCIL**

Asset Management

Elizabeth House  
Walpole Lake  
Dereham  
Norfolk  
NR19 1EE

Tel: 01362 656870 Fax: 01362 656877



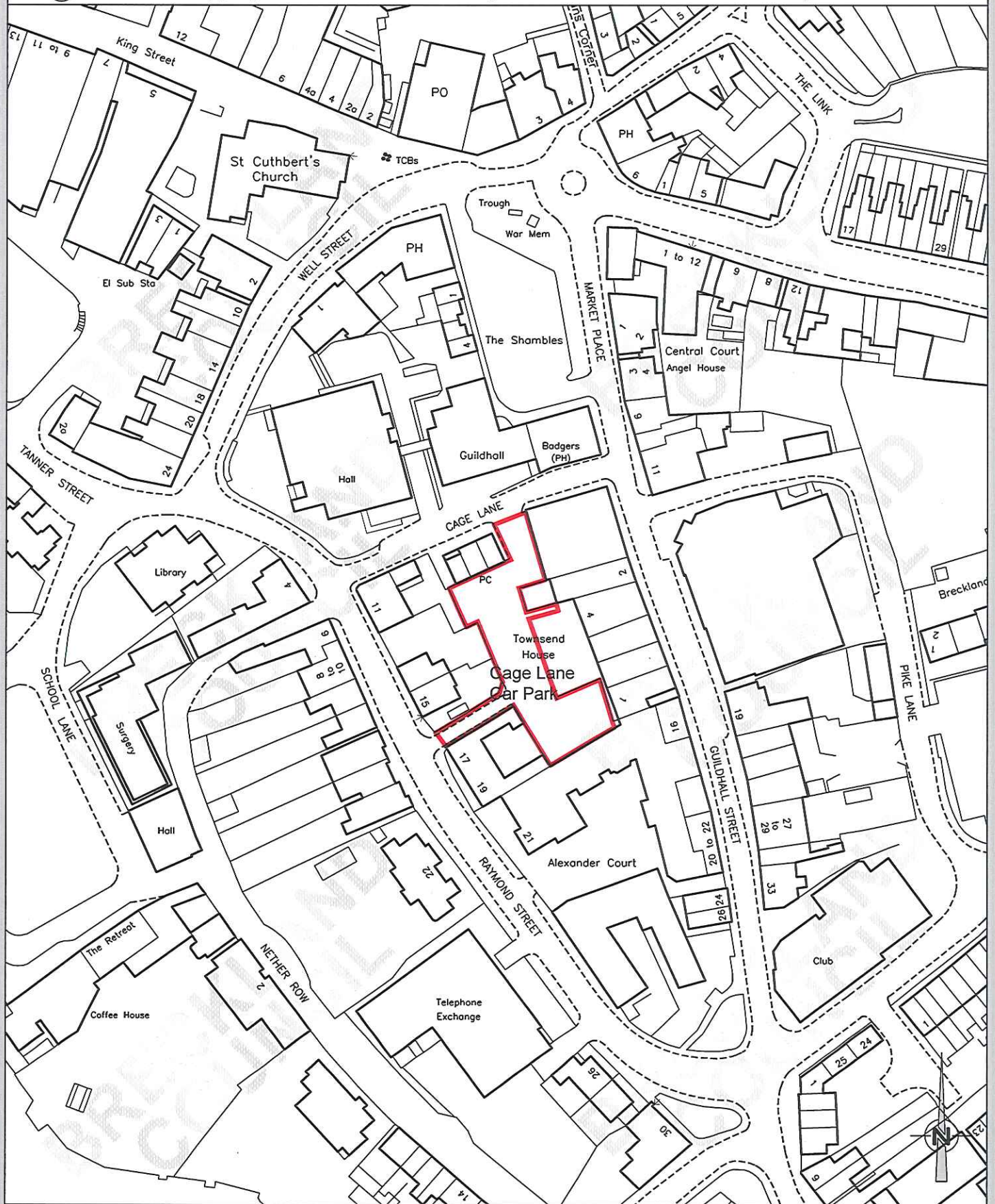

Asset Management

Elizabeth House  
Walpole Lake  
Dereham  
Norfolk  
NR19 1EE

Tel: 01362 656870 Fax: 01362 656877

TITLE  
**BRECKLAND DISTRICT COUNCIL  
(OFF-STREET PARKING PLACES)  
CONSOLIDATION ORDER 2011**

DRAWING DETAILS  
**SCHEDULE 4  
PLAN 15**



This drawing and the works depicted thereon are the copyright of Breckland District Council. Unauthorised reproduction infringes copyright.

PRODUCED BY	DATE	SCALES
PRD	Sep 2011	1:1250
DRAWING No.	Rev.	
	<b>PLAN 15</b>	



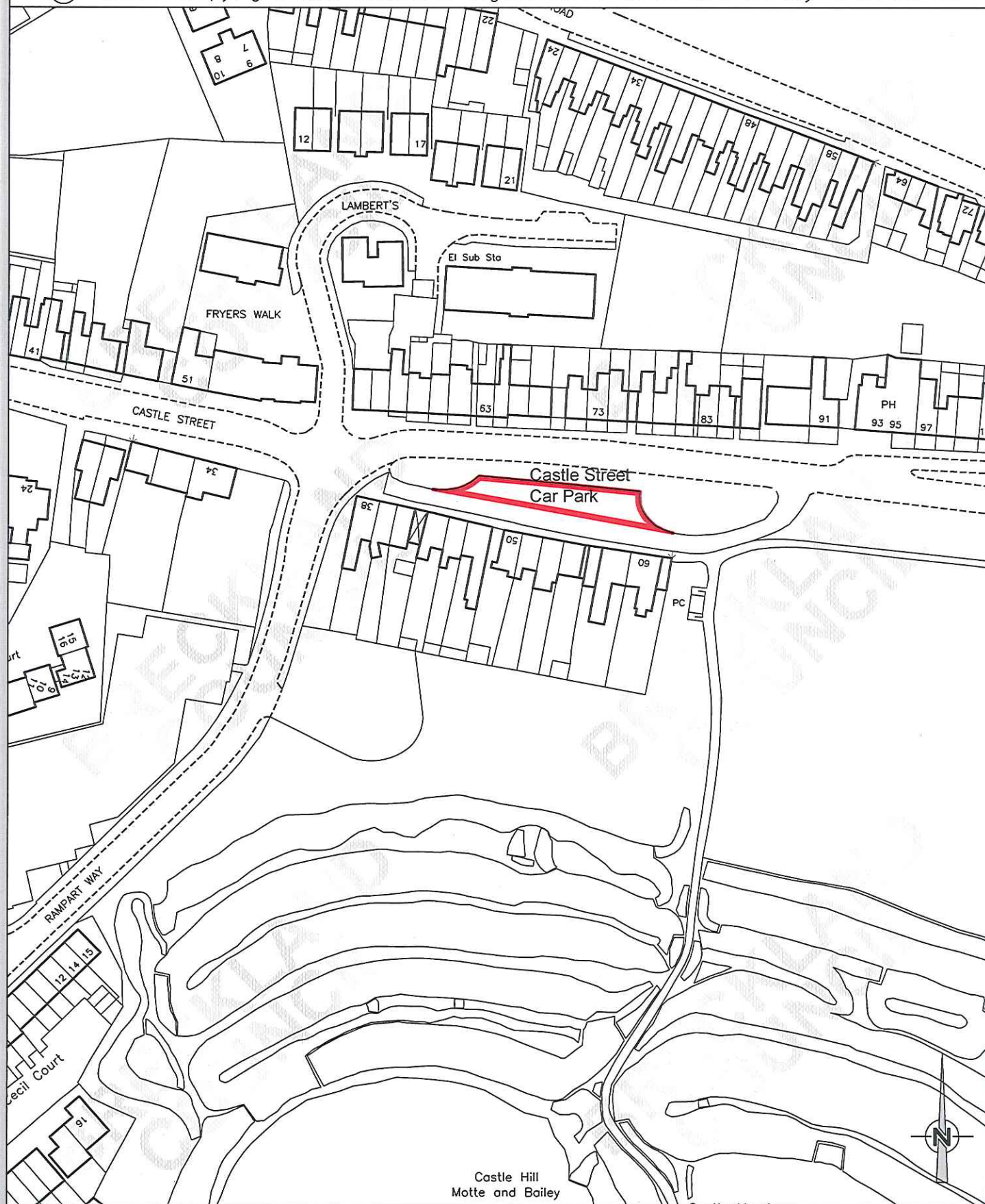

Castle Hill  
Motte and Bailey



Asset Management

Elizabeth House  
Walpole Lake  
Dereham  
Norfolk  
NR19 1EE

Tel: 01362 656870 Fax: 01362 656877

TITLE  
**BRECKLAND DISTRICT COUNCIL  
(OFF-STREET PARKING PLACES)  
CONSOLIDATION ORDER 2011**

DRAWING DETAILS  
**SCHEDULE 4  
PLAN 16**



This drawing and the works depicted thereon are the copyright of Breckland District Council. Unauthorised reproduction infringes copyright.

PRODUCED BY	DATE	SCALES
PRD	Sep 2011	1:1250
DRAWING No.		Rev.
PLAN 16		





Asset Management  
Elizabeth House  
Walpole Loke  
Dereham  
Norfolk  
NR19 1EE

Tel: 01362 656870 Fax: 01362 656877

TITLE  
**BRECKLAND DISTRICT COUNCIL  
(OFF-STREET PARKING PLACES)  
CONSOLIDATION ORDER 2011**

DRAWING DETAILS  
**SCHEDULE 4  
PLAN 17**



This drawing and the works depicted thereon are the copyright of Breckland District Council. Unauthorised reproduction infringes copyright.

PRODUCED BY	DATE	SCALES
PRD	Sep 2011	1:1250
DRAWING No.		Rev.
PLAN 17		



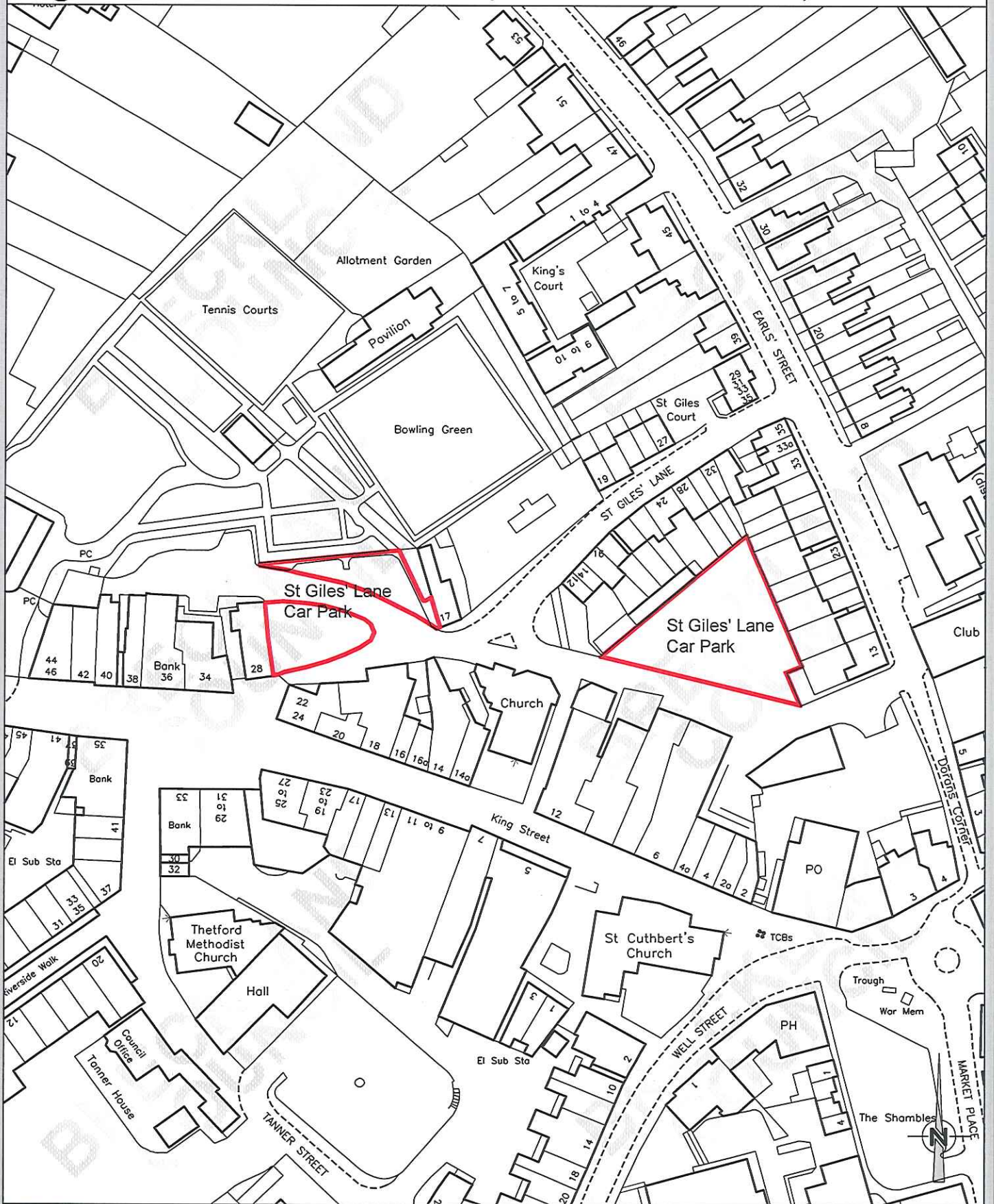

TITLE



Asset Management

Elizabeth House  
Walpole Loke  
Dereham  
Norfolk  
NR19 1EE

Tel: 01362 656870 Fax: 01362 656877

**BRECKLAND DISTRICT COUNCIL  
(OFF-STREET PARKING PLACES)  
CONSOLIDATION ORDER 2011**

DRAWING DETAILS

**SCHEDULE 4  
PLAN 18**



This drawing and the works depicted thereon are the copyright of Breckland District Council. Unauthorised reproduction infringes copyright.

PRODUCED BY	DATE	SCALES
PRD	Sep 2011	1:1250
DRAWING No.		Rev.
PLAN 18		



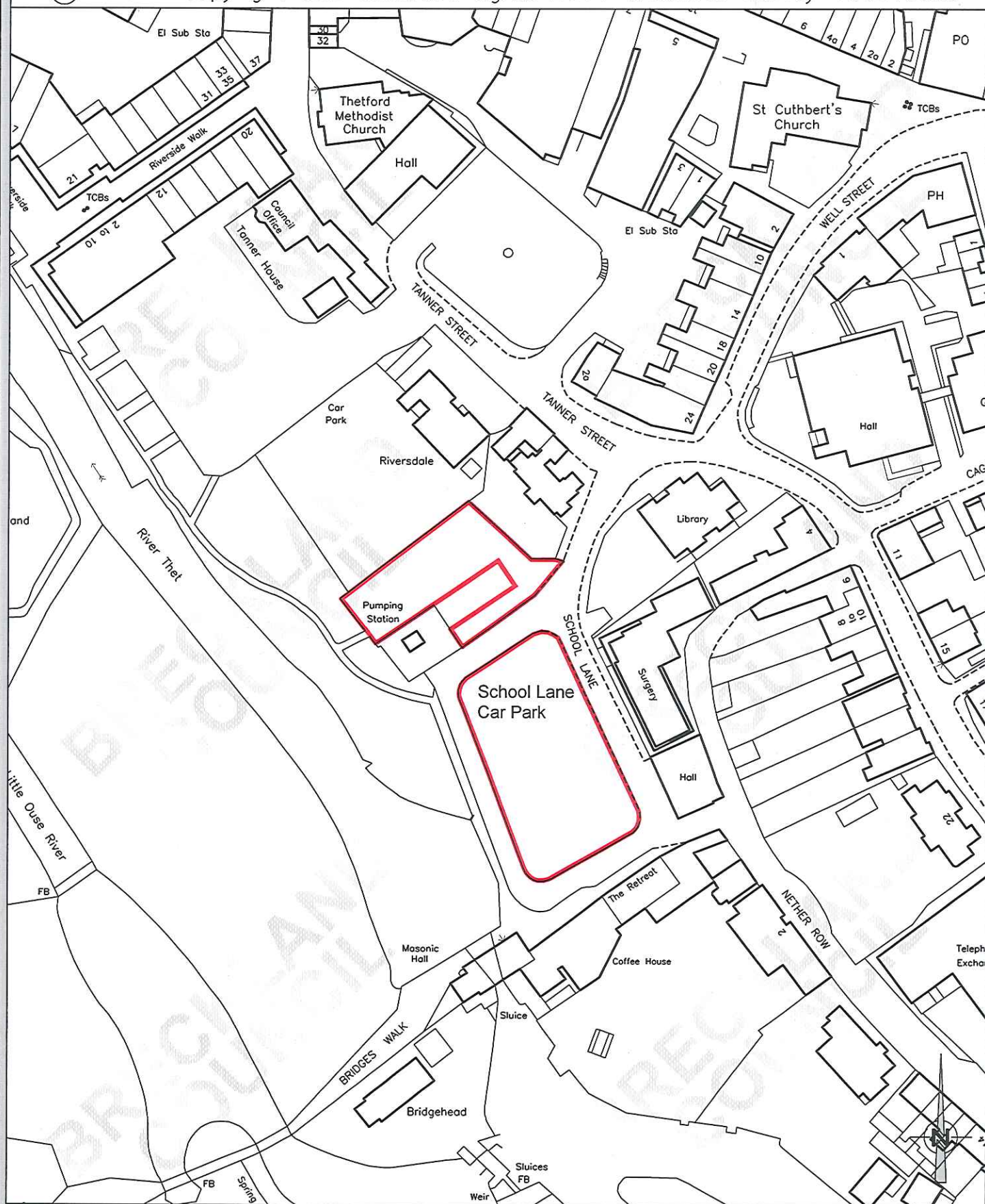

Asset Management

Elizabeth House  
Walpole Lake  
Dereham  
Norfolk  
NR19 1EE

Tel: 01362 656870 Fax: 01362 656877

TITLE  
**BRECKLAND DISTRICT COUNCIL  
(OFF-STREET PARKING PLACES)  
CONSOLIDATION ORDER 2011**

DRAWING DETAILS  
**SCHEDULE 4  
PLAN 19**



This drawing and the works depicted thereon are the copyright of Breckland District Council. Unauthorised reproduction infringes copyright.

PRODUCED BY	DATE	SCALES
PRD	Sep 2011	1:1250
DRAWING No.		Rev.
PLAN 19		



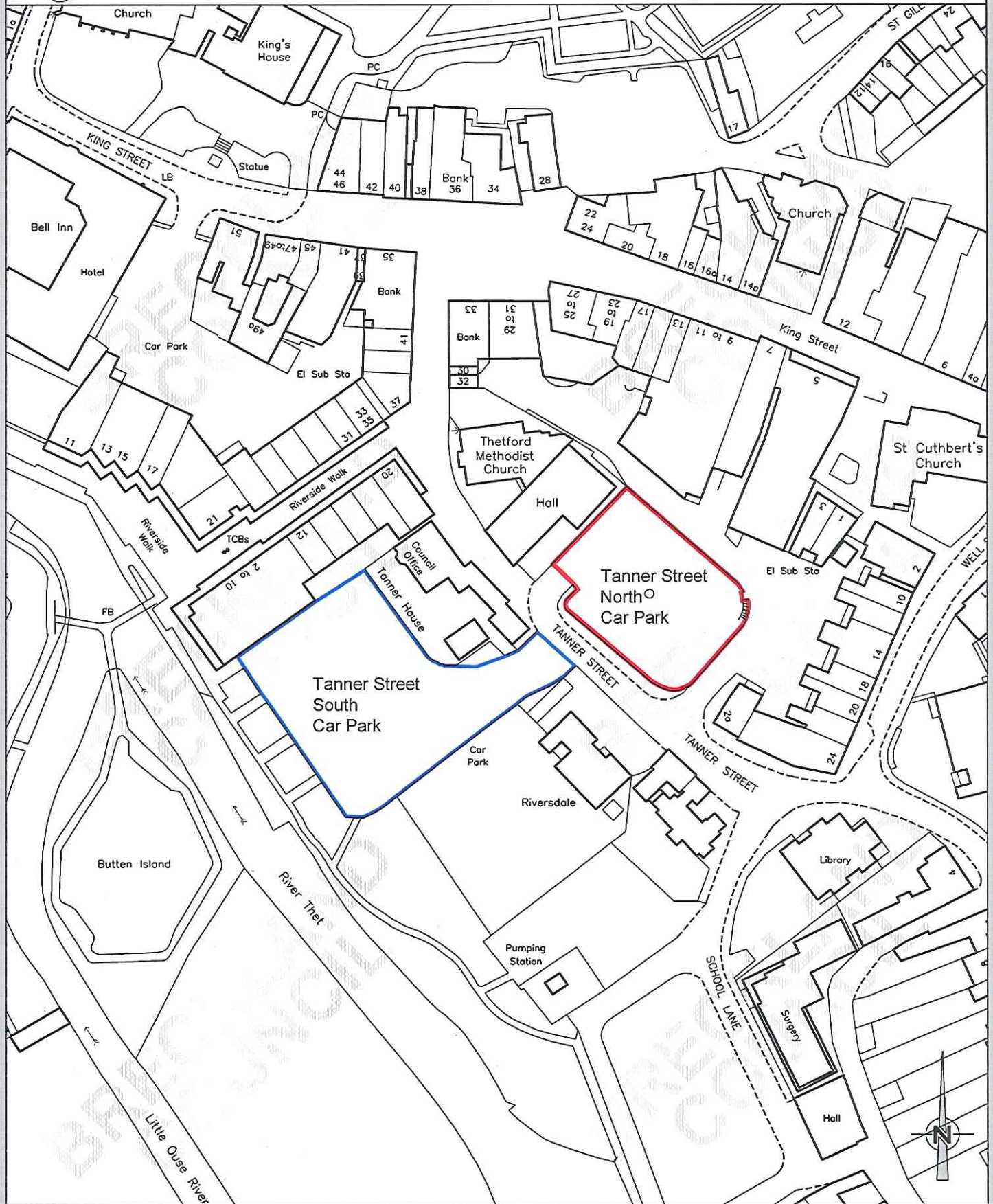

Asset Management

Elizabeth House  
Walpole Lake  
Dereham  
Norfolk  
NR19 1EE

Tel: 01362 656870 Fax: 01362 656877

TITLE  
**BRECKLAND DISTRICT COUNCIL  
(OFF-STREET PARKING PLACES)  
CONSOLIDATION ORDER 2011**

DRAWING DETAILS  
**SCHEDULE 4  
PLAN 20**



This drawing and the works depicted thereon are the copyright of Breckland District Council. Unauthorised reproduction infringes copyright.

PRODUCED BY	DATE	SCALES
PRD	Sep 2011	1:1250
DRAWING No.		Rev.
PLAN 20		



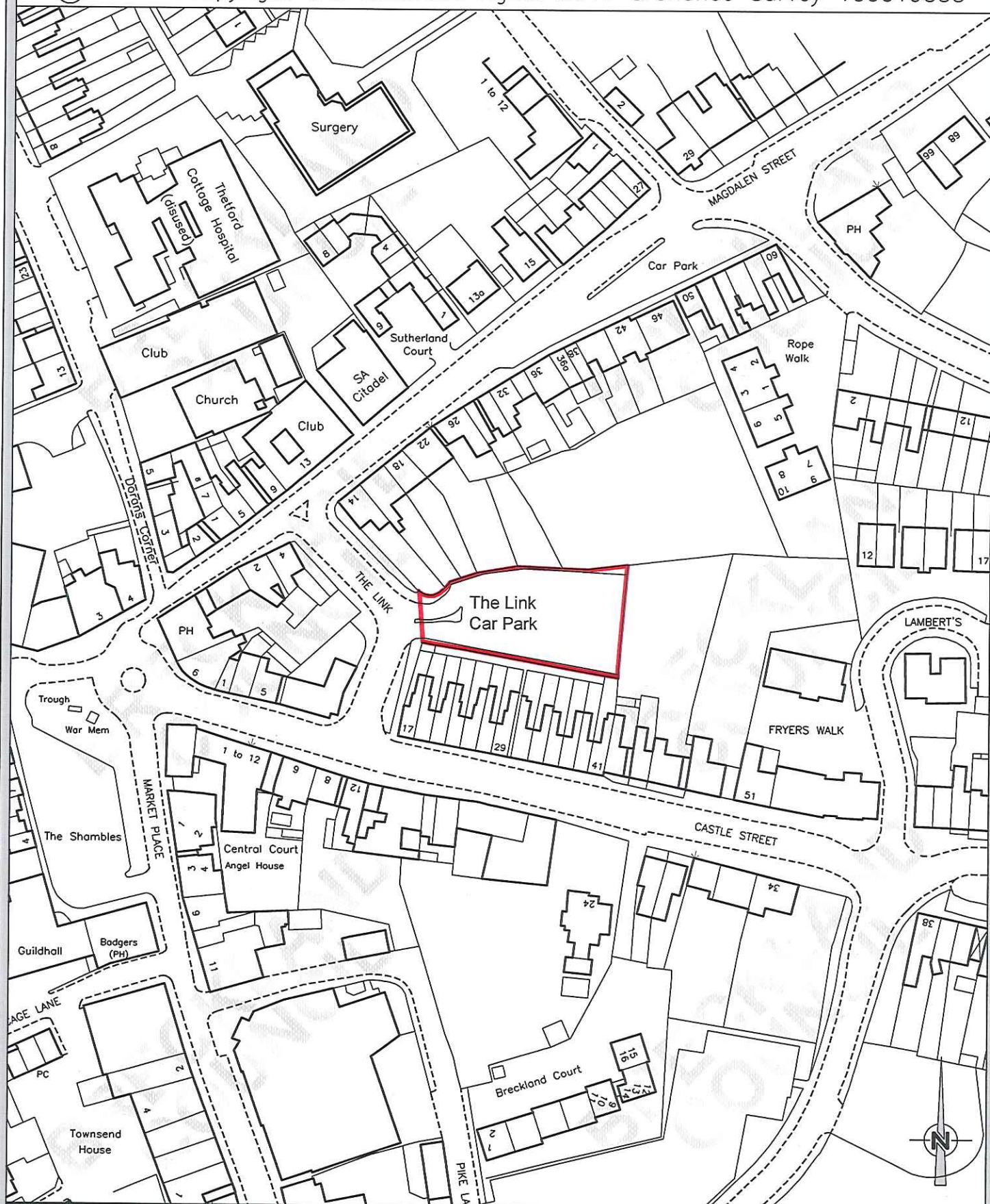

Asset Management

Elizabeth House  
Walpole Loke  
Dereham  
Norfolk  
NR19 1EE

Tel: 01362 656870 Fax: 01362 656877

**BRECKLAND DISTRICT COUNCIL  
(OFF-STREET PARKING PLACES)  
CONSOLIDATION ORDER 2011**

DRAWING DETAILS

**SCHEDULE 4  
PLAN 21**



This drawing and the works depicted thereon are the copyright of Breckland District Council. Unauthorised reproduction infringes copyright.

PRODUCED BY

DATE

SCALES

PRD

Sep 2011

1:1250

DRAWING No.

Rev.

**PLAN 21**



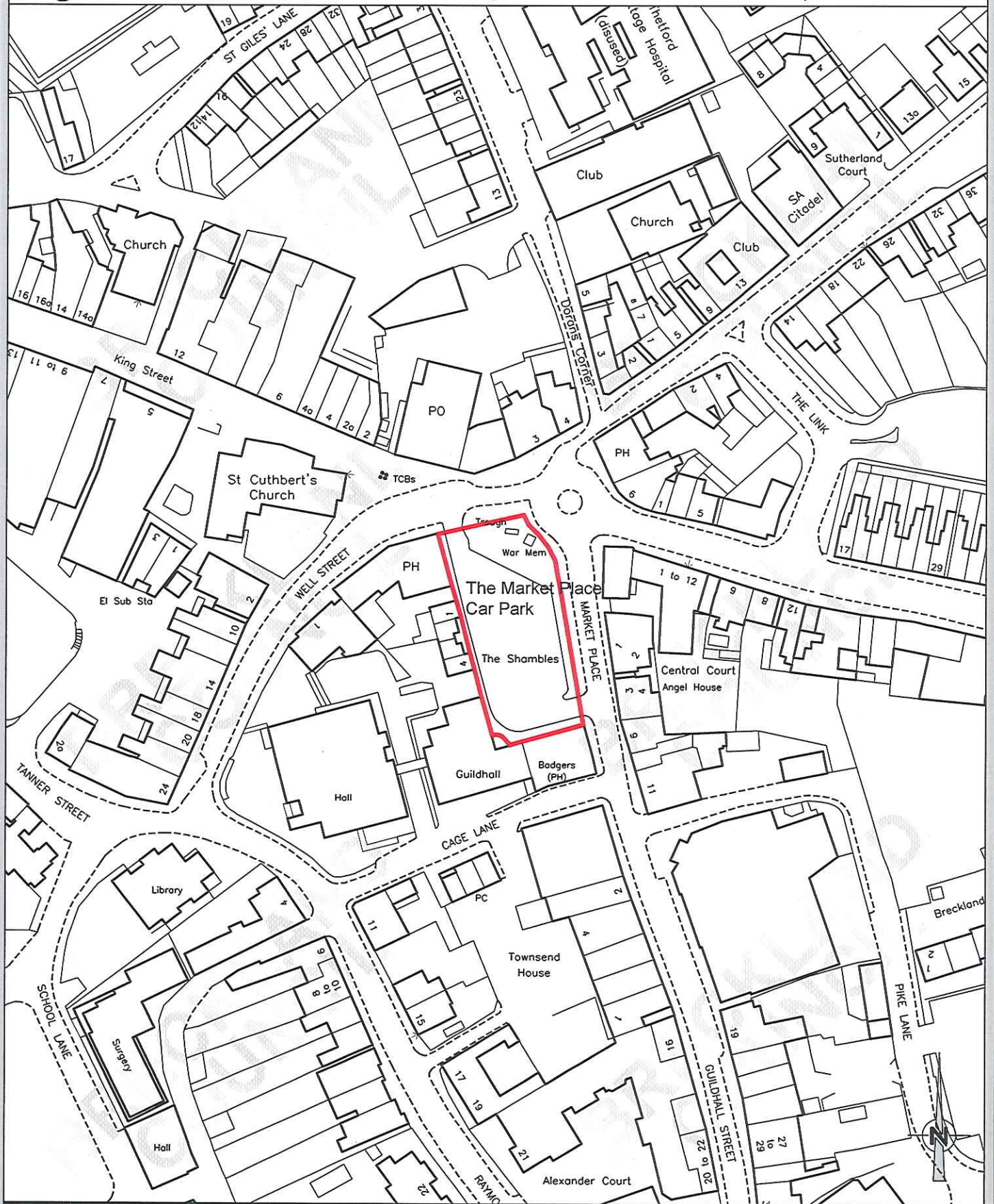

Asset Management

Elizabeth House  
Walpole Lake  
Dereham  
Norfolk  
NR19 1EE

Tel: 01362 656870 Fax: 01362 656877

**BRECKLAND DISTRICT COUNCIL  
(OFF-STREET PARKING PLACES)  
CONSOLIDATION ORDER 2011**

DRAWING DETAILS

**SCHEDULE 4  
PLAN 22**



This drawing and the works depicted thereon are the copyright of Breckland District Council. Unauthorised reproduction infringes copyright.

PRODUCED BY	DATE	SCALES
PRD	Sep 2011	1:1250
DRAWING No.		Rev.
PLAN 22		



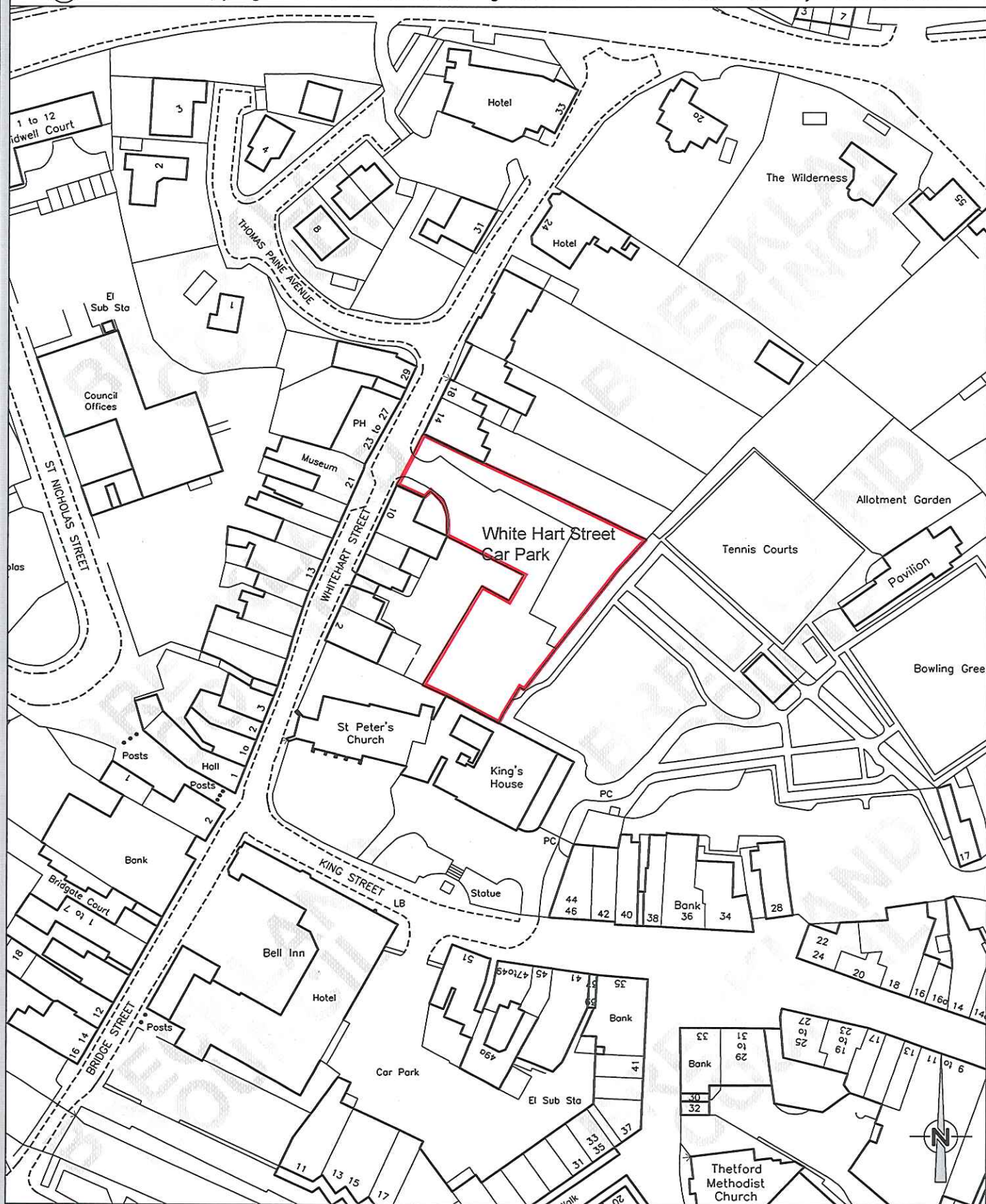

Asset Management

Elizabeth House  
Walpole Lake  
Dereham  
Norfolk  
NR19 1EE

Tel: 01362 656870 Fax: 01362 656877

TITLE  
**BRECKLAND DISTRICT COUNCIL  
(OFF-STREET PARKING PLACES)  
CONSOLIDATION ORDER 2011**

DRAWING DETAILS

**SCHEDULE 4  
PLAN 23**



This drawing and the works depicted thereon are the copyright of Breckland District Council. Unauthorised reproduction infringes copyright.

PRODUCED BY	DATE	SCALES
PRD	Sep 2011	1:1250
DRAWING No.		Rev.
<b>PLAN 23</b>		



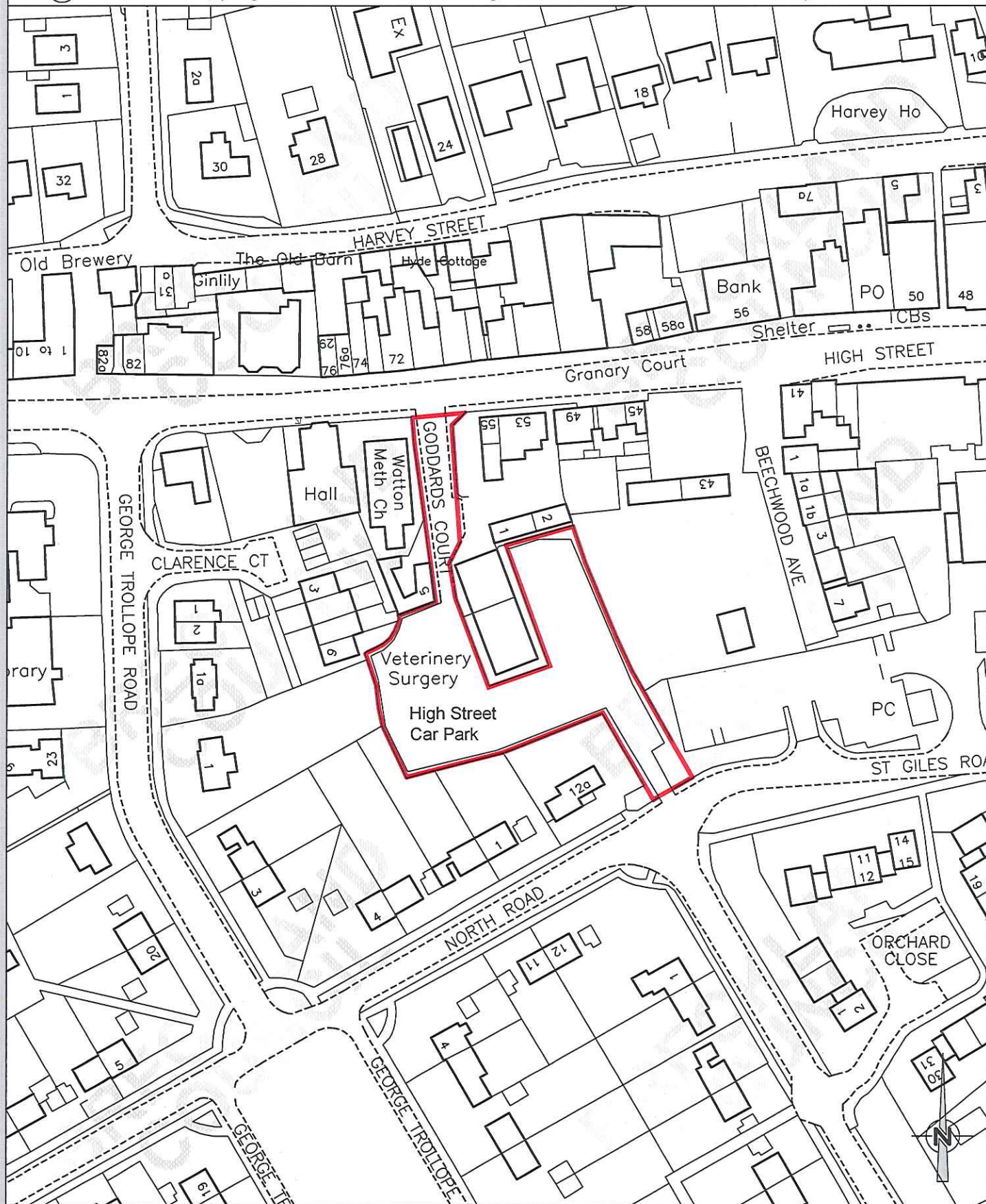

TITLE



Asset Management

Elizabeth House  
Walpole Lake  
Dereham  
Norfolk  
NR19 1EE

Tel: 01362 656870 Fax: 01362 656877

**BRECKLAND DISTRICT COUNCIL  
(OFF-STREET PARKING PLACES)  
CONSOLIDATION ORDER 2011**

DRAWING DETAILS

**SCHEDULE 5**

**PLAN 24**



This drawing and the works depicted thereon are the copyright of Breckland District Council. Unauthorised reproduction infringes copyright.

PRODUCED BY	DATE	SCALES
PRD	Sep 2011	1:1250
DRAWING No.		Rev.
PLAN 24		



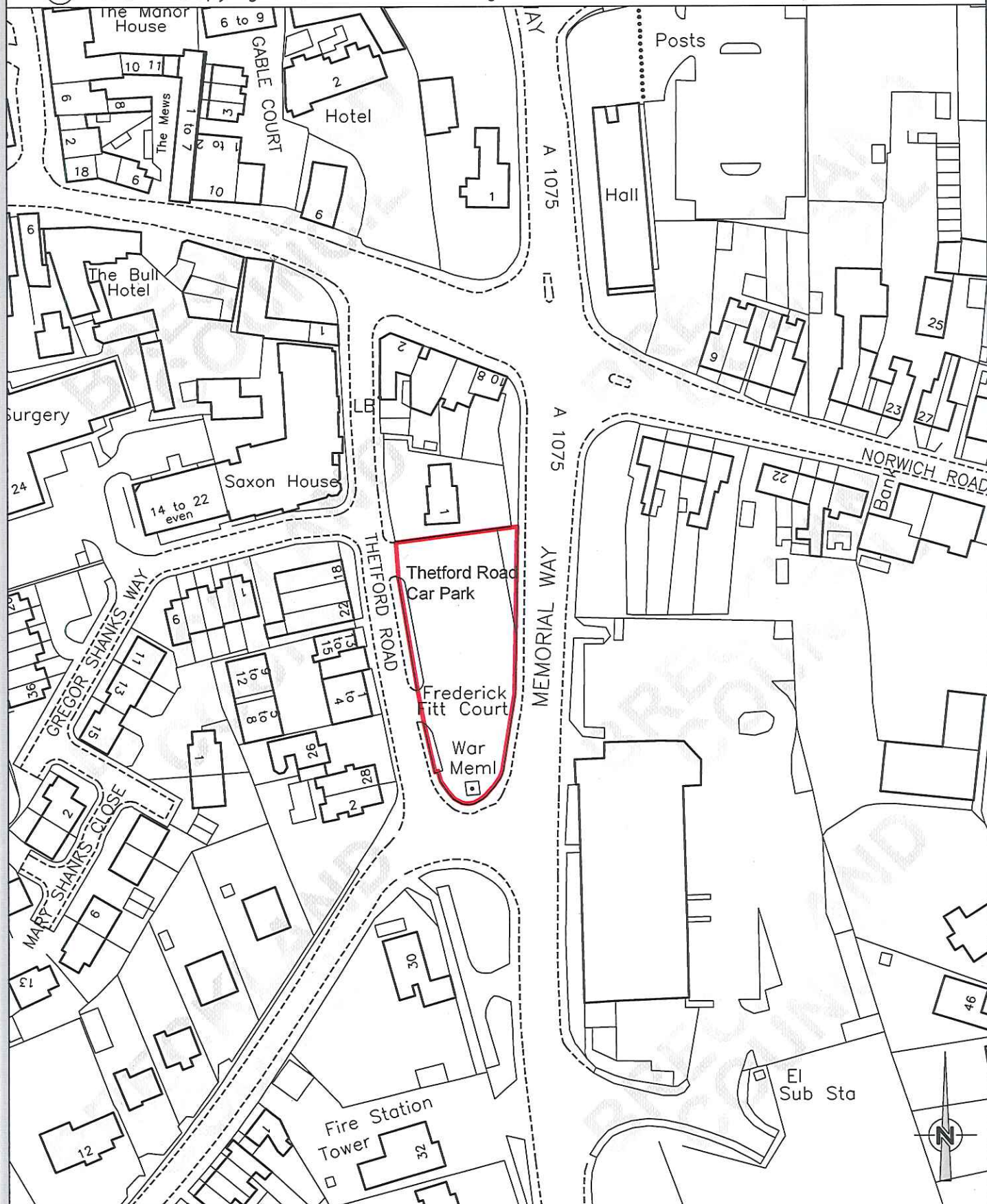

TITLE

**BRECKLAND DISTRICT COUNCIL  
(OFF-STREET PARKING PLACES)  
CONSOLIDATION ORDER 2011**

DRAWING DETAILS  
**SCHEDULE 5  
PLAN 25**



This drawing and the works depicted thereon are the copyright of Breckland District Council. Unauthorised reproduction infringes copyright.

PRODUCED BY	DATE	SCALES
PRD	Sep 2011	1:1250
DRAWING No.		Rev.
<b>PLAN 25</b>		



Asset Management

Elizabeth House  
Walpole Lake  
Dereham  
Norfolk  
NR19 1EE

*a better place, a brighter future*  
**Breckland**  
COUNCIL

Tel: 01362 656870 Fax: 01362 656877



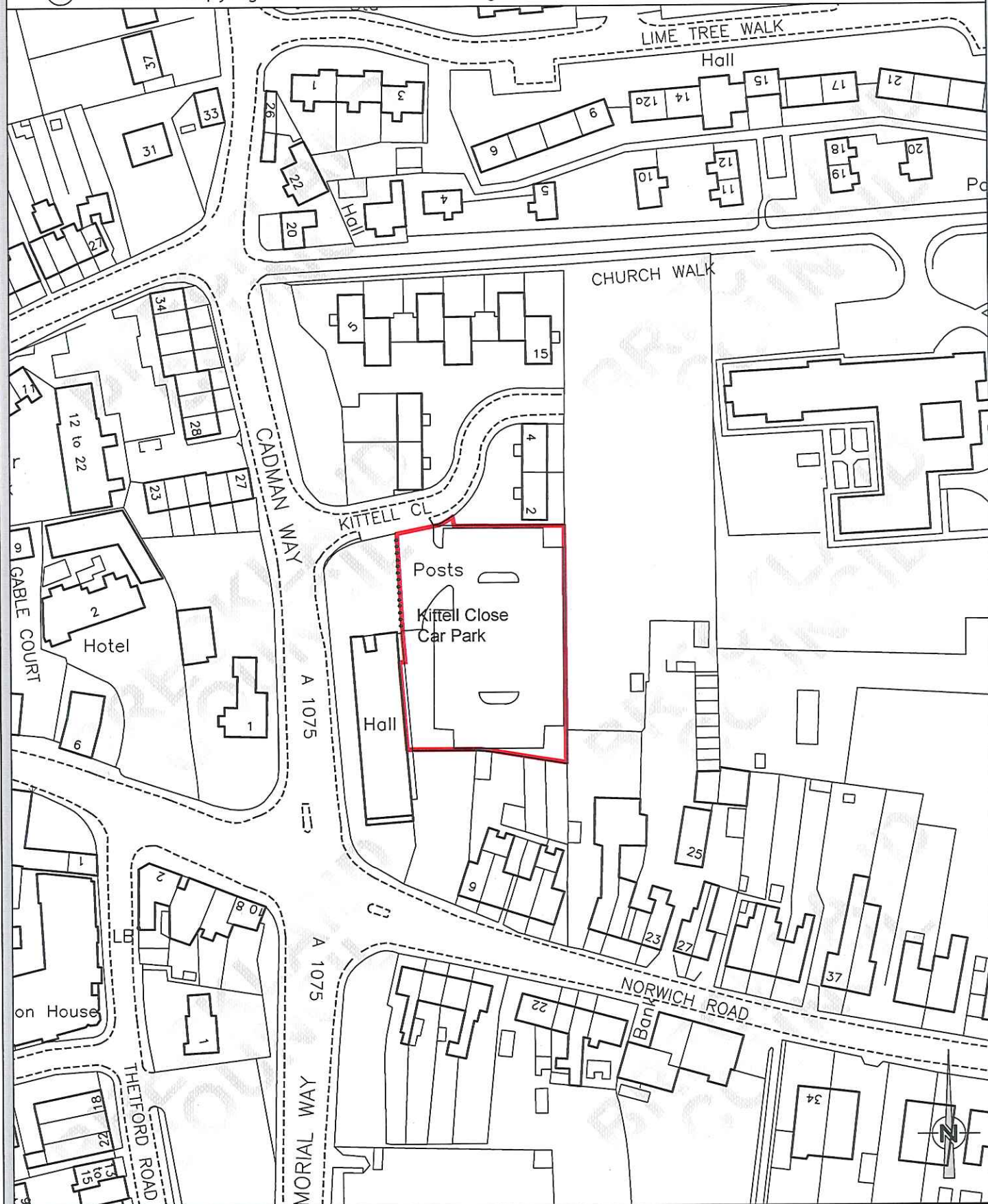

TITLE

**BRECKLAND DISTRICT COUNCIL  
(OFF-STREET PARKING PLACES)  
CONSOLIDATION ORDER 2011**

DRAWING DETAILS

**SCHEDULE 5  
PLAN 26**



This drawing and the works depicted thereon are the copyright of Breckland District Council. Unauthorised reproduction infringes copyright.

PRODUCED BY

DATE

SCALES

PRD

Sep 2011

1:1250

DRAWING No.

Rev.

**PLAN 26**



Asset Management

Elizabeth House  
Walpole Loke  
Dereham  
Norfolk  
NR19 1EE

*a better place, a brighter future*  
**Breckland**  
COUNCIL

Tel: 01362 656870 Fax: 01362 656877