

BRACKNELL FOREST BOROUGH COUNCIL
(CONTROL OF OFF-STREET PARKING)
ORDER 2015



Bracknell Forest Borough Council (hereinafter called "the Council") in exercise of its powers under Sections 32, 33 and 35 of the Road Traffic Regulation Act 1984 ("the 1984 Act") as amended and the Traffic Management Act 2004 ("the 2004 Act") and Part IV of Schedule 9 to the 1984 Act and of all other enabling powers and after consulting the Chief Officer of Police in accordance with Part III of Schedule 9 to the Act of 1984 hereby makes the following Order:-

PART I

CITATION AND INTERPRETATION

Citation

1. This Order shall come into operation on the 1st June 2015 and may be cited as the Bracknell Forest Borough Council (Control of Off-Street Parking) Order 2015.

Interpretation

2. In this Order, except where the context otherwise requires, the following expressions have the meanings hereby respectively assigned to them:-

"authorised vehicle" means a vehicle of a class specified in Column 3 of Schedule 1 to this Order;

"authorised officer" means the Director of Environment, Culture and Communities for the Council or any other officer of the Council (to whom the Council has delegated all relevant powers) to be designated by the Council;

"civil enforcement officer" means a person authorised by or on behalf of the Council to supervise the parking places and enforce the restrictions imposed by this Order;

"charging hours" in relation to a parking place means the period specified in Column 6 of Schedule 1 to this Order;

"the Council" means Bracknell Forest Borough Council and includes any agent of theirs appointed by them for the purposes of this Order;

"disabled person's badge" has the meaning given in the Disabled Persons (Badges for Motor Vehicles) (England) Regulations 2000 ("the 2000 Regulations") no .682 as amended.

"driver", in relation to a vehicle waiting in a parking place, means the person driving the vehicle at the time it was left in that parking place and in relation to a vehicle leaving a parking place means the person driving the vehicle at the time it leaves the parking place;

"enactment" means any enactment, whether public general or local, and includes any order, byelaw, rule, regulation, scheme or other instrument having effect by virtue of an enactment and any reference in this Order to any enactment shall be construed as a reference to that enactment as amended, applied, consolidated, re-enacted by or as having effect by virtue of any subsequent enactment;

"goods" means goods or burden of any description and includes postal packets of any description;

"loading" means the loading or unloading of goods to or from a vehicle;

"motor car" has the same meaning as in Section 136 of the Act of 1984;

"motor cycle" has the same meaning as in Section 136 of the Act of 1984;

"owner", in relation to a vehicle means the person who is named in the vehicle registration document as the registered keeper of a goods or passenger vehicle or the person who has the use of such a vehicle and who is entitled to use such a

vehicle as though he/she were the registered keeper thereof;

"parking bay" means any area of a parking place which is provided for the leaving of a vehicle and indicated by surface markings, barriers, posts or similar in the parking place;

"parking place" means any area of land or building specified by name in Column 1 of Schedule 1 provided by the Council under Section 32(1) of the Act of 1984 for use as a parking place;

"parking ticket" means a ticket issued by a pay and display ticket machine pursuant to this Order;

"pay and display" in relation to a parking place means a parking place where the driver makes payment by the insertion of an appropriate sum of coins into a ticket machine whereby a parking ticket is issued which must be exhibited on the vehicle;

"pay on exit" in relation to a parking place means a parking place where the driver makes payment by the insertion of an appropriate sum of coins into a exit machine of the amount due for parking;

"PCSO" means a Police Community Support Officer as designated by the Chief Police Officer;

"penalty charge" and *"reduced penalty charge"* means a charge set by the Council under Section 77 of Part 6 and Schedule 9 of the 2004 Act, which is to be paid to the Council following the issue of a penalty charge notice (PCN) and within 28 days beginning with the date of issue of the notice, or 14 days in the case of a reduced penalty charge;

"penalty charge notice" means a notice issued by or served by a Civil Enforcement Officer pursuant to the provisions of 'The Civil Enforcement of Parking Contraventions (England) General Regulations 2007;

"permit" means a card issued by the Council for use in the Market Street Service Yard Car Park to be used and displayed strictly upon the terms and conditions of issue of the permit;

"permit holder" means the individual, firm or company to whom a permit has been issued;

"relevant position" means exhibited on the dashboard or fascia of the motor vehicle in a conspicuous position in or on the motor vehicle so that the front is clearly visible and legible from the outside of the motor vehicle;

"season ticket" means a card issued by the Council annually or quarterly for use in the car parks stated in Schedule 2 and shall be used and displayed strictly upon the terms and conditions of issue; and

"ticket machine" means an apparatus designed to indicate the time by a clock and to issue parking tickets to show that a payment has been made of an amount or for a period specified thereon and which specify the date and either the time of such payment or the time at which the vehicle must leave the parking place;

3. Except where otherwise stated, any reference in this Order to a numbered Article or Schedule is a reference to the Article or Schedule bearing that number in this Order;
4. The Interpretation Act 1978 shall apply for the interpretation of this Order as it applies for the interpretation of an Act of Parliament.

PART II

USE OF PARKING PLACES

Designation

5. Each parking place specified in Column 1 of Schedule 1 may be used, subject to the following provisions of this Order, as a parking place for such classes of

vehicles, in such positions, on such days and during such hours and on payment of such charges as are specified in relation to that parking place in the Schedule.

6. Where in Schedule 1 a parking place is described as available for vehicles of a specified class or that vehicles must be parked in a specified position, the driver of a vehicle shall not permit it to wait in that parking place unless it is of the class and in the position specified.
7. The Council will not be liable for any loss or damage to a vehicle or its contents while in a parking place.

Maximum Waiting Period

8. Except with the express written consent of an authorised officer of the Council, the driver of a vehicle shall not park the vehicle in the parking place for longer than the maximum period permitted for waiting specified in Column 7 of Schedule 1 to this Order in relation to that parking place.

Parking in Correct Position

9.
 - a) With the exception of the parking place specified in Schedule 1 as item 26, the driver of a vehicle using a parking place shall not leave the vehicle in any position in the parking place except in such position as to be wholly within a parking bay which may be indicated by white lines or other similar indication. The vehicle shall not obstruct the access road over the parking place, and if positions are provided in the parking place for specified classes of vehicle shall neither leave any vehicle of such specified class in any other position, nor leave any vehicle in a position provided for any other class of vehicle.
 - b) In the case of the parking place specified in Schedule 1 as item 26, the driver of a vehicle shall not leave the vehicle in any position within the parking place that obstructs the access roads over the parking place or that obstructs the passage of another parked vehicle. If positions are provided in the parking place for specified classes of vehicle the driver shall neither leave any vehicle of such

specified class in any other position, nor leave any vehicle in a position provided for any other class of vehicle.

- c) With the exception of the parking place specified in Schedule 1 as item 27, this article shall not operate so as to preclude any vehicle displaying a disabled persons badge from being parked in any parking space provided for private motor vehicles generally.

Disabled Person's Parking Spaces

10. Where, within a parking place, there is a sign and/or surface marking which indicates that a parking space is available only for a disabled person's vehicle, no person shall cause or permit a vehicle to wait in that parking space unless it is a disabled person's vehicle displaying in a relevant position a disabled person's badge.

Entering, Exiting and Speed in Parking Places

11. Where, within a parking place signs are erected or surface markings are laid for the purpose of:-

- (a) indicating the entrance to, exit from the parking place, or maximum vehicle speeds,
- (b) indicating that a vehicle using the parking place shall proceed in a specified direction within the parking place,

no person shall drive or cause or permit to be driven any vehicle,

- (i) so that it enters the parking place otherwise than by an entrance, or leaves the parking place otherwise than by an exit, so indicated, or
- (ii) in a direction other than that specified, or
- (iii) so that it exceeds the indicated maximum vehicle speed.

Double Yellow Lines

12. Where within the boundaries of a parking place there are double yellow lines, no person shall cause or permit any vehicle to be parked on such yellow lines.

Loading Areas

13. Where within the boundaries of a parking place signs are erected or surface markings are laid for the purpose of indicating an area reserved for loading, no person shall cause or permit any vehicle to be parked in such an area unless actively undertaking loading and unloading.

Requirement for Excise Duty Licence and Insurance

14. The driver of a vehicle subject to Excise Duty by virtue of Section 1 of the Vehicle Excise and Registration Act 1994 when used or kept on public roads shall not permit such vehicle to wait in a parking place unless the necessary licence for using or keeping the vehicle on public roads has been taken out and is visibly displayed on such vehicle and unless there is in relation to the use of the vehicle by the driver such policy of insurance as complies with the requirements of the Road Traffic Act 1988.

Stopping of Engines

15. The driver of a motor vehicle using a parking place shall stop the engine as soon as the vehicle is in position in the parking place, and shall not start the engine except when about to change the position of the vehicle in or to depart from the parking place.

Sounding of Horns

16. The driver of a vehicle using a parking place shall not sound any horn or other similar instrument except when about to change the position of the vehicle in or to depart from the parking place.

Prohibited Activities

17. No person shall, except with the permission authorised officer, drive or permit to be driven any vehicle in a parking place for any purpose other than the purpose of leaving that vehicle in the parking place in accordance with the provisions of this Order or for the purpose of departing from the parking place.
18. No person shall, without the written consent of the Council, use a vehicle while it is in a parking place in connection with the sale of any article to persons in or near the parking place or in connection with the selling or offering for hire of his skill or services.
19. No person shall in a parking place, without the written consent of the Council, which may be given on such terms and conditions as it thinks fit;
- (a) sell or offer for sale anything whatsoever;
 - (b) make any collection of money or articles for charitable or other purposes;
 - (c) advertise or publish by any means any event, display, entertainment, sale, business, shop, organisation, collection or other activity; or
 - (d) erect or cause or permit to be erected any tent, booth, stand, building or other structure.
20. No person shall in a parking place;

- (a) wantonly shout or otherwise make any loud noise to the disturbance or annoyance of users of the parking place or residents of premises in the neighbourhood;
- (b) play any ball game or game using a ball;
- (c) ride any bicycle, moped, scooter or motorcycle unless proceeding directly to or from an area designated or otherwise permitted to be used for the parking of these vehicles;
- (d) use any roller skates or blades, scooters, skate boards;
- (e) remain in the parking place after being told to leave by an authorised officer, Police Officer in uniform or PCSO in uniform;
- (f) use any threatening, abusive or insulting language, gesture or conduct with intent to put any person in fear or so as to occasion a breach of the peace or whereby a breach of the peace is likely to be occasioned;
- (g) without the consent of an authorised officer, leave or cause to be left unattended, other than in a designated trolley park, any shopping or supermarket trolley
- (h) light or cause or permit to be lit any fire, stove or cooker.

21. No person shall, without the written consent of the Council, use any part of a parking place or any vehicle left in a parking place-

- (a) for sleeping or camping or washing purposes; or
- (b) for eating or cooking; or

- (c) for the purpose of servicing or washing any vehicle or part thereof other than is reasonably necessary to enable that vehicle to depart from the parking place;

Careless or Dangerous Driving

22. No person shall drive a motor vehicle in a parking place in such manner as would give rise to an offence of careless or dangerous driving in terms of Sections 2 and 3 of the Road Traffic Act 1988 if the offending driving had taken place on a road or in any manner such as to cause concern, nuisance or damage to other users of the parking place and/or their vehicles.

Reasons to be in a Parking Place

23. No person shall come onto, be in or upon any parking place or annex, office, store, stairway, liftwell, or other associated structure thereof on foot or cycle for any purpose other than the removal of any vehicle properly parked in the parking place in accordance with the provisions of this Order or for the deposit or removal of goods therein.

Complying with directions or instructions

24. No person shall refuse or fail to comply with a direction or instruction in terms of this Order given to them by an authorised officer or by a Police Officer.

Means of Passage

25. Except with the written consent of the Council no person shall use a parking place as a means of passage on foot or by vehicle.

Mobile Homes etc

26. Mobile homes and caravans are specifically excluded from entry to the parking places included in this Order.

Charges at Parking Places

27. The charge for an authorised vehicle parking in a parking place during the charging hours subject as hereinafter provided shall be that specified in Column 8 of Schedule 1 to this Order.

PART III

PAY AND DISPLAY & PAY BY PHONE

Method of Payment of Charge

28. The charge referred to in Column 8 of Schedule 1 shall be payable by:
- (a) the insertion of current coins of the appropriate denomination into the ticket machine, and the driver of a vehicle shall, prior to leaving the vehicle in the parking place, display any ticket issued on payment of the charge in a relevant position in the vehicle and shall cause the said ticket to be exhibited in that position at all times while the vehicle is parked in the parking place.
 - (b) the use of a credit/debit payment card in the ticket machine, and the driver of a vehicle shall, prior to leaving the vehicle in the parking place, display any ticket issued on payment of the charge in a relevant position in the vehicle and shall cause the said ticket to be exhibited in that position at all times while the vehicle is parked in the parking place.
 - (c) By telephoning the number displayed in the relevant car park, quoting the displayed code for the relevant car park and paying the required charge by credit/debit card. All relevant details required by the driver of the vehicle to be able to pay the charge will be clearly displayed in the relevant car parks.

Defective Apparatus

29. Where any ticket machine is defective it shall be the responsibility of the driver of a vehicle to obtain a ticket of the appropriate kind from an alternative parking apparatus within the parking place. Where all the ticket machines in that parking

place carry notices on them by the Council indicating that they are out of order, the driver of that vehicle shall be exempt from purchasing a parking ticket during the charging hours for up to the maximum period of stay in the parking place.

Unexpired Parking Ticket

30. A driver of a motor vehicle who has purchased a ticket and who leaves the parking place with his motor vehicle before the period of waiting has expired, shall not pass his ticket to the driver of any other motor vehicle or to any other person and the other driver or person shall not accept the ticket in order to take benefit of any unexpired period of parking to which the original purchaser of the ticket is entitled.

Disabled Person's Badge Holders

31. A vehicle which displays in the relevant position a disabled person's badge shall be exempt from the pay and display charge referred to in Column 8 of Schedule 1 to this Order.

Purchase of additional ticket

32. Notwithstanding that a vehicle has displayed a ticket for less than the maximum time permitted for the parking place, as indicated by the parking place notice, a further parking ticket may not be displayed on that vehicle until the vehicle has left the parking place and returned after the expiry of two hours.

Season Ticket Holders

33. The driver of a vehicle using any of the parking places referred to in Column 1 of Schedule 3 of this Order shall be exempt from the provisions of Articles 28 of this Order provided that a valid season ticket issued by the Council in respect of the parking place is placed in a relevant position on the vehicle and shall cause the said ticket to be exhibited in that position at all times while the vehicle is parked in the parking place.

Replacement Season Ticket

34. If a season ticket is mutilated, defaced, illegible, lost or destroyed the season ticket may apply to the Council for a replacement season ticket. The fee for a replacement season ticket for use at the parking places referred to in Column 1 of Schedule 2 to this Order shall be that referred to in Column 4 of the said Schedule.

PART IV

PAY ON FOOT SYSTEM

Method of Payment of Charge

35. The following provisions shall govern the method of payment of the charge by drivers who are not season ticket holders in a parking place:
- (a) The driver of an authorised vehicle who intends to park the said vehicle in a parking place shall stop at the rising arm barrier at the entrance to the parking place.
 - (b) The driver shall then take, from the entry machine; the chip coin (hereinafter called "the entry coin") tendered to the driver by the said machine and shall retain the entry coin.
 - (c) The driver shall immediately upon the raising of the rising arm barrier drive the said vehicle to a parking bay.
 - (d) When the driver intends to remove his vehicle from the parking place he/she shall insert the entry coin into the payment machine provided.
 - (e) Upon the entry coin acceptance and the payment machine indicating the charge to be paid the driver shall pay the charge so indicated by inserting the appropriate monies into the said machine.

- (f) When at the exit of the parking place the entry coin shall be placed in the exit machine. When the barrier is raised or lowered the driver shall immediately drive his vehicle from the parking place.
- (g) In the event of a driver of an authorised vehicle being unable to produce the entry coin through loss or any other cause whatsoever or being responsible for damage to the entry coin, he/she shall be liable to pay the lost coin charge specified in Column 8 of Schedule 1 hereto.

Issue of Season Ticket

- 36. The Council may on the application of the owner of an authorised vehicle issue a season ticket to the said owner. The fee for a season ticket for use at the parking places referred to in Column 1 of Schedule 2 to this Order shall be that referred to in Column 2 of the said Schedule.

Season Ticket Holders

- 37. The driver of a vehicle using any of the parking places referred to in Column 1 of Schedule 2 of this Order shall be exempt from the provisions of Articles 27 and 35 of this Order provided that a valid season ticket issued by the Council in respect of the parking place is used on entry and exit to the car park.

Use of Season Ticket

- 38. The season ticket shall be used strictly in accordance with the terms and conditions of issue including date, time and location.
- 39. The following provisions shall govern the use of a parking place by the driver of a vehicle who is entitled to use a season ticket in accordance with Articles 36, 37 and 38 hereof:

- (a) The driver of an authorised vehicle who intends to park the vehicle in the parking place shall stop the vehicle at the rising arm barrier at the entrance to the parking place.
- (b) The entry machine will recognise the registration number plate of the season ticket holders vehicle and the rising arm barrier will be raised.
- (c) When the rising arm barrier is raised the driver shall immediately drive the vehicle to a parking bay.
- (d) When the driver intends to remove the vehicle from the parking place, he/she shall drive the vehicle to and stop at the exit barrier at the exit from the parking place.
- (e) The exit machine will recognise the registration number plate of the season ticket holders vehicle and the exit barrier will be raised or lowered.
- (f) Upon the raising or lowering of the exit barrier the driver shall immediately drive the vehicle from the parking place.
- (g) In the event of a driver of an authorised vehicle being unable to produce the season ticket through loss or any other cause whatsoever he/she shall be liable to pay the lost ticket charge specified in Column 8 of Schedule 1 hereto.

Replacement Season Ticket

40. If a season ticket or permit is mutilated, defaced, illegible, lost or destroyed the season ticket or permit holder may apply to the Council for a replacement season ticket. The fee for a replacement season ticket for use at the parking places referred to in Column 1 of Schedule 2 to this Order shall be that referred to in Column 4 of the said Schedule.

PART V
PERMIT PARKING

41. The Council may, on the application of the owner of an authorised vehicle, issue a permit for use in the Market Street Service Yard Car Park (Schedule 1, item 27) to the said owner.
42. The permit will be valid for a period of twelve months and shall be used strictly in accordance with the terms and conditions of issue.
43. Each permit will display the valid from date, expiry date and the parking bay number for which the permit is valid. All vehicles displaying a valid permit shall be parked wholly within a marked bay which has a surface marking with the corresponding parking bay number.
44. The permits referred to in this Order shall be exhibited on the vehicle in the relevant position at all times during which the vehicle is left in the parking place.
45. If a permit is mutilated or accidentally defaced or the figures or particulars thereon have become illegible the permit shall become invalid and the Permit Holder shall be required to surrender it to the Council and apply for the issue to him of a duplicate Permit.
46. If a Permit is lost or destroyed, the Permit Holder may apply to the Council for the issue to him of a duplicate Permit and the Council, upon being satisfied as to such loss or destruction, shall issue a duplicate Permit and upon such issue the Permit that has been replaced shall become invalid.
47. Permits may not be copied under any circumstances. If the Council has reason to believe that a permit has been copied or falsified then the Council may at its absolute discretion by serving notice in writing on the permit holder at the address provided by that person on their application for the permit, or at any other address believed to be that persons place of abode, withdraw the permit and the permit

holder shall surrender the permit to the Council within 48 hours of the receipt of the aforementioned notice.

PART V

SUSPENSION OF PARKING PLACE

Power to suspend parking places

48. Nothing in this Order shall prevent the Council by notice, sign or barrier displayed in the parking place;
- (a) from suspending the parking place or any part thereof for any period; and/or
 - (b) from setting aside the parking place or any part or parts thereof on all days or on certain days or during certain parts of days for use only by particular vehicles or organisations.

Signing of suspension

49. Any person authorised by the Council in that respect who suspends the use of a parking place or any part thereof in accordance with the provisions of Article 48 shall thereupon place or cause to be placed in or adjacent to that parking place or that part thereof a notice or traffic sign indicating that the use of that parking place or part thereof is suspended and that waiting by vehicles is prohibited.

Parking in suspended bays

50. No person shall cause or permit a vehicle to be left in a parking place or any part thereof during such periods that the use of that parking place or any part thereof is suspended or during such period as there is in or adjacent thereto a notice or traffic sign placed by or on behalf of the Council in pursuance of Articles 48 and 49. Provided that a vehicle may be left with the express written consent of the Council in a parking place or part thereof which has been set aside for use by particular vehicles or organisations.

PART VI
CONTRAVENTION OF ORDER

51. If a vehicle is parked in a parking place in contravention of the provisions of, or without complying with, any Article of this Order a Penalty Charge shall be payable.
52. If a vehicle is left in a parking place during the charging hours for longer than the initial period for which payment was made, a Penalty Charge shall be payable.
53. If a vehicle is left in a parking place for which no payment has been made a Penalty Charge shall be payable.
54. If a vehicle is left in a parking place in contravention of or without complying with the requirements of this Order, a contravention shall have occurred and a penalty charge shall be payable for each day of the contravention. A penalty charge notice showing the information required by the 2004 Act may then be issued by a civil enforcement officer in accordance with the requirements of the 2004 Act or any subsequent applicable legislation.

Penalty Charge Notice

55. In the case of a Vehicle in respect of which the penalty charge may have been incurred, it shall be the duty of a civil enforcement officer to either hand the Penalty Charge Notice to the driver of the vehicle, post the Penalty Charge Notice to the Owner of the vehicle or attach the Penalty Charge Notice to the vehicle in a conspicuous position. The notice shall include the following particulars:
 - (a) the registration mark of the vehicle or, where the vehicle is being used under a trade licence, the number of the trade plate carried by the vehicle;
 - (b) the grounds on which the Civil Enforcement Officer believes that a Penalty Charge is payable in respect of that vehicle;
 - (c) the amount of Penalty Charge required to be paid;
 - (d) the date the contravention occurred;

- (e) the date of issue of the Penalty Charge Notice;
- (f) that if the Penalty Charge is paid before the end of the period of 14 days beginning with the date of the notice, the amount of the Penalty Charge will be reduced by the specified proportion or amount;
- (g) that if the Penalty Charge is not paid before the end of the 28 day period a Notice to Owner may be served by the Council on the person appearing to be the owner of the vehicle; and
- (h) the address to which payment of the Penalty Charge must be sent.

Manner of payment of Penalty Charge

56. The Penalty Charge shall be paid to the Council within 28 days of the issue of the Penalty Charge Notice either;
- (a) by cheque, bankers' draft, money order or postal order delivered or sent by post as indicated on the Penalty Charge Notice, or
 - (b) by cheque, postal order, in cash by credit card or debit card in person at any Bracknell Forest Borough Council office which accepts such payments, or
 - (c) by credit card or debit card over the phone using the number specified on the Penalty Charge Notice, or
 - (d) by internet using the Bracknell Forest Borough Council web site:
- Provided that, if the said twenty eighth day falls upon a day on which the said Department or office is closed, the period within which payment of the said charge shall be made to the Council shall be extended until 4.30pm on the next full day on which the said Department is open.
57. If the Penalty Charge is paid before the end of the period of 14 days beginning with the date of the notice, the amount of the Penalty Charge will be reduced by the specified proportion.
58. If the owner fails to pay the Penalty Charge by the end of the 28 day period, a Notice to Owner may be served; and if the charge is not paid within a further 28 days it may be increased by 50% on the issue of a Charge Certificate in accordance with the provisions of the 2004 Act.

59. Continuing failure to pay the Penalty Charge may result in a judgement in the County Court against the owner to enable the Council to recover the payments due.

Indications as Evidence

60. The particulars given in the Penalty Charge Notice in accordance with Article 55 shall be treated as evidence in any proceedings relating to failure to pay such Penalty Charge.

Restriction on removal of notices

61. Where a Penalty Charge Notice has been issued in accordance with the provisions of Article 55 of this Order, no person, not being the driver of the vehicle, a Civil Enforcement Officer in uniform, Police Officer in uniform or PCSO in uniform or some other person duly authorised by the Council, shall remove the notice from the vehicle unless authorised to do so by the driver.

PART VII REVOCATIONS

Revocations

62. The Bracknell Forest Borough Council (Off-Street Parking Places) (Consolidation No. 1) Order 2013 is hereby revoked in its entirety.
63. All subsequent amendments and variations to the above Order are hereby revoked.

THE COMMON SEAL of BRACKNELL

FOREST BOROUGH COUNCIL was

hereunto affixed on the 15th day of

MAY 2015 in the presence of :

S. M. H.

.....
BOROUGH SOLICITOR

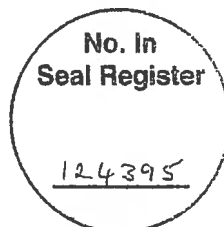

SCHEDULE 1

Name of Parking Place	Position in which a vehicle may wait	Class of Vehicle	Days of Operation of Parking Place	Hours of Operation of Parking Place	Charging Hours	Maximum period which Vehicle may wait	Maximum Scale of Charges
1. High Street Multi-storey Car Park, Bracknell (As shown edged black on Plan 1.)	2 Wholly within a parking bay save that motor-cycles shall be parked in that area on the ground floor specifically set aside for the parking of motor-cycles and in no other place whatsoever.	3 (i) Motor cars within the provisions of Section 136(2) (a) of the Act of 1984. (ii) Motor-cycles as defined in Section 136(4) of the Act of 1984. (iii) Motor vehicles, constructed or adapted for the conveyance of goods or burdens, which do not exceed 1.5 tonnes unladen weight or 2 metres in height.	4 All days	5 All hours	6 7 Days per week, 24 Hours per day	7 Not applicable	8 "Pay on Foot" daily charges during the charging hours. <u>Monday to Saturday 6.00am to 8:00pm</u> (i) 0 to 1 hours - £1.10 (ii) 1 to 2 hours - £1.60 (iii) 2 to 3 hours - £2.10 (iv) 3 to 4 hours - £2.60 (v) 4 to 5 hours - £3.70 (vi) 5 to 6 hours - £4.50 (vii) Over 6 hours - £6.00 (viii) Lost ticket - £10.00 <u>Sunday and Overnight Charges</u> (i) Nightly charge 8.00pm to 6.00am (Monday to Sunday) - £1.10 (ii) Sunday 6:00am to 8:00pm - £1.20 Visitors Passes - £7.50
2. Charles Square Multi-storey Car Park, Bracknell (As shown edged black on Plan 2.)	Wholly within a parking bay save that motor-cycles shall be parked in that area on the ground floor specifically set aside for the parking of motor-cycles and in no other place whatsoever.	(i) Motor cars within the provisions of Section 136(2) (a) of the Act of 1984. (ii) Motor-cycles as defined in Section 136(4) of the Act of 1984. (iii) Motor vehicles, constructed or adapted for the conveyance of goods or burdens, which do not exceed 1.5 tonnes unladen weight or 2.2 metres in height.	All days	All hours.	7 Days per week, 24 Hours per day	Not applicable	"Pay on Foot" daily charges during the charging hours. <u>Monday to Saturday 6.00am to 8:00pm</u> (i) 0 to 1 hours - £1.10 (ii) 1 to 2 hours - £1.60 (iii) 2 to 3 hours - £2.10 (iv) 3 to 4 hours - £2.60 (v) 4 to 5 hours - £3.70 (vi) 5 to 6 hours - £4.50 (vii) Over 6 hours - £6.00 (viii) Lost ticket - £10.00

SCHEDULE 1

Name of Parking Place	Position in which a vehicle may wait	Class of Vehicle	Days of Operation of Parking Place	Hours of Operation of Parking Place	Charging Hours	Maximum period which Vehicle may wait	Maximum Scale of Charges
1	2	3	4	5	6	7	8
5. Access Road to Service Yard D, Bracknell (As shown edged black on Plan 5.)	Wholly within a parking bay.	(i) Motor cars within the provisions of Section 136(2) (a) of the Act of 1984. (ii) Motor vehicles, constructed or adapted for the conveyance of goods or burdens, which do not exceed 1.5 tonnes unladen weight or 2.0 metres in height.	Monday to Saturday inclusive	All hours	Saturday and Sunday Sunday (6:00am to 8:00pm)	Not applicable	£1.10 Sunday (6:00am to 8:00pm) - £1.20
6. Heath Hill Road, Crowthorne. (As shown edged black on Plan 6.)	Wholly within a parking bay.	(i) Motor cars within the provisions of Section 136(2) (a) of the Act of 1984. (ii) Motor-cycles as defined in Section 136(4) of the Act of 1984. (iii) Motor vehicles, constructed or adapted for the conveyance of goods or burdens, which do not exceed 1.5 tonnes unladen weight.	All days	All hours	Not Applicable	2 hours with return prohibited within 2 hours between the hours of 08:00am and 18:00pm Mondays to Saturdays inclusive.	"Pay and Display or Pay by Phone" charges during the charging hours: Monday to Saturday 7.00am to 8.00pm (i) 0 to 40 minutes -- 80p Monday to Sunday (8:00pm to 6:00am) - £1.20 Sunday (6:00am to 8:00pm) - £1.20
7. Napier Road, Crowthorne. (As shown edged black on Plan 7.)	Wholly within a parking bay.	(i) Motor cars within the provisions of Section 136(2) (a) of the Act of 1984. (ii) Motor-cycles as defined in Section 136(4) of the Act of 1984. (iii) Motor vehicles, constructed or adapted for the conveyance of goods or burdens, which do not exceed 1.5 tonnes	All days	All hours	Not Applicable	2 hours with return prohibited within 2 hours between the hours of 08:00am and 18:00pm Mondays to	Not Applicable

SCHEDULE 1

Name of Parking Place	Position in which a vehicle may wait	Class of Vehicle	Days of Operation of Parking Place	Hours of Operation of Parking Place	Charging Hours	Maximum period which Vehicle may wait	Maximum Scale of Charges
1	2	3	4	5	6	7	8
3. Albert Road Car Park, Bracknell (As shown edged black on Plan 3.)	Wholly within a parking bay.	(i) Motor cars within the provisions of Section 136(2) (a) of the Act of 1984. (ii) Motor-cycles as defined in Section 136(4) of the Act of 1984. (iii) Motor vehicles, constructed or adapted for the conveyance of goods or burdens, which do not exceed 1.5 tonnes unladen weight or 2.0 metres in height.	All days	All hours	Between 07:00am and 20:00pm Monday to Saturday. Sunday (7:00am to 8:00pm)	Not applicable	<p>"Pay and Display or Pay by Phone" charges during the charging hours:</p> <p><u>Monday to Saturday 7.00am to 8.00pm</u></p> <p>(i) 0 to 2 hours - £1.10 (ii) 2 to 4 hours - £1.60 (iii) 4 to 6 hours - £2.10 (iv) 6 to 8 hours - £3.50 (v) Over 8 hours - £5.00</p> <p>Sunday (7:00am to 8:00pm) - £1.20</p>
4. Easthampstead House Car Park, Bracknell (As shown edged black on Plan 4.)	Wholly within a parking bay.	(i) Motor cars within the provisions of Section 136(2) (a) of the Act of 1984.	Saturday	All hours	Between 06:00am and 20:00pm Saturday. Between 4.00pm and 6.00am Monday to Friday Between 8:00pm and 6:00am	Not applicable	<p>"Pay and Display or Pay by Phone" charges during the charging hours:</p> <p><u>Saturday 6.00am to 20.00pm</u></p> <p>(i) 0 to 2 hours - £1.10 (ii) 2 to 4 hours - £1.60</p> <p>Monday to Friday (4.00pm to 6:00am) - £1.10</p> <p>Saturday and Sunday (8:00pm to 6:00am) -</p>

SCHEDULE 1

Name of Parking Place	Position in which a vehicle may wait	Class of Vehicle	Days of Operation of Parking Place	Hours of Operation of Parking Place	Charging Hours	Maximum period which Vehicle may wait	Maximum Scale of Charges
1	2	3 unladen weight.	4	5	6	7 Saturdays inclusive.	8
8. Wellington Business Park, Crowthorne. (As shown edged black on Plan 8.)	Wholly within a parking bay.	(i) Motor cars within the provisions of Section 136(2) (a) of the Act of 1984. (ii) Motor-cycles as defined in Section 136(4) of the Act of 1984. (iii) Motor vehicles, constructed or adapted for the conveyance of goods or burdens, which do not exceed 1.5 tonnes unladen weight.	All days	All hours	Not Applicable	2 hours with return prohibited within 2 hours between the hours of 08:00am and 18:00pm Mondays to Saturdays inclusive.	Not Applicable
9. New Road, Crowthorne. (As shown edged black on Plan 9.)	Wholly within a parking bay.	(i) Motor cars within the provisions of Section 136(2) (a) of the Act of 1984. (ii) Motor-cycles as defined in Section 136(4) of the Act of 1984. (iii) Motor vehicles, constructed or adapted for the conveyance of goods or burdens, which do not exceed 1.5 tonnes unladen weight.	All days	All hours	Not Applicable	2 hours with return prohibited within 2 hours between the hours of 08:00am and 18:00pm Mondays to Saturdays inclusive.	Not Applicable
10. The Broadway, Sandhurst (As shown edged black on Plan 10.)	Wholly within a parking bay.	(i) Motor cars within the provisions of Section 136(2) (a) of the Act of 1984. (ii) Motor-cycles as defined in Section 136(4) of the Act of 1984. (iii) Motor vehicles, constructed or adapted for the conveyance of goods or burdens, which do not exceed 1.5 tonnes unladen weight.	All days	All hours	Not Applicable	No Limit	Not Applicable
11 Birch Hill Shopping Centre, Bracknell (As shown edged black on Plan 11)	Wholly within a parking bay.	(i) Motor cars within the provisions of Section 136(2) (a) of the Act of 1984. (ii) Motor-cycles as defined in Section 136(4) of the Act of 1984. (iii) Motor vehicles, constructed or adapted for the conveyance of goods or burdens, which do not exceed 1.5 tonnes	All days	All hours	Not Applicable	2 hours with return prohibited within 2 hours between the hours of 08:00am and 18:00pm Mondays to	Not Applicable

SCHEDULE 1

Name of Parking Place	Position in which a vehicle may wait	Class of Vehicle	Days of Operation of Parking Place	Hours of Operation of Parking Place	Charging Hours	Maximum period which Vehicle may wait	Maximum Scale of Charges
1	2	3 unladen weight.	4	5	6	7 Saturdays inclusive.	8
12. Leppington, Birch Hill, Bracknell (As shown edged black on Plan 12.)	Wholly within a parking bay.	(i) Motor cars within the provisions of Section 136(2) (a) of the Act of 1984. (ii) Motor-cycles as defined in Section 136(4) of the Act of 1984. (iii) Motor vehicles, constructed or adapted for the conveyance of goods or burdens, which do not exceed 1.5 tonnes unladen weight.	All days	All hours	Not Applicable	No Limit	Not Applicable
13. Bywood, Hanworth, Bracknell (As shown edged black on Plan 13.)	Wholly within a parking bay.	(i) Motor cars within the provisions of Section 136(2) (a) of the Act of 1984. (ii) Motor-cycles as defined in Section 136(4) of the Act of 1984. (iii) Motor vehicles, constructed or adapted for the conveyance of goods or burdens, which do not exceed 1.5 tonnes unladen weight.	All days	All hours	Not Applicable	No Limit	Not Applicable
14. Great Hollands Shopping Centre, Bracknell (As shown edged black on Plan 14.)	Wholly within a parking bay.	(i) Motor cars within the provisions of Section 136(2) (a) of the Act of 1984. (ii) Motor-cycles as defined in Section 136(4) of the Act of 1984. (iii) Motor vehicles, constructed or adapted for the conveyance of goods or burdens, which do not exceed 1.5 tonnes unladen weight.	All days	All hours	Not Applicable	2 hours with return prohibited within 2 hours between the hours of 08:00am and 18:00pm Mondays to Saturdays inclusive.	Not Applicable
15. William Twigg Car Park, Great Hollands, Bracknell (As shown edged black on Plan 15.)	Wholly within a parking bay.	(i) Motor cars within the provisions of Section 136(2) (a) of the Act of 1984. (ii) Motor-cycles as defined in Section 136(4) of the Act of 1984. (iii) Motor vehicles, constructed or adapted for the conveyance of goods or burdens, which do not exceed 1.5 tonnes	All days	All hours	Not Applicable	No Limit	Not Applicable

SCHEDULE 1

Name of Parking Place	Position in which a vehicle may wait	Class of Vehicle	Days of Operation of Parking Place	Hours of Operation of Parking Place	Charging Hours	Maximum period which Vehicle may wait	Maximum Scale of Charges
1	2	3	4	5	6	7	8
		unladen weight.					
16. Crown Wood Shopping Centre, Bracknell (As shown edged black on Plan 16.)	Wholly within a parking bay.	(i) Motor cars within the provisions of Section 136(2) (a) of the Act of 1984. (ii) Motor-cycles as defined in Section 136(4) of the Act of 1984. (iii) Motor vehicles, constructed or adapted for the conveyance of goods or burdens, which do not exceed 1.5 tonnes unladen weight.	All days	All hours	Not Applicable	No Limit	Not Applicable
17. Wildridings Square Shopping Centre, Bracknell (As shown edged black on Plan 17.)	Wholly within a parking bay.	(i) Motor cars within the provisions of Section 136(2) (a) of the Act of 1984. (ii) Motor-cycles as defined in Section 136(4) of the Act of 1984. (iii) Motor vehicles, constructed or adapted for the conveyance of goods or burdens, which do not exceed 1.5 tonnes unladen weight.	All days	All hours	Not Applicable	No Limit	Not Applicable
18. Rectory Row, Bracknell (As shown edged black on Plan 18.)	Wholly within a parking bay.	(i) Motor cars within the provisions of Section 136(2) (a) of the Act of 1984. (ii) Motor-cycles as defined in Section 136(4) of the Act of 1984. (iii) Motor vehicles, constructed or adapted for the conveyance of goods or burdens, which do not exceed 1.5 tonnes unladen weight.	All days	All hours	Not Applicable	No Limit	Not Applicable
19. Junction of Bay Road / Bay Drive, Bracknell (As shown edged black on Plan 19.)	Wholly within a parking bay.	(i) Motor cars within the provisions of Section 136(2) (a) of the Act of 1984. (ii) Motor-cycles as defined in Section 136(4) of the Act of 1984. (iii) Motor vehicles, constructed or adapted for the conveyance of goods or burdens, which do not exceed 1.5 tonnes unladen weight.	All days	All hours	Not Applicable	No Limit	Not Applicable

SCHEDULE 1

Name of Parking Place	Position in which a vehicle may wait	Class of Vehicle	Days of Operation of Parking Place	Hours of Operation of Parking Place	Charging Hours	Maximum period which Vehicle may wait	Maximum Scale of Charges
1	2	3	4	5	6	7	8
20. Southern End of Bay Road, Bracknell (As shown edged black on Plan 20.)	Wholly within a parking bay.	unladen weight. (i) Motor cars within the provisions of Section 136(2) (a) of the Act of 1984. (ii) Motor-cycles as defined in Section 136(4) of the Act of 1984. (iii) Motor vehicles, constructed or adapted for the conveyance of goods or burdens, which do not exceed 1.5 tonnes unladen weight.	All days	All hours	Not Applicable	No Limit	Not Applicable
21. The Square, Harman's Water, Bracknell (As shown edged black on Plan 21.)	Wholly within a parking bay.	(i) Motor cars within the provisions of Section 136(2) (a) of the Act of 1984. (ii) Motor-cycles as defined in Section 136(4) of the Act of 1984. (iii) Motor vehicles, constructed or adapted for the conveyance of goods or burdens, which do not exceed 1.5 tonnes unladen weight.	All days	All hours	Not Applicable	No Limit	Not Applicable
22. Yeovil Road, Owlsmoor (As shown edged black on Plan 22.)	Wholly within a parking bay.	(i) Motor cars within the provisions of Section 136(2) (a) of the Act of 1984. (ii) Motor-cycles as defined in Section 136(4) of the Act of 1984. (iii) Motor vehicles, constructed or adapted for the conveyance of goods or burdens, which do not exceed 1.5 tonnes unladen weight.	All days	All hours	Not Applicable	2 hours with return prohibited within 2 hours between the hours of 08:00am and 18:00pm Mondays to Saturdays inclusive.	Not Applicable

SCHEDULE 1

Name of Parking Place	Position in which a vehicle may wait	Class of Vehicle	Days of Operation of Parking Place	Hours of Operation of Parking Place	Charging Hours	Maximum period which Vehicle may wait	Maximum Scale of Charges
1 23. Land adjacent to 1 Victoria Road, Owlsmoor (As shown edged black on Plan 23.)	2 Wholly within a parking bay.	3 (i) Motor cars within the provisions of Section 136(2) (a) of the Act of 1984. (ii) Motor-cycles as defined in Section 136(4) of the Act of 1984. (iii) Motor vehicles, constructed or adapted for the conveyance of goods or burdens, which do not exceed 1.5 tonnes unladen weight.	4 All days	5 All hours	6 Not Applicable	7 No Limit	8 Not Applicable
24. York Way, Sandhurst (As shown edged black on Plan 24)	Wholly within a parking bay.	(i) Motor cars within the provisions of Section 136(2) (a) of the Act of 1984. (ii) Motor-cycles as defined in Section 136(4) of the Act of 1984. (iii) Motor vehicles, constructed or adapted for the conveyance of goods or burdens, which do not exceed 1.5 tonnes unladen weight.	All days	All hours	Not Applicable	No Limit	Not Applicable
25. Coral Reef Car Park (As shown edged black on Plan 25)	Wholly within a parking bay.	All Motor Vehicles	All days	Monday to Friday – 7:00am to 10:30pm Saturday and Sunday – 8:00am to 9:00pm	Monday to Friday – 7:00am to 10:30pm Saturday and Sunday – 8:00am to 9:00pm	Monday to Friday – 7:00am to 10:30pm Saturday and Sunday – 8:00am to 9:00pm	Pay and Display or Pay by Phone charges during the charging hours: 0 to 5 hours - £3.00 All Day Charge - £5.00 No Charge for the first 10 minutes
26. The Look Out Discovery Centre Car Park (As shown edged black on Plan 26)	In a position within the parking place so not to obstruct the access roads or to obstruct another parked vehicle.	All Motor Vehicles	All days	April to September 7:00am to 8:30pm. October to March 7:00am to 6:00pm.	April to September 7:00am to 8:30pm. October to March 7:00am to 6:00pm.	April to September 7:00am to 8:30pm. October to March 7:00am to 6:00pm.	Pay and Display or Pay by Phone charges during the charging hours: 0 to 4 hours - £2.00 All Day Charge - £4.00 No Charge for the first 10 minutes

SCHEDULE 1

Name of Parking Place	Position in which a vehicle may wait	Class of Vehicle	Days of Operation of Parking Place	Hours of Operation of Parking Place	Charging Hours	Maximum period which Vehicle may wait	Maximum Scale of Charges
<p>1</p> <p>27. Market Street Service Area. (As shown edged black on Plan 27)</p>	<p>2</p> <p>Wholly within a parking bay only where that vehicle is displaying a valid permit and where the permit number matches the surface marking in the parking bay.</p>	<p>3</p> <p>(i) Motor cars within the provisions of Section 136(2) (a) of the Act of 1984. (ii) Motor-cycles as defined in Section 136(4) of the Act of 1984. (iii) Motor vehicles, constructed or adapted for the conveyance of goods or burdens, which do not exceed 1.5 tonnes unladen weight.</p>	<p>4</p> <p>All days</p>	<p>5</p> <p>All hours</p>	<p>6</p> <p>Not Applicable</p>	<p>7</p> <p>No Limit</p>	<p>8</p> <p>Not Applicable</p>
<p>23. Netherton, Bracknell (As shown edged black on Plan 28.)</p>	<p>Wholly within a parking bay.</p>	<p>(i) Motor cars within the provisions of Section 136(2) (a) of the Act of 1984. (ii) Motor-cycles as defined in Section 136(4) of the Act of 1984. (iii) Motor vehicles, constructed or adapted for the conveyance of goods or burdens, which do not exceed 1.5 tonnes unladen weight.</p>	<p>All days</p>	<p>All hours</p>	<p>Not Applicable</p>	<p>No Limit</p>	<p>Not Applicable</p>

SCHEDULE 2 – SEASON TICKETS, PAY ON FOOT CAR PARKS

Name of Parking Place 1	Fee 2	Conditions of Use 3	Cost of Replacement Season Ticket 4
1. High Street Multi-storey Car Park, Bracknell (As shown edged black on Plan 1.)	Monday to Friday	Use strictly upon the terms and conditions of issue.	£35.00
	5 day annual (1-50 tickets) £800.00		
	5 day annual (51-100 tickets) £750.00		
	5 day annual (101+ tickets) £750.00		
	Monthly 7 day Access (non refundable) £90.00		
2. Charles Square Multi-storey Car Park, Bracknell (As shown edged black on Plan 2.)	Monday to Friday	Use strictly upon the terms and conditions of issue.	£35.00
	5 day annual (1-50 tickets) £800.00		
	5 day annual (51-100 tickets) £750.00		
	5 day annual (101+ tickets) £750.00		
	Monthly 7 day Access (non refundable) £90.00		

SCHEDULE 3 – SEASON TICKETS, PAY AND DISPLAY CAR PARKS

Name of Parking Place 1	Fee 2	Conditions of Use 3	Cost of Replacement Season Ticket 4
1. The Look Out Discovery Centre Car Park (As shown edged black on Plan 26.)	Residents of Bracknell Forest	Use strictly upon the terms and conditions of issue.	£35.00
	Annual £60.00		
	All others		
	Annual £100.00		

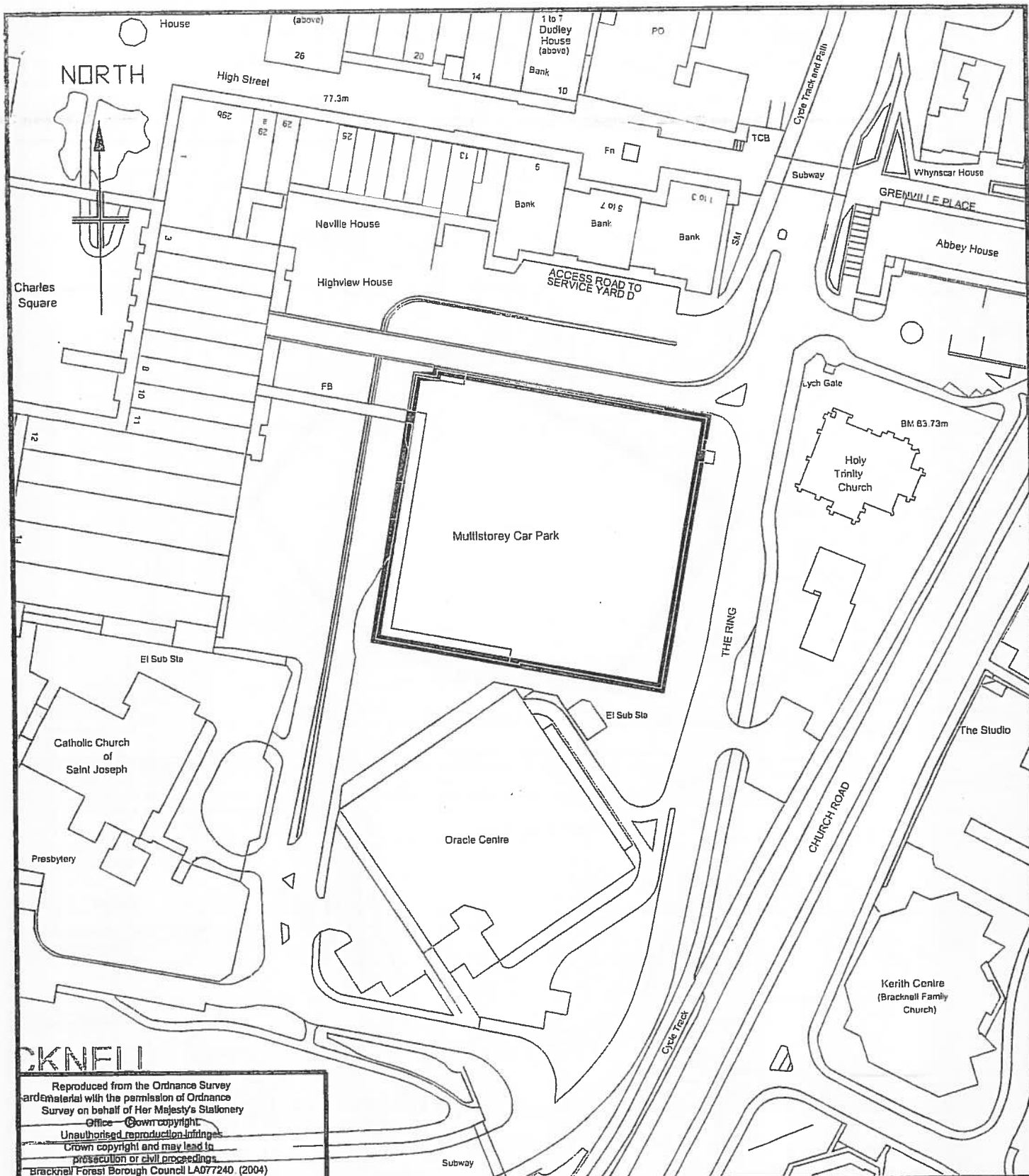

Reproduced from the Ordnance Survey
aerial material with the permission of Ordnance
Survey on behalf of Her Majesty's Stationery
Office. Crown copyright.
Unauthorised reproduction infringes
Crown copyright and may lead to
prosecution or civil proceedings.
Bracknell Forest Borough Council LA077240. (2004)



ENVIRONMENT
Traffic & Safety Group

Amendment	Date	Initials	Project title CONTROL OF OFF-STREET PARKING ORDER 2015		
			Drawing title CHARLES SQUARE MULTI-STOREY CAR PARK		
			Prepared by AMT	Checked by NM	
			Scale 1:1250	Date JAN. 2015	
			Project No.	Drawing Number PLAN 2	Amend Letter

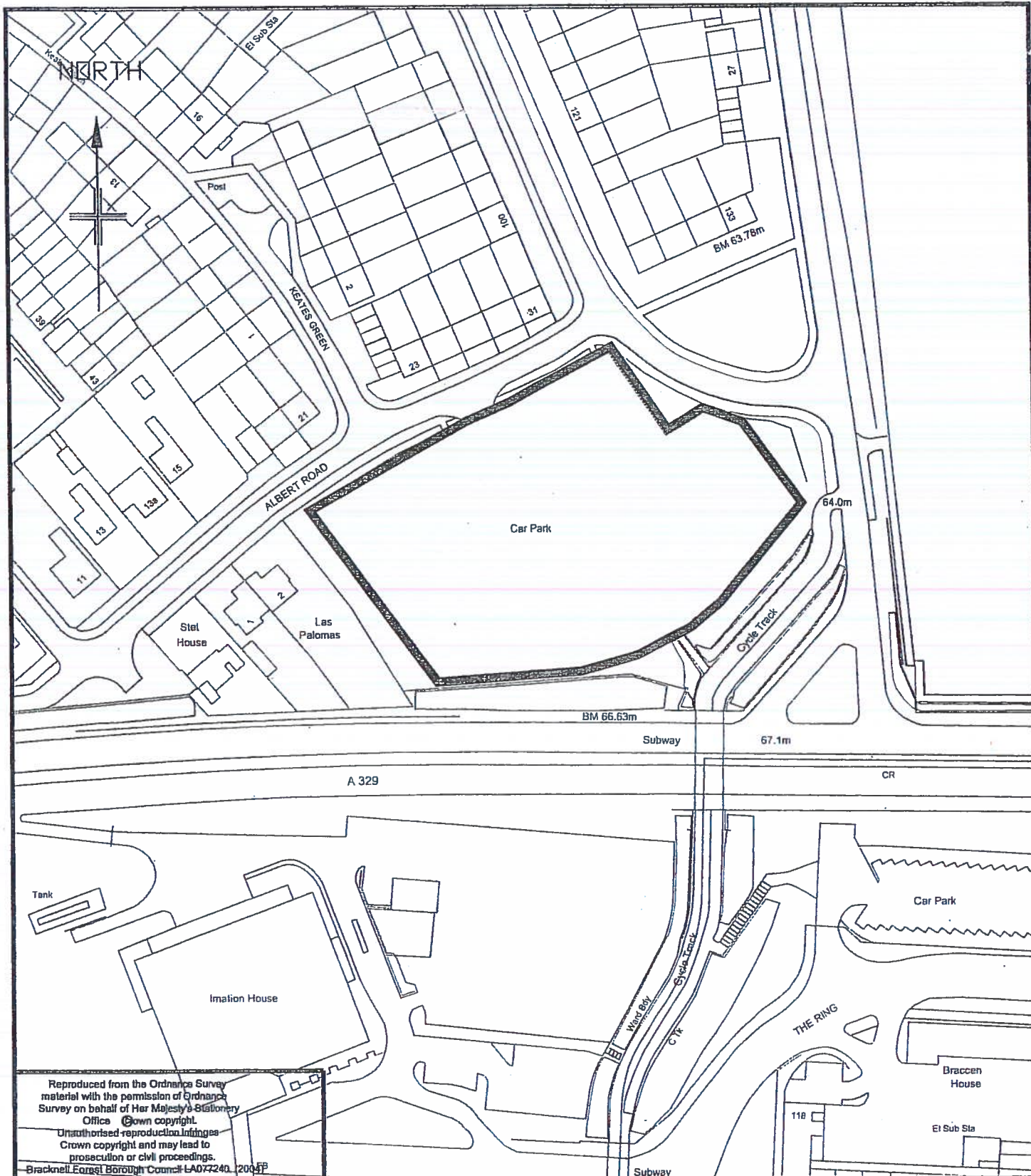

Reproduced from the Ordnance Survey material with the permission of Ordnance Survey on behalf of Her Majesty's Stationery Office. Crown copyright. Unauthorised reproduction infringes Crown copyright and may lead to prosecution or civil proceedings. Bracknell Forest Borough Council LA072240, 2004



BRACKNELL FOREST BOROUGH COUNCIL
ENVIRONMENT
Traffic & Safety Group

Amendment	Date	Initials	Project title CONTROL OF OFF-STREET PARKING ORDER 2015		
			Drawing title ALBERT ROAD CAR PARK		
			Prepared by AMT	Checked by NM	
			Scale 1:1250	Date JAN. 2015	
			Project No.	Drawing Number PLAN 3	Amend Letter

NORTH

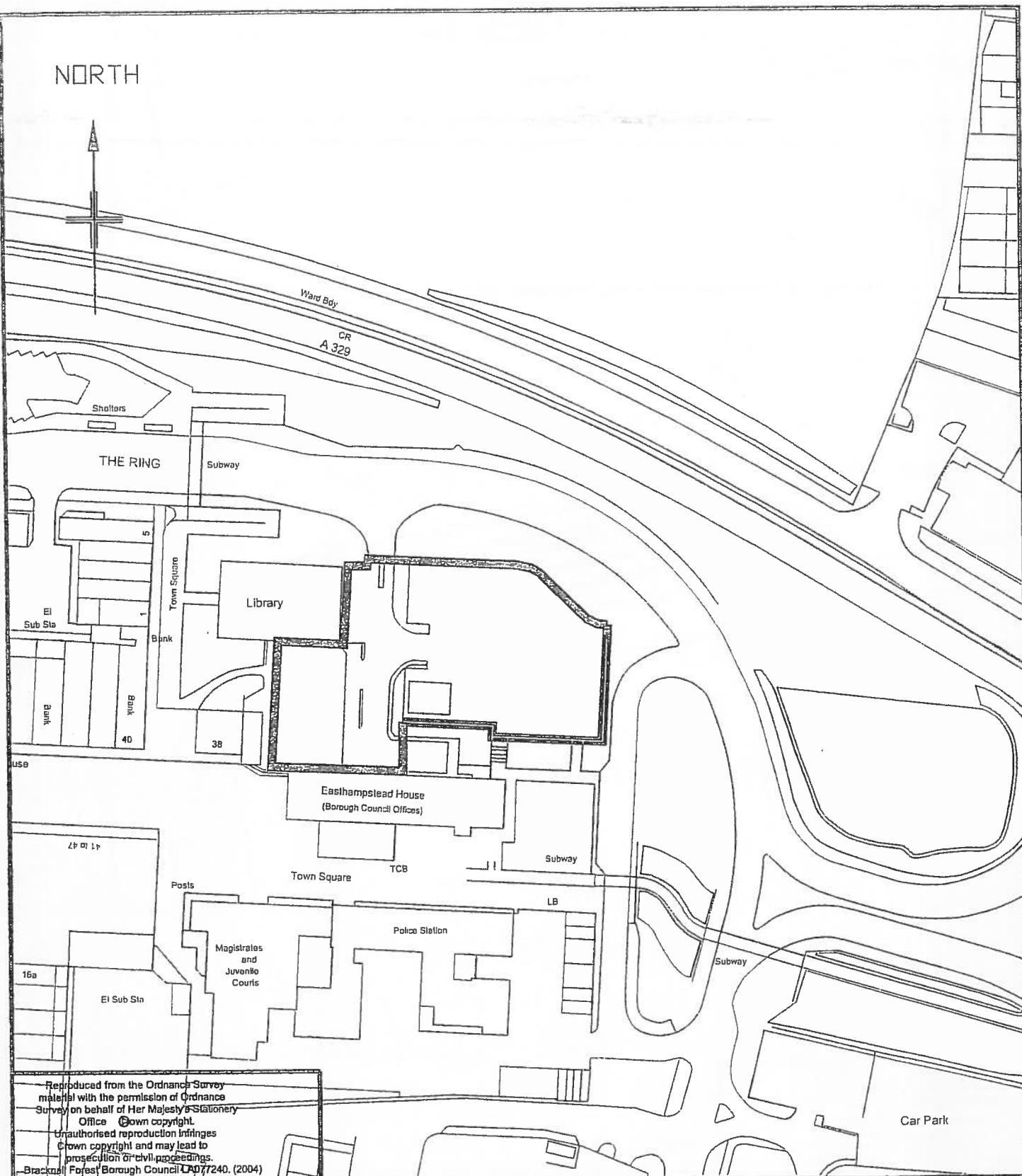

Reproduced from the Ordnance Survey material with the permission of Ordnance Survey on behalf of Her Majesty's Stationery Office. Crown copyright. Unauthorised reproduction infringes Crown copyright and may lead to prosecution or civil proceedings. Bracknell Forest Borough Council LA077240. (2004)



ENVIRONMENT
Traffic & Safety Group

Amendment	Date	Initials	Project title CONTROL OF OFF-STREET PARKING ORDER 2015		
			Drawing title EASTHAMPSTEAD HOUSE CAR PARK		
			Prepared by AMT	Checked by NM	
			Scale 1:1250	Date JAN. 2015	
			Project No.	Drawing Number PLAN 4	Amend Letter

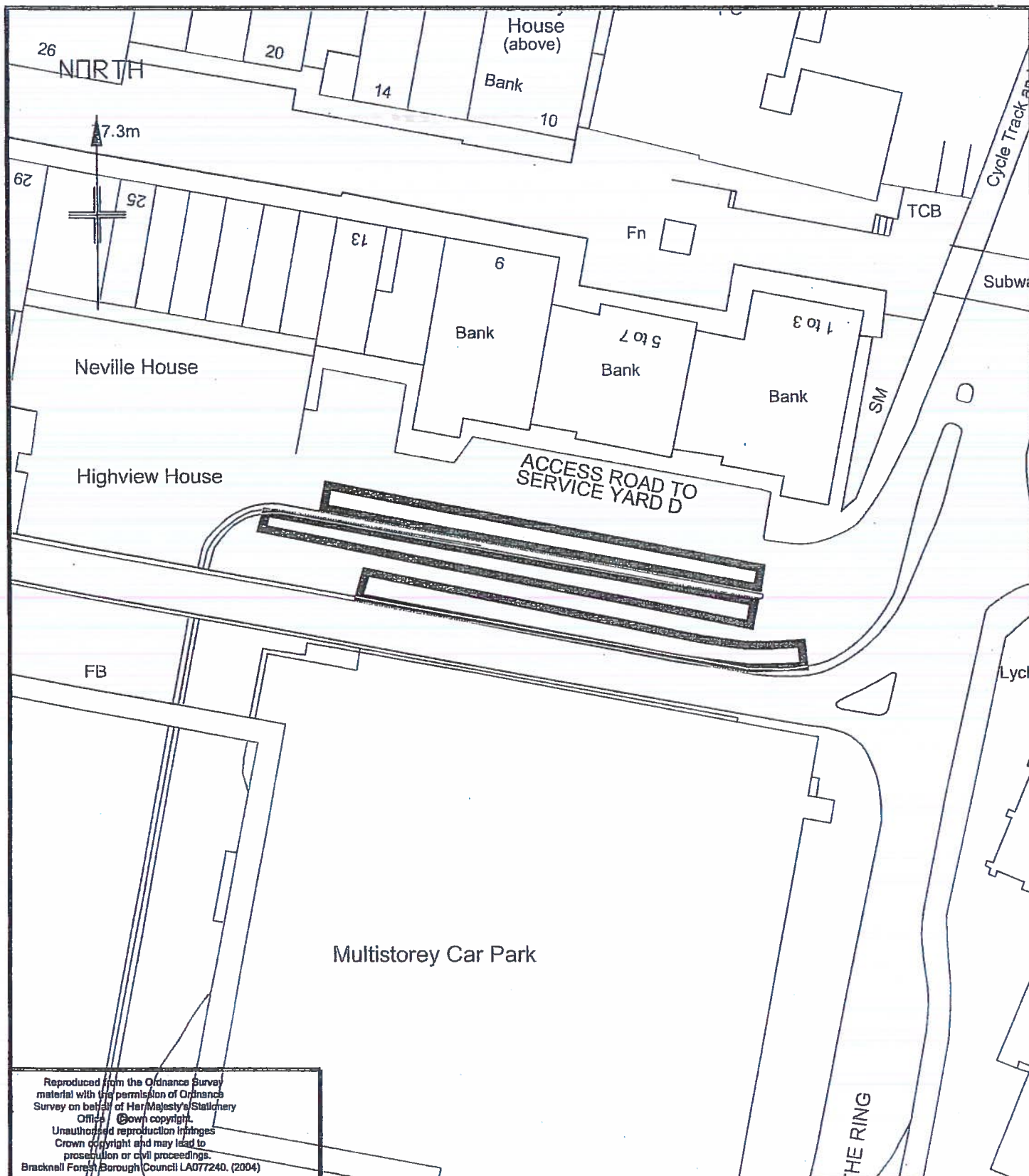

Reproduced from the Ordnance Survey material with the permission of Ordnance Survey on behalf of Her Majesty's Stationery Office. Crown copyright. Unauthorized reproduction infringes Crown copyright and may lead to prosecution or civil proceedings. Bracknell Forest Borough Council LA077240. (2004)



ENVIRONMENT
Traffic & Safety Group

Amendment	Date	Initials	Project title		
			CONTROL OF OFF-STREET PARKING ORDER 2015		
			Drawing title		
			ACCESS ROAD TO SERVICE YARD D - CAR PARK		
			Prepared by	Checked by	
			AMT	NM	
			Scale	Date	
			1:750	JAN. 2015	
			Project No.	Drawing Number	Amend Letter
				PLAN 5	

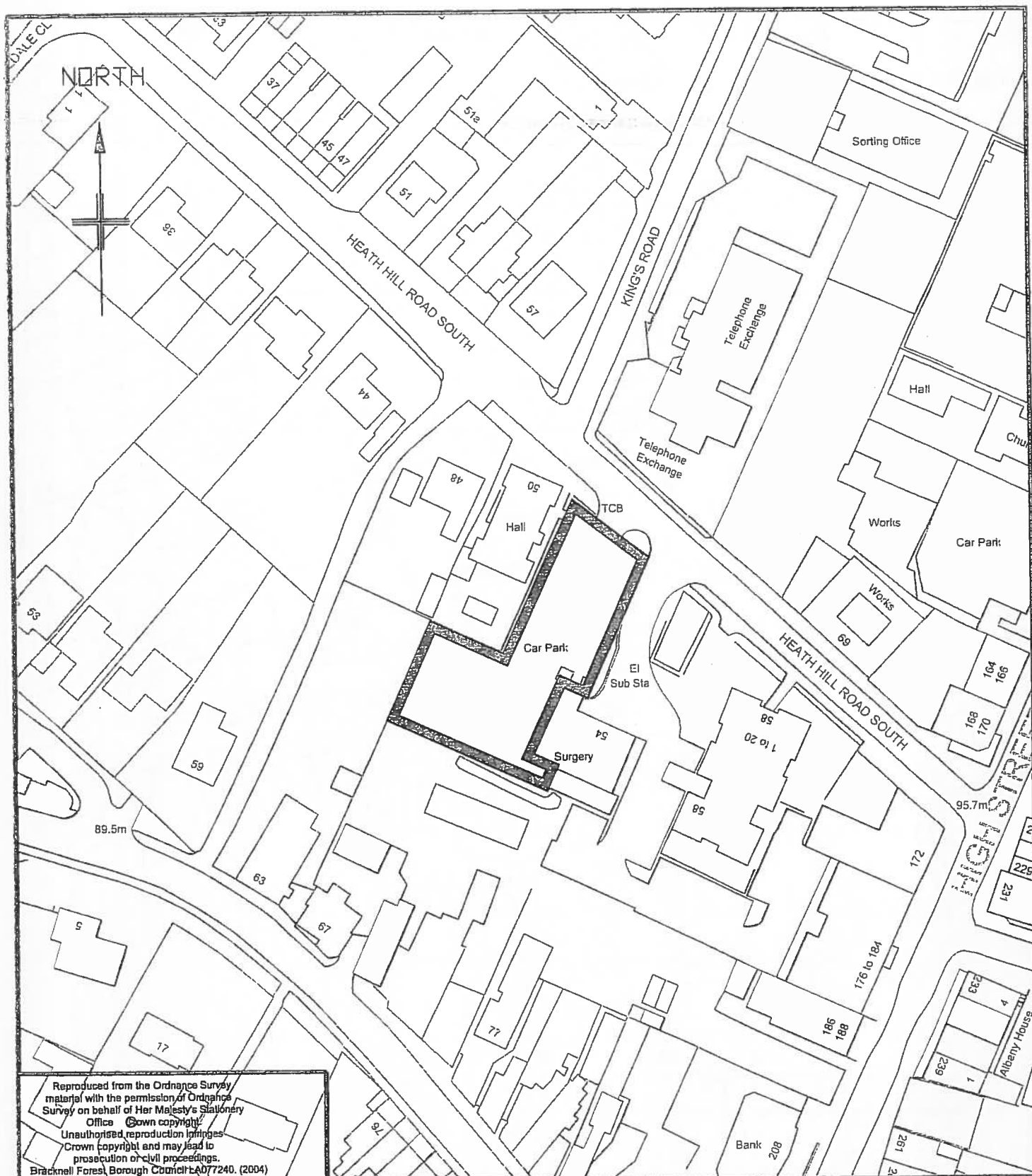

Reproduced from the Ordnance Survey material with the permission of Ordnance Survey on behalf of Her Majesty's Stationary Office. Crown copyright. Unauthorised reproduction infringes Crown copyright and may lead to prosecution or civil proceedings. Bracknell Forest Borough Council LA077240. (2004)



ENVIRONMENT
Traffic & Safety Group

Amendment	Date	Initials	Project title CONTROL OF OFF-STREET PARKING ORDER 2015		
			Drawing title HEATH HILL ROAD CAR PARK		
			Prepared by AMT	Checked by NM	
			Scale 1:1000	Date JAN. 2015	
			Project No.	Drawing Number PLAN 6	Amend Letter

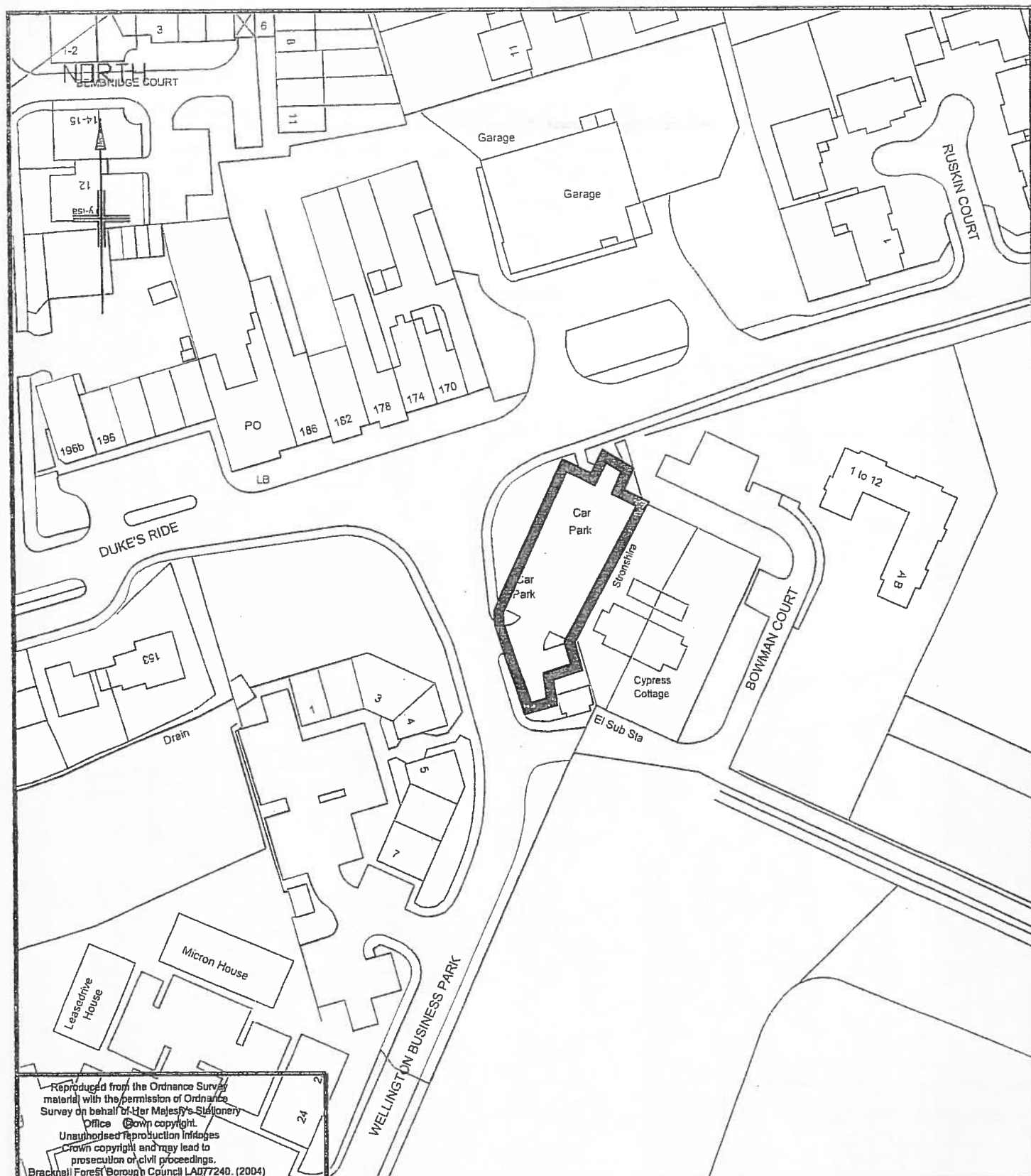

Reproduced from the Ordnance Survey
material with the permission of Ordnance
Survey on behalf of Her Majesty's Stationery
Office. Crown copyright.
Unauthorised reproduction infringes
Crown copyright and may lead to
prosecution or civil proceedings.
Bracknell Forest Borough Council LA077240. (2004)



ENVIRONMENT
Traffic & Safety Group

Amendment	Date	Initials	Project title		
			CONTROL OF OFF-STREET PARKING ORDER 2015		
			Drawing title		
			WELLINGTON BUSINESS PARK CAR PARK		
			Prepared by	AMT	Checked by NM
			Scale	1:1000	Date JAN. 2015
			Project No.	Drawing Number	Amend Letter
				PLAN 8	

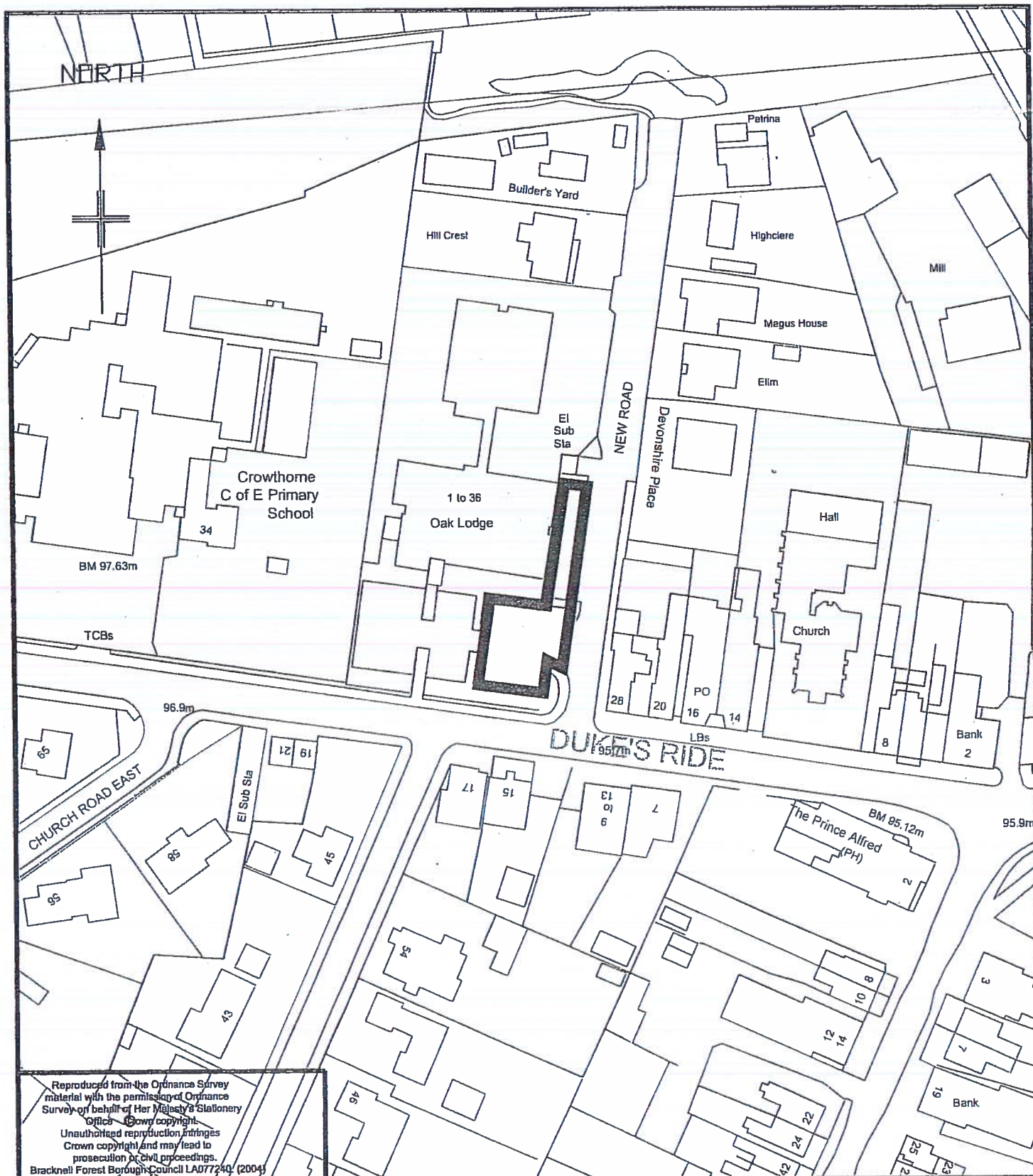

Reproduced from the Ordnance Survey material with the permission of Ordnance Survey on behalf of Her Majesty's Stationery Office. Crown copyright. Unauthorised reproduction infringes Crown copyright and may lead to prosecution or civil proceedings. Bracknell Forest Borough Council LA077240 (2004)



ENVIRONMENT
Traffic & Safety Group

Amendment	Date	Initials	Project title CONTROL OF OFF-STREET PARKING ORDER 2015		
			Drawing title NEW ROAD CAR PARK		
			Prepared by AMT	Checked by NM	
			Scale 1:1000	Date JAN. 2015	
			Project No.	Drawing Number PLAN 9	Amend Letter

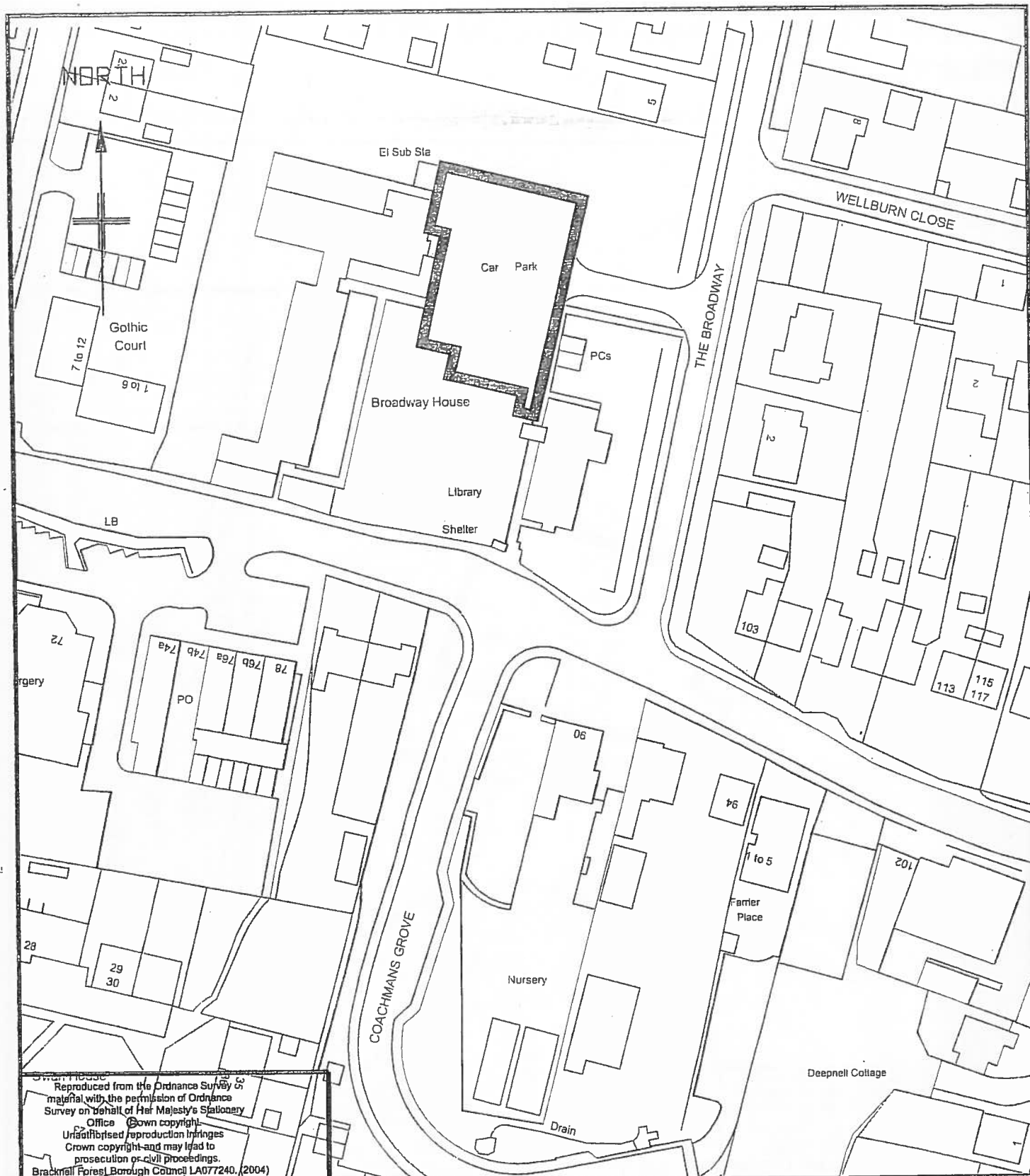

ENVIRONMENT
Traffic & Safety Group

Amendment	Date	Initials	Project title CONTROL OF OFF-STREET PARKING ORDER 2015		
			Drawing title THE BROADWAY CAR PARK		
			Prepared by AMT	Checked by NM	
			Scale 1:1000	Date JAN. 2015	
			Project No.	Drawing Number PLAN 10	Amend Letter

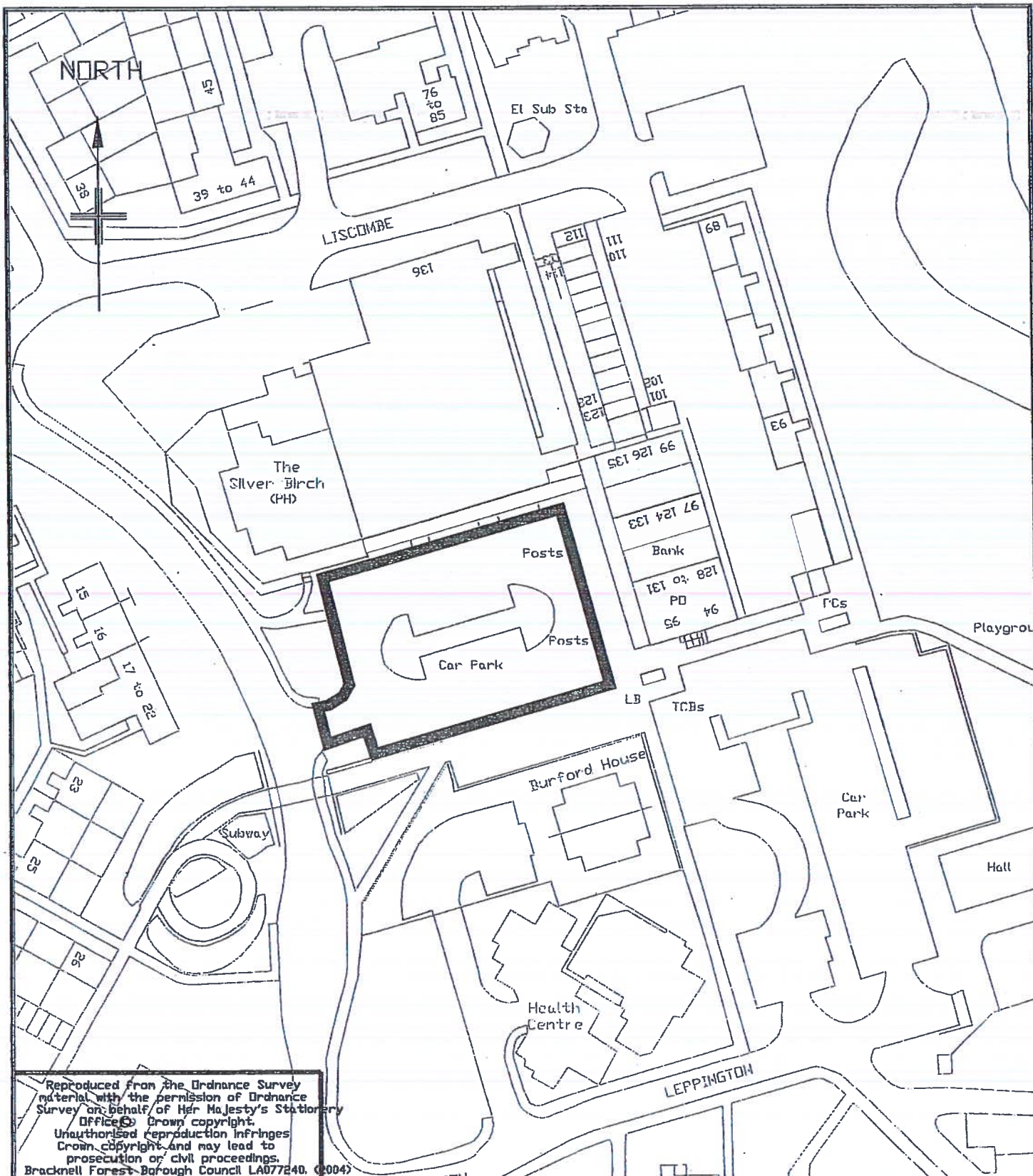

Reproduced from the Ordnance Survey material with the permission of Ordnance Survey on behalf of Her Majesty's Stationery Office. Crown copyright. Unauthorised reproduction infringes Crown copyright and may lead to prosecution or civil proceedings. Bracknell Forest Borough Council LA077240. (0004)



**BRACKNELL FOREST
BOROUGH COUNCIL**

ENVIRONMENT
Traffic & Safety Group

Amendment	Date	Initials	Project title CONTROL OF OFF-STREET PARKING ORDER 2015		
			Drawing title BIRCH HILL SHOPPING CENTRE		
			Prepared by AMT	Checked by NM	
			Scale 1:1000	Date JAN. 2015	
			Project No.	Drawing Number PLAN 11	Amend Letter

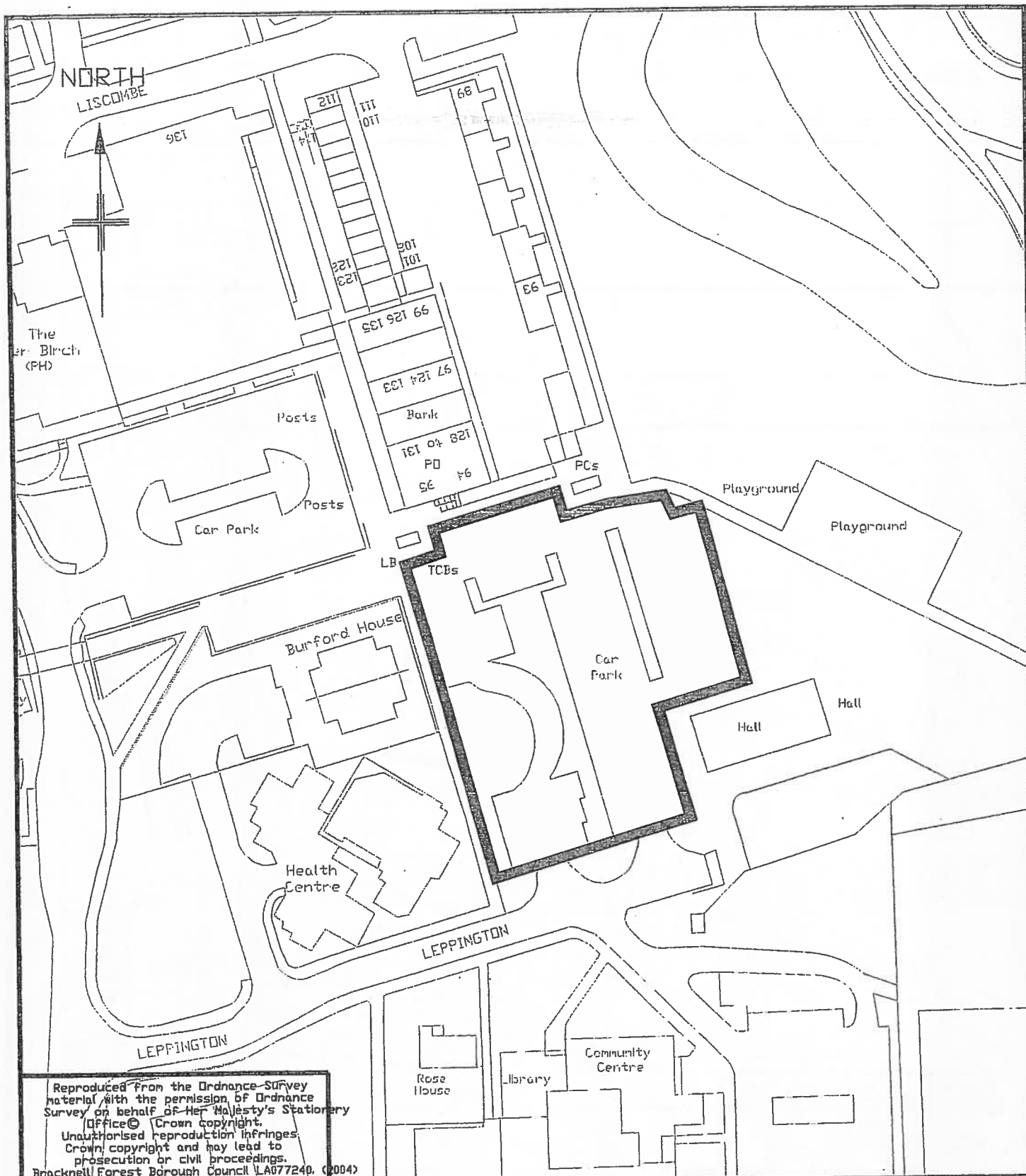

Reproduced from the Ordnance Survey material with the permission of Ordnance Survey on behalf of Her Majesty's Stationery Office. Crown copyright. Unauthorised reproduction infringes Crown copyright and may lead to prosecution or civil proceedings. Bracknell Forest Borough Council LA077240. (2004)



ENVIRONMENT
Traffic & Safety Group

Amendment	Date	Initials	Project title CONTROL OF OFF-STREET PARKING ORDER 2015		
			Drawing title LEPPINGTON BIRCH HILL		
			Prepared by AMT	Checked by NM	
			Scale 1:1000	Date JAN. 2015	
			Project No.	Drawing Number PLAN 12	Amend Letter

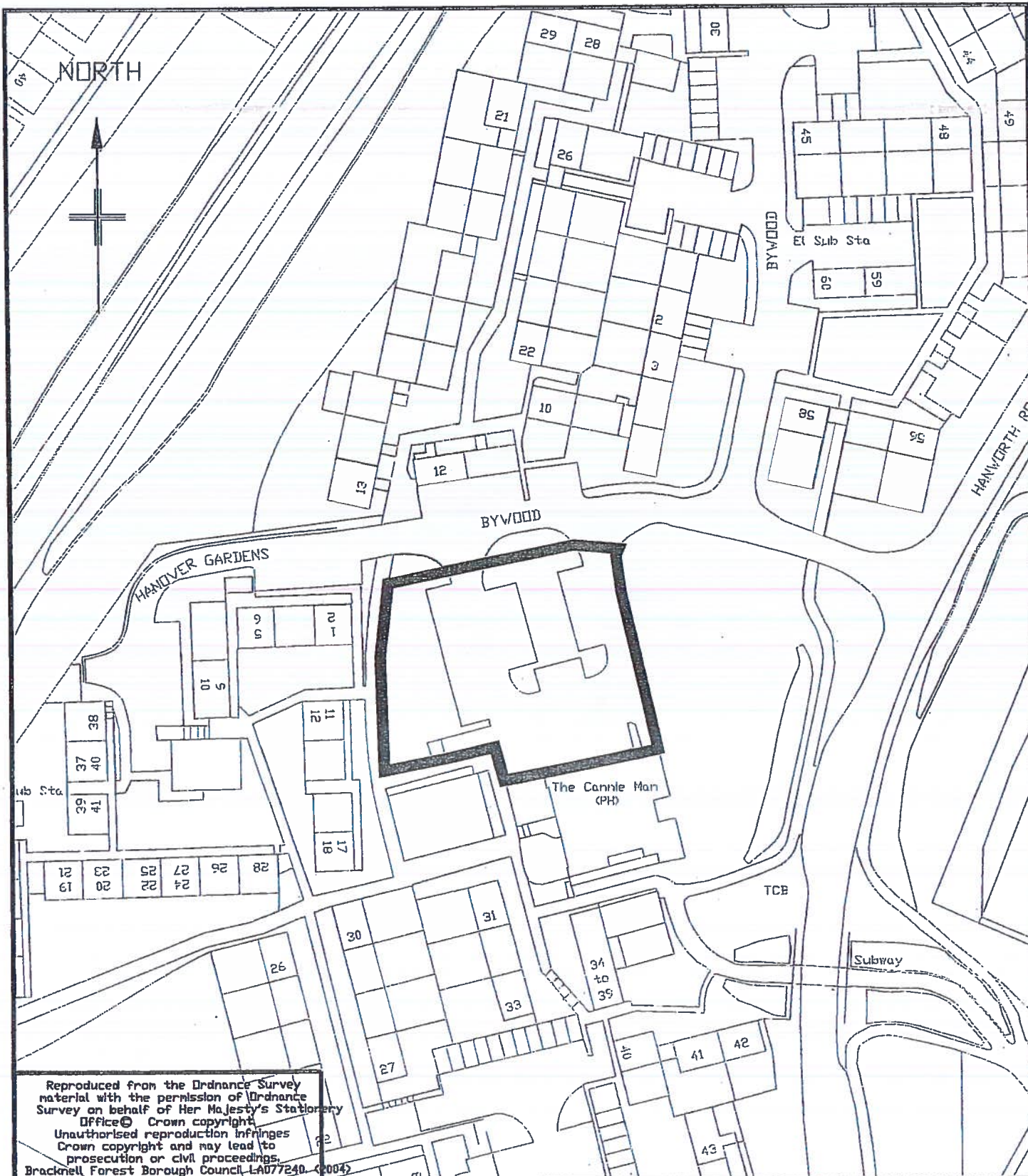

ENVIRONMENT
Traffic & Safety Group

Amendment	Date	Initials	Project title CONTROL OF OFF-STREET PARKING ORDER 2015		
			Drawing title BYWOOD HANWORTH		
			Prepared by AMT	Checked by NM	
			Scale 1:1000	Date JAN. 2015	
			Project No.	Drawing Number PLAN 13	Amend Letter

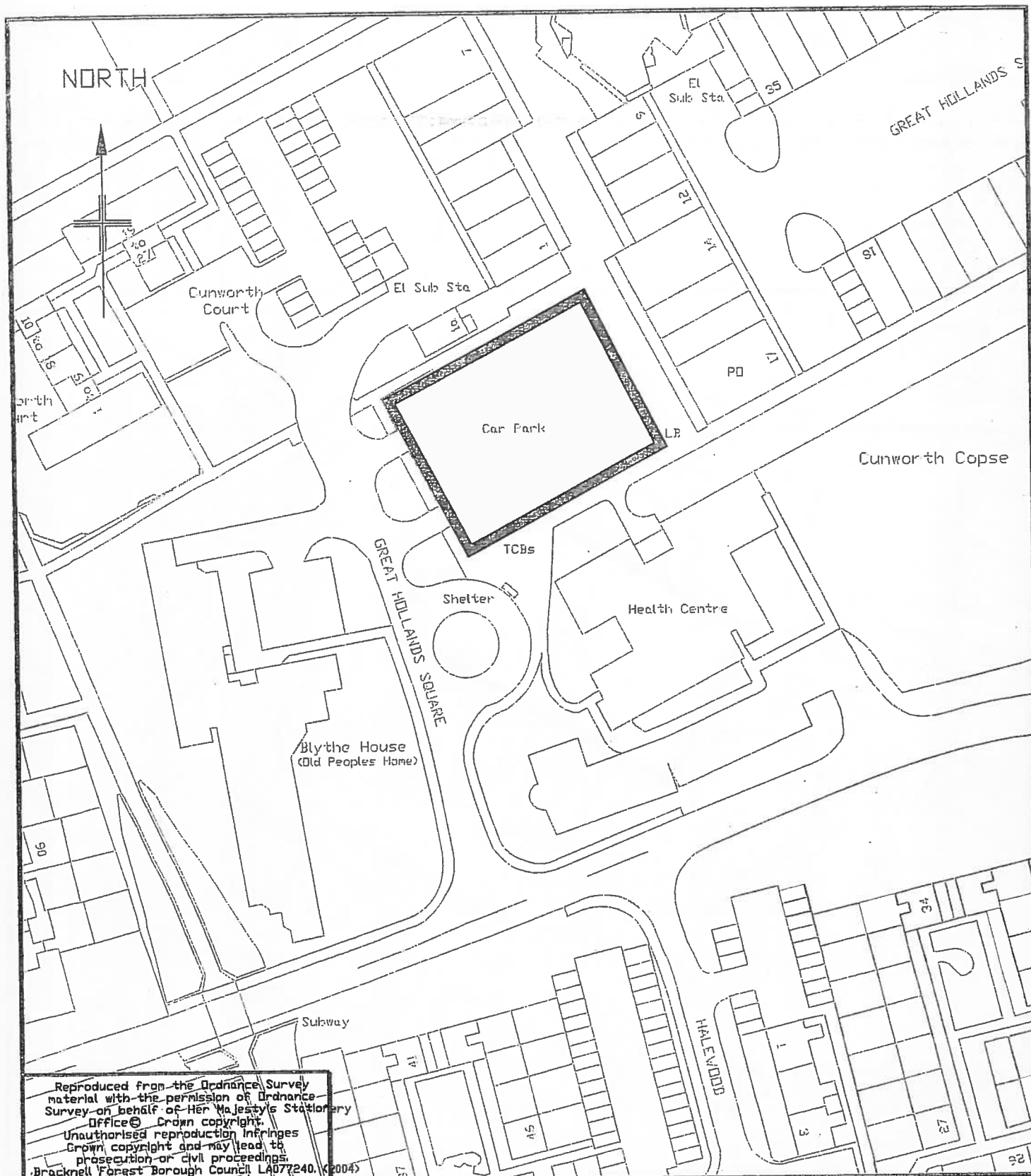

Reproduced from the Ordnance Survey material with the permission of Ordnance Survey on behalf of Her Majesty's Stationery Office. Crown copyright. Unauthorised reproduction infringes Crown copyright and may lead to prosecution or civil proceedings. Bracknell Forest Borough Council LA077240. (2004)



ENVIRONMENT
Traffic & Safety Group

Amendment	Date	Initials	Project title CONTROL OF OFF-STREET PARKING ORDER 2015		
			Drawing title GREAT HOLLANDS SHOPPING CENTRE		
			Prepared by AMT	Checked by NM	
			Scale 1:1000	Date JAN. 2015	
			Project No.	Drawing Number PLAN 14	Amend Letter

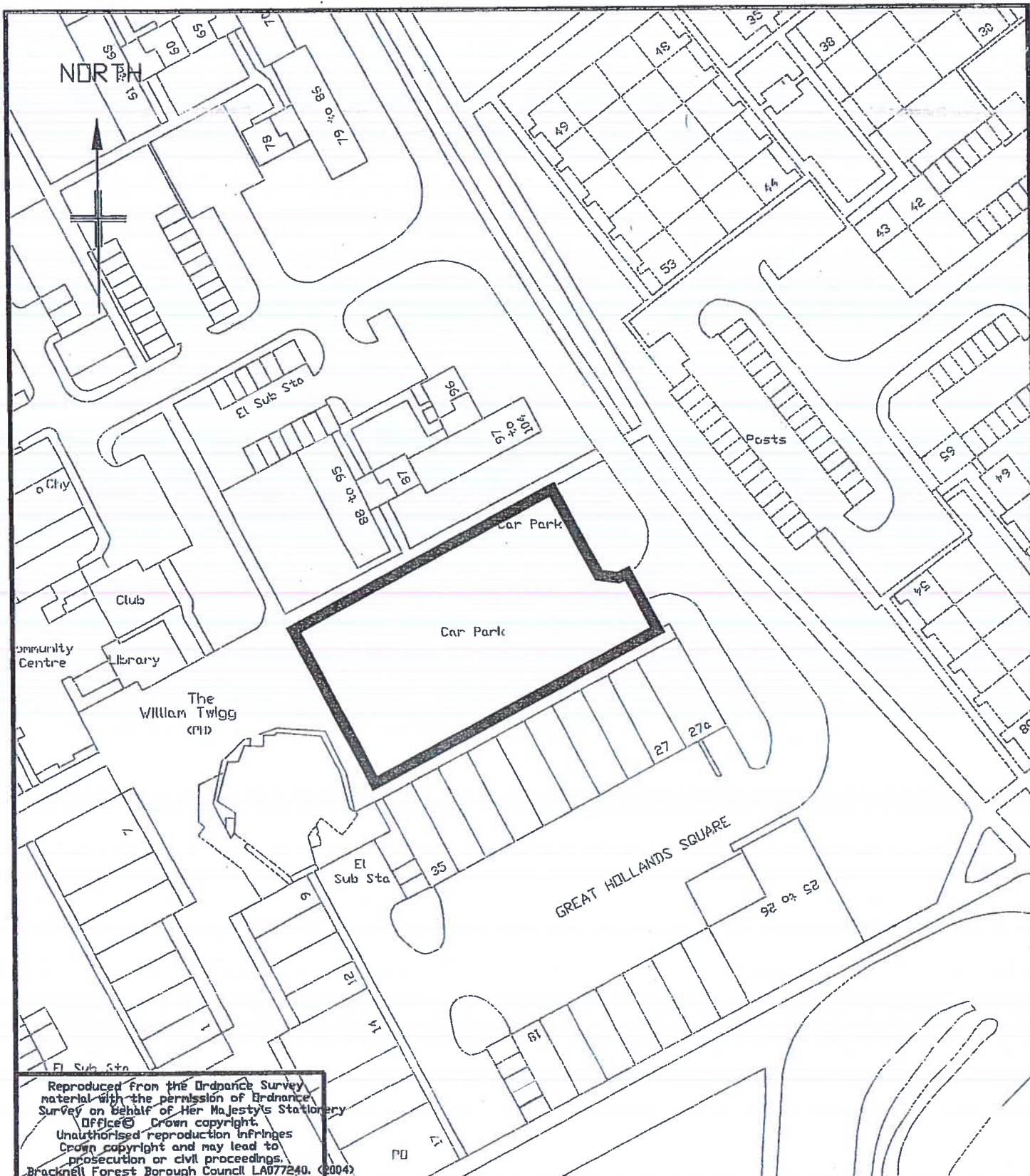

ENVIRONMENT
Traffic & Safety Group

Amendment	Date	Initials	Project title CONTROL OF OFF-STREET PARKING ORDER 2015		
			Drawing title WILLIAM TWIGG CAR PARK GREAT HOLLANDS		
			Prepared by AMT		Checked by NM
			Scale 1:1000		Date JAN. 2015
			Project No.	Drawing Number PLAN 15	Amend Letter

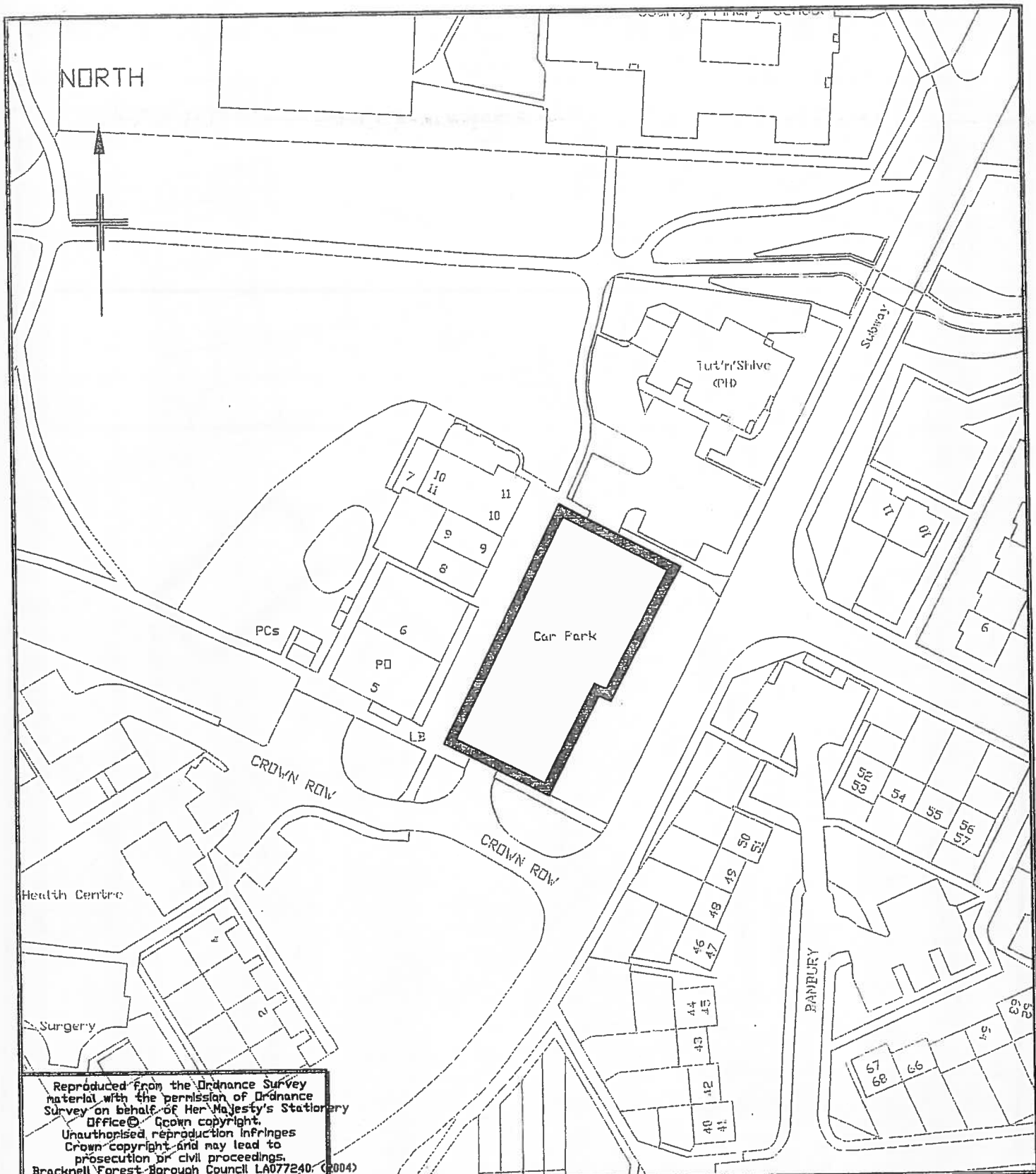

Reproduced from the Ordnance Survey material with the permission of Ordnance Survey on behalf of Her Majesty's Stationary Office. Crown copyright. Unauthorised reproduction infringes Crown copyright and may lead to prosecution or civil proceedings. Bracknell Forest Borough Council LA077240: (2004)



ENVIRONMENT
Traffic & Safety Group

Amendment	Date	Initials	Project title CONTROL OF OFF-STREET PARKING ORDER 2015		
			Drawing title CROWN WOOD SHOPPING CENTRE		
			Prepared by AMT	Checked by NM	
			Scale 1:1000	Date JAN. 2015	
			Project No.	Drawing Number PLAN 16	Amend Letter



Reproduced from the Ordnance Survey material with the permission of Ordnance Survey on behalf of Her Majesty's Stationery Office © Crown copyright. Unauthorised reproduction infringes Crown copyright and may lead to prosecution or civil proceedings. Bracknell Forest Borough Council LA077240. (2004)



ENVIRONMENT
Traffic & Safety Group

Amendment	Date	Initials	Project title CONTROL OF OFF-STREET PARKING ORDER 2015		
			Drawing title WILDRIDINGS SQUARE SHOPPING CENTRE		
			Prepared by AMT	Checked by NM	
			Scale 1:1000	Date JAN. 2015	
			Project No.	Drawing Number PLAN 17	Amend Letter

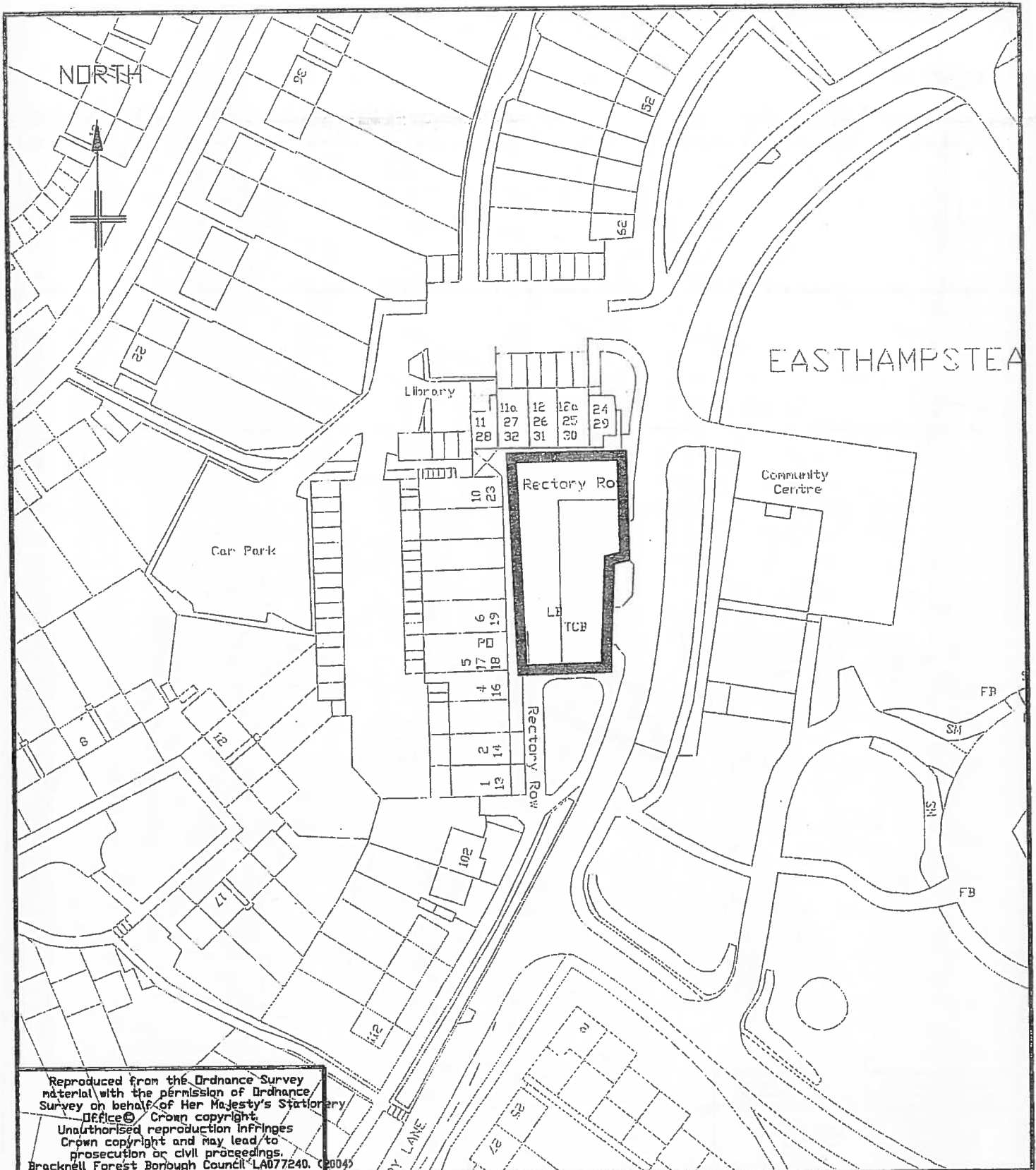

Reproduced from the Ordnance Survey material with the permission of Ordnance Survey on behalf of Her Majesty's Stationery Office. Crown copyright. Unauthorised reproduction infringes Crown copyright and may lead to prosecution or civil proceedings. Bracknell Forest Borough Council LA077240. (2004)



**BRACKNELL FOREST
BOROUGH COUNCIL**

ENVIRONMENT
Traffic & Safety Group

Amendment	Date	Initials	Project title CONTROL OF OFF-STREET PARKING ORDER 2015		
			Drawing title RECTORY ROW BRACKNELL		
			Prepared by AMT	Checked by NM	
			Scale 1:1000	Date JAN. 2015	
			Project No.	Drawing Number PLAN 18	Amend Letter

NORTH

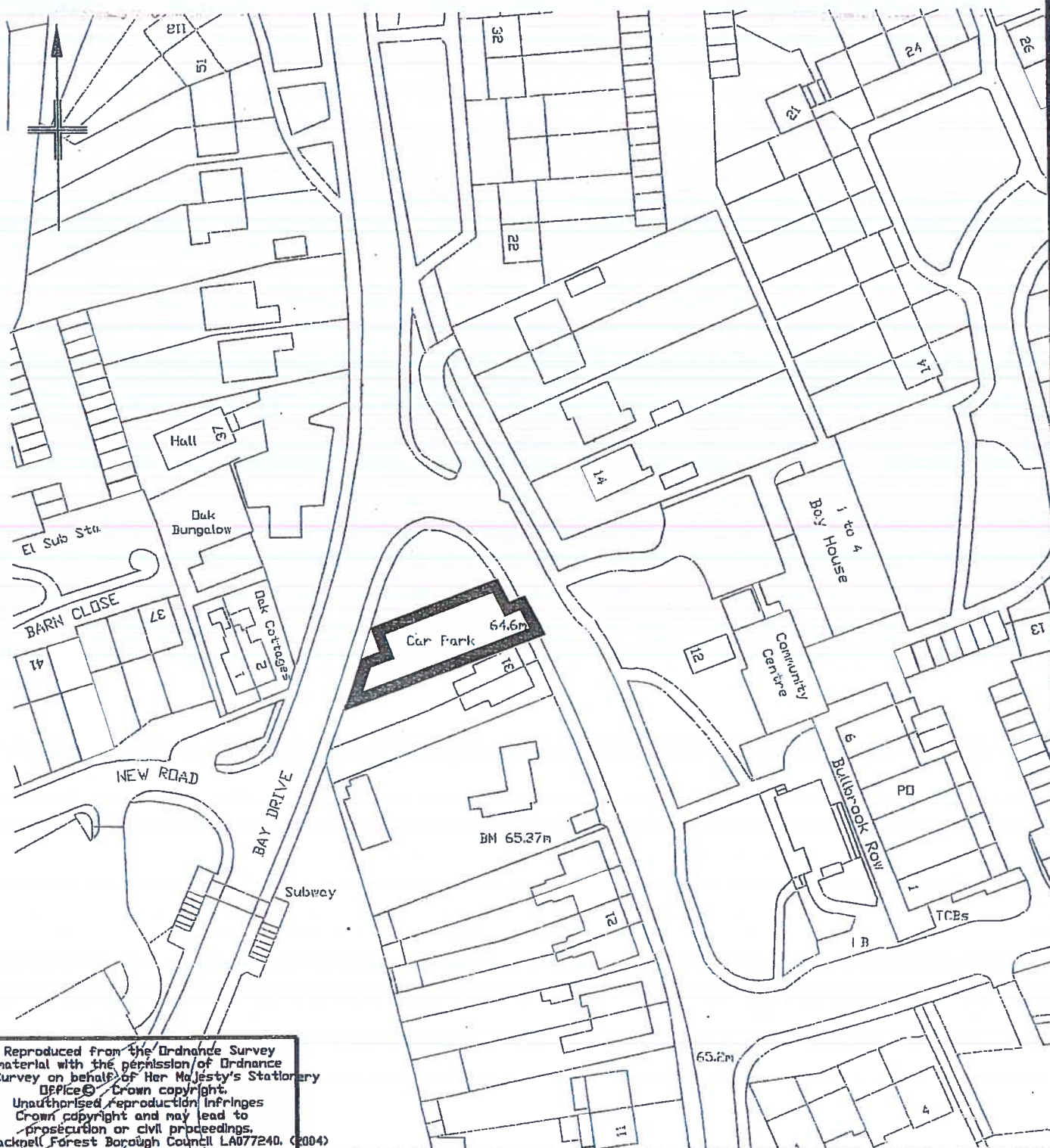

Reproduced from the Ordnance Survey material with the permission of Ordnance Survey on behalf of Her Majesty's Stationery Office. Crown copyright. Unauthorised reproduction infringes Crown copyright and may lead to prosecution or civil proceedings. Bracknell Forest Borough Council LA077240. (2004)



BRACKNELL FOREST BOROUGH COUNCIL
ENVIRONMENT
Traffic & Safety Group

Amendment	Date	Initials	Project title
			CONTROL OF OFF-STREET PARKING ORDER 2015
			Drawing title
			BAY ROAD JUNCTION WITH BAY DRIVE, BRACKNELL
			Prepared by
			AMT
			Checked by
			NM
			Scale
			1:1000
			Date
			JAN. 2015
			Project No.
			Drawing Number
			PLAN 19
			Amend Letter

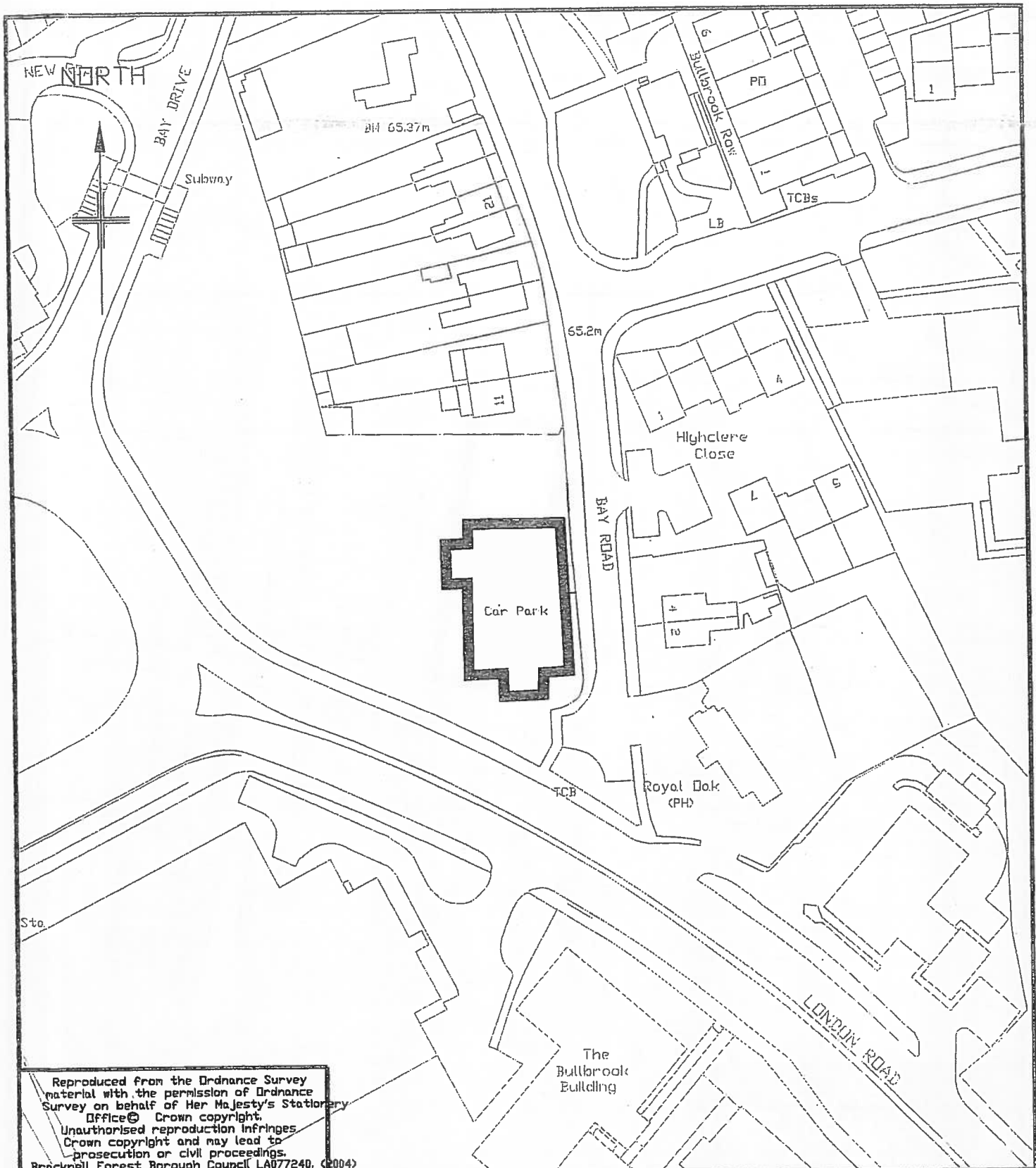

Reproduced from the Ordnance Survey material with the permission of Ordnance Survey on behalf of Her Majesty's Stationery Office. Crown copyright. Unauthorised reproduction infringes Crown copyright and may lead to prosecution or civil proceedings. Bracknell Forest Borough Council LA077240, (2004)



ENVIRONMENT
Traffic & Safety Group

Amendment	Date	Initials	Project title CONTROL OF OFF-STREET PARKING ORDER 2015		
			Drawing title SOUTHERN END OF BAY ROAD BRACKNELL		
			Prepared by AMT	Checked by NM	
			Scale 1:1000	Date JAN. 2015	
			Project No.	Drawing Number PLAN 20	Amend Letter

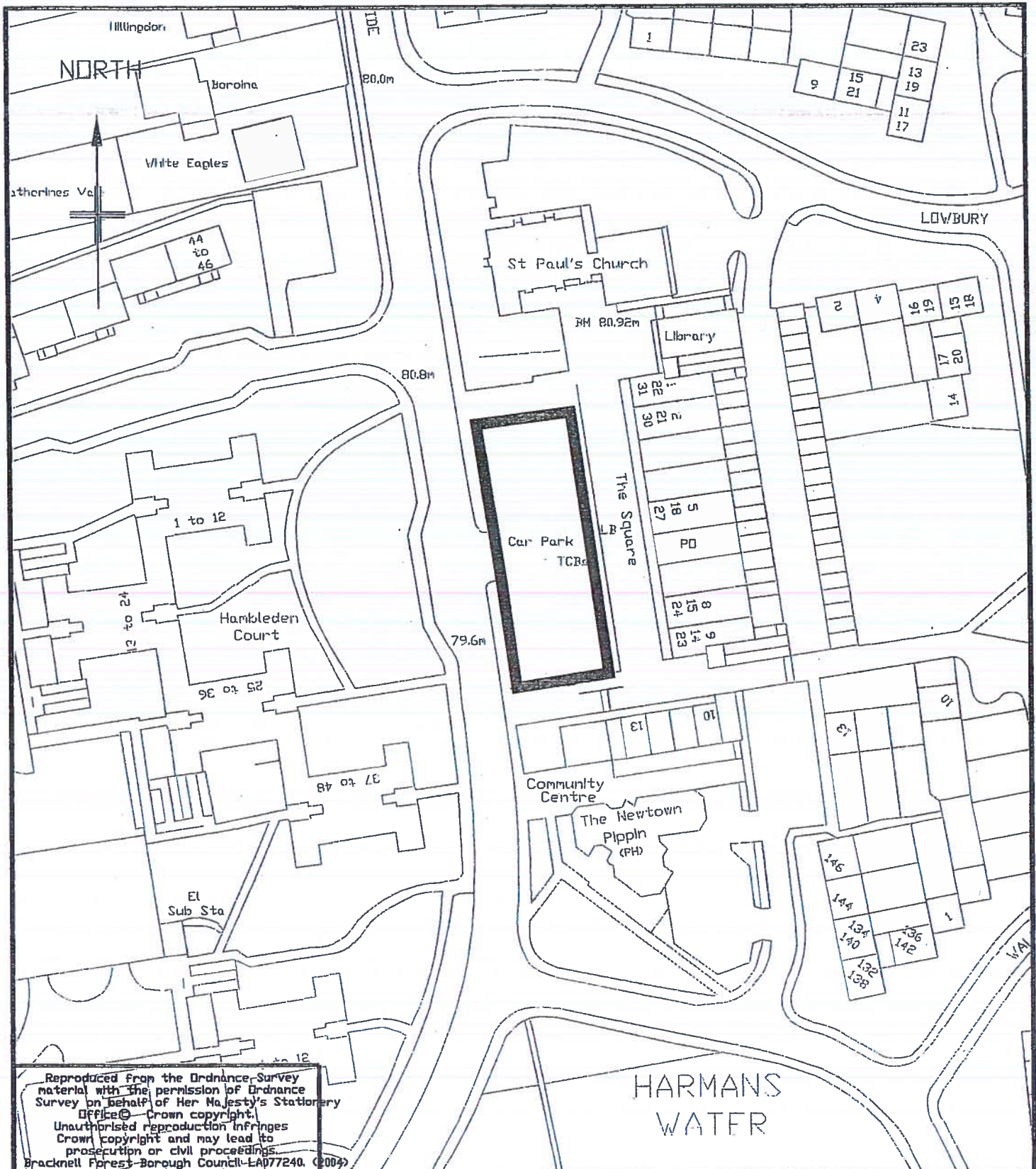

Reproduced from the Ordnance Survey material with the permission of Ordnance Survey on behalf of Her Majesty's Stationary Office. Crown copyright. Unauthorised reproduction infringes Crown copyright and may lead to prosecution or civil proceedings. Bracknell Forest Borough Council-EP077240. (2004)



ENVIRONMENT
Traffic & Safety Group

Amendment	Date	Initials	Project title CONTROL OF OFF-STREET PARKING ORDER 2015		
			Drawing title THE SQUARE HARMANS WATER, BRACKNELL		
			Prepared by AMT		Checked by NM
			Scale 1:1000		Date JAN. 2015
			Project No.	Drawing Number PLAN 21	Amend Letter

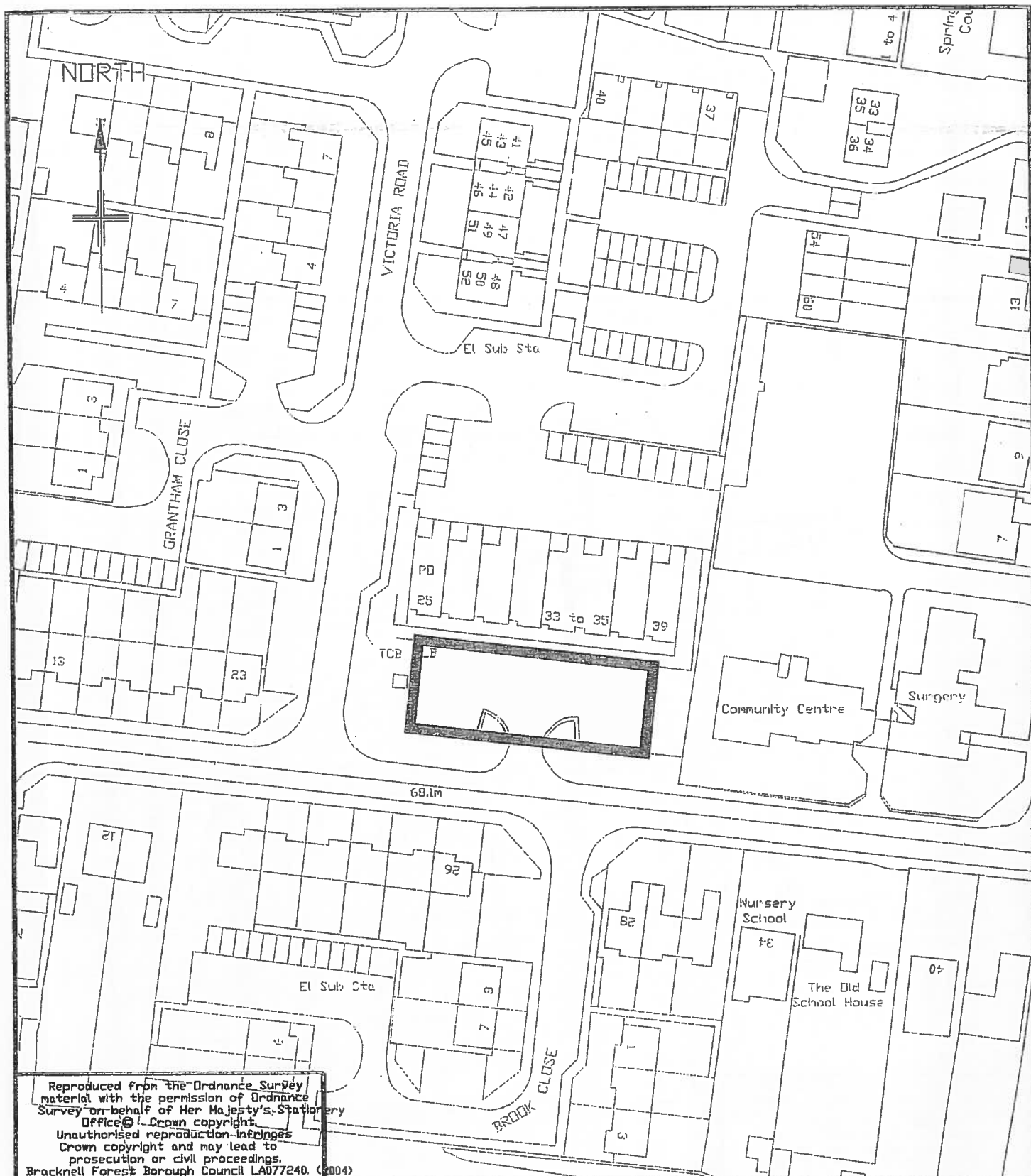

Reproduced from the Ordnance Survey material with the permission of Ordnance Survey on behalf of Her Majesty's Stationery Office. Crown copyright. Unauthorised reproduction infringes Crown copyright and may lead to prosecution or civil proceedings. Bracknell Forest Borough Council LA077240. (3004)



ENVIRONMENT
Traffic & Safety Group

Amendment	Date	Initials	Project title CONTROL OF OFF-STREET PARKING ORDER 2015		
			Drawing title YEOVIL ROAD OWLSMOOR		
			Prepared by AMT	Checked by NM	
			Scale 1:1000	Date JAN. 2015	
			Project No.	Drawing Number PLAN 22	Amend Letter

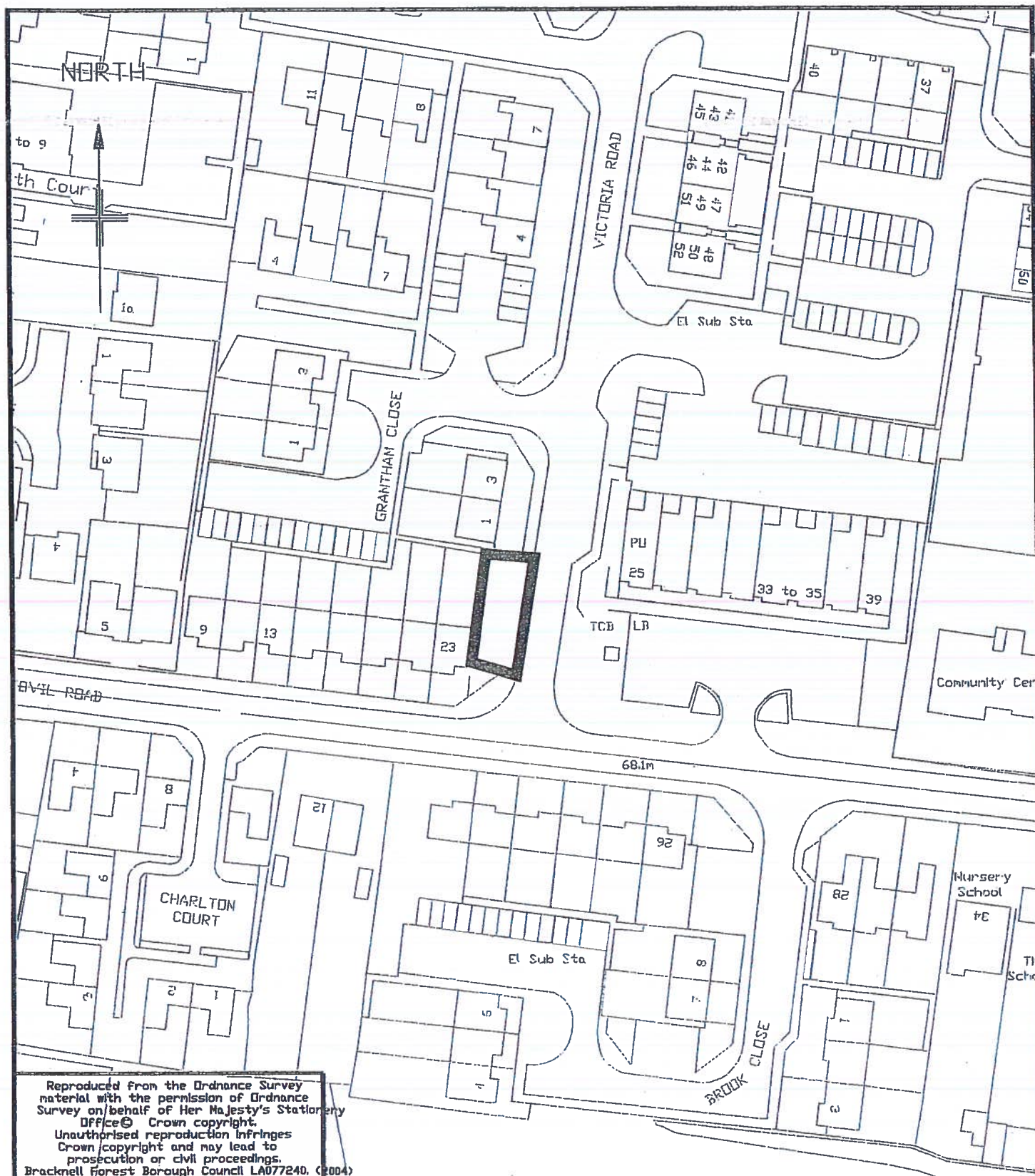

Reproduced from the Ordnance Survey material with the permission of Ordnance Survey on behalf of Her Majesty's Stationery Office © Crown copyright. Unauthorised reproduction infringes Crown copyright and may lead to prosecution or civil proceedings. Bracknell Forest Borough Council LA077240. (2004)



ENVIRONMENT
Traffic & Safety Group

Amendment	Date	Initials	Project title CONTROL OF OFF-STREET PARKING ORDER 2015		
			Drawing title LAND ADJACENT TO 1 VICTORIA ROAD, OWLSMOOR		
			Prepared by AMT	Checked by NM	
			Scale 1:1000	Date JAN. 2015	
			Project No.	Drawing Number PLAN 23	Amend Letter

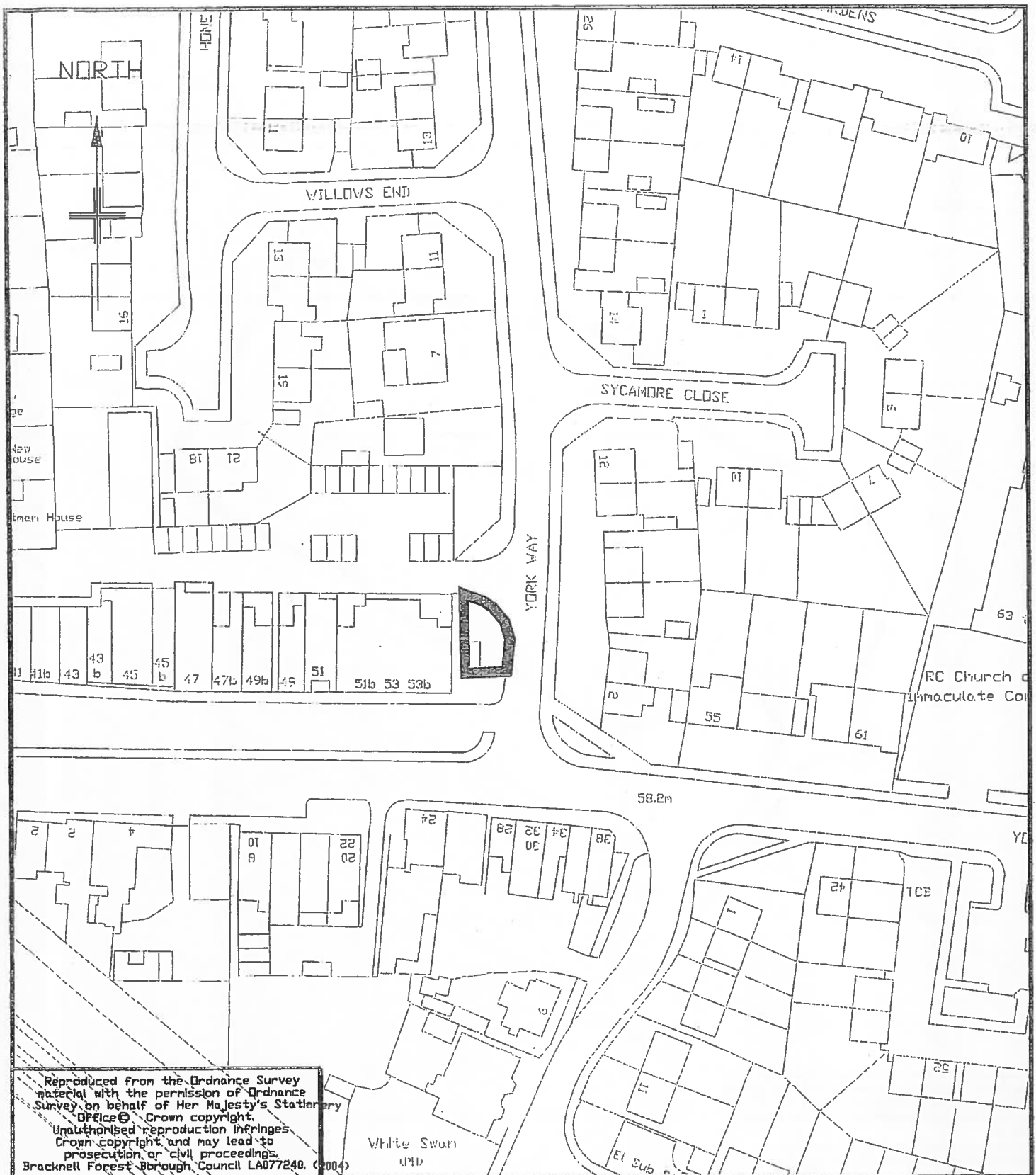

ENVIRONMENT
Traffic & Safety Group

Amendment	Date	Initials	Project title
			CONTROL OF OFF-STREET PARKING ORDER 2015
			Drawing title
			YORK WAY SANDHURST
			Prepared by
			AMT
			Checked by
			NM
			Scale
			1:1000
			Date
			JAN. 2015
			Project No.
			Drawing Number
			PLAN 24
			Amend Letter

NORTH

L Tvr

L Tvr

L Tvr

21 Sub Siz

Leisure Pool

Cycle Tr

94.9m

NINE MILE RIDE

Ward Ety
Dr

This map is reproduced from Ordnance Survey material with the permission of Ordnance Survey on behalf of the Controller of Her Majesty's Stationery Office © Crown Copyright.
Unauthorized reproduction infringes Crown copyright and may lead to prosecution or civil proceedings.
Bracknell Forest Borough Council LA100019488.



**Bracknell
Forest
Council**

ENVIRONMENT, CULTURE & COMMUNITIES
Traffic & Safety Group

Amendment	Date	Initials	Project title CONTROL OF OFF-STREET PARKING ORDER 2015		
			Drawing title CORAL REEF CAR PARK		
			Prepared by AMT	Checked by NM	
			Scale 1:1250	Date JAN. 2015	
			Project No.	Drawing Number PLAN 25	Amend Letter

NORTH

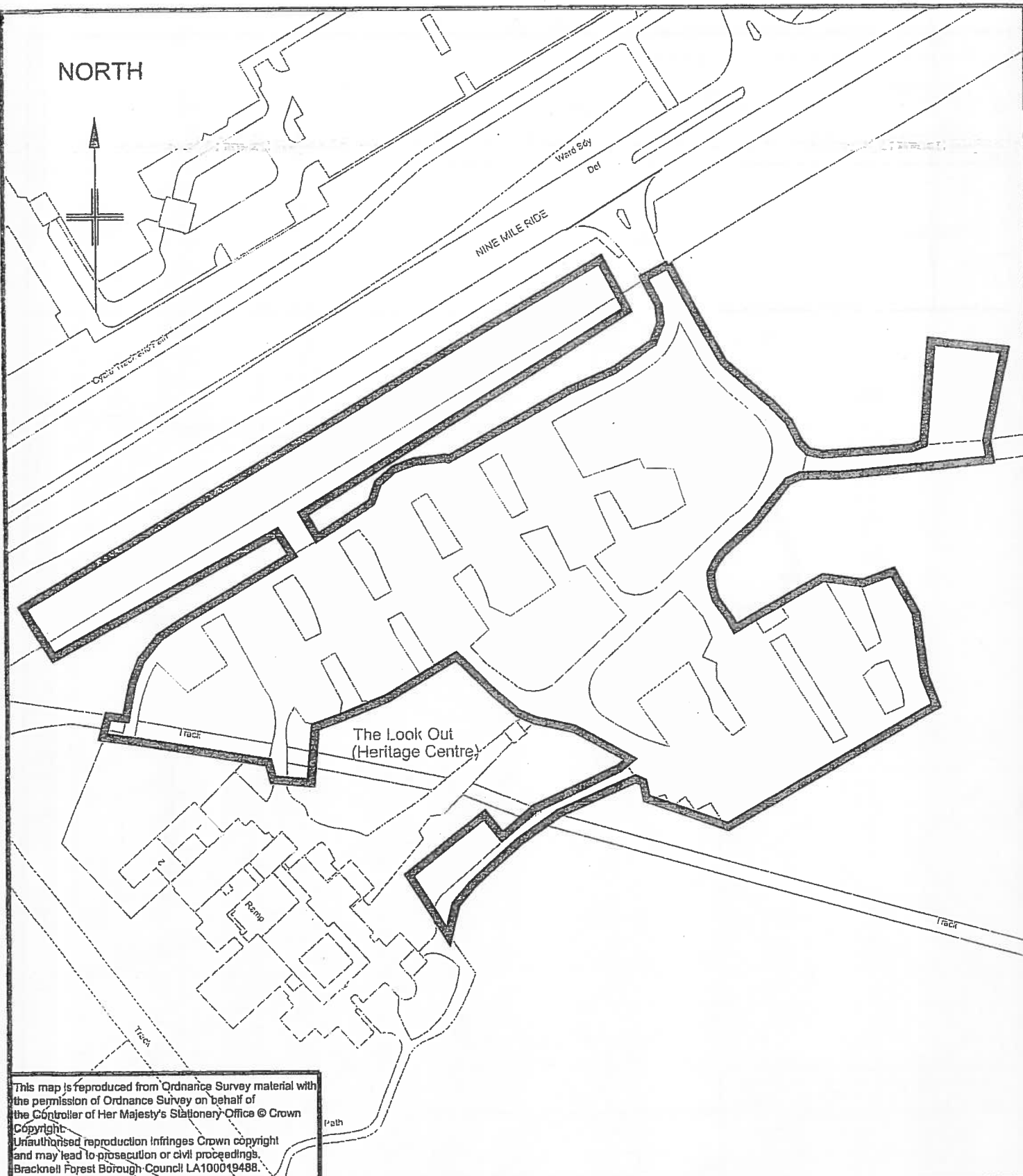

This map is reproduced from Ordnance Survey material with the permission of Ordnance Survey on behalf of the Controller of Her Majesty's Stationary Office © Crown Copyright. Unauthorised reproduction infringes Crown copyright and may lead to prosecution or civil proceedings. Bracknell Forest Borough Council LA100019488.



**Bracknell
Forest
Council**

ENVIRONMENT, CULTURE & COMMUNITIES
Traffic & Safety Group

Amendment	Date	Initials	Project title CONTROL OF OFF-STREET PARKING ORDER 2015		
			Drawing title THE LOOK OUT DISCOVERY CENTRE CAR PARK		
			Prepared by AMT	Checked by NM	
			Scale 1:1250	Date JAN. 2015	
			Project No.	Drawing Number PLAN 26	Amend Letter

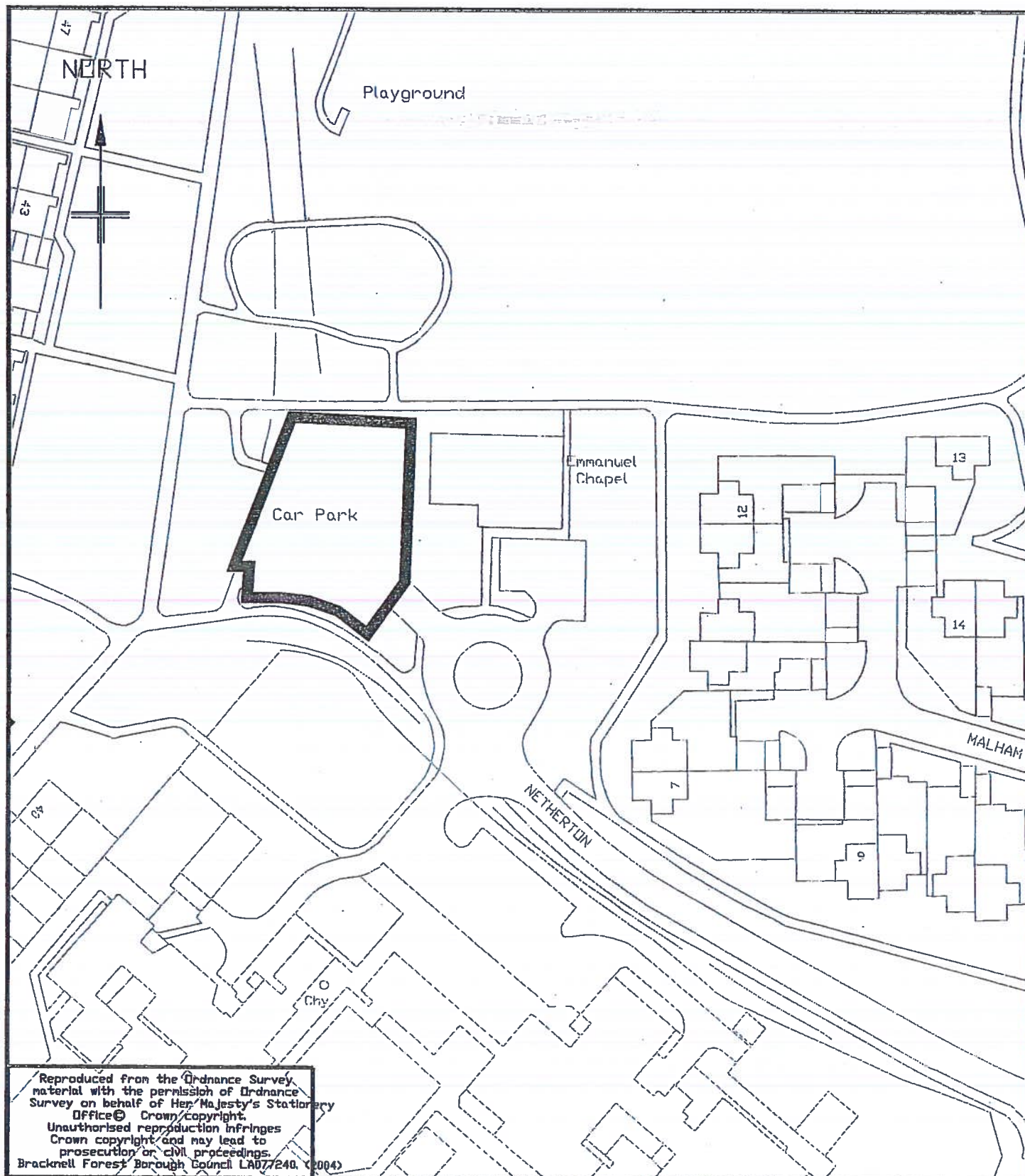

Reproduced from the Ordnance Survey material with the permission of Ordnance Survey on behalf of Her Majesty's Stationary Office © Crown/copyright. Unauthorized reproduction infringes Crown copyright and may lead to prosecution or civil proceedings. Bracknell Forest Borough Council LA07/240, (2004)



ENVIRONMENT
Traffic & Safety Group

Amendment	Date	Initials	Project title CONTROL OF OFF-STREET PARKING ORDER 2015		
			Drawing title NETHERTON, BRACKNELL		
			Prepared by AMT	Checked by NR	
			Scale 1:1000	Date JAN. 2015	
			Project No.	Drawing Number PLAN 27	Amend Letter