

ASHFORD BOROUGH COUNCIL (OFF-STREET PARKING PLACES) CONSOLIDATED ORDER 2024

Ashford Borough Council (the Council”) in exercise of its powers under sections 32, 33, 35, 124 and Part IV of Schedule 9 of the Road Traffic Regulations Act 1984 (“the 1984 act”) and section 43 and schedule 3 of the Road Traffic Act (“the 1991 Act”) Part 6 of the Traffic Management Act 2004 (“the 2004 Act”) and of all other powers enabling it in that behalf and with the consent of the Kent County Council given under section 30(3) of the 1984 Act and after consultation with the Chief Officer of Police in accordance with Part III of schedule 9 to the 1984 Act hereby make the following Order:-

Commencement and Citation

- 1 (1) This order shall come into operation on **Tuesday 1 October 2024** and may be cited as the Ashford Borough Council (Off-Street Parking Places) Consolidated Order 2024, hereinafter referred to as “this Order”.

- (2) The Ashford Borough Off-Street Plans (“the Off-Street Plans”) and the schedules of this order are incorporated into this Order.

Revocations

- 2 The orders listed within Schedule 1 are hereby revoked.

Interpretation

- 3 (1) In this Order the following expressions have the meanings assigned to them except where the context requires otherwise:

“the 1984 Act”	means the Road Traffic Regulation Act 1984
“the 1991 Act”	means the Road Traffic Act 1991
“the 2004 Act”	means the Traffic Management Act 2004
“Active Vehicle”	means the Vehicle which is selected to be valid on the users’ Permit Account.
“Camper Van”	has the same meaning as “Motor Caravan” (see below)
“Civil Enforcement Officer”	means a person authorised by or on behalf of the Council to supervise Parking Places and enforce the provisions of this Order and as is defined by Section 76(a) of the 2004 Act
“Coach”	has the same meaning as that which is set out in Regulation 3(2) of the Road Vehicles (Construction and Use) Regulations 1986 S.I. 1078
“the Council”	means Ashford Borough Council

“Disabled person’s Badge”	has the same meaning as that which is set out in Regulation 3(1) of the Local Authorities’ Traffic Orders (Exemptions for Disabled Persons) (England) Regulations 2000 S.I 683
“Driver”	in relation to a Vehicle in a Parking Place means the person driving or having control or charge of the said Vehicle, or the person having driven or having had control or charge of the Vehicle that entered or was left in the Parking Place
“Electric Vehicle”	means a motor Vehicle which is propelled by electric energy (battery-only powered Vehicle) from rechargeable batteries, inclusive of hybrid Vehicles, that combine an internal combustion engine with one or more electric motors powered by rechargeable batteries which require charging.
“Goods Vehicle”	means a motor Vehicle constructed or adapted for use for the carriage of goods or burden of any description
“Invalid Carriage”	has the same meaning as that set out in Section 136(5) of the 1984 Act
“Licensed Taxi”	means a Vehicle licensed as a hackney carriage under section 38 of the Town Police Clauses Act 1847, as amended
“Limited Waiting Bay”	means a Parking Bay designated for a period of free parking with a maximum time limit identified by signs and/or surface markings
“Loading or Unloading”	means the act of taking heavy or bulky goods from a Vehicle to a stationary premises.
“Minibus”	has the same meaning as that which is set out in Regulation 3(2) of the Road Vehicles (Construction and Use) Regulations 1986
“Motor Caravan”	has the same meaning as a Special Purpose Vehicle (Code ‘SA’) which is set out in Section 5.1 or EU Commission Regulation No 678/2011, as amended
“Motor Cycle”	has the same meaning as that which is set out in section 3 of the Road Vehicles (Construction and Use) Regulations 1986
“Off-Street Plans”	means the Ashford Borough Off-Street Plans which are incorporated into this Order pursuant to the Article 1(2) hereof
“Owner”	has the meaning assigned to it by Section 92(1) of the Traffic Management Act 2004
“Parking Bay”	means an area in a Parking Place delineated by white, yellow, green (or otherwise) markings to indicate the position in which a Vehicle shall be parked in that parking bay.

"Parking Charge"	means an amount ascertained by reference to the scales specified in Column 8 of Schedule 2 (or such other amount as shall be notified in accordance with Section 35c(1) of the 1984 Act) which has been paid at; a Ticket machine, or to a Civil Enforcement Officer, or by using the Council's "pay by phone" arrangements or as otherwise deemed appropriate by the Council under the provisions of this Order in respect of a Vehicle left in that Parking Place for a parking period
"Parking Disc"	has the same meaning as that which is set out in Regulation 8(5) of the Local Authorities' Traffic Orders (Exemptions for Disabled Persons) (England) Regulations 2000 S.I. 683
"Parking Period"	means a period of time within the chargeable hours set out in Column 5 of Schedule 2 for which a Parking Charge has been paid
"Parking Place"	has the same meaning as that set out in Section 32(4)(b) of the 1984 Act and is as stipulated in Column 1 of Schedule 2 and on the relevant Off-Street Plan
"Parking Ticket"	means a ticket issued in accordance with Article 7(1) identifying a specific Parking Place, date and time of expiry of the Parking Period
"Pay and display"	means a system of payment of a parking charge for the parking of motor Vehicles used at car parks where pre-paid tickets must be obtained and be displayed in the appropriate manner within the Vehicle for the entire period that the Vehicle is parked unless payment for parking has been made by "pay by phone"
"Pay by phone"	means a method of payment for a parking period whereby a parking charge (and any appropriate administration charge) is collected by a Borough Council appointed third party, via an arranged account with payment being made over the telephone or by other electronic system (including via the internet) by credit or debit card or other means of secure authorised payment
"Pay to park"	is to be construed in like fashion to "Pay and Display"
"Penalty Charge"	means a charge set in accordance with the provisions of the 1991 Act payable to the council following the issue of a penalty charge notice
"Permit"	means a non-transferable digital document issued by the council in accordance with Article 10 which when used in accordance with the particulars stipulated thereon provides authority for the specified Vehicle to remain in a specified

	Parking Place(s) without payment of the Parking Charge
“Permit Account”	means an account used to purchase Season Tickets, add & remove Vehicles and change the Active Vehicle, which is accessible by www.ashford.gov.uk
“Public Highway”	A public road maintained by the highway authority Kent County Council
“Relevant Position”	means; in the case of a Parking Ticket – a Vehicle displays a Parking Ticket in the Relevant Position if the said ticket is exhibited in a conspicuous position within the said Vehicle so that the side of the ticket marked “THIS SIDE UP” is clearly visible and can be read from the outside of the Vehicle; In the case if a Disabled Person’s Badge and a Parking Disc – A vehicle displayed a Disabled Persons’ Badge and a Parking Disc in the Relevant Position if the badge or disc if displayed in accordance with Regulation 4 of the Local Authorities’ Traffic Orders (Exemptions for Disabled Persons) (England) Regulations 2000 S.I. 683
“Season Ticket”	means a non-transferable season ticket issued by the Council in accordance with Article 9 which when the Vehicle is marked active via the users’ Permit Account shall permit the Vehicle specified on the said season ticket to park without displaying a valid parking ticket
“Taxi”	has the same meaning as “licensed taxi” (see above)
“Ticket Machine”	means an apparatus installed in a parking place to issue a Parking Ticket
“Vehicle”	has the same meaning as that assigned to “motor Vehicle” in section 136(1) of the 1984 Act

- 3 (2) Except where the context otherwise requires, references in this Order to Articles and Schedules are references to the Articles of and Schedules to this Order.
- 3 (3) The interpretation Act 1978 shall apply for the interpretation of this Order as it applies for the interpretation of an Act of Parliament.
- 3 (4) Any reference in this Order to any enactment, shall be construed as a reference to that enactment as amended by any subsequent enactment.

Parking Places

4 Each of the Parking Places specified in Column 1 of Schedule 2 and as identified and defined in the Off-Street Plans may only be used, subject to the provisions of this Order, for the parking of such classes of Vehicles in such

positions, on such days and during such hours as are specified in Columns 2 to 5 respectively of Schedule 2 in relation to that Parking Place.

Class, Position, and Parking Charges

5 (1) A vehicle shall not enter or remain in a Parking Place unless the said Vehicle falls within a class specified in Column 2 of Schedule 2 in relation to that Parking Place.

5 (2) A vehicle shall not enter or remain in a Parking Bay reserved by means of a sign or surface marking for use by Vehicles of a class specified in column 2 of schedule 2 unless the said Vehicle is of the class for the said Parking Bay is so reserved.

5 (3) A vehicle shall be wholly parked within the limits of a Parking Bay indicated in Column 3 of Schedule 2 in relation to the Parking Place in which that Parking Bay is situated.

5 (4) Save as provided for in Article 7(5), the driver of a Vehicle on causing that Vehicle to remain in a Parking Place at any time during the chargeable hours specified in column 5 of Schedule 2 in relation to the Parking Place in which that Vehicle is parked shall pay, or cause to be paid, the appropriate Parking Charge.

Maximum Period for which a Vehicle may remain in a Parking Place and Restrictions on Return Periods

6 (1) Except with the permission of the Council, no Vehicle shall remain in a Parking Place for longer than the maximum period stipulated in Column 6 of Schedule 2 in relation to that Parking Place.

6 (2) No vehicle that has been caused to remain in a Parking Bay shall (except with the permission of the Council) remain in that Parking Bay save in accordance with that which is stipulated by any sign or surface marking in relation to that Parking Bay.

6 (3) No Vehicle that has been caused to remain in a Parking Bay shall (except with the permission of the Council) be returned to any Parking Bay within the same Parking Place, before the expiry of any period of time stipulated in Column 7 of Schedule 2 in relation to that Parking Place or as is stipulated by any sign or surface marking in relation to that Parking Bay.

6 (4) Except with the permission of the Council, no Electric Vehicle shall remain in an Electric Vehicle Parking Bay for longer than the maximum period stipulated by the signage in relation to that Parking Bay.

Use of Parking Places

7 (1) Save as provided for in Article 7(5), no Vehicle shall remain in a Parking Place unless it displays in the Relevant Position at all times while it remains in

that Parking Place a valid Parking Ticket issued by a Ticket Machine, a Civil Enforcement Officer or as otherwise deemed appropriate by the Council, unless payment for parking at that location has been made by Pay By Phone or a Permit is valid for the Vehicle.

7 (2) Save as provided for in Article 7(5), no Vehicle shall remain in a Parking Place after the expiry date and time identified on the Parking Ticket displayed in the Relevant Position in that Vehicle or where payment at that location has been made by Pay By Phone, no Vehicle shall remain in a Parking Place after the expiry of the Parking Period for that location paid using the Pay By Phone system.

7 (3) A vehicle shall not remain in a Parking Place or part thereof that has been reserved by means of a sign or surface marking for use by:

Permit holder Vehicles

(a) specific Permit holders holding a valid Permit for the said Parking Place of part thereof unless the said Vehicle displays a valid permit for that Parking Place or part thereof in accordance with Article 7(5)(c);

Disabled Person's Badge holders

(b) Disabled Person's Badge holders unless the said Vehicle displays a valid disabled persons badge in accordance with Article 7(5)(c);

Loading and Unloading

(c) Vehicles in connection with loading and unloading unless the said Vehicle is being loaded and/or unloaded in accordance with Article 7(5)(f);

Coaches, Motor Cycles, Camper Vans, Minibuses, Licensed Taxis or Goods Vehicles

(d) Coaches, Motor Cycles, Camper Vans, Minibuses, Licensed Taxis, or Goods Vehicles unless the said Vehicle is of the class for which that Parking Place or part thereof is so reserved;

Electric Vehicles

(e) Electric Vehicles unless the said Vehicle is of the class for which that Parking Place or part thereof is so reserved and an active charge session is taking place.

7 (4) A parking ticket is not valid if it is transferred between Parking Places or between Vehicles.

7 (5) The following exemptions apply in relation to Articles 5(4), 7(1) and 7(2) in the specified circumstances:

- (a) A Vehicle at all times while it remains in a Parking Place a valid season ticket in the Relevant Position, issued in accordance with Article 9 for the specified Parking Place(s) for which the Season Ticket was issued and in which the said Vehicle is situated;
- (b) A vehicle displaying at all times while it remains in a Parking Place a valid Disabled Person's Badge and Parking Disc in the Relevant Position provided that the said Parking Disc displays the quarter hour period during which the period of exempted parking began. This exemption shall not apply where such a Vehicle remains in a Parking Place for a period exceeding 3 hours in which case the Parking Charge in respect of the full duration of time that the Vehicle was first parked in the Parking Place shall be due and payable. A Vehicle shall be deemed to remain in a Parking Place if it departs from and returns to any Parking Bay within that Parking Place within 1 hour. A Vehicle displaying a valid Disabled Person's Badge may park in any standard Pay and Display Parking Bay or disabled Parking Bay.
- (c) A Vehicle displaying at all times while it remains in a Parking Place a valid permit issued in accordance with Article 10 in the Relevant Position and complying with the particulars stipulated thereon;
- (d) A Motor Cycle parked in a Parking Bay identified by signs and/or surface marking as provided for use of Motor Cycles only';
- (e) A vehicle parked in an area identified by signs and/or surface marking as provided in connection with the depositing of appropriate items in recycling receptacles position in a Parking Place for so long as is reasonably required to deposit the same items;
- (f) A Vehicle parked in a Parking Bay identified by signs and/or surface markings as provided for use that in connection with loading and/or unloading provided that goods are being continually loaded onto the Vehicle or unloaded from the Vehicle and that does not remain longer than the period stipulated on any nearby sign relation to that Parking Bay.
- (g) A Vehicle parked in a Limited Waiting Bay identified by signs and/or surface markings that allow a period of free parking.

7 (6) For the purposes of this Article a Vehicle shall be deemed to remain in a Parking Place if it departs from and returns to that Parking Place within one hour.

7 (7) No Vehicle shall remain on double yellow lines in a Parking Place, including utilising common exemptions found on double yellow lines on the Public Highway.

The exemption for Loading or Unloading and Disabled person's Badge used on the Public Highway are not used in any Parking Place without prior agreement from the Council.

Closure or Suspension of use of a Parking Place

8 (1) Notwithstanding any of the provisions of this Order the Council may by notice displayed on or near a Parking Place close or suspend that Parking Place or any part thereof for any period and may use such Parking Place or any part thereof for any purpose.

8 (2) No vehicle shall enter or remain in a Parking Place or any part thereof that has been closed or suspended as described in paragraph (1) of this Article without the prior consent in writing of the Council.

8 (3) No Vehicle shall enter or remain in a Parking Place outside the day of operation specified in Column 4 of Schedule 2 in relation to that Parking Place.

8 (4) No Vehicle shall enter or remain in a Parking Place outside the days of operation specified in Column 5 of Schedule 2 in relation to that Parking Place

Season Tickets

9 (1) The Council may at its discretion issue season tickets for use in Parking Places which shall permit the Vehicle specified on the Season Ticket to park without payment of the Parking Charge. Where applicable, the charge for such season ticket is as stipulated in Column 8 of Schedule 2 in relation to that Parking Place (or such other amount as shall be notified in accordance with Section 35C(1) of the 1984 Act) and shall be payable in advance.

9 (2) A season ticket may be used only in respect of the Vehicle or one of the vehicles for which it is used

9 (3) A Vehicle is not parked in accordance with this Article unless the Vehicle on the Season Ticket is made the Active Vehicle on the Permit Account.

Permits

10 (1) The Council may at its discretion issue permits which shall permit Vehicle(s) to park in a Parking Place or places without payment of the Parking Charge.

10 (2) A Permit may be used only in respect of the Vehicle or Vehicles for which it is issued.

10 (3) No person shall use a Permit otherwise than in accordance with this Order, any other conditions set out on the Permit or any conditions set out in an application form in respect of the said Permit.

10 (4) Any Permit issued by the Council remains the property of the Council and is not transferable to another Vehicle or Parking Place.

10 (5) A Vehicle is not parked in accordance with this Article unless the Permit is displayed in the Relevant Position.

Penalty Charge

11 If a Vehicle remains in a Parking Place in contravention of any Article contained within this Order, a Penalty Charge will be payable by the owner of that Vehicle.

Other Provisions

12 The Driver of a Vehicle using a Parking Place shall stop the engine as soon as the said Vehicle is in position in the Parking Place and shall not start the engine except when about the change the position of the Vehicle or to depart from that Parking Place.

13 A Vehicle shall not cause an obstruction in a Parking Place.

14 A Vehicle may only use a Disabled Person's Badge in a Parking Place, where the Vehicle is parked in accordance with Article 7(5)(b).

15 (1) No person shall use a Vehicle while it is in a Parking Place in connection with the sale of any article to persons in or near that Parking Place or in connection with the selling or offering for hire of his skill or service.

15 (2) No person shall leave any Vehicle in a Parking Place in connection with the sale or advertising or displaying for sale of that or any other Vehicle.

15 (3) No person shall use any part of a Parking Place or any Vehicle left in a Parking Place:

- (a) For sleeping or camping or cooking;
- (b) For the purpose of servicing or washing any Vehicle or part thereof other than is reasonably necessary to enable that the Vehicle to depart from that Parking Place.

16 No person shall in a Parking Place wantonly shout or otherwise make any loud noise to the disturbance or annoyance of users of the Parking Place or residents of premises in the neighbourhood.

17 No person shall in a Parking Place use any threatening, abusive, or insulting language, gesture or conduct with intent to put any person in fear or so as to occasion a breach of the peace or whereby a breach of the peace is likely to be occasioned.

18 In a Parking Place, no person shall:

- (a) Erect or cause to be erected any tent, booth, stand, building or other structure without the written consent of the Council;
- (b) Light or cause or permit to be lit any fire.

19 The driver of a Vehicle shall not use a Parking Place as a means of passage proceeding from one road to another.

20 The driver of a Vehicle using a Parking Place shall not sound any audible warning instrument save in circumstances where such action is reasonably required.

21 (1) If a Vehicle is left in a Parking Place other than in accordance with the provisions of this Order a person authorised by the Council in that behalf may alter or cause to be altered the position of that Vehicle so that its position is in accordance with said provisions.

21 (2) If a Vehicle is left in a Parking Place in contravention of any of the foregoing provisions of this Order a person authorised by the Council in that behalf may remove the said Vehicle from that Parking Place or arrange for such removal.

21 (3) For the purpose of meeting the requirement of an emergency a person authorised in that behalf by the Council or a police constable in uniform may alter or cause to be altered the position of a Vehicle from that Parking Place.

21 (4) Any person altering or causing the alteration of the position of a Vehicle by virtue of paragraph (1) of this Article or removing or causing the removal of a Vehicle by virtue of paragraphs (2) or (3) of this Article may do so by towing or driving the said Vehicle or in such other manner as he may think reasonable necessary to enable the position of the said Vehicle to be altered or the said Vehicle to be removed.

21 (5) Any person removing or arranging for the removal of a Vehicle by virtue of paragraph (2) or (3) of this Article shall make arrangements as he considers to be reasonably necessary for the safety of the said Vehicle in the place to which it is removed.

22 Where in a Parking Place signs are erected or surface markings are laid for the purpose of

- (a) indicating the entrance to or exit from the Parking Place; or
- (b) indicating that a Vehicle is using the Parking Place shall proceed in a specified direction with the Parking Place

no person shall drive or permit to be driven any Vehicle:

- (i) so that it enters the Parking Place otherwise than by an entrance or leave the Parking Place otherwise than by an exit so indicated; or
- (ii) in a direction other than so specified

23 No person shall except with the permission of a person authorised by the Council in that behalf drive or permit to be driven any Vehicle in a Parking Place for any purpose other than the purpose of leaving that Vehicle in the Parking Place in accordance with the provisions of this Order or for the purpose of departing from the Parking Place.

24 No person shall in any Parking Place without the consent of the Council distribute or affix to any Vehicle left in that Parking Place any literature or leaflets.

GIVEN under the COMMON SEAL of)
the ASHFORD BOROUGH COUNCIL)
Which was hereunto affixed this day)

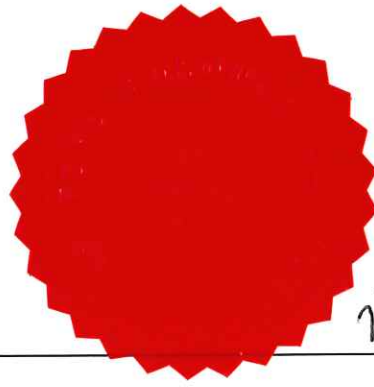

21,756

-Mayor

A handwritten signature in black ink, consisting of several loops and a long tail.

Solicitor

21st August 2024

SCHEDULE 1

The list of Traffic Orders revoked by this order:

- (i) Ashford Borough Council (Off-Street Parking Places) (Amendment No.3) Order 2022
- (ii) Ashford Borough Council (Off-Street Parking Places) (Amendment No.2) Order 2022
- (iii) Ashford Borough Council (Off-Street Parking Places) (AMENDMENT 1) Order 2021
- (iv) ASHFORD BOROUGH COUNCIL (OFF STREET PARKING PLACES) CONSOLIDATED ORDER 2019

SCHEDULE 2

1 Name of Parking Place	2 Classes of Vehicle	3 Position in which Vehicles may park		4 Days of operation of Parking Place	5 Chargeable hours and hours of operation	6 Maximum period for which Vehicles may remain	7 Restrictions on periods of return	8 Parking period and scale of Parking Charges
1. Adley's Yard Car Park, Ashford	Motor vehicles not exceeding 3.5 tonnes maximum gross weight and not exceeding 2.1 meters in height underneath building	Wholly within a Parking Bay		Monday to Saturday excluding bank holidays.	Chargeable Hours 08:00-18:00 Hours of Operations 24 hours	No limit	None	Minimum payment: 55p (30m) Per Hour: £1.10 Up to 4 hours: £4.40 Over 4 hours: £4.80 Payable in 5p increments. Unreserved Season Ticket Charges 12 months: £394

1 Name of Parking Place	2 Classes of Vehicle	3 Position in which Vehicles may park	4 Days of operation of Parking Place	5 Chargeable hours and hours of operation	6 Maximum period for which Vehicles may remain	7 Restrictions on periods of return	8 Parking period and scale of Parking Charges
2. Civic Centre & Stour Centre Car Park, Ashford	Motor vehicles not exceeding 3.5 tonnes maximum gross weight and not exceeding 2.1 meters in height underneath building	Wholly within a Parking Bay	All days	Chargeable Hours 08:00-18:00 Hours of Operations 24 hours	No limit	None	Minimum payment: 65p (30m) Per Hour: £1.30 Up to 4 hours: £5.20 Over 4 hours Mon-Fri: £13.20 Over 4 hours Sat-Sun: £6.00 Payable in 5p increments.
2. Civic Centre & Stour Centre Car Park, Ashford	Coaches	Wholly within a Parking Bay	All days	Chargeable Hours 08:00-18:00 Hours of Operations 24 hours	No limit	None	Minimum payment: £2.00 per hour Up to 4 hours: £8.00 Over 4 hours: £13.20
2. Civic Centre & Stour Centre Car Park, Ashford	Motor Cycle	Wholly within a Parking Bay	All days	Chargeable Hours Not applicable Hours of Operations 24 hours	No limit	None	No charge

1 Name of Parking Place	2 Classes of Vehicle	3 Position in which Vehicles may park	4 Days of operation of Parking Place	5 Chargeable hours and hours of operation	6 Maximum period for which Vehicles may remain	7 Restrictions on periods of return	8 Parking period and scale of Parking Charges
3. Dover Place Car Park, Ashford	Motor vehicles not exceeding 3.5 tonnes maximum gross weight and not exceeding 2.15 meters in height	Wholly within a Parking Bay	All days	Chargeable Hours 08:00-18:00 Hours of Operations 24 hours	No limit	None	Minimum payment: 65p (30m) Per Hour: £1.30 Up to 4 hours: £5.20 Over 4 hours £6.00 Payable in 5p increments.
3. Dover Place Car Park, Ashford	Motor Cycle	Wholly within a Parking Bay	All days	Chargeable Hours Not applicable Hours of Operations 24 hours	No limit	None	No charge

1 Name of Parking Place	2 Classes of Vehicle	3 Position in which Vehicles may park	4 Days of operation of Parking Place	5 Chargeable hours and hours of operation	6 Maximum period for which Vehicles may remain	7 Restrictions on periods of return	8 Parking period and scale of Parking Charges
4. Edinburgh Road Car Park, Ashford	Motor vehicles not exceeding 3.5 tonnes maximum gross weight and not exceeding 2.1 meters in height	Wholly within a Parking Bay	Monday – Saturday Excluding bank holidays	Chargeable Hours 08:00-15:00 Hours of Operations 24 hours	No limit	None	Minimum payment: 65p (30m) Per Hour: £1.30 Up to 4 hours: £5.20 Over 4 hours £6.00 Payable in 5p increments. 20p discount if using pay be phone
4. Edinburgh Road Car Park, Ashford	Motor vehicles not exceeding 3.5 tonnes maximum gross weight and not exceeding 2.1 meters in height	Wholly within a Parking Bay	Sunday	Chargeable Hours Not applicable Hours of Operations 24 hours	No limit	None	No charge

1 Name of Parking Place	2 Classes of Vehicle	3 Position in which Vehicles may park	4 Days of operation of Parking Place	5 Chargeable hours and hours of operation	6 Maximum period for which Vehicles may remain	7 Restrictions on periods of return	8 Parking period and scale of Parking Charges
5. Elwick Place Car Park, Ashford	Motor vehicles not exceeding 3.5 tonnes maximum gross weight	Wholly within a Parking Bay	All days	Chargeable Hours 09:00-15:00 Hours of Operations 24 hours	No limit	None	Minimum payment: £2.60 (2hrs) Per Hour: £1.30 Up to 5 hours: £6.00 Over 5 hours £13.20 Payable in 5p increments.
5. Elwick Place Car Park, Ashford	Motor Cycles	Wholly within a Parking Bay	All days	Chargeable Hours Not applicable Hours of Operations 24 hours	No limit	None	No charge

1	Name of Parking Place	2	Classes of Vehicle	3	Position in which Vehicles may park	4	Days of operation of Parking Place	5	Chargeable hours and hours of operation	6	Maximum period for which Vehicles may remain	7	Restrictions on periods of return	8	Parking period and scale of Parking Charges
	6. Elwick Road Car Park, Ashford	Motor vehicles not exceeding 3.5 tonnes maximum gross weight and not exceeding 2.1 meters in height	Wholly within a Parking Bay	All days	Chargeable Hours 08:00-15:00 Hours of Operations 24 hours	No limit	None	Minimum payment: 65p (30m) Per Hour: £1.30 Up to 4 hours: £5.20 Over 4 hours £6.00 Payable in 5p increments.							
	6. Elwick Road Car Park, Ashford	Motor Cycles	Wholly within a Parking Bay	Monday – Saturday – Excluding bank holidays	Chargeable Hours Not applicable Hours of Operations 24 hours	No limit	None	No charge							

1	Name of Parking Place	2	Classes of Vehicle	3	Position in which Vehicles may park	4	Days of operation of Parking Place	5	Chargeable hours and hours of operation	6	Maximum period for which Vehicles may remain	7	Restrictions on periods of return	8	Parking period and scale of Parking Charges
	7. Flour Mills Car Park, Ashford	Motor vehicles not exceeding 3.5 tonnes maximum gross weight.	Wholly within a Parking Bay	All days	Chargeable Hours 08:00-18:00 Hours of Operations 24 hours	No limit	None	Minimum payment: 65p (30m) Per Hour: £1.30 Up to 4 hours: £5.20 Over 4 hours £6.00 Payable in 5p increments.							

1 Name of Parking Place	2 Classes of Vehicle	3 Position in which Vehicles may park	4 Days of operation of Parking Place	5 Chargeable hours and hours of operation	6 Maximum period for which Vehicles may remain	7 Restrictions on periods of return	8 Parking period and scale of Parking Charges
8. Station Road Car Park, Ashford	Motor vehicles not exceeding 3.5 tonnes maximum gross weight and not exceeding 2.15 meters in height	Wholly within a Parking Bay	Monday - Saturday	Chargeable Hours 08:00-18:00 Hours of Operations 24 hours	No limit	None	Minimum payment: 65p (30m) Per Hour: £1.30 Up to 4 hours: £5.20 Over 4 hours £6.00 Payable in 5p increments.
8. Station Road Car Park, Ashford	Motor vehicles not exceeding 3.5 tonnes maximum gross weight and not exceeding 2.15 meters in height	Wholly within a Parking Bay	Sunday	Chargeable Hours 08:00-15:00 Hours of Operations 24 hours	No limit	None	Minimum payment: 65p (30m) Per Hour: £1.30 Up to 4 hours: £5.20 Over 4 hours £6.00 Payable in 5p increments.
8. Station Road Car Park, Ashford	Motor vehicles not exceeding 3.5 tonnes maximum gross weight and not exceeding 2.15 meters in height	Wholly within a Parking Bay	Bank holidays	Chargeable Hours 08:00-15:00 Hours of Operations 24 hours	No limit	None	Minimum payment: 65p (30m) Per Hour: £1.30 Up to 4 hours: £5.20 Over 4 hours £6.00 Payable in 5p increments.

1 Name of Parking Place	2 Classes of Vehicle	3 Position in which Vehicles may park	4 Days of operation of Parking Place	5 Chargeable hours and hours of operation	6 Maximum period for which Vehicles may remain	7 Restrictions on periods of return	8 Parking period and scale of Parking Charges
9. Vicarage Lane Car Park, Ashford	Motor vehicles not exceeding 3.5 tonnes maximum gross weight and not exceeding 2.15 meters in height	Wholly within a Parking Bay	All days	Chargeable Hours 08:00-18:00 Hours of Operations 24 hours	No limit	None	Minimum payment: 65p (30m) Per Hour: £1.30 Up to 4 hours: £5.20 Over 4 hours £13.20 Payable in 5p increments.
9. Vicarage Lane Car Park, Ashford	Motor Cycles	Wholly within a Parking Bay	All days	Chargeable Hours Not applicable Hours of Operations 24 hours	No limit	None	No charge

1 Name of Parking Place	2 Classes of Vehicle	3 Position in which Vehicles may park	4 Days of operation of Parking Place	5 Chargeable hours and hours of operation	6 Maximum period for which Vehicles may remain	7 Restrictions on periods of return	8 Parking period and scale of Parking Charges
10. Victoria Road Car Park, Ashtford	Motor vehicles not exceeding 3.5 tonnes maximum gross weight and not exceeding 2.15 meters in height	Wholly within a Parking Bay	All days	Chargeable Hours 08:00-18:00 Hours of Operations 24 hours	No limit	None	Minimum payment: 65p (30m) Per Hour: £1.30 Up to 4 hours: £5.20 Over 4 hours £6.00 Payable in 5p increments.
10. Victoria Road Car Park, Ashtford	Motor Cycles	Wholly within a Parking Bay	All days	Chargeable Hours Not applicable Hours of Operations 24 hours	No limit	None	No charge

1 Name of Parking Place	2 Classes of Vehicle	3 Position in which Vehicles may park	4 Days of operation of Parking Place	5 Chargeable hours and hours of operation	6 Maximum period for which Vehicles may remain	7 Restrictions on periods of return	8 Parking period and scale of Parking Charges
11. Bridewell Lane Car Park, Tenterden	Motor vehicles not exceeding 3.5 tonnes maximum gross weight and not exceeding 2.1 meters in height	Wholly within a Parking Bay	Monday – Saturday	Chargeable Hours 08:00-18:00 Hours of Operations 24 hours	No limit	None	Minimum payment: 65p (30m) Per Hour: £1.30 Up to 4 hours: £5.20 Over 4 hours £6.00 Payable in 5p increments.
11. Bridewell Lane Car Park, Tenterden	Motor vehicles not exceeding 3.5 tonnes maximum gross weight and not exceeding 2.1 meters in height	Wholly within a Parking Bay	Sunday & Bank Holidays	Chargeable Hours Not applicable Hours of Operations 24 hours	No limit	None	No charge

1 Name of Parking Place	2 Classes of Vehicle	3 Position in which Vehicles may park	4 Days of operation of Parking Place	5 Chargeable hours and hours of operation	6 Maximum period for which Vehicles may remain	7 Restrictions on periods of return	8 Parking period and scale of Parking Charges
12. Recreation Ground Road Car Park, Tenterden	Motor vehicles not exceeding 3.5 tonnes maximum gross weight	Wholly within a Parking Bay	All days	Chargeable Hours 08:00-18:00 Hours of Operations 24 hours	No limit	None	Minimum payment: 65p (30m) Per Hour: £1.30 Up to 4 hours: £5.20 Over 4 hours £13.20 Payable in 5p increments.
12. Recreation Ground Road Car Park, Tenterden	Motor cycles	Wholly within a Parking Bay	All days	Chargeable Hours Not applicable Hours of Operations 24 hours	No limit	None	No charge

1	2	3	4	5	6	7	8
Name of Parking Place	Classes of Vehicle	Position in which Vehicles may park	Days of operation of Parking Place	Chargeable hours and hours of operation	Maximum period for which Vehicles may remain	Restrictions on periods of return	Parking period and scale of Parking Charges
13. Station Road (West) Car Park, Tenderden	Motor vehicles not exceeding 3.5 tonnes maximum gross weight	Wholly within a Parking Bay	All days	Chargeable Hours 08:00-18:00 Hours of Operations 24 hours	No limit	None	Minimum payment: 65p (30m) Per Hour: £1.30 Up to 4 hours: £5.20 Over 4 hours £13.20 Payable in 5p increments.
13. Station Road (East) Car Park, Tenderden	Motor vehicles not exceeding 3.5 tonnes maximum gross weight	Wholly within a Parking Bay	All days	Chargeable Hours 08:00-18:00 Hours of Operations 24 hours	No limit	None	Minimum payment: 65p (30m) Per Hour: £1.30 Up to 4 hours: £5.20 Over 4 hours £13.20 Payable in 5p increments.
13. Station Road (East) Car Park, Tenderden	Coaches	Wholly within a Parking Bay	All days	Chargeable Hours 08:00-18:00 Hours of Operations 24 hours	No limit	None	Up to 3 hours: Free 3 hours: £8.10 4 hours+: £13.20

1	2	3	4	5	6	7	8
Name of Parking Place	Classes of Vehicle	Position in which Vehicles may park	Days of operation of Parking Place	Chargeable hours and hours of operation	Maximum period for which Vehicles may remain	Restrictions on periods of return	Parking period and scale of Parking Charges
14. Leisure Centre Car Park, Tenterden	Motor vehicles not exceeding 3.5 tonnes maximum gross weight	Wholly within a Parking Bay	All days	Chargeable Hours 08:00-18:00 Hours of Operations 24 hours	No limit	None	Minimum payment: 65p (30m) Per Hour: £1.30 Up to 4 hours: £5.20 Over 4 hours £13.20 Payable in 5p increments.
14. Leisure Centre Car Park, Tenterden	Coaches	Wholly within a Parking Bay	All days	Chargeable Hours 08:00-18:00 Hours of Operations 24 hours	No limit	None	Minimum payment: £2.00 Per hour: £2.00 Up to 4 hours: £8.00 Over 4 hours: £13.20
14. Leisure Centre Car Park, Tenterden	Motor cycles	Wholly within a Parking Bay	All days	Chargeable Hours Not applicable Hours of Operations 24 hours	No limit	None	No charge

1	2	3	4	5	6	7	8
Name of Parking Place	Classes of Vehicle	Position in which Vehicles may park	Days of operation of Parking Place	Chargeable hours and hours of operation	Maximum period for which Vehicles may remain	Restrictions on periods of return	Parking period and scale of Parking Charges
15. Church Hill Car Park, Kingsnorth	Motor vehicles not exceeding 3.5 tonnes maximum gross weight	Wholly within a Parking Bay	All days	Hours of Operations 24 hours	23 hours together at one time	None	No Charge
16. Gregory Court Car Park, Wye	Motor vehicles not exceeding 3.5 tonnes maximum gross weight	Wholly within a Parking Bay	All days	Hours of Operations 24 hours	23 hours together at one time	None	No Charge
17. Market Place Car Park, Charing	Motor vehicles not exceeding 3.5 tonnes maximum gross weight	Wholly within a Parking Bay	All days	Hours of Operations 24 hours	23 hours together at one time	None	No Charge
18. Marsh Road Car Park, Hamstreet	Motor vehicles not exceeding 3.5 tonnes maximum gross weight	Wholly within a Parking Bay	All days	Hours of Operations 24 hours	23 hours together at one time	None	No Charge
19. Rock Hill Road Car Park, Egerton	Motor vehicles not exceeding 3.5 tonnes maximum gross weight	Wholly within a Parking Bay	All days	Hours of Operations 24 hours	23 hours together at one time	None	No Charge

1 Name of Parking Place	2 Classes of Vehicle	3 Position in which Vehicles may park	4 Days of operation of Parking Place	5 Chargeable hours and hours of operation	6 Maximum period for which Vehicles may remain	7 Restrictions on periods of return	8 Parking period and scale of Parking Charges
20. Station Road Car Park, Charing	Motor vehicles not exceeding 3.5 tonnes maximum gross weight	Wholly within a Parking Bay	All days	Hours of Operations 24 hours	23 hours together at one time	None	No Charge
21. Taylors Hill Car Park, Chilham	Motor vehicles not exceeding 3.5 tonnes maximum gross weight	Wholly within a Parking Bay	All days	Hours of Operations 24 hours	23 hours together at one time	None	No Charge
22. Taylors Hill Car Park, Chilham	Coaches	Wholly within a coach Parking Bay	All days	Hours of Operations 24 hours	23 hours together at one time	None	No Charge
23. International House Car Park, Ashford	Motor vehicles not exceeding 3.5 tonnes maximum gross weight	Wholly within a Parking Bay	All days	Hours of Operations 24 hours	23 hours together at one time	None	No Charge
23. International House Car Park, Ashford	Motor Cycles	Wholly within a Parking Bay	All days	Hours of Operations 24 hours	23 hours together at one time	None	No charge

Adley's Yard Car Park

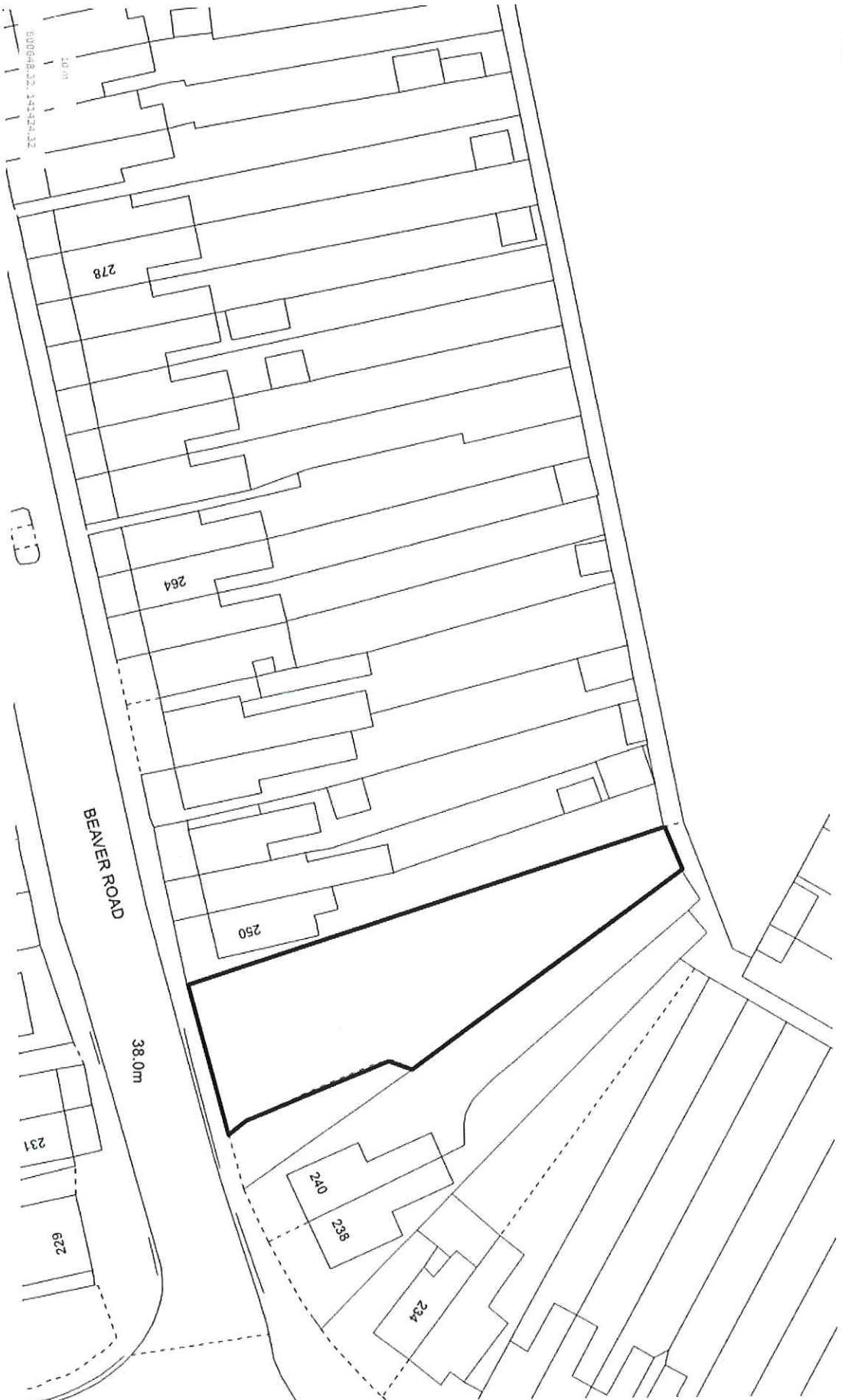

Church Hill Car Park (Kingsnorth)

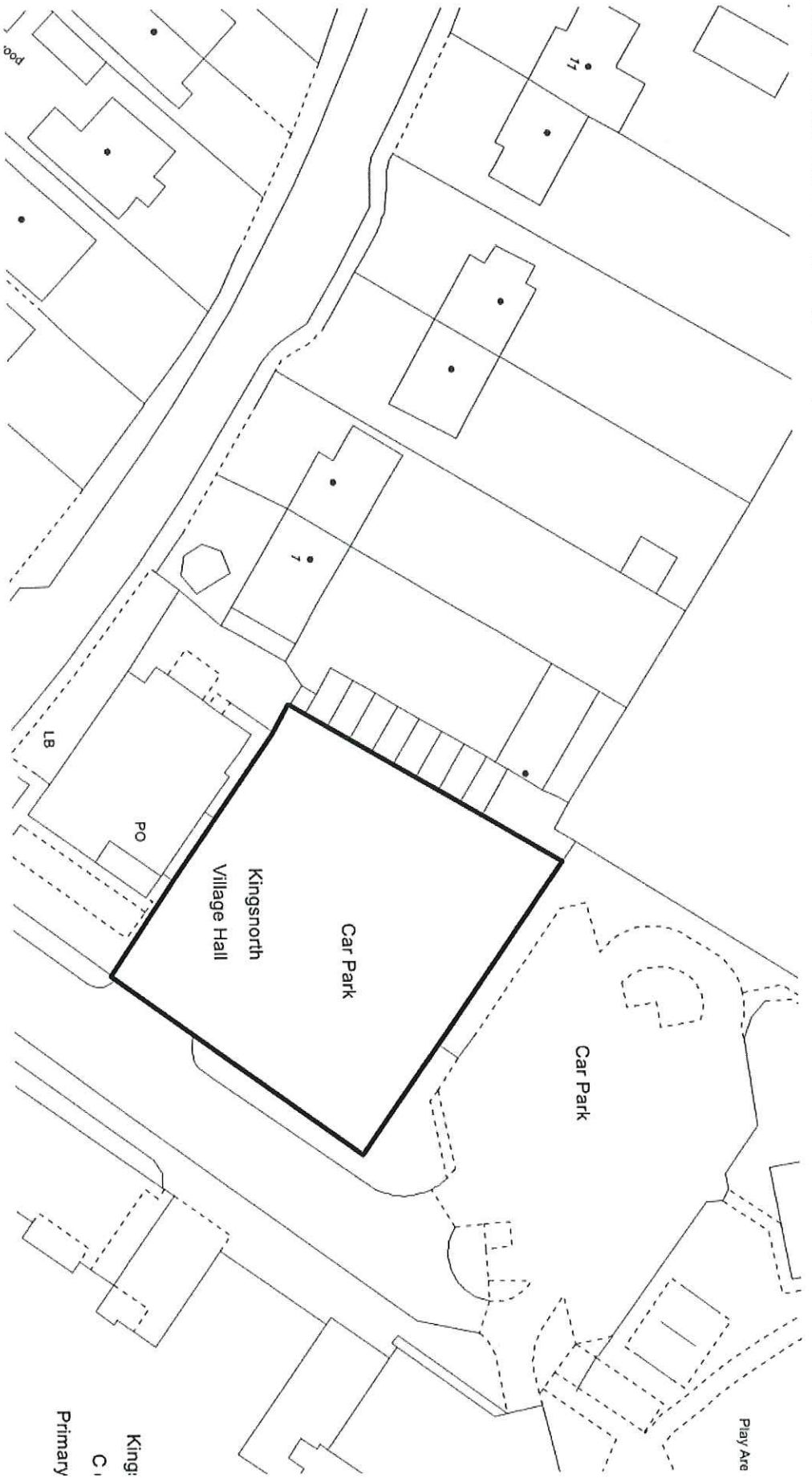

King:
C
Primary

Civic Centre & Stour Centre Car Park

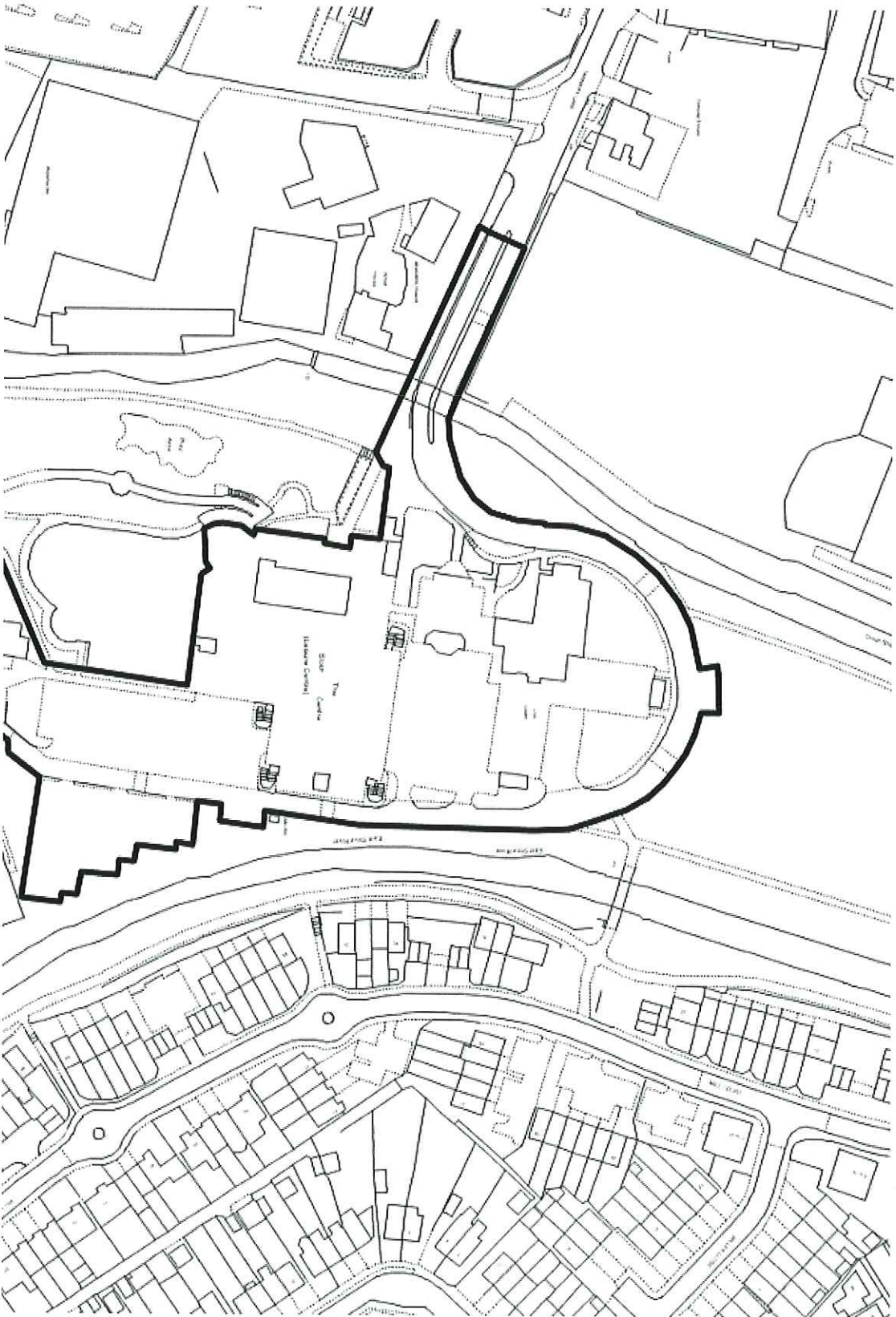



Dover Place Car Park

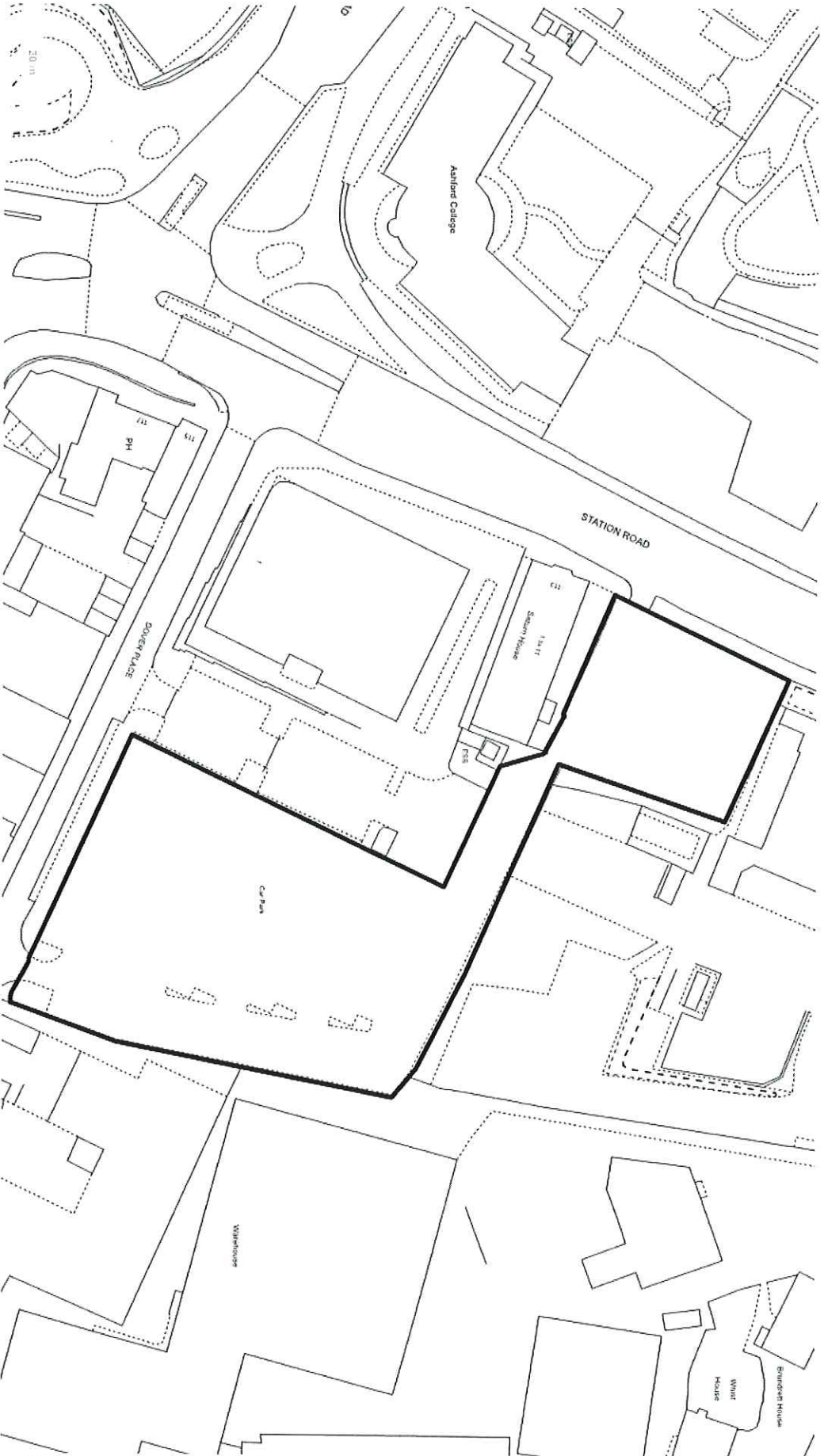

Edinburgh Road Car Park

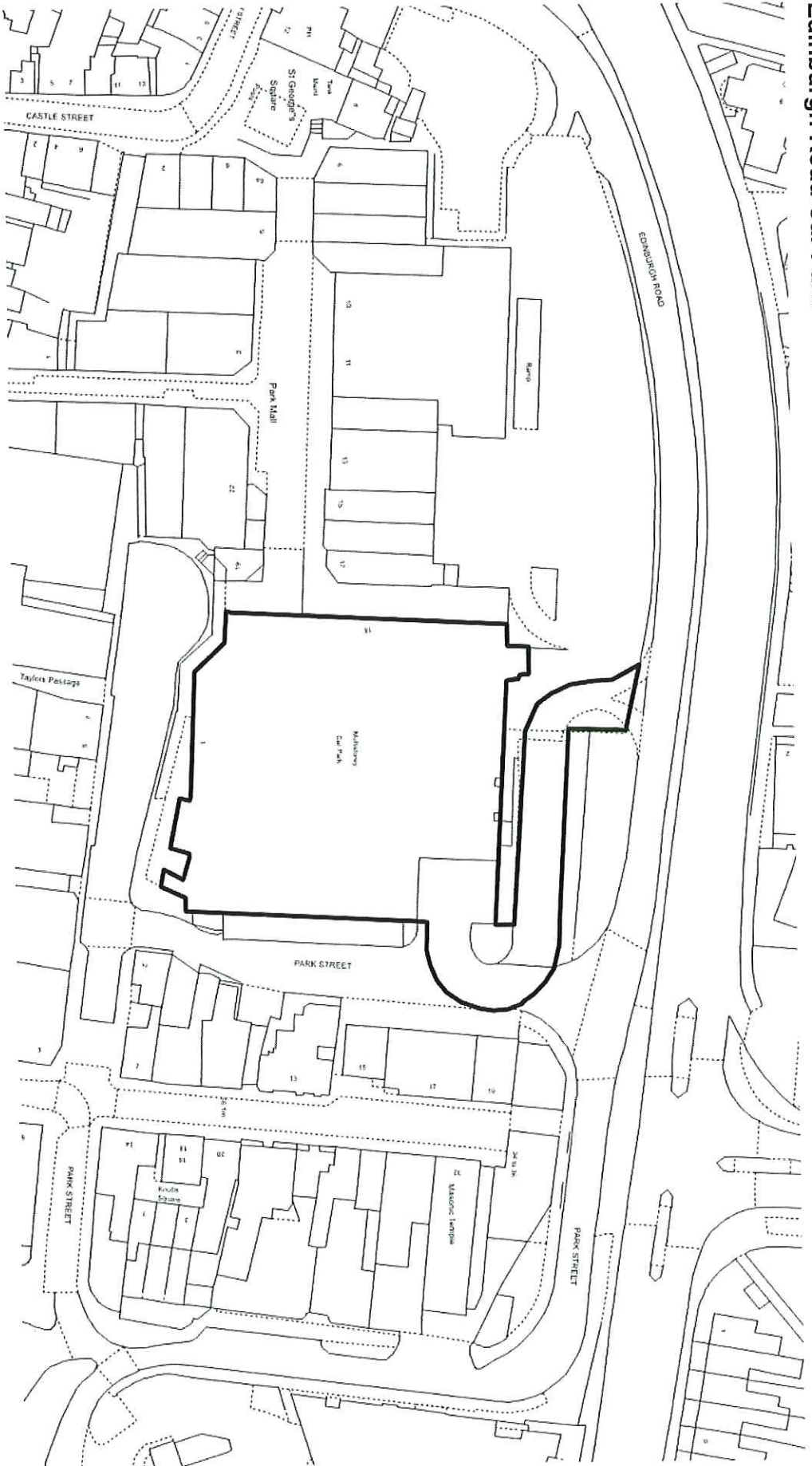

Elwick Place Car Park

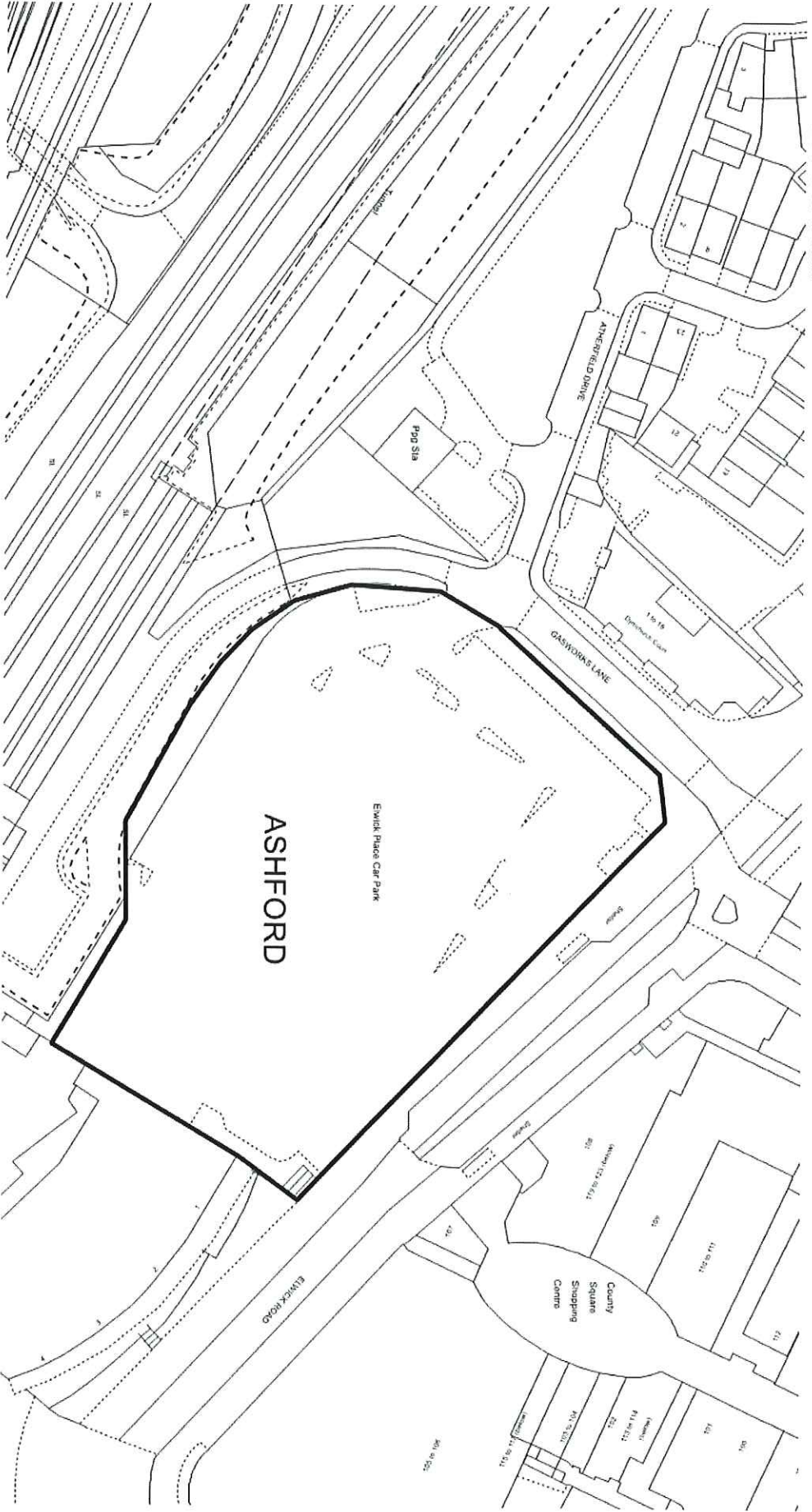

Flour Mills Car Park

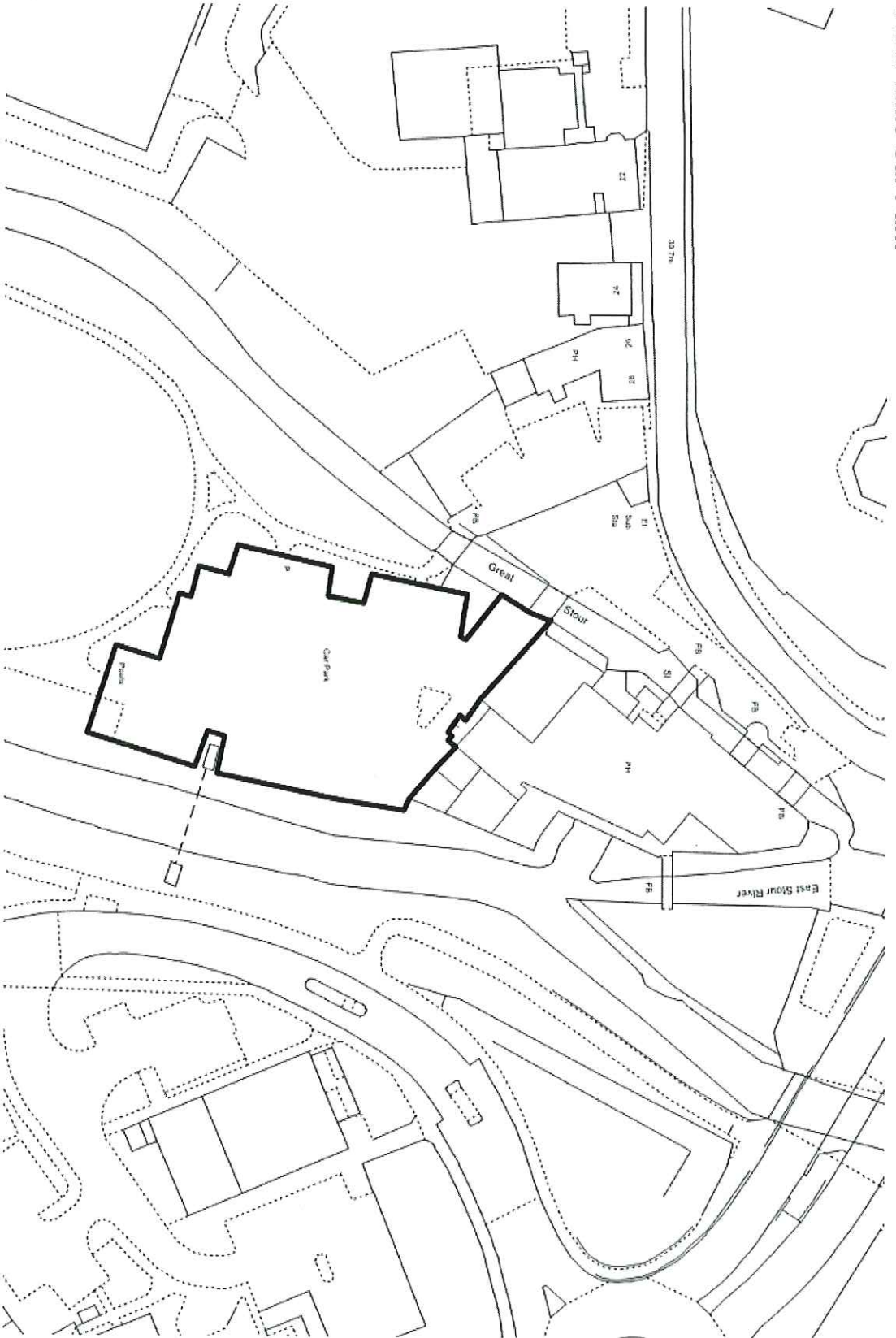

International House Car Park

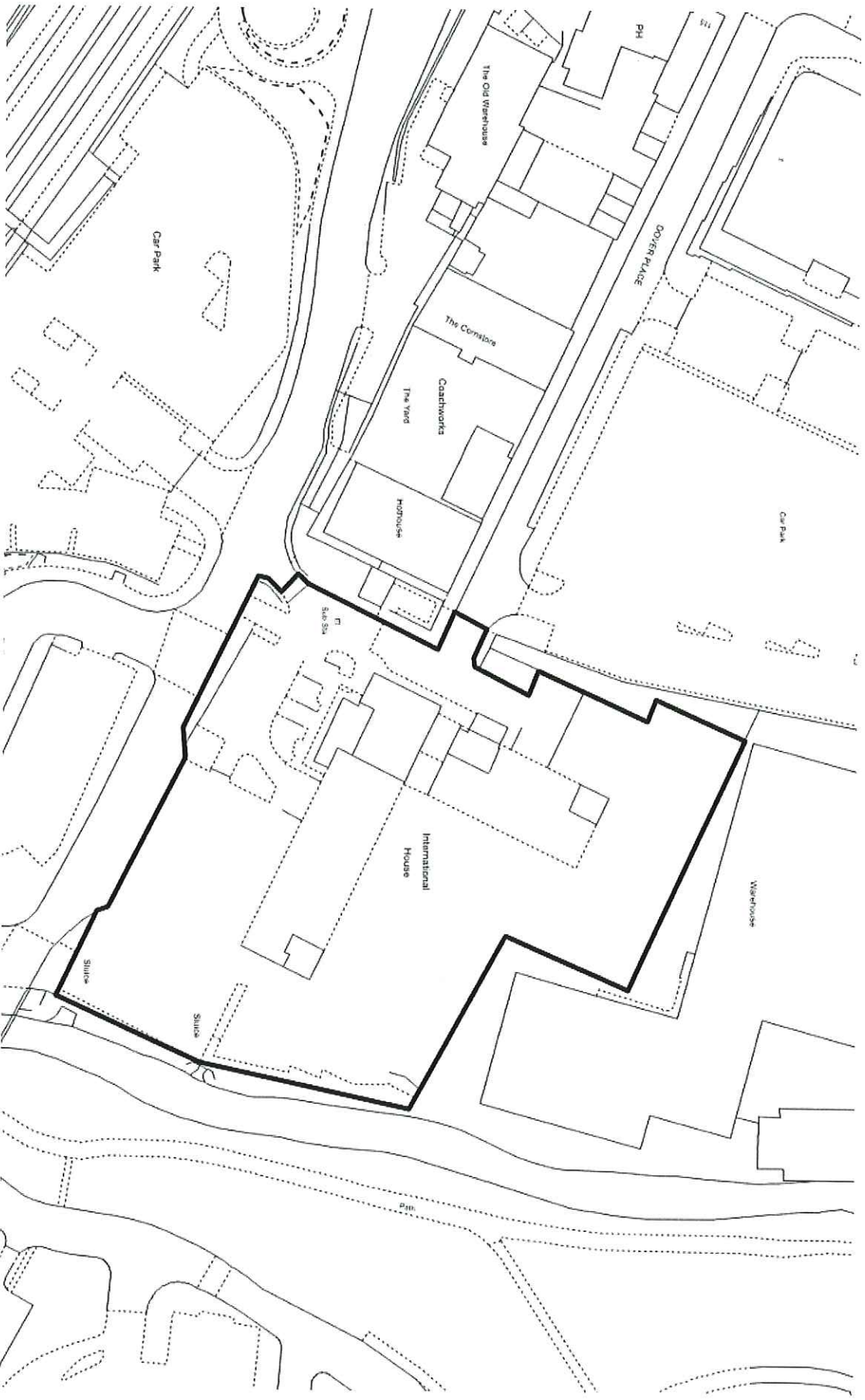

Leisure Centre Car Park, Tenterden

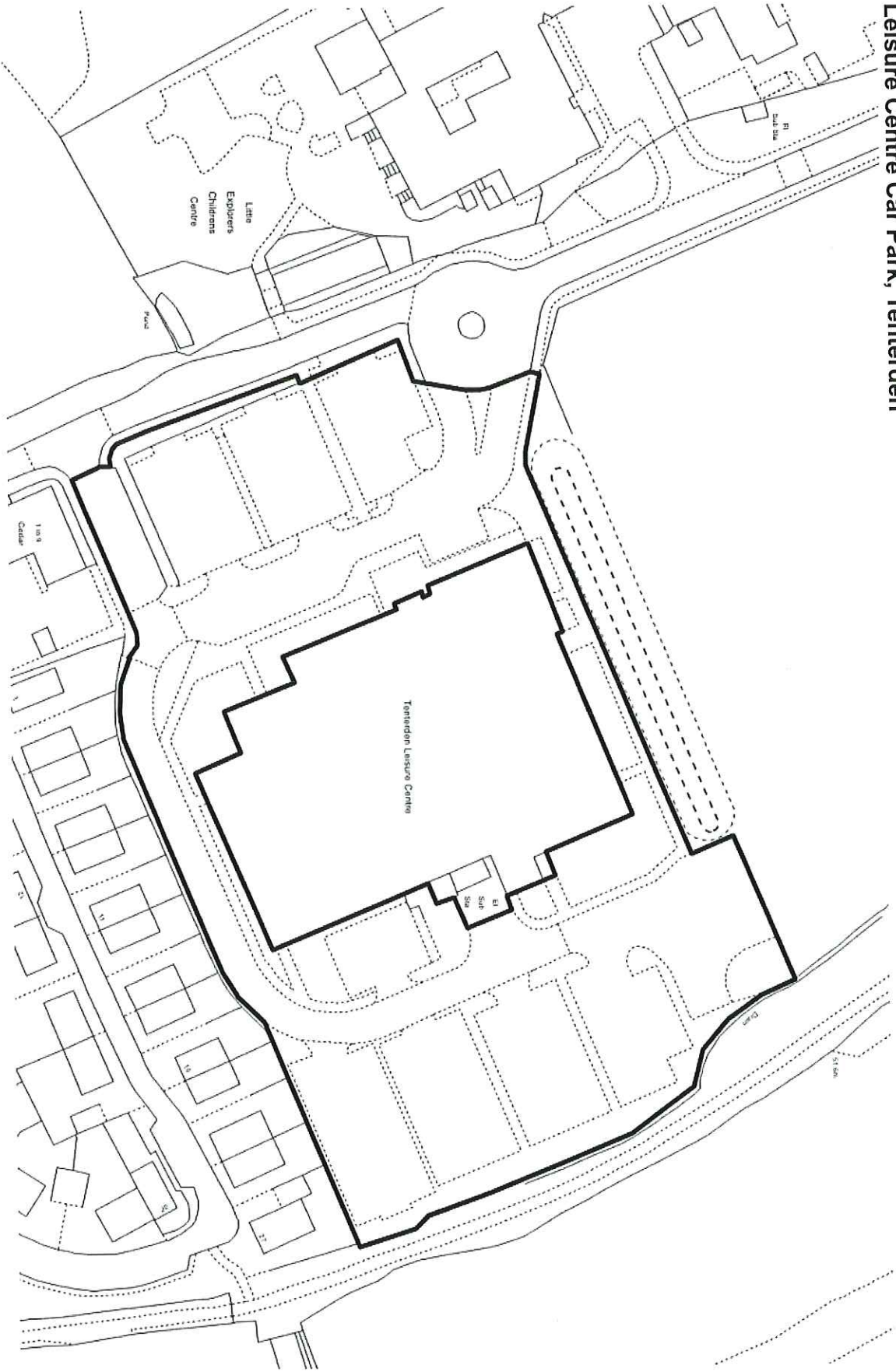

Market Place Car Park, Charing

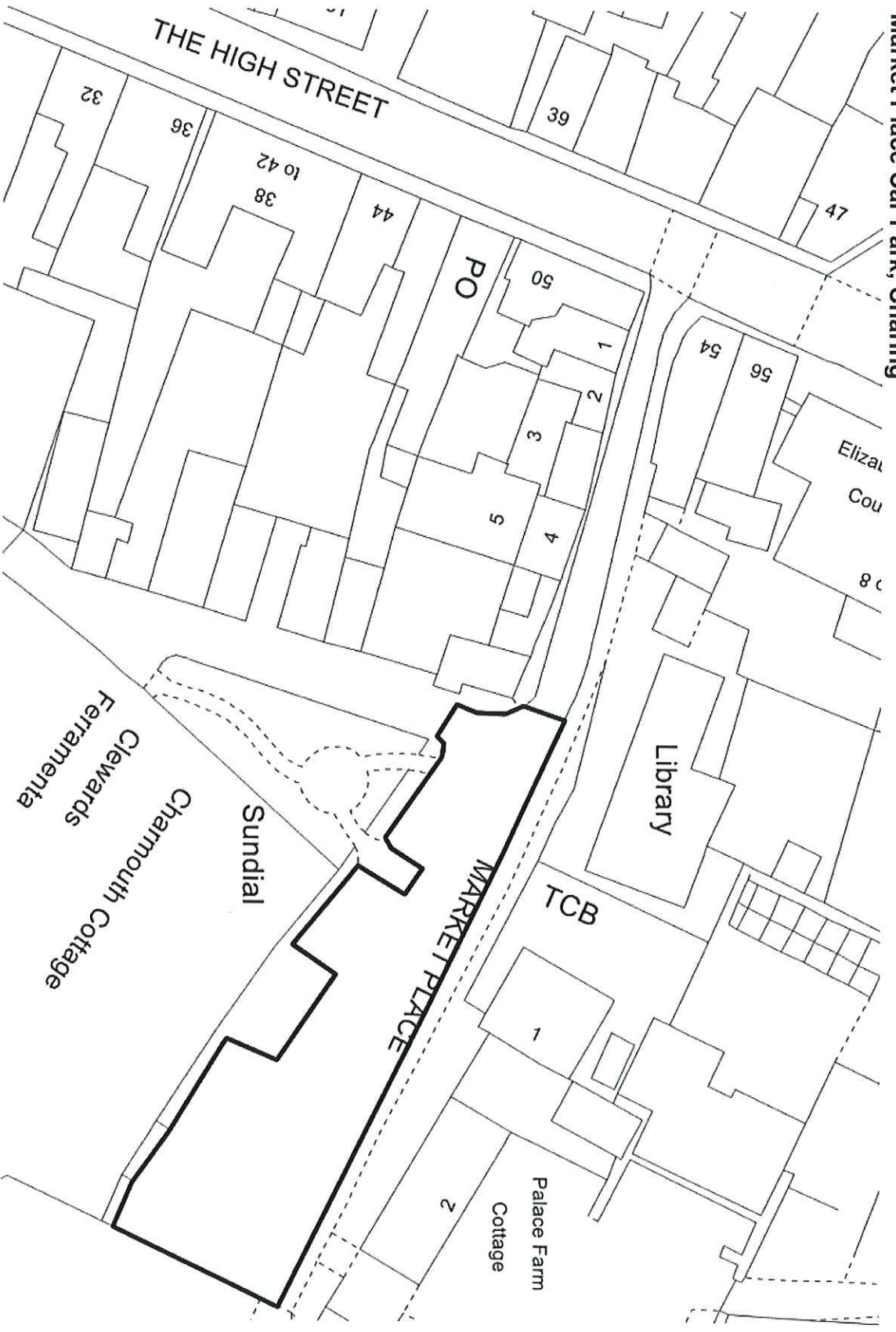

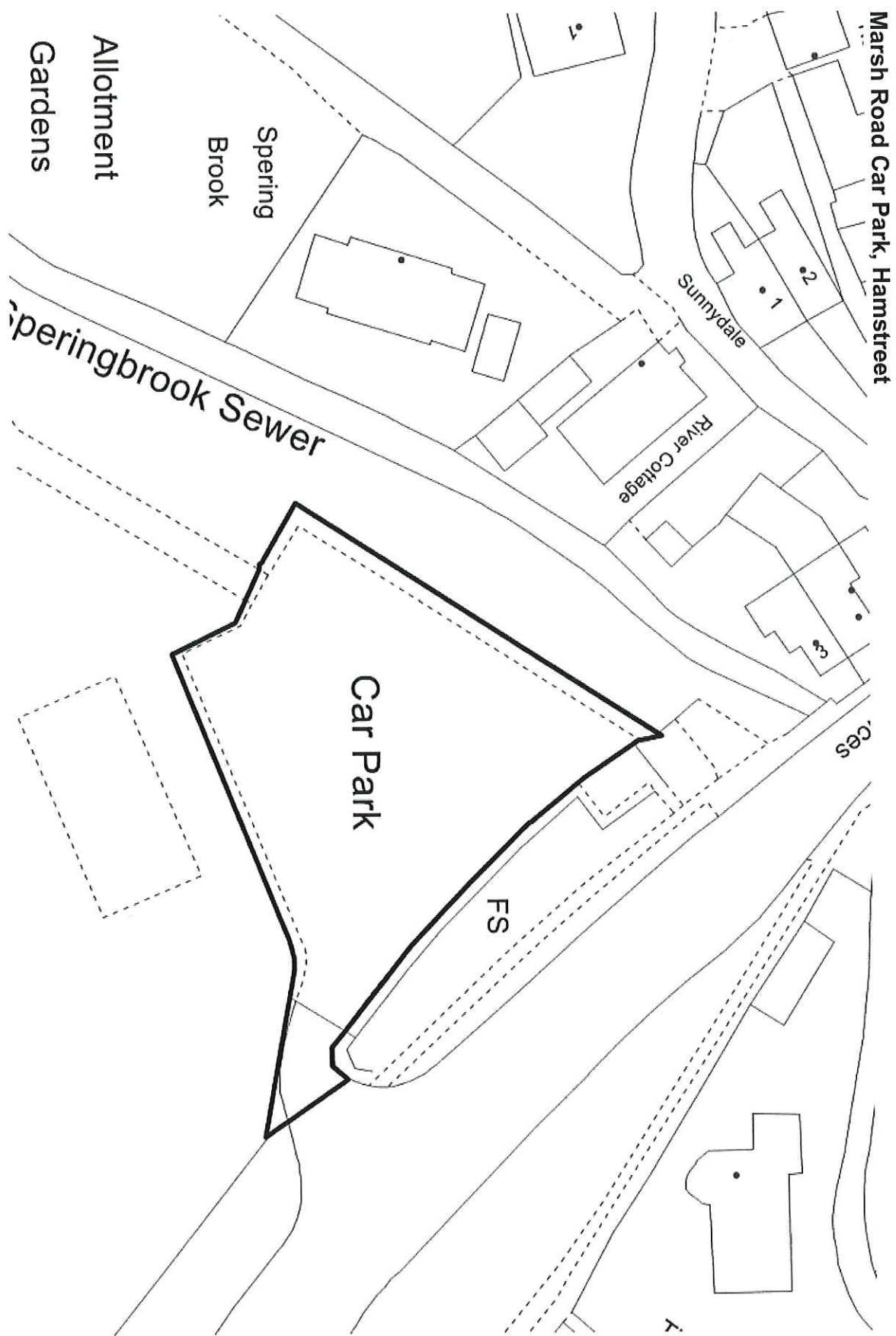

Recreation Ground Road Car Park, Tenterden

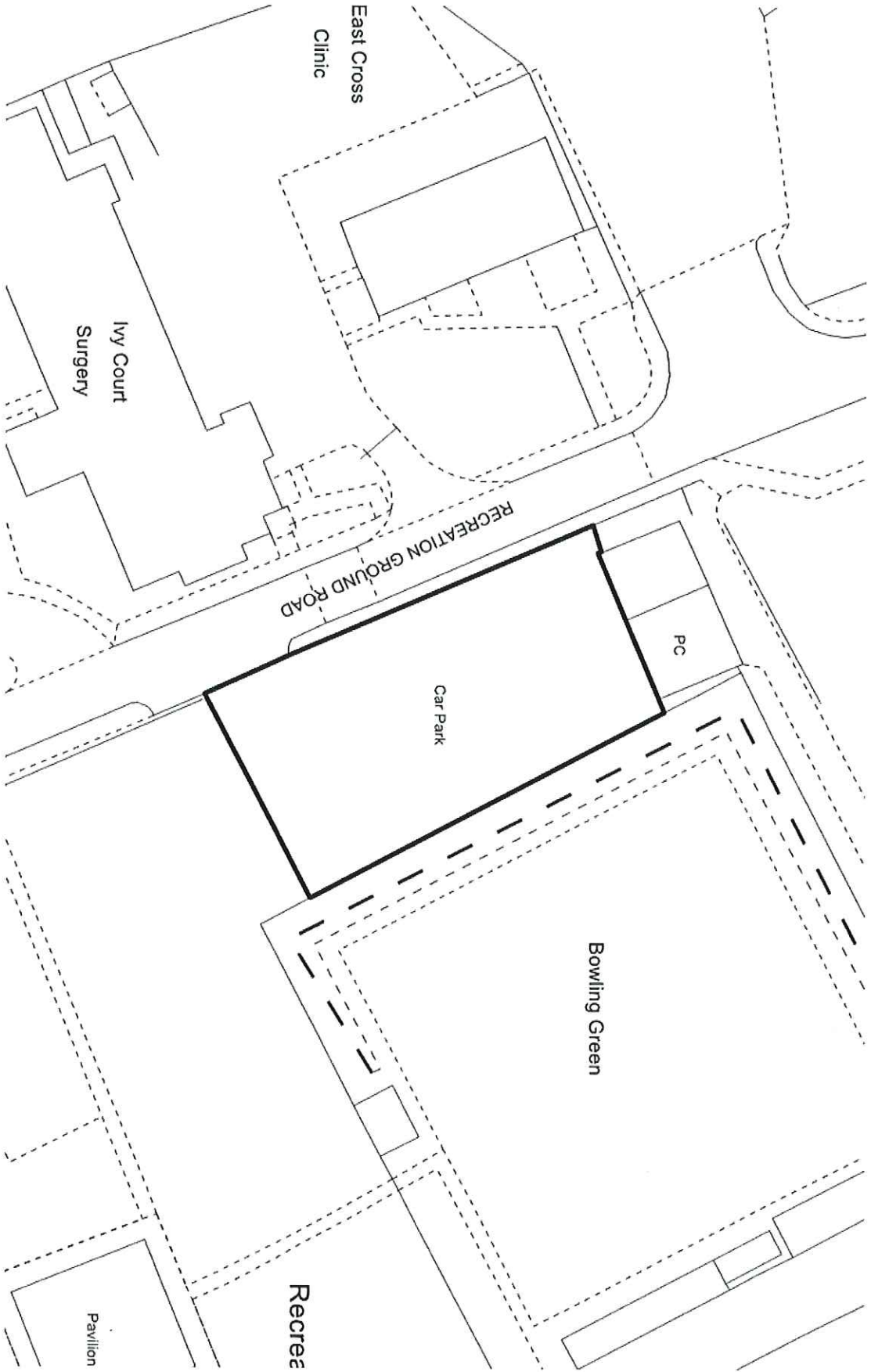

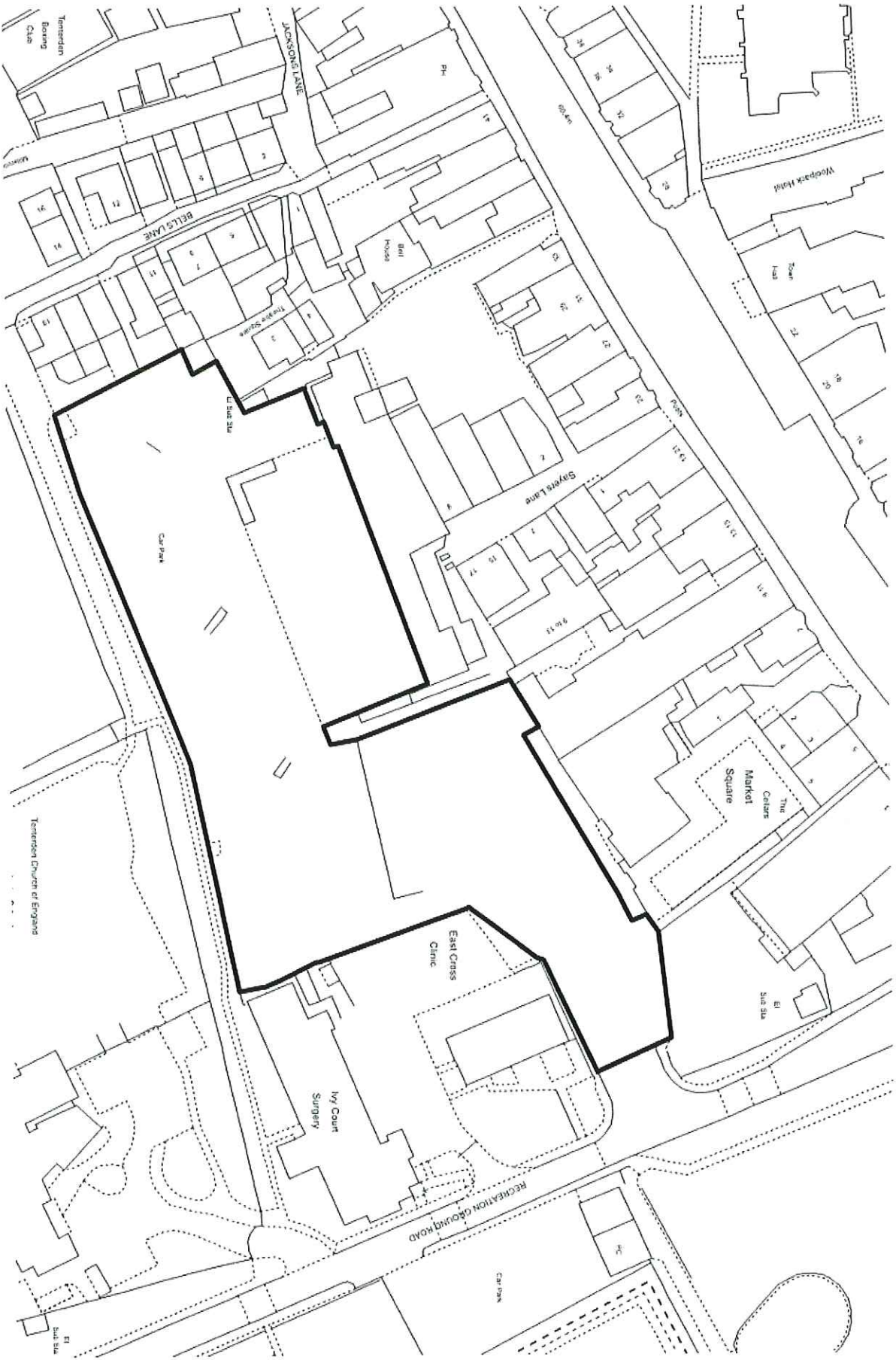

Rock Hill Road Car Park, Egerton

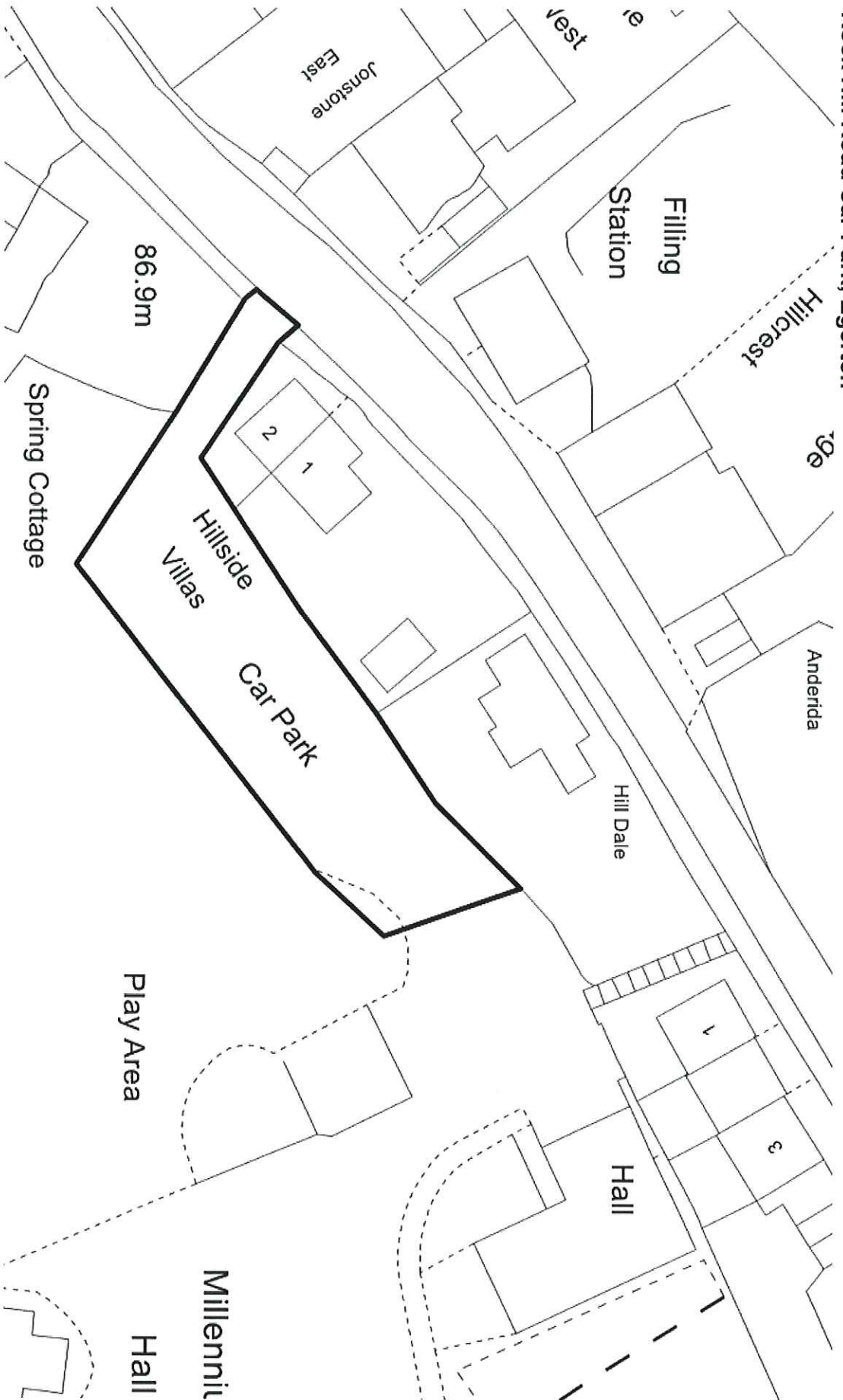

Station Road, Car Park, Tenterden

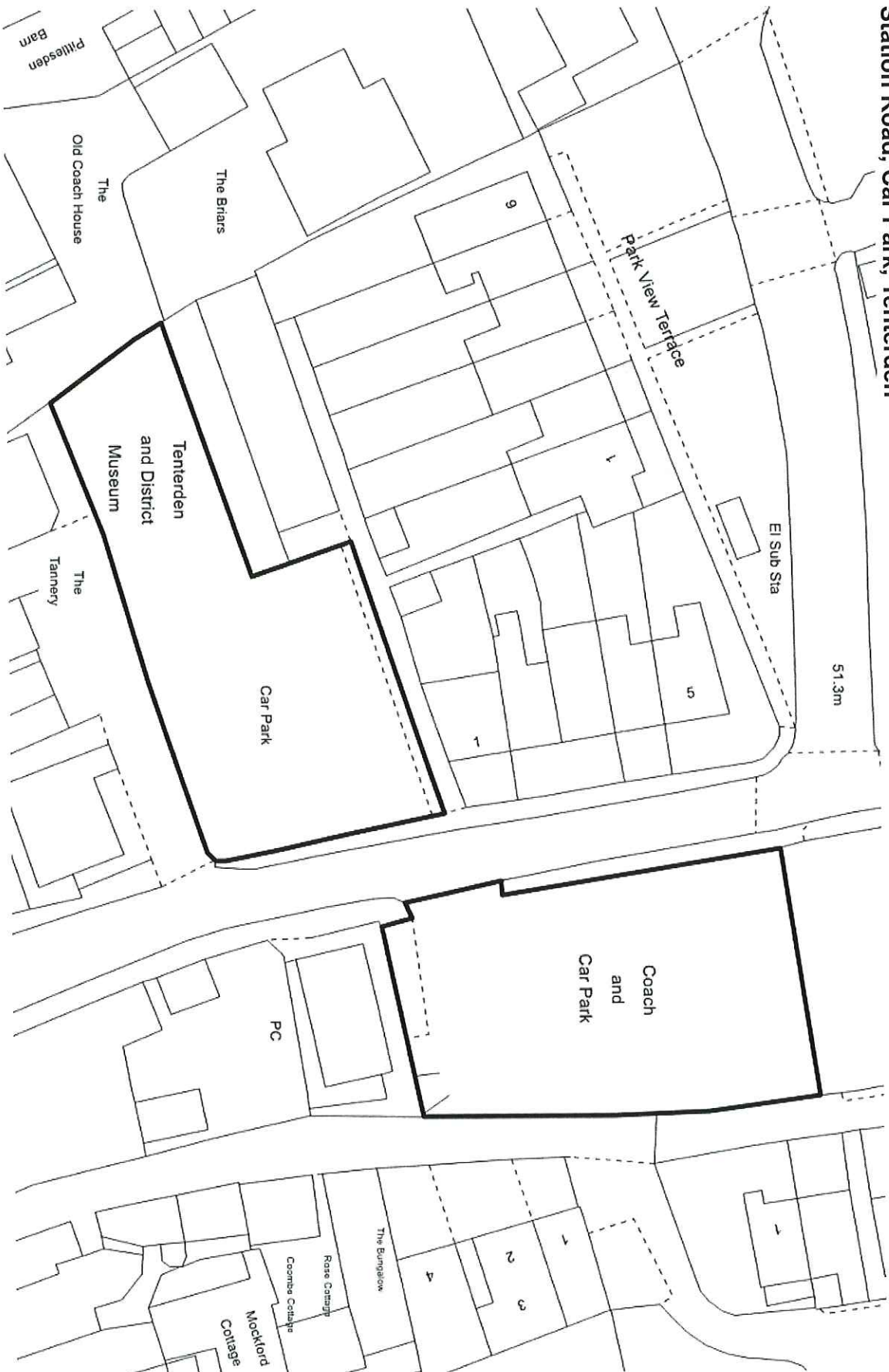

Station Road Car Park, Ashford

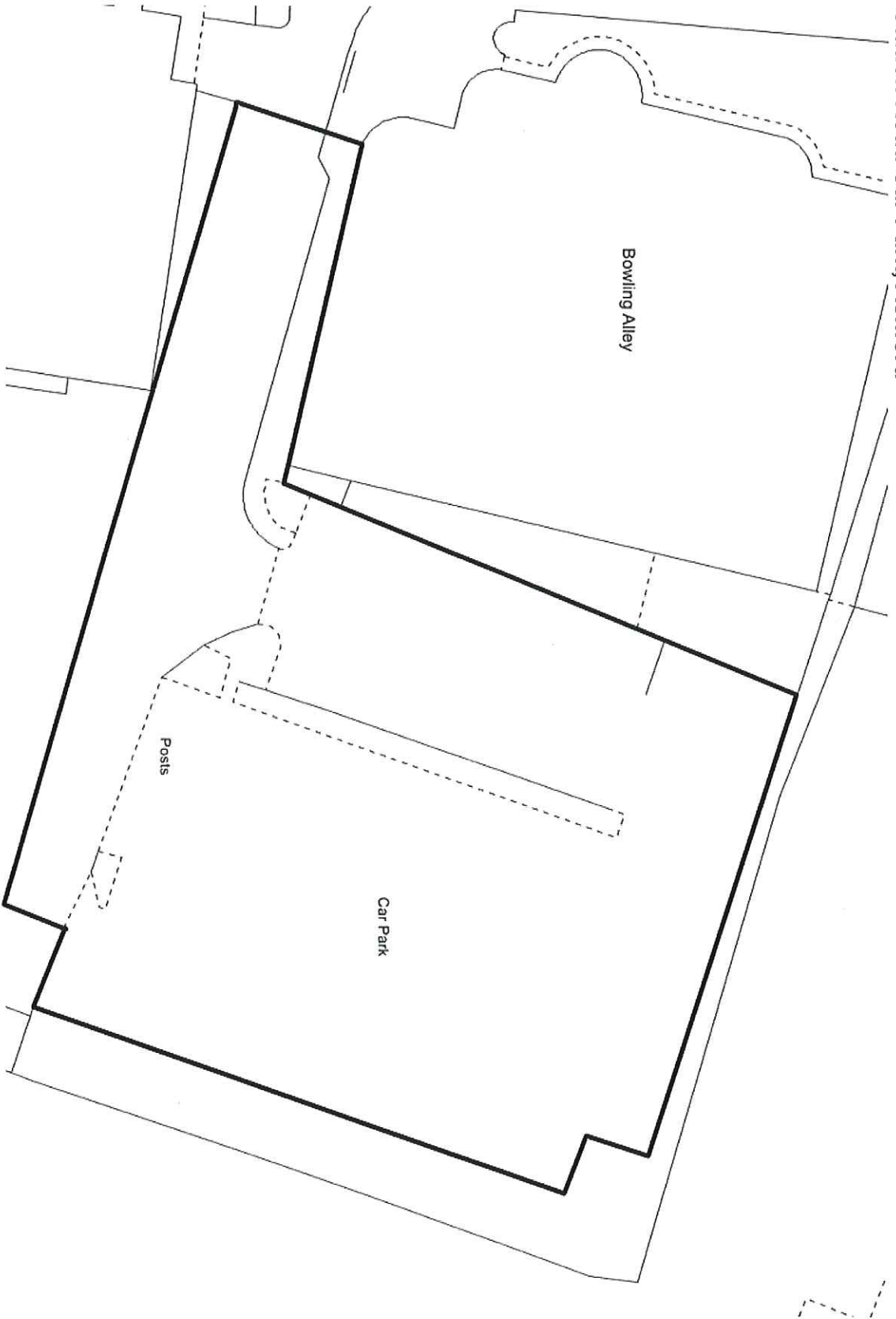

Station Road Car Park, Charing

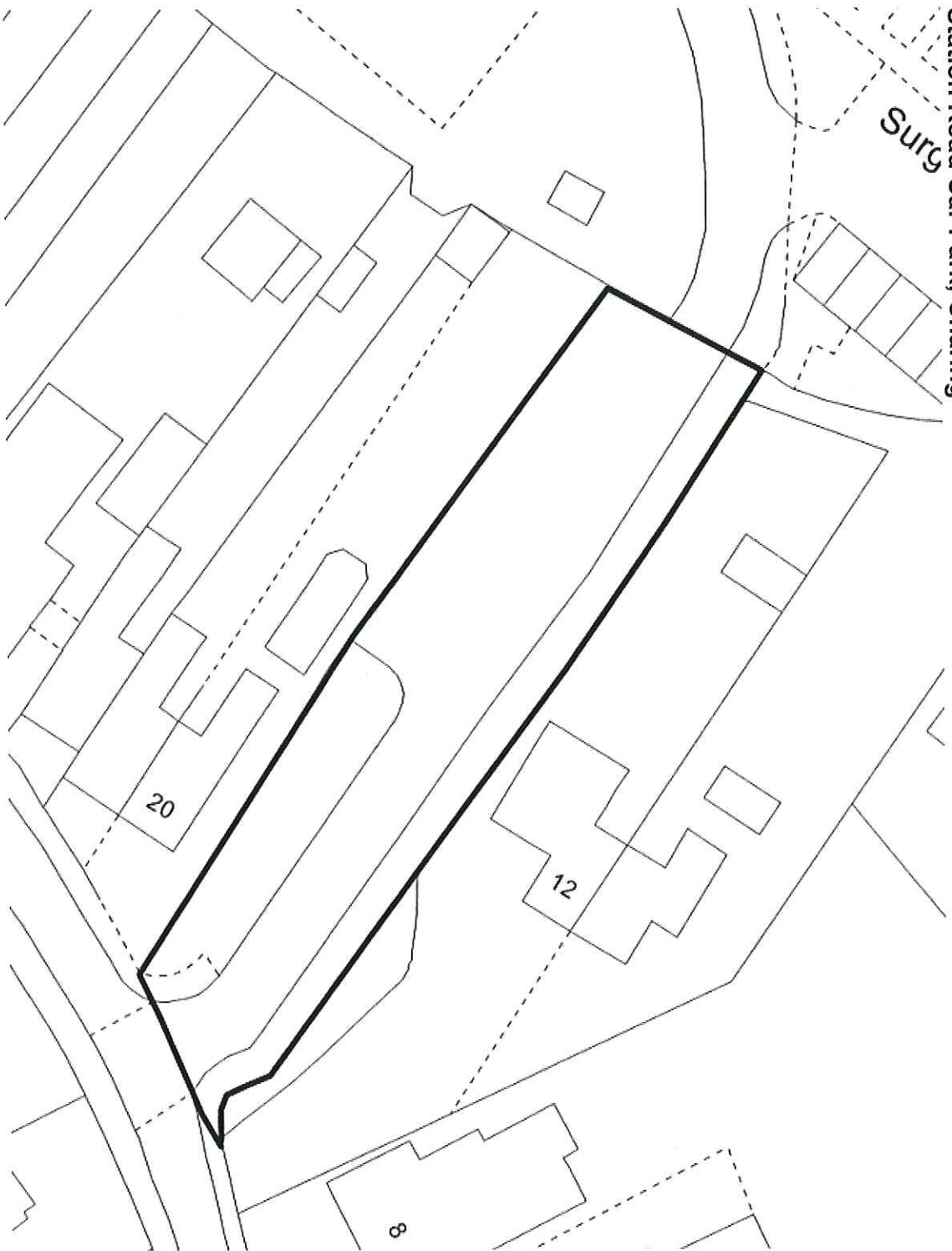

Civic Centre & Stour Centre Car Park

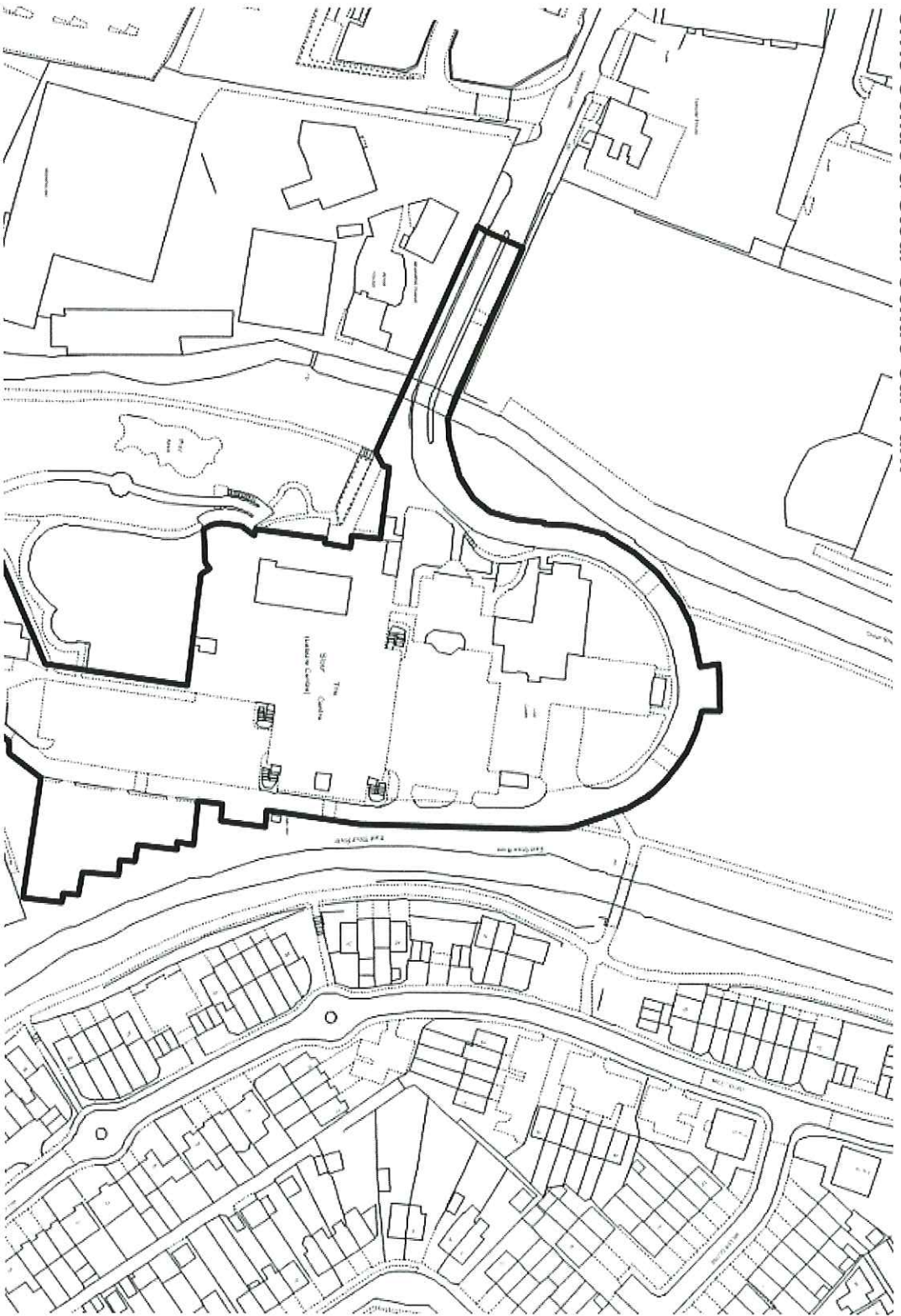



Taylor's Hill, Chilham

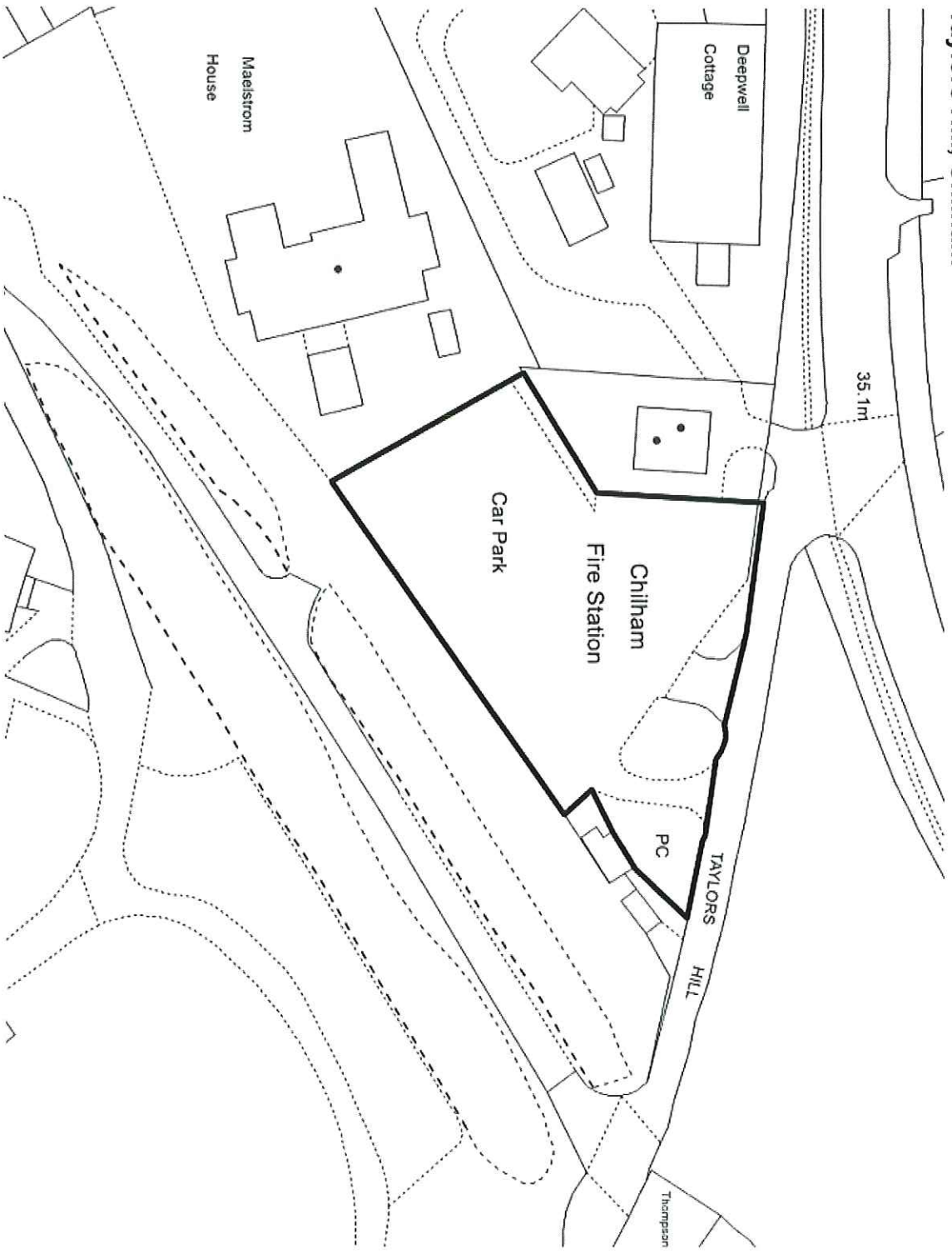

Vicarage Lane Car Park

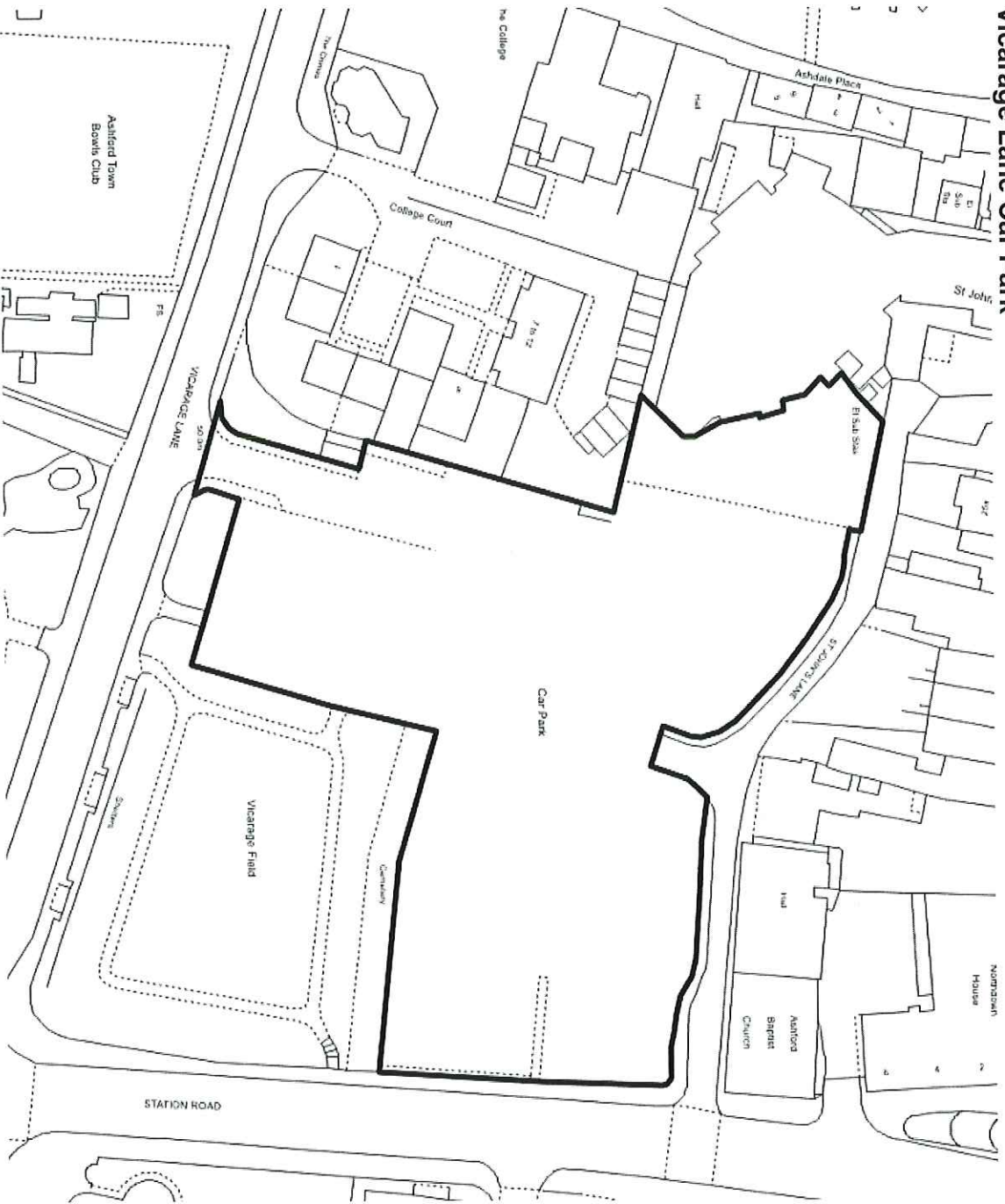

Victoria Road Car Park

